

INDEX TO DRAWINGS	
SHEET NO.	DESCRIPTION
1	T-1 TITLE SHEET
2	T-2 WORK SCOPE & GENERAL NOTES
3	AR-1 ASBESTOS REMOVAL-PARTIAL FLOOR PLAN AND DETAILS
4	A-1 FLOOR DEMOLITION AND RENOVATION PLAN
5	A-2 ROOF DEMOLITION AND RENOVATION PLAN
6	A-3 RENOVATION OF LABORATORY #1
7	A-4 RENOVATION OF LABORATORY #2
8	A-5 RENOVATION OF STORAGE SHED
9	A-6 OFFICE ADDITION
10	A-7 RENOVATION OF EXHAUST FANS
11	A-8 CABINET & COUNTERTOP SCHEDULE
12	A-9 WALL ENCLOSURE DETAILS, WALL MOUNTED CABINET DETAILS
13	A-10 WALL MOUNTED CABINET DETAILS
14	A-11 BASE CABINET AND COUNTER SECTIONS
15	S-1 FLOOR PLANS, SECTIONS, & GENERAL NOTES
16	S-2 SECTIONS & DETAILS
17	M-1 MECHANICAL
18	M-2 MECHANICAL
19	M-3 MECHANICAL
20	E-1 ELECTRICAL SYMBOLS, DEMOLITION NOTES, LUMINAIRE DETAIL
21	E-2 ELECTRICAL PLAN - DEMOLITION WORK
22	E-3 ELECTRICAL PLAN - NEW WORK

STATE OF HAWAII  
DEPARTMENT OF TRANSPORTATION  
HIGHWAYS DIVISION  
HONOLULU, HAWAII  
PLANS FOR  
BUILDING RENOVATION - MISCELLANEOUS  
MATERIALS TESTING & RESEARCH BRANCH  
PROJECT NO. HWY-0-02-00M  
2530 LIKELIKE HIGHWAY  
HONOLULU, HAWAII  
TAX MAP KEY 1-4-22:14  
DISTRICT OF HONOLULU  
ISLAND OF OAHU

DIST. NO.	STATE	PROJ. NO.	FISCAL YEAR	SHEET NO.	TOTAL SHEETS
HAWAII	HAW.	HWY-0-02-00M	2000	1	22

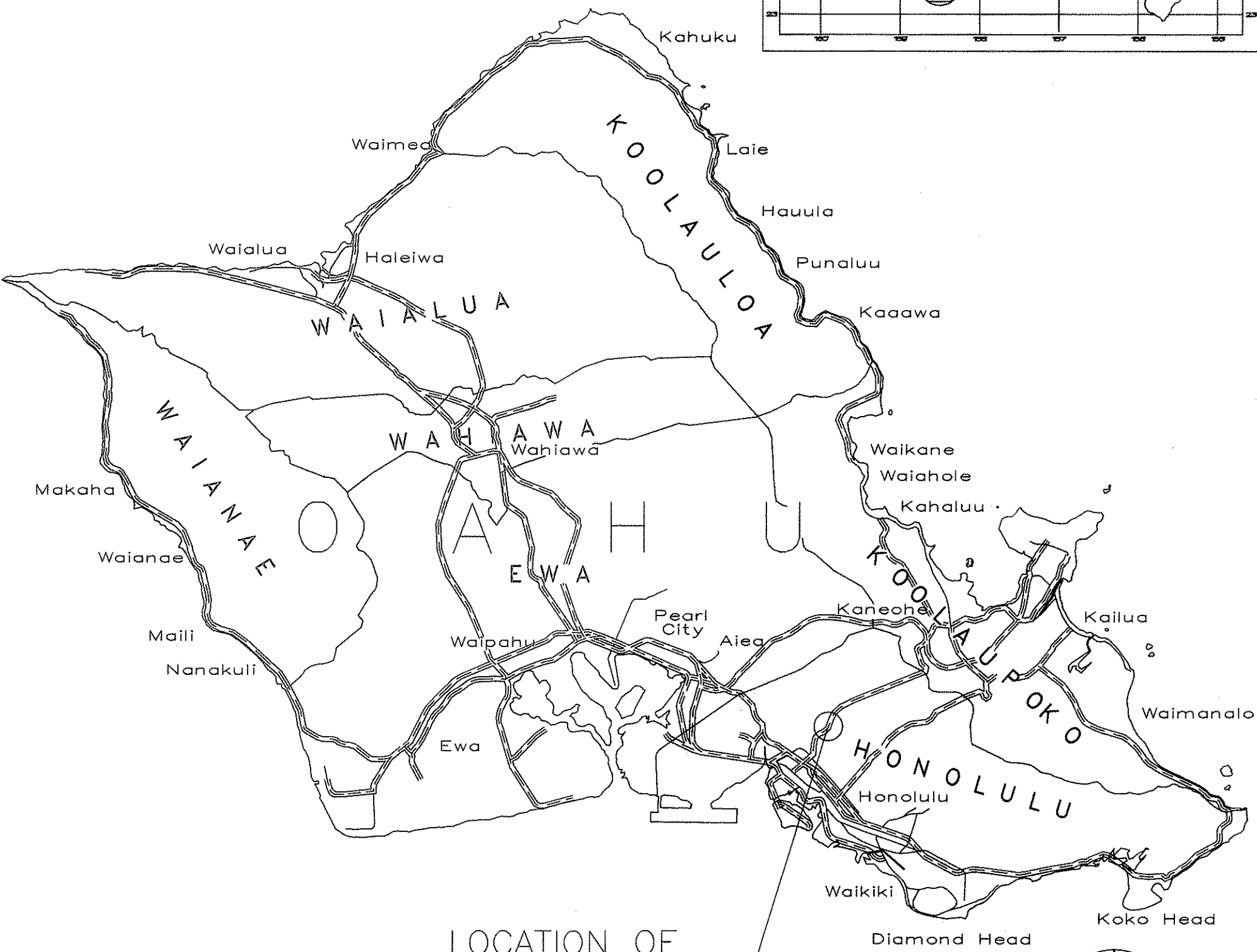
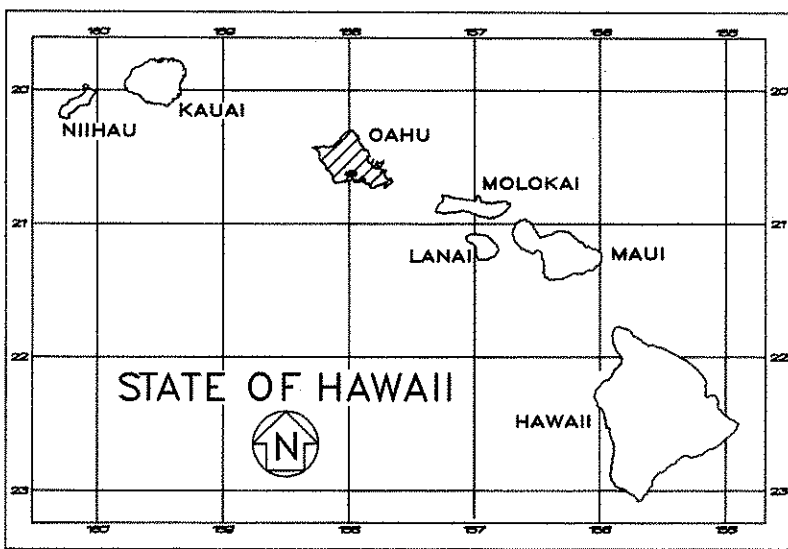
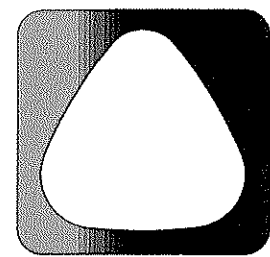

LOCATION OF  
PROJECT

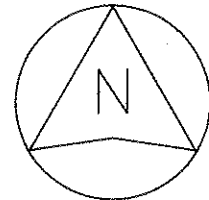

SCALE IN MILES

FEDERAL AID PROJECTS PREVIOUSLY CONSTRUCTED  
OR UNDER CONSTRUCTION

MILE POST 2.92 TO MILE POST 2.94

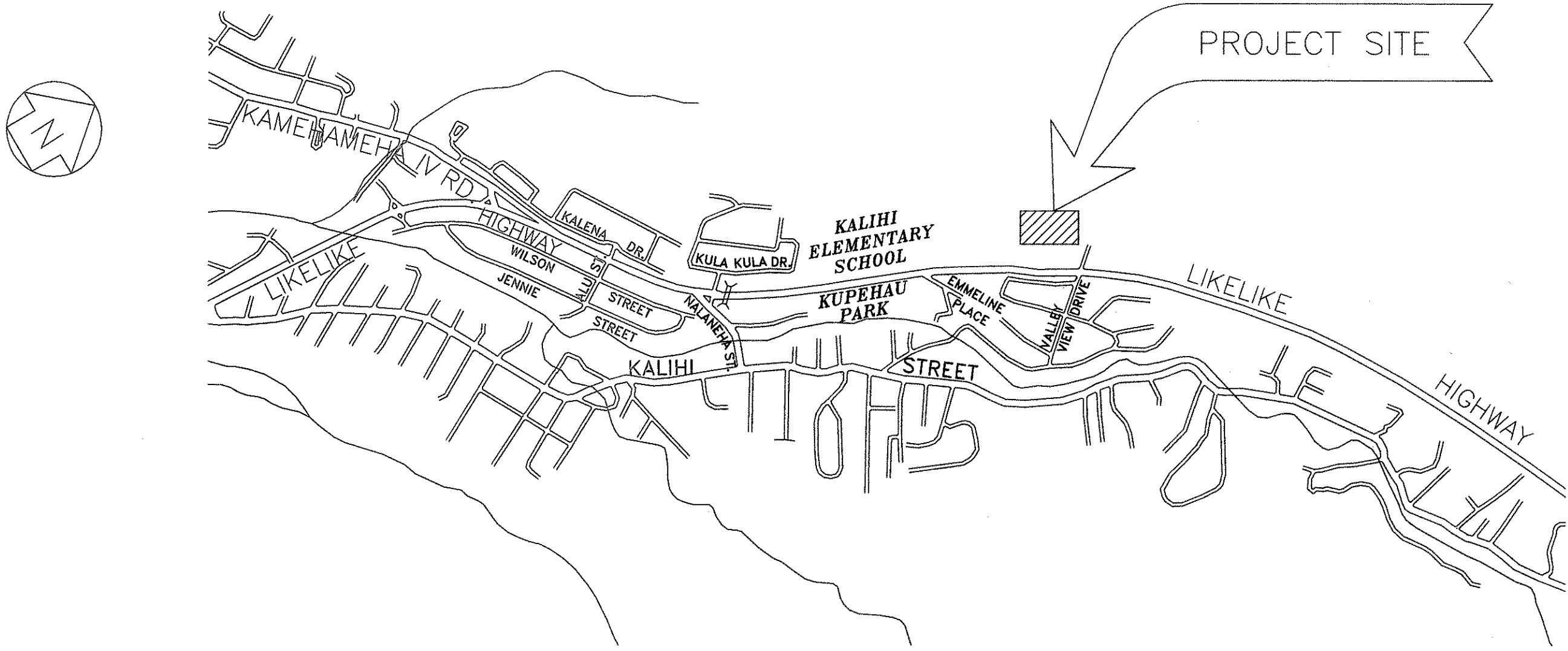

LOCATION PLAN

SCALE IN HUNDRED FEET

LOU CHAN & ASSOCIATES  
DESIGNED BY  
L. CHAN  
P. S. & E. BY  
596-7551  
PHONE  
MAY, 2000  
DATE

DEPARTMENT OF TRANSPORTATION  
STATE OF HAWAII  
APPROVED:  
*Kay Hayashida* 5/24/00  
DIR. OF TRANSPORTATION DATE

DIST. NO.	STATE	PROJ. NO.	FISCAL YEAR	SHEET NO.	TOTAL SHEETS
HAWAII	HAW.	HWY-0-02-00M	2000	ADD.2	22

## GENERAL NOTES

1. Demolition And Removal Work Shall Include All The Works Called Out To Be Demolished And Removed In The Construction Documents And All The Existing Work Required To Be Demolished And Removed For The New Construction Regardless Whether Or Not The Demolition And Removal Work Has Shown In The Drawings.

2. Items To Be Removed Shall Be Carefully Dismantled And/Or Demolished. Except Items Designated To Be Salvaged Or Saved For Re-Use.

3. Items Called Out Or Required To Be Demolished, Removal And Relocated But Physically Attached To Existing Surfaces Of Materials Designated To Be Remained Shall Be Dismantled Carefully As Not To Damage Existing Surfaces. Removed Items Connected To Existing Electrical, Data, Communication, Water, Waste, Pressure Air Supply, Gas, Plumbing, Security Devices Shall Be Carefully Disconnected And Capped At The Disconnections And/Or Capped At The Original Source If They Were In The Way Of New Construction. Remove And Dispose All Abandoned Pippings And Wiring. Cost For Dismantling, Removal, Disconnecting And Capping Shall Be Entirely Borne By The Contractor.

4. Asbestos Containing Materials (ACM) Are Found In The Existing Laboratory Counter Top Surface Panels, Backsplash, Undercoating Of Existing Stainless Steel Sinks, Vinyl Floor Tiles And Asbestos Cementitious Soffit Panels. A Copy Of Survey Report Is Included In The Specifications. Contractor Shall Notify His Employees, Subcontractors And All Other Persons Engaged On The Project Of The Presence Of Asbestos In The Materials Testing And Research Branch In Accordance With The Requirements Of Chapter 110, Article 12-110-2(F) (1) (B) Of The Occupational Safety And Health Standards, State Of Hawaii. All Work Which Disturbs Asbestos Containing Materials And Air Monitoring Work Shall Be Performed In Accordance With The Specification Section 686 - Asbestos Abatement. The Scope Of Asbestos Removal Work For This Project Is Described In The Drawings and Specifications.

5. Lead-Based Paint (LCP) Are Assumed To Be Present In The Existing Building Surfaces. The Contractor Shall Follow The Requirements Of Title 12 (Depart. Of Labor And Industrial Relations) Subtitle 8 Division Of Occupational Safety And Health, Chapter 148 (Lead Exposure In Construction), Hawaii Administrative Rules. All Work Which Disturbs LCP Shall Be Performed In Accordance With The Specification Section 685 - Handling Of Surfaces With Lead-Containing Paint. The Scope Of LCP Removal Is Incidental To The Scope Of Dismantling, Demolition, Repair And Repainting Work Indicated On This Plans.

### 2. LABORATORY #2

- Replace Countertop and Backsplash ACM Surfaces With Epoxy Resin Surfaces.
- Replace Stainless Steel Sinks, Faucets, and Plumbing Accessories.
- Remove and Reinstall Gas, Water, Air Outlets.
- Install Wall Cabinets.
- Replace Existing Metal Door and Jalousie Windows With CMU Wall.
- Repaint Cabinet Doors And Exterior Surfaces.

### 3. STORAGE SHED

- Replace Existing Metal Roof
- Replace Entrance Door, Frame and Hardware

### 4. OFFICE ADDITION

- Construct Metal Stud Walls To Enclose Lanai.
- Install Flooring, Replace Door Hardware
- Install Air Conditioning System
- Install Electrical Lights, Outlets and Telephone Jack.

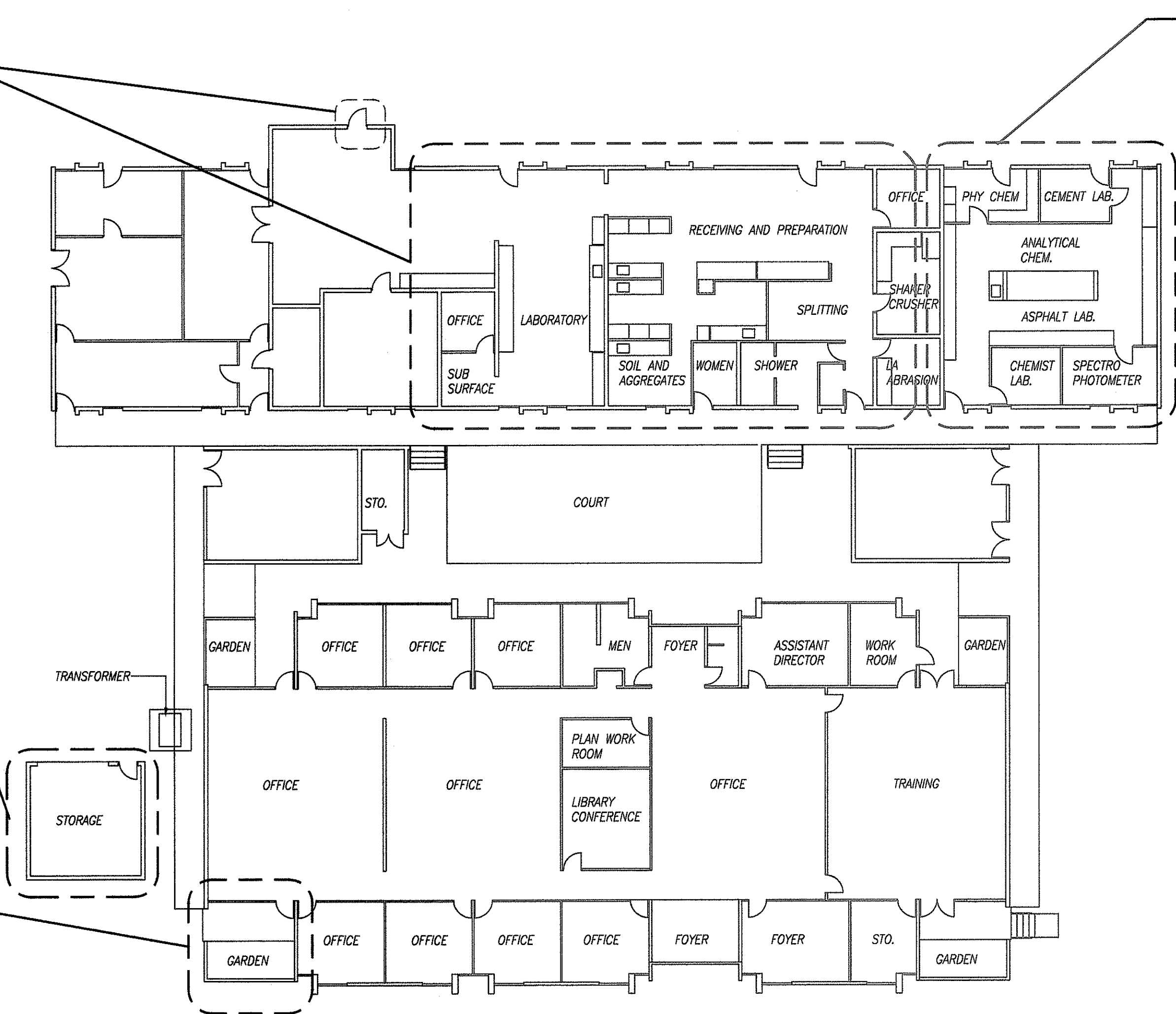

### 1. LABORATORY #1

- Replace Countertop and Backsplash ACM Surfaces With Epoxy Resin Surfaces.
- Replace Epoxy Resin Sinks, Faucets, and Plumbing Accessories.
- Remove and Reinstall Gas, Water, Air Outlets.
- Replace Roof Mounted Fans, Housings, and Base Flashings.
- Repaint Cabinet Doors And Exterior Surfaces.

ORIGINAL PLAN	SURVEY PLOTTED BY	DATE
NOTE BOOK	DRAWN BY	M. Fiteraid
DESIGNED BY	CHECKED BY	L. Chan
QUANTITIES BY		
NO.		

## WORK SCOPE PLAN

SCALE: 1/8" = 1'-0"

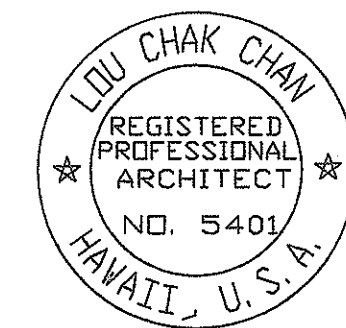

THIS WORK WAS PREPARED BY ME OR UNDER MY SUPERVISION.

T-2

6/19/00

Revised Notes.

DATE

REVISION

STATE OF HAWAII  
DEPARTMENT OF TRANSPORTATION  
HIGHWAYS DIVISION

WORK SCOPE & GENERAL NOTES

BUILDING RENOVATION - MISCELLANEOUS  
MATERIALS TESTING & RESEARCH BRANCH  
Project No. HWY-0-02-00M

Scale:

Date: MAY, 2000

SHEET No. 2 OF 22 SHEETS

ADD.2