

FED. ROAD DIST. NO.	STATE	FED. AID PROJ. NO.	FISCAL YEAR	SHEET NO.	TOTAL SHEETS
HAWAII	HAW.	I-H3-1(57)	1988	26	274

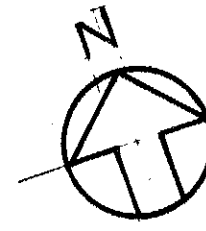

Notes: 1 Existing Topographic Features, Including Ground Contours are from Field Surveys of the Project Site Provided by the State of Hawaii, Dated 27 September 1983.
Existing Topography has been Supplemented by Information from the Haiku Valley Bridges Construction Plans.

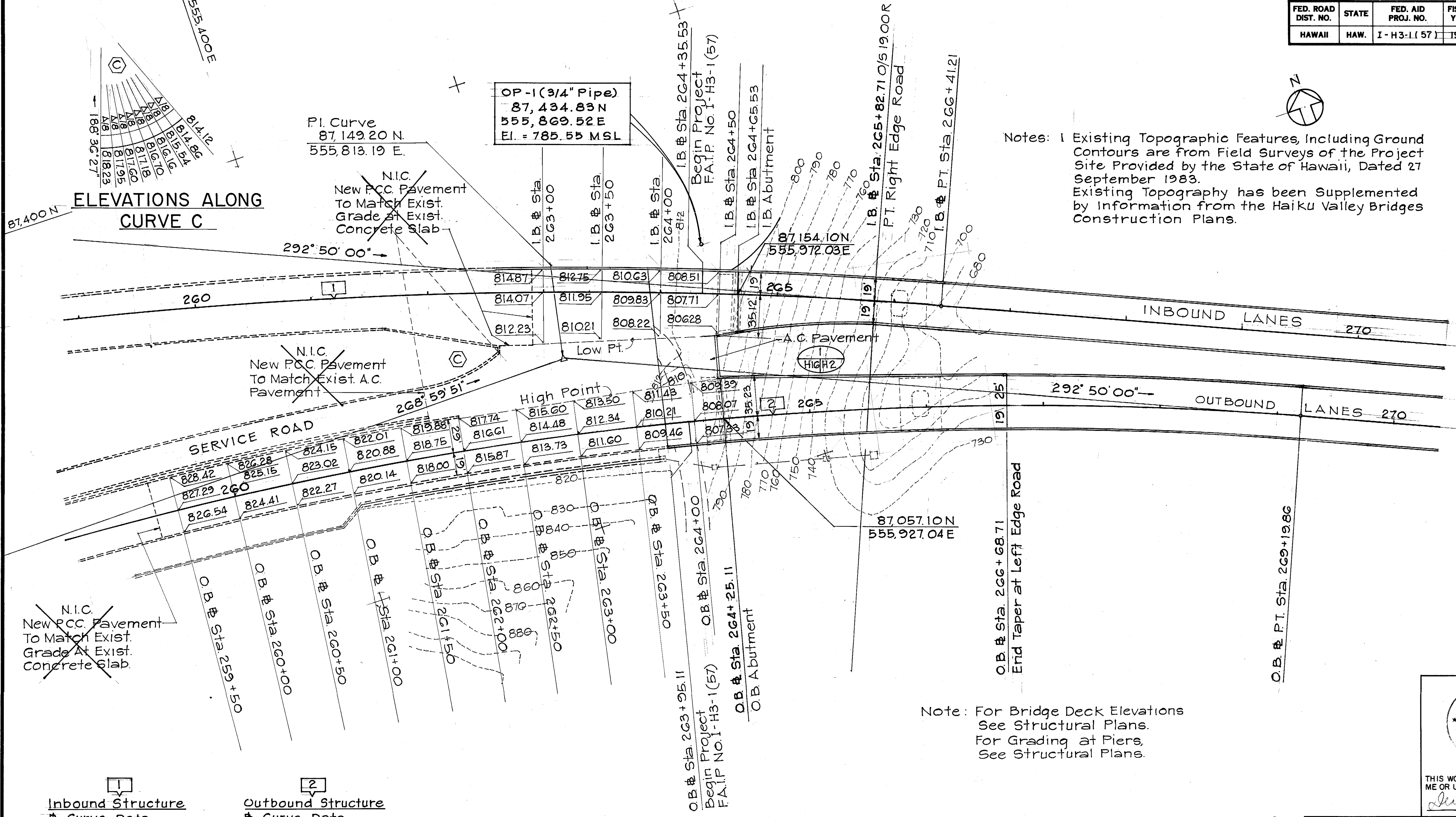

Note: For Bridge Deck Elevations See Structural Plans.
For Grading at Piers, See Structural Plans.

Inbound Structure	Outbound Structure
Curve Data	Curve Data
$\Delta = 28^{\circ} 43' 44''$	$\Delta = 23^{\circ} 50' 09''$
$\Delta/2 = 14^{\circ} 21' 52''$	$\Delta/2 = 11^{\circ} 55' 04''$
$R = 4000.00'$	$R = 3000.00'$
$T = 1024.38'$	$T = 633.18'$
$Ch = 1984.71'$	$Ch = 1239.06'$
$Lc = 2005.65'$	$Lc = 1248.04'$

GRADING PLAN
SCALE: 1" = 40'

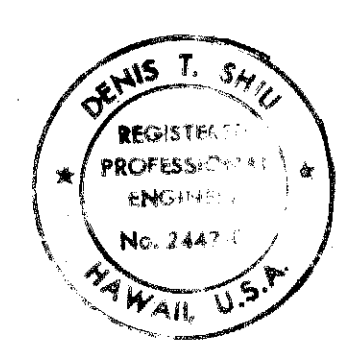

THIS WORK WAS PREPARED BY ME OR UNDER MY SUPERVISION
Denis T. Shiu

STATE OF HAWAII
DEPARTMENT OF TRANSPORTATION
HIGHWAYS DIVISION

GRADING PLAN

INTERSTATE ROUTE H-3
F.A.I. PROJECT NO. I-H3-1(57)
F.A.I. PROJECT NO. I-H3-1(58)
SCALE: AS NOTED DATE: SEPT. 1988
SHEET NO. H16 OF 18 SHEETS

ORIGINAL PLAN	DATE
DESIGNED BY	
TRACED BY	
NOTED BY	
CHECKED BY	
NO.	