

FED. ROAD DIST. NO.	STATE	FED. AID PROJ. NO.	FISCAL YEAR	SHEET NO.	TOTAL SHEETS
HAWAII	HAW.	I-H3-1(57)	1988	6	274

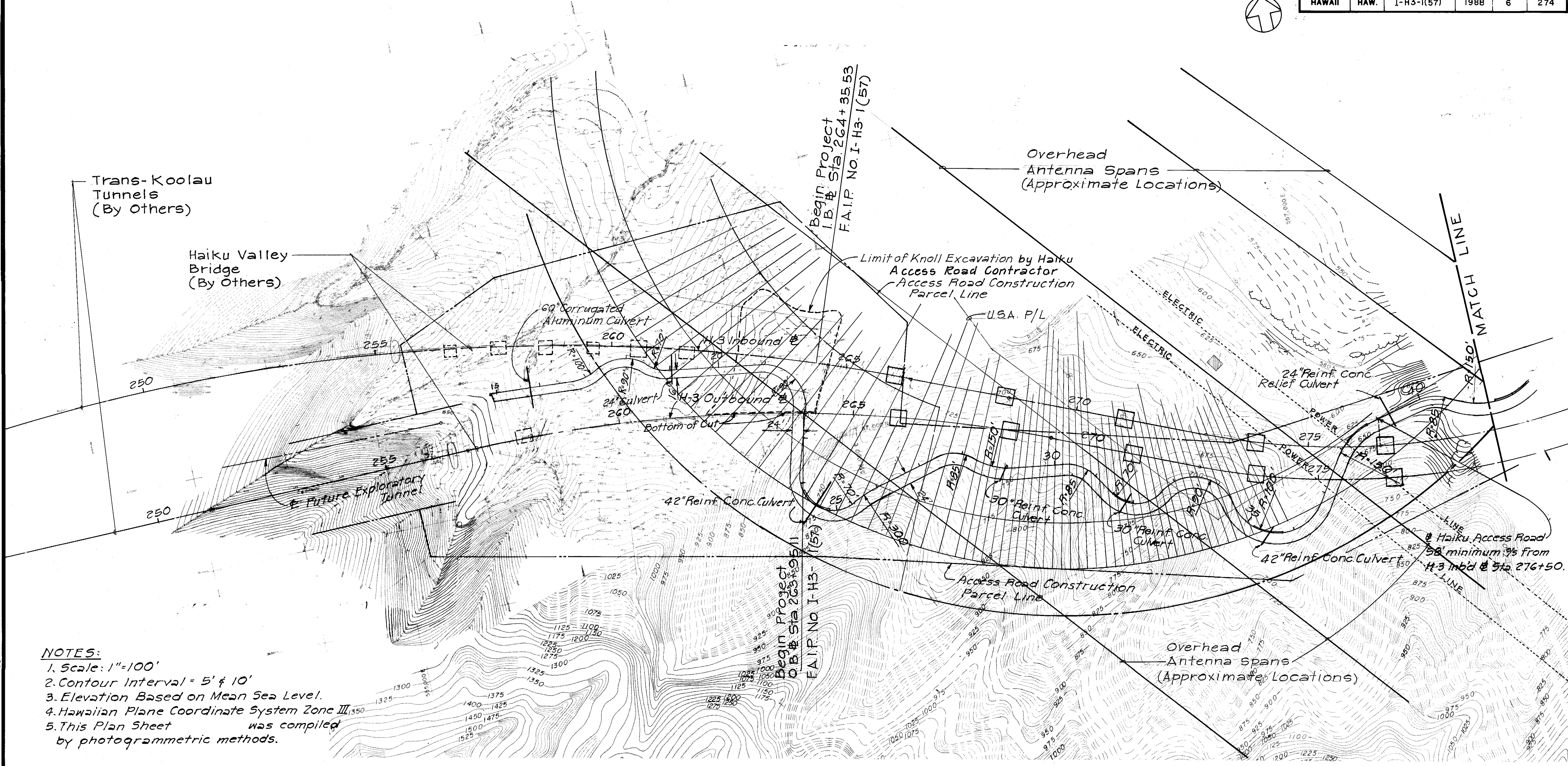

- NOTES:**
1. Scale: 1"=100'
  2. Contour Interval = 5' & 10'
  3. Elevation Based on Mean Sea Level.
  4. Hawaiian Plane Coordinate System Zone III
  5. This Plan Sheet was compiled by photogrammetric methods.

SURVEY PLOTTED BY	DATE
DRAWN BY	
DESIGNED BY	
QUANTITIES BY	
CHECKED BY	
ORIGINAL PLAN	
NOTE BOOK	
NO.	

Notes: 1. The Haiku Access Road Alignment is Based on the Haiku Access Road Construction Plans Dated May 1988. The Actual Alignment Shall be Verified by the Contractor. These Plans are Furnished for Information Only.

2. Existing Topographic Features, Including

Ground Contours are from Field Surveys of the Project Site Provided by the State of Hawaii, Dated 27 September 1983.

STATE OF HAWAII  
DEPARTMENT OF TRANSPORTATION  
HIGHWAYS DIVISION  
**EXISTING PLAN**  
@ STA 250+00 TO STA 280+00  
INTERSTATE ROUTE H-3  
F.A.I. PROJECT NO. I-H3-1(57)  
F.A.I. PROJECT NO. I-H3-1(58)  
SCALE: 1"=100' DATE: SEPT. 1988  
SHEET No. 1 OF 3 SHEETS



FED. ROAD DIST. NO.	STATE	FED. AID PROJ. NO.	FISCAL YEAR	SHEET NO.	TOTAL SHEETS
HAWAII	HAW.	I-H3-1(57)	1988	7	274

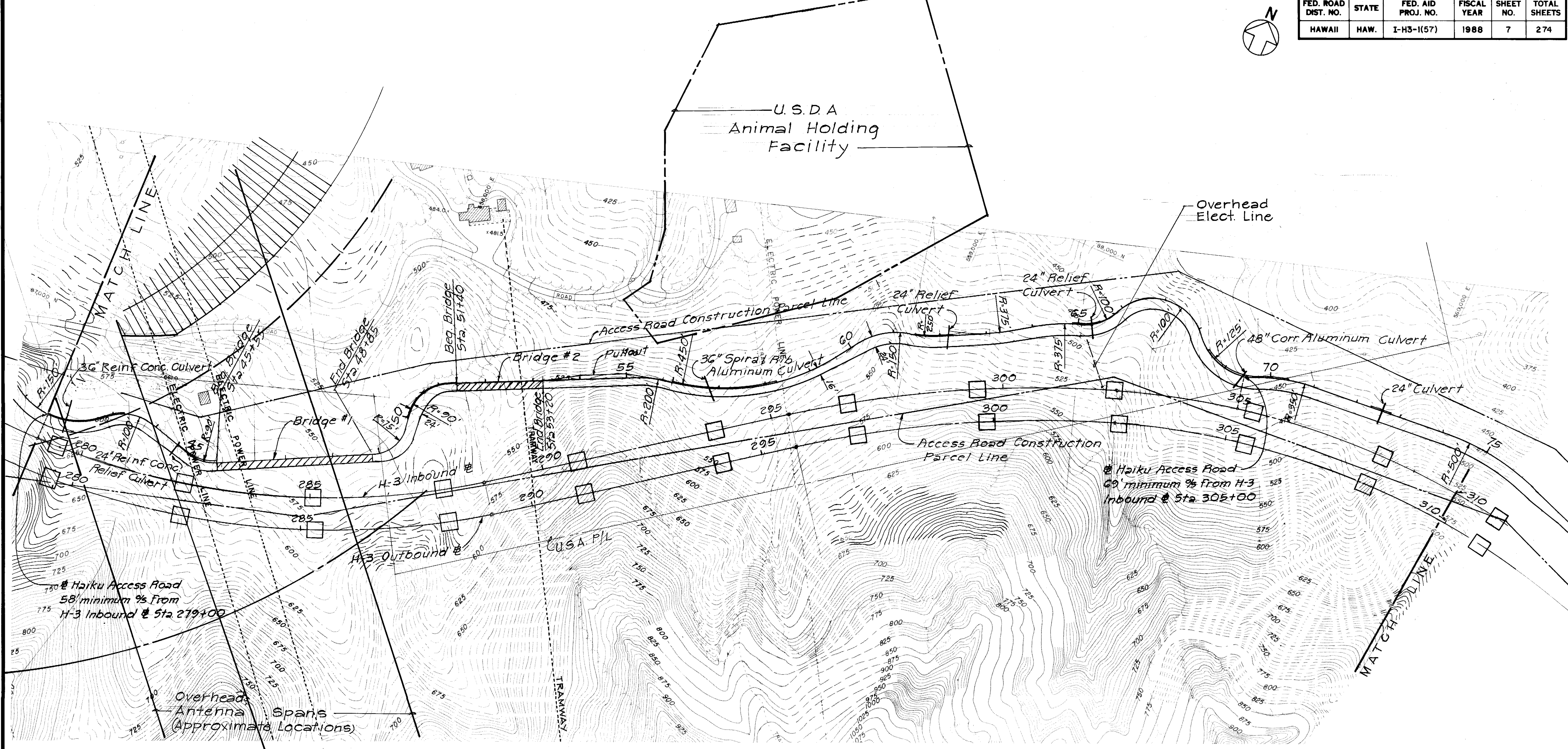
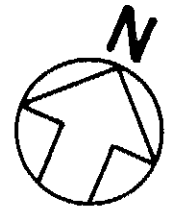

- NOTES:**
1. Scale: 1"=100'
  2. Contour Interval = 5'
  3. Elevation Based on Mean Sea Level.
  4. Hawaiian Plane Coordinate System Zone III.
  5. This Plan Sheet was compiled by photogrammetric methods.

- Notes:
1. The Haiku Access Road Alignment is Based on the Haiku Access Road Construction Plans Dated May 1988. The Actual Alignment Shall be Verified by the Contractor. These Plans are Furnished for Information Only.
  2. Existing Topographic Features, Including

Ground Contours are from Field Surveys of the Project Site Provided by the State of Hawaii, Dated 27 September 1983.

STATE OF HAWAII  
DEPARTMENT OF TRANSPORTATION  
HIGHWAYS DIVISION

**EXISTING PLAN**

STA 280+00 TO STA 310+00

INTERSTATE ROUTE H-3

F.A.I. PROJECT NO. I-H3-1(57)

F.A.I. PROJECT NO. I-H3-1(58)

SCALE: 1"=100'      DATE: SEPT. 1988

SHEET NO. 2 OF 3 SHEETS

SURVEY PLOTTED BY	DATE
DRAWN BY	
DESIGNED BY	
QUANTITIES BY	
CHECKED BY	
ORIGINAL PLAN	
NOTE BOOK	
No.	



FED. ROAD DIST. NO.	STATE	FED. AID PROJ. NO.	FISCAL YEAR	SHEET NO.	TOTAL SHEETS
HAWAII	HAW.	I-H3-1(57)	1988	8.	274

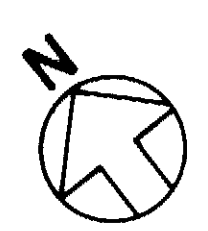

Note to Windward Viaduct Contractor  
The Contractor Shall not use The Existing BWS Service Road for Access to the Pier Locations.

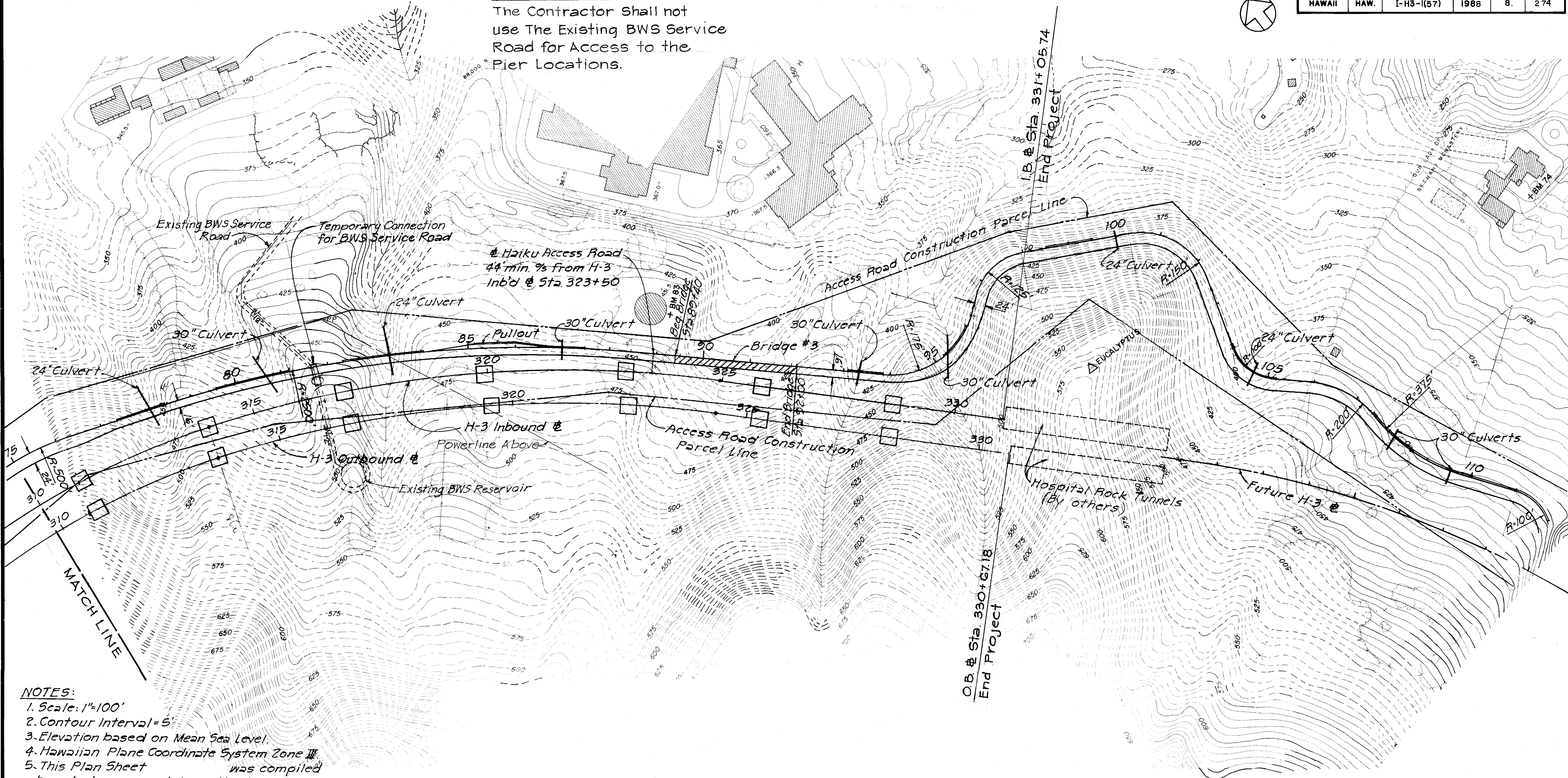

- NOTES:
1. Scale: 1"=100'
  2. Contour Interval=5'
  3. Elevation based on Mean Sea Level.
  4. Hawaiian Plane Coordinate System Zone III.
  5. This Plan Sheet was compiled by photogrammetric methods.

- Notes:
1. The Haiku Access Road Alignment is Based on the Haiku Access Road Construction Plans Dated May 1988, The Actual Alignment shall be Verified by the Contractor These Plans are Furnished for Information only.
  2. Existing Topographic Features Including

Ground Contours are from Field Surveys of the Project Site Provided by the State of Hawaii, Dated 27 September 1983.

STATE OF HAWAII  
DEPARTMENT OF TRANSPORTATION  
HIGHWAYS DIVISION  
**EXISTING PLAN**  
Sta 310+00 TO STA 315+00  
INTERSTATE ROUTE H-3  
F.A.I. PROJECT NO. I-H3-1(57)  
F.A.I. PROJECT NO. I-H3-1(58)  
SCALE: 1"=100'      DATE: SEPT. 1988  
**SHEET No. 3 OF 3 SHEETS**

SURVEY PLOTTED BY	DATE
DRAWN BY	
DESIGNED BY	
QUANTITIES BY	
CHECKED BY	
ORIGINAL PLAN	
NOTE BOOK	
NO.	