

FED. ROAD DIST. NO.	STATE	FEDERAL AID PROJ. NO.	FISCAL YEAR	SHEET NO.	TOTAL SHEETS
HAWAII	HAW.	I-H3-1(75), UNIT VIIC	2022	25	50

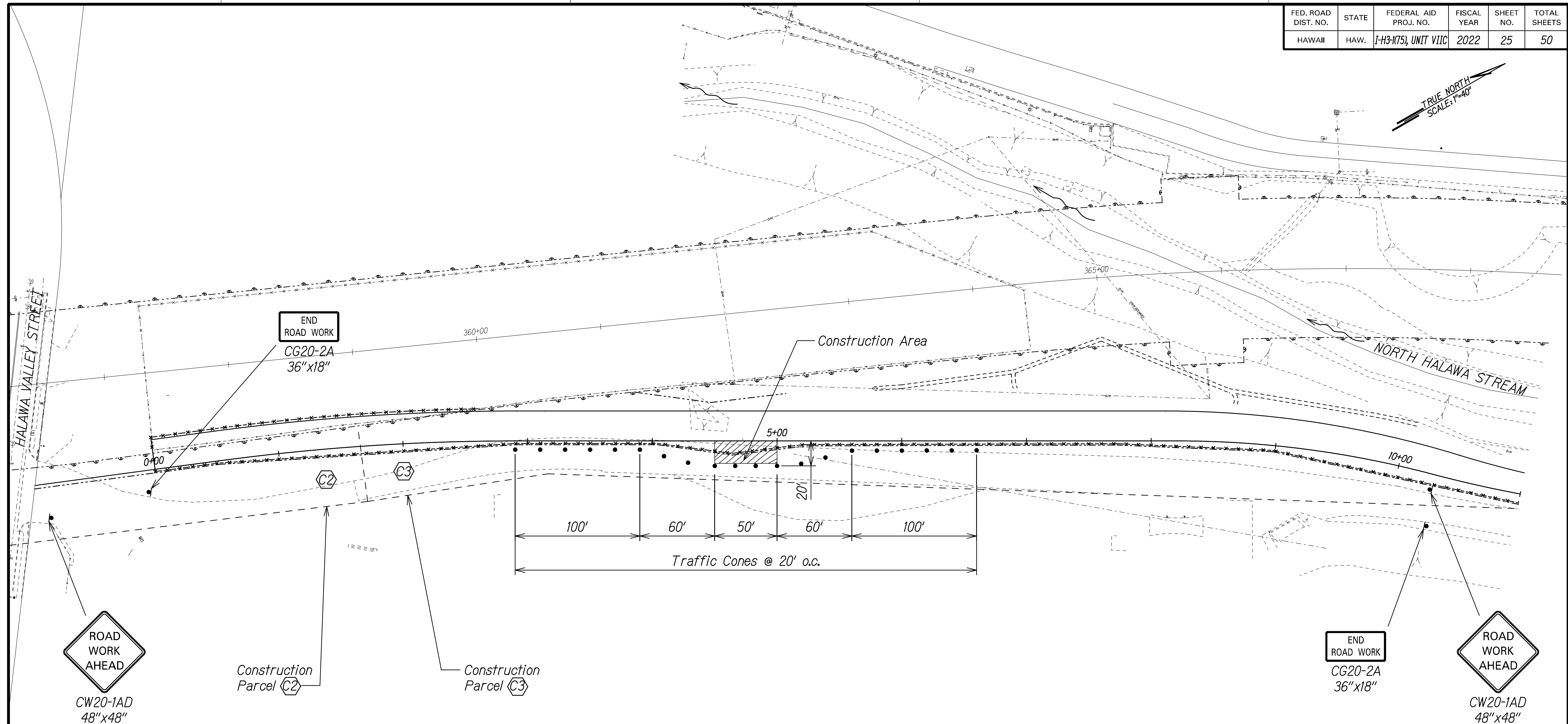

NOTES:

1. For coordination in the joint use of the existing Halawa Access Road with Hawaiian Cement, see Special Provisions, Subsection 105.09(6) - Coordination Between the Contractors.
2. The existing Halawa Access Road shall be passable to vehicular traffic at all times.

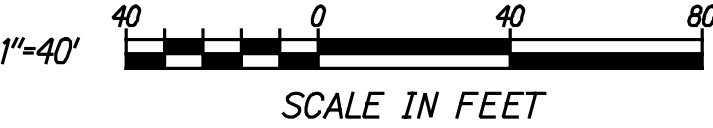

ORIGINAL PLAN	SURVEY PLOTTED BY	DATE
NOTE BOOK	DRAWN BY	
	DESIGNED BY	
	QUANTITIES BY	
	CHECKED BY	

T:\H3RE\PLAN\TC-HQVAF01.dgn

THIS WORK WAS PREPARED BY ME OR UNDER MY SUPERVISION.

R. Urasaki 04/30/24
SIGNATURE EXPIRATION DATE OF THE LICENSE

STATE OF HAWAII
DEPARTMENT OF TRANSPORTATION
HIGHWAYS DIVISION

TRAFFIC CONTROL PLAN
RELOCATED HALAWA ACCESS ROAD
INTERSTATE ROUTE H-3
H-3 FINISH, UNIT VIIC
FAIP NO. I-H3-1(75), UNIT VIIC
Scale: 1"=40'
Date: Feb. 2022