

FED. ROAD DIST. NO.	STATE	FEDERAL AID PROJ. NO.	FISCAL YEAR	SHEET NO.	TOTAL SHEETS
HAWAII	HAW.	I-H3-1(75), UNIT VIIC	2022	22	50

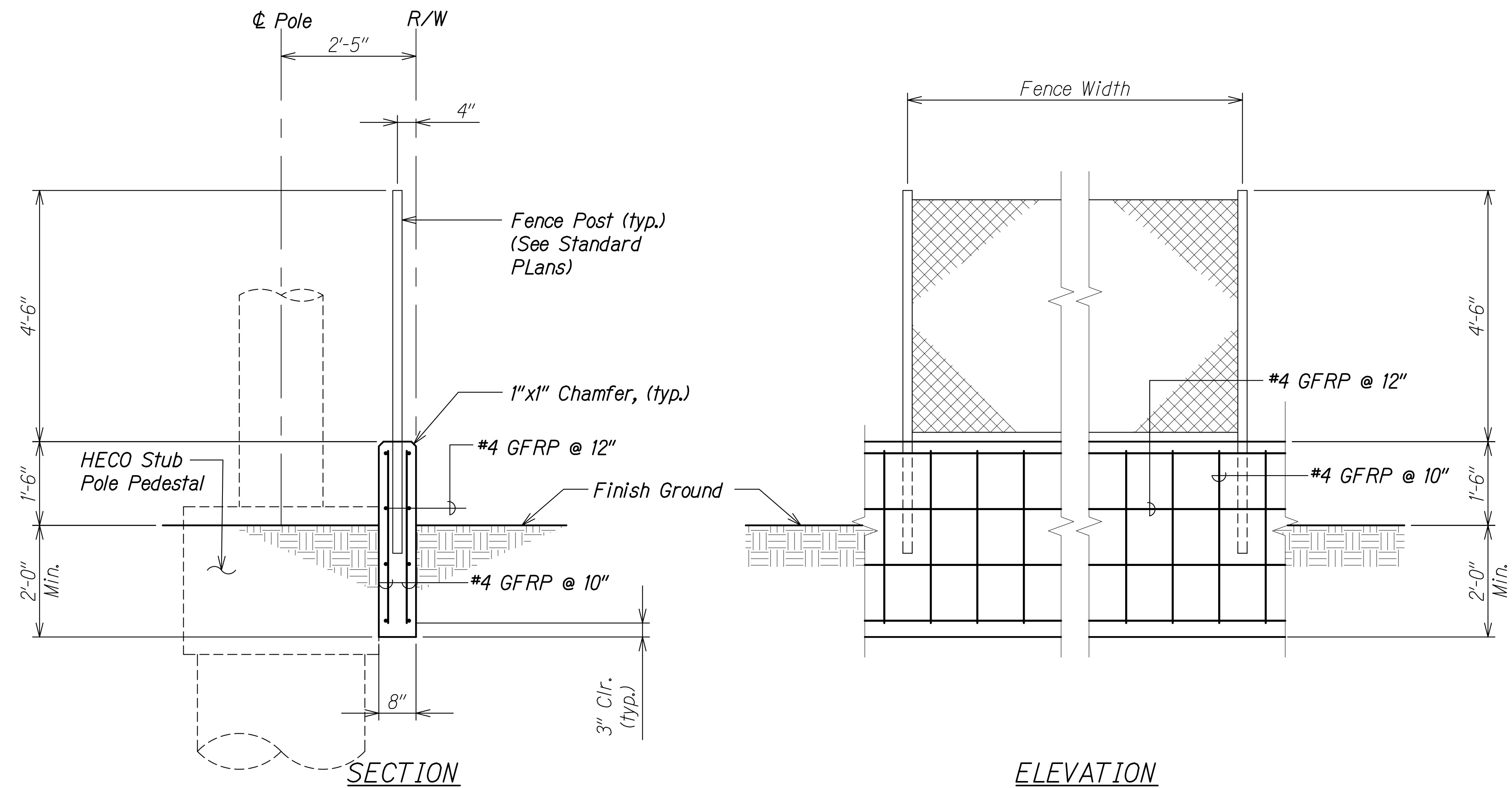

1'-6" CONCRETE CURB WITH  
MOUNTED 4'-6" CHAIN LINK FENCE  
Not to Scale

NOTES: (Concrete Curb)

1. Provide contraction joints every 20'-0" (maximum) o.c.
2. Payment for contraction joints shall be incidental to curb pay items.
3. Concrete shall conform to Section 638 - Portland Cement Curb and Gutter and Structural General Notes 4.A.(3) and 4.I on S-1 (Corrosion inhibitor and macro-synthetic fiber).
4. Reinforcing shall be GFRP per Note 4.H on S-1.
5. Fence post blockouts in concrete curb shall be PVC block outs (Remove prior to fence post installation).
6. Fence post grout shall be  $\frac{3}{8}$ " minimum all around the fence post. The grout shall be built up  $\frac{3}{8}$ " minimum around the post at the top of the concrete curb.
7. Fence post grout shall contain a corrosion inhibitor, See Structural General Notes on S-1.

ORIGINAL PLAN	SURVEY PLOTTED BY	DATE
NOTE BOOK	DRAWN BY	
No.	DESIGNED BY	
	CHECKED BY	

DRAWING NAME: Z:\00 ONGOING\19-008 H3 GUY WIRE POLE - WSP\01 CAD\02-15-22 BID\HW-506 PHASE.DWG PLOT TIME: 04-15-22, 10:44 AM

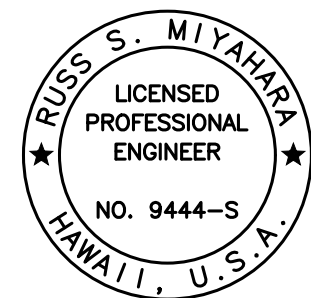

THIS WORK WAS PREPARED BY  
ME OR UNDER MY SUPERVISION.

*Russ S. Miyahara*  
SIGNATURE  
4-30-24  
EXPIRATION DATE OF THE LICENSE

STATE OF HAWAII  
DEPARTMENT OF TRANSPORTATION  
HIGHWAYS DIVISION

**MISCELLANEOUS DETAILS**

**RELOCATED HALAWA ACCESS ROAD**

INTERSTATE ROUTE H-3  
H-3 FINISH, UNIT VIIC  
FAIP NO. I-H3-1(75), UNIT VIIC

Scale: As Noted Date: Feb. 2022

SHEET No. S-6 OF 7 SHEETS