

FED. ROAD DIST. NO.	STATE	FED. AID PROJ. NO.	FISCAL YEAR	SHEET NO.	TOTAL SHEETS
HAWAII	HAW.	I-H3-1(75), UNIT VIIA	2003	22	60

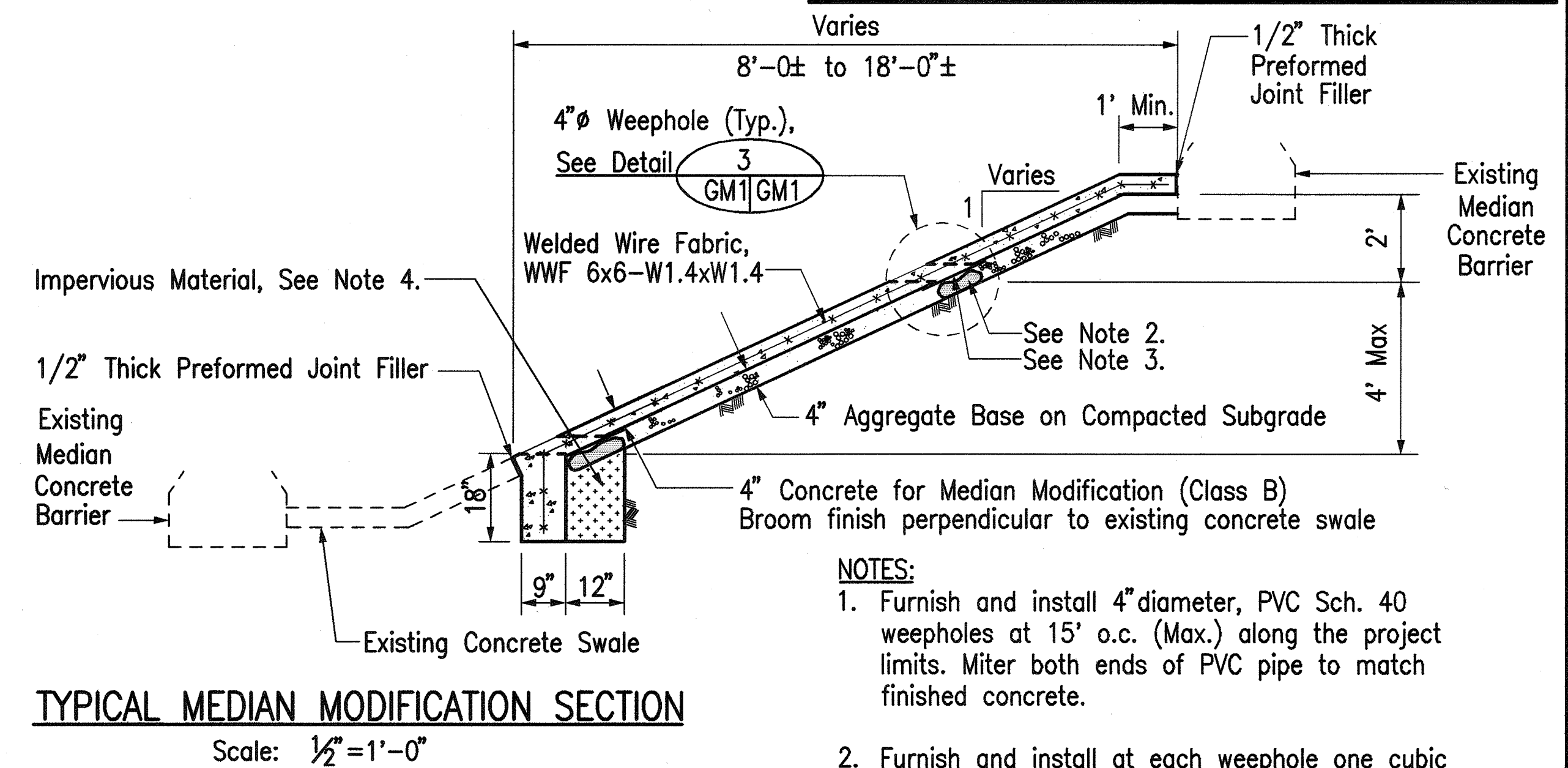

- NOTES:
- Furnish and install 4" diameter, PVC Sch. 40 weepholes at 15' o.c. (Max.) along the project limits. Miter both ends of PVC pipe to match finished concrete.
  - Furnish and install at each weephole one cubic foot filter material in a burlap sack securely tied. See Detail 3.
  - Furnish and install 12"-square galvanized steel 1/4" wire mesh hardware cloth (Min. wire dia. 0.025"). Anchor firmly around the backface of each weephole.
  - Furnish and place impervious material selected by the Engineer. Make impervious as possible by pneumatic tamping or other approved methods.
  - Provide joint per Detail 2.
  - All of the above work will not be measured or paid separately, but shall be considered incidental to the concrete pay item.

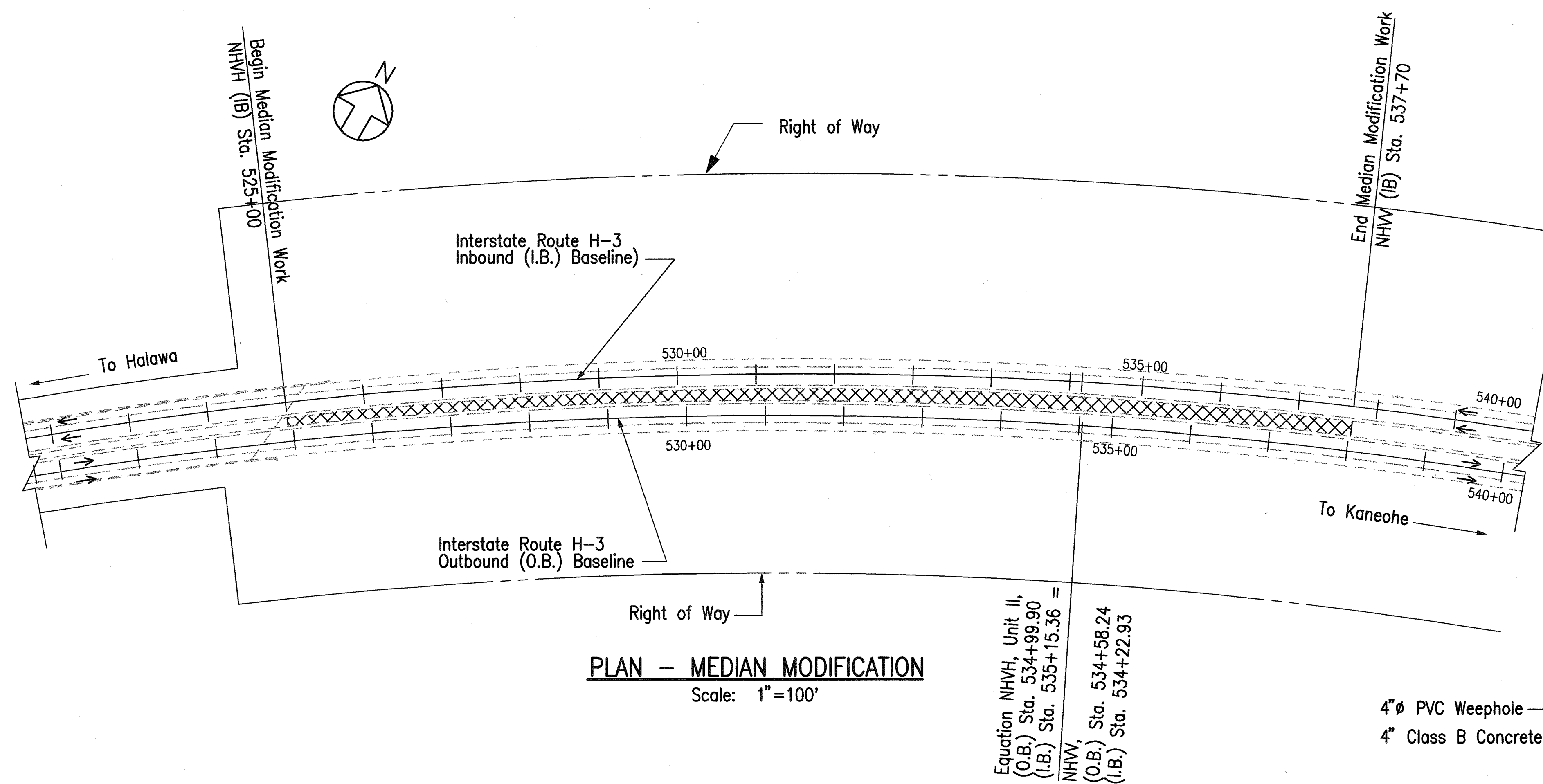
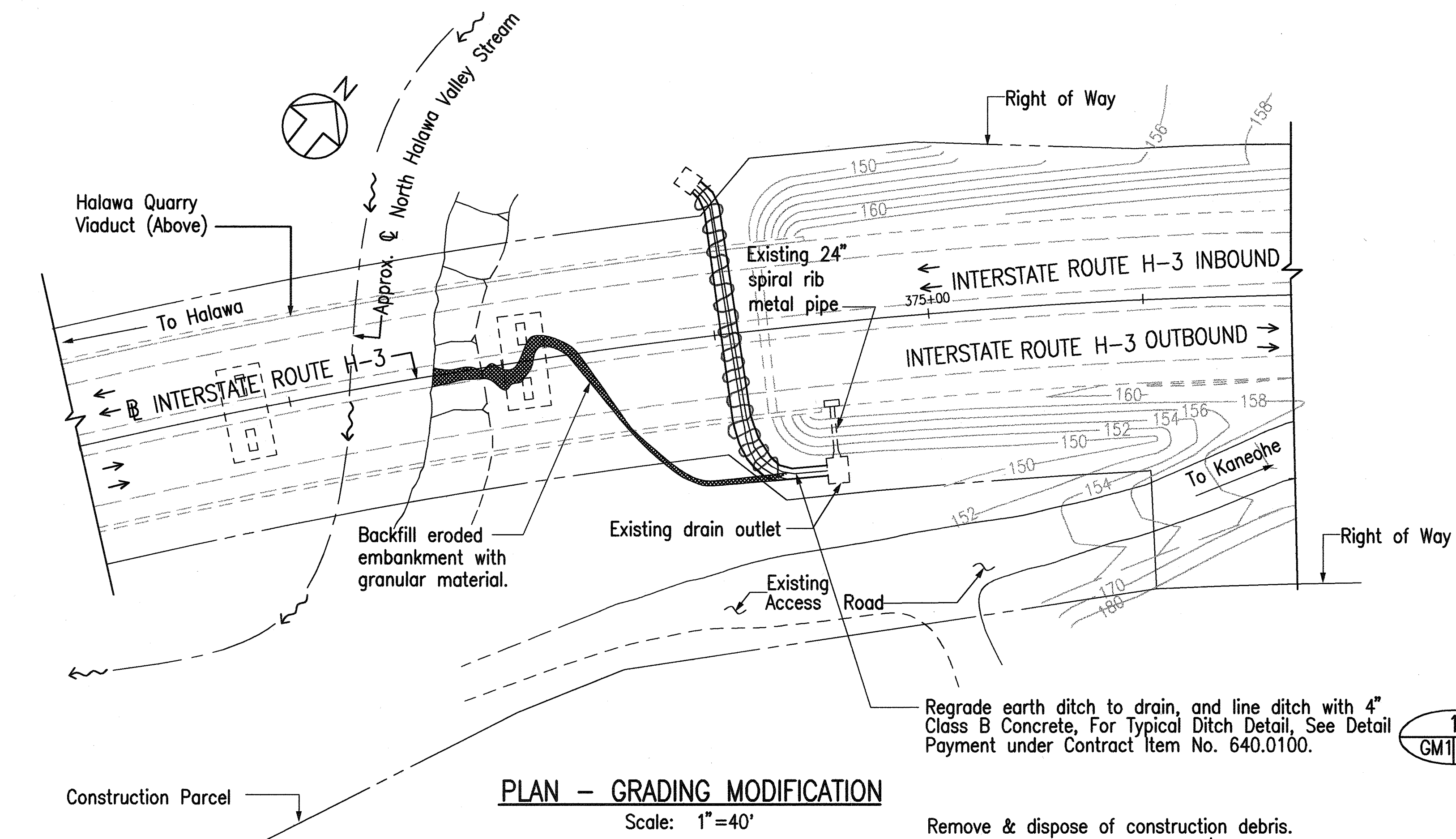
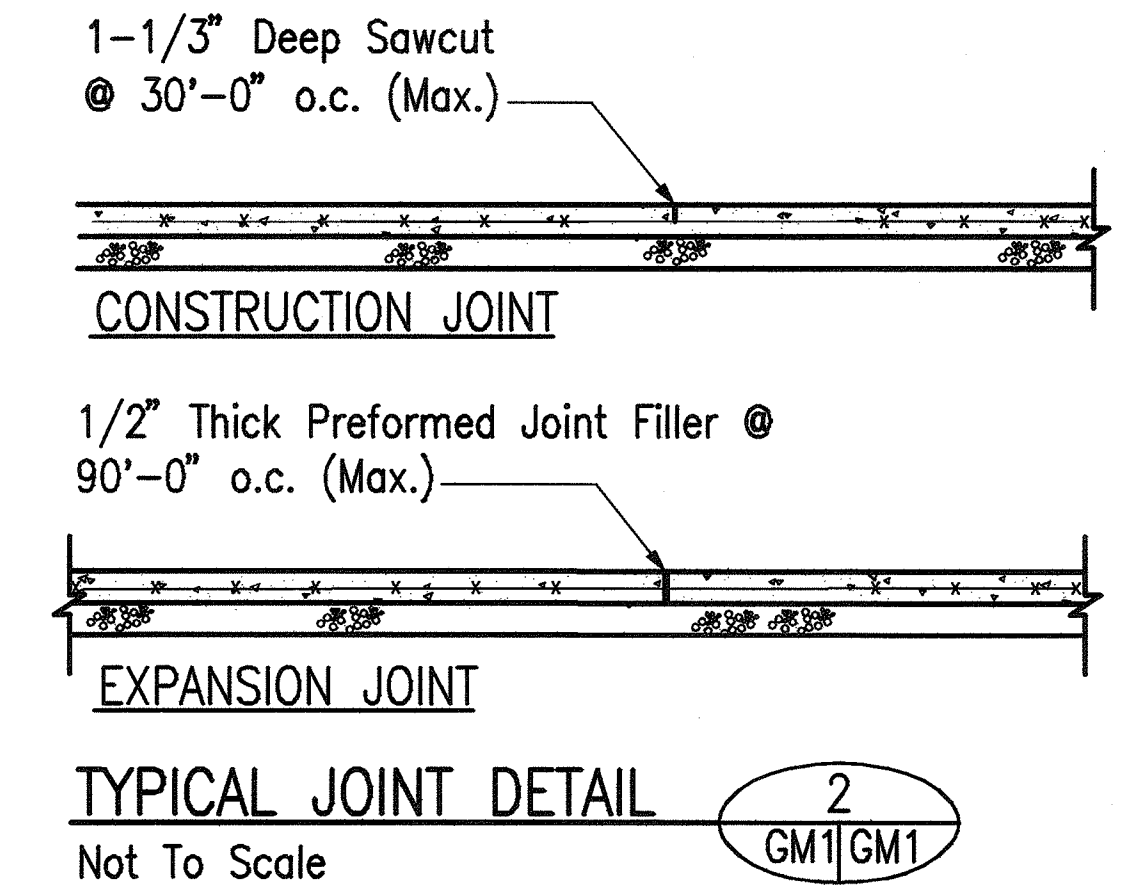
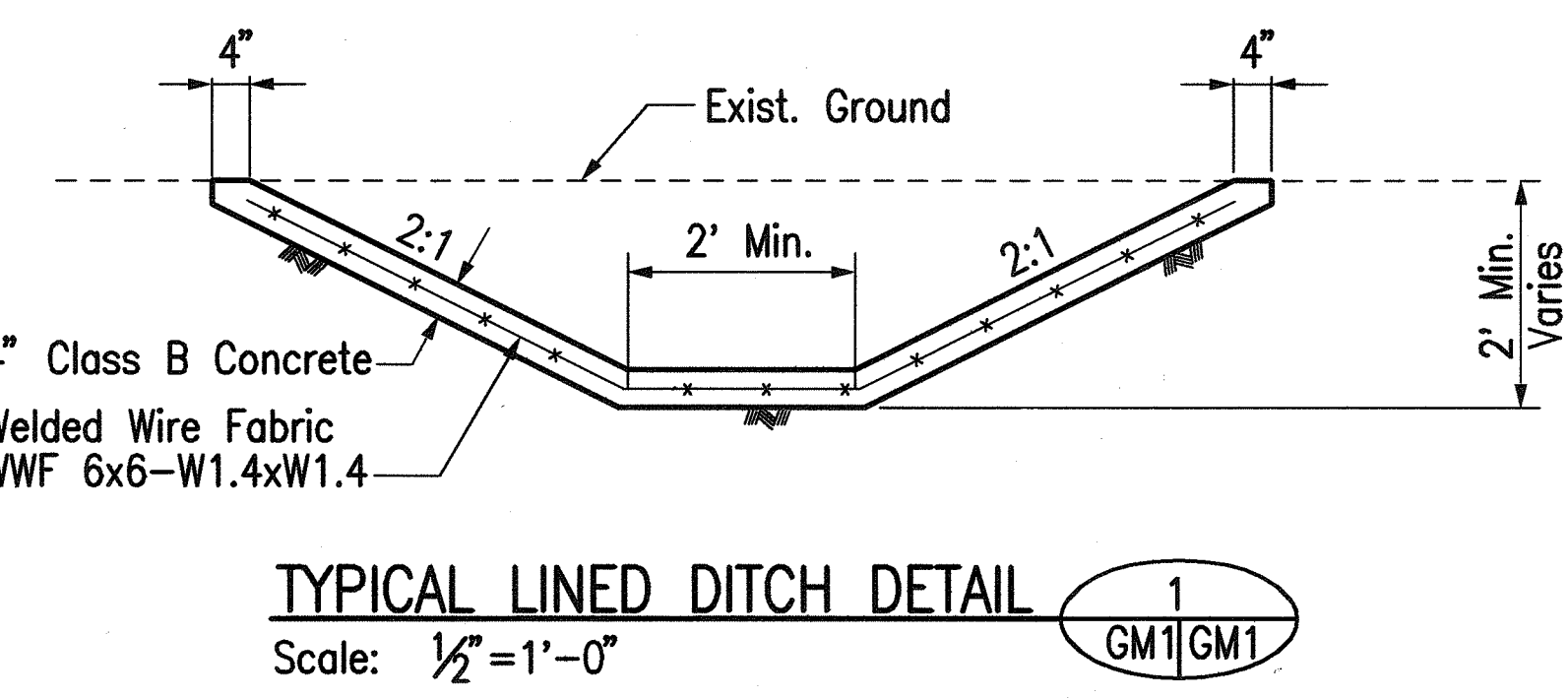
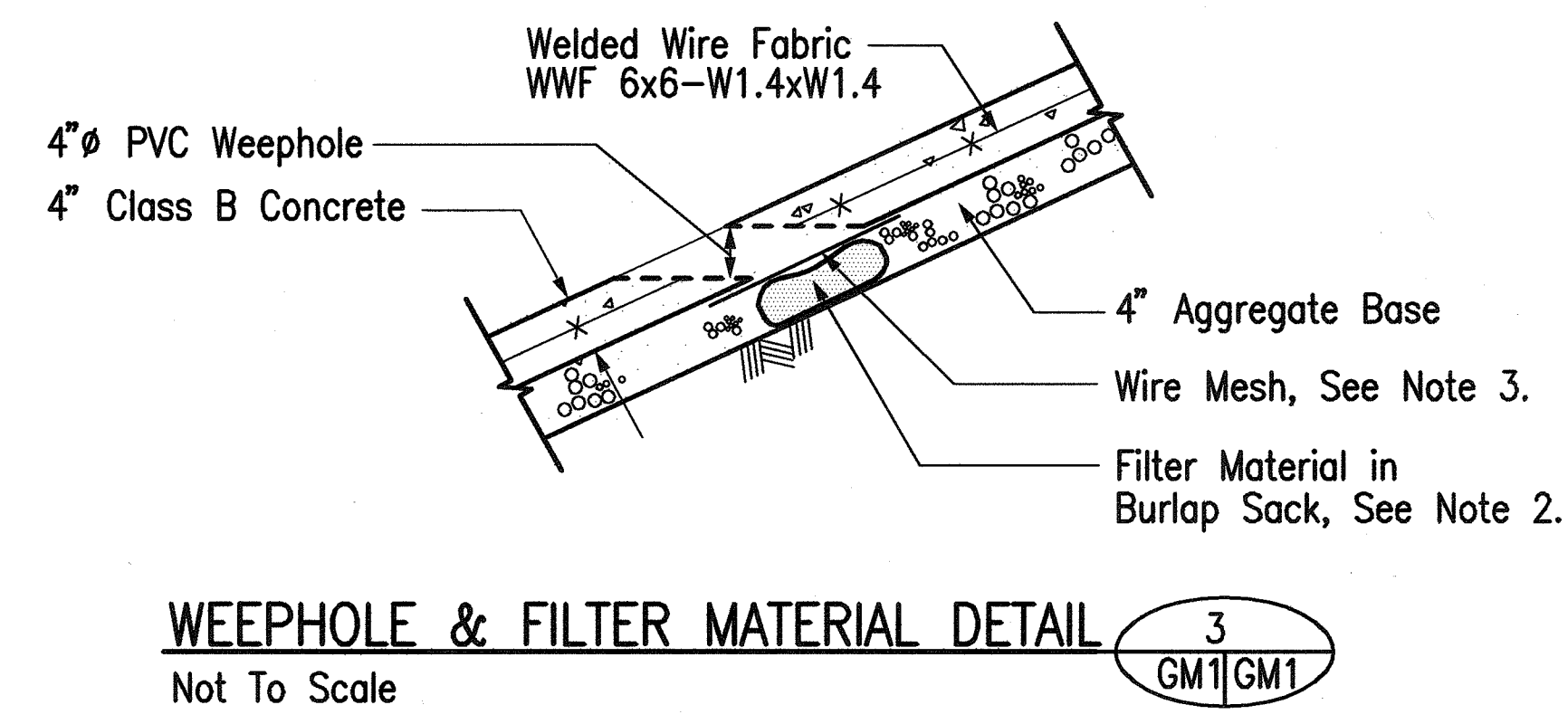

Remove & dispose of construction debris. This work will not be measured/paid separately, but will be considered incidental to Contract Item No. 203.0300.

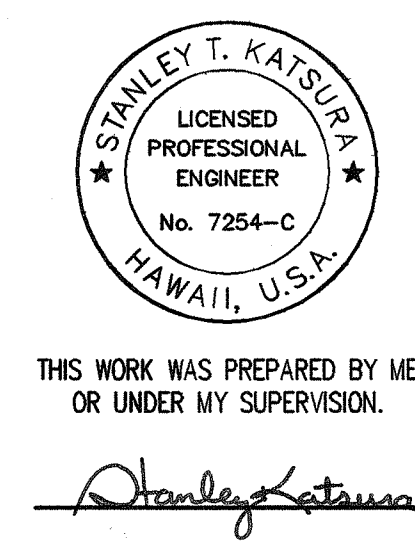

STATE OF HAWAII  
DEPARTMENT OF TRANSPORTATION  
HIGHWAYS DIVISION

**NORTH HALAWA VALLEY**  
**GRADING AND**  
**MEDIAN MODIFICATIONS**

H-3 FINISH (UNIT VIIA)  
FAIP NO. I-H3-1(75), UNIT VIIA

SCALE: AS SHOWN      DATE: APRIL 2001  
SHEET NO. GM1 OF 1 SHEETS

DATE	_____
DESIGNED BY	_____
CHECKED BY	_____
NO.	_____

CAD: L. Fujimori 2000 / Z. Create 2001

FED. ROAD DIST. NO.	STATE	FED. AID PROJ. NO.	FISCAL YEAR	SHEET NO.	TOTAL SHEETS
HAWAII	HAW.	I-H3-1(75)	2003	C022S-1	60

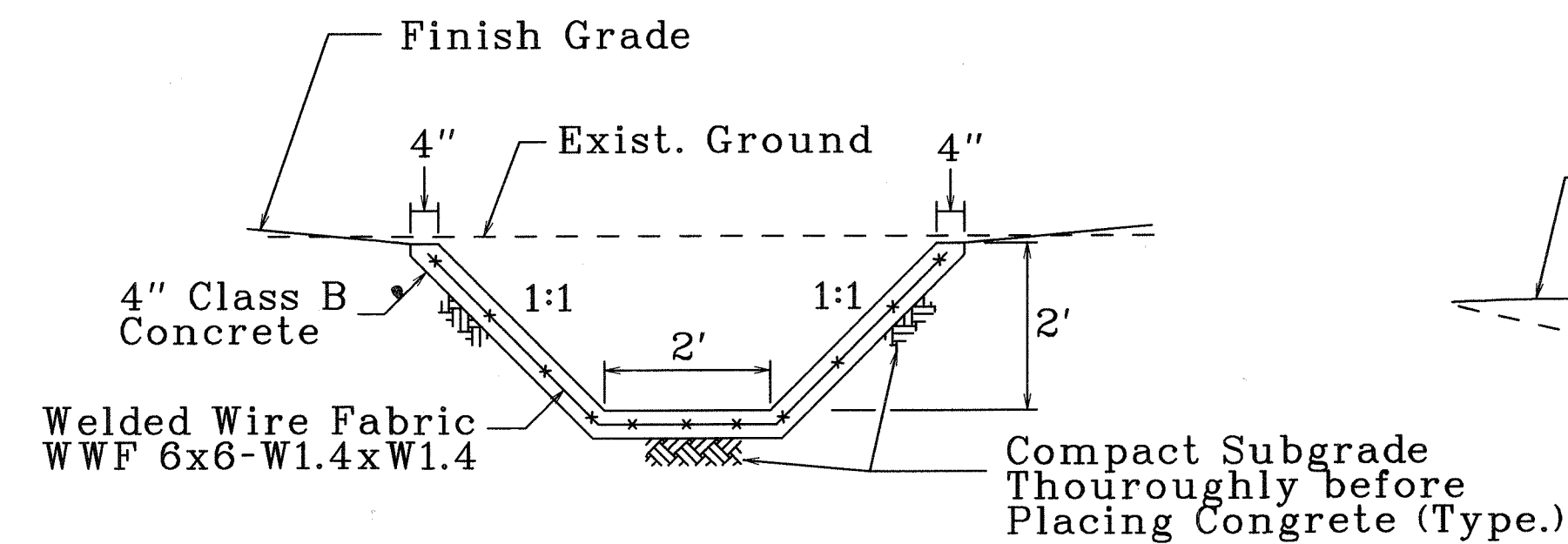

DETAIL 1 - TYPICAL LINED TRAP DITCH  
Scale: 1/2"=1'-0"

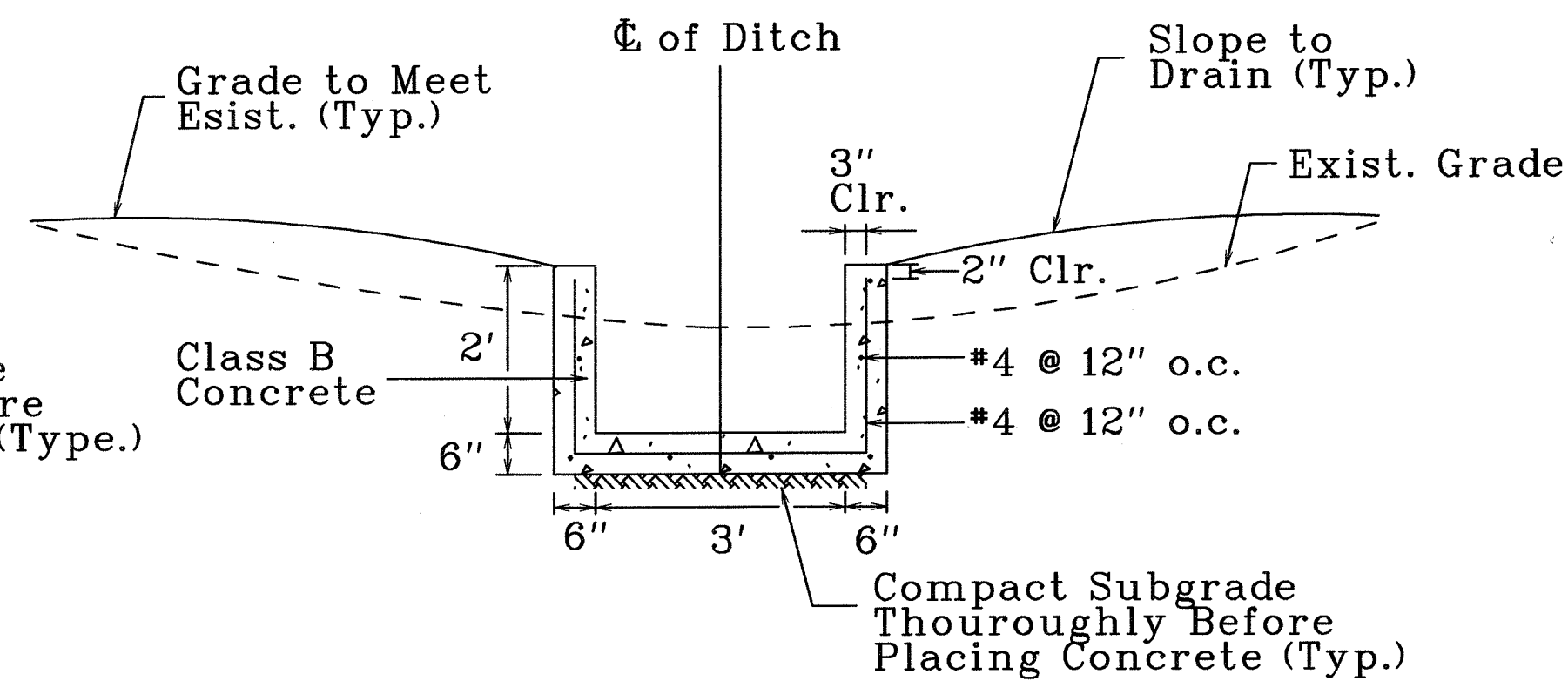

DETAIL 4 - TYPICAL LINED CHANNEL  
Scale: 1/2"=1'-0"

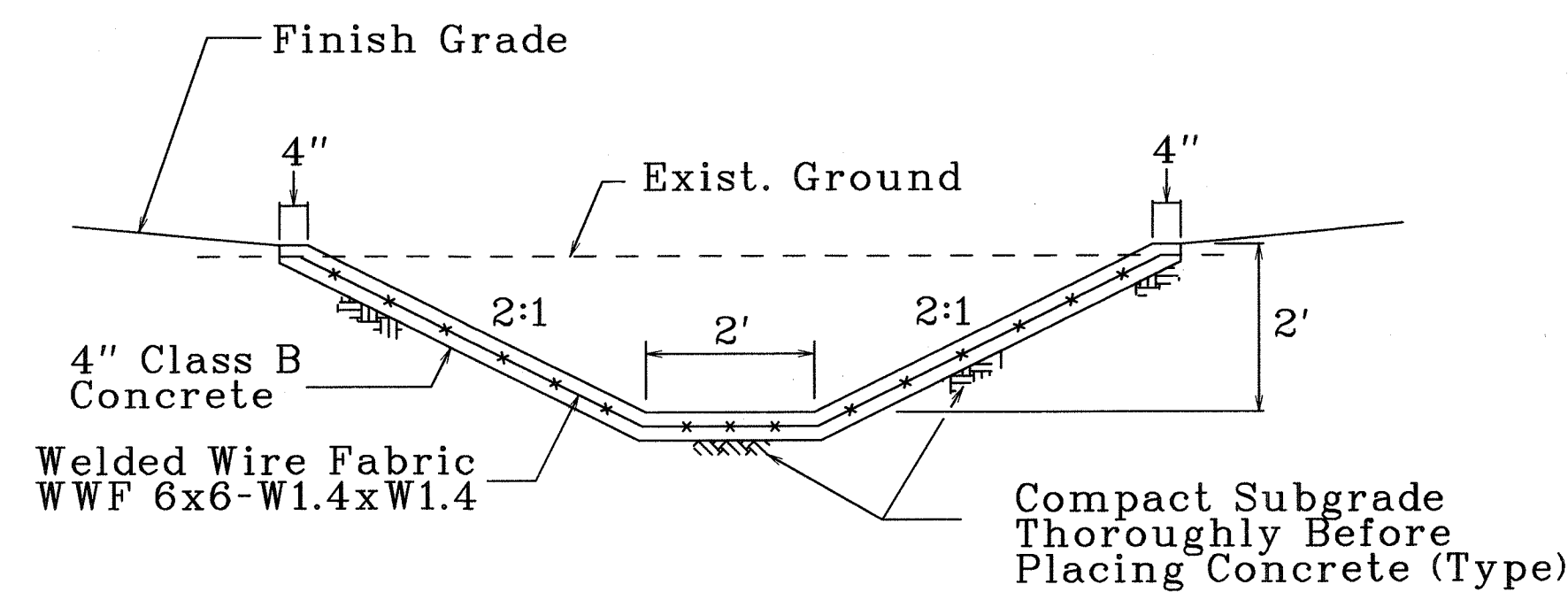
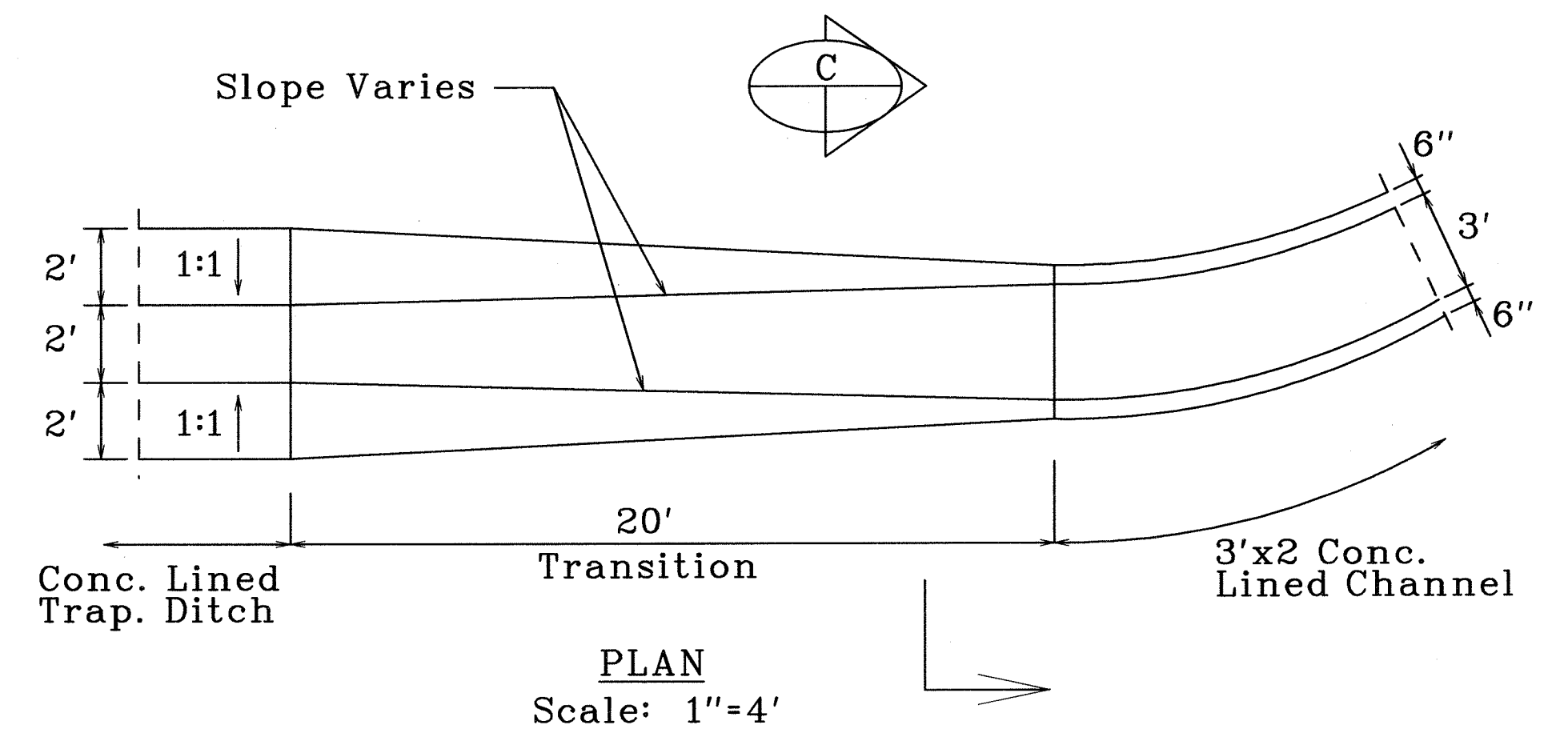

DETAIL 2 - TYPICAL LINED TRAP DITCH  
Scale: 1/2"=1'-0"

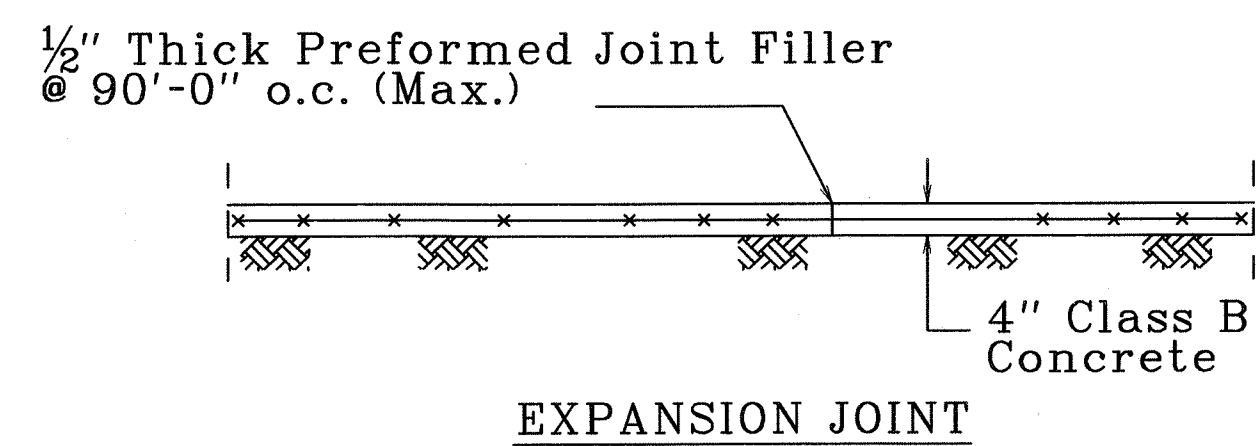
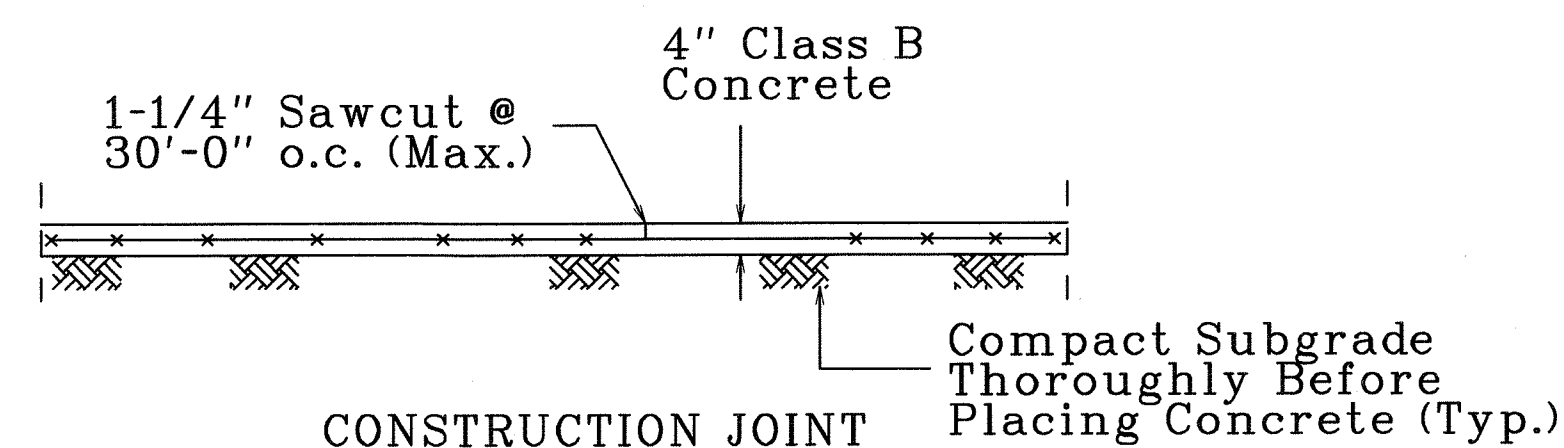
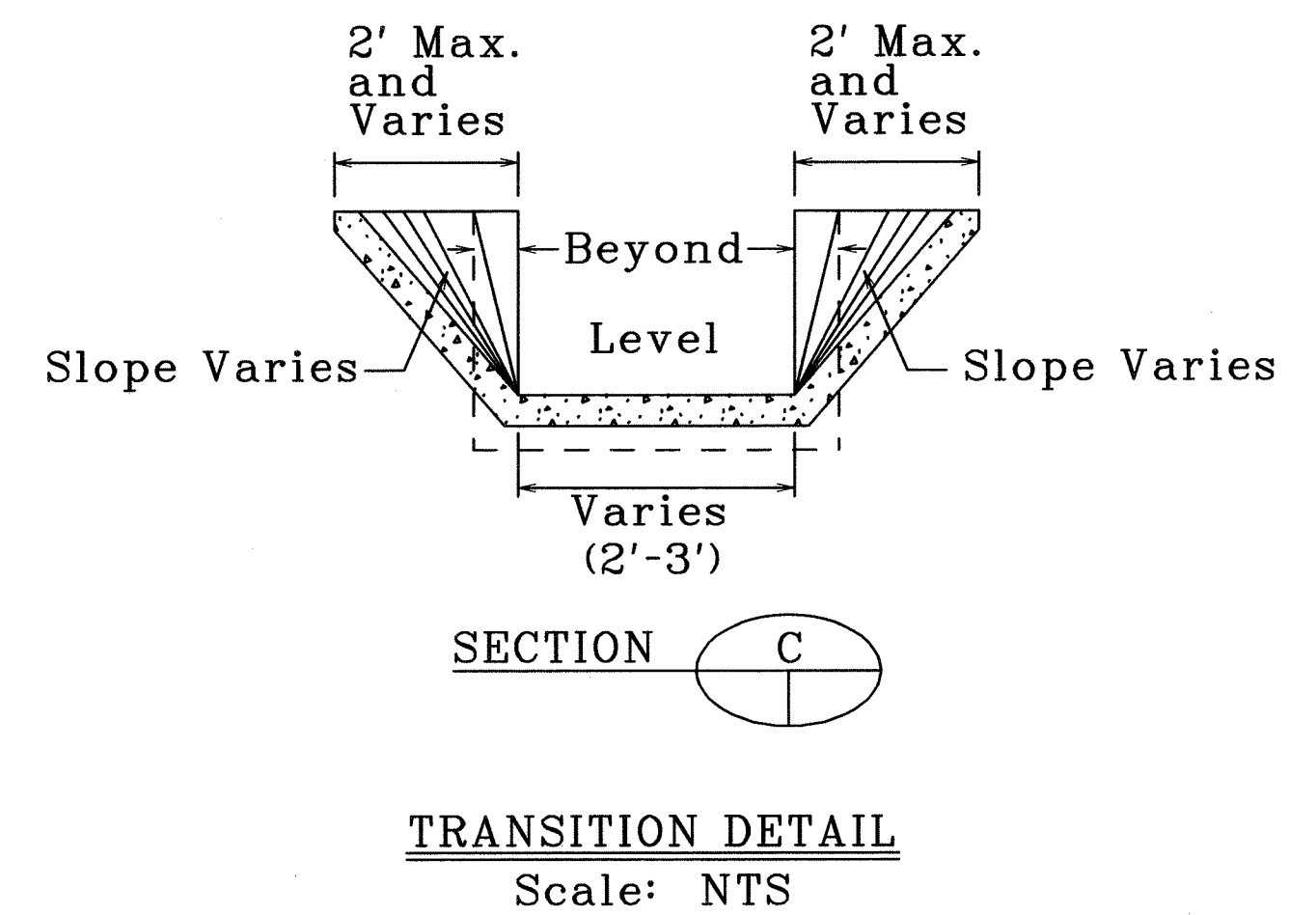

DETAIL 3 - TYPICAL JOINT  
Not To Scale

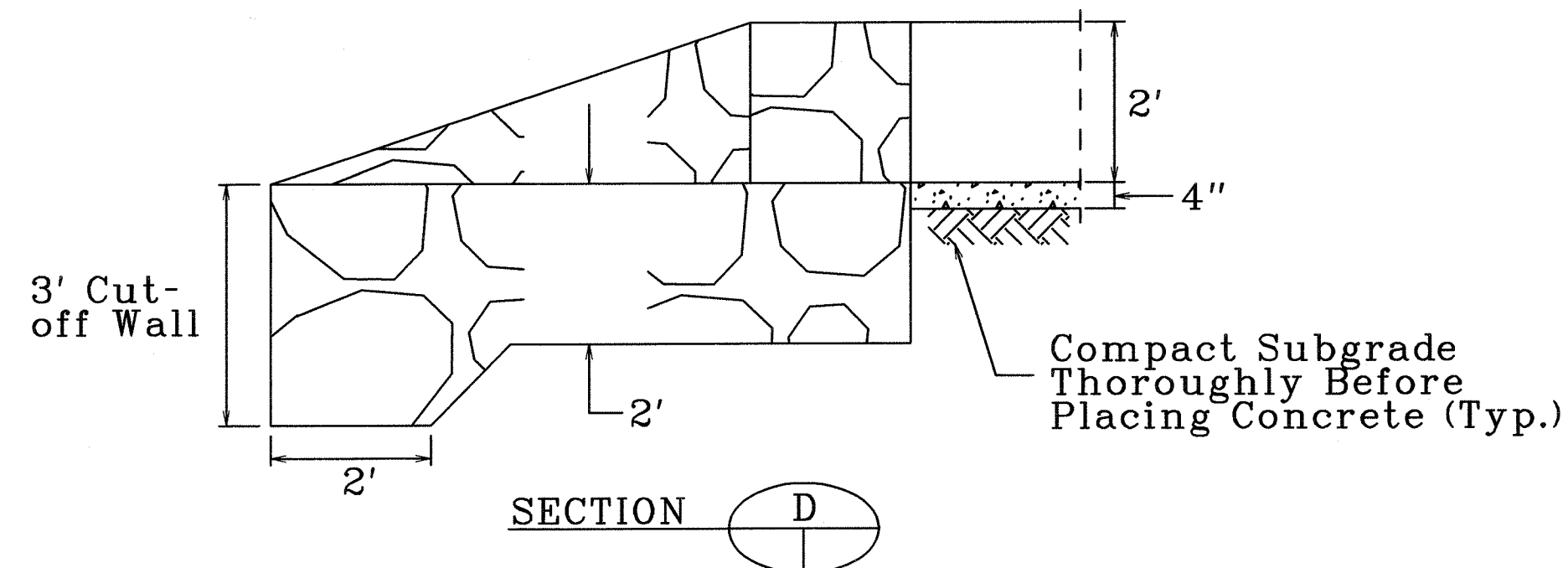
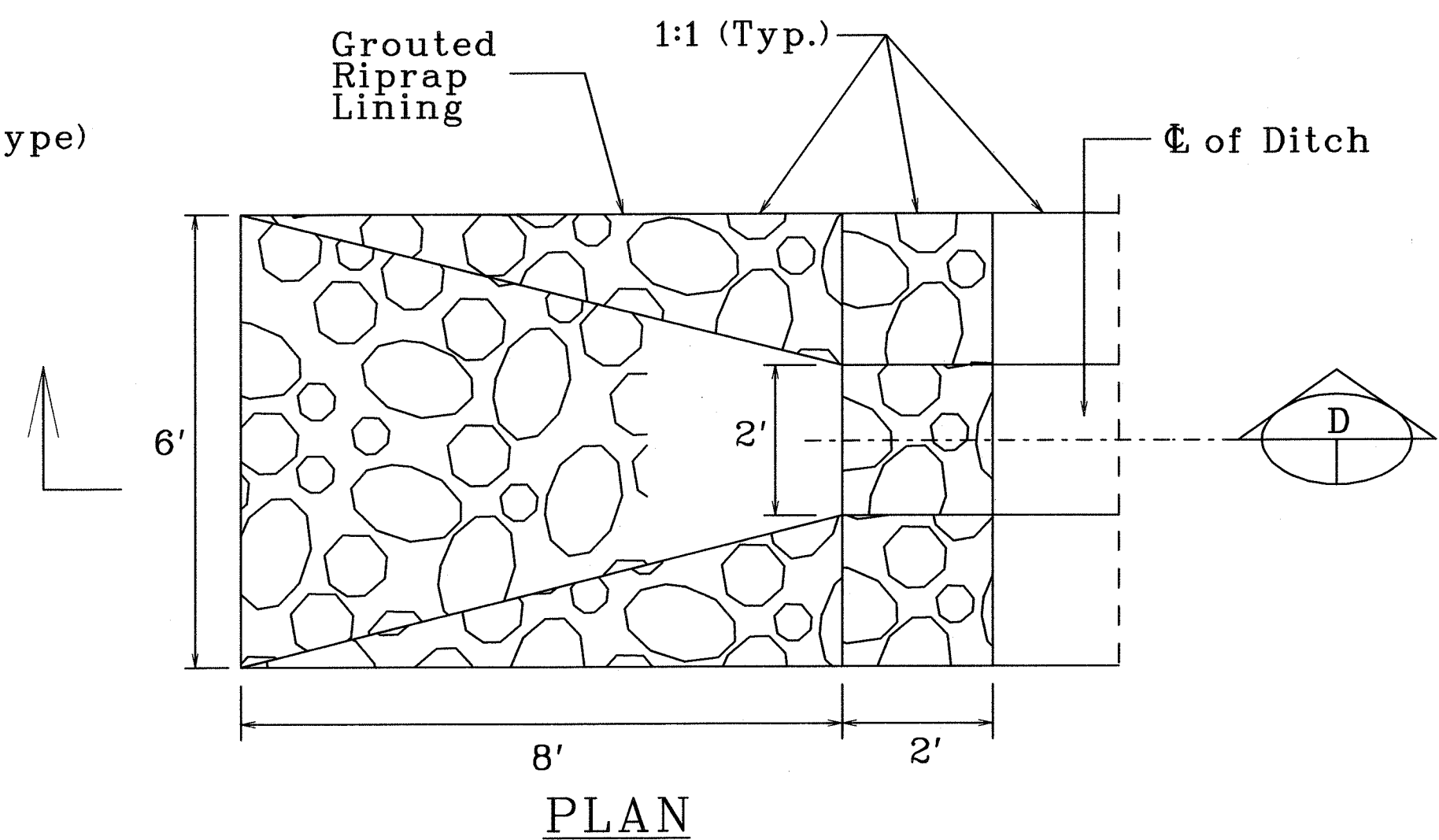

DETAIL 5 - TYPICAL DRAINAGE OUTLET  
Scale: 1/2"=1'

ORIGINAL PLAN	SURVEY PLOTTED BY	DATE
NOTE BOOK	DRAWN BY	
	TRACED BY	
	QUANTITIES BY	
	CHECKED BY	

LEGEND FOR AS-BUILT POSTINGS	
	Squiggly line for as-built deletion
	Double line for as-built deletion
Roadway	Text for as-built posting

STATE OF HAWAII  
DEPARTMENT OF TRANSPORTATION  
HIGHWAYS DIVISION

**NORTH HALAWA VALLEY**

**GRADING AND MEDIAN MODIFICATIONS**

**H-3 Finish (Unit VIIA)**

**FAP: I-H3-1(75), UNIT VIIA**

*Scale: As Shown* *Date: April, 2001*

**SHEET No. 601 OF 1 SHEETS**



FED. ROAD DIST. NO.	STATE	FED. AID PROJ. NO.	FISCAL YEAR	SHEET NO.	TOTAL SHEETS
HAWAII	HAW.	I-H3-1(75)	2003	CO22S-2	60

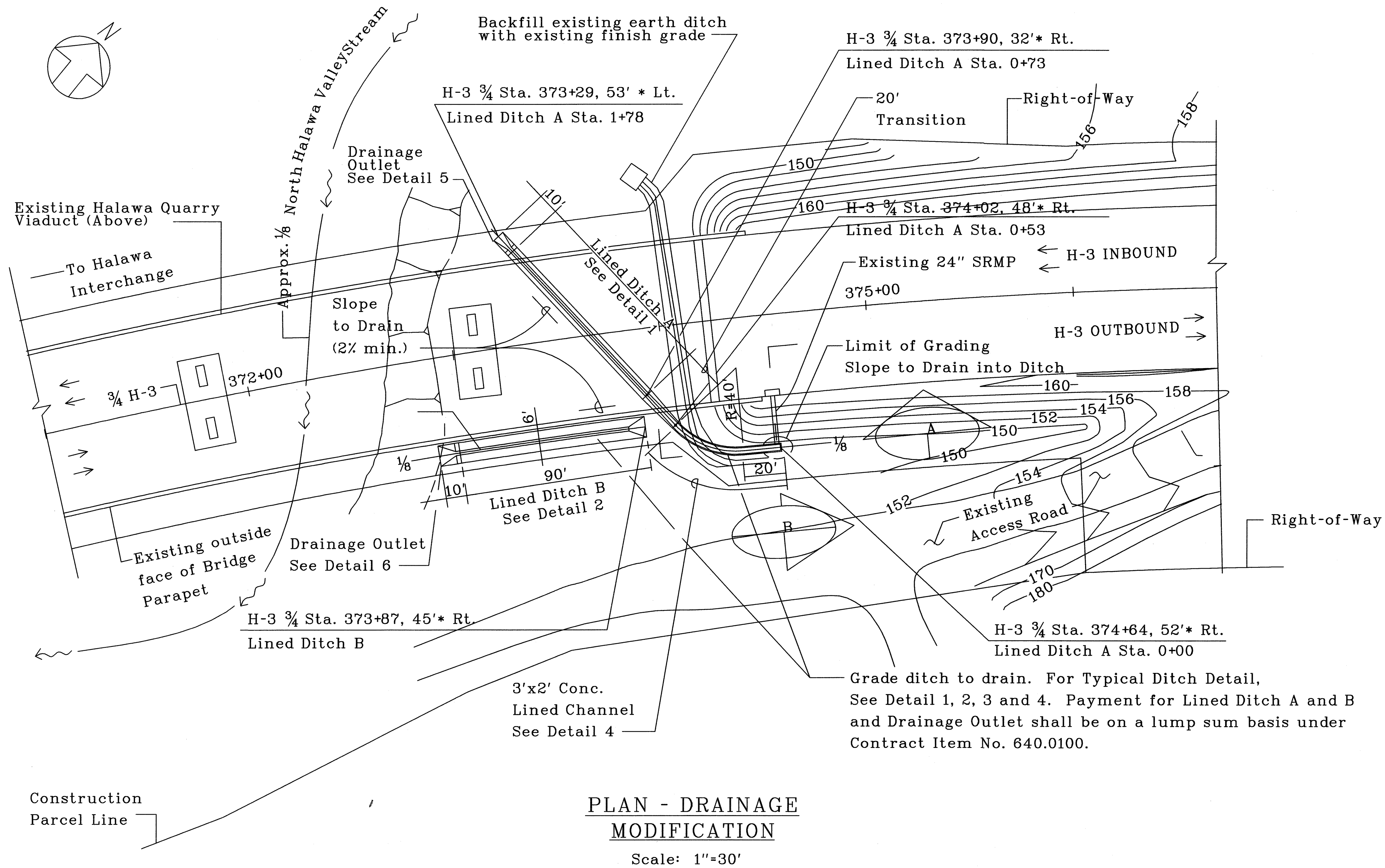

LEGEND FOR AS-BUILT POSTINGS	
	Squiggly line for as-built deletion
	Double line for as-built deletion
Roadway	Text for as-built posting

NOTES:

1. Remove and dispose of off-site construction debris within grading area. This work will not be measured nor paid for separately, but will be considered incidental to Contract Item No. 203.0300.
2. Engineer will verify the stakeout of Lined Ditch A and B alignment prior to start of ditch construction.
3. Clean and remove silt and debris from the existing 24" SRMP and inlet structure.

STATE OF HAWAII  
DEPARTMENT OF TRANSPORTATION  
HIGHWAYS DIVISION

**NORTH HALAWA VALLEY**  
**GRADING AND MEDIAN MODIFICATIONS**  
**H-3 Finish (Unit VIIA)**  
**FAP: I-H3-1(75), UNIT VIIA**  
Scale: 1"=30'

Date: April, 2001  
SHEET No. **GM2** OF 1 SHEETS

SURVEY PLOTTED BY	DATE
DRAWN BY	
CHECKED BY	
NOTE BOOK	
QUANTITIES BY	
CHECKED BY	
ORIGINAL PLAN	
NOTE BOOK	
QUANTITIES BY	
CHECKED BY	

"AS-BUILT"

C.O. 22 S-2