

FED. ROAD DIST. NO.	HAWAII	FED. AID PROJ. NO.	FISCAL YEAR	SHEET NO.	TOTAL SHEETS
HAWAII	HAW.	I-H3-1-(75)	1996	15	42

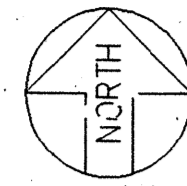

CONSTRUCTION PARCEL BOUNDARY

INSTALL SILT FENCE @ TOE OF EXISTING SLOPE PRIOR TO COMMENCING HILLSIDE GRADING

LIMITS OF WORK

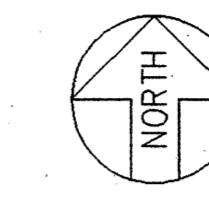

INSTALL SILT FENCE WHEN SOIL ABOVE THE LEVEL OF EXISTING CHANNEL WALL IS DISTURBED SEE DETAIL

MATCH LINE

STA 10+00

LIMITS OF WORK

PLAN-STA 10+00 TO END
SCALE: 1" = 40'

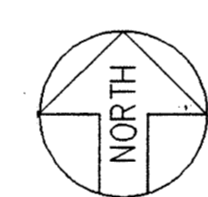

LIMITS OF WORK

PLAN-NAVY ROAD/BRIDGE
SCALE: 1" = 40'

MATCH LINE

STA 10+00

PLAN-STA 0+00 TO STA 10+00
SCALE: 1" = 40'

GENERAL NOTES

- A. EROSION & SEDIMENT CONTROL INSPECTION & MAINTENANCE PRACTICES.
1. THE CONTRACTOR SHALL INSPECT THE EROSION & SEDIMENT CONTROL MEASURES AT LEAST ONCE A WEEK OR AFTER 0.5 INCHES OF RAINFALL.
 2. THE CONTRACTOR SHALL MAINTAIN THE EROSION & SEDIMENT CONTROL MEASURES ACCORDING TO THE CONTRACT. IF A REPAIR IS NECESSARY, THE CONTRACTOR SHALL INITIATE THE REPAIRS WITHIN TWENTY-FOUR (24) HOURS AFTER THE INSPECTION SUCH AS:
 - (a) WHEN SEDIMENT BUILD-UP REACHES ONE-THIRD (1/3) THE HEIGHT OF THE SILT FENCE, THE CONTRACTOR SHALL REMOVE & DISPOSE OF THE SEDIMENT BUILD-UP FROM THE SILT FENCE.
 - (b) WHEN TEARS ARE FOUND ON THE SILT FENCE, THE CONTRACTOR SHALL REPLACE THE FABRIC.
 - (c) THE CONTRACTOR SHALL CHECK TO SEE IF THE FABRIC IS SECURELY ATTACHED TO THE FENCE POSTS & TO SEE THAT THE FENCE POSTS ARE FIRMLY IN THE GROUND.
 - (d) THE CONTRACTOR SHALL INSPECT TEMPORARY & PERMANENT SEEDING & PLANTING FOR BARE SPOTS, WASHOUTS & HEALTHY GROWTH.
 3. THE CONTRACTOR SHALL HAVE ITS PERSONNEL MAKE A MAINTENANCE INSPECTION REPORT PROMPTLY AFTER EACH INSPECTION. THE CONTRACTOR SHALL SELECT A MINIMUM OF THREE (3) PERSONNEL WHO WILL BE RESPONSIBLE FOR INSPECTION, MAINTENANCE REPAIR ACTIVITIES, & FILLING OUT THE INSPECTION & MAINTENANCE REPORT. PERSONNEL SELECTED FOR THE INSPECTION & MAINTENANCE RESPONSIBILITIES WILL RECEIVE TRAINING FROM THE CONTRACTOR. THE CONTRACTOR SHALL TRAIN THESE PERSONNEL IN THE INSPECTION & MAINTENANCE PRACTICES NECESSARY FOR KEEPING THE EROSION & SEDIMENT USED ON-SITE ACCORDING TO THE CONTRACT.

INSTALL SILT FENCE WHEN ADJACENT GRADE IS HIGHER THAN THE EXISTING CHANNEL WALL SEE DETAIL

SOUTH HALAWA DRAINAGE CHANNEL (CITY)

HALAWA CORRECTIONAL FACILITY

HALAWA VALLEY ST. (CITY)

A.C. PAVT (HATCHED)

OWNED BY STATE OF HAWAII

OWNED BY QUEEN EMMA FOUNDATION

OWNED BY QUEEN EMMA FOUNDATION

SEE FENCE PLAN C14 FOR ADDITIONAL WORK

OWNED BY STATE OF HAWAII

SSFM ENGINEERS, INC.
CONSULTING ENGINEERS
804 SUMNER STREET, SUITE 502
HONOLULU, HAWAII 96817

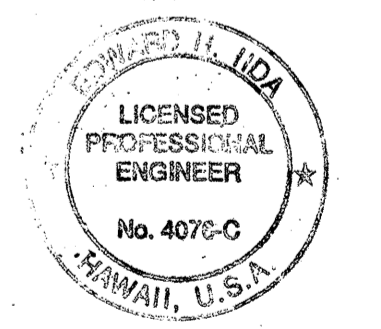

THIS WORK WAS PREPARED BY ME OR UNDER MY SUPERVISION

STATE OF HAWAII
DEPARTMENT OF TRANSPORTATION
HIGHWAYS DIVISION

HALAWA JAIL ACCESS ROAD

EROSION CONTROL PLAN

INTERSTATE ROUTE H3

F.A.I. PROJECT NO. I-H3-1 (75)

SCALE: 1"=40'

DATE: APR. 1996

SHEET No. 11 OF 42 SHEETS

DATE	PLOTTED BY
DESIGNED BY	DESIGNED BY
QUANTITIES BY	QUANTITIES BY
CHECKED BY	CHECKED BY
NO.	NO.

FED. ROAD DIST. NO.	STATE	FED. AID PROJ. NO.	FISCAL YEAR	SHEET NO.	TOTAL SHEETS
HAWAII	HAW.	I-H3-1-(73)	1996	16	42

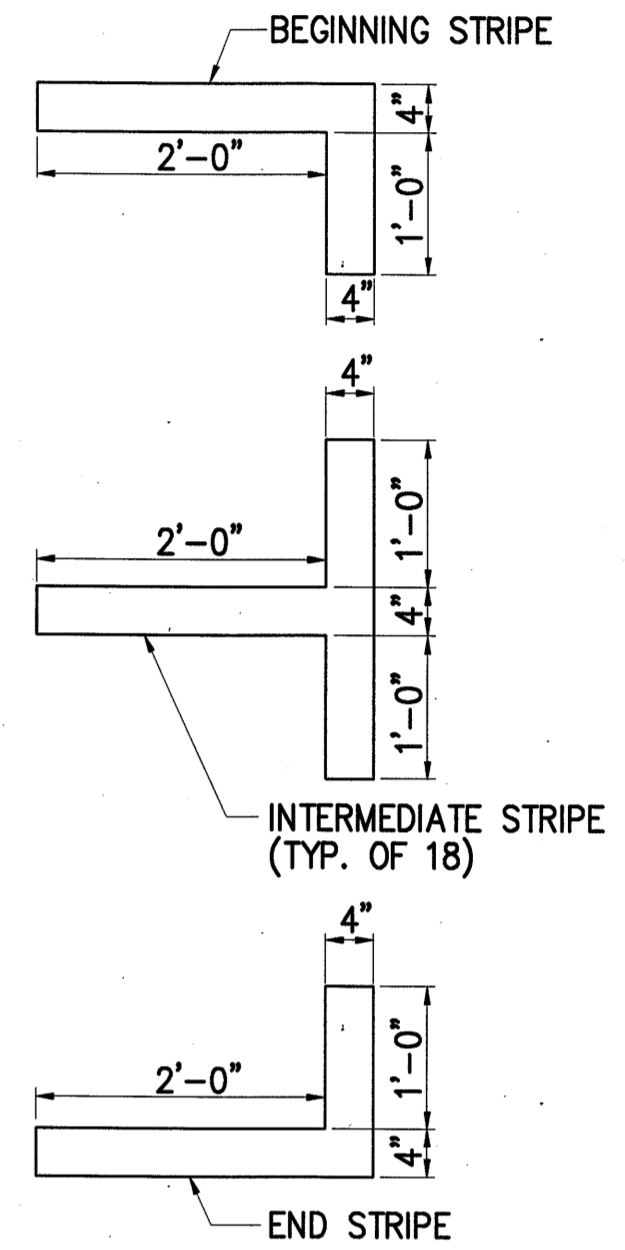
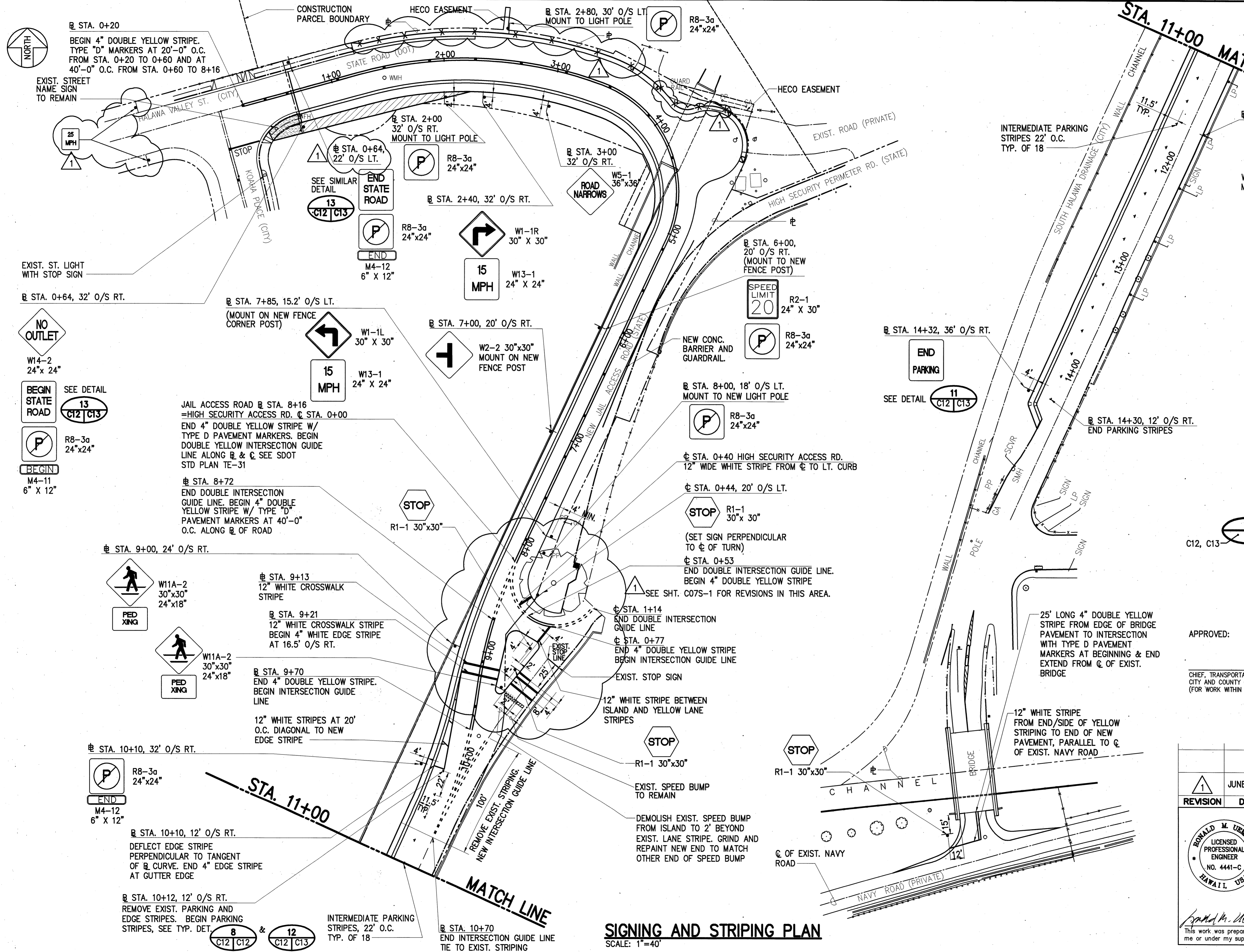

NOTE: ALL PARKING STRIPES SHALL BE WHITE

TYPICAL PARKING STRIPES

SCALE: 3/4"=1'-0"

NOTE:
1. SEE SDOT STD PLAN TE-01, 02, AND 03 FOR SIGN INSTALLATION DETAILS.

APPROVED:

CHIEF, TRANSPORTATION MANAGEMENT DIVISION, D.T.S.
CITY AND COUNTY OF HONOLULU
(FOR WORK WITHIN CITY RIGHT-OF-WAY ONLY)

DATE

REVISION	DATE	REVISION	BY
1	JUNE 1997	DELETE LEFT SIDEWALK. ADA MODIFICATIONS	
STATE OF HAWAII DEPARTMENT OF TRANSPORTATION HIGHWAYS DIVISION HALAWA JAIL ACCESS ROAD SIGNING AND STRIPING PLAN INTERSTATE ROUTE H-3 F.A.I. PROJ. I-H3-1 (73)			
		DATE: APR. 1996 SCALE: 1"=40' SHEET No. C12 OF 42 SHEETS	

SIGNING AND STRIPING PLAN

SCALE: 1"=40'

DATE	
DESIGNED BY	
DRAWN BY	
CHECKED BY	
IN CHARGE	

FED. ROAD DIST. NO.	STATE	FED. AID PROJ. NO.	FISCAL YEAR	SHEET NO.	TOTAL SHEETS
HAWAII	HAW.	I-H3-1-(73)	1996	17	42

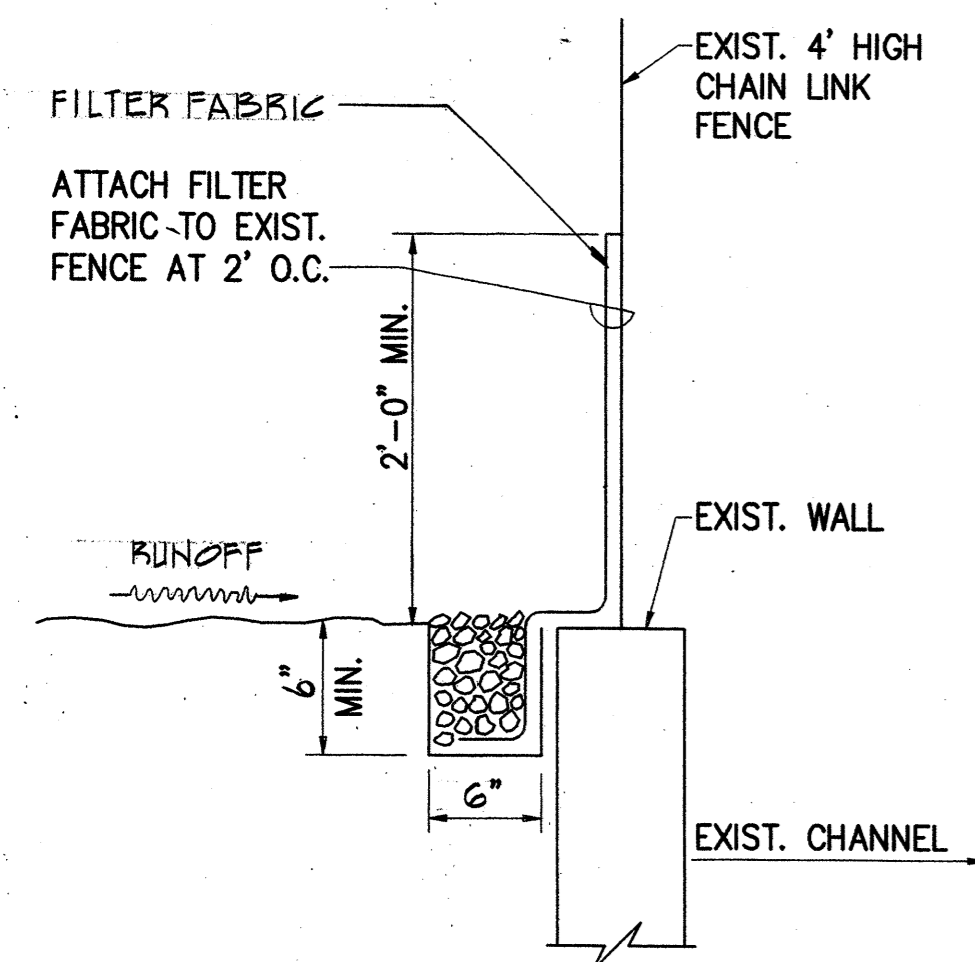

NOTE: SILT FENCE MAY BE ATTACHED TO THE EXISTING CHAIN LINK FENCE AT THE CONTRACTOR'S OPTION.

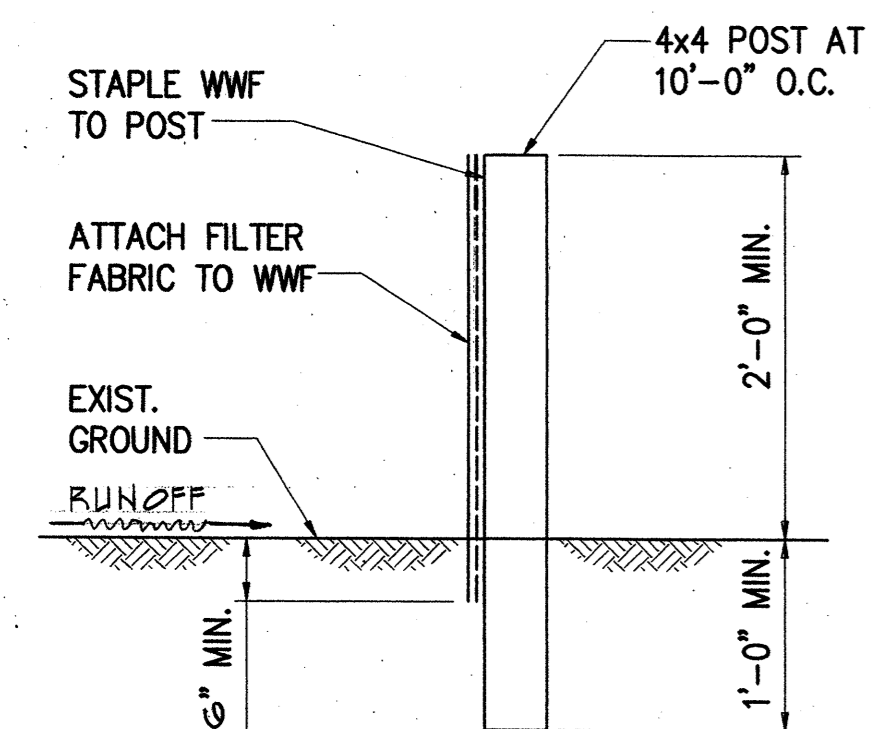

SILT FENCE DETAIL

NOT TO SCALE

9
C11 C13

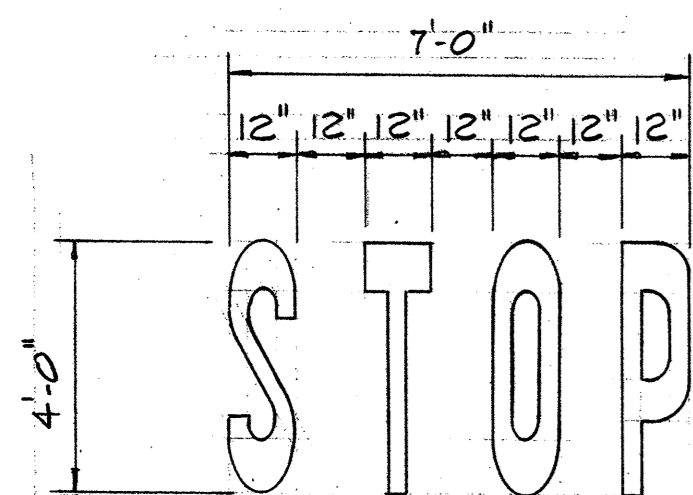

C&C DTS "STOP" WORD PAVEMENT MARKING DETAIL

NOT TO SCALE

10
C12 C13

SILT FENCE NOTES

INSTALLATION:

1. THE FILTER FABRIC SHALL BE PURCHASED IN A CONTINUOUS ROLL OUT TO THE LENGTH OF THE BARRIER TO AVOID THE USE OF JOINTS. WHEN JOINTS ARE NECESSARY, FILTER FABRIC SHALL BE SPICED TOGETHER ONLY AT A SUPPORT POST, WITH A MINIMUM 6-INCH OVERLAP, AND SECURELY SEALED.
2. POSTS SHALL BE SPACED A MAXIMUM OF 10 FEET APART AND DRIVEN SECURELY INTO THE GROUND (12 INCH MINIMUM EMBEDMENT).
3. THE WIRE FABRIC SHALL BE FASTENED SECURELY TO THE UPSLOPE SIDE OF THE POSTS USING HEAVY DUTY WIRE STAPLES AT LEAST 1 INCH LONG OR TIE WIRES. THE WIRE FABRIC SHALL EXTEND A MINIMUM OF 4 INCHES INTO THE TRENCH.
4. STANDARD STRENGTH FILTER FABRIC SHALL BE STAPLED OR WIRED TO THE FENCE, AND 8 INCHES OF THE FABRIC SHALL BE EXTENDED INTO THE TRENCH. THE FABRIC SHALL NOT EXTEND MORE THAN 36 INCHES ABOVE THE ORIGINAL GROUND SURFACE. FILTER FABRIC SHALL NOT BE STAPLED TO EXISTING TREES.
5. AT THE CONTRACTOR'S OPTION, THE FILTER FABRIC MAY BE ATTACHED TO THE EXISTING CHAIN LINK FENCE. THE TRENCH SHALL BE CONSTRUCTED IMMEDIATELY ADJACENT TO THE EXISTING CONCRETE AND 8 INCHES OF THE FABRIC EXTENDED INTO THE TRENCH.
6. THE TRENCH SHALL BE BACKFILLED WITH SPOILS, NATIVE SOIL, OR CRUSHED AGGREGATE AND THE SOIL COMPACTED OVER THE FILTER FABRIC.
7. SILT FENCES SHALL BE REMOVED WHEN THEY HAVE SERVED THEIR USEFUL PURPOSE, BUT NOT BEFORE THE UPSLOPE AREA HAS BEEN STABILIZED.

MAINTENANCE:

1. SILT FENCES SHALL BE INSPECTED IMMEDIATELY AFTER EACH RAINFALL AND AT LEAST DAILY DURING PROLONGED RAINFALL. ANY REQUIRED REPAIRS SHALL BE MADE IMMEDIATELY.
2. SHOULD THE FABRIC ON A SILT FENCE DECOMPOSE OR BECOME INEFFECTIVE WHILE THE FENCE IS STILL REQUIRED, THE FABRIC SHALL BE REPLACED PROMPTLY.
3. SEDIMENT DEPOSITS SHOULD BE REMOVED AFTER EACH STORM EVENT, AND AT LEAST DAILY DURING PROLONGED RAINFALL. THEY MUST BE REMOVED WHEN DEPOSITS REACH 12 INCHES ABOVE THE GROUND SURFACE.

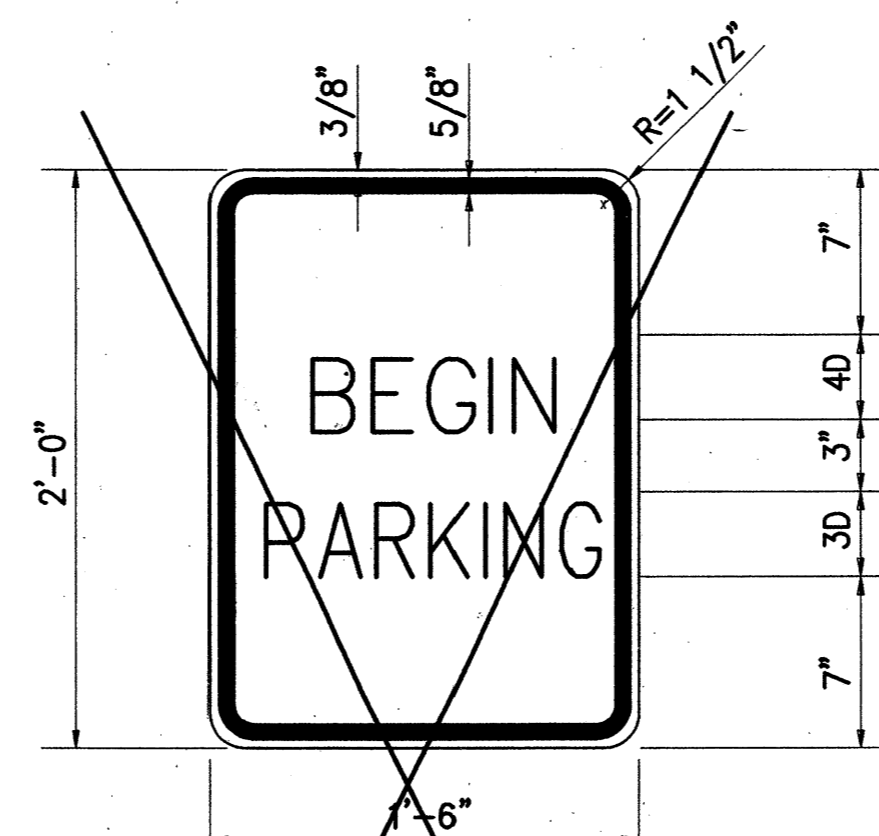

COLORS:
LEGEND - BLACK (NON-REFL)
BACKGROUND - WHITE (REFL)

NOTE:
SIGN LETTERING SHALL BE IN CONFORMANCE WITH THE STANDARD ALPHABETS FOR HIGHWAY SIGN BOOKLET.

BEGIN PARKING SIGN

SCALE: 1 1/2" = 1'-0"

10
C12 C13

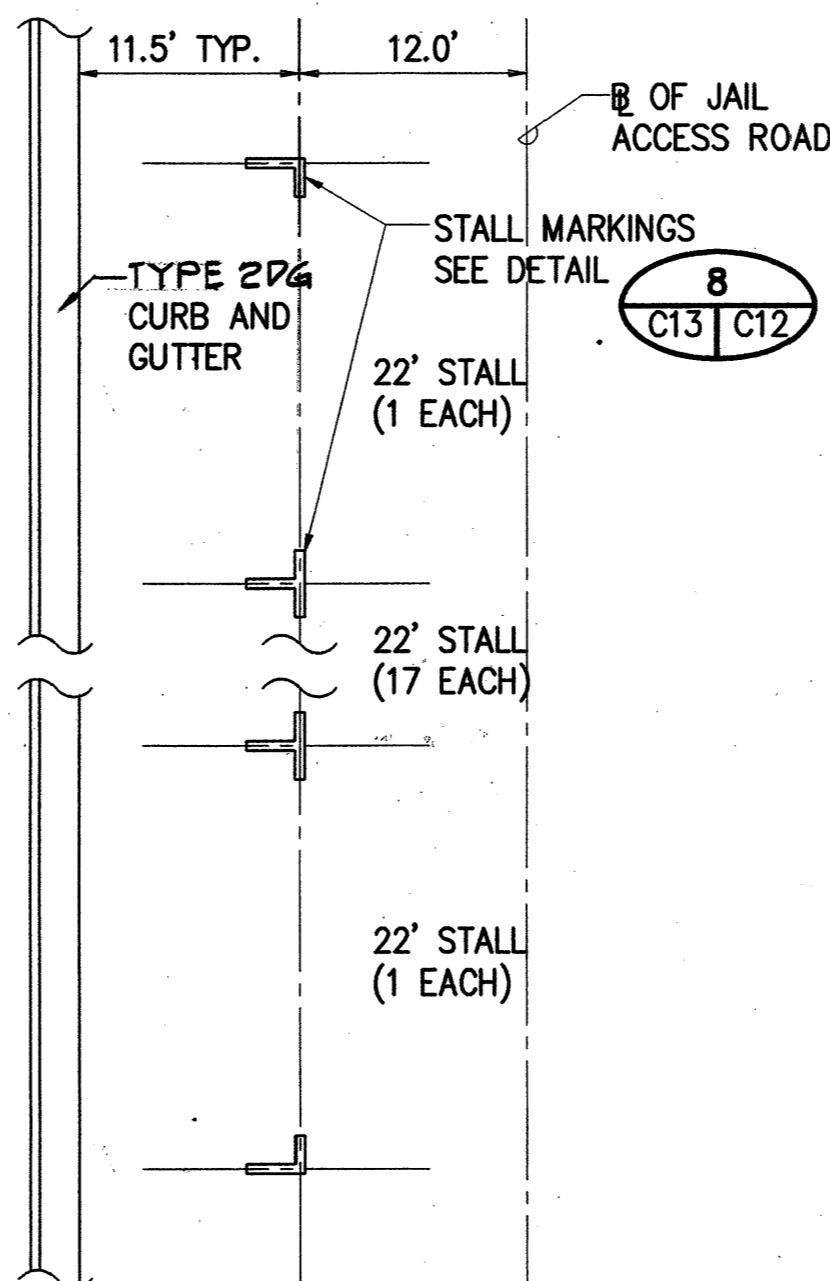

PARKING STALL LAYOUT

SCALE: 1" = 10'

12
C12 C13

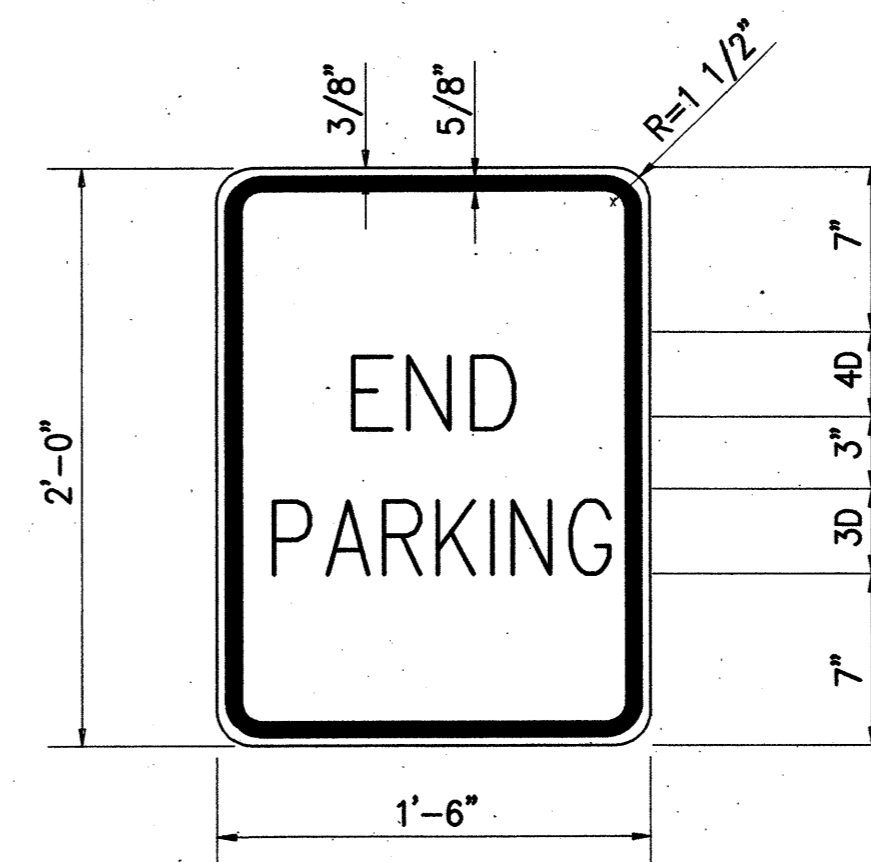

COLORS:
LEGEND - BLACK (NON-REFL)
BACKGROUND - WHITE (REFL)

NOTE:
SIGN LETTERING SHALL BE IN CONFORMANCE WITH THE STANDARD ALPHABETS FOR HIGHWAY SIGN BOOKLET.

END PARKING SIGN

SCALE: 1 1/2" = 1'-0"

11
C12 C13

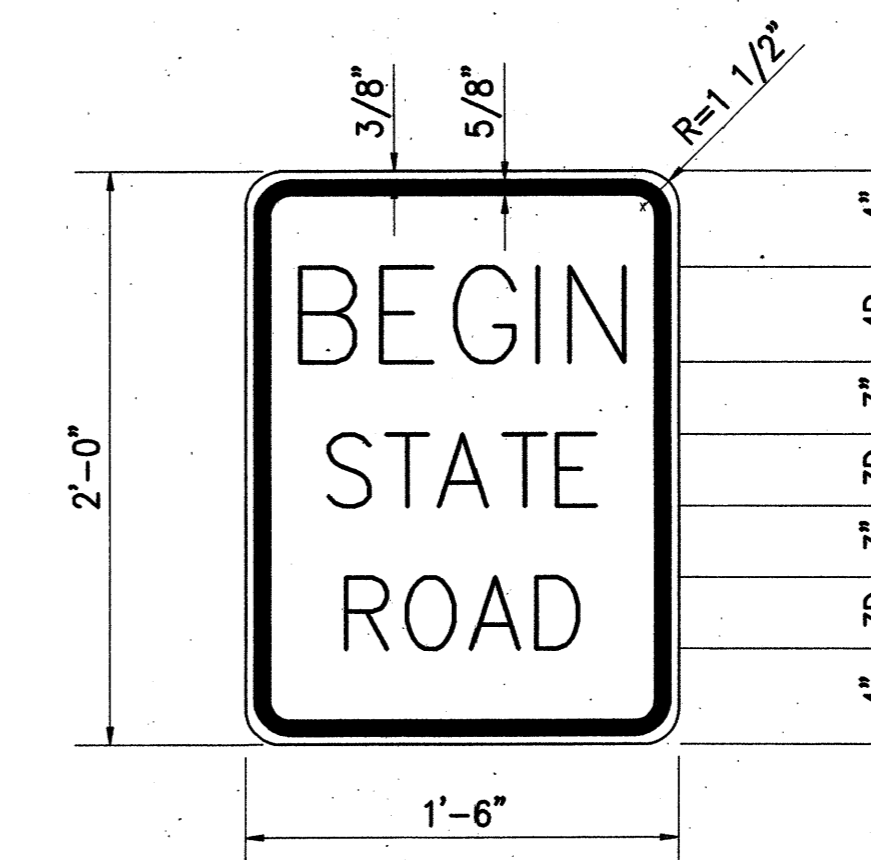

COLORS:
LEGEND - BLACK (NON-REFL)
BACKGROUND - WHITE (REFL)

NOTE:
SIGN LETTERING SHALL BE IN CONFORMANCE WITH THE STANDARD ALPHABETS FOR HIGHWAY SIGN BOOKLET.

BEGIN STATE ROAD SIGN

SCALE: 1 1/2" = 1'-0"

13
C12 C13

APPROVED:

CHIEF, TRANSPORTATION MANAGEMENT SERVICES, D.T.S. DATE
CITY & COUNTY OF HONOLULU
(FOR WORK WITHIN CITY RIGHT-OF-WAY ONLY)

SSPM ENGINEERS, INC.
CONSULTING ENGINEERS
501 SUMNER STREET, SUITE 502
HONOLULU, HAWAII 96817

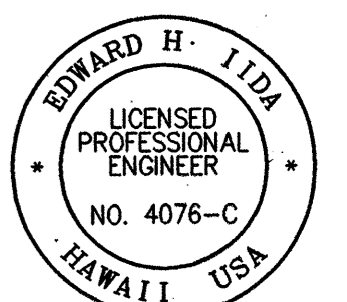

This work was prepared by me or under my supervision.

STATE OF HAWAII
DEPARTMENT OF TRANSPORTATION
HIGHWAYS DIVISION
HALAWA JAIL ACCESS ROAD
E.C./SIGN & STRIPING DETAILS
INTERSTATE ROUTE H-3
F.A.I. PROJ. I-H3-1 (73)

SCALE: AS NOTED DATE: APR. 1996

SHEET No. C13 OF 42 SHEETS

DATE	_____
DESIGNED BY	_____
CHECKED BY	_____
NO.	_____