

FED. ROAD DIST. NO.	STATE	FED. AID PROJ. NO.	FISCAL YEAR	SHEET NO.	TOTAL SHEETS
HAWAII	HAW.	1-H3-1(69)	1992	93	925

STRIPING CURVE DATA

(W)	(X)	(Y)	(Z)
$\Delta = 15^{\circ}59'38''$	$\Delta = 15^{\circ}16'22''$	$\Delta = 31^{\circ}53'14''$	$\Delta = 31^{\circ}09'58''$
$\Delta/2 = 07^{\circ}59'49''$	$\Delta/2 = 07^{\circ}38'11''$	$\Delta/2 = 15^{\circ}56'37''$	$\Delta/2 = 15^{\circ}34'59''$
$R = 3808.50'$	$R = 3791.50'$	$R = 3994.00'$	$R = 4006.00'$
$T = 535.05'$	$T = 508.35'$	$T = 1141.01'$	$T = 1117.22'$
$C = 1059.68'$	$C = 1007.68'$	$C = 2191.24'$	$C = 2152.31'$
$L_c = 1063.13'$	$L_c = 1010.67'$	$L_c = 2222.81'$	$L_c = 2179.07'$

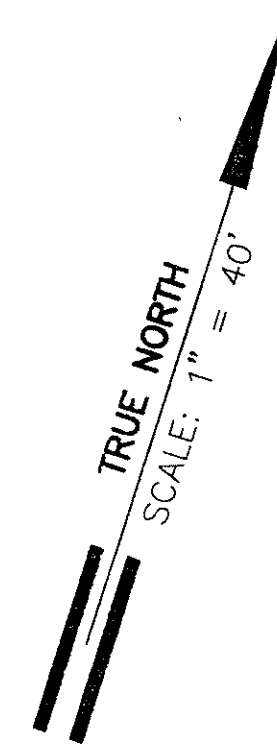

STA. 479+57.77
END F.A.I. PROJECT NO. 1-H3-1(68) =
STA. 480+00
BEGIN F.A.I. PROJECT NO. 1-H3-1(69) & (70)

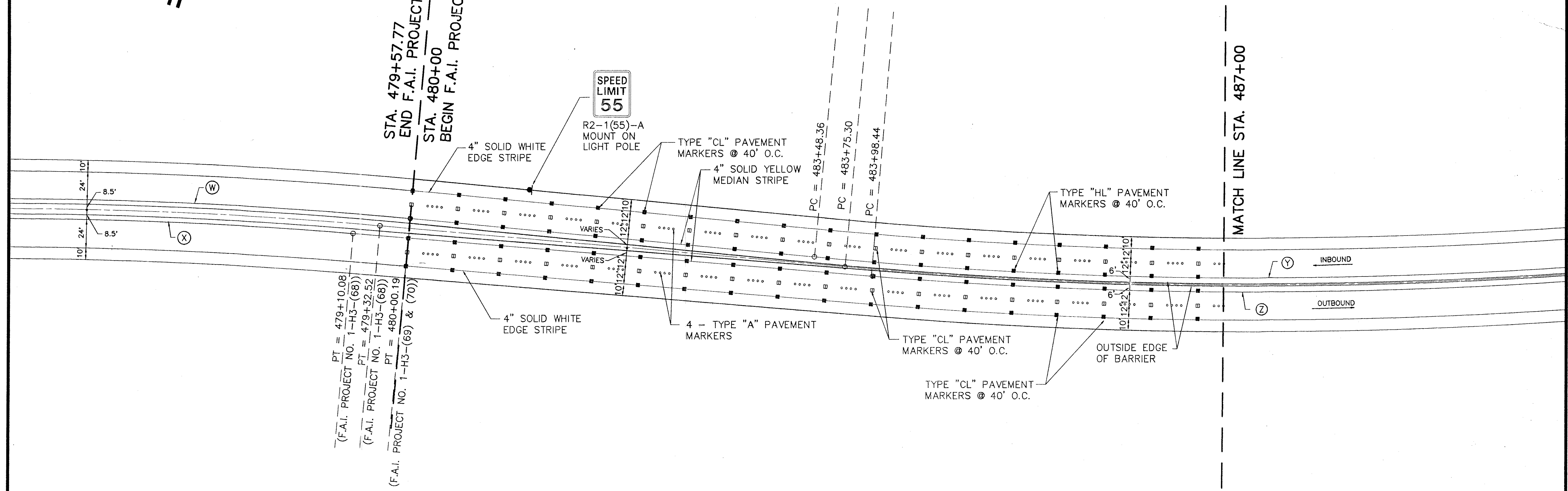

PT = 479+10.08
(F.A.I. PROJECT NO. 1-H3-(68))
PT = 479+32.52
(F.A.I. PROJECT NO. 1-H3-(68))
PT = 480+00.19
(F.A.I. PROJECT NO. 1-H3-(69) & (70))

GENERAL NOTES:

- EXACT LOCATION OF SIGNS WILL BE DETERMINED IN THE FIELD BY THE ENGINEER.
- SIGNS SHALL CONFORM TO THE LATEST EDITIONS AND AMENDMENTS OF THE FOLLOWING FHWA PUBLICATIONS:
 - "MANUAL ON UNIFORM TRAFFIC CONTROL DEVICES FOR STREETS AND HIGHWAYS" (MUTCD).
 - "STANDARD HIGHWAY SIGNS"
 - "STANDARD ALPHABETS FOR HIGHWAY SIGNS"
- PAINTED STRIPES WILL NOT BE PERMITTED ON THE HIGHWAY.
- ADHESIVES, PREFORMED PAVEMENT, AND REFLECTIVE THERMOPLASTIC COMPOUND PAVEMENT MARKINGS SHALL BE PERMITTED ON THE HIGHWAY.

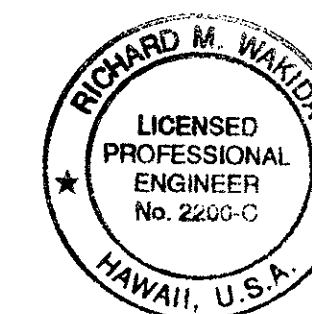

THIS WORK WAS PREPARED BY ME OR UNDER MY SUPERVISION
Richard M. Waiida 3/14/92
SIGNATURE DATE

GRAPHIC SCALE

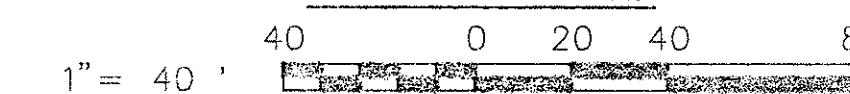

9-14-95	REVISED MEDIAN TAPER
11-5-93	REVISED MEDIAN TAPER
DATE	REVISION
STATE OF HAWAII DEPARTMENT OF TRANSPORTATION HIGHWAYS DIVISION	
SIGNING AND STRIPING PLAN STA. 480+00 TO STA. 487+00	
INTERSTATE ROUTE H-3 F.A.I. PROJECT NO. 1-H3-1(69) & (70)	
SCALE: 1" = 40'	DATE: MARCH 1992

SHEET No. C900F 95 SHEETS

C.O. ADD.93

SURVEY PLOTTED BY	DATE
DESIGNED BY	
TRACED BY	
NOTE BOOK	
QUANTITIES BY	
CHECKED BY	
No.	

FED. ROAD DIST. NO.	STATE	FED. AID PROJ. NO.	FISCAL YEAR	SHEET NO.	TOTAL SHEETS
HAWAII	HAW.	I-H3-1(69)	1992	94	95

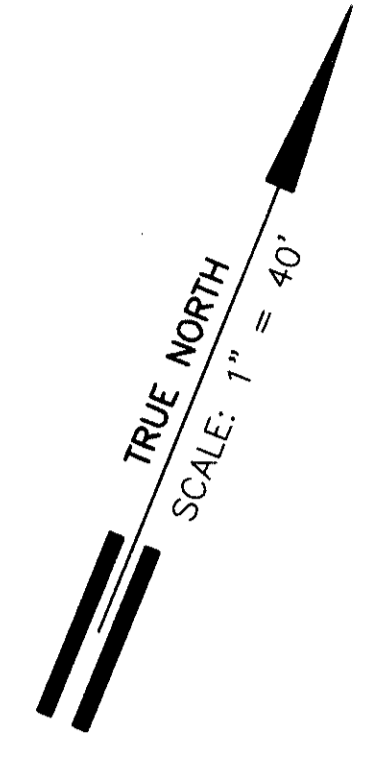

MATCH LINE STA. 487+00

MATCH LINE STA. 495+00

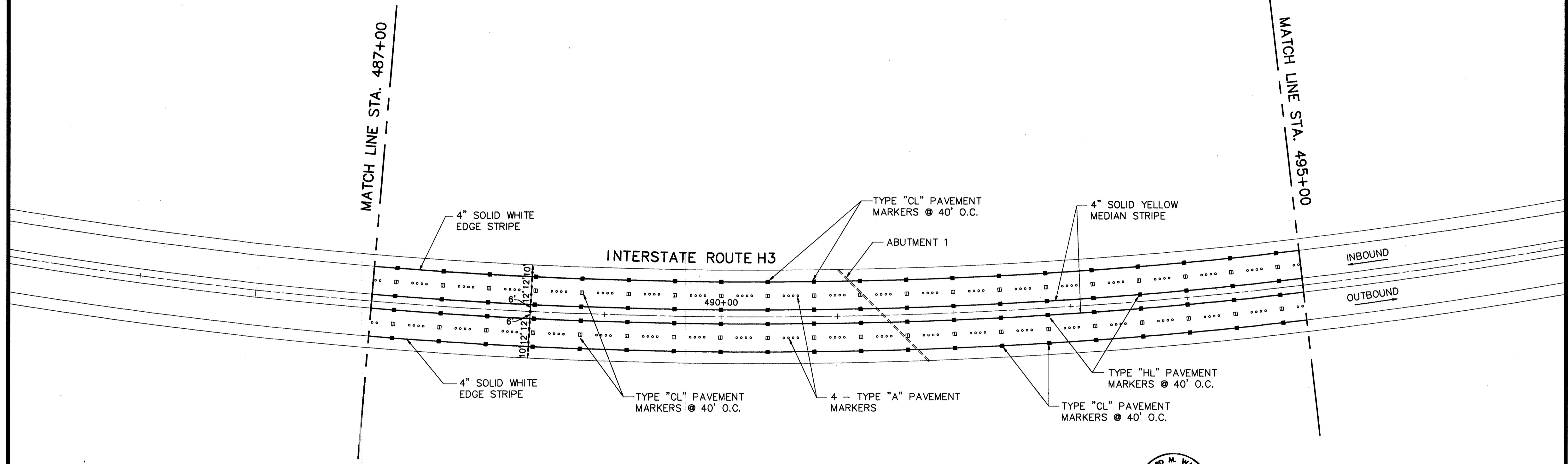

ORIGINAL PLAN	DATE
NOTED BY	
DESIGNED BY	
QUANTITIES BY	
CHECKED BY	



THIS WORK WAS PREPARED BY ME OR UNDER MY SUPERVISION.
Richard M. Ward
 SIGNATURE DATE

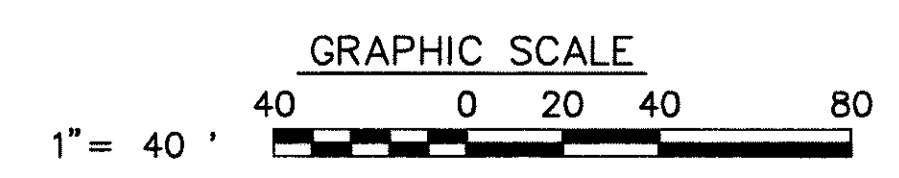

STATE OF HAWAII
 DEPARTMENT OF TRANSPORTATION
 HIGHWAYS DIVISION

SIGNING AND STRIPING PLAN
 STA. 487+00 TO STA. 495+00

INTERSTATE ROUTE H-3
 F.A.I. PROJECT NO. I-H3-1(69) & (70)

SCALE: 1" = 40' DATE: MARCH 1992

SHEET No. 94 OF 95 SHEETS

FED. ROAD DIST. NO.	STATE	FED. AID PROJ. NO.	FISCAL YEAR	SHEET NO.	TOTAL SHEETS
HAWAII	HAW.	I-H3-1(69)	1992	95	326

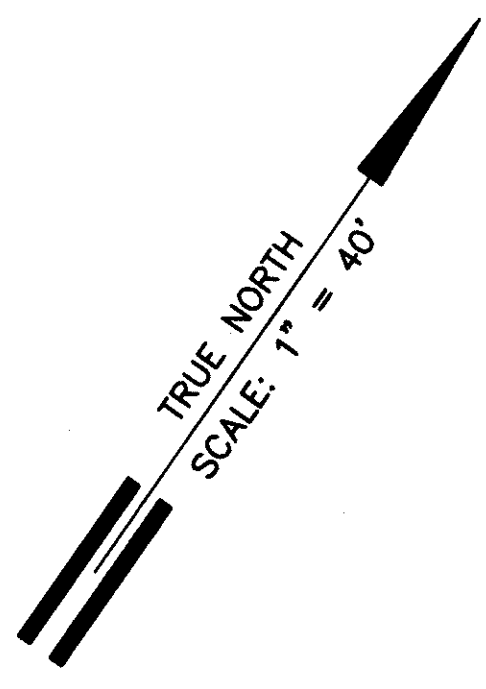

MATCH LINE STA. 495+00

MATCH LINE STA. 506+00
P.T. STA. 505+74.47

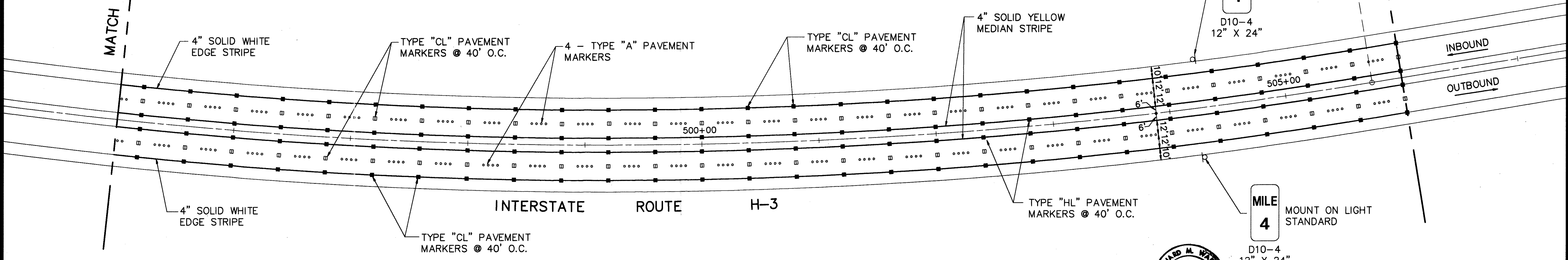

MILE 4
MOUNT ON LIGHT STANDARD
D10-4
12" X 24"

MILE 4
MOUNT ON LIGHT STANDARD
D10-4
12" X 24"



THE WORK WAS PREPARED BY ME
OR UNDER MY SUPERVISION.
Richard M. Waters
REGISTERED PROFESSIONAL ENGINEER

SURVEY PLOTTED BY	DATE
DRAWN BY	
DESIGNED BY	
QUANTITIES BY	
CHECKED BY	
ORIGINAL PLAN No.	

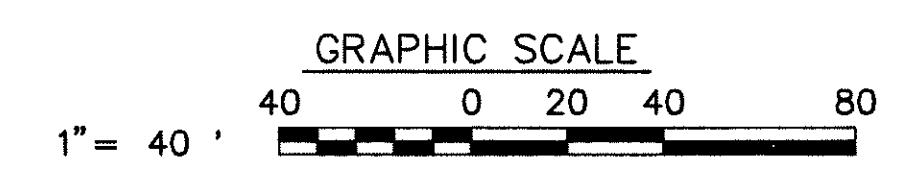

STATE OF HAWAII
DEPARTMENT OF TRANSPORTATION
HIGHWAYS DIVISION

SIGNING AND STRIPING PLAN
STA. 495+00 TO STA. 506+00

INTERSTATE ROUTE H-3
F.A.I. PROJECT NO. I-H3-1(69) & (70)

SCALE: 1" = 40' DATE: MARCH 1992

SHEET No. C92 OF 95 SHEETS

FED. ROAD DIST. NO.	STATE	FED. AID PROJ. NO.	FISCAL YEAR	SHEET NO.	TOTAL SHEETS
HAWAII	HAW.	I-H3-1(69)	1992	96	925

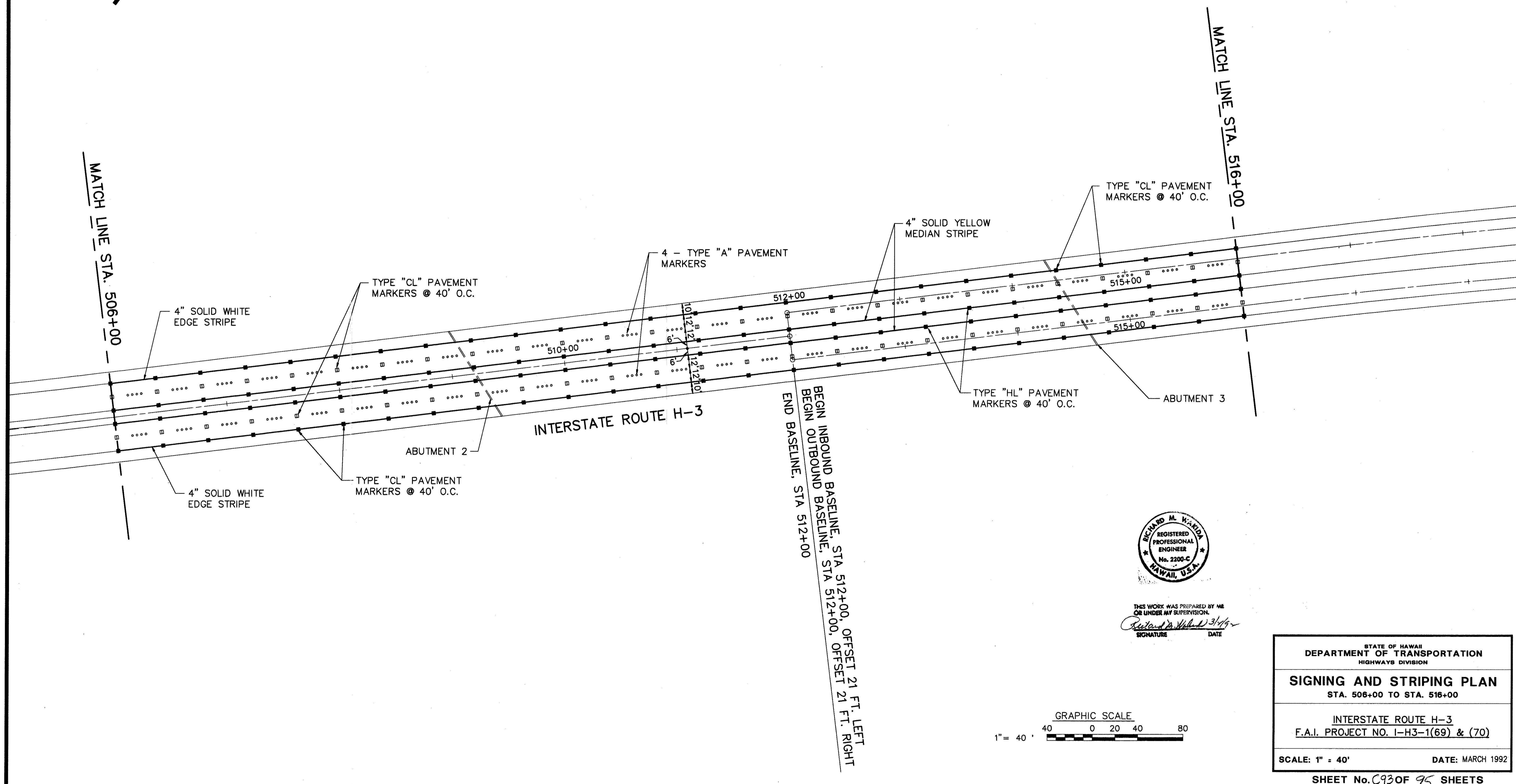
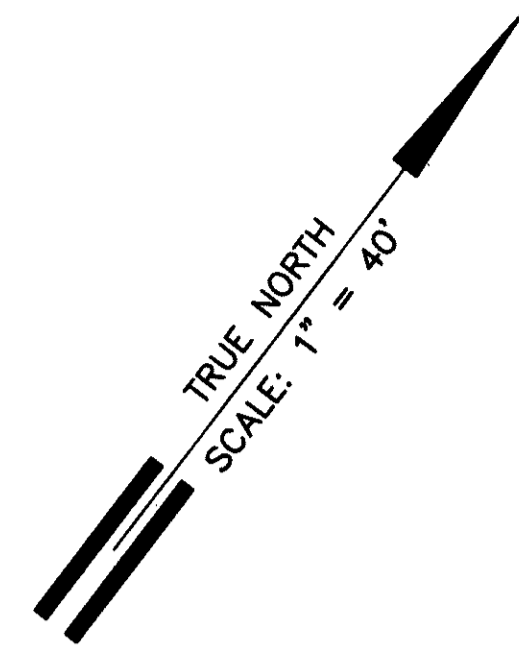

SURVEY PLOTTED BY	DATE
DESIGNED BY	
QUANTITIES BY	
CHECKED BY	
NOTE BOOK	
No.	

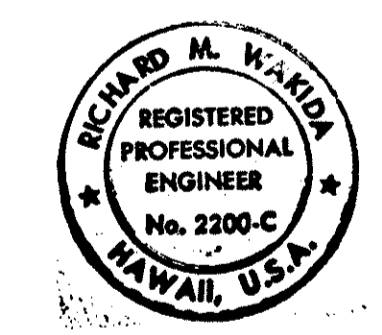

THIS WORK WAS PREPARED BY ME OR UNDER MY SUPERVISION.
Richard M. Waiolo 3/1/92
 SIGNATURE DATE

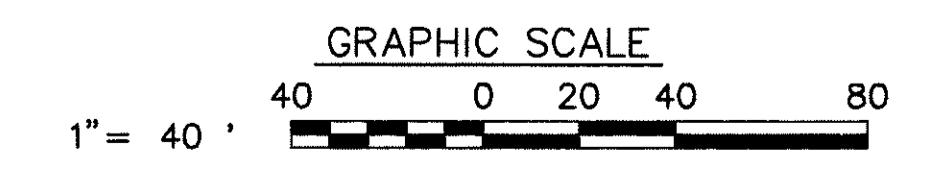

STATE OF HAWAII
 DEPARTMENT OF TRANSPORTATION
 HIGHWAYS DIVISION

SIGNING AND STRIPING PLAN
 STA. 506+00 TO STA. 516+00

INTERSTATE ROUTE H-3
 F.A.I. PROJECT NO. I-H3-1(69) & (70)

SCALE: 1" = 40' DATE: MARCH 1992

SHEET No. C93 OF 95 SHEETS

FED. ROAD DIST. NO.	STATE	FED. AID PROJ. NO.	FISCAL YEAR	SHEET NO.	TOTAL SHEETS
HAWAII	HAW.	I-H3-1(69)	1992	97	325

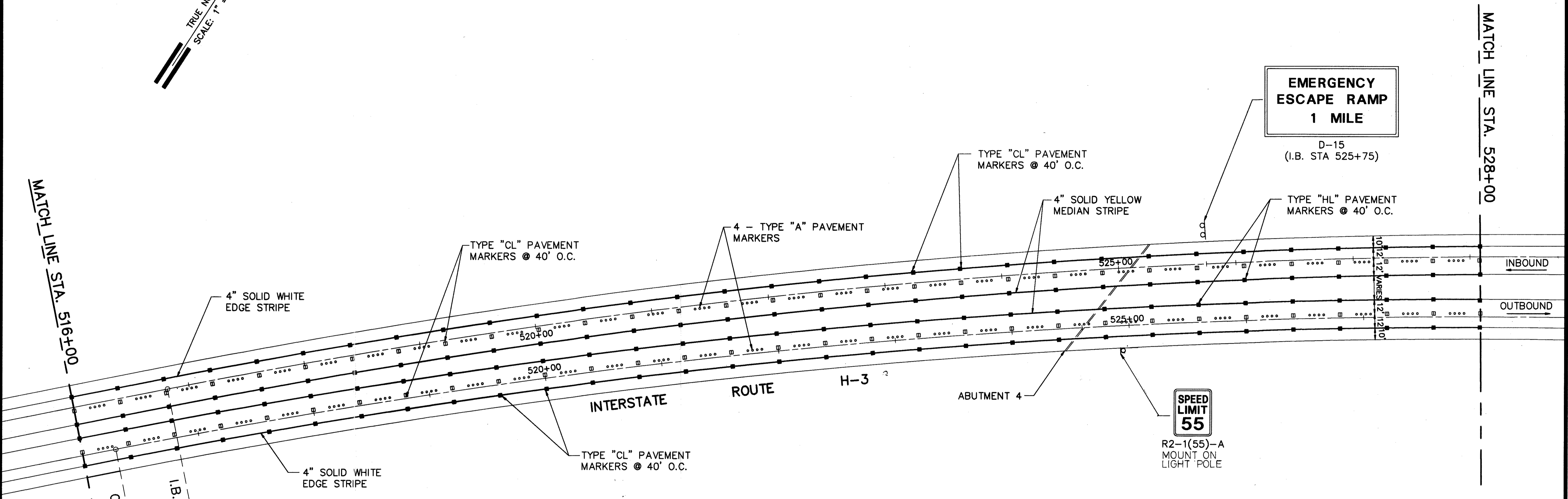
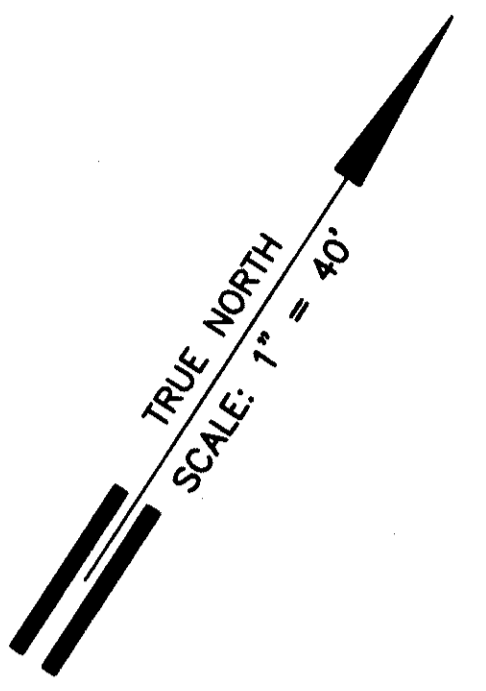

SURVEY PLOTTED BY	DATE
DESIGNED BY	
TRACED BY	
QUANTITIES BY	
CHECKED BY	
NOTE BOOK	
No.	

O.B. P.C. STA. 516+28.46
 I.B. P.C. STA. 516+81.51

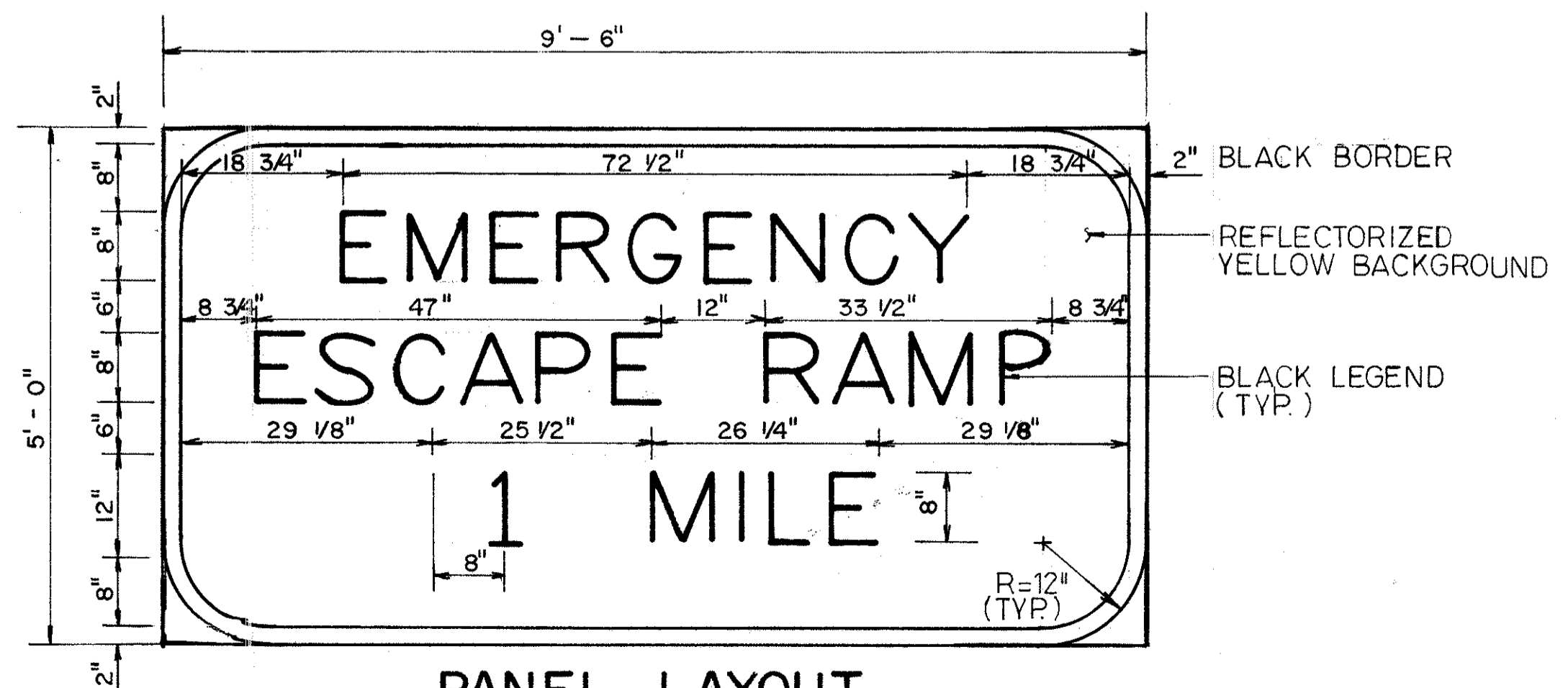

PANEL LAYOUT
SIGN D-15
 NOT TO SCALE



THIS WORK WAS PREPARED BY ME
 OR UNDER MY SUPERVISION.
Richard M. Wakia 3/1/92
 SIGNATURE DATE

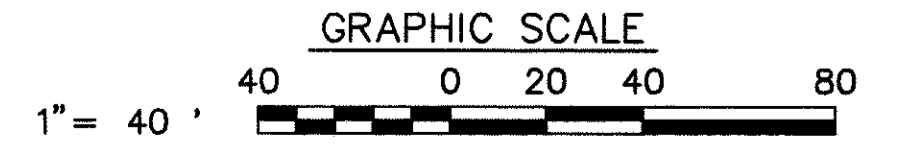

STATE OF HAWAII
 DEPARTMENT OF TRANSPORTATION
 HIGHWAYS DIVISION

SIGNING AND STRIPING PLAN
 STA. 516+00 TO STA. 528+00

INTERSTATE ROUTE H-3
 F.A.I. PROJECT NO. I-H3-1(69) & (70)

SCALE: 1" = 40' DATE: MARCH 1992

SHEET No. 094 OF 95 SHEETS

FED. ROAD DIST. NO.	STATE	FED. AID PROJ. NO.	FISCAL YEAR	SHEET NO.	TOTAL SHEETS
HAWAII	HAW.	I-H3-1(69)	1992	98	925

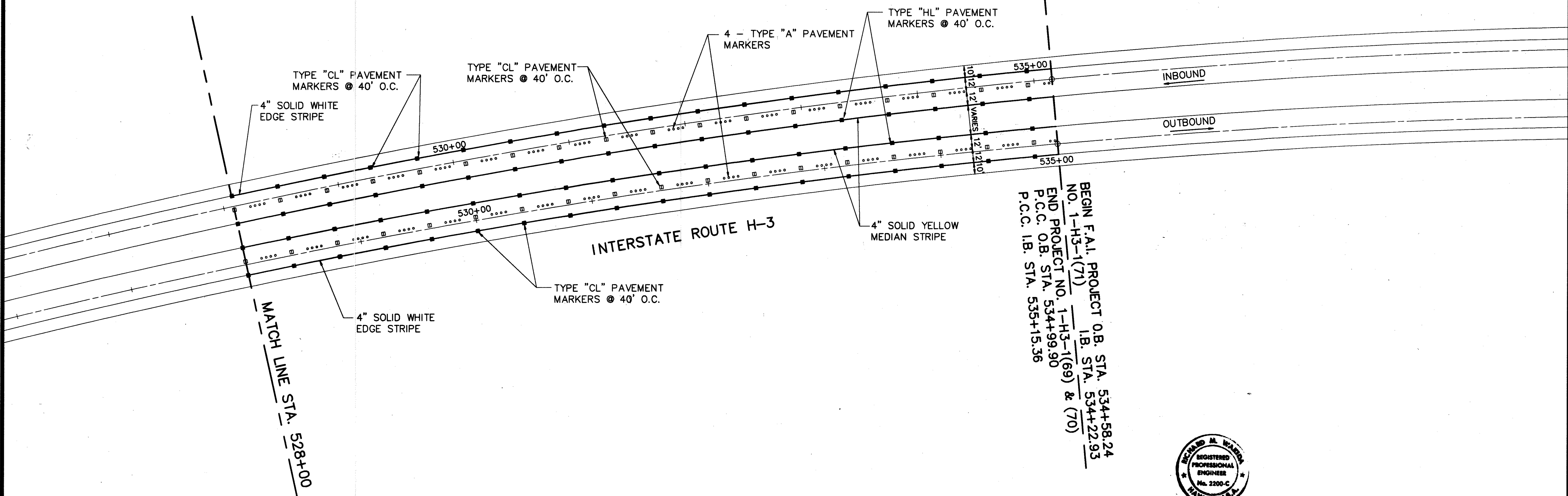
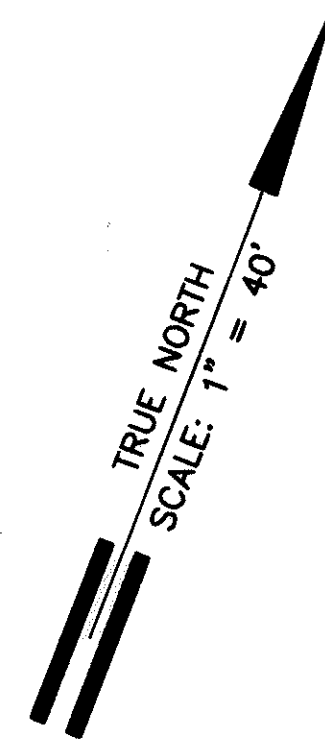

BEGIN F.A.I. PROJECT O.B. STA. 534+58.24
 NO. 1-H3-1(71) I.B. STA. 534+22.93
 END PROJECT NO. 1-H3-1(69) & (70)
 P.C.C. O.B. STA. 534+99.90
 P.C.C. I.B. STA. 535+15.36

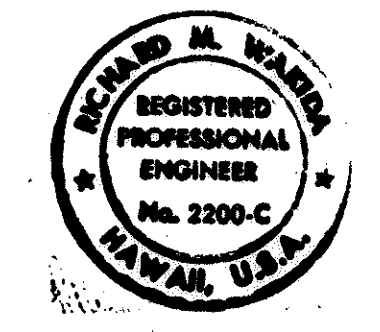

THE WORK WAS PREPARED BY ME
 OR UNDER MY SUPERVISION.
Richard M. Waiha 3/4/92
 SIGNATURE DATE

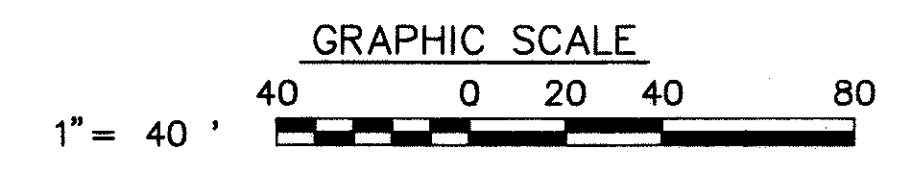

SURVEY PLOTTED BY	DATE
DRAWN BY	
TRACED BY	
QUANTITIES BY	
CHECKED BY	
ORIGINAL PLAN	
NOTE BOOK	
No.	

STATE OF HAWAII
 DEPARTMENT OF TRANSPORTATION
 HIGHWAYS DIVISION

SIGNING AND STRIPING PLAN
 STA. 528+00 TO STA. 534+99.90

INTERSTATE ROUTE H-3
 F.A.I. PROJECT NO. 1-H3-1(69) & (70)

SCALE: 1" = 40' DATE: MARCH 1992

SHEET No. 095 OF 95 SHEETS