

FED. ROAD DIST. NO.	STATE	FED. AID PROJ. NO.	FISCAL YEAR	SHEET NO.	TOTAL SHEETS
HAWAII	HAW.	F-078-1(7)	1971	36	302

Revised: July 19, 1971

GENERAL NOTES FOR CONSTRUCTION AND DETOUR PHASING AND TEMPORARY SIGNING

1. All service from existing utilities that are to remain or are to be relocated shall be maintained at all times, unless special approval is obtained from the Engineer for the temporary discontinuance of service.
2. The Contractor shall follow the order of construction detour phasing as shown on the plans. However, phasing may overlap and contract items of work involved in each phasing may be constructed at any time as long as the detour phasing is not affected. Any request for adjustment of sequencing or phasing must be submitted in writing and approved by the Engineer.
3. Contractor shall maintain access to properties affected by construction at all times until a permanent replacement access is provided by timely construction of each phase of the work.
4. All utilities, guard rail, lighting, signing, hydro-mulching and other related work within each individual construction phase shall be performed completely to the extent necessary in such timely sequence as to preclude duplication of efforts (as re-excavation for installation of utilities) and hazardous roadside construction (as installation of guard rails or signs on roadways open to public traffic).
5. Construction of temporary pavement section shall be paid for under applicable contract items. Scarifying and removal of pavement section and restoring ground, guard rails and other items to original condition upon completion of the project shall be considered as incidental to the various contract items.
6. Temporary traffic and destination signs, barricades, traffic drums and other related work shown on the plans shall be paid for under applicable contract items.
7. All relocations of temporary warning, regulatory, construction and maintenance signs, posts, barricades, and traffic drums between phases are to be considered as incidental to the applicable contract items of work.
8. Contractor may use portable or temporary posts for construction and maintenance signs with the approval of the Engineer.
9. All traffic and destination signs, barricades, and traffic drums for the purposes of traffic detours and construction sequencing shall be the property of the State upon completion of the project and shall be removed and stockpiled at the jobsite as directed by the Engineer. Costs for removal and stockpiling shall be incidental to the various contract items.
10. Unless noted otherwise, exact locations of signs, barricades, and traffic drums shall be determined in the field by the Engineer.
11. The shape, color, dimensions, symbols, wording, lettering and reflectorizing of all temporary warning, regulatory, construction and maintenance signs shall be in accordance with the "Manual on Uniform Traffic Control Devices for Streets and Highways," dated June 1961 and the BPR manual "Standard Highway Signs," dated September 1961, unless otherwise specified.
12. Pavements used for temporary detouring of traffic shall be constructed as shown in the Typical Sections.
13. Where temporary striping of the permanent pavement is required, the top 1-inch of Asphalt Concrete Pavement, Mix II shall be omitted until the final striping of the pavement can be incorporated.

14. Temporary destination sign panels shall be either 3/4" waterproof plywood or 0.100" thick sheet aluminum. Sign legends shall be 8" uppercase with 6" lowercase Series "E" modified letters conforming to the "Standard Alphabets for Highway Signs" Bureau of Public Roads, 1966. Letters, borders and arrows shall be white reflective sheeting on green reflective sheeting background.
15. Contractor is to maintain two lanes of traffic in each direction at all times on Moanalua Road, except as noted below, when one lane of traffic in each direction shall be permitted:
 - a. 9:00 P.M. to 5:30 A.M. (All days except Fridays, Saturdays, and days before Holidays)
 - b. Any exceptions must be approved by the Engineer.
16. The Contractor shall verify locations of all underground utilities before installing guard rail. Any damage to the existing and/or newly installed utilities shall be repaired at the Contractor's expense.
17. The Contractor shall take extra precaution against damaging the existing utilities while constructing the detour road within the existing median.

SUMMARY OF CONSTRUCTION SIGNS FOR DETOUR

TYPE	DESCRIPTION	QUANTITY
R1-1	STOP	3
R1-2	YIELD	1
R4-7(L)	KEEP LEFT	1
W1-4(R)	↗	1
W1-4(L)	↖	1
W4-1	MERGING TRAFFIC	1
W13-1(25)	25 M.P.H.	2
W20-1a	ROAD CONSTRUCTION 1500 FT.	1
W20-2b	DETOUR 1000 FT.	1
TOTAL		12
CLASS I BARRICADE		1
TRAFFIC DRUMS 0		130

TRAFFIC DRUMS SHALL BE IN ACCORDANCE WITH THE MANUAL ON UNIFORM TRAFFIC CONTROL DEVICES

DATE	_____
DESIGNED BY	_____
DRAWN BY	_____
CHECKED BY	_____
NO.	_____

THIS SHEET SUPERSEDES SHEET NO. 36

STATE OF HAWAII
DEPARTMENT OF TRANSPORTATION
HIGHWAYS DIVISION

CONSTRUCTION DETOUR
GENERAL NOTES AND SUMMARY

MOANALUA ROAD
F.A.P. Proj. No. F-078-1(7)

Date: April, 1971

SHEET No. 1 OF 14 SHEETS

ADD. 36

FED. ROAD DIST. NO.	STATE	FED. AID PROJ. NO.	FISCAL YEAR	SHEET NO.	TOTAL SHEETS
HAWAII	HAW.	F-078-1(7)	1971	37	302

TRUE NORTH
Scale: 1" = 50'

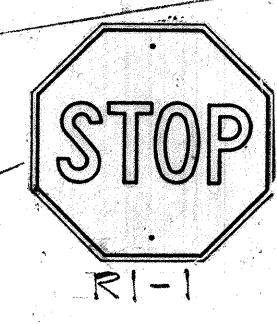
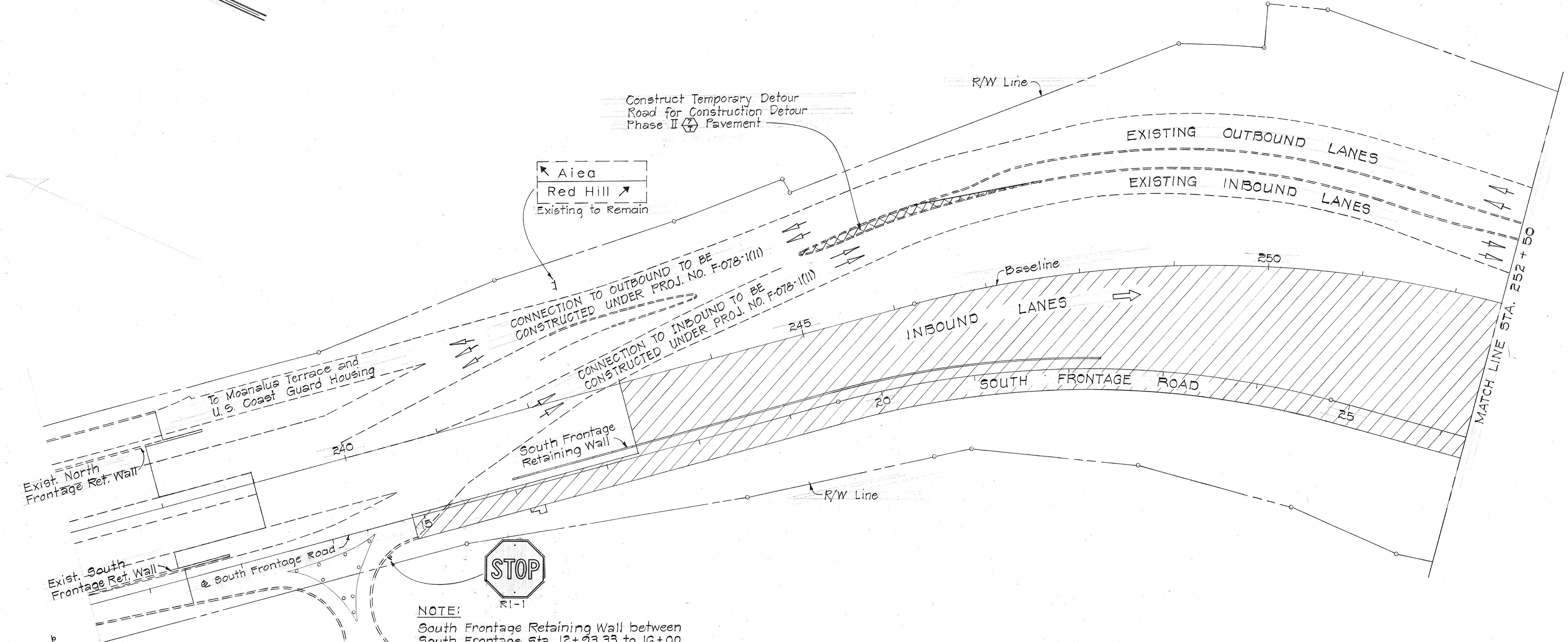

NOTE:
South Frontage Retaining Wall between South Frontage Sta. 12+03.33 to 16+00 shall not be constructed until the use of South Frontage Road is no longer required for detouring of traffic.

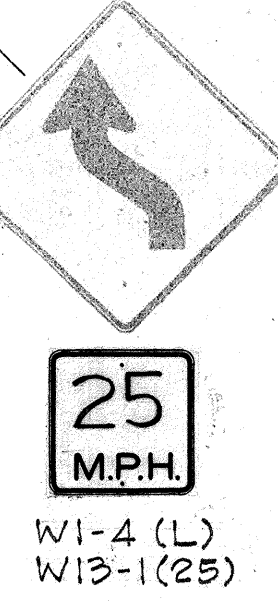

W1-4 (L)
W13-1(25)

DESIGNED BY	DATE
TRACED BY	
DESIGNED BY	
CHECKED BY	
NO.	

STATE OF HAWAII
DEPARTMENT OF TRANSPORTATION
HIGHWAYS DIVISION

**CONSTRUCTION DETOUR
PHASE I**

MOANALUA ROAD
E.A.P. PROJECT No. F-078-1(7)

Scale: 1" = 50' Date: April, 1971

SHEET No. 2 OF 14 SHEETS

FED. ROAD DIST. NO.	STATE	FED. AID PROJ. NO.	FISCAL YEAR	SHEET NO.	TOTAL SHEETS
HAWAII	HAW.	F-078-1(7)	1971	38	302

TRUE NORTH
Scale: 1" = 50'

NOTE
The contractor shall take extra precaution against damaging the existing utilities while constructing the detour road within the existing median.

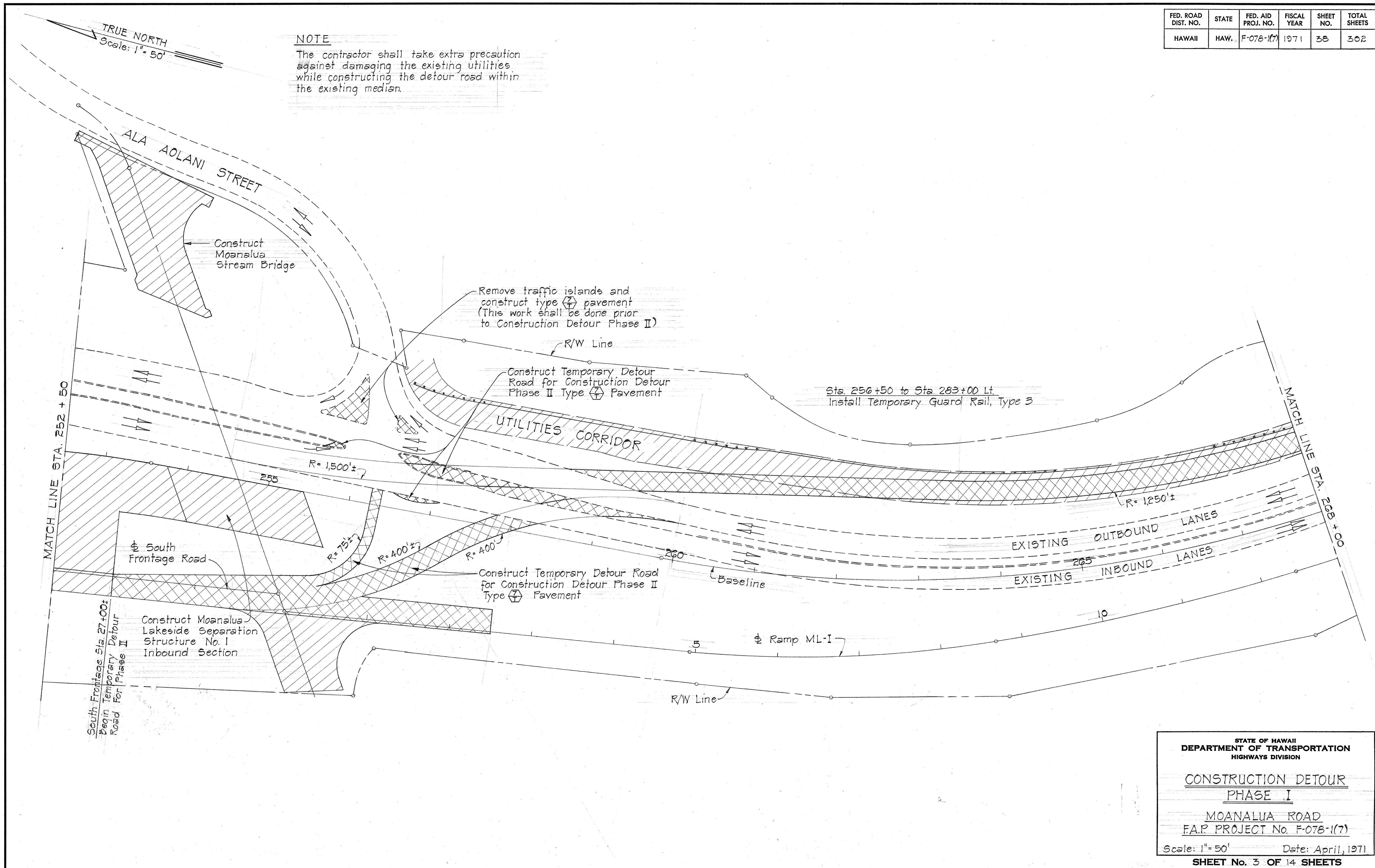

SURVEY PLOTTED BY	DATE
DESIGNED BY	
TRACED BY	
QUANTITIES BY	
CHECKED BY	
ORIGINAL PLAN NOTE BOOK No.	

STATE OF HAWAII
DEPARTMENT OF TRANSPORTATION
HIGHWAYS DIVISION

**CONSTRUCTION DETOUR
PHASE I**

MOANALUA ROAD
F.A.P. PROJECT No. F-078-1(7)

Scale: 1" = 50' Date: April, 1971

SHEET No. 3 OF 14 SHEETS

FED. ROAD DIST. NO.	STATE	FED. AID PROJ. NO.	FISCAL YEAR	SHEET NO.	TOTAL SHEETS
HAWAII	HAW.	F-078-1(7)	1971	39	302

Revised: July 17, 1971

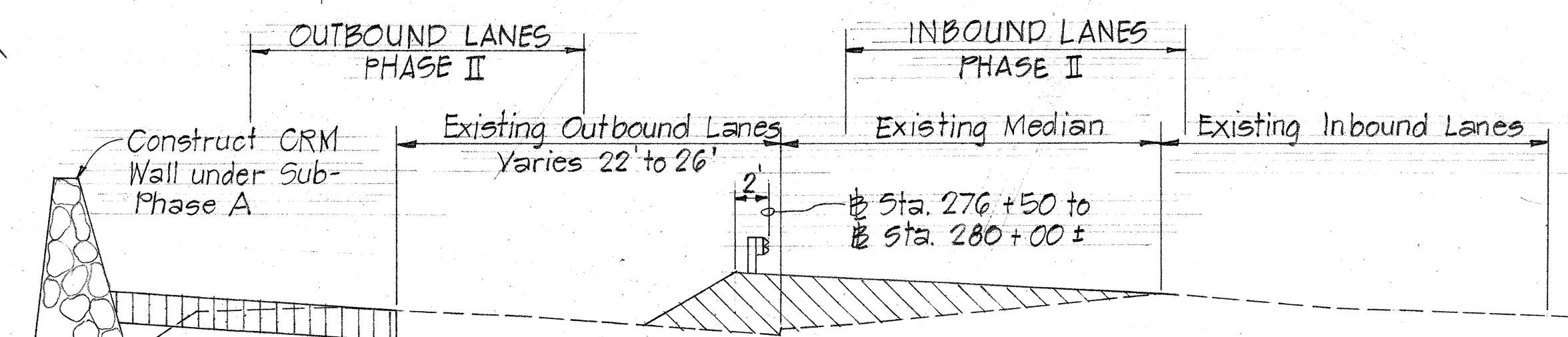
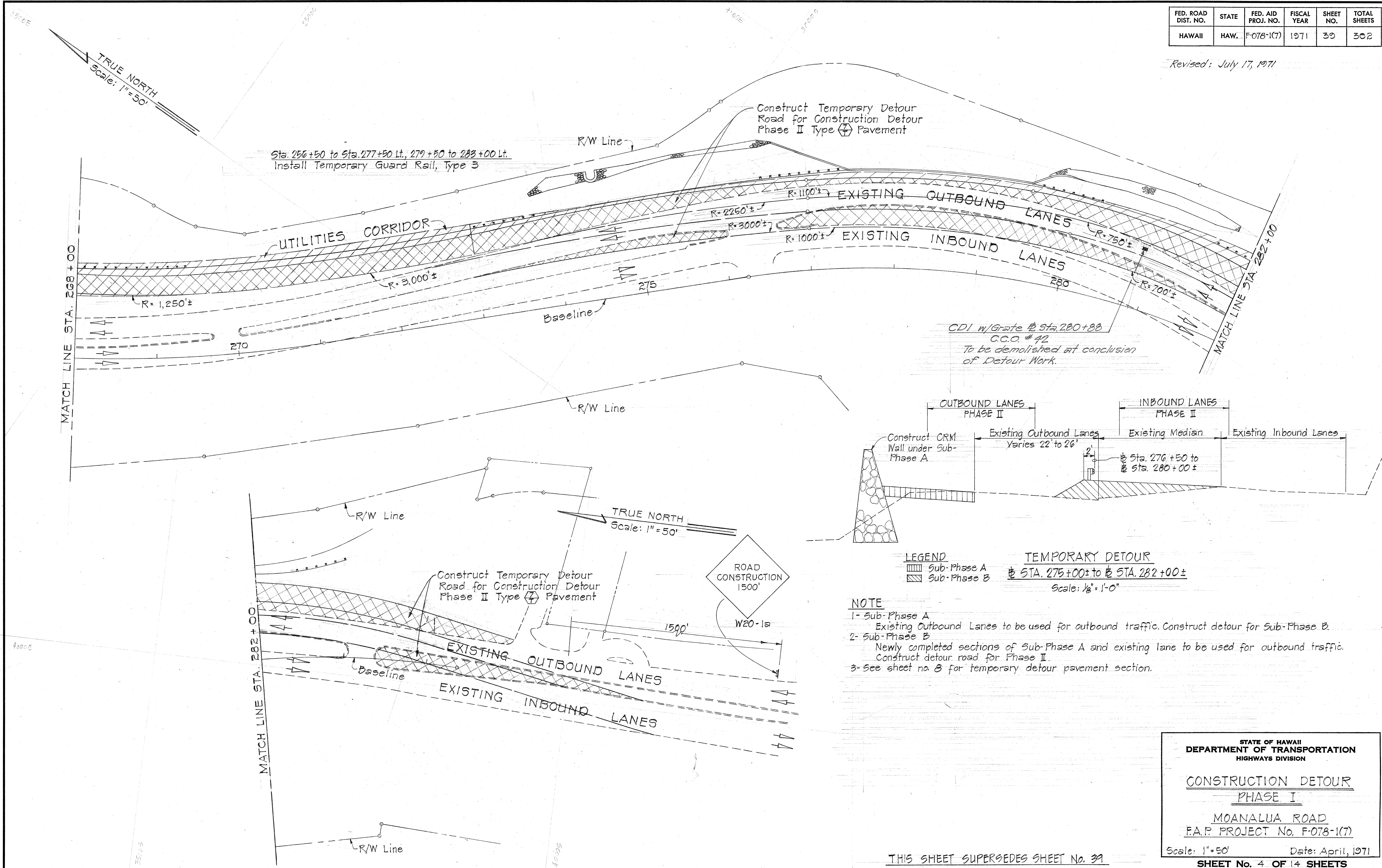

LEGEND
 [Hatched Box] Sub-Phase A
 [Cross-hatched Box] Sub-Phase B

TEMPORARY DETOUR
 Sta. 275+00± to Sta. 282+00±
 Scale: 1/8" = 1'-0"

- NOTE**
- 1- Sub-Phase A
Existing Outbound Lanes to be used for outbound traffic. Construct detour for Sub-Phase B.
 - 2- Sub-Phase B
Newly completed sections of Sub-Phase A and existing lane to be used for outbound traffic. Construct detour road for Phase II.
 - 3- See sheet no. 8 for temporary detour pavement section.

DATE	
DESIGNED BY	
CHECKED BY	
DATE	
DESIGNED BY	
CHECKED BY	
DATE	
DESIGNED BY	
CHECKED BY	

STATE OF HAWAII
 DEPARTMENT OF TRANSPORTATION
 HIGHWAYS DIVISION

CONSTRUCTION DETOUR
PHASE I

MOANALUA ROAD
 F.A.P. PROJECT No. F-078-1(7)

Scale: 1" = 50' Date: April, 1971

SHEET No. 4 OF 14 SHEETS

THIS SHEET SUPERSEDES SHEET No. 39

ADD. 39

FED. ROAD DIST. NO.	STATE	FED. AID PROJ. NO.	FISCAL YEAR	SHEET NO.	TOTAL SHEETS
HAWAII	HAW.	F-078-1(7)	1971	40	302

NOTE:
 North Frontage Retaining Wall between North Frontage Sta. 12+05 to 24+00.00 shall not be constructed until the use of North Frontage Road is no longer required for detouring of traffic.

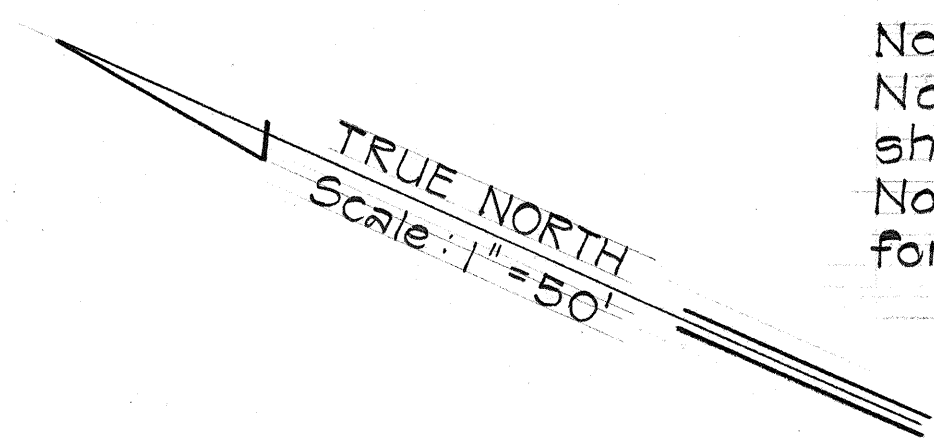

Provide Temporary smooth riding connection to Existing Pavement for Construction Detour Phase II A

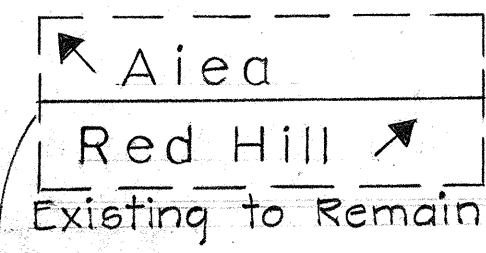

CONNECTION TO OUTBOUND TO BE CONSTRUCTED UNDER PROJ. NO. F-078-1(1)

To Moanalua Terrace and U.S. Coast Guard Housing

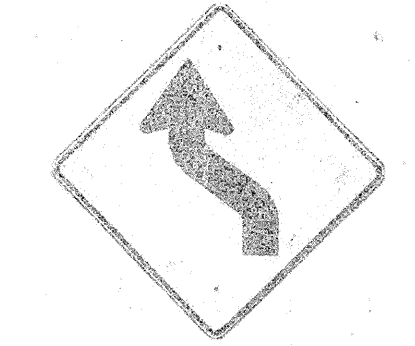
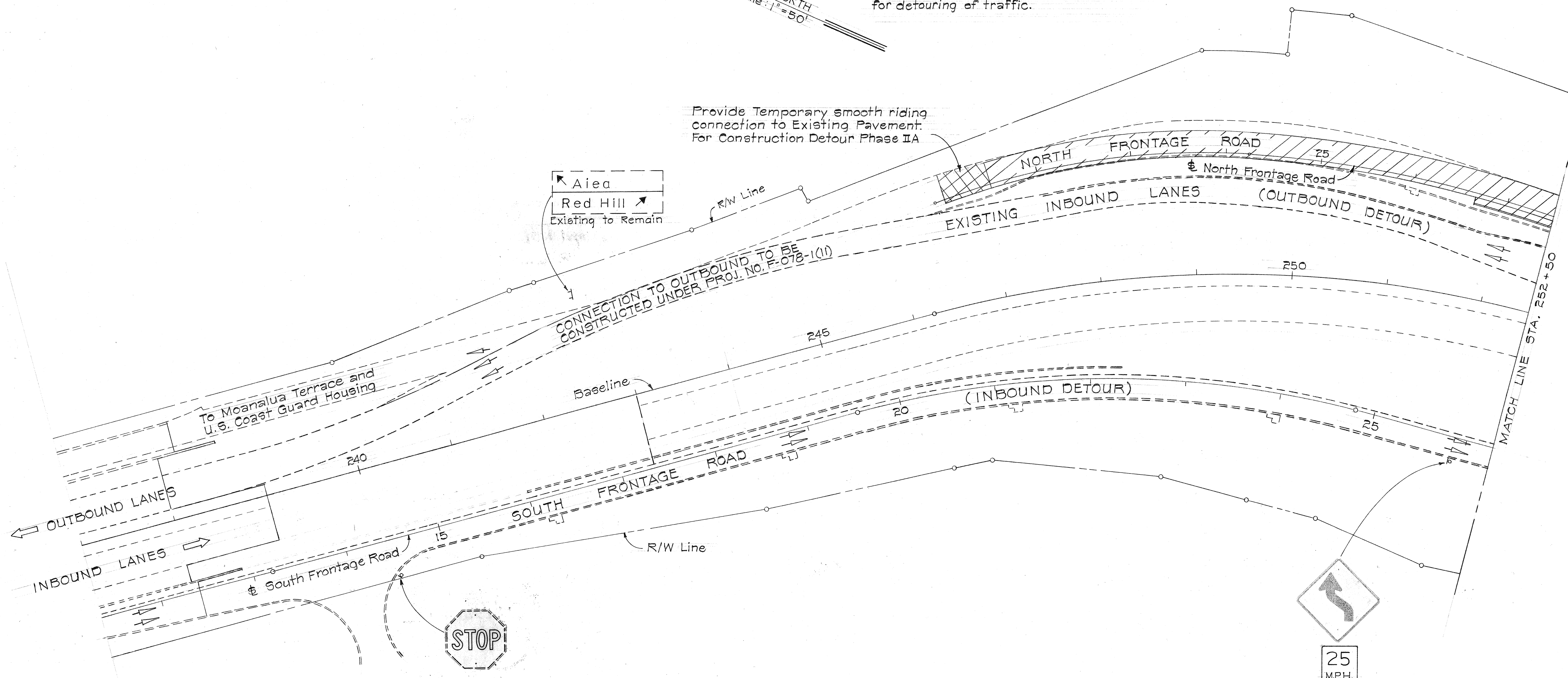

25 M.P.H.

W1-4 (L)
 W13-1 (25)
 Relocated From Phase I

SURVEY PLATTED BY	DATE
FRACED BY	
DESIGNED BY	
QUANTITIES BY	
CHECKED BY	
ORIGINAL PLAN	
NOTE BOOK	
No.	

STATE OF HAWAII
 DEPARTMENT OF TRANSPORTATION
 HIGHWAYS DIVISION

**CONSTRUCTION DETOUR
 PHASE II**

MOANALUA ROAD
 E.A.P. PROJECT NO. F-078-1(7)

Scale: 1"=50' Date: April, 1971

SHEET No. 5 OF 14 SHEETS

FED. ROAD DIST. NO.	STATE	FED. AID PROJ. NO.	FISCAL YEAR	SHEET NO.	TOTAL SHEETS
HAWAII	HAW.	F-078-1(7)	1971	42	302

Revised: July 12, 1971

TRUE NORTH
Scale: 1"=50'

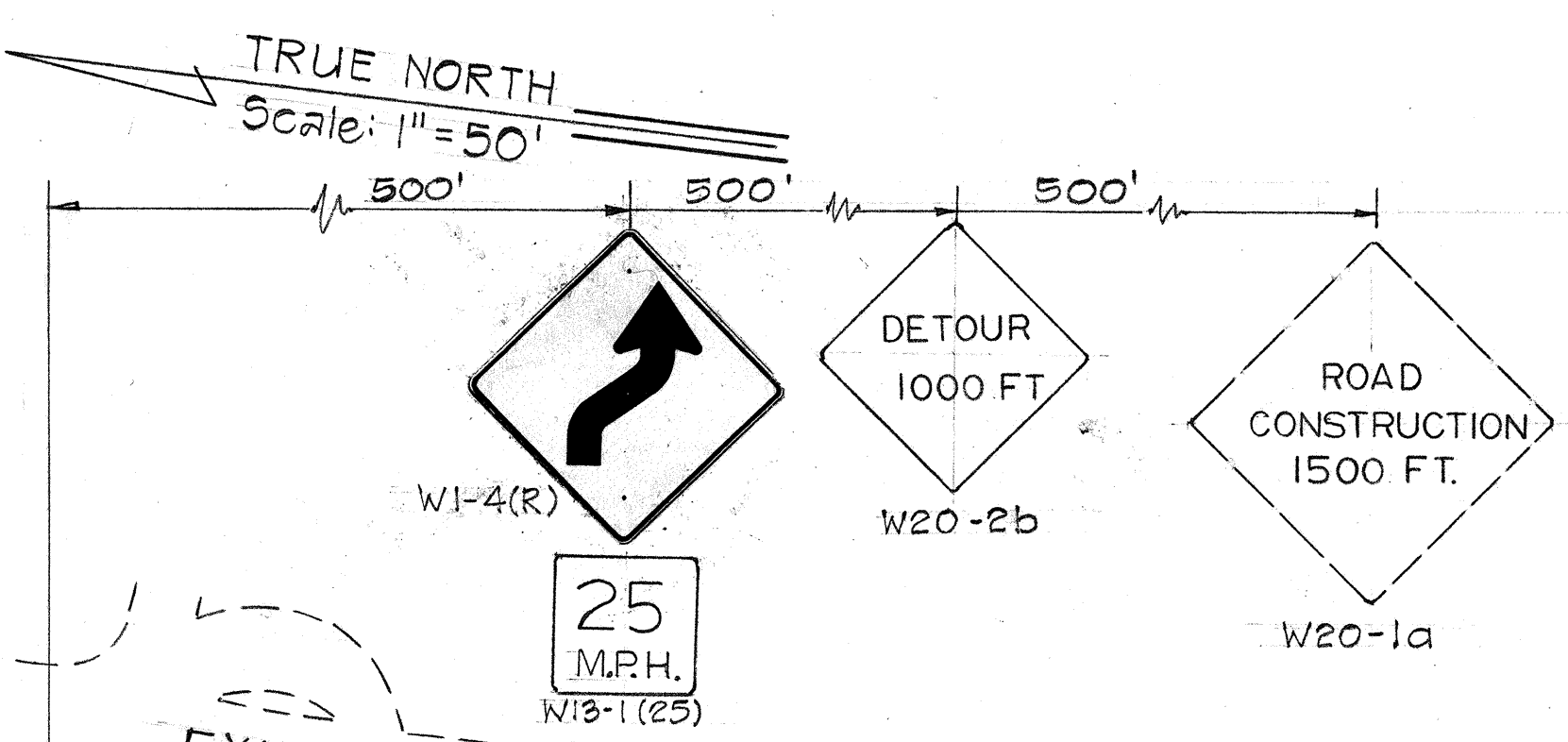
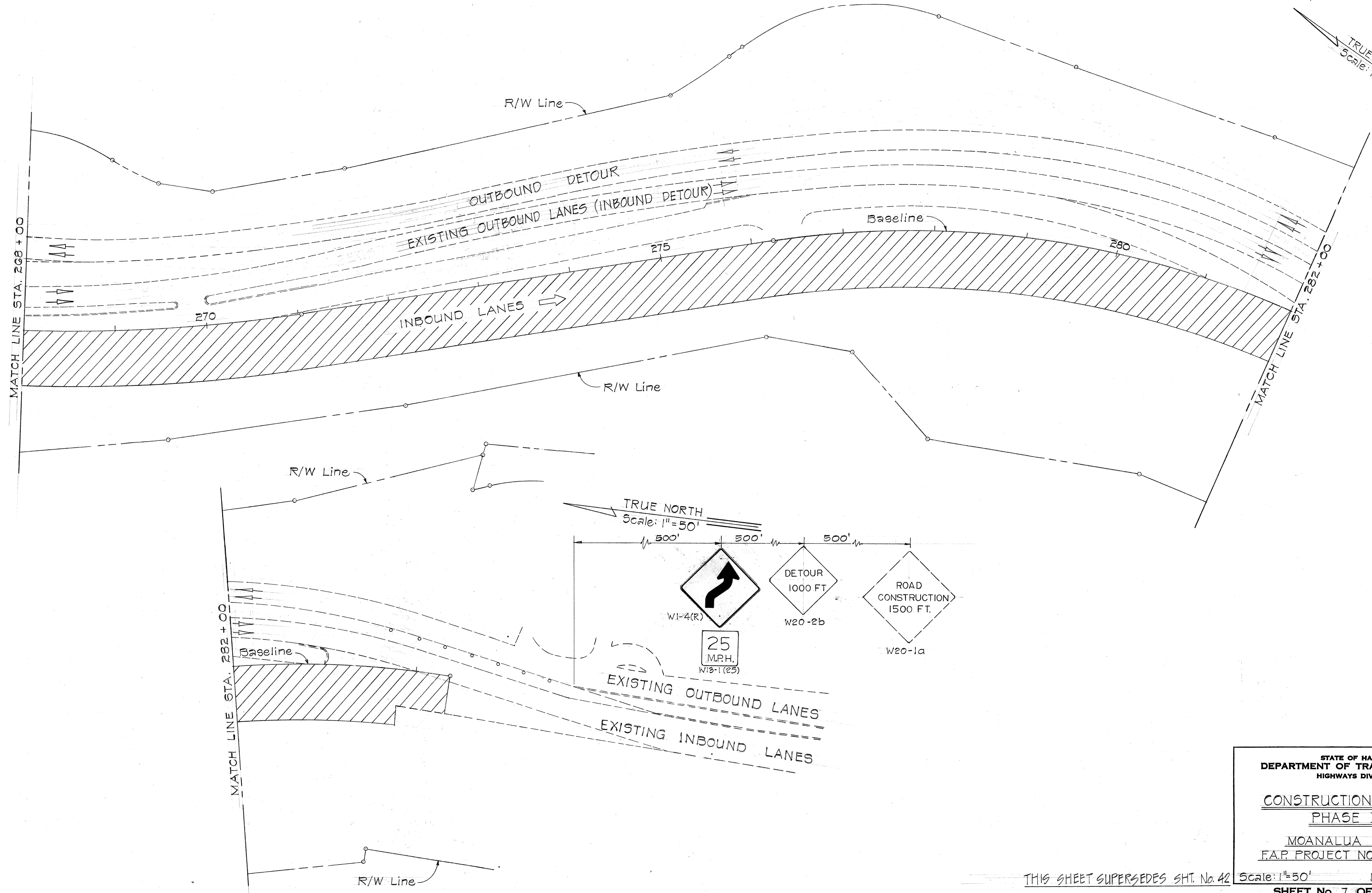

DESIGNED BY	DATE
DRAWN BY	
CHECKED BY	
DATE	
NO.	

STATE OF HAWAII
DEPARTMENT OF TRANSPORTATION
HIGHWAYS DIVISION

**CONSTRUCTION DETOUR
PHASE II**

MOANALUA ROAD
F.A.P. PROJECT NO. F-078-1(7)

Scale: 1"=50' Date: April, 1971

SHEET No. 7 OF 14 SHEETS

THIS SHEET SUPERSEDES SHT. No. 42

ADD. 42

FED. ROAD DIST. NO.	STATE	FED. AID PROJ. NO.	FISCAL YEAR	SHEET NO.	TOTAL SHEETS
HAWAII	HAW.	F-078-1(7)	1971	43	302

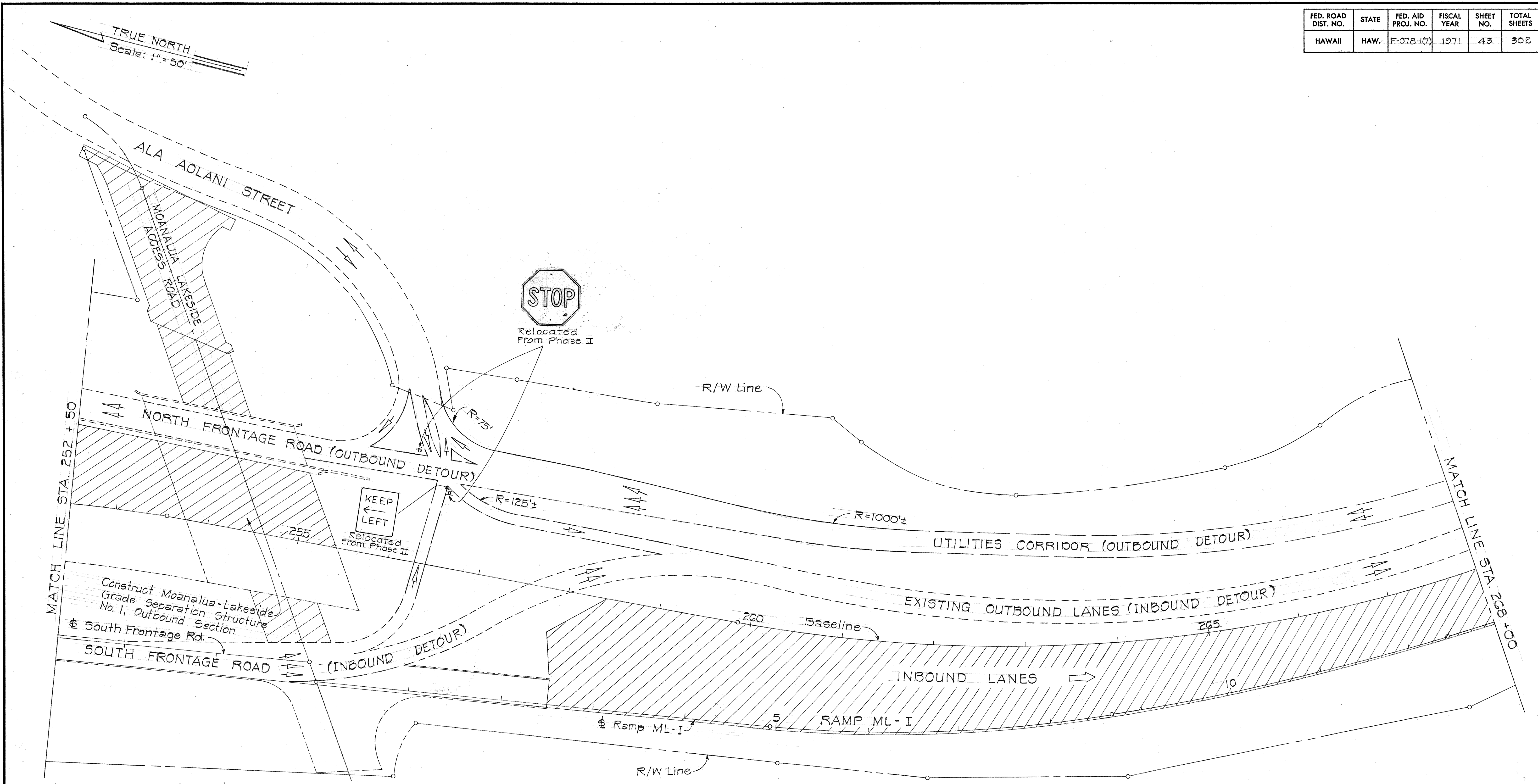

DESIGNED BY	DATE
DRAWN BY	
CHECKED BY	
APPROVED BY	
NO. _____	

PHASE IA
 Similar to Phase II except outbound traffic is shifted to North Frontage Road. Begin construction of Moanalua - Lakeside Grade Separation Structure No. 1 outbound section, and complete construction of Moanalua - Lakeside Access Road.

STATE OF HAWAII
 DEPARTMENT OF TRANSPORTATION
 HIGHWAYS DIVISION

CONSTRUCTION DETOUR
PHASE IA

MOANALUA ROAD
 F.A.P. PROJECT No. F-078-1(7)

Scale: 1" = 50' Date: April, 1971

SHEET No. 8 OF 14 SHEETS

FED. ROAD DIST. NO.	STATE	FED. AID PROJ. NO.	FISCAL YEAR	SHEET NO.	TOTAL SHEETS
HAWAII	HAW.	F-078-1(7)	1971	44	302

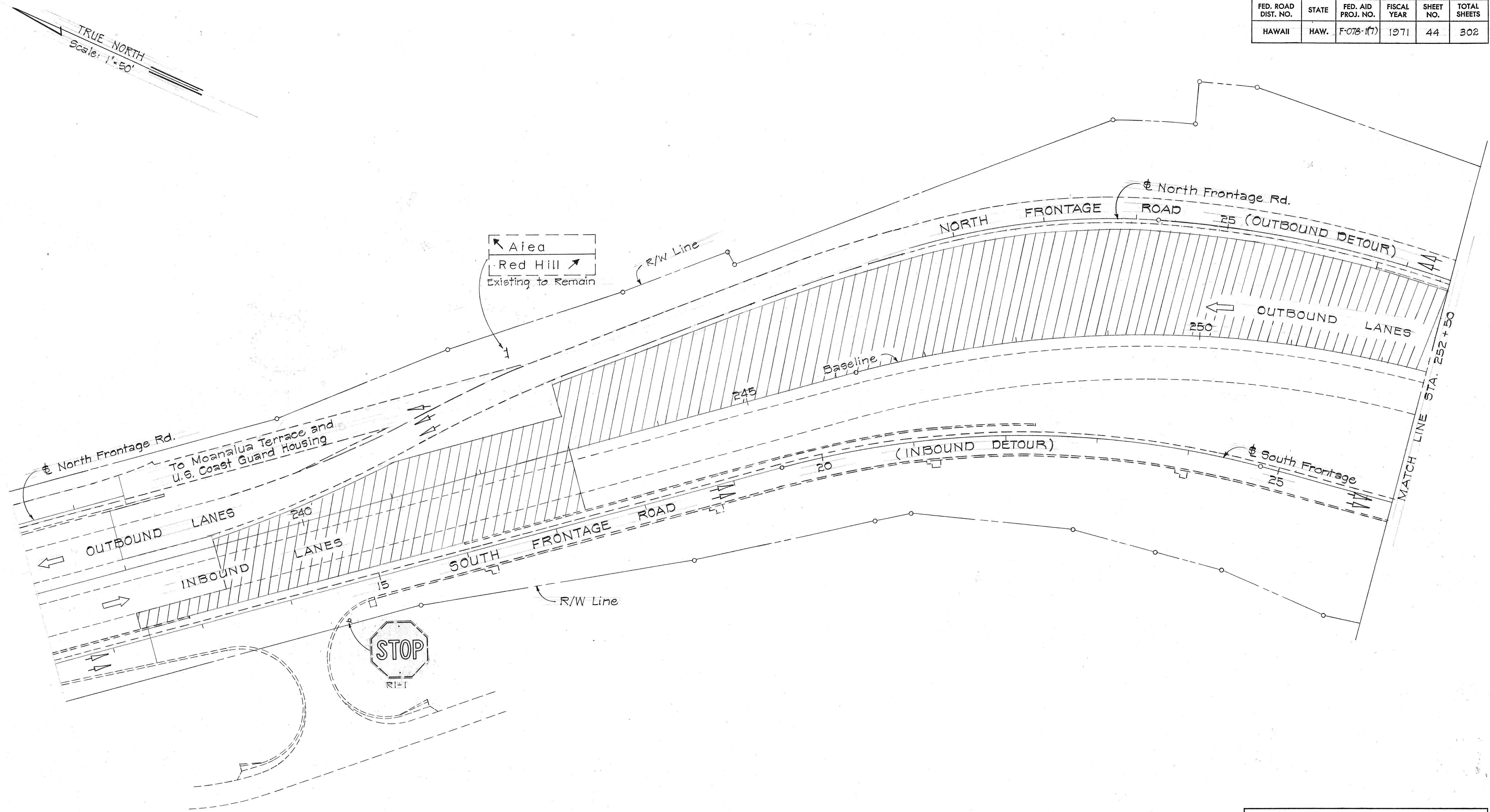

DESIGNED BY	DATE
TRACED BY	
DESIGNED BY	
CHECKED BY	
NO.	

STATE OF HAWAII
DEPARTMENT OF TRANSPORTATION
HIGHWAYS DIVISION

CONSTRUCTION DETOUR
PHASE III

MOANALUA ROAD
F.A.P. PROJECT No. F-078-1(7)

Scale: 1" = 50' Date: April, 1971

SHEET No. 9 OF 14 SHEETS

FED. ROAD DIST. NO.	STATE	FED. AID PROJ. NO.	FISCAL YEAR	SHEET NO.	TOTAL SHEETS
HAWAII	HAW.	F-078-1(7)	1971	45	302

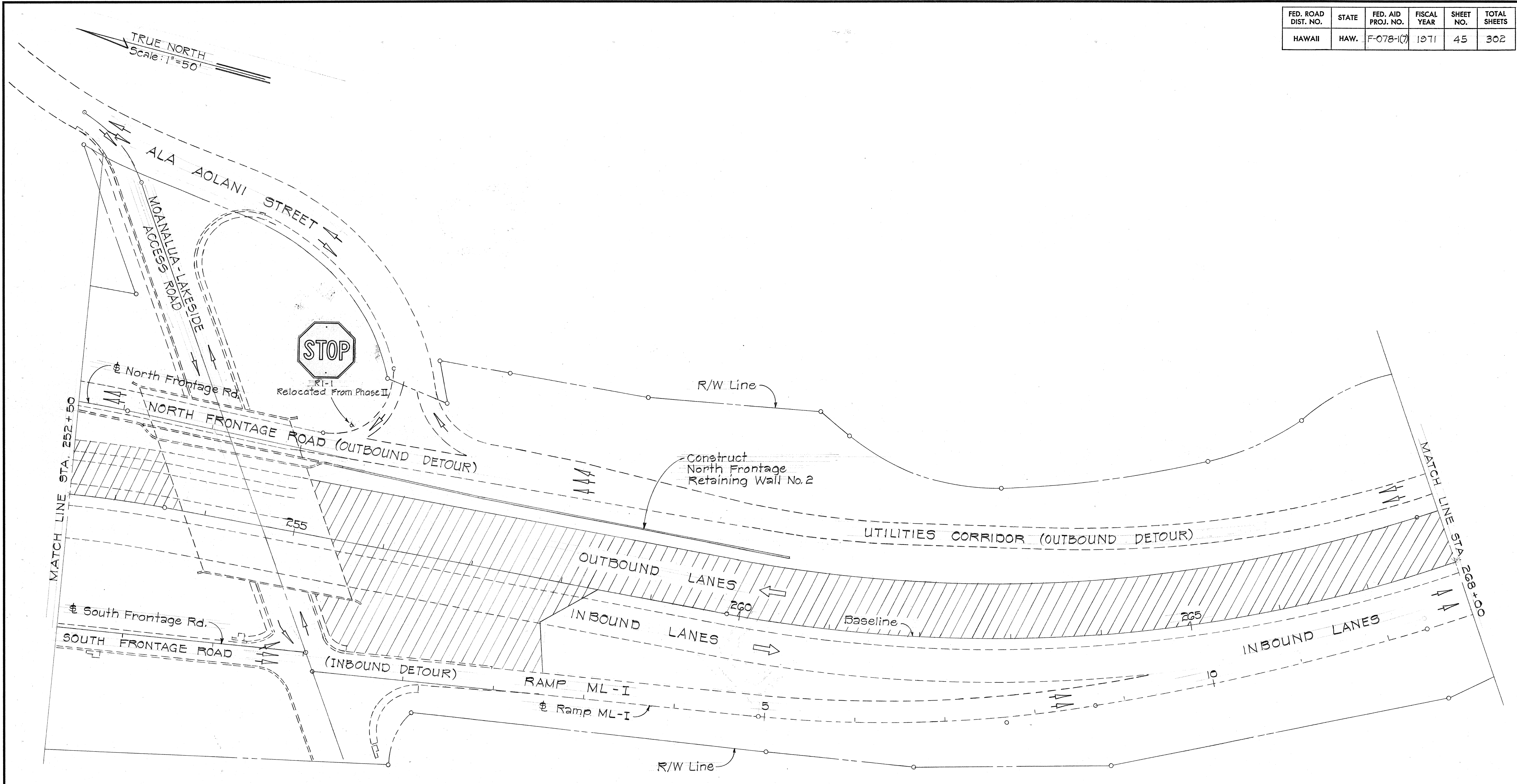

DATE
DESIGNED BY
CHECKED BY
DATE
DESIGNED BY
CHECKED BY
DATE
DESIGNED BY
CHECKED BY

STATE OF HAWAII
DEPARTMENT OF TRANSPORTATION
HIGHWAYS DIVISION

**CONSTRUCTION DETOUR
PHASE III**

MOANALUA ROAD
F.A.P. PROJECT NO. F-078-1(7)

Scale: 1" = 50' Date: April, 1971

SHEET No. 10 OF 14 SHEETS

Revised: July 10, 1971

FED. ROAD DIST. NO.	STATE	FED. AID PROJ. NO.	FISCAL YEAR	SHEET NO.	TOTAL SHEETS
HAWAII	HAW.	F-078-1(7)	1971	46	302

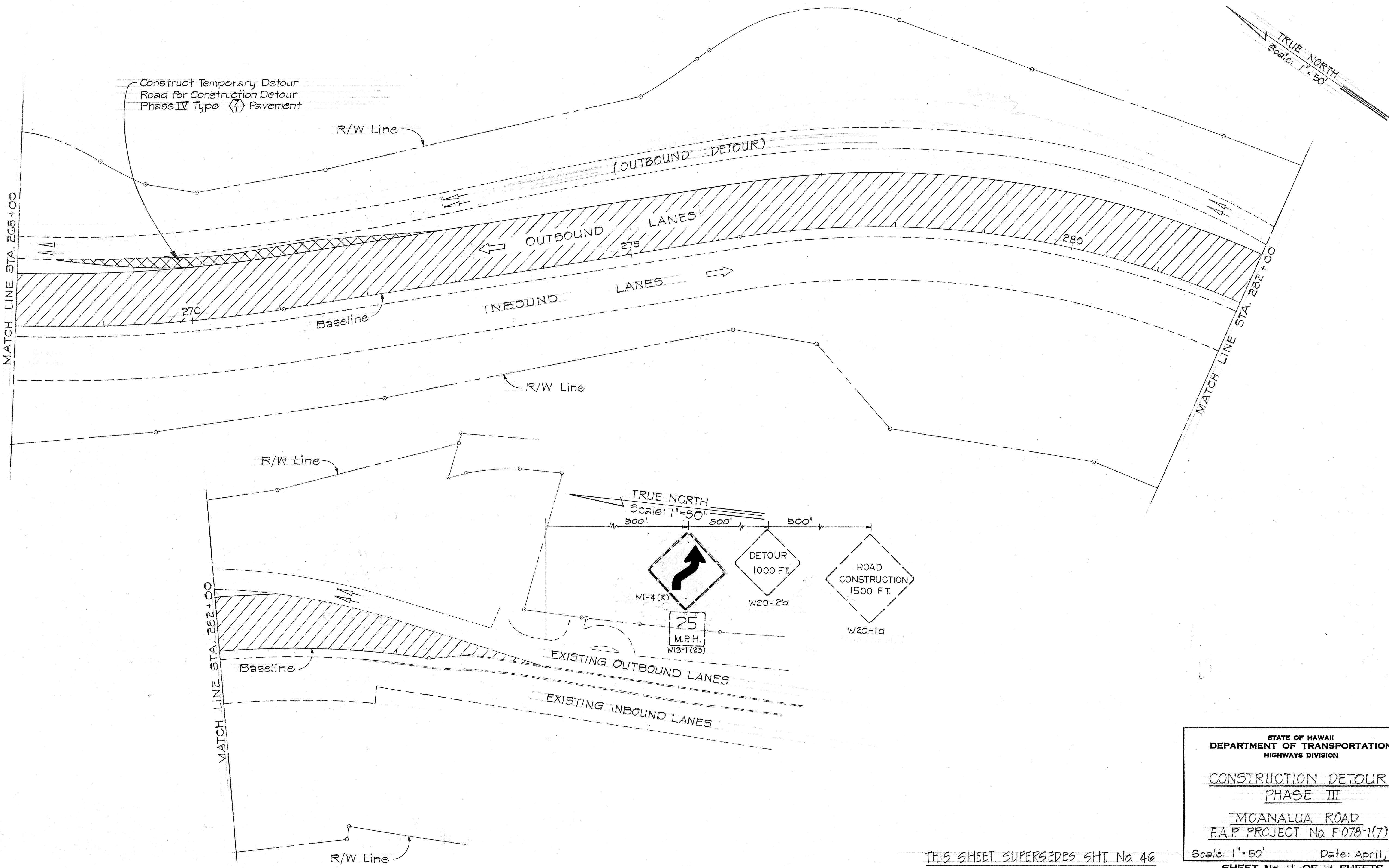

DESIGNED BY	DATE
FRAMED BY	
NOTED BY	
CHECKED BY	
ORIGINAL PLAN	
NOTE BOOK	
No.	

STATE OF HAWAII
 DEPARTMENT OF TRANSPORTATION
 HIGHWAYS DIVISION

**CONSTRUCTION DETOUR
 PHASE III**

MOANALUA ROAD
 F.A.P. PROJECT No. F-078-1(7)

Scale: 1"=50' Date: April, 1971

THIS SHEET SUPERSEDES SH. No. 46

SHEET No. 11 OF 14 SHEETS

ADD. 46

FED. ROAD DIST. NO.	STATE	FED. AID PROJ. NO.	FISCAL YEAR	SHEET NO.	TOTAL SHEETS
HAWAII	HAW.	F-078-1(7)	1971	47	302

TRUE NORTH
Scale: 1" = 50'

NOTE

The contractor shall provide one lane for local traffic at all times while constructing North Frontage Road Sta. 12+50 to 21+50.

↑ Aiea
Red Hill ↗
Existing to Remain

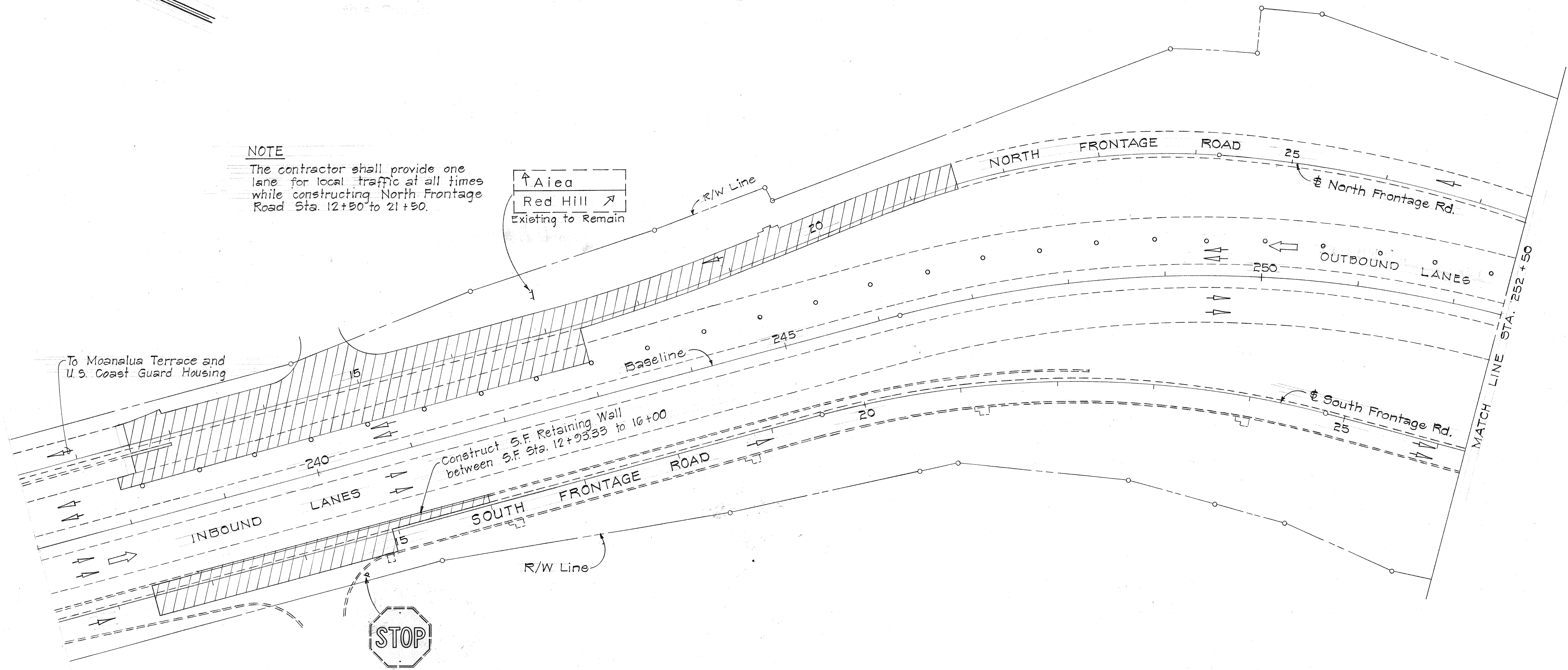

DESIGNED BY	DATE
FRAMED BY	
DESIGNED BY	
CHECKED BY	
ORIGINAL PLAN	
NOTE BOOK	
No.	

STATE OF HAWAII
DEPARTMENT OF TRANSPORTATION
HIGHWAYS DIVISION

**CONSTRUCTION DETOUR
PHASE IV**

MOANALUA ROAD
F.A.P. PROJECT No. F-078-1(7)

Scale: 1" = 50' Date: April, 1971

SHEET No. 12 OF 14 SHEETS

FED. ROAD DIST. NO.	STATE	FED. AID PROJ. NO.	FISCAL YEAR	SHEET NO.	TOTAL SHEETS
HAWAII	HAW.	F-078-1(7)	1971	48	302

TRUE NORTH
Scale: 1"=50'

NOTE:
Provide one lane for ingress and one lane for egress at all times while constructing Ala Aolani St. and North Frontage Intersection.

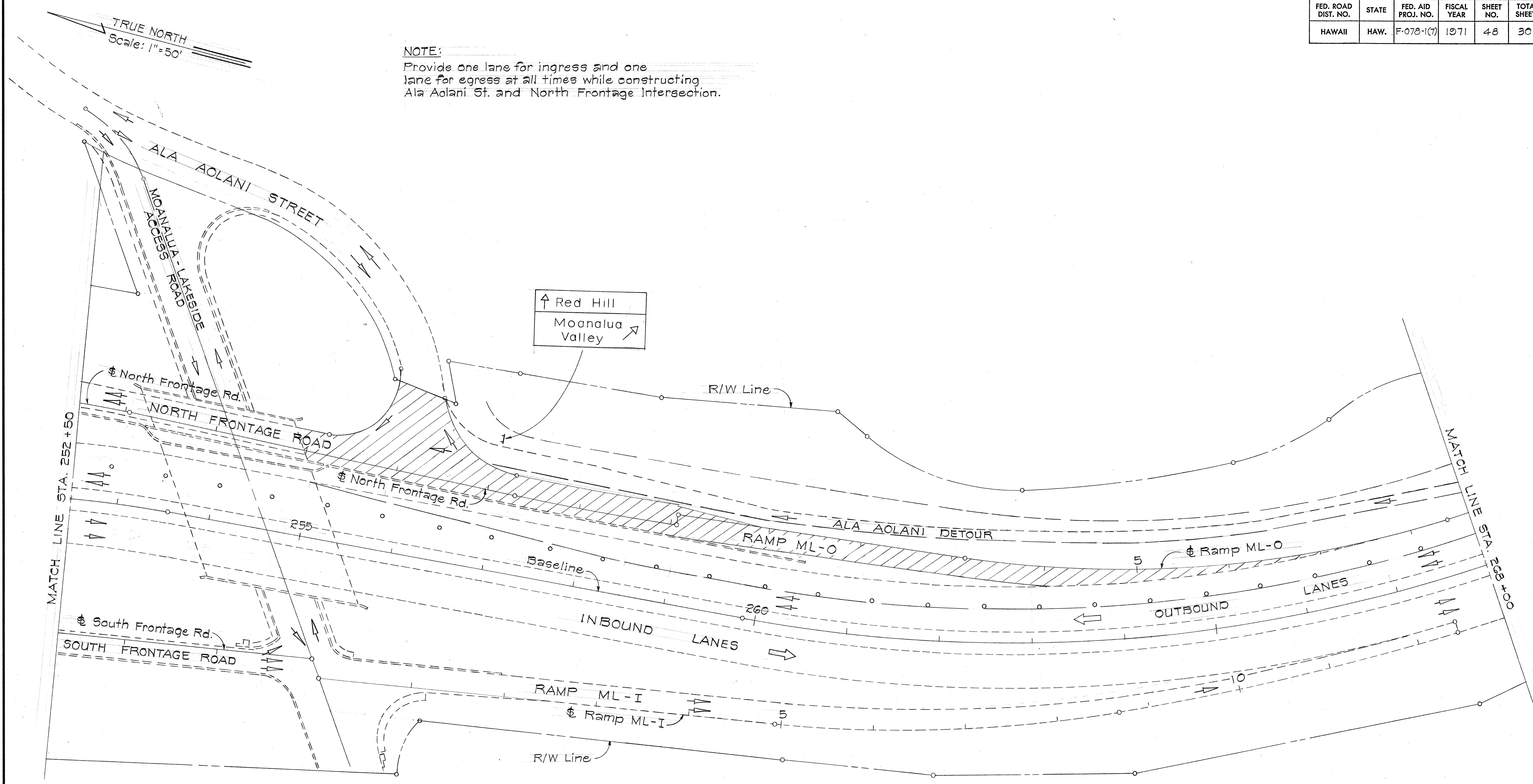

DATE
DESIGNED BY
DRAWN BY
CHECKED BY
NO.

STATE OF HAWAII
DEPARTMENT OF TRANSPORTATION
HIGHWAYS DIVISION

CONSTRUCTION DETOUR
PHASE IV

MOANALUA ROAD
F.A.P. PROJECT No. F-078-1(7)

Scale: 1"=50' Date: April, 1971

SHEET No. 13 OF 14 SHEETS

