

DATE	
BY	
CHECKED	
PLANNED	
NO. OF SHEETS	
NO. OF SHEETS CHECKED	
NO. OF SHEETS NOT CHECKED	

DATE	
BY	
CHECKED	
PLANNED	
NO. OF SHEETS	
NO. OF SHEETS CHECKED	
NO. OF SHEETS NOT CHECKED	

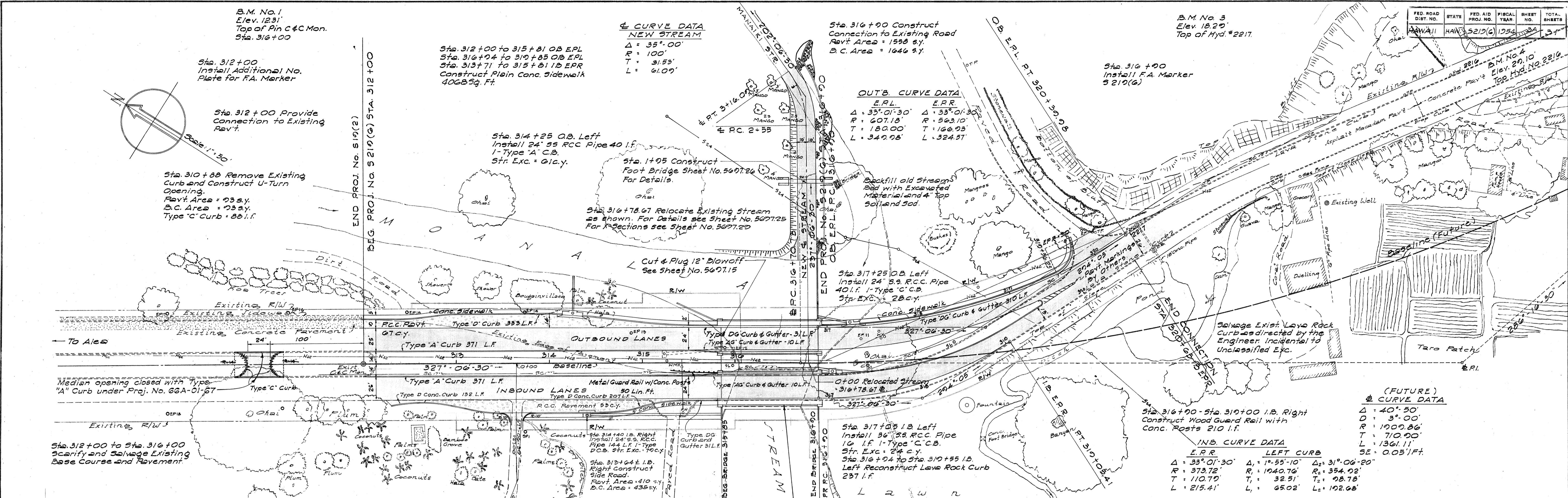

- NOTE:**
- All utilities to be moved by others.
 - Signal Corps Cable, 42" Water Main and 24" Sewer Main to remain.
 - Adjust all M.P.'s to new grades as directed by the Engineer.
 - Salvage all Lays Rock Curbs.

