

FED. ROAD DIST. NO.	STATE	PROJ. NO.	FISCAL YEAR	SHEET NO.	TOTAL SHEETS
HAWAII	HAW.	HWY-0-03-05MR	2008	5	38

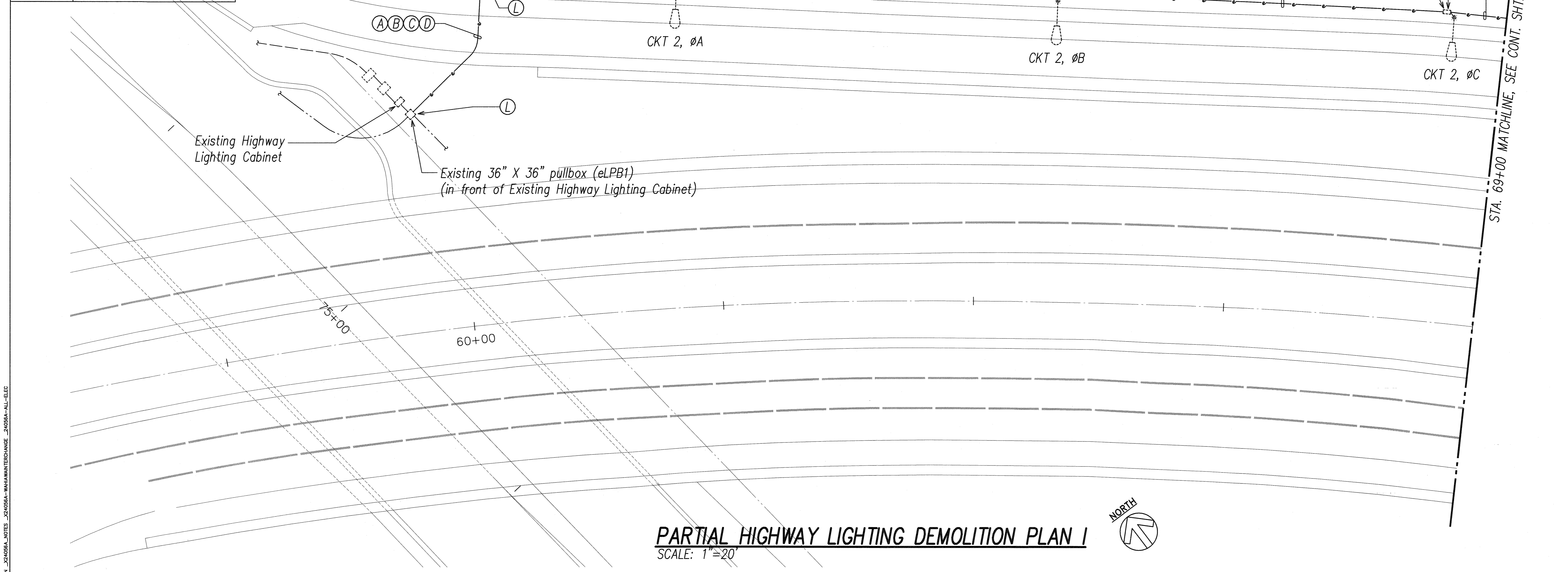
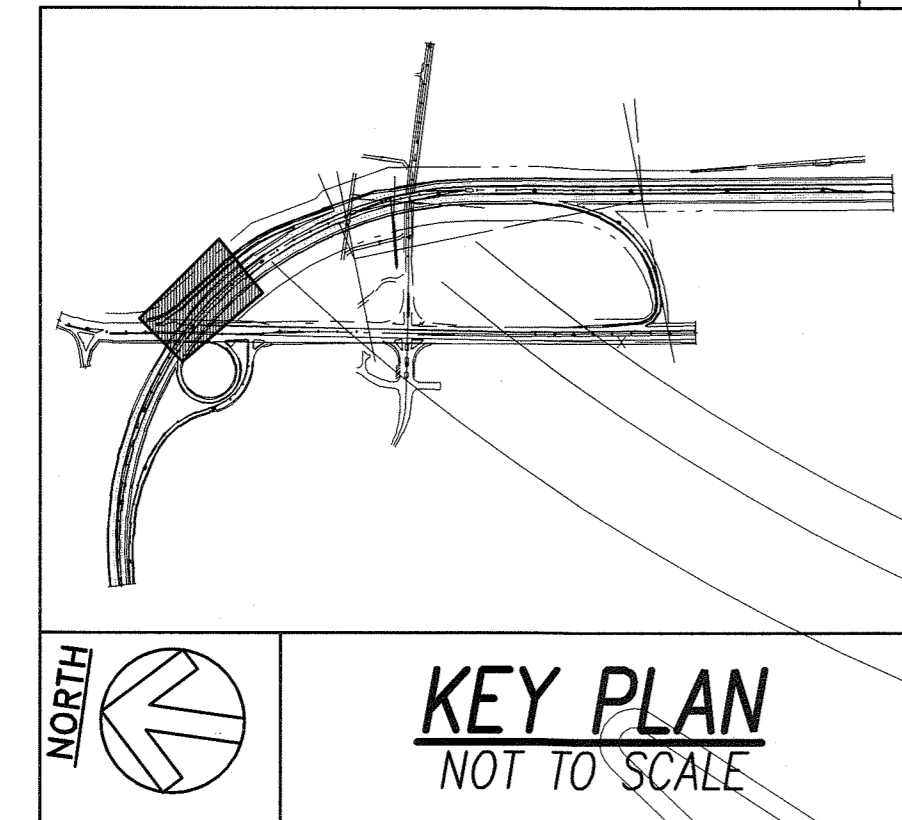

**PARTIAL HIGHWAY LIGHTING DEMOLITION PLAN I**  
SCALE: 1"=20'

**DEMOLITION PLAN NOTES**

- (A) Existing Circuit No. 1: 2" Conduit with 4#4, 1#8 Ground; Remove Conductors and Reuse Conduit.
- (B) Existing Circuit No. 2: 2" Conduit, 4#4, 1#8 Ground; Remove Conductors and Reuse Conduit.
- (C) Existing Circuit No. 4: 2" Conduit, 3#8, 1#8 Ground.
- (D) Existing Spare 2" Conduit.
- (E) Existing Circuit No. 3: 2" Conduit, 4#8, 1#8 Ground.
- (F) Existing Circuit No. 1: 2" Conduit, 4#4, 1#8 Ground; Remove Conductors and Abandon Conduit in Place.
- (G) Existing Circuit No. 2: 2" Conduit, 4#4, 1#8 Ground; Remove Conductors and Abandon Conduit in Place.
- (H) Existing Junction Box, Flush Mounted in Existing Concrete Barrier; Remove Conductors and Abandon Junction Box in Place.
- (I) Remove Existing Barrier Top Mounted Continuous Row Fluorescent Light Fixtures and All Associated Mounting Hardware; Patch Existing Concrete Barrier with Epoxy Grout, Flush with Existing Finish.
- (J) Existing Circuit to Existing Highway Sign Light to Remain and be Disconnected from Existing Circuit Conductors to Maintain Existing Circuit Continuity.
- (K) Existing Highway Lighting Concrete Pullbox to be Abandoned in Place.
- (L) Existing Highway Lighting Concrete Pullbox to Remain and be Reused.

DATE	_____
DESIGNED BY	_____
DRAWN BY	_____
CHECKED BY	_____
NOTED BY	_____
QUANTITIES BY	_____
NO.	_____

LAST SAVE: 06/03/07 @ 06:52:44 BY: AM PLT SC: 1=20  
 Z:\CAD\PROJECTS\24056A\001\_24056A.dwg  
 XREFS: X12-REV\_024056A\_KEYPLAN\_024056A\_NOTES\_024056A-WAHIAWAINTERCHANGE\_24056A-ALL-ELEC

RONALD N. S. HO & ASSOCIATES, INC.  
 Electrical Engineers  
  
 ANDREW I. MIYASATO  
 LICENSED PROFESSIONAL ENGINEER  
 No. 4340-E  
 HAWAII, U.S.A.  
 05.22.08  
 Andrew I. Miyasato  
 THIS WORK WAS PREPARED BY ME OR UNDER MY SUPERVISION  
 04.30.2008  
 EXPIRATION DATE OF THE LICENSE

STATE OF HAWAII  
 DEPARTMENT OF TRANSPORTATION  
 HIGHWAYS DIVISION  
**PARTIAL HIGHWAY LIGHTING DEMOLITION PLAN I**  
 H-2 RAIL LIGHT REPLACEMENT, VICINITY OF WAHIAWA OFF RAMP  
 Project No. HWY-0-03-05MR  
 Scale: AS NOTED Date: MAY 2008  
 SHEET No. E-4 OF 35 SHEETS

FED. ROAD DIST. NO.	STATE	PROJ. NO.	FISCAL YEAR	SHEET NO.	TOTAL SHEETS
HAWAII	HAW.	HWY-0-03-05MR	2008	6	38

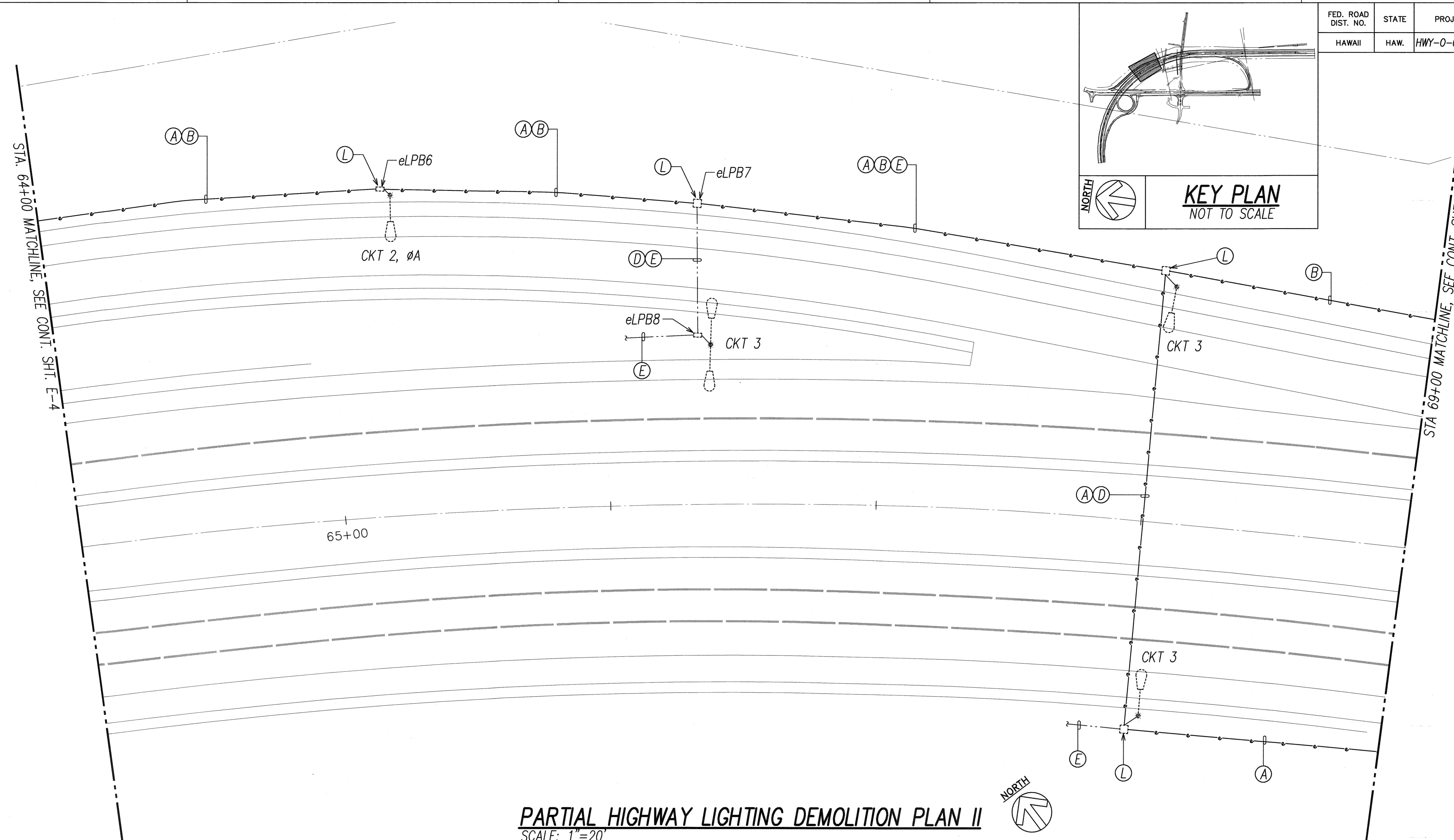
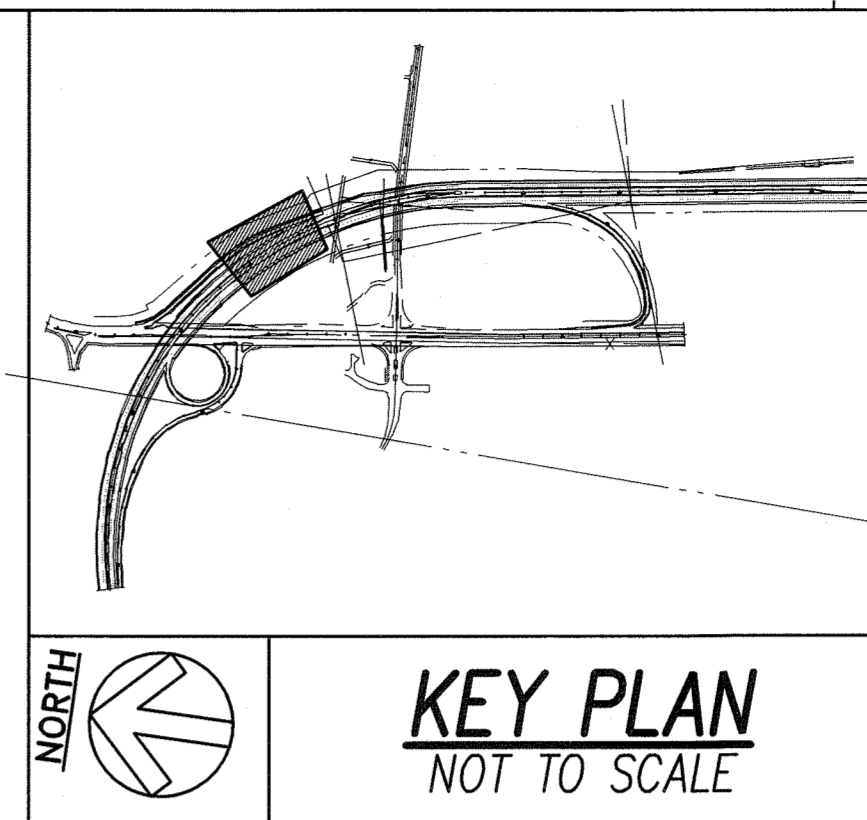

**PARTIAL HIGHWAY LIGHTING DEMOLITION PLAN II**  
SCALE: 1"=20'

**DEMOLITION PLAN NOTES**

- (A) Existing Circuit No. 1: 2" Conduit with 4#4, 1#8 Ground; Remove Conductors and Reuse Conduit.
- (B) Existing Circuit No. 2: 2" Conduit, 4#4, 1#8 Ground; Remove Conductors and Reuse Conduit.
- (C) Existing Circuit No. 4: 2" Conduit, 3#8, 1#8 Ground.
- (D) Existing Spare 2" Conduit.
- (E) Existing Circuit No. 3: 2" Conduit, 4#8, 1#8 Ground.
- (F) Existing Circuit No. 1: 2" Conduit, 4#4, 1#8 Ground; Remove Conductors and Abandon Conduit in Place.
- (G) Existing Circuit No. 2: 2" Conduit, 4#4, 1#8 Ground; Remove Conductors and Abandon Conduit in Place.
- (H) Existing Junction Box, Flush Mounted in Existing Concrete Barrier; Remove Conductors and Abandon Junction Box in Place.
- (I) Remove Existing Barrier Top Mounted Continuous Row Fluorescent Light Fixtures and All Associated Mounting Hardware; Patch Existing Concrete Barrier with Epoxy Grout, Flush with Existing Finish.
- (J) Existing Circuit to Existing Highway Sign Light to Remain and be Disconnected from Existing Circuit Conductors to Maintain Existing Circuit Continuity.
- (K) Existing Highway Lighting Concrete Pullbox to be Abandoned in Place.
- (L) Existing Highway Lighting Concrete Pullbox to Remain and be Reused.

ORIGINAL PLAN	DATE
TRACED BY	
DESIGNED BY	
CHECKED BY	
NO.	

LAST SAVE: 06/02/07 08:52:26 BY: AM PL07 SC 1:20  
 Z:\PROJECTS\2005\0505\_0506\_0507\_0508\_0509\_0510\_0511\_0512\_0513\_0514\_0515\_0516\_0517\_0518\_0519\_0520\_0521\_0522\_0523\_0524\_0525\_0526\_0527\_0528\_0529\_0530\_0531\_0532\_0533\_0534\_0535\_0536\_0537\_0538\_0539\_0540\_0541\_0542\_0543\_0544\_0545\_0546\_0547\_0548\_0549\_0550\_0551\_0552\_0553\_0554\_0555\_0556\_0557\_0558\_0559\_0560\_0561\_0562\_0563\_0564\_0565\_0566\_0567\_0568\_0569\_0570\_0571\_0572\_0573\_0574\_0575\_0576\_0577\_0578\_0579\_0580\_0581\_0582\_0583\_0584\_0585\_0586\_0587\_0588\_0589\_0590\_0591\_0592\_0593\_0594\_0595\_0596\_0597\_0598\_0599\_0600\_0601\_0602\_0603\_0604\_0605\_0606\_0607\_0608\_0609\_0610\_0611\_0612\_0613\_0614\_0615\_0616\_0617\_0618\_0619\_0620\_0621\_0622\_0623\_0624\_0625\_0626\_0627\_0628\_0629\_0630\_0631\_0632\_0633\_0634\_0635\_0636\_0637\_0638\_0639\_0640\_0641\_0642\_0643\_0644\_0645\_0646\_0647\_0648\_0649\_0650\_0651\_0652\_0653\_0654\_0655\_0656\_0657\_0658\_0659\_0660\_0661\_0662\_0663\_0664\_0665\_0666\_0667\_0668\_0669\_0670\_0671\_0672\_0673\_0674\_0675\_0676\_0677\_0678\_0679\_0680\_0681\_0682\_0683\_0684\_0685\_0686\_0687\_0688\_0689\_0690\_0691\_0692\_0693\_0694\_0695\_0696\_0697\_0698\_0699\_0700\_0701\_0702\_0703\_0704\_0705\_0706\_0707\_0708\_0709\_0710\_0711\_0712\_0713\_0714\_0715\_0716\_0717\_0718\_0719\_0720\_0721\_0722\_0723\_0724\_0725\_0726\_0727\_0728\_0729\_0730\_0731\_0732\_0733\_0734\_0735\_0736\_0737\_0738\_0739\_0740\_0741\_0742\_0743\_0744\_0745\_0746\_0747\_0748\_0749\_0750\_0751\_0752\_0753\_0754\_0755\_0756\_0757\_0758\_0759\_0760\_0761\_0762\_0763\_0764\_0765\_0766\_0767\_0768\_0769\_0770\_0771\_0772\_0773\_0774\_0775\_0776\_0777\_0778\_0779\_0780\_0781\_0782\_0783\_0784\_0785\_0786\_0787\_0788\_0789\_0790\_0791\_0792\_0793\_0794\_0795\_0796\_0797\_0798\_0799\_0800\_0801\_0802\_0803\_0804\_0805\_0806\_0807\_0808\_0809\_0810\_0811\_0812\_0813\_0814\_0815\_0816\_0817\_0818\_0819\_0820\_0821\_0822\_0823\_0824\_0825\_0826\_0827\_0828\_0829\_0830\_0831\_0832\_0833\_0834\_0835\_0836\_0837\_0838\_0839\_0840\_0841\_0842\_0843\_0844\_0845\_0846\_0847\_0848\_0849\_0850\_0851\_0852\_0853\_0854\_0855\_0856\_0857\_0858\_0859\_0860\_0861\_0862\_0863\_0864\_0865\_0866\_0867\_0868\_0869\_0870\_0871\_0872\_0873\_0874\_0875\_0876\_0877\_0878\_0879\_0880\_0881\_0882\_0883\_0884\_0885\_0886\_0887\_0888\_0889\_0890\_0891\_0892\_0893\_0894\_0895\_0896\_0897\_0898\_0899\_0900\_0901\_0902\_0903\_0904\_0905\_0906\_0907\_0908\_0909\_0910\_0911\_0912\_0913\_0914\_0915\_0916\_0917\_0918\_0919\_0920\_0921\_0922\_0923\_0924\_0925\_0926\_0927\_0928\_0929\_0930\_0931\_0932\_0933\_0934\_0935\_0936\_0937\_0938\_0939\_0940\_0941\_0942\_0943\_0944\_0945\_0946\_0947\_0948\_0949\_0950\_0951\_0952\_0953\_0954\_0955\_0956\_0957\_0958\_0959\_0960\_0961\_0962\_0963\_0964\_0965\_0966\_0967\_0968\_0969\_0970\_0971\_0972\_0973\_0974\_0975\_0976\_0977\_0978\_0979\_0980\_0981\_0982\_0983\_0984\_0985\_0986\_0987\_0988\_0989\_0990\_0991\_0992\_0993\_0994\_0995\_0996\_0997\_0998\_0999\_1000

RONALD N. S. HO & ASSOCIATES, INC.  
Electrical Engineers

05.22.08  
Andrew L. Miyasato  
THIS WORK WAS PREPARED BY ME OR UNDER MY SUPERVISION  
04.30.2008  
EXPIRATION DATE OF THE LICENSE

STATE OF HAWAII  
DEPARTMENT OF TRANSPORTATION  
HIGHWAYS DIVISION

**PARTIAL HIGHWAY LIGHTING  
DEMOLITION PLAN II**

H-2 RAIL LIGHT REPLACEMENT,  
VICINITY OF WAHIAWA OFF RAMP

Project No. HWY-0-03-05MR  
Scale: AS NOTED Date: MAY 2008

SHEET No. E-5 OF 35 SHEETS

FED. ROAD DIST. NO.	STATE	PROJ. NO.	FISCAL YEAR	SHEET NO.	TOTAL SHEETS
HAWAII	HAW.	HWY-0-03-05MR	2008	7	38

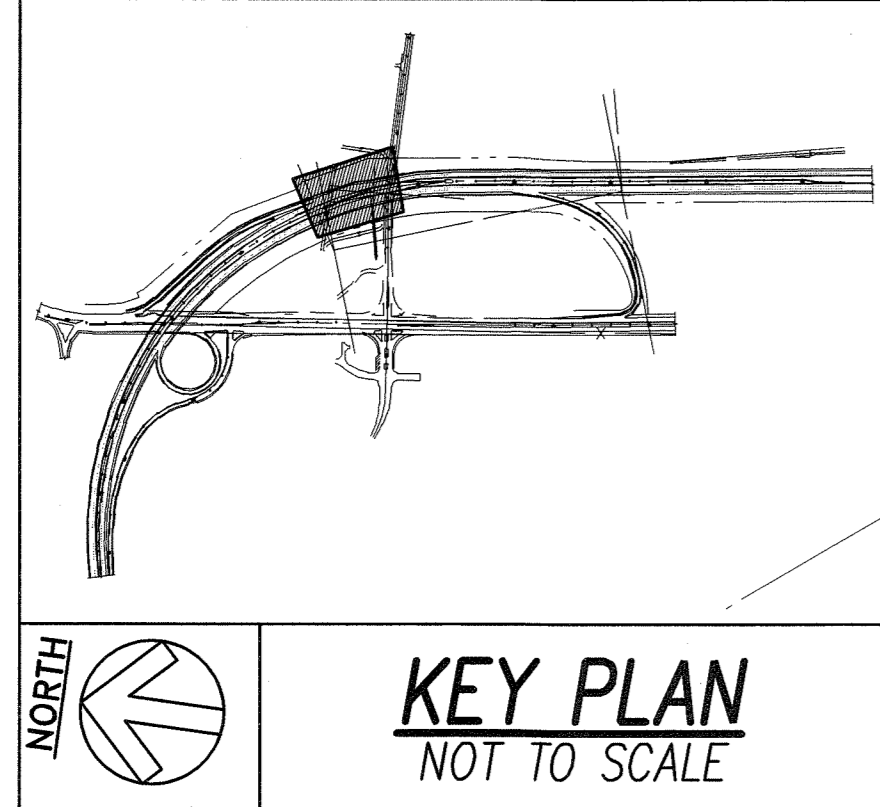

MATCHLINE STA. 69+00, SEE CONT. SHT. E-5

MATCHLINE STA. 74+00, SEE CONT. SHT. E-7

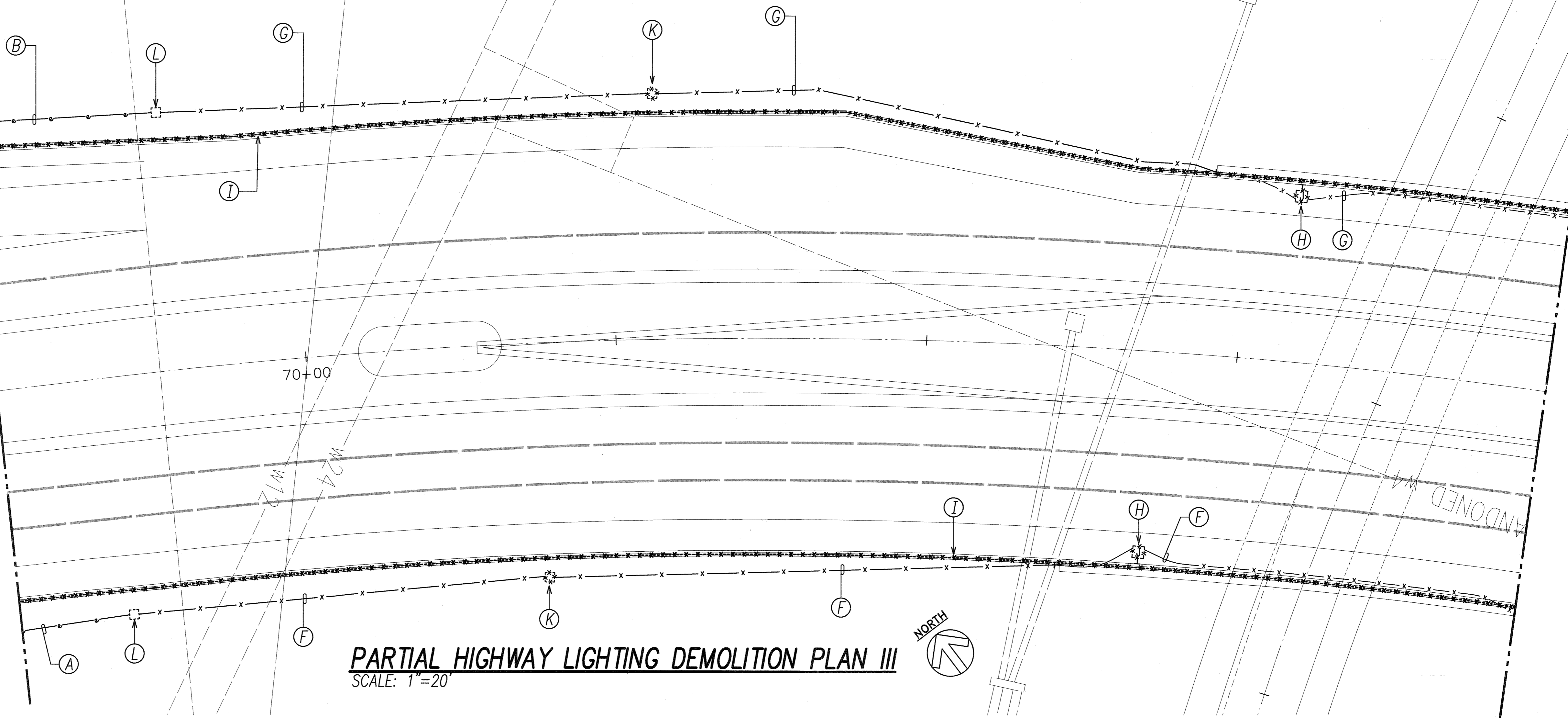

**PARTIAL HIGHWAY LIGHTING DEMOLITION PLAN III**  
SCALE: 1"=20'

DEMOLITION PLAN NOTES

- (A) Existing Circuit No. 1: 2" Conduit with 4#4, 1#8 Ground; Remove Conductors and Reuse Conduit.
- (B) Existing Circuit No. 2: 2" Conduit, 4#4, 1#8 Ground; Remove Conductors and Reuse Conduit.
- (C) Existing Circuit No. 4: 2" Conduit, 3#8, 1#8 Ground.
- (D) Existing Spare 2" Conduit.
- (E) Existing Circuit No. 3: 2" Conduit, 4#8, 1#8 Ground.
- (F) Existing Circuit No. 1: 2" Conduit, 4#4, 1#8 Ground; Remove Conductors and Abandon Conduit in Place.
- (G) Existing Circuit No. 2: 2" Conduit, 4#4, 1#8 Ground; Remove Conductors and Abandon Conduit in Place.
- (H) Existing Junction Box, Flush Mounted in Existing Concrete Barrier; Remove Conductors and Abandon Junction Box in Place.
- (I) Remove Existing Barrier Top Mounted Continuous Row Fluorescent Light Fixtures and All Associated Mounting Hardware; Patch Existing Concrete Barrier with Epoxy Grout, Flush with Existing Finish.
- (J) Existing Circuit to Existing Highway Sign Light to Remain and be Disconnected from Existing Circuit Conductors to Maintain Existing Circuit Continuity.
- (K) Existing Highway Lighting Concrete Pullbox to be Abandoned in Place.
- (L) Existing Highway Lighting Concrete Pullbox to Remain and be Reused.

DATE	BY

ORIGINAL PLAN  
DESIGNED BY  
TRACED BY  
NOTE BOOK  
DESIGNED BY  
QUANTITIES BY  
CHECKED BY

LAST SAVE: 05/03/07 @ 06:53:10 BY: AM PLT SC 1=20  
Z:\CAD\PROJECTS\24056A\008\_24056A.dwg hwy plan REFS: 012-REV \_24056A-MAIN\INTERCHANGE \_24056A-ALL-ELEC

RONALD N. S. HO & ASSOCIATES, INC.  
Electrical Engineers  
**ANDREW L. MIYABE**  
LICENSED PROFESSIONAL ENGINEER  
No. 4340-E  
HAWAII, U.S.A.  
05.22.08  
Andrew L. Miyabe  
THIS WORK WAS PREPARED BY ME OR UNDER MY SUPERVISION  
04.30.2008  
EXPIRATION DATE OF THE LICENSE

STATE OF HAWAII  
DEPARTMENT OF TRANSPORTATION  
HIGHWAYS DIVISION  
**PARTIAL HIGHWAY LIGHTING  
DEMOLITION PLAN III**  
H-2 RAIL LIGHT REPLACEMENT,  
VICINITY OF WAHIAWA OFF RAMP  
Project No. HWY-0-03-05MR  
Scale: AS NOTED Date: MAY 2008  
SHEET No. E-6 OF 35 SHEETS



FED. ROAD DIST. NO.	STATE	PROJ. NO.	FISCAL YEAR	SHEET NO.	TOTAL SHEETS
HAWAII	HAW.	HWY-0-03-05MR	2008	9	38

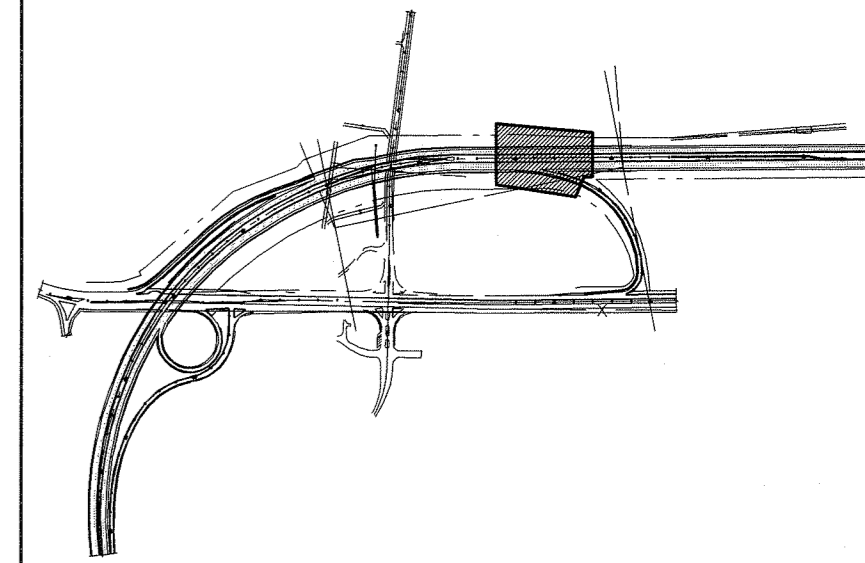

**KEY PLAN**  
NOT TO SCALE

MATCHLINE STA. 79+00, SEE CONT. SHT. E-7

MATCHLINE STA. 84+00, SEE CONT. SHT. E-9

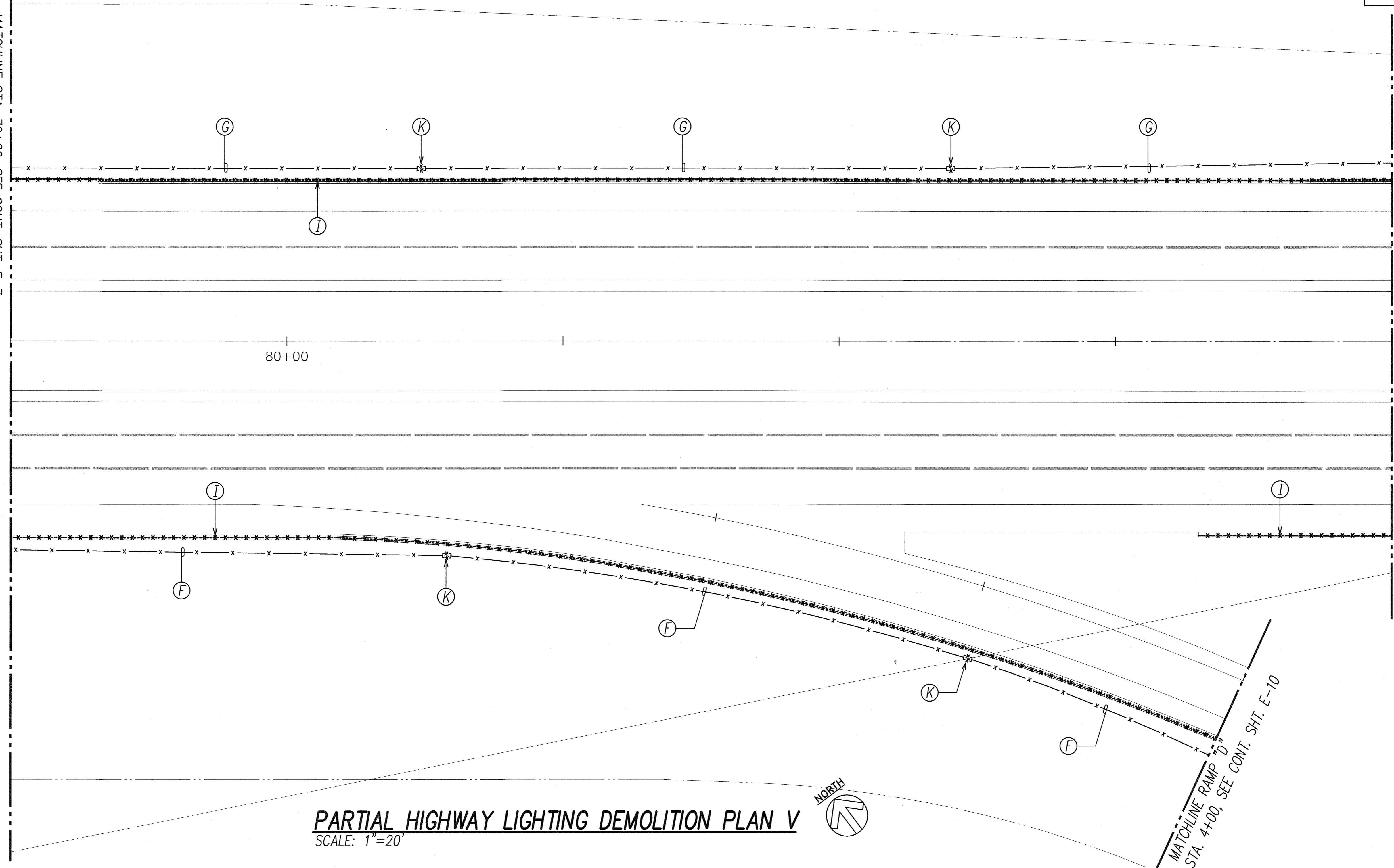

**PARTIAL HIGHWAY LIGHTING DEMOLITION PLAN V**  
SCALE: 1"=20'

DEMOLITION PLAN NOTES

- |  |  |  |
|--|--|--|
| <ul style="list-style-type: none"> <li>(A) Existing Circuit No. 1: 2" Conduit with 4#4, 1#8 Ground; Remove Conductors and Reuse Conduit.</li> <li>(B) Existing Circuit No. 2: 2" Conduit, 4#4, 1#8 Ground; Remove Conductors and Reuse Conduit.</li> <li>(C) Existing Circuit No. 4: 2" Conduit, 3#8, 1#8 Ground.</li> <li>(D) Existing Spare 2" Conduit.</li> <li>(E) Existing Circuit No. 3: 2" Conduit, 4#8, 1#8 Ground.</li> <li>(F) Existing Circuit No. 1: 2" Conduit, 4#4, 1#8 Ground; Remove Conductors and Abandon Conduit in Place.</li> </ul> | <ul style="list-style-type: none"> <li>(G) Existing Circuit No. 2: 2" Conduit, 4#4, 1#8 Ground; Remove Conductors and Abandon Conduit in Place.</li> <li>(H) Existing Junction Box, Flush Mounted in Existing Concrete Barrier; Remove Conductors and Abandon Junction Box in Place.</li> <li>(I) Remove Existing Barrier Top Mounted Continuous Row Fluorescent Light Fixtures and All Associated Mounting Hardware; Patch Existing Concrete Barrier with Epoxy Grout, Flush with Existing Finish.</li> </ul> | <ul style="list-style-type: none"> <li>(J) Existing Circuit to Existing Highway Sign Light to Remain and be Disconnected from Existing Circuit Conductors to Maintain Existing Circuit Continuity.</li> <li>(K) Existing Highway Lighting Concrete Pullbox to be Abandoned in Place.</li> <li>(L) Existing Highway Lighting Concrete Pullbox to Remain and be Reused.</li> </ul> |
|--|--|--|

DATE	_____
DESIGNED BY	_____
DRAWN BY	_____
CHECKED BY	_____
NO.	_____

LAST SAVE: 05/03/07 @ 05:53:45 BY: AM PLT SC 1=20  
Z:\CAD\PROJECTS\24056A\08\_24056A.dwg Plot: V PREP: 02-REV \_24056A\_DETMAN \_24056A-ALL-ELEC

RONALD N. S. HO & ASSOCIATES, INC.  
Electrical Engineers  
**ANDREW L. MIYAKI**  
LICENSED PROFESSIONAL ENGINEER  
No. 4340-E  
HAWAII, U.S.A.  
05.22.08  
THIS WORK WAS PREPARED BY ME OR UNDER MY SUPERVISION  
04.30.2008  
EXPIRATION DATE OF THE LICENSE

STATE OF HAWAII  
DEPARTMENT OF TRANSPORTATION  
HIGHWAYS DIVISION  
**PARTIAL HIGHWAY LIGHTING  
DEMOLITION PLAN V**  
H-2 RAIL LIGHT REPLACEMENT,  
VICINITY OF WAHIAWA OFF RAMP  
Project No. HWY-0-03-05MR  
Scale: AS NOTED Date: MAY 2008  
SHEET No. E-8 OF 35 SHEETS





