

| | | | | | |
|---------------------|-------|-------------|-------------|-----------|--------------|
| FED. ROAD DIST. NO. | STATE | PROJ. NO. | FISCAL YEAR | SHEET NO. | TOTAL SHEETS |
| HAWAII | HAW. | HWY-0-08-14 | 2016 | 50 | 88 |

PLANT NOTES

1.

Landscape Contractor shall field verify all plant quantities and dimensions prior to installation. Quantities shown on the plant list are for reference only. Verify actual quantites as shown on plan. If there is a discrepancy, the Planting Plan shall take precedence.
2.

Landscape Contractor shall be responsible for locating and protecting existing utilities.
3.

Do not plant until ground has been prepared and free of stones greater than 1/2 inch diameter, site is neat, orderly, and the Engineer accepts the site for planting.
4.

Notify Engineer of any discrepancies in plant locations or insufficient plant quantities due to difference in plans and actual field conditions.
5.

Notify Engineer 30 days prior to planting operations for approval of all plant material at place of growth. All plant material not approved by the Engineer will be subject to rejection.
6.

Engineer will inspect plants at the place of growth and after the delivery to the project.
7.

Plants shall meet size indicated by minimum height and spread. Plants shall be straight and uniformly shaped, unless unique or special characteristics are specified, and shall be undamaged, sound, healthy, vigorous and free of disease and insect infestation. Plants not conforming to these requirements on delivery to the project and at the end of the plant establishment period will be rejected.
8.

Contractor shall be solely responsible for the complete removal and damages resulting from the introduction of planting any plant species listed on the Hawaii Department of Agriculture 'Noxious Weed Rules' as defined in the statute, Hawaii Administrative Rules 4:68:1 or the 'Federal Noxious Weed List' as defined in Title 7 of the Code of Federal Regulations (CFR), Parts 360 and 361.
9.

All tree work must adhere to American National Standard Institute (ANSI) A300 Tree Care Standards and ANSI-Z133 Safety Standards for Tree Work. Work shall be contracted to arborists that have been certified in good standings as an ISA Certified Arborist for at least 10 years to assure that tree work is performed properly and trees are not damaged by practices such as topping, flush cuts, over-thinning, or climbing with spikes. Contractor shall submit a copy of the ISA Arborist Certification of good standing of 10 years to the Engineer a minimum of 7 days prior to the tree pruning.
10.

For the duration of construction within the drip line of trees to remain, there must be: No changes, alterations or disturbance to the grade by adding fill, excavating or scraping except as notes on plans; No storage of construction material or equipment; No stockpiling of any construction material or any excavated material; No disposal of any liquids (e.g. concrete sleuth, gas, oil, paint); No vehicular traffic, equipment or excessive pedestrian traffic; No attachment of any wires, ropes, lights, or any other such attachment other than those of protective nature to any tree to be preserved; and No cleaning of equipment or material under the canopy of any tree or group of trees to remain.
11.

If trees other than those specifically designated for removal are damaged beyond survival conditions as determined by Engineer, the Contractor shall remove such trees and replace the tree with the same specie and size and maintain for the duration of construction or 12 months, whichever is greater at no cost to the State.
12.

Representative Soil samples from project site shall be submitted to labs as stated in Section 617 of the Special Provisions. Test results and fertilization schedule shall be presented to the Engineer for review and acceptance before placing planting soil. Uniformly distribute fertilizer and amendments over planting areas as recommended by the soil analysis report. Rototill top four to six inches of soil to evenly incorporate fertilizer and amendments. After completion of soil amendments, retest to meet soil analysis, continue amending until test meets soil test recommendations. Provide copies of all soil test to the Engineer.
13.

Guy wires, flagging, stakes, windbreakers, etc. shall be maintained and replaced if necessary by the Contractor until the tree or shrub is able to stand by itself. Contractor shall remove and dispose at the end of plant establishment period.
14.

Any planting that obstructs sight distance, signs or traffic lights shall be relocated or removed as determined by the Engineer.

PLANT LIST (EXAMINATION SITE)

| QUANTITY | COMMON NAME | BOTANICAL NAME | DESCRIPTION |
|--------------------|------------------|---------------------|---|
| 14,830 square feet | Common Bermuda | Cynodon dactylon | seeded at a rate of 10 lbs per 1,000 square feet |
| 970 each | Mau'u Akiaki | Fimbristylis cymosa | 4 rows; 4" pots @ 12" o.c. staggered spacing between rows |
| 1,900 square feet | Wood chip mulch | | 2" layer in planting bed surrounding Mau'u akiaki |
| 15,800 square feet | Soil Preparation | | Planter Mix "A" under Mau'u akiaki areas |
| 14,830 square feet | Hydro-mulch cap | | Over all common bermuda seed areas |
| 500 linear feet | Plastic header | | Olyola Black Jack 5" Landscape Edging or Approved Equal |

PLANT LIST (OFFICE)

| QUANTITY | COMMON NAME | BOTANICAL NAME | DESCRIPTION |
|-----------------|------------------|----------------|--|
| 74 each | Dwarf Pink Ixora | Ixora spp. | 1 gallon @ 18" o.c. 12" height, 6" spread |
| 720 square feet | Wood chip mulch | | 2" layer in planting bed surrounding dwarf Ixora |
| 150 square feet | Soil Preparation | | |

STATE OF HAWAII
DEPARTMENT OF TRANSPORTATION
HIGHWAYS DIVISION

PLANT LIST & NOTES
COMMERCIAL DRIVER'S LICENSE AND
MOTORCYCLE LICENSE TESTING FACILITY
EXAMINATION SITE AND OFFICE RENOVATION
Beneath Interstate Route H-1 Pearl City Viaduct
Project No. HWY-0-08-14
Date: May 2016

SHEET No. 11 OF 3 SHEETS

| | | |
|------------------|---------------|------|
| ORIGINAL PLAN | DESIGNED BY | DATE |
| | DRAWN BY | |
| | CHECKED BY | |
| | NOTED BY | |
| NOTE BOOK | QUANTITIES BY | |
| N. | CHECKED BY | |

| FED. ROAD DIST. NO. | STATE | PROJ. NO. | FISCAL YEAR | SHEET NO. | TOTAL SHEETS |
|---------------------|-------|-------------|-------------|-----------|--------------|
| HAWAII | HAW. | HWY-0-08-14 | 2016 | 51 | 88 |

Notes:

- Top of root ball to be set at one-quarter inch above finish grade.
- Prior to mulching, lightly tamp soil around the root ball in 6" lifts to brace shrub. Do not over compact. When the planting hole has been backfilled, pour water around the root ball to settle the soil.

4" high x 8" wide soil berm above and surrounding root ball surface; berm shall begin at root ball periphery

2" layer mulch; no more than 1" of mulch on top of root ball

finish grade

Backfill mix:
1 part soil amendments
4 parts planting soil

Bottom of root ball rests on existing or recompacted soil

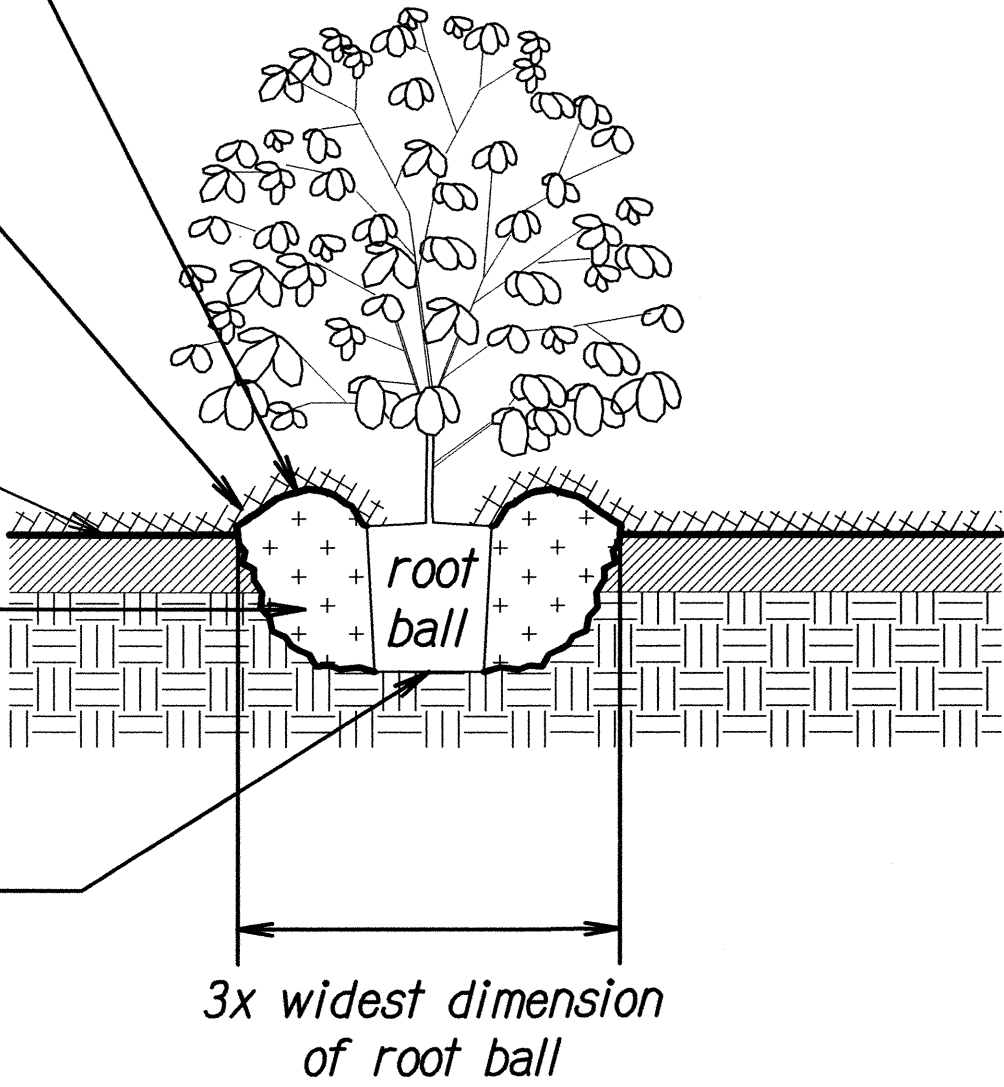

3 SHRUB PLANTING DETAIL
Not to scale

Notes:

- Scarify root ball; roots on the periphery can be removed at the time of planting.
- Top of root ball to be set at one-quarter inch above finish grade.
- Puddle and settle soil around root ball of each ground cover prior to mulching.

2" layer mulch; no more than 1" of mulch on top of root ball

Finish grade

Planting Mix "A",
12" depth, see Special Provisions Section 617

existing subgrade

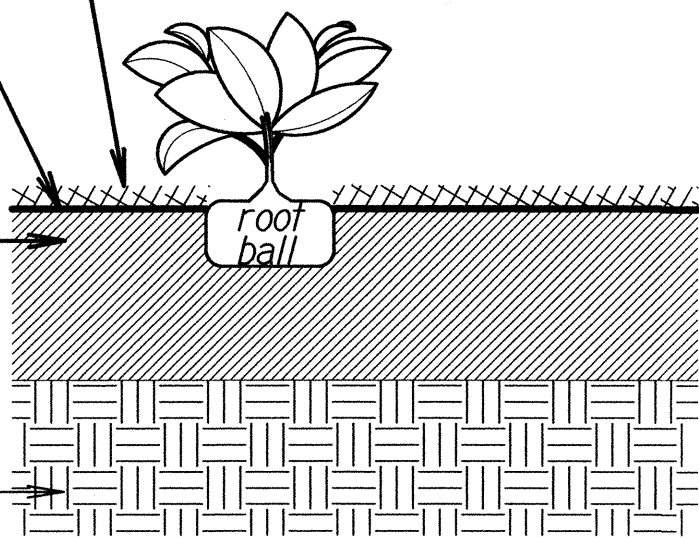

2 GROUND COVER PLANTING DETAIL
Not to scale

Note:

S = spacing, refer to Plant List for length of spacing

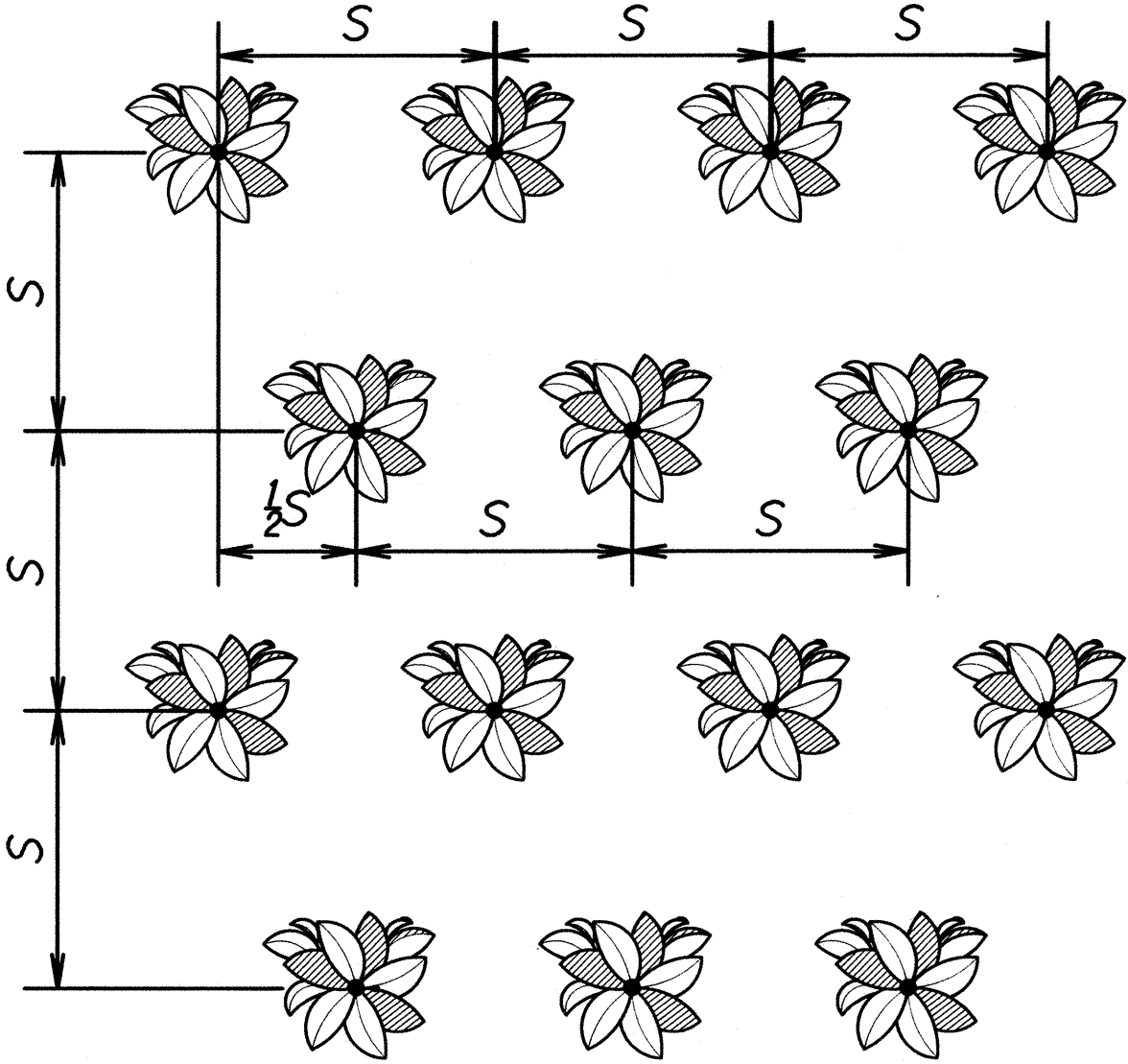

1 STAGGERED SPACING DETAIL
Not to scale

| | | |
|---------------|-------------------|------|
| ORIGINAL PLAN | SURVEY PLOTTED BY | DATE |
| NOTE BOOK | DRAWN BY | |
| | TRACED BY | |
| | DESIGNED BY | |
| | QUANTITIES BY | |
| | CHECKED BY | |

STATE OF HAWAII
DEPARTMENT OF TRANSPORTATION
HIGHWAYS DIVISION

PLANT DETAILS
COMMERCIAL DRIVER'S LICENSE AND
MOTORCYCLE LICENSE TESTING FACILITY
EXAMINATION SITE AND OFFICE RENOVATION
Beneath Interstate Route H-1 Pearl City Viaduct
Project No. HWY-0-08-14

Scale: Not to Scale
Date: May 2016

SHEET No. L2 OF 3 SHEETS

| FED. ROAD DIST. NO. | STATE | PROJ. NO. | FISCAL YEAR | SHEET NO. | TOTAL SHEETS |
|---------------------|-------|-------------|-------------|-----------|--------------|
| HAWAII | HAW. | HWY-0-08-14 | 2016 | 52 | 88 |

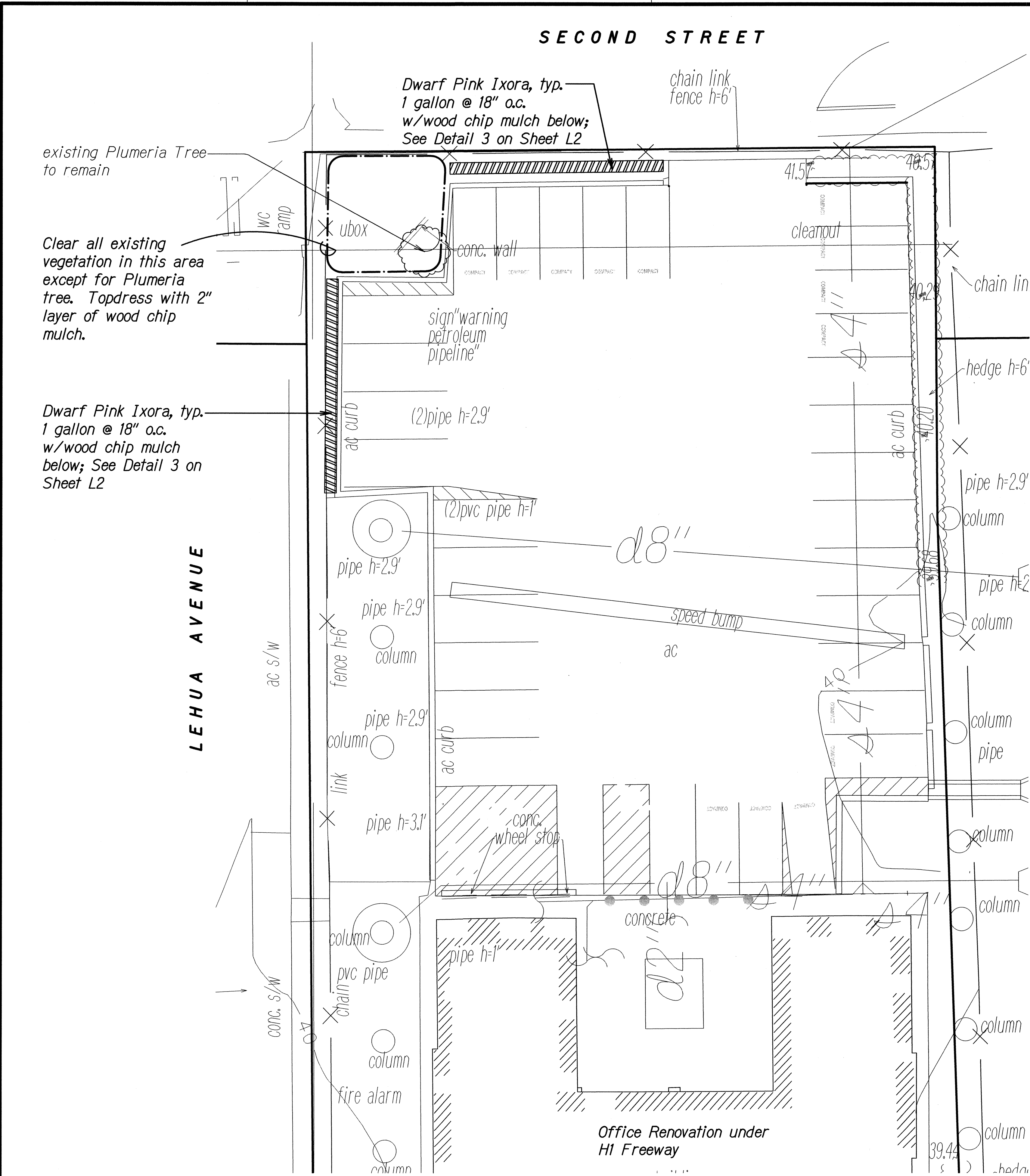

Note: Clear all existing vegetation, including existing trees, where new plantings are specified. For existing trees to be removed, grind down stump to finish grade.

OFFICE PLANTING PLAN

Scale: 1" = 20'-0"

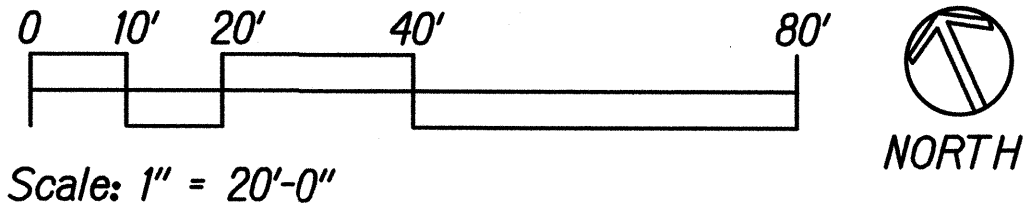

STATE OF HAWAII
DEPARTMENT OF TRANSPORTATION
HIGHWAYS DIVISION

OFFICE PLANTING PLAN
COMMERCIAL DRIVER'S LICENSE AND
MOTORCYCLE LICENSE TESTING FACILITY
EXAMINATION SITE AND OFFICE RENOVATION
Beneath Interstate Route H-1 Pearl City Viaduct
Project No. HWY-0-08-14
Scale: 1" = 20'-0" Date: May 2016

SHEET No. L3 OF 3 SHEETS

| | | |
|---------------|-------------------|------|
| ORIGINAL PLAN | SURVEY PLOTTED BY | DATE |
| NOTE BOOK | DRAWN BY | |
| | DESIGNED BY | |
| | QUANTITIES BY | |
| | CHECKED BY | |

| FED. ROAD DIST. NO. | STATE | PROJ. NO. | FISCAL YEAR | SHEET NO. | TOTAL SHEETS |
|---------------------|-------|-------------|-------------|-------------|--------------|
| HAWAII | HAW. | HWY-0-08-14 | 2016 | ADD. 52 S-1 | 88 |

TEMPORARY IRRIGATION NOTES:

- Support new planting with existing irrigation system or install above grade temporary irrigation system.
- If installing an above grade temporary irrigation system, point of connection shall be after the reduced pressure backflow preventer. See Detail 1 on this sheet.
- All temporary irrigation materials shall be removed from site after final acceptance of the new plantings.
- Existing water meters, valves, and irrigation point of connection are derived from the best available information and on-site inspection. Contractor shall verify those points of connection noted and report any discrepancies to the Engineer.
- Contractor shall secure all necessary permits and observe all local codes and regulations.
- Install sprinkler heads minimum 6" away from sidewalks, curbs, driveways, pavement and walls unless otherwise noted.
- Within 30 calendar days after notice to proceed of the contract, submit for the Engineer's acceptance detailed scaled drawings and wiring diagrams for the temporary irrigation systems. Submit product literature of the materials being used.

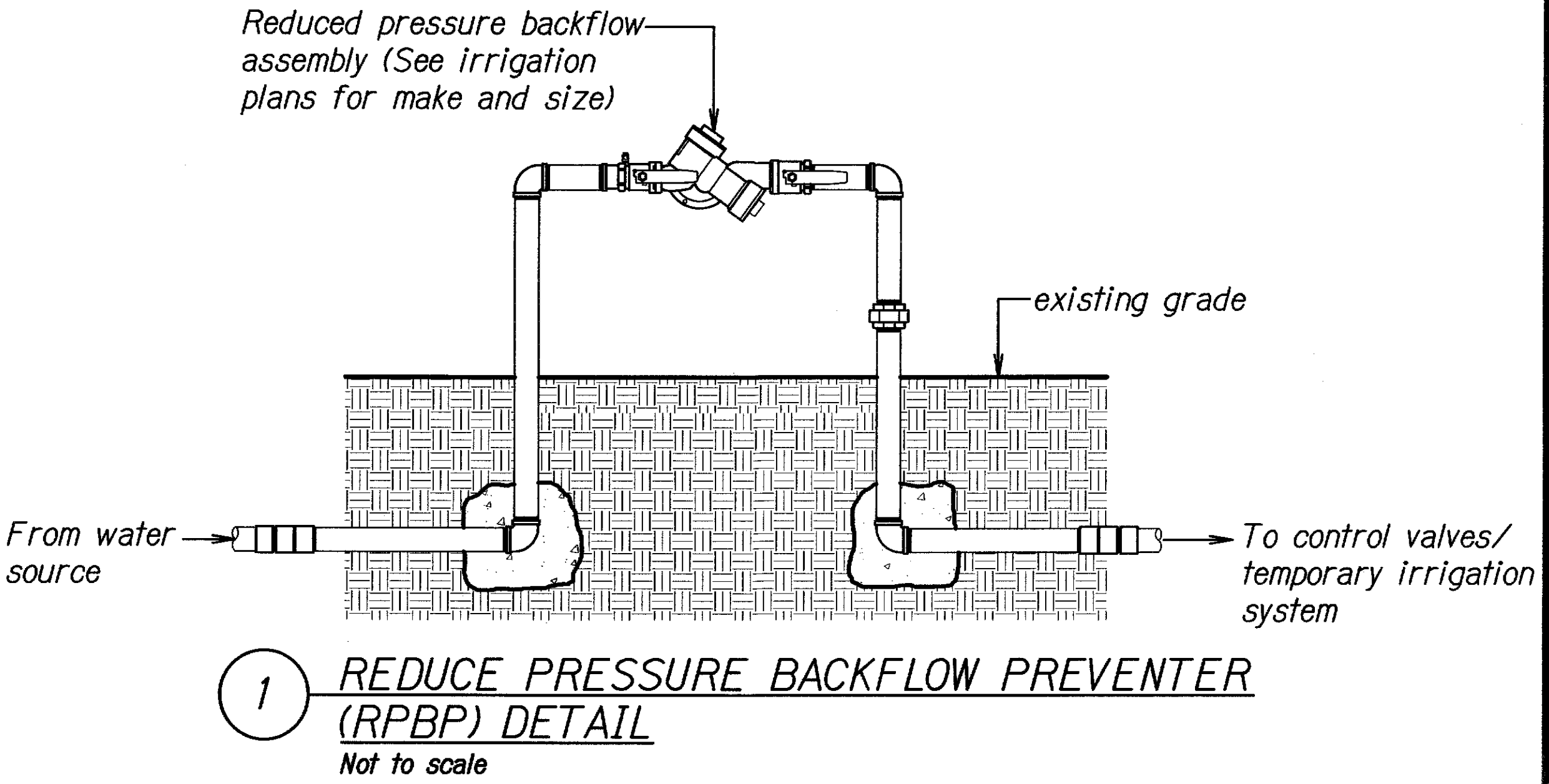

| 6/2/16 | Added sheet. |
|---|--------------|
| DATE | REVISION |
| STATE OF HAWAII DEPARTMENT OF TRANSPORTATION HIGHWAYS DIVISION OFFICE PLANTING PLAN COMMERCIAL DRIVER'S LICENSE AND MOTORCYCLE LICENSE TESTING FACILITY EXAMINATION SITE AND OFFICE RENOVATION Beneath Interstate Route H-1 Pearl City Viaduct Project No. HWY-0-08-14 Scale: 1" = 10'-0" Date: May 2016 | |
| SHEET No. L3A OF 3 SHEETS | |

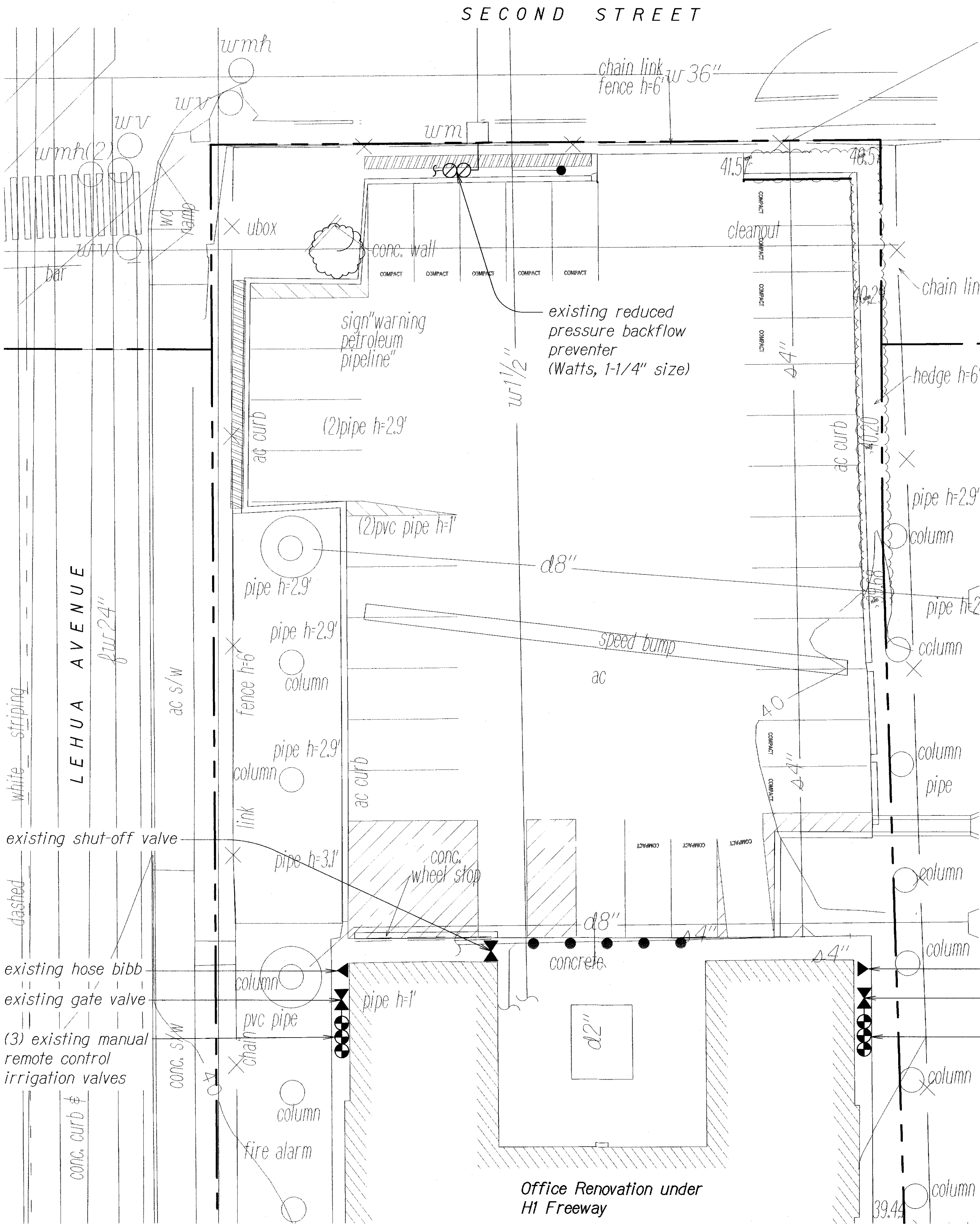

OFFICE EXISTING IRRIGATION PLAN

Scale: 1" = 10'-0"

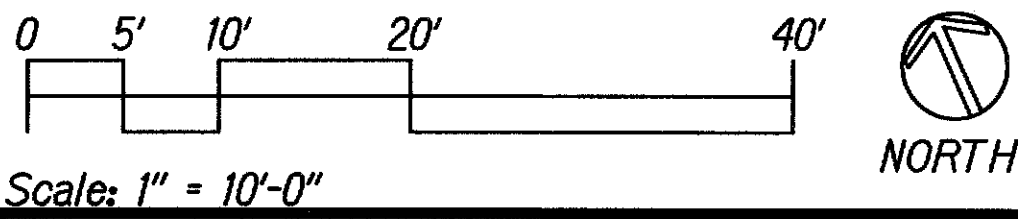

| | | |
|---------------|-------------------|------|
| ORIGINAL PLAN | SURVEY PLOTTED BY | DATE |
| DRAWN BY | | |
| TRACED BY | | |
| NOTE BOOK | | |
| DESIGNED BY | | |
| CHECKED BY | | |
| | | |