

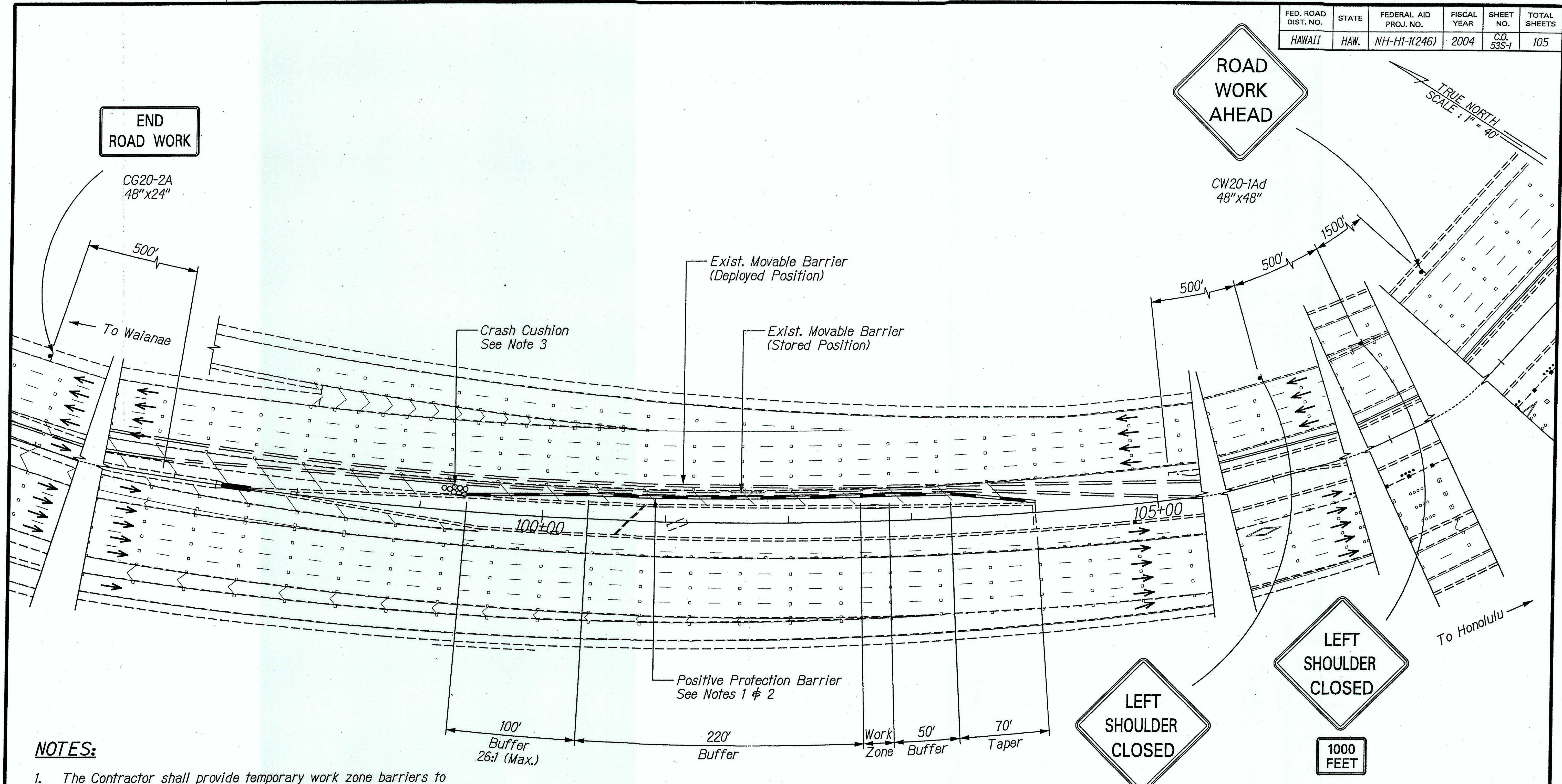



FED. ROAD DIST. NO.	STATE	FEDERAL AID PROJ. NO.	FISCAL YEAR	SHEET NO.	TOTAL SHEETS
HAWAII	HAW.	NH-H1-1(246)	2004	C.O. 53S-1	105



# **NOTES:**

1. The Contractor shall provide temporary work zone barriers to provide positive protection between the work area and adjacent travel lanes. The barriers shall meet NCHRP 350 Standards and be approved by the Engineer. Payment shall be considered incidental to the various items of the Contract.
2. The Contractor shall install steady-burn warning lights mounted on the positive protection barrier at 20' o.c. Payment shall be considered incidental to the various contract items.
3. Crash Cushions shall be appropriate for the Positive Protection Barrier System selected by the Contractor and approved by the barrier Manufacturer. The end treatments shall meet NCHRP 350 Standards and be approved by the Engineer. Payment shall be incidental to the various items of the Contract.

DESIGNED BY	DATE
DRAWN BY	
CHECKED BY	
IN CHARGE	
NOTED BY	
NO.	

1/2 ZIPPER EXTENSION/CHANGE ORDER/TC-06.dgn

<p>THIS WORK WAS PREPARED BY ME OR UNDER MY SUPERVISION</p> <p><i>Perry M. Small</i></p>	<p>STATE OF HAWAII</p> <p>DEPARTMENT OF TRANSPORTATION</p> <p>HIGHWAYS DIVISION</p> <p><b>TRAFFIC CONTROL FOR MEDIAN BARRIER</b></p> <p><b>MOUNTED SIGN SUPPORT @ H-1 @ STA. 102+70</b></p> <p><b>INTERSTATE ROUTE H-1 ZIPPER LANE EXTENSION</b></p> <p><b>RADFORD DRIVE OVERPASS TO KEEHI INTERCHANGE</b></p> <p><b>FEDERAL AID PROJECT NO. NH-H1-1(246)</b></p> <p>Scale: 1" = 40'      Date: Mar. 2, 2004</p>
	SHEET No. - OF - SHEETS
	C.O. 53 S-1



**NOTES:**

1. The Contractor shall provide temporary work zone barriers to provide positive protection between the work area and adjacent travel lanes. The barriers shall meet NCHRP 350 Standards and be approved by the Engineer. Payment shall be considered incidental to the various items of the Contract.
2. Crash Cushions shall be appropriate for the Positive Protection Barrier System selected by the Contractor and approved by the barrier Manufacturer. The end treatments shall meet NCHRP 350 Standards and be approved by the Engineer. Payment shall be incidental to the various items of the Contract.
3. The Contractor shall install Steady-Burn Warning lights mounted on the Positive Protection Barrier @ 20' o.c. Payment shall be considered incidental to the various items of the Contract.
4. The Contractor shall remove all temporary pavement markings shown on the Traffic Control Plans after construction and restore all pavement markings to existing condition.

FED. ROAD DIST. NO.	STATE	FEDERAL AID PROJ. NO.	FISCAL YEAR	SHEET NO.	TOTAL SHEETS
HAWAII	HAW.	NH-HI-1(246)	2004	C.O. 53S-2	105

TRUE NORTH  
SCALE: 1" = 40'

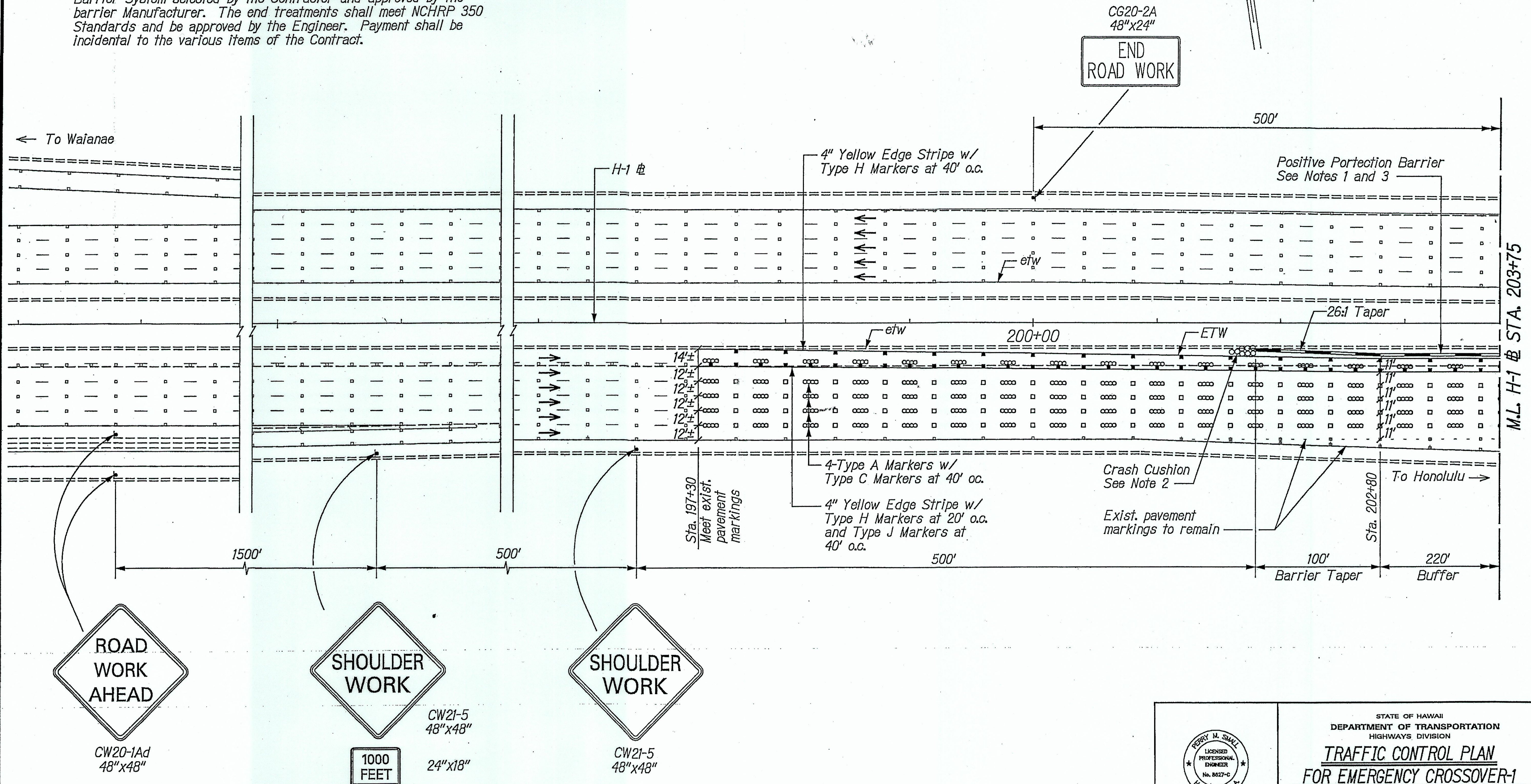

ROAD WORK AHEAD  
CW20-1Ad  
48"x48"

SHOULDER WORK  
1000 FEET  
CW21-5  
48"x48"

SHOULDER WORK  
CW21-5  
48"x48"

STATE OF HAWAII  
DEPARTMENT OF TRANSPORTATION  
HIGHWAYS DIVISION

**TRAFFIC CONTROL PLAN  
FOR EMERGENCY CROSSOVER-1**

INTERSTATE ROUTE H-1 ZIPPER LANE EXTENSION  
RADFORD DRIVE OVERPASS TO KEEHI INTERCHANGE  
FEDERAL AID PROJECT NO. NH-HI-1(246)

Scale: 1" = 40'      Date: Mar. 2, 2004

SHEET No. TC8 OF 8 SHEETS

THIS WORK WAS PREPARED BY ME  
OR UNDER MY SUPERVISION.

**PERRY M. SHALL**  
LICENSED PROFESSIONAL ENGINEER  
No. 8827-C  
HAWAII, U.S.A.



1. *The Contractor shall provide temporary work zone barriers to provide positive protection between the work area and adjacent travel lanes. The barriers shall meet NCHRP 350 Standards and be approved by the Engineer. Payment shall be considered incidental to the various items of the Contract.*
2. *Crash Cushions shall be appropriate for the Positive Protection Barrier System selected by the Contractor and approved by the barrier Manufacturer. The end treatments shall meet NCHRP 350 Standards and be approved by the Engineer. Payment shall be incidental to the various items of the Contract.*

3. *The Contractor shall install Steady-Burn Warning lights mounted on the Positive Protection Barrier @ 20' o.c. Payment shall be considered incidental to the various items of the Contract.*
4. *The Contractor shall remove all temporary pavement markings shown on the Traffic Control Plans after construction and restore all pavement markings to existing condition.*

FED. ROAD DIST. NO.	STATE	FEDERAL AID PROJ. NO.	FISCAL YEAR	SHEET NO.	TOTAL SHEETS
HAWAII	HAW.	NH-HI-1(246)	2004	C.O. 53S-3	105

TRUE NORTH  
SCALE : 1" = 40'

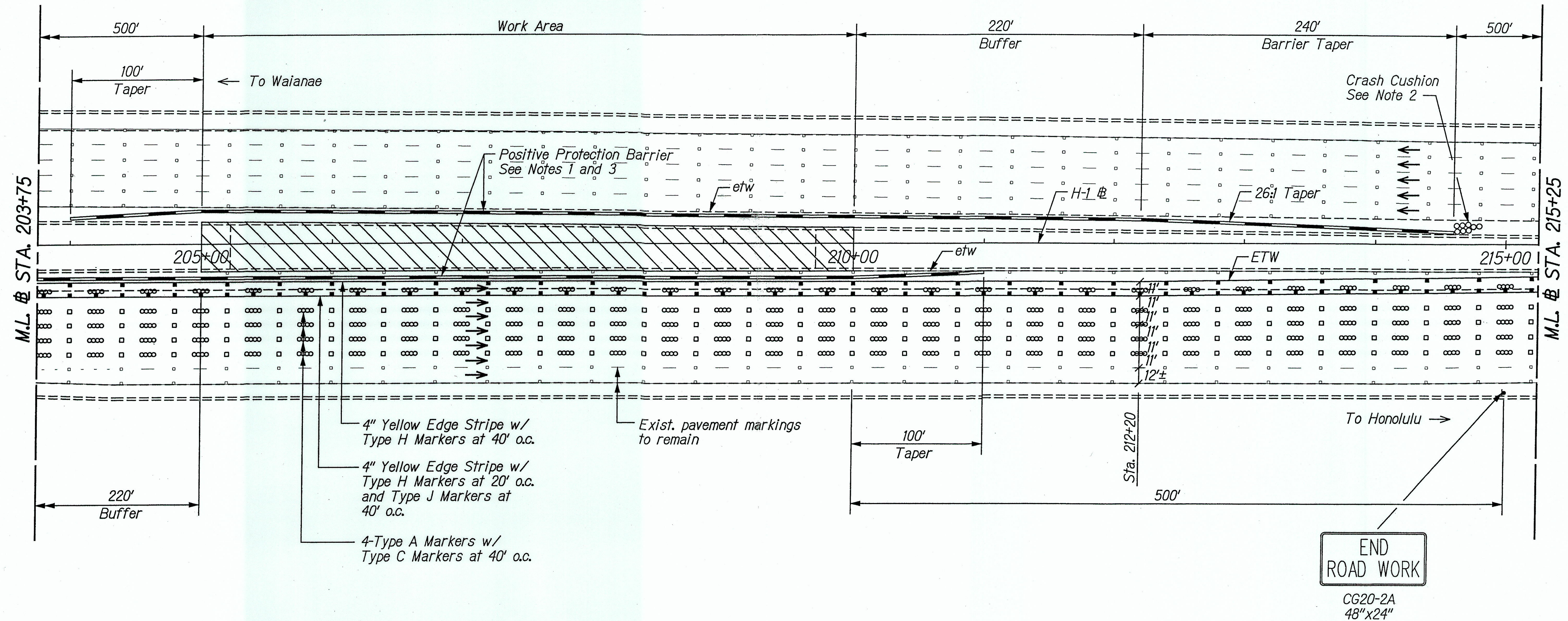

END  
ROAD WORK

CG20-2A  
48"x24"

ORIGINAL PLAN	SURVEY PLOTTED BY _____	DATE _____
NOTE BOOK	DRAWN BY _____	_____
	DESIGNED BY _____	_____
	QUANTITIES BY _____	_____
	CHECKED BY _____	_____
NO.		

1./ZIPPER EXTENSION/CHANGE ORDER/TCP-08.dgn

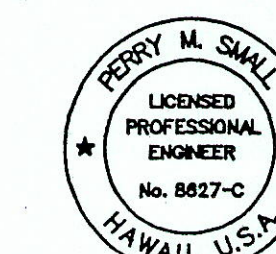

THIS WORK WAS PREPARED BY  
OR UNDER MY SUPERVISION

STATE OF HAWAII  
DEPARTMENT OF TRANSPORTATION  
HIGHWAYS DIVISION

TRAFFIC CONTROL PLAN  
FOR EMERGENCY Crossover-2  
INTERSTATE ROUTE H-1 ZIPPER LANE EXTENSION  
RADFORD DRIVE OVERPASS TO KEEHI INTERCHANGE  
FEDERAL AID PROJECT NO. NH-HI-1(246)

Scale: 1" = 40' Date: Mar. 2, 2004

SHEET No. *TC8* OF *8* SHEETS

C.O. 53 S-3



*The Contractor shall remove all temporary pavement markings shown on the Traffic Control Plans after construction and restore all pavement markings to existing condition.*

FED. ROAD DIST. NO.	STATE	FEDERAL AID PROJ. NO.	FISCAL YEAR	SHEET NO.	TOTAL SHEETS
HAWAII	HAW.	NH-HI-1(246)	2004	C.O. 535-4	105

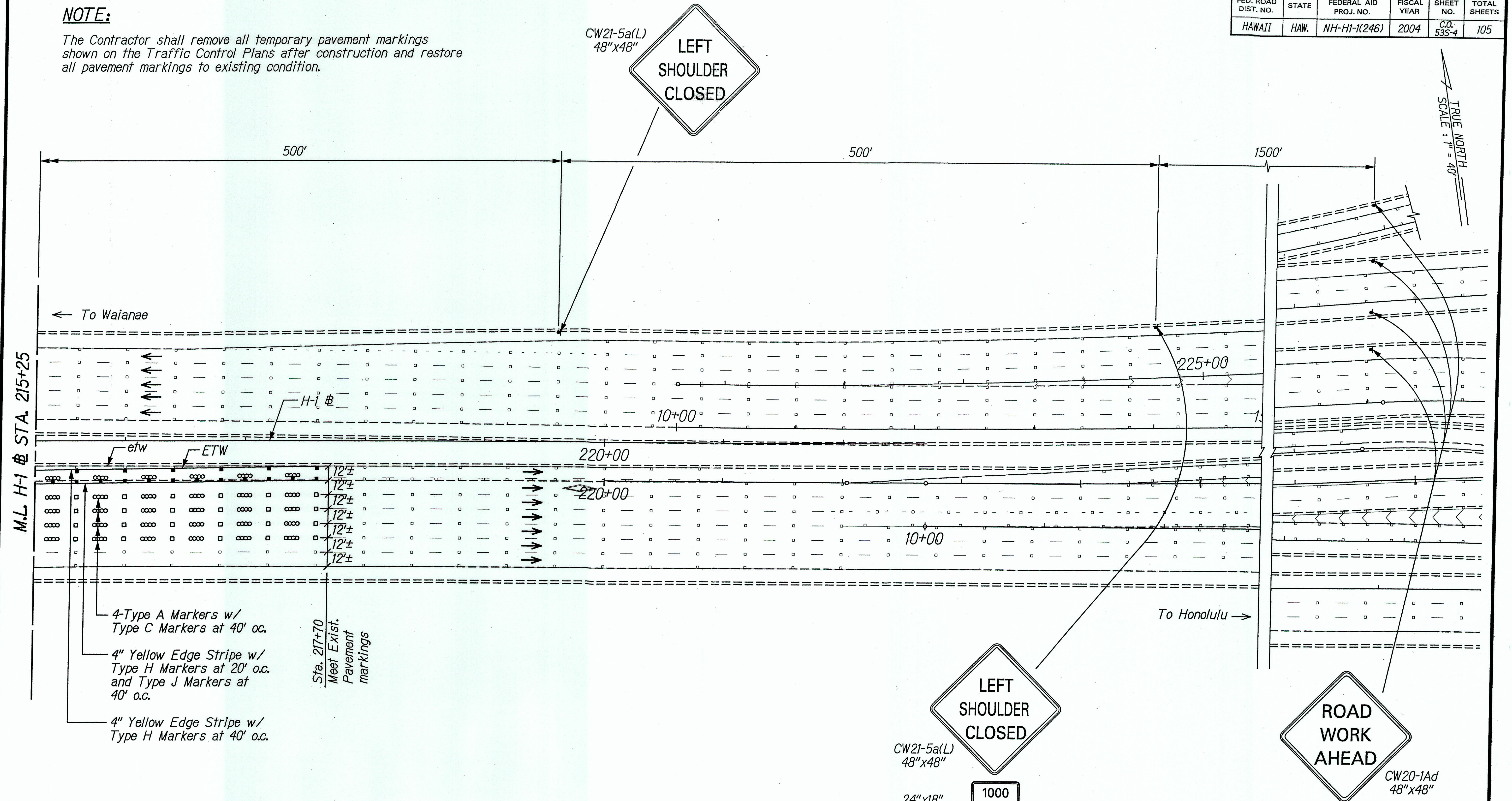

ORIGINAL PLAN	SURVEY PLOTTED BY _____	DATE _____
	DRAWN BY _____	_____
NOTE BOOK	DESIGNED BY _____	_____
	QUANTITIES BY _____	_____
No. _____	CHECKED BY _____	_____

1./ZIPPER EXTENSION/CHANGE ORDER/TCP-09.dgn

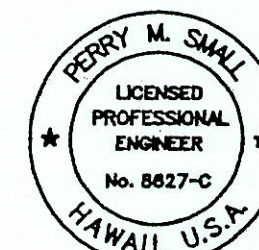

THIS WORK WAS PREPARED BY  
OR UNDER MY SUPERVISION.

STATE OF HAWAII  
DEPARTMENT OF TRANSPORTATION  
HIGHWAYS DIVISION

**TRAFFIC CONTROL PLAN**  
**FOR EMERGENCY CROSSOVER-3**

**INTERSTATE ROUTE H-1 ZIPPER LANE EXTENSION**  
**RADFORD DRIVE OVERPASS TO KEEHI INTERCHANGE**  
**FEDERAL AID PROJECT NO. MH-HI-1(246)**

Scale: 1" = 40'      Date: Mar. 2, 2004

SHEET No. *TC8* OF *8* SHEETS

C.O. 53 S-4