

FED. ROAD DIST. NO.	STATE	FEDERAL AID PROJ. NO.	FISCAL YEAR	SHEET NO.	TOTAL SHEETS
HAWAII	HAW.	NH-HI-1(246)	2004	55	105

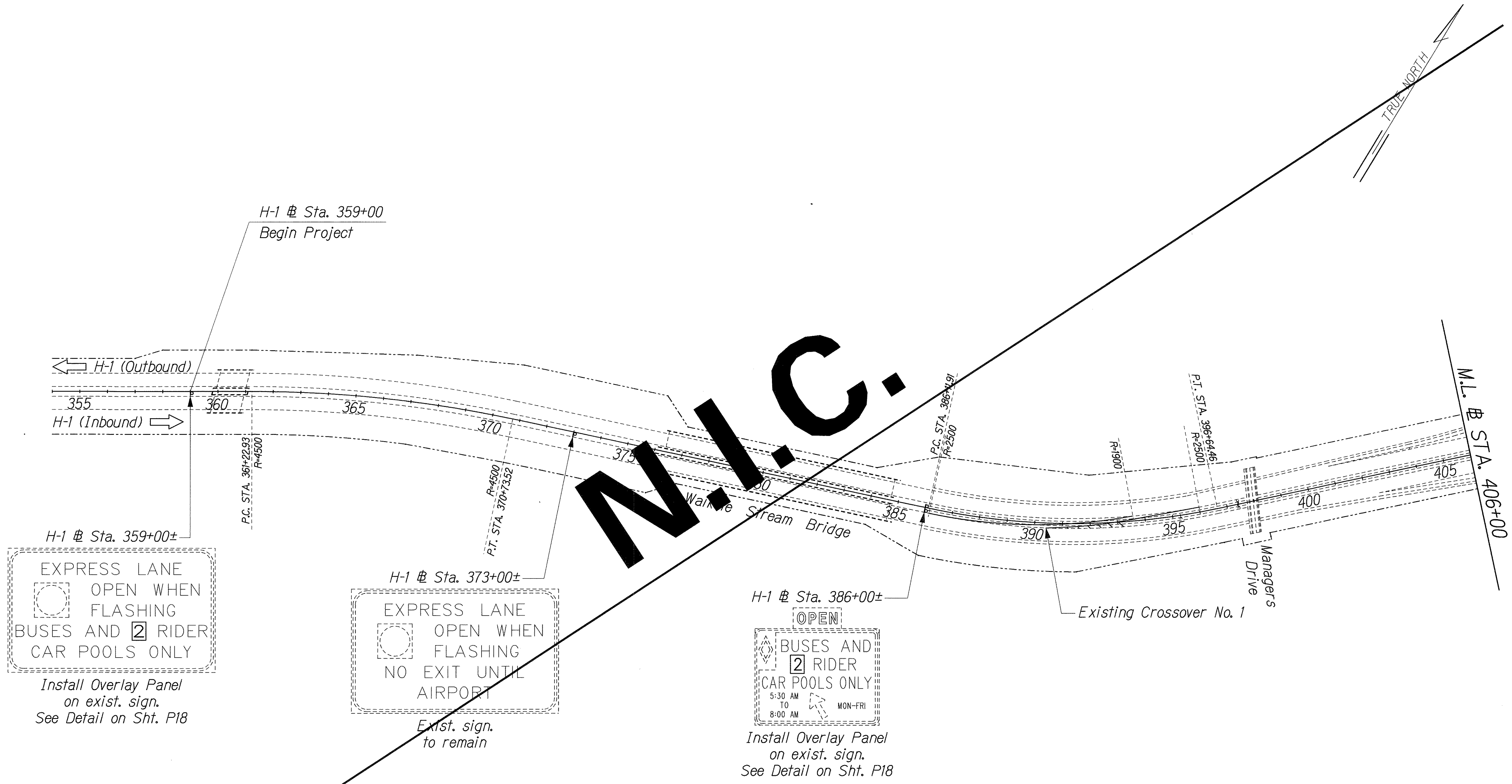

EXPRESS LANE
 OPEN WHEN FLASHING
 BUSES AND RIDER CAR POOLS ONLY

Install Overlay Panel on exist. sign.
 See Detail on Sht. P18

EXPRESS LANE
 OPEN WHEN FLASHING
 NO EXIT UNTIL AIRPORT

Exist. sign. to remain

OPEN
 BUSES AND RIDER CAR POOLS ONLY
 5:30 AM TO 8:00 AM MON-FRI

Install Overlay Panel on exist. sign.
 See Detail on Sht. P18

SURVEY PLOTTED BY	DATE
DRAWN BY	
TRACED BY	
QUANTITIES BY	
CHECKED BY	
ORIGINAL PLAN	
NOTE BOOK	
N.	

H-1 ZIPPER EXTENSION/STGN/ISS-01.dgn

<p>THIS WORK WAS PREPARED BY ME OR UNDER MY SUPERVISION.</p>	STATE OF HAWAII DEPARTMENT OF TRANSPORTATION HIGHWAYS DIVISION
	SIGNING AND PAVEMENT MARKINGS @ STA. 355+00 TO 406+00
	INTERSTATE ROUTE H-1 ZIPPER LANE EXTENSION RADFORD DRIVE OVERPASS TO KEEHI INTERCHANGE FEDERAL AID PROJECT NO. NH-HI-1(246)
	Scale: 1" = 200' Date: Mar. 2, 2004
	SHEET No. P2 OF 19 SHEETS

FED. ROAD DIST. NO.	STATE	FEDERAL AID PROJ. NO.	FISCAL YEAR	SHEET NO.	TOTAL SHEETS
HAWAII	HAW.	NH-HI-1(246)	2004	57	105

EXPRESS LANE
 OPEN WHEN FLASHING
 BUSES AND  RIDER CAR POOLS ONLY
 Install Overlay Panel on exist. sign.
 See Detail on Sht. P18

EXPRESS LANE
 OPEN WHEN FLASHING
 NO EXIT UNTIL AIRPORT
 Exist. sign. to remain

H-2 # Sta. 475+50±
 OPEN
 BUSES AND  RIDER CAR POOLS ONLY
 5:30 AM TO 8:00 AM MON-FRI
 Install Overlay Panel on exist. sign.
 See Detail on Sht. P18

Waiawa Interchange

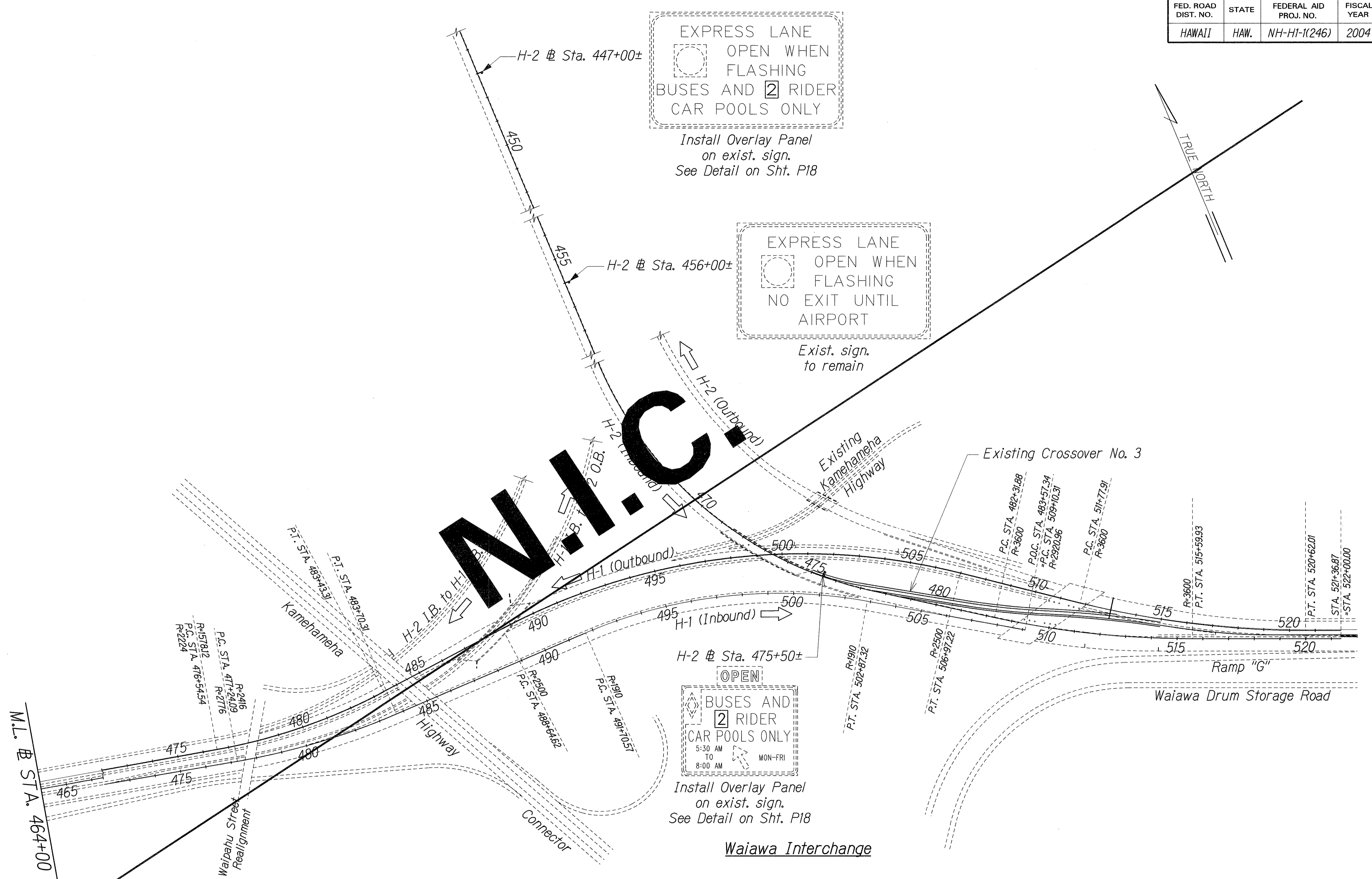

ORIGINAL PLAN	DATE
DESIGNED BY	
TRACED BY	
NOTE BOOK	
QUANTITIES BY	
CHECKED BY	

\\ZIPPER_EXTENSION\SIGN\SS-03.dgn

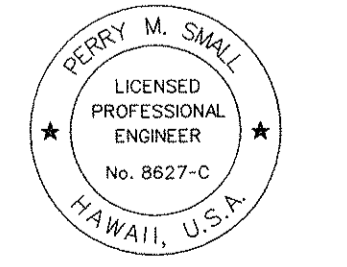

THIS WORK WAS PREPARED BY ME OR UNDER MY SUPERVISION.
Perry M. Small

STATE OF HAWAII
 DEPARTMENT OF TRANSPORTATION
 HIGHWAYS DIVISION

SIGNING AND PAVEMENT MARKINGS

WAIAWA INTERCHANGE

INTERSTATE ROUTE H-1 ZIPPER LANE EXTENSION
 RADFORD DRIVE OVERPASS TO KEEHI INTERCHANGE
 FEDERAL AID PROJECT NO. NH-HI-1(246)

Scale: 1"=200' Date: Mar. 2, 2004

FED. ROAD DIST. NO.	STATE	FEDERAL AID PROJ. NO.	FISCAL YEAR	SHEET NO.	TOTAL SHEETS
HAWAII	HAW.	NH-H1-1(246)	2004	58	105

TRUE NORTH
SCALE: 1" = 40'

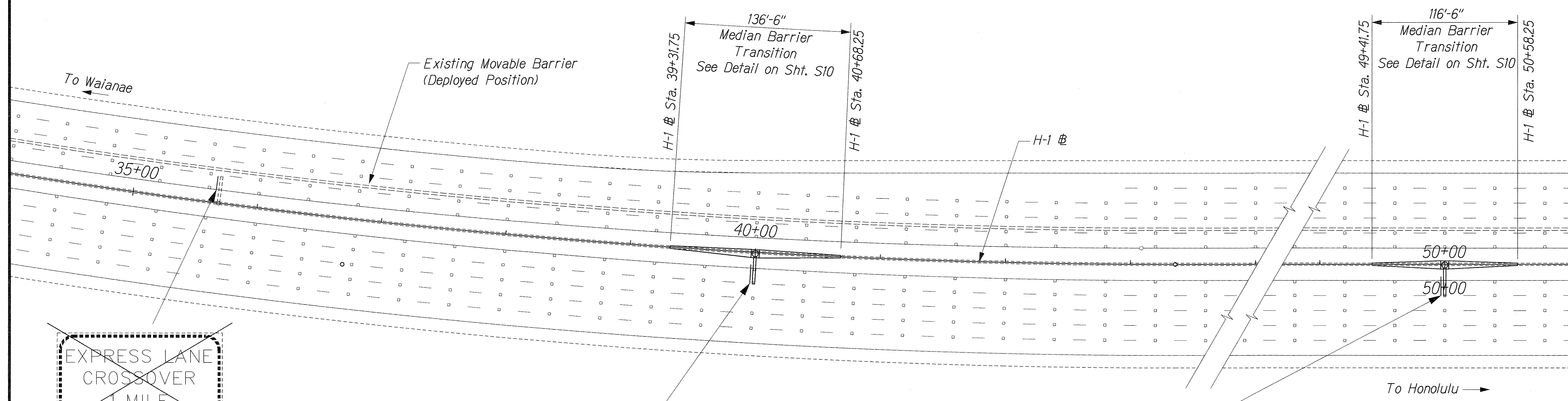

~~EXPRESS LANE CROSSOVER 1 MILE~~

EXPRESS LANE AIRPORT EXIT 1 MILE

Remove exist. sign at H-1 Sta. 35+70± and Install Sign WS-1 on exist. cantilever sign support. See Sign Panel Layout Detail on Sht. P16.

EXPRESS LANE
 OPEN WHEN FLASHING
 BUSES AND 3 RIDER CAR POOLS ONLY

Install sign DS-1 at H-1 Sta. 40+00 on cantilever sign support. See Sign Panel Layout Detail on Sht. P17. See Cantilever Sign Support Detail on Sht. S2.

EXPRESS LANE
 OPEN WHEN FLASHING
 NO EXIT UNTIL DOWNTOWN

Install Sign DS-2 at H-1 Sta. 50+00 on cantilever sign support. See Sign Panel Layout Detail on Sht. P17. See Cantilever Sign Support Detail on Sht. S2.

DATE	DESIGNED BY
	CHECKED BY
	QUANTITIES BY
	DESIGNED BY
	TRACED BY
	DRAWN BY
	PLOTTED BY
	ORIGINAL PLAN
	NOTE BOOK

H-1 ZIPPER LANE EXTENSION/SIGN/SS-04.dgn

THIS WORK WAS PREPARED BY ME OR UNDER MY SUPERVISION.

Perry M. Small

STATE OF HAWAII
 DEPARTMENT OF TRANSPORTATION
 HIGHWAYS DIVISION

SIGNING AND PAVEMENT MARKINGS
STA. 35+00 TO 55+00

INTERSTATE ROUTE H-1 ZIPPER LANE EXTENSION
 RADFORD DRIVE OVERPASS TO KEEHI INTERCHANGE
 FEDERAL AID PROJECT NO. NH-H1-1(246)
 Scale: 1" = 40' Date: Mar. 2, 2004

FED. ROAD DIST. NO.	STATE	FEDERAL AID PROJ. NO.	FISCAL YEAR	SHEET NO.	TOTAL SHEETS
HAWAII	HAW.	NH-HI-K(246)	2004	58	105

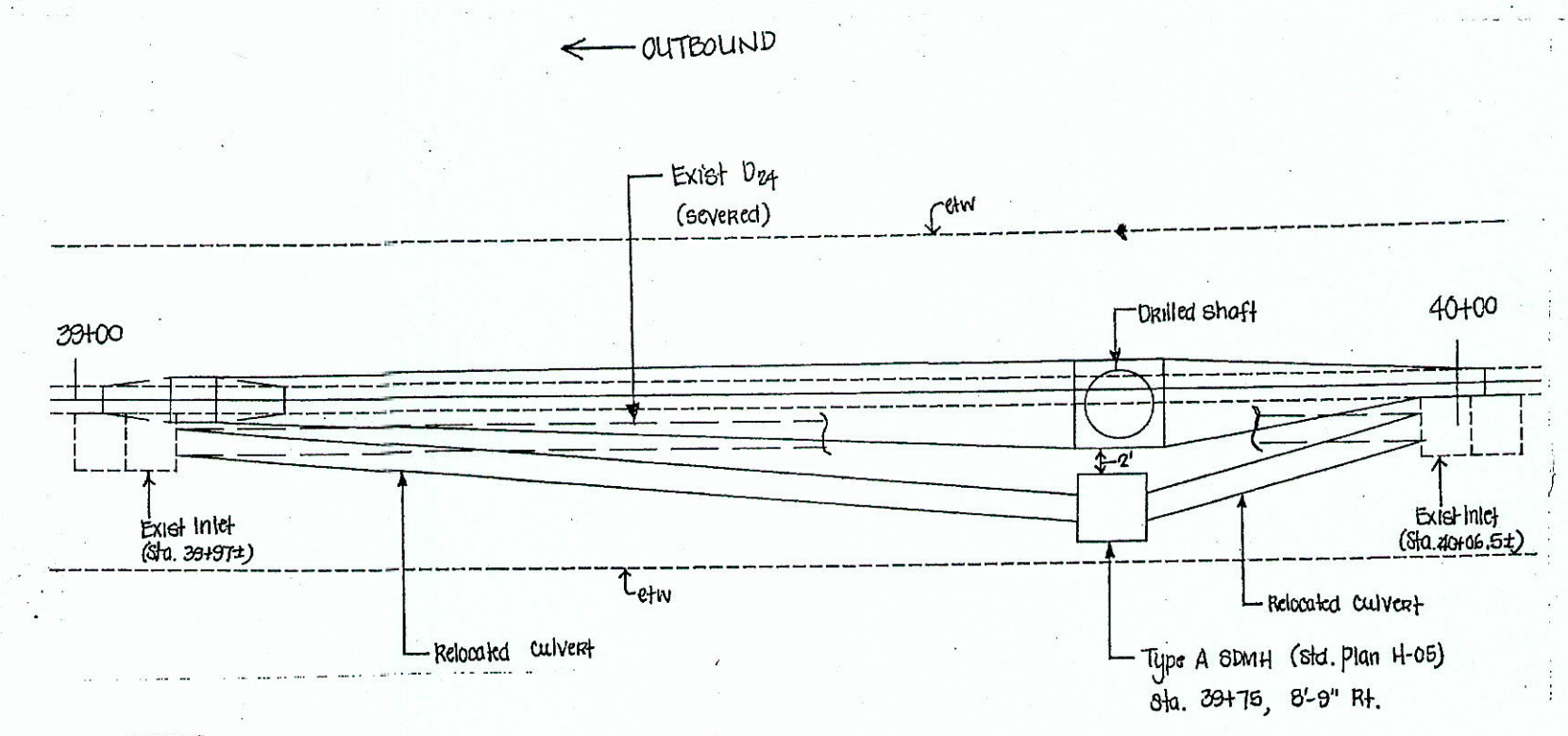

TRUE NORTH
SCALE: 1" = 40'

- NOTES:
1. The Contractor shall install new drainage pipe of same size as existing culvert. Pipe material shall conform to Special Provisions Section 603 - Culverts and Storm Drains.
 2. The Contractor shall install the culvert at a constant slope to meet existing invert elevations at each drain inlet.

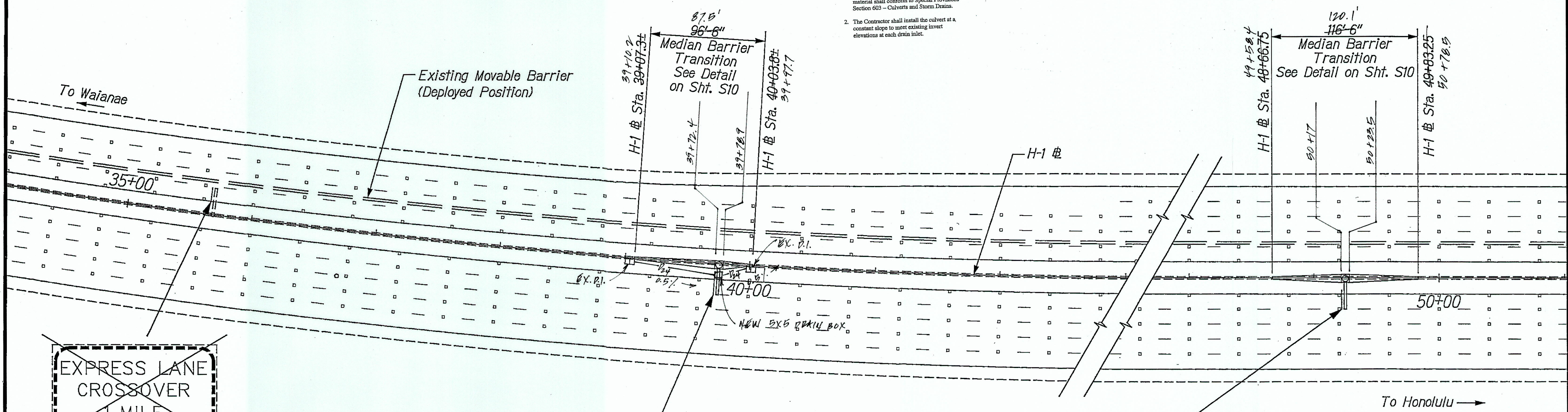

~~EXPRESS LANE CROSSOVER 1 MILE~~

EXPRESS LANE AIRPORT EXIT 1 MILE

EXPRESS LANE
 OPEN WHEN FLASHING
 BUSES AND 3 RIDER CAR POOLS ONLY

EXPRESS LANE
 OPEN WHEN FLASHING
 NO EXIT UNTIL DOWNTOWN

Remove exist. sign at H-1 # Sta. 35+70± and Install Sign WS-1 on exist. cantilever sign support. See Sign Panel Layout Detail on Sht. P16.

Install sign DS-1 at H-1 # Sta. 39+75.6± on cantilever sign support. See Sign Panel Layout Detail on Sht. P17. See Cantilever Sign Support Detail on Sht. S2.

Install Sign DS-2 at H-1 # Sta. 49+25 on cantilever sign support. See Sign Panel Layout Detail on Sht. P17. See Cantilever Sign Support Detail on Sht. S2.

SURVEY PLOTTED BY	DATE
DRAWN BY	
CHECKED BY	
NOTED BY	
DESIGNED BY	
CHECKED BY	

1/10/05	Revised Sign Structure Locations
Date	Revision

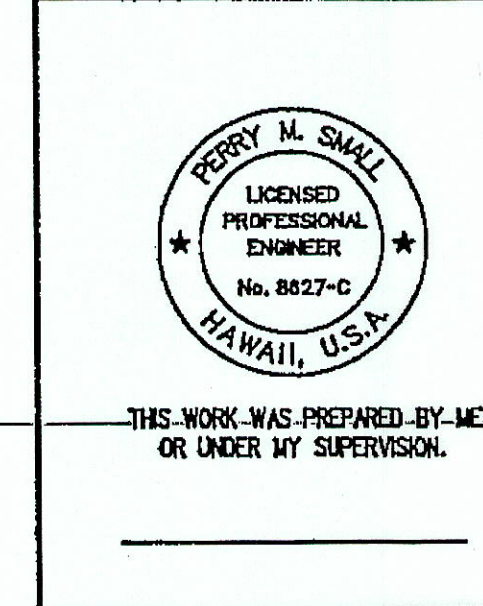

STATE OF HAWAII
 DEPARTMENT OF TRANSPORTATION
 HIGHWAYS DIVISION
SIGNING AND PAVEMENT MARKINGS
STA. 35+00 TO 55+00
 INTERSTATE ROUTE H-1 ZIPPER LANE EXTENSION
 RADFORD DRIVE OVERPASS TO KEEHI INTERCHANGE
 FEDERAL AID PROJECT NO. NH-HI-K(246)
 Scale: 1" = 40' Date: Mar. 2, 2004

FED. ROAD DIST. NO.	STATE	FEDERAL AID PROJ. NO.	FISCAL YEAR	SHEET NO.	TOTAL SHEETS
HAWAII	HAW.	NH-HI-1(246)	2004	60	105

TRUE NORTH
SCALE: 1" = 40'

Relocate Existing Merge Sign to Sta 83+40 (New Post)

Install Signs WS-3 and WS-4 at H-1 @ Sta. 84+60 on cantilever sign support. See Sign Panel Layout Details on Sht. P16. See Cantilever Sign Support Details on Sht. S2.

EXPRESS LANE
45
M.P.H.

Install Sign R-8 on sign post at H-1 @ Sta. 76+90. See Sign Panel Layout Detail on Sht. P16. See Median Barrier Mounted Sign Support Details on Sht. S13.

Remove exist. sign from light standard to sign post at H-1 @ Sta. 83+40.

Remove exist. sign from light standard. Install Sign R3-12b on sign post. See Sign Panel Layout Detail on Sht. P16. See Median Barrier Mounted Sign Support Details on Sht. S13.

WHEN HOV IN USE

A.M. ONLY

EXPRESS LANE THRU TRAFFIC KEEP LEFT

EXPRESS LANE AIRPORT EXIT RIGHT LANE ONLY

Existing Movable Barrier (Deployed Position)

4" Yellow Stripe with Type H Markers at 40' o.c.

4 Type A Markers and Type C Markers at 40' o.c.

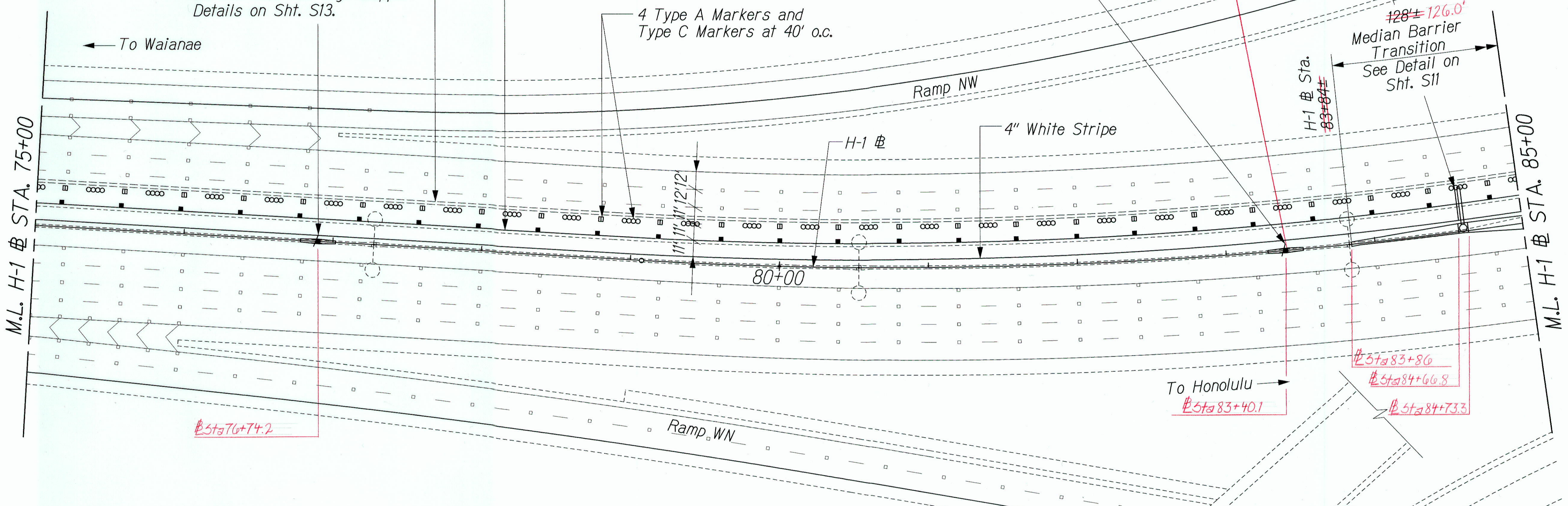

DESIGNED BY	DATE
DRAWN BY	
CHECKED BY	
IN CHARGE BY	
ORIGINAL PLAN	
NOTE BOOK	
NO.	

ZIPPER EXTENSION/SIGN/SS-06.dwg

THIS WORK WAS PREPARED BY ME OR UNDER MY SUPERVISION.

Perry M. Small

STATE OF HAWAII
DEPARTMENT OF TRANSPORTATION
HIGHWAYS DIVISION

SIGNING AND PAVEMENT MARKINGS

@ STA. 75+00 TO 85+00

INTERSTATE ROUTE H-1 ZIPPER LANE EXTENSION
RADFORD DRIVE OVERPASS TO KEEHI INTERCHANGE
FEDERAL AID PROJECT NO. NH-HI-1(246)

Scale: 1" = 40' Date: Mar. 2, 2004

"AS-BUILT"

FED. ROAD DIST. NO.	STATE	FEDERAL AID PROJ. NO.	FISCAL YEAR	SHEET NO.	TOTAL SHEETS
HAWAII	HAW.	NH-HI-1(246)	2004	61	105

TRUE NORTH
SCALE: 1" = 40'

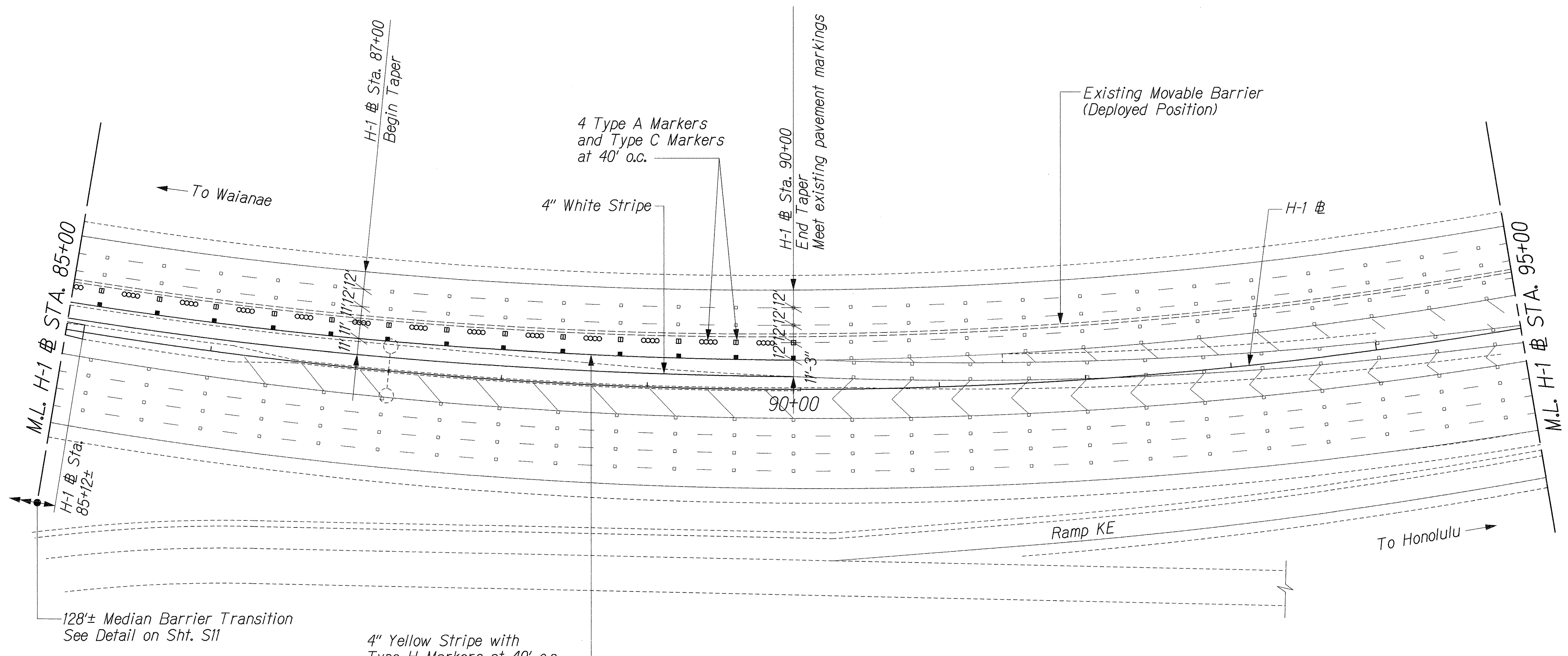

ORIGINAL PLAN	DATE
NOTED BY	
DESIGNED BY	
CHECKED BY	
DATE	

ZIPPER EXTENSION/SIGN/SS-07.dwg

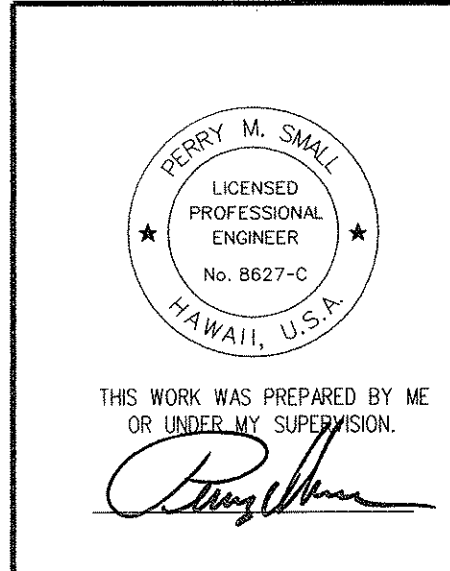

STATE OF HAWAII
DEPARTMENT OF TRANSPORTATION
HIGHWAYS DIVISION
SIGNING AND PAVEMENT MARKINGS
@ STA. 85+00 TO 95+00
INTERSTATE ROUTE H-1 ZIPPER LANE EXTENSION
RADFORD DRIVE OVERPASS TO KEEHI INTERCHANGE
FEDERAL AID PROJECT NO. NH-HI-1(246)
Scale: 1" = 40' Date: Mar. 2, 2004

FED. ROAD DIST. NO.	STATE	FEDERAL AID PROJ. NO.	FISCAL YEAR	SHEET NO.	TOTAL SHEETS
HAWAII	HAW.	NH-H1-1(246)	2004	62	105

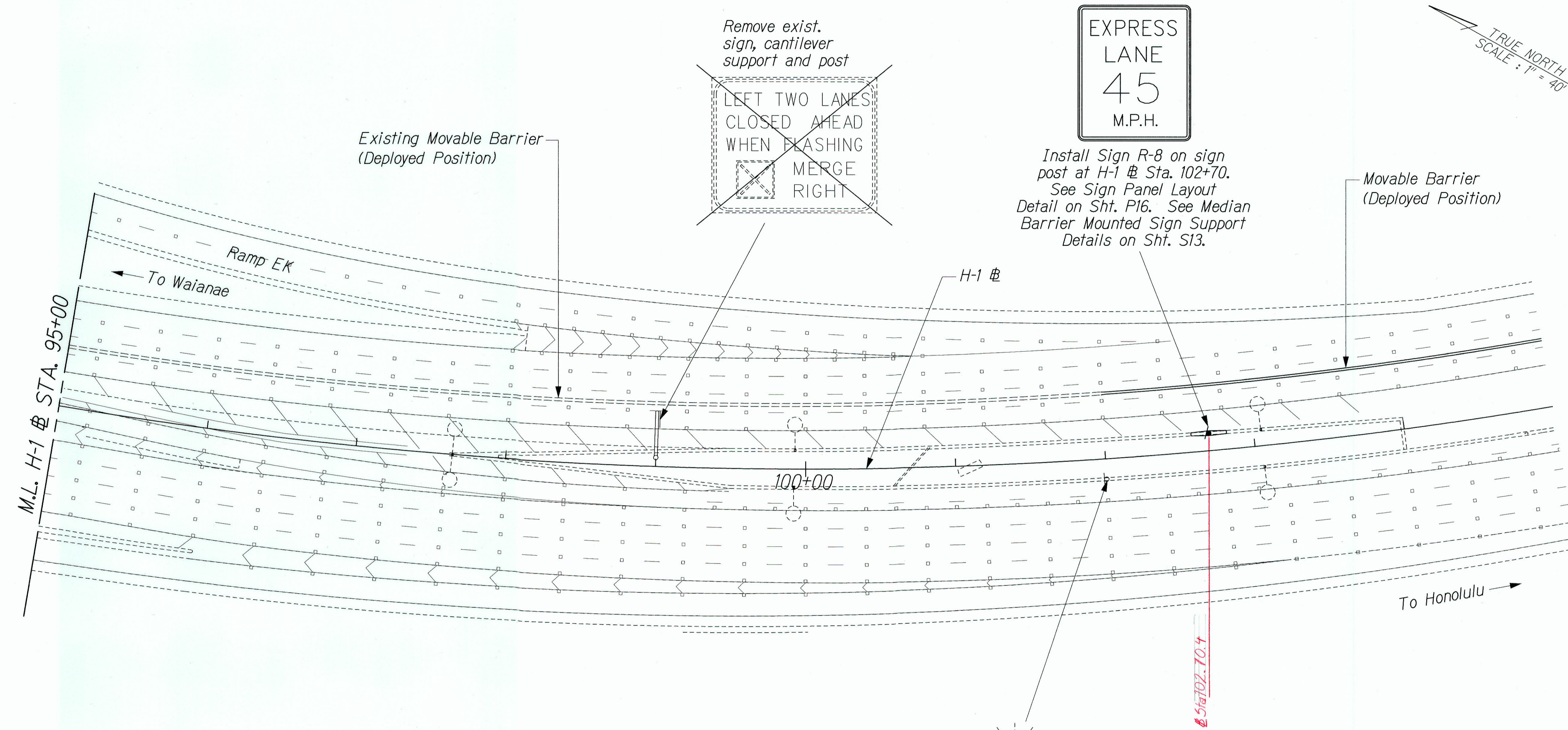

Remove exist.
sign, cantilever
support and post

~~LEFT TWO LANES
CLOSED AHEAD
WHEN FLASHING
MERGE
RIGHT~~

EXPRESS
LANE
45
M.P.H.

Install Sign R-8 on sign
post at H-1 @ Sta. 102+70.
See Sign Panel Layout
Detail on Sht. P16. See Median
Barrier Mounted Sign Support
Details on Sht. S13.

Movable Barrier
(Deployed Position)

Existing Movable Barrier
(Deployed Position)

CAUTION
SLOW MOVING
VEHICLE
WHEN
FLASHING

Exist. sign
to remain

DESIGNED BY	DATE
DRAWN BY	
CHECKED BY	
IN CHARGE	
DATE	
NOTE BOOK	
QUANTITIES BY	
CHECKED BY	
No.	

ZIPPER EXTENSION/SIGN/SS-08.dgn

<p>THIS WORK WAS PREPARED BY ME OR UNDER MY SUPERVISION.</p> <p><i>Perry M. Small</i></p>	<p>STATE OF HAWAII DEPARTMENT OF TRANSPORTATION HIGHWAYS DIVISION</p> <p>SIGNING AND PAVEMENT MARKINGS @ STA. 95+00 TO 105+00</p> <p>INTERSTATE ROUTE H-1 ZIPPER LANE EXTENSION RADFORD DRIVE OVERPASS TO KEEHI INTERCHANGE FEDERAL AID PROJECT NO. NH-H1-1(246)</p> <p>Scale: 1" = 40' Date: Mar. 2, 2004</p>
	SHEET No. P9 OF 19 SHEETS

"AS-BUILT"

FED. ROAD DIST. NO.	STATE	FEDERAL AID PROJ. NO.	FISCAL YEAR	SHEET NO.	TOTAL SHEETS
HAWAII	HAW.	NH-H1-K(246)	2004	63	105

TRUE NORTH
SCALE: 1" = 40'

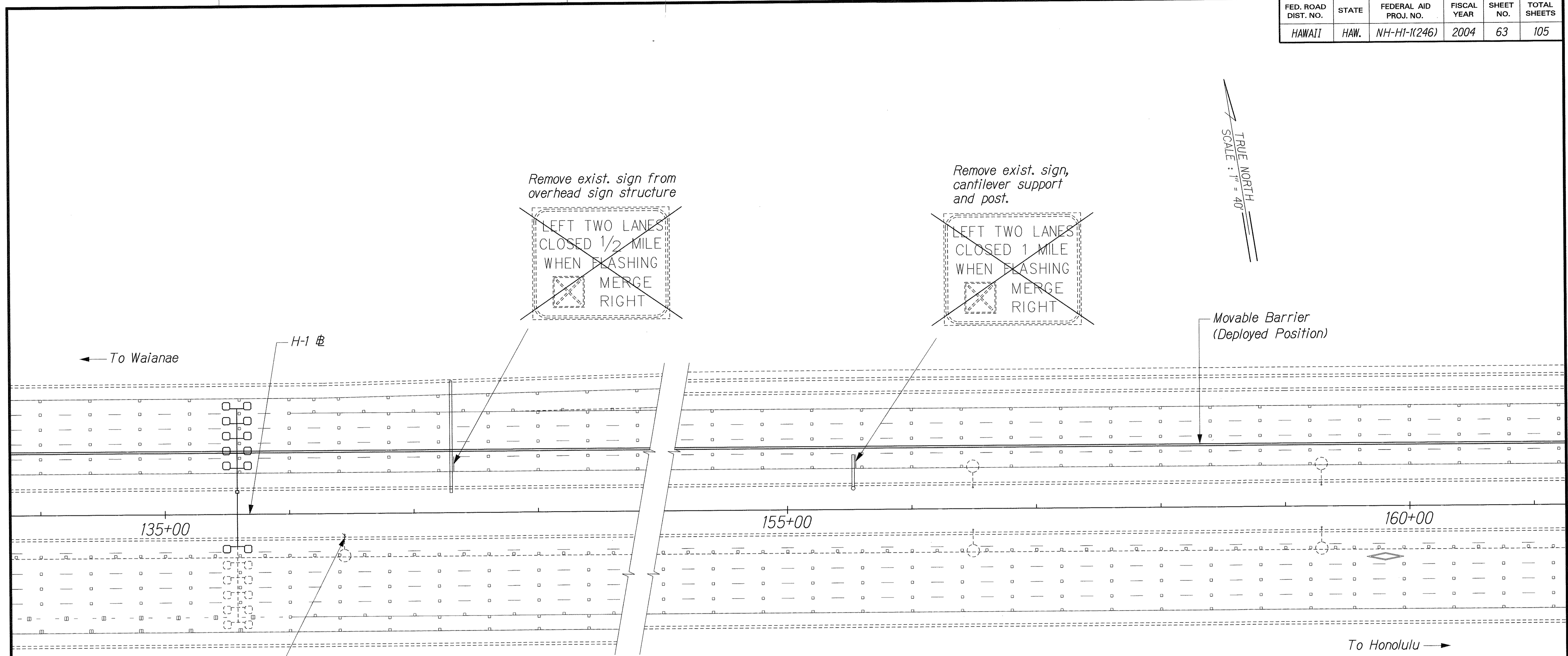

Remove exist. sign from overhead sign structure

Remove exist. sign, cantilever support and post.

Movable Barrier (Deployed Position)

← To Waianae

To Honolulu →

SHOULDER LANE FOR EXPRESS LANE USERS ONLY
HOV LANE 2 OR MORE
OPEN 5:30-8AM 5:30-8AM 3:30-6PM
EXCEPT SAT SUN & HOL

Exist. sign to remain

SURVEY PLOTTED BY	DATE
DRAWN BY	
DESIGNED BY	
QUANTITIES BY	
CHECKED BY	
ORIGINAL PLAN	
NOTE BOOK	
No.	

H-1 ZIPPER EXTENSION/SIGN/SS-09-007

<p>THIS WORK WAS PREPARED BY ME OR UNDER MY SUPERVISION.</p> <p><i>Perry M. Small</i></p>	<p>STATE OF HAWAII DEPARTMENT OF TRANSPORTATION HIGHWAYS DIVISION</p> <p>SIGNING AND PAVEMENT MARKINGS @ STA. 135+00 TO 160+00</p> <p>INTERSTATE ROUTE H-1 ZIPPER LANE EXTENSION RADFORD DRIVE OVERPASS TO KEEHI INTERCHANGE FEDERAL AID PROJECT NO. NH-H1-K(246)</p> <p>Scale: 1" = 40' Date: Mar. 2, 2004</p>
	<p>SHEET No. 63 OF 19 SHEETS</p>

FED. ROAD DIST. NO.	STATE	FEDERAL AID PROJ. NO.	FISCAL YEAR	SHEET NO.	TOTAL SHEETS
HAWAII	HAW.	NH-HI-1(246)	2004	65	105

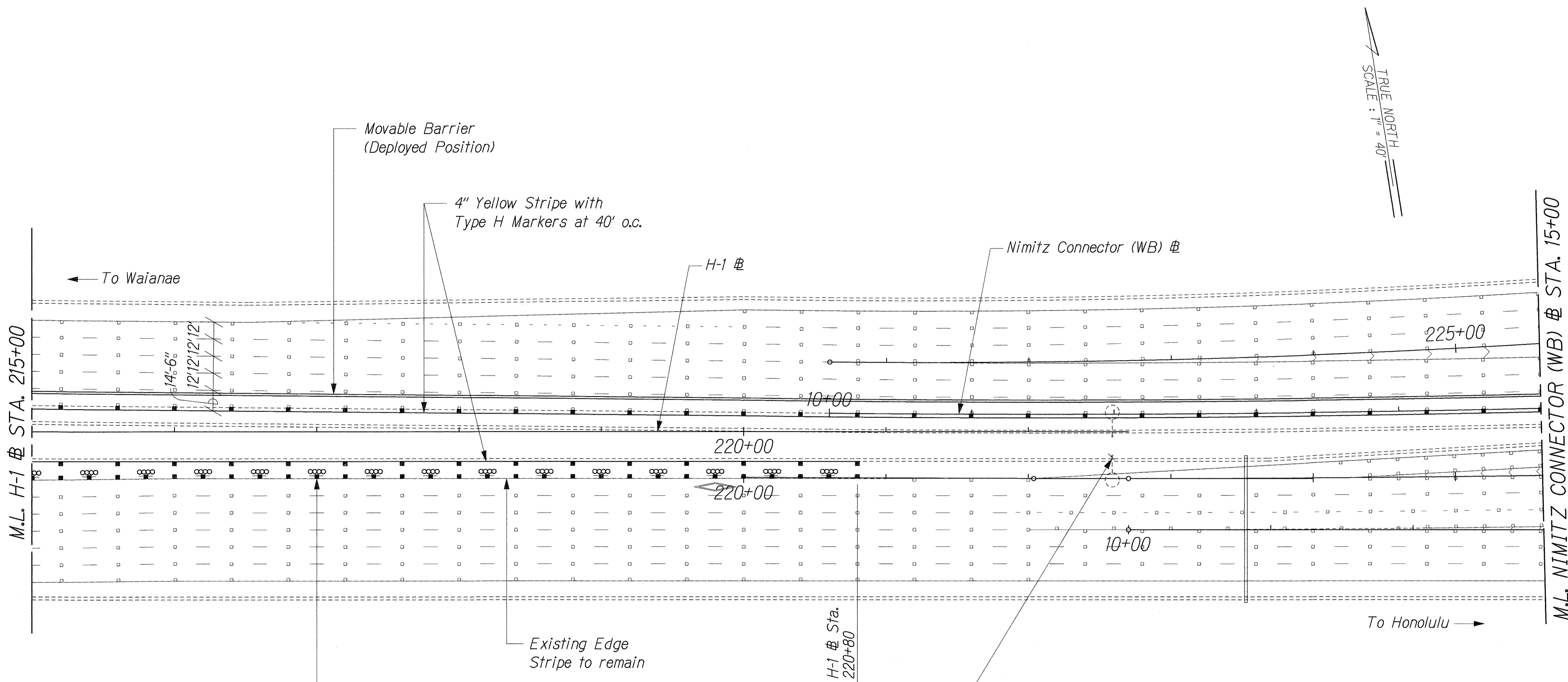

TRUE NORTH
SCALE: 1" = 40'

M.L. H-1 # STA. 215+00

M.L. NIMITZ CONNECTOR (WB) # STA. 15+00

← To Waianae

To Honolulu →

Relocated sign on existing light standard at Nimitz Connector (WB) # Sta. 12+00±

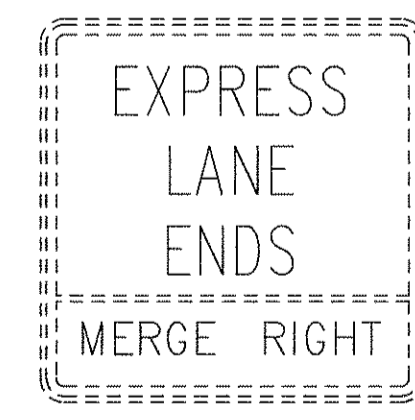

Exist. sign to remain

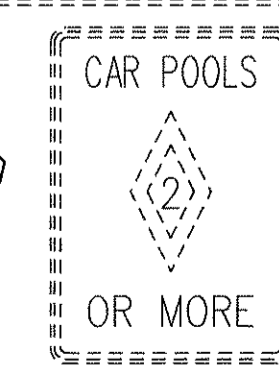

Type H Markers at 20' o.c. and 4 Type J Markers at 40' o.c.

Existing Edge Stripe to remain

DESIGNED BY	DATE
DRAWN BY	
TRACED BY	
DESIGNED BY	
QUANTITIES BY	
CHECKED BY	
ORIGINAL PLAN	
NOTE BOOK	

H-1 ZIPPER LANE EXTENSION/SIGN/SS/11/04/04

THIS WORK WAS PREPARED BY ME OR UNDER MY SUPERVISION.

Perry M. Small

STATE OF HAWAII
DEPARTMENT OF TRANSPORTATION
HIGHWAYS DIVISION

SIGNING AND PAVEMENT MARKINGS

H-1 # STA. 215+00 TO NIMITZ OB # 15+00

INTERSTATE ROUTE H-1 ZIPPER LANE EXTENSION
RADFORD DRIVE OVERPASS TO KEEHI INTERCHANGE
FEDERAL AID PROJECT NO. NH-HI-1(246)

Scale: 1" = 40' Date: Mar. 2, 2004

FED. ROAD DIST. NO.	STATE	FEDERAL AID PROJ. NO.	FISCAL YEAR	SHEET NO.	TOTAL SHEETS
HAWAII	HAW.	NH-H1-1(246)	2004	66	105

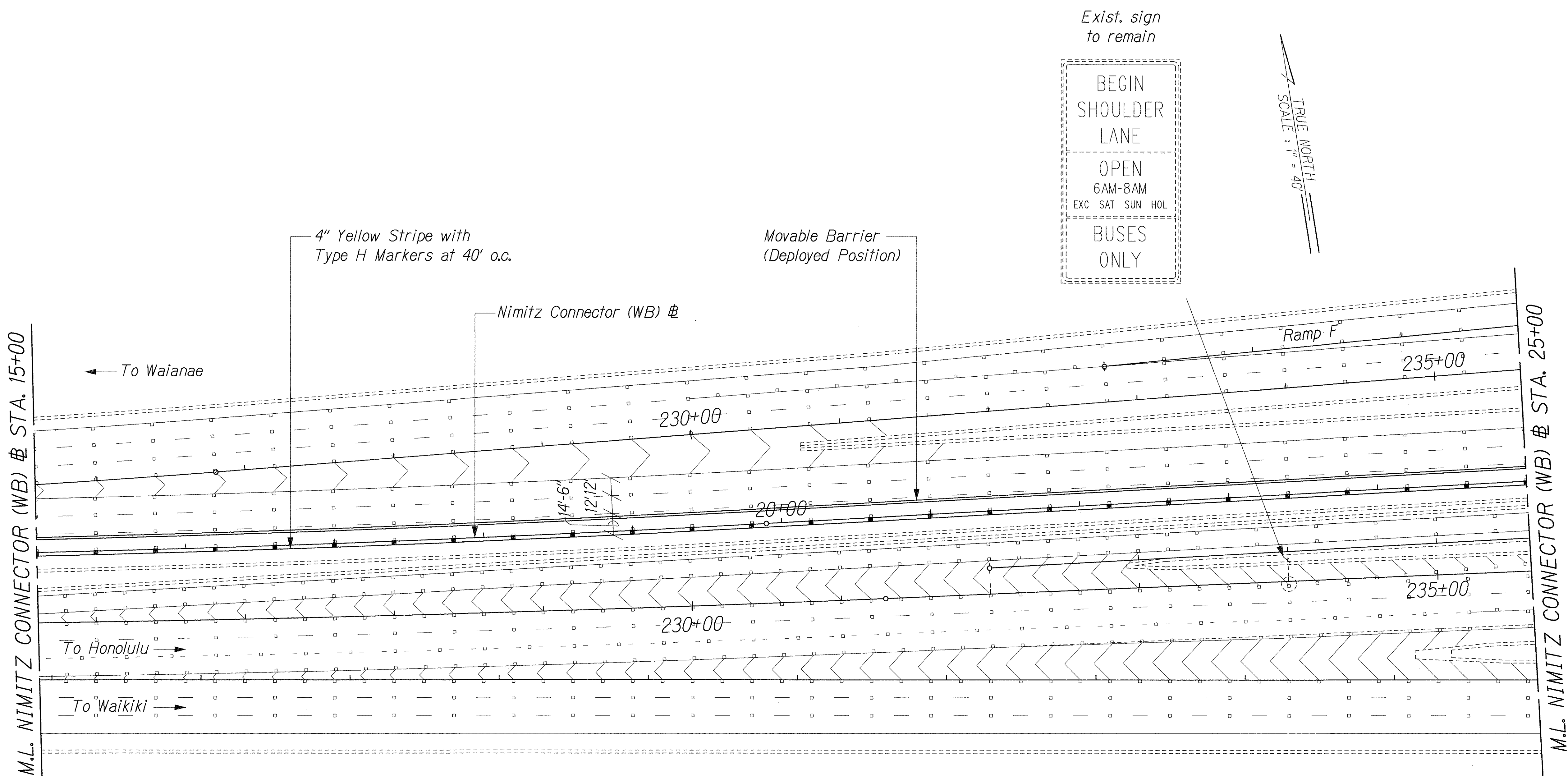

Exist. sign to remain

BEGIN SHOULDER LANE

OPEN 6AM-8AM
EXC SAT SUN HOL

BUSES ONLY

TRUE NORTH
SCALE: 1" = 40'

DESIGNED BY	DATE
TRACED BY	
DESIGNED BY	
QUANTITIES BY	
CHECKED BY	

H-ZIPPER EXTENSION/SIGN/SS-12.dgn

THIS WORK WAS PREPARED BY ME OR UNDER MY SUPERVISION.

Perry M. Small

STATE OF HAWAII
DEPARTMENT OF TRANSPORTATION
HIGHWAYS DIVISION

SIGNING AND PAVEMENT MARKINGS

NIMITZ OB @ STA. 15+00 TO 25+00

INTERSTATE ROUTE H-1 ZIPPER LANE EXTENSION
RADFORD DRIVE OVERPASS TO KEEHI INTERCHANGE

FEDERAL AID PROJECT NO. NH-H1-1(246)

Scale: 1" = 40' Date: Mar. 2, 2004

FED. ROAD DIST. NO.	STATE	FEDERAL AID PROJ. NO.	FISCAL YEAR	SHEET NO.	TOTAL SHEETS
HAWAII	HAW.	NH-H1-1(246)	2004	67	105

Install sign WS-6b on sign post at Nimitz Connector (WB) @ Sta. 26+00. See sign panel layout Detail on Sht. P16. See Parapet Mounted Sign Support Details on Sht. S13.

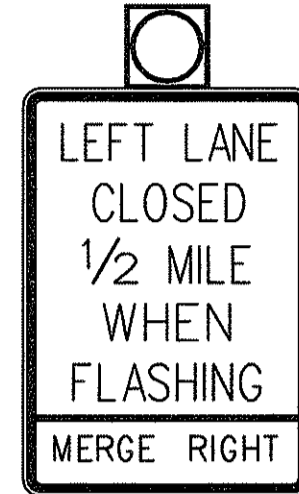

Movable Barrier (Deployed Position)

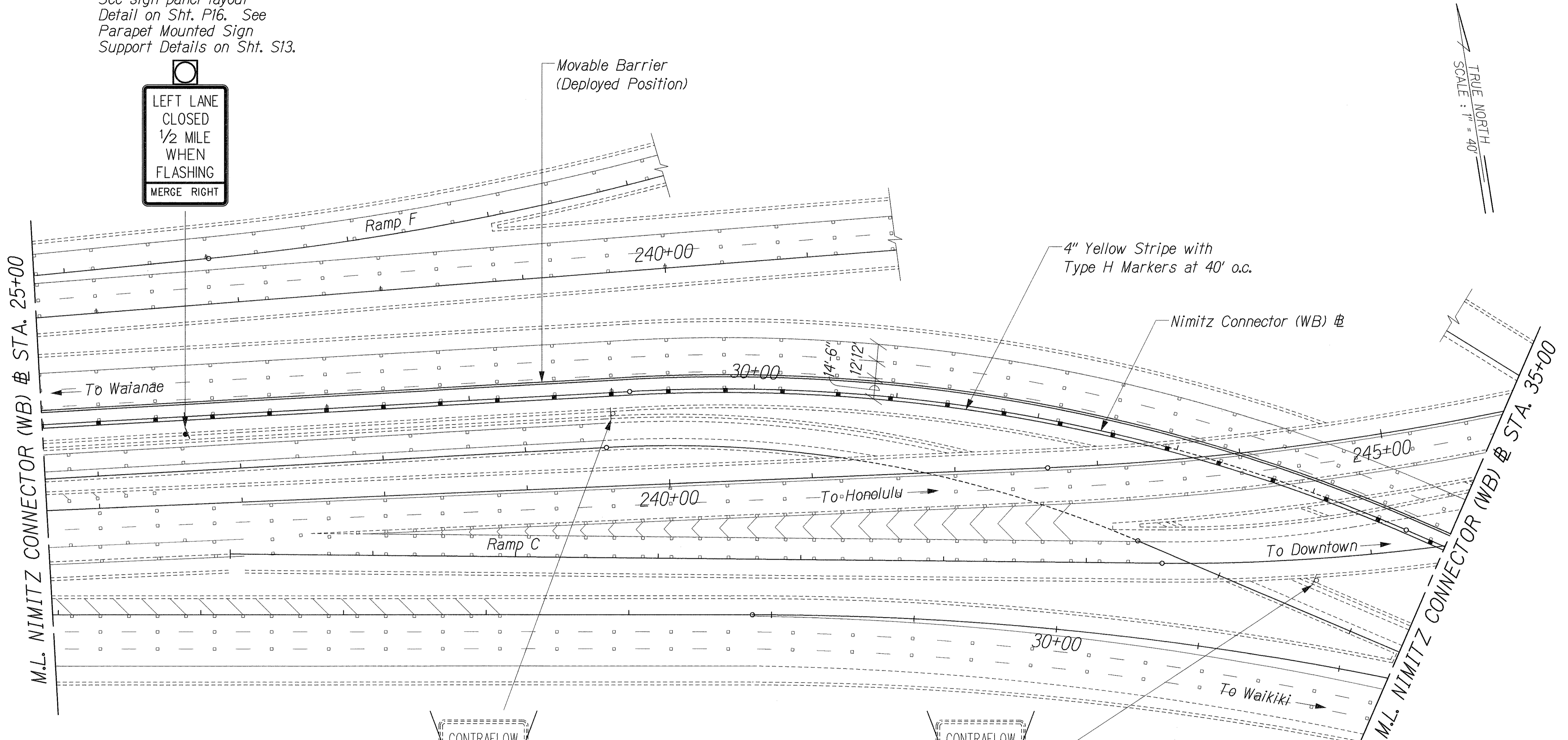

TRUE NORTH
SCALE: 1" = 40'

DESIGNED BY	DATE
PLANNED BY	
TRACED BY	
DESIGNED BY	
QUANTITIES BY	
CHECKED BY	
No.	

ZIPPER EXTENSION/SIGN/SS-13.dgn

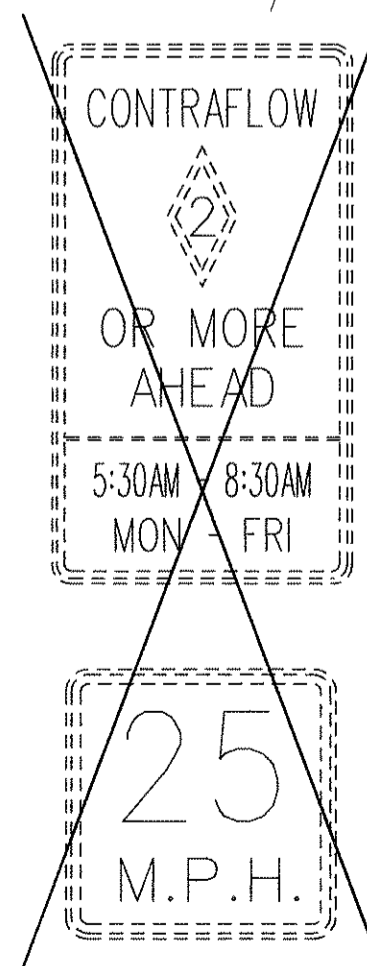

Remove existing signs and post

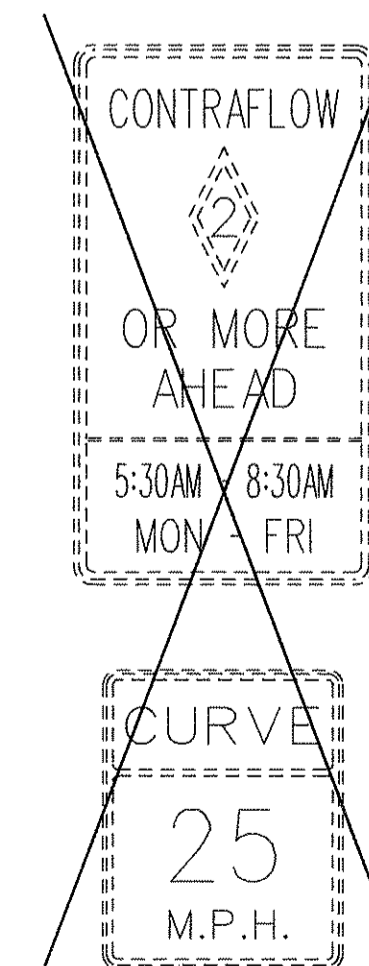

Remove existing signs and post

THIS WORK WAS PREPARED BY ME OR UNDER MY SUPERVISION.

Perry M. Small

STATE OF HAWAII
DEPARTMENT OF TRANSPORTATION
HIGHWAYS DIVISION

SIGNING AND PAVEMENT MARKINGS
NIMITZ OB @ STA. 25+00 TO 35+00

INTERSTATE ROUTE H-1 ZIPPER LANE EXTENSION
RADFORD DRIVE OVERPASS TO KEEHI INTERCHANGE
FEDERAL AID PROJECT NO. NH-H1-1(246)

Scale: 1" = 40' Date: Mar. 2, 2004

FED. ROAD DIST. NO.	STATE	FEDERAL AID PROJ. NO.	FISCAL YEAR	SHEET NO.	TOTAL SHEETS
HAWAII	HAW.	NH-HI-1(246)	2004	68	105

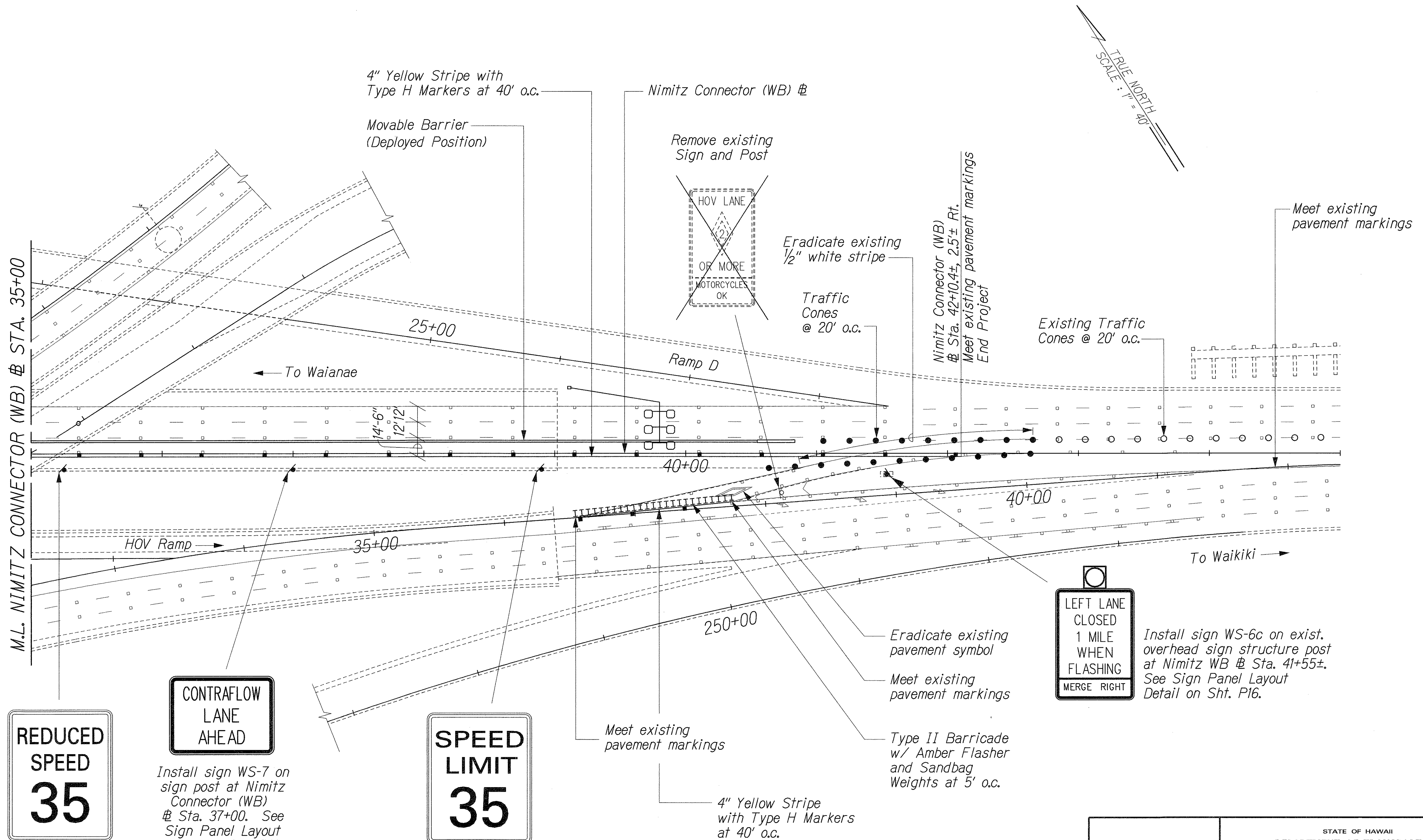

DESIGNED BY	DATE
TRACED BY	
DESIGNED BY	
QUANTITIES BY	
CHECKED BY	
ORIGINAL PLAN	
NOTE BOOK	

H-1 ZIPPER EXTENSION/SIGN/SS-14.dgn

REDUCED SPEED 35

48"x60"
Install sign R2-5b(35)-A on sign post at Nimitz Connector (WB) @ Sta. 35+25. See Parapet Mounted Sign Support Details on Sht. S13.

CONTRAFLOW LANE AHEAD

Install sign WS-7 on sign post at Nimitz Connector (WB) @ Sta. 37+00. See Sign Panel Layout Detail on Sht. P16. See Parapet Mounted Sign Support Details on Sht. S13.

SPEED LIMIT 35

48"x60"
Install sign R2-1(35)-A on sign post at Nimitz Connector (WB) @ Sta. 38+90. See Parapet Mounted Sign Support Details on Sht. S13.

LEFT LANE CLOSED 1 MILE WHEN FLASHING MERGE RIGHT

Install sign WS-6c on exist. overhead sign structure post at Nimitz WB @ Sta. 41+55±. See Sign Panel Layout Detail on Sht. P16.

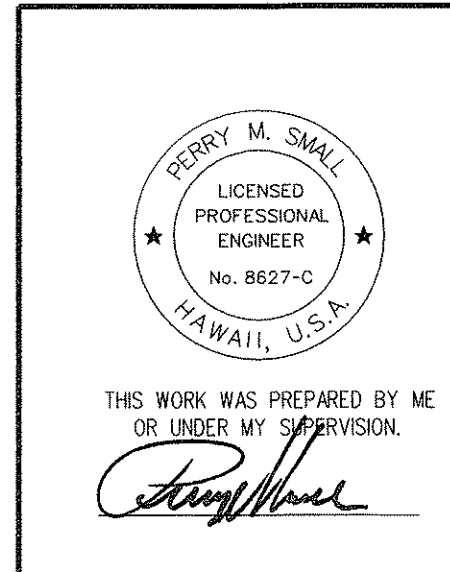

STATE OF HAWAII
DEPARTMENT OF TRANSPORTATION
HIGHWAYS DIVISION
SIGNING AND PAVEMENT MARKINGS
NIMITZ OB @ STA. 35+00 TO 45+00
INTERSTATE ROUTE H-1 ZIPPER LANE EXTENSION
RADFORD DRIVE OVERPASS TO KEEHI INTERCHANGE
FEDERAL AID PROJECT NO. NH-HI-1(246)
Scale: 1" = 40' Date: Mar. 2, 2004