

**LEGEND:**

- Temporary construction sign w/ post
- Temporary construction sign w/ two posts
- 28" Traffic cones w/ retroreflective bands
- 48" Delineators w/ retroreflective bands
- Type II barricade w/ lamp
- Type III barricade w/ lamp
- Flashing arrow board
- High level warning device (Flag Tree)
- Work Zone Area

FED. ROAD DIST. NO.	STATE	PROJ. NO.	FISCAL YEAR	SHEET NO.	TOTAL SHEETS
HAWAII	HAWAII	H1A-01-02M	2003	18	88

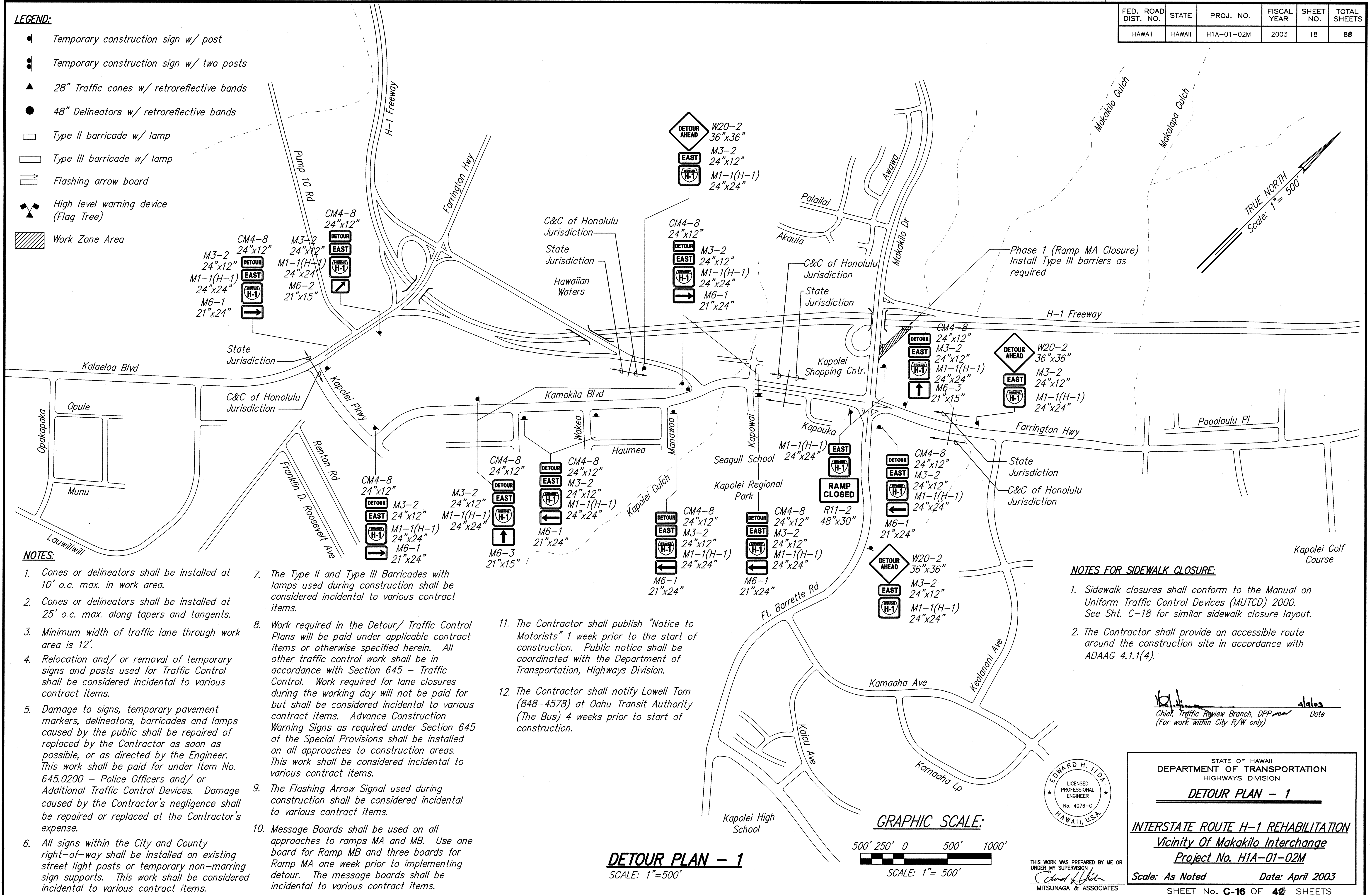

**NOTES:**

- Cones or delineators shall be installed at 10' o.c. max. in work area.
- Cones or delineators shall be installed at 25' o.c. max. along tapers and tangents.
- Minimum width of traffic lane through work area is 12'.
- Relocation and/ or removal of temporary signs and posts used for Traffic Control shall be considered incidental to various contract items.
- Damage to signs, temporary pavement markers, delineators, barricades and lamps caused by the public shall be repaired or replaced by the Contractor as soon as possible, or as directed by the Engineer. This work shall be paid for under Item No. 645.0200 - Police Officers and/ or Additional Traffic Control Devices. Damage caused by the Contractor's negligence shall be repaired or replaced at the Contractor's expense.
- All signs within the City and County right-of-way shall be installed on existing street light posts or temporary non-marring sign supports. This work shall be considered incidental to various contract items.
- The Type II and Type III Barricades with lamps used during construction shall be considered incidental to various contract items.
- Work required in the Detour/ Traffic Control Plans will be paid under applicable contract items or otherwise specified herein. All other traffic control work shall be in accordance with Section 645 - Traffic Control. Work required for lane closures during the working day will not be paid for but shall be considered incidental to various contract items. Advance Construction Warning Signs as required under Section 645 of the Special Provisions shall be installed on all approaches to construction areas. This work shall be considered incidental to various contract items.
- The Flashing Arrow Signal used during construction shall be considered incidental to various contract items.
- Message Boards shall be used on all approaches to ramps MA and MB. Use one board for Ramp MB and three boards for Ramp MA one week prior to implementing detour. The message boards shall be incidental to various contract items.

- The Contractor shall publish "Notice to Motorists" 1 week prior to the start of construction. Public notice shall be coordinated with the Department of Transportation, Highways Division.
- The Contractor shall notify Lowell Tom (848-4578) at Oahu Transit Authority (The Bus) 4 weeks prior to start of construction.

**NOTES FOR SIDEWALK CLOSURE:**

- Sidewalk closures shall conform to the Manual on Uniform Traffic Control Devices (MUTCD) 2000. See Sht. C-18 for similar sidewalk closure layout.
- The Contractor shall provide an accessible route around the construction site in accordance with ADAAG 4.1.1(4).

*[Signature]*  
Chief, Traffic Review Branch, DPP  
(For work within City R/W only)

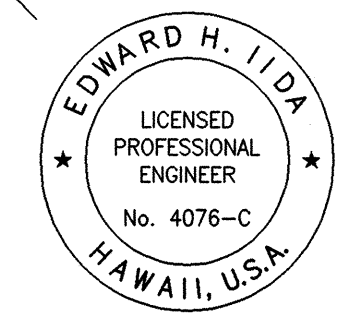

THIS WORK WAS PREPARED BY ME OR UNDER MY SUPERVISION  
*[Signature]*  
MITSUNAGA & ASSOCIATES

**DETOUR PLAN - 1**  
SCALE: 1"=500'

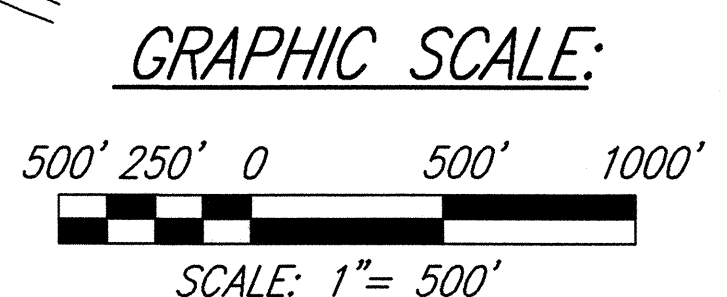

STATE OF HAWAII  
DEPARTMENT OF TRANSPORTATION  
HIGHWAYS DIVISION  
**DETOUR PLAN - 1**  
**INTERSTATE ROUTE H-1 REHABILITATION**  
**Vicinity Of Makakilo Interchange**  
**Project No. H1A-01-02M**  
Scale: As Noted Date: April 2003  
SHEET No. C-16 OF 42 SHEETS

SURVEY PLOTTED BY	DATE
DRAWN BY	
TRACED BY	
QUANTITIES BY	
CHECKED BY	
ORIGINAL PLAN	
NOTE BOOK	
No.	

FED. ROAD DIST. NO.	STATE	PROJ. NO.	FISCAL YEAR	SHEET NO.	TOTAL SHEETS
HAWAII	HAWAII	H1A-01-02M	2003	19	88

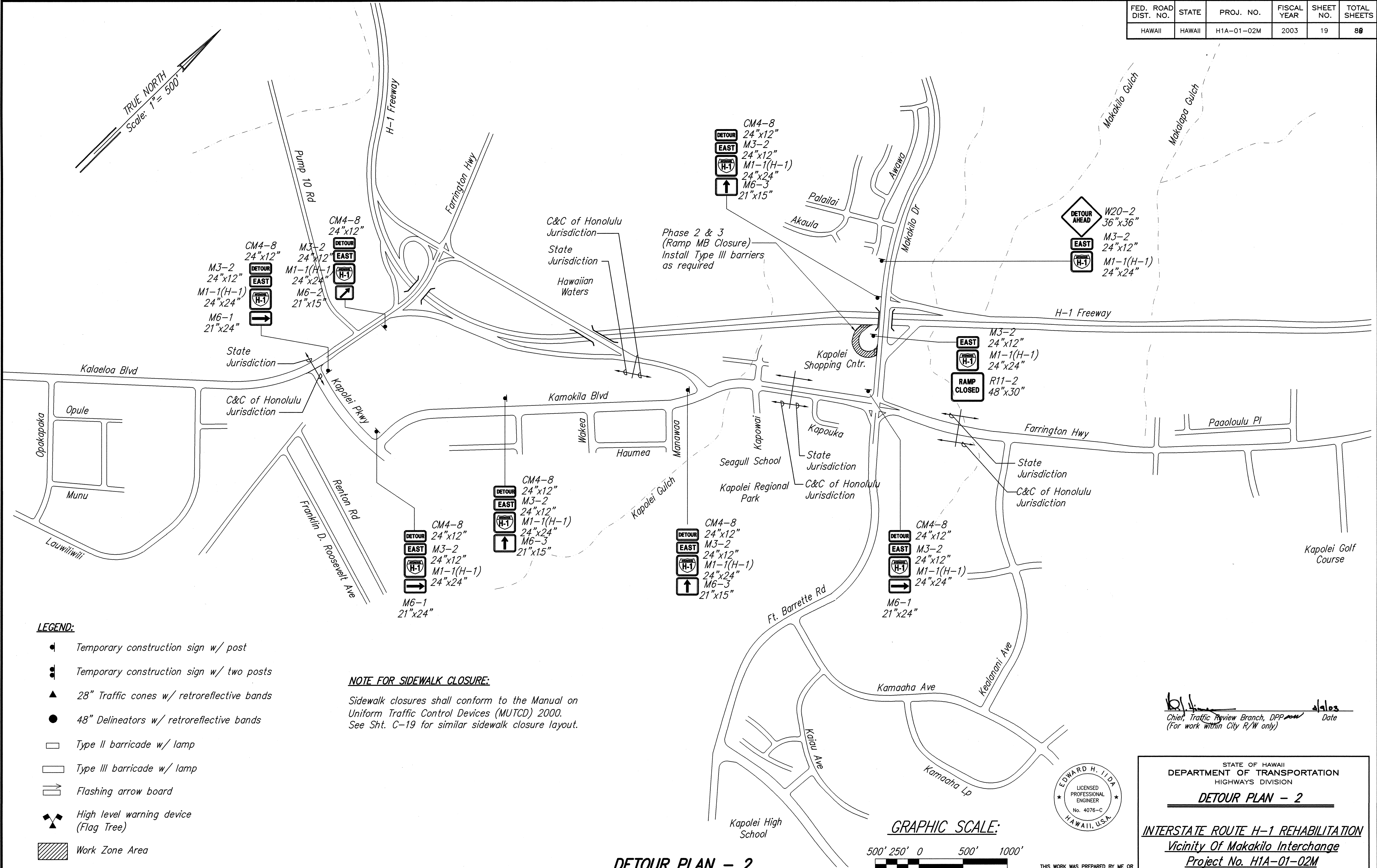

LEGEND:

- Temporary construction sign w/ post
- Temporary construction sign w/ two posts
- 28" Traffic cones w/ retroreflective bands
- 48" Delineators w/ retroreflective bands
- Type II barricade w/ lamp
- Type III barricade w/ lamp
- Flashing arrow board
- High level warning device (Flag Tree)
- Work Zone Area

NOTE FOR SIDEWALK CLOSURE:

Sidewalk closures shall conform to the Manual on Uniform Traffic Control Devices (MUTCD) 2000. See Sht. C-19 for similar sidewalk closure layout.

GRAPHIC SCALE:

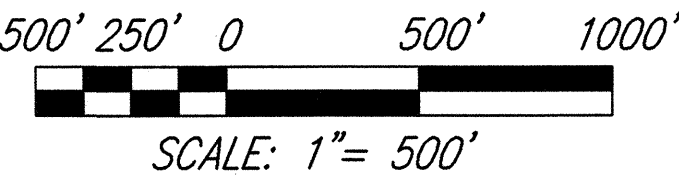

DETOUR PLAN - 2

SCALE: 1"=500'

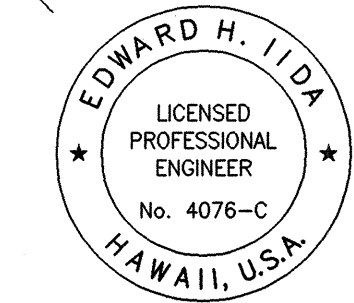

THIS WORK WAS PREPARED BY ME OR UNDER MY SUPERVISION  
*Edward H. Iida*  
MITSUNAGA & ASSOCIATES

STATE OF HAWAII  
DEPARTMENT OF TRANSPORTATION  
HIGHWAYS DIVISION

DETOUR PLAN - 2

INTERSTATE ROUTE H-1 REHABILITATION  
Vicinity Of Makakilo Interchange  
Project No. H1A-01-02M

Scale: As Noted Date: April 2003  
SHEET No. C-17 OF 42 SHEETS