

FED. ROAD DIST. NO.	STATE	FED. AID PROJ. NO.	FISCAL YEAR	SHEET NO.	TOTAL SHEETS
HAWAII	HAW.	IM-NH-H1-1(239)	2001	24	103

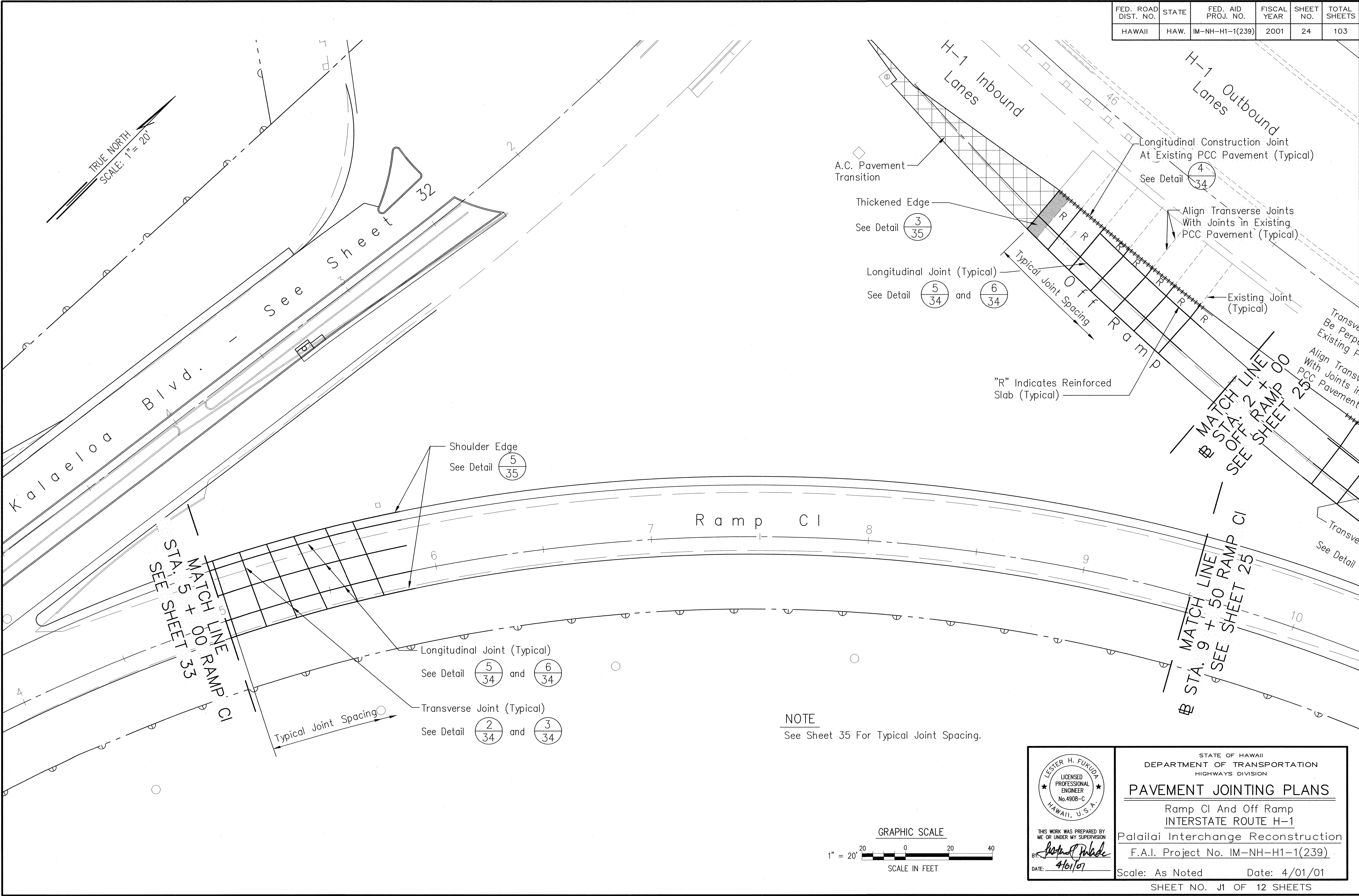

DATE: 06/28/99  
SCALE: 1" = 1'  
FILE: PI-Ramp-Joints.dwg  
JOB NO: 9810B

JUN LKH/PT\*/MAM  
PM: OPER: REVISED: 04/16/01

ORIGINAL PLAN	DATE
SURVEY PLOTTED BY	
DESIGNED BY	
TRACED BY	
DESIGNED BY	
QUANTITIES BY	
CHECKED BY	
No.	

FED. ROAD DIST. NO.	STATE	FED. AID PROJ. NO.	FISCAL YEAR	SHEET NO.	TOTAL SHEETS
HAWAII	HAW.	IM-NH-H1-1(239)	2001	25	103

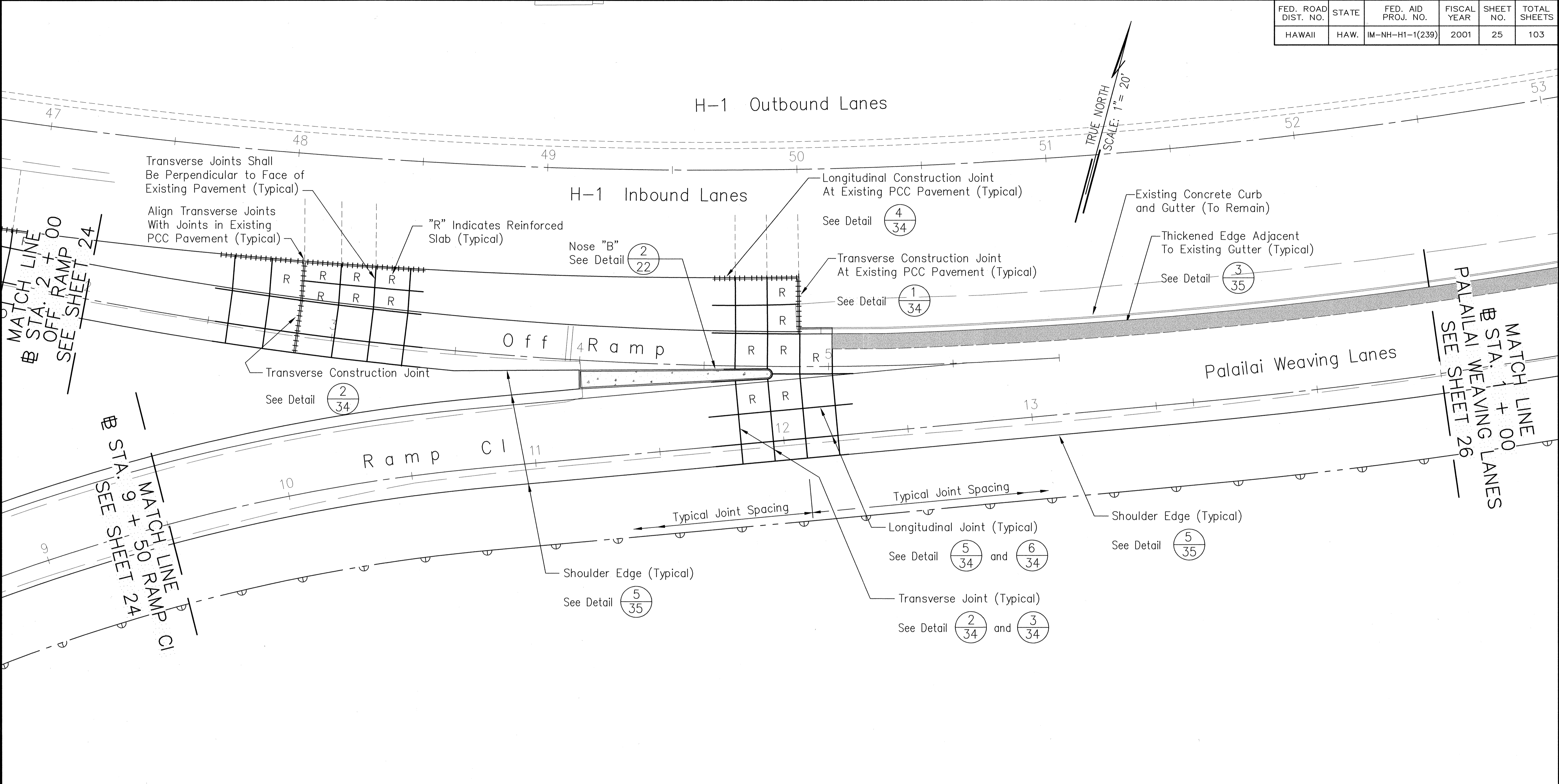

NOTE  
See Sheet 35 For Typical Joint Spacing.

ORIGINAL PLAN	DATE
NOTED	
DESIGNED BY	
QUANTITIES BY	
CHECKED BY	
No.	

DATE: 06/28/99  
 SCALE: 1" = 100'  
 FILE: PI-RAMP-JOINTS.DWG  
 JOB NO: 9810B

PM: JUN  
 OPER: LHK/PT\*/MAM  
 REVISED: 04/16/01

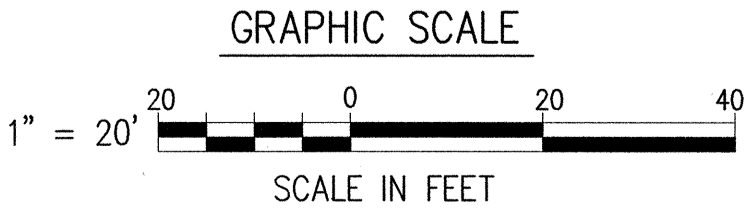

THIS WORK WAS PREPARED BY ME OR UNDER MY SUPERVISION

BY: *[Signature]*

DATE: 4/01/01

STATE OF HAWAII  
DEPARTMENT OF TRANSPORTATION  
HIGHWAYS DIVISION

**PAVEMENT JOINTING PLANS**

Off Ramp And Ramp CI  
INTERSTATE ROUTE H-1

Palailai Interchange Reconstruction

F.A.I. Project No. IM-NH-H1-1(239)

Scale: As Noted      Date: 4/01/01

SHEET NO. J2 OF 12 SHEETS

FED. ROAD DIST. NO.	STATE	FED. AID PROJ. NO.	FISCAL YEAR	SHEET NO.	TOTAL SHEETS
HAWAII	HAW.	IM-NH-H1-1(239)	2001	26	103

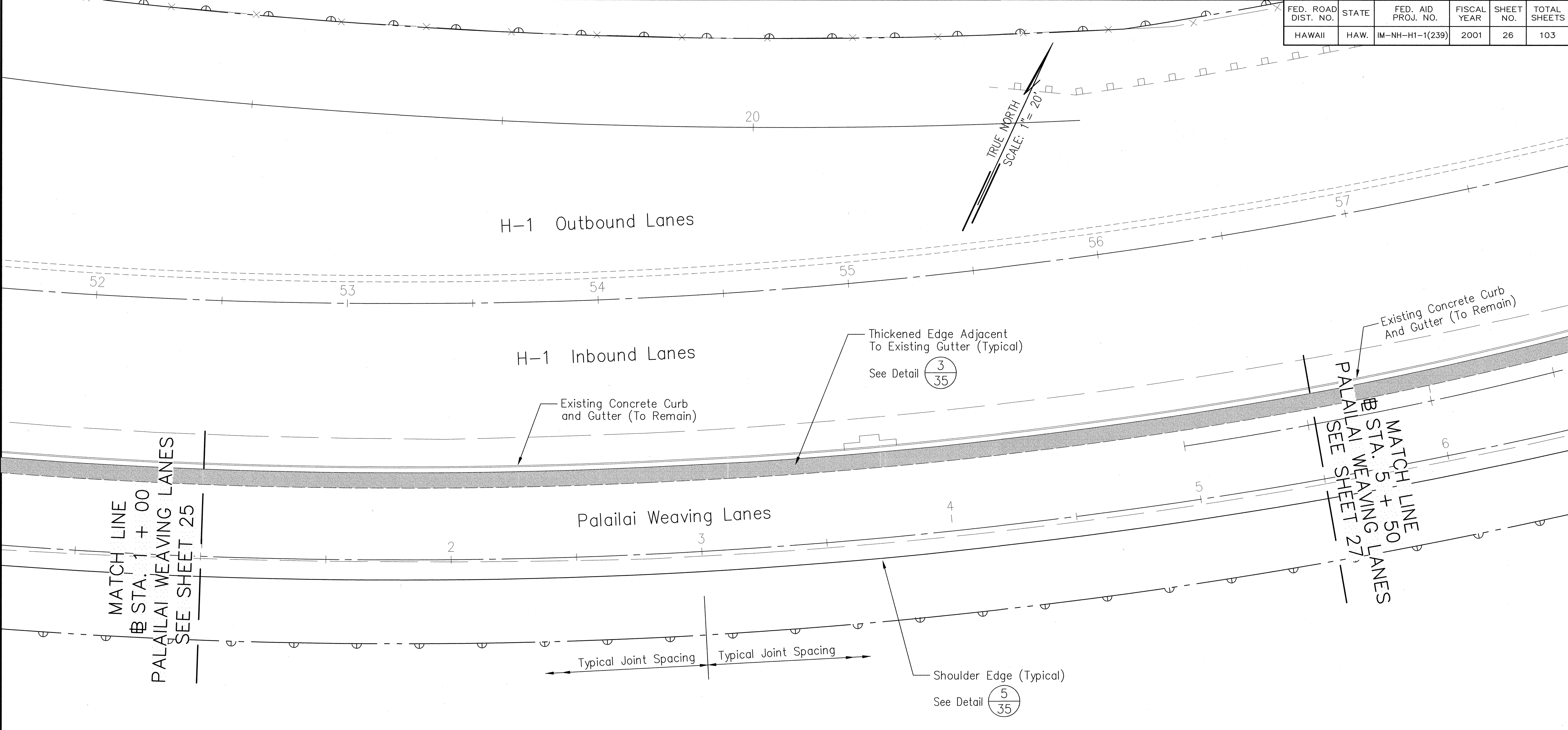

ORIGINAL PLAN	SURVEY PLOTTED BY	DATE
	DRAWN BY	
NOTEBOOK	TRACED BY	
	DESIGNED BY	
No.	QUANTITIES BY	
	CHECKED BY	

DATE: 06/28/99  
 SCALE: 1" = 1  
 FILE: PI-Ramp-Joints.dwg  
 JOB NO: 9810B

NOTE  
 See Sheet 35 For Typical Joint Spacing.

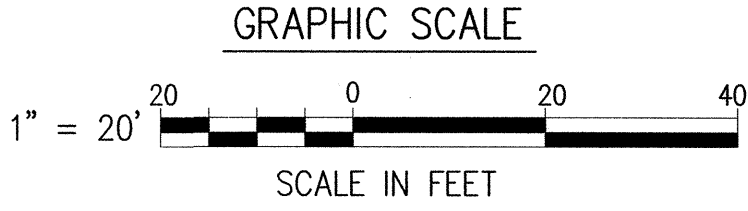

THIS WORK WAS PREPARED BY ME OR UNDER MY SUPERVISION

BY: *Lester H. Fukuda*  
 DATE: 4/1/01

STATE OF HAWAII  
 DEPARTMENT OF TRANSPORTATION  
 HIGHWAYS DIVISION

**PAVEMENT JOINTING PLANS**

Palailai Weaving Lanes  
 INTERSTATE ROUTE H-1  
 Palailai Interchange Reconstruction

F.A.I. Project No. IM-NH-H1-1(239)

Scale: As Noted      Date: 4/01/01

SHEET NO. J3 OF 12 SHEETS

FED. ROAD DIST. NO.	STATE	FED. AID PROJ. NO.	FISCAL YEAR	SHEET NO.	TOTAL SHEETS
HAWAII	HAW.	IM-NH-H1-1(239)	2001	27	103

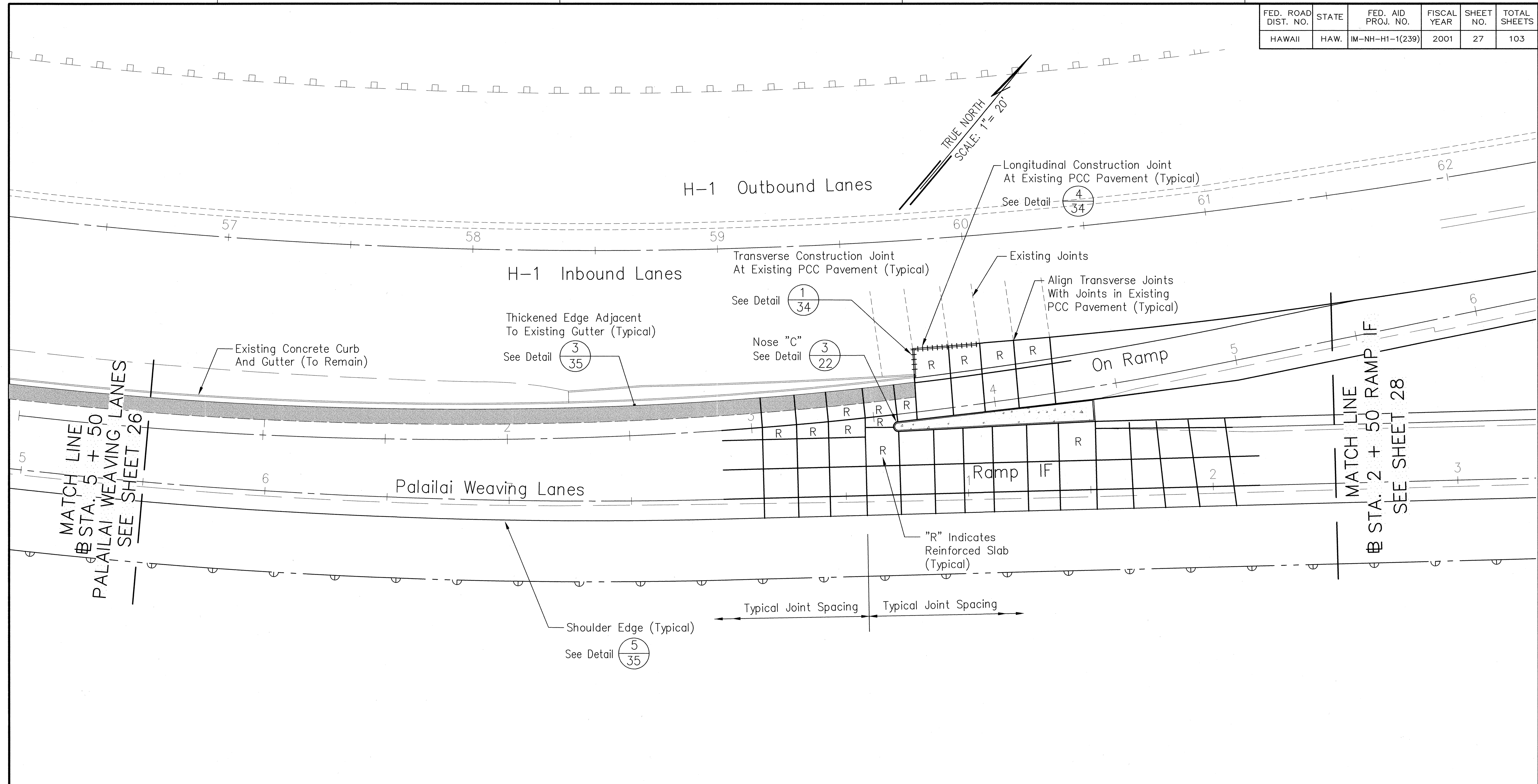

DATE: 06/28/99  
 SCALE: 1" = 1'  
 FILE: PI-Ramp-Joints.dwg  
 JOB NO: 9810B

SURVEY DATED BY	DATE
DRAWN BY	
DESIGNED BY	
QUANTITIES BY	
CHECKED BY	

NOTE  
 See Sheet 35 For Typical Joint Spacing.

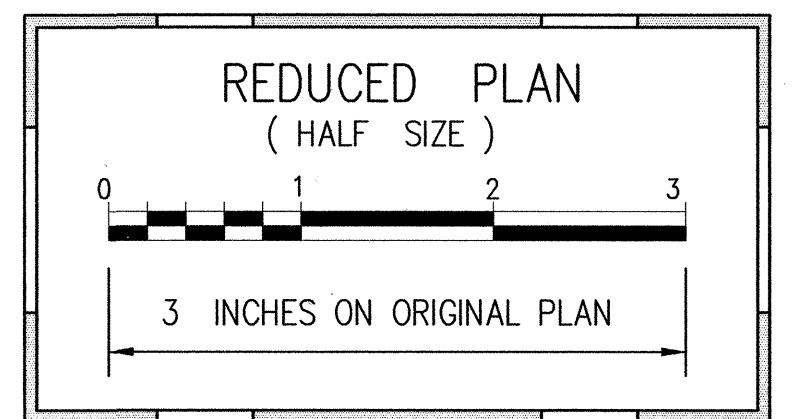
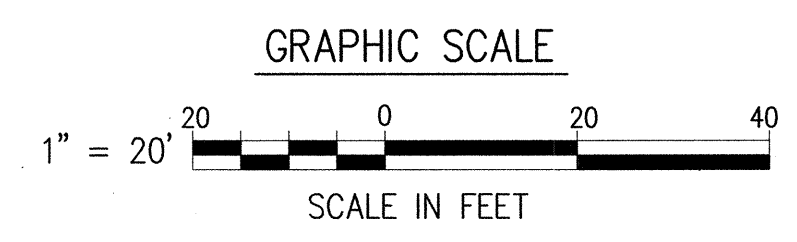

STATE OF HAWAII  
 DEPARTMENT OF TRANSPORTATION  
 HIGHWAYS DIVISION

**PAVEMENT JOINTING PLANS**

Palailai Weaving Lanes, On Ramp & Ramp IF  
 INTERSTATE ROUTE H-1

Palailai Interchange Reconstruction  
 F.A.I. Project No. IM-NH-H1-1(239)

Scale: As Noted      Date: 4/01/01

SHEET NO. J4 OF 12 SHEETS

LESTER H. FUKUDA  
 LICENSED PROFESSIONAL ENGINEER  
 No. 4908-C  
 HAWAII, U.S.A.

THIS WORK WAS PREPARED BY ME OR UNDER MY SUPERVISION

*[Signature]*  
 DATE: 4/01/01

FED. ROAD DIST. NO.	STATE	FED. AID PROJ. NO.	FISCAL YEAR	SHEET NO.	TOTAL SHEETS
HAWAII	HAW.	IM-NH-H1-1(239)	2001	28	103

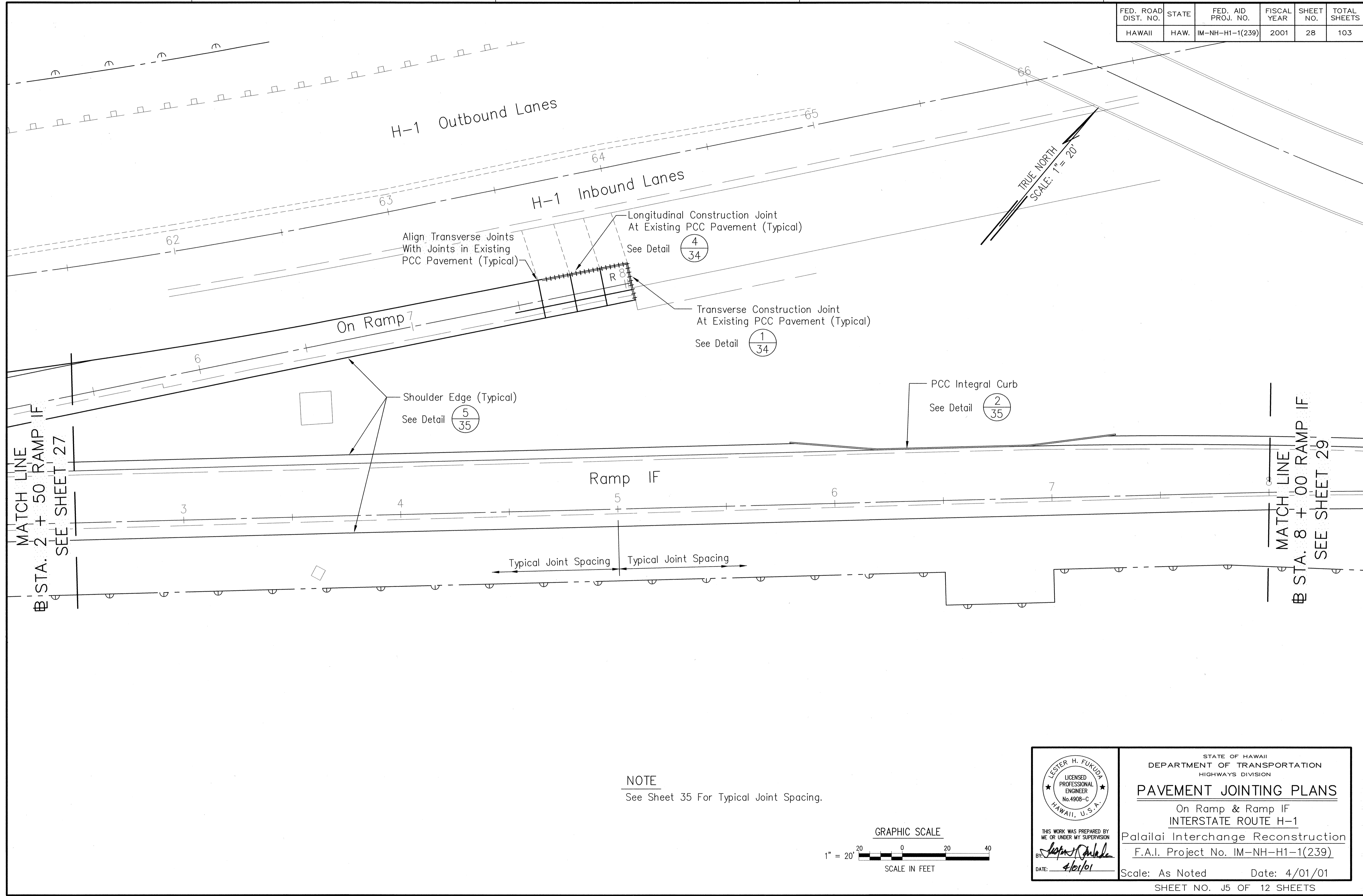

ORIGINAL PLAN	DATE
DESIGNED BY	
NOTED BY	
CHECKED BY	
DATE	

DATE: 06/28/99  
 SCALE: 1" = 1'  
 FILE: PI-Ramp-Joints.dwg  
 JOB NO: 9810B

**NOTE**  
 See Sheet 35 For Typical Joint Spacing.

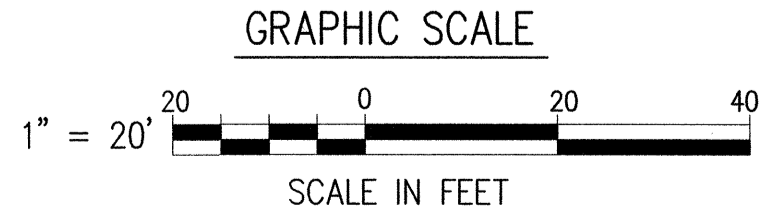

THIS WORK WAS PREPARED BY ME OR UNDER MY SUPERVISION  
 BY: *Lester H. Fukuda*  
 DATE: 4/01/01

STATE OF HAWAII  
 DEPARTMENT OF TRANSPORTATION  
 HIGHWAYS DIVISION

**PAVEMENT JOINTING PLANS**

On Ramp & Ramp IF  
 INTERSTATE ROUTE H-1  
 Palailai Interchange Reconstruction  
 F.A.I. Project No. IM-NH-H1-1(239)

Scale: As Noted      Date: 4/01/01

SHEET NO. J5 OF 12 SHEETS

FED. ROAD DIST. NO.	STATE	FED. AID PROJ. NO.	FISCAL YEAR	SHEET NO.	TOTAL SHEETS
HAWAII	HAW.	IM-NH-H1-1(239)	2001	29	103

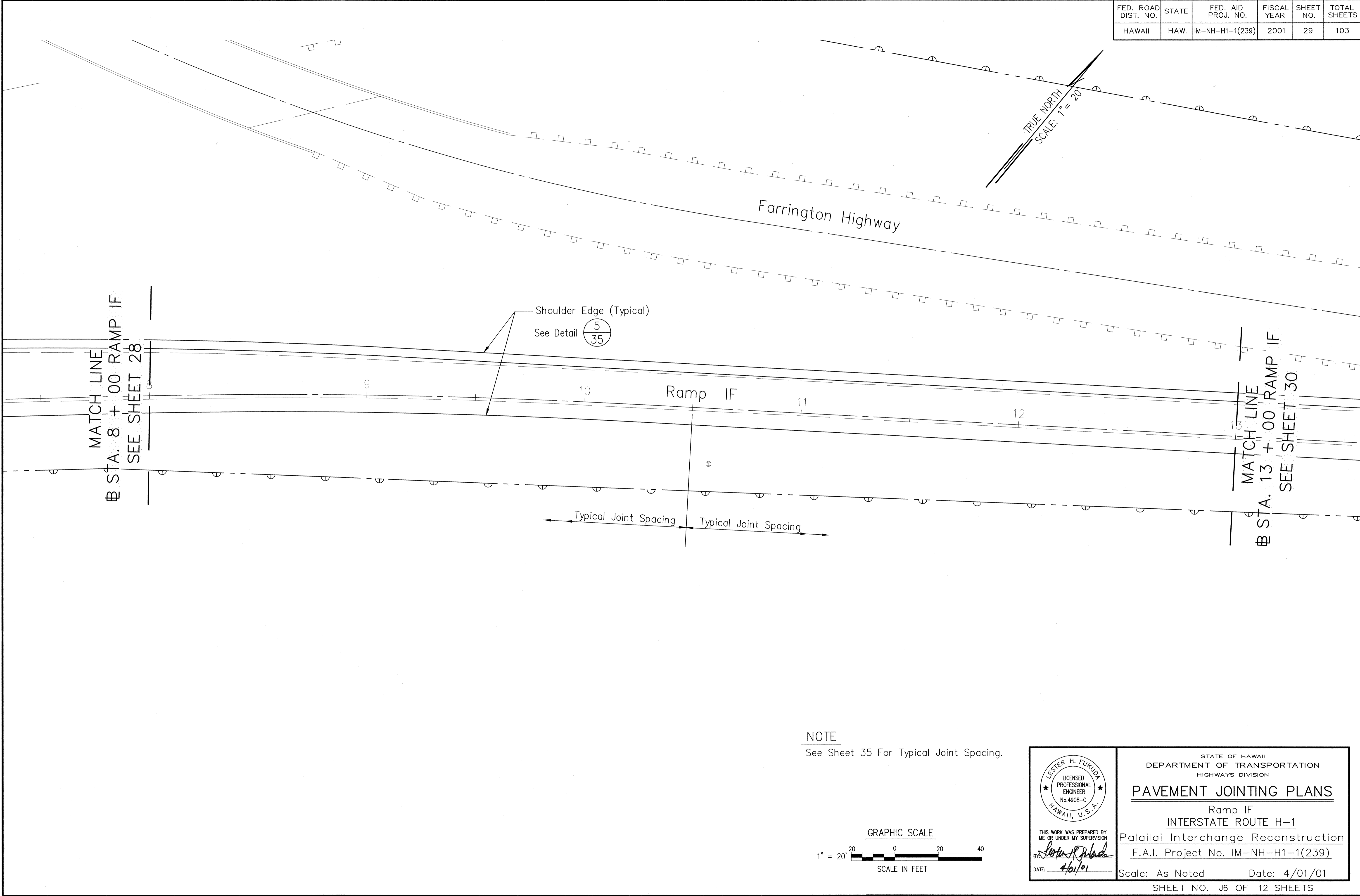

FED. ROAD DIST. NO.	STATE	FED. AID PROJ. NO.	FISCAL YEAR	SHEET NO.	TOTAL SHEETS
HAWAII	HAW.	IM-NH-H1-1(239)	2001	30	103

TRUE NORTH  
SCALE: 1" = 20'

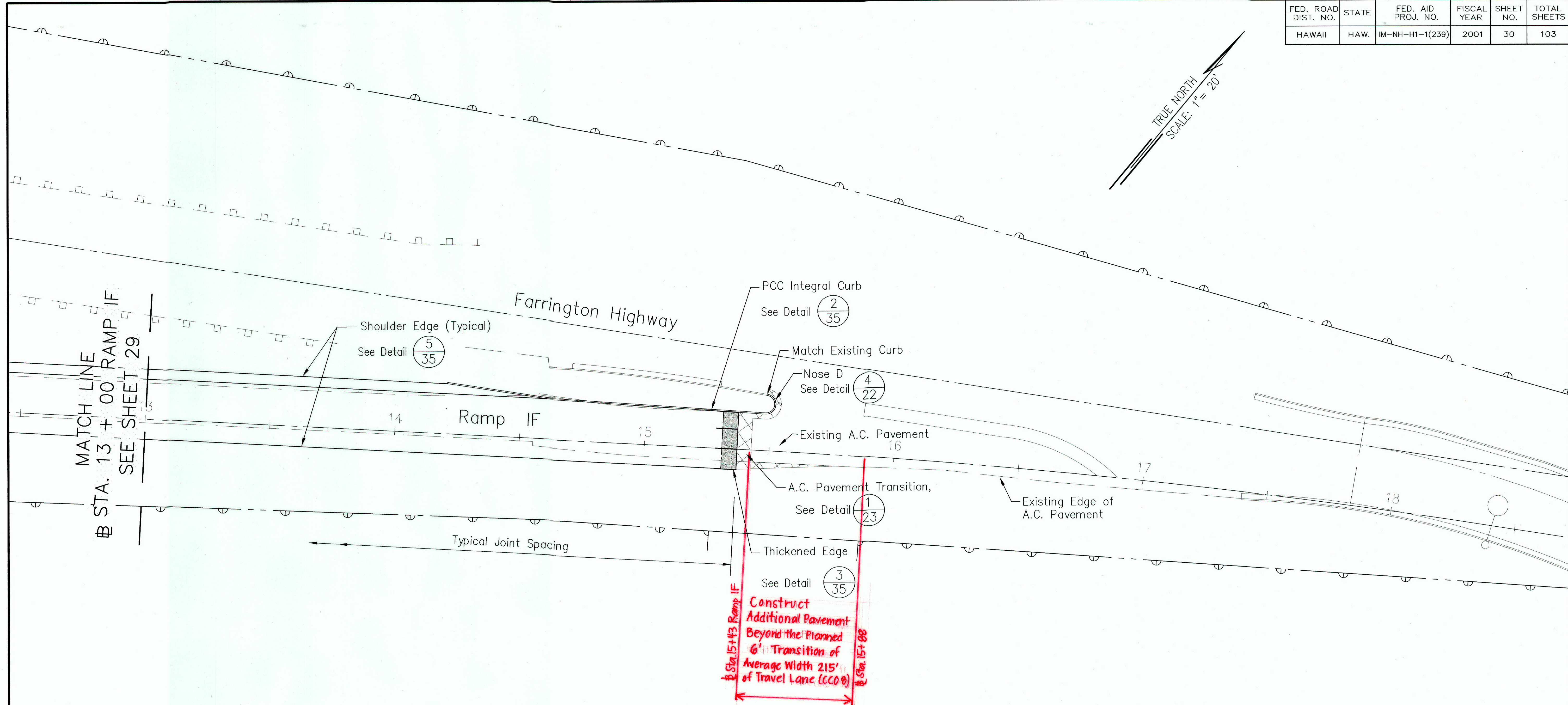

Construct Additional Pavement Beyond the Planned 6' Transition of Average Width 215' of Travel Lane (CCO @)

NOTE  
See Sheet 35 For Typical Joint Spacing.

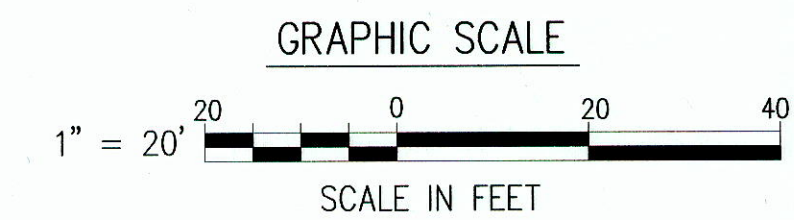

THIS WORK WAS PREPARED BY ME OR UNDER MY SUPERVISION  
BY: *[Signature]*  
DATE: 4/1/01

STATE OF HAWAII  
DEPARTMENT OF TRANSPORTATION  
HIGHWAYS DIVISION

**PAVEMENT JOINTING PLANS**

Ramp IF  
INTERSTATE ROUTE H-1  
Palailai Interchange Reconstruction  
F.A.I. Project No. IM-NH-H1-1(239)

Scale: As Noted      Date: 4/01/01

SHEET NO. J7 OF 12 SHEETS

SURVEY PLOTTED BY	DATE
DRAWN BY	
DESIGNED BY	
NOTED BY	
CHECKED BY	
No.	

DATE: 06/28/99  
SCALE: 1" = 1'  
FILE: PI-Ramp-Joints.dwg  
JOB NO: 9810B

JUN  
LKH/PT\*/MAM  
OPER:  
REVISED: 04/16/01

"AS-BUILT"

FED. ROAD DIST. NO.	STATE	FED. AID PROJ. NO.	FISCAL YEAR	SHEET NO.	TOTAL SHEETS
HAWAII	HAW.	IM-NH-H1-1(239)	2001	31	103

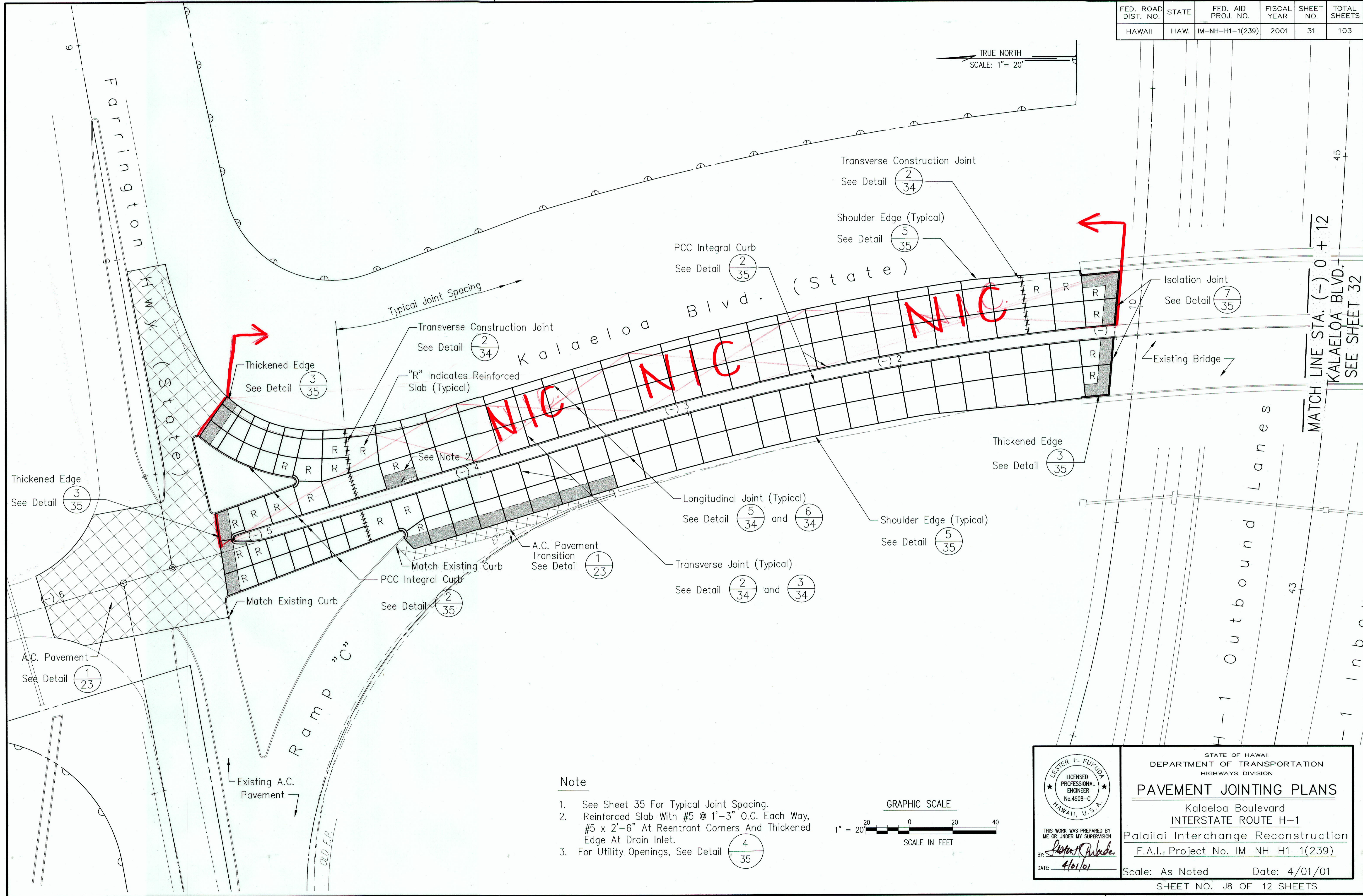

DATE: 11/11/98  
 SCALE: 1" = 1'  
 FILE: P1-layout joints.dwg  
 JOB NO: 9810B

ORIGINAL PLAN	SURVEY PLOTTED BY	DATE
NOTED BY	DRAWN BY	
DESIGNED BY	TRACED BY	
CHECKED BY	QUANTITIES BY	

- Note
- See Sheet 35 For Typical Joint Spacing.
  - Reinforced Slab With #5 @ 1'-3" O.C. Each Way, #5 x 2'-6" At Reentrant Corners And Thickened Edge At Drain Inlet.
  - For Utility Openings, See Detail (4/35)

LESTER H. FUKUDA  
 LICENSED PROFESSIONAL ENGINEER  
 No. 4908-C  
 HAWAII, U.S.A.

STATE OF HAWAII  
 DEPARTMENT OF TRANSPORTATION  
 HIGHWAYS DIVISION

**PAVEMENT JOINTING PLANS**

Kalaeloa Boulevard  
 INTERSTATE ROUTE H-1  
 Palilali Interchange Reconstruction  
 F.A.I. Project No. IM-NH-H1-1(239)

Scale: As Noted      Date: 4/01/01

SHEET NO. J8 OF 12 SHEETS

"AS-BUILT"

FED. ROAD DIST. NO.	STATE	FED. AID PROJ. NO.	FISCAL YEAR	SHEET NO.	TOTAL SHEETS
HAWAII	HAW.	IM-NH-H1-1(239)	2001	32	103

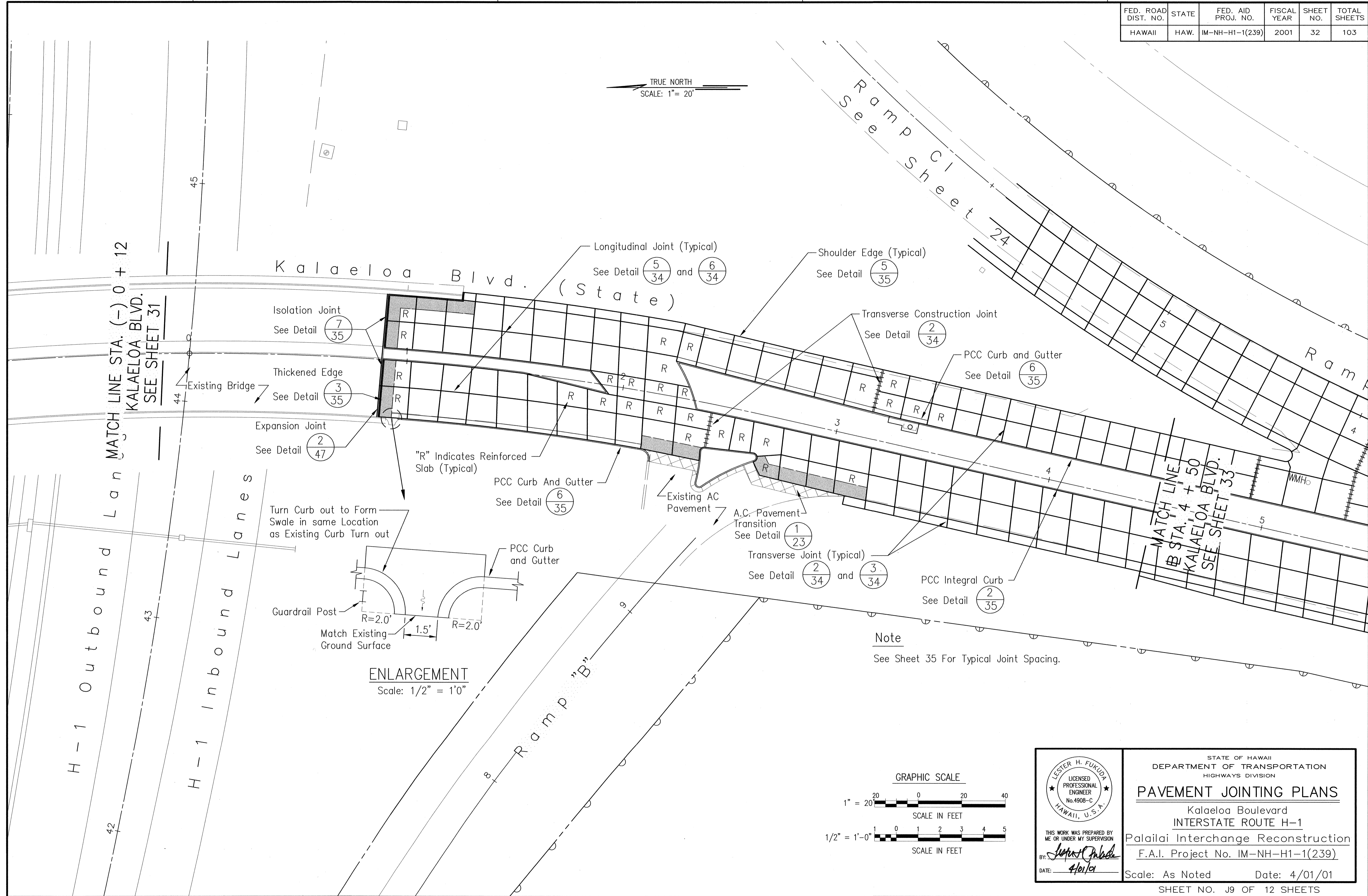

SURVEY PLOTTED BY	DATE
ORIGINAL PLAN	
DESIGNED BY	
NOTED BY	
CHECKED BY	
DATE	

DATE: 11/11/98  
SCALE: 1" = 1'  
FILE: PI-layout\_joints.dwg  
JOB NO: 9810B

JUN  
LKH/PT\*/MAM  
OPER:  
REVISED: 04/16/01

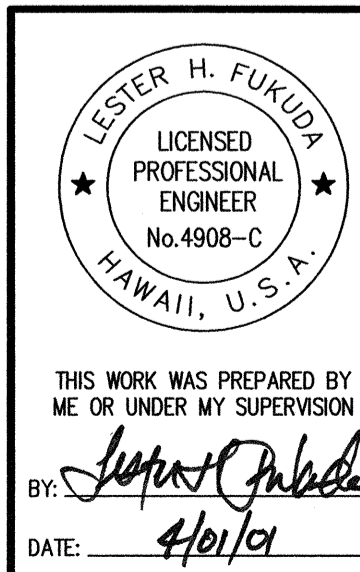
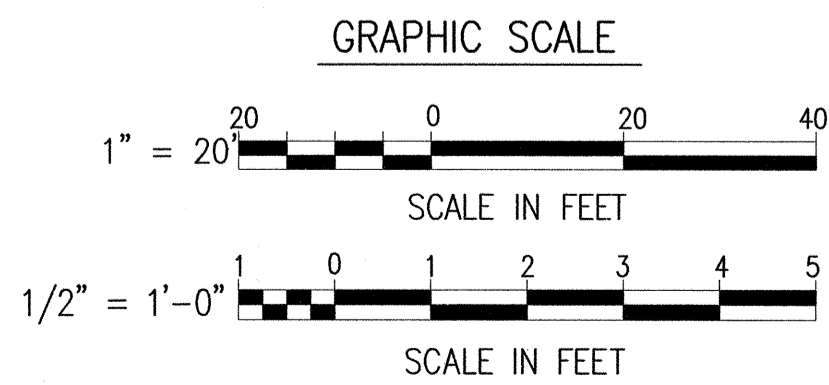

STATE OF HAWAII  
DEPARTMENT OF TRANSPORTATION  
HIGHWAYS DIVISION

**PAVEMENT JOINTING PLANS**

Kalaeloa Boulevard  
INTERSTATE ROUTE H-1  
Palailai Interchange Reconstruction  
F.A.I. Project No. IM-NH-H1-1(239)

Scale: As Noted Date: 4/01/01

SHEET NO. J9 OF 12 SHEETS

FED. ROAD DIST. NO.	STATE	FED. AID PROJ. NO.	FISCAL YEAR	SHEET NO.	TOTAL SHEETS
HAWAII	HAW.	IM-NH-H1-1(239)	2001	33	103

Note

- For WIM Plate Locations, See Sheet No 98. Joint Locations Shall Conform To Manufacturer's Requirements.
- 1 1/2" Diameter PVC Drain Per WIM Manufacturer's Requirements. Connect Drain To Underdrain System. Drain Shall Be Cast In Pavement Slab.

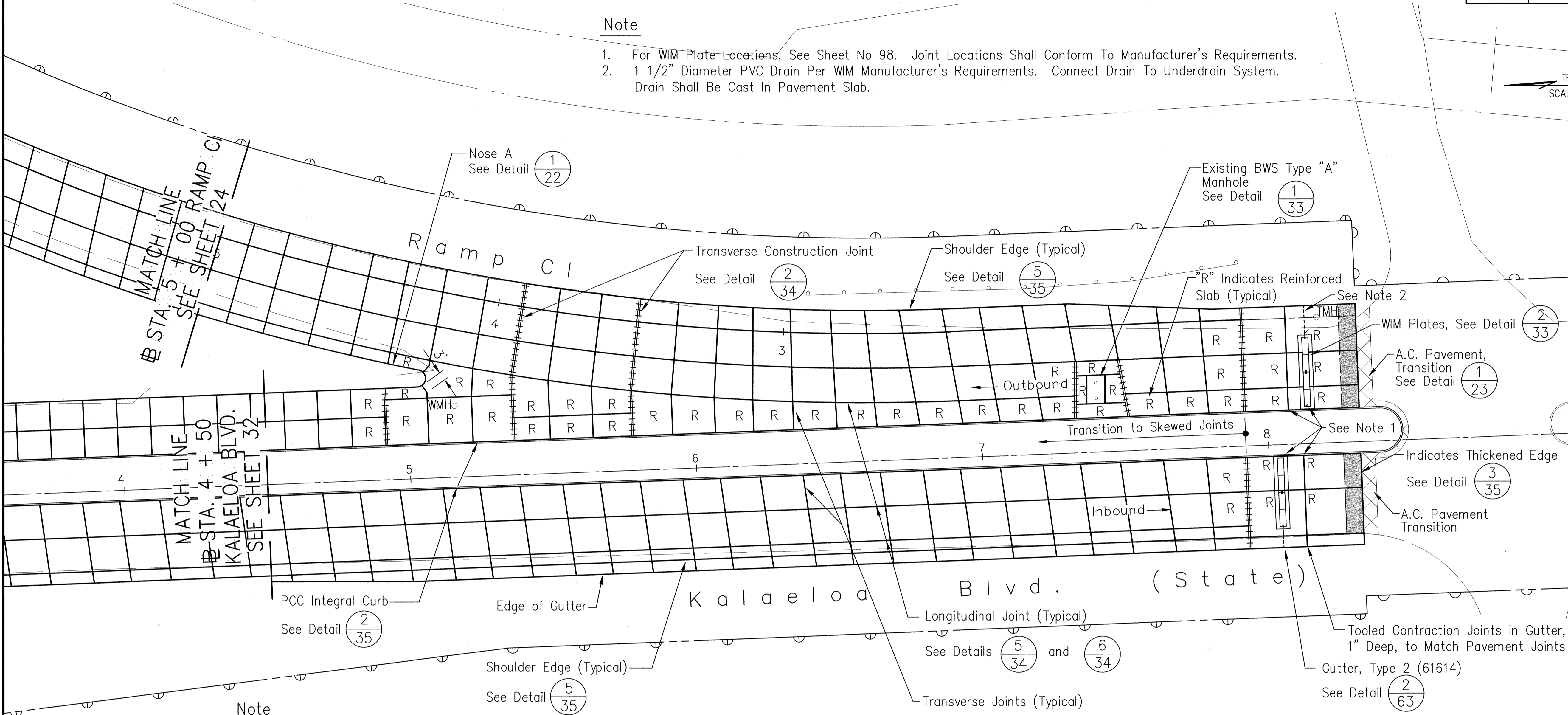
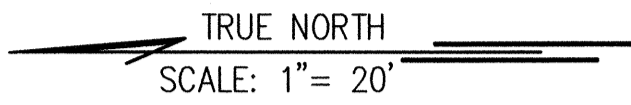

Note

- See Sheet 35 For Typical Joint Spacing.
- for Utility Openings, See Detail (4/35)

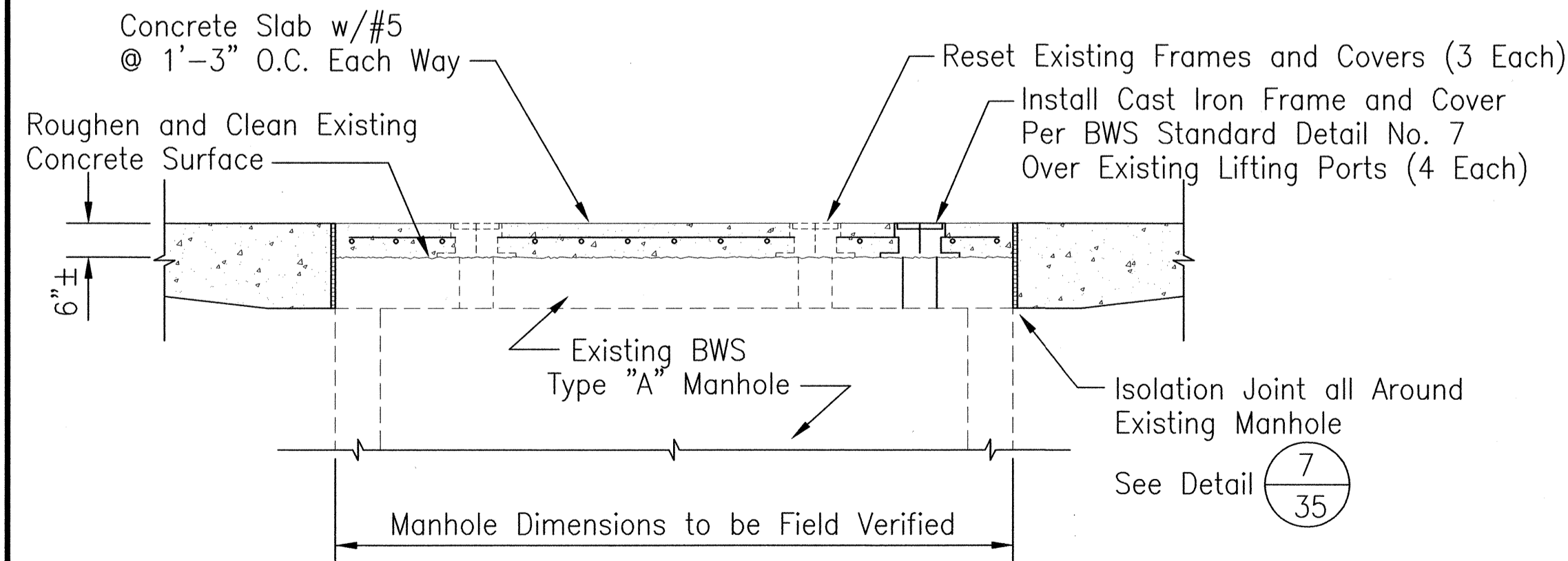

1  
33 EXISTING MANHOLE DETAIL  
SCALE: 1/2" = 1'-0"

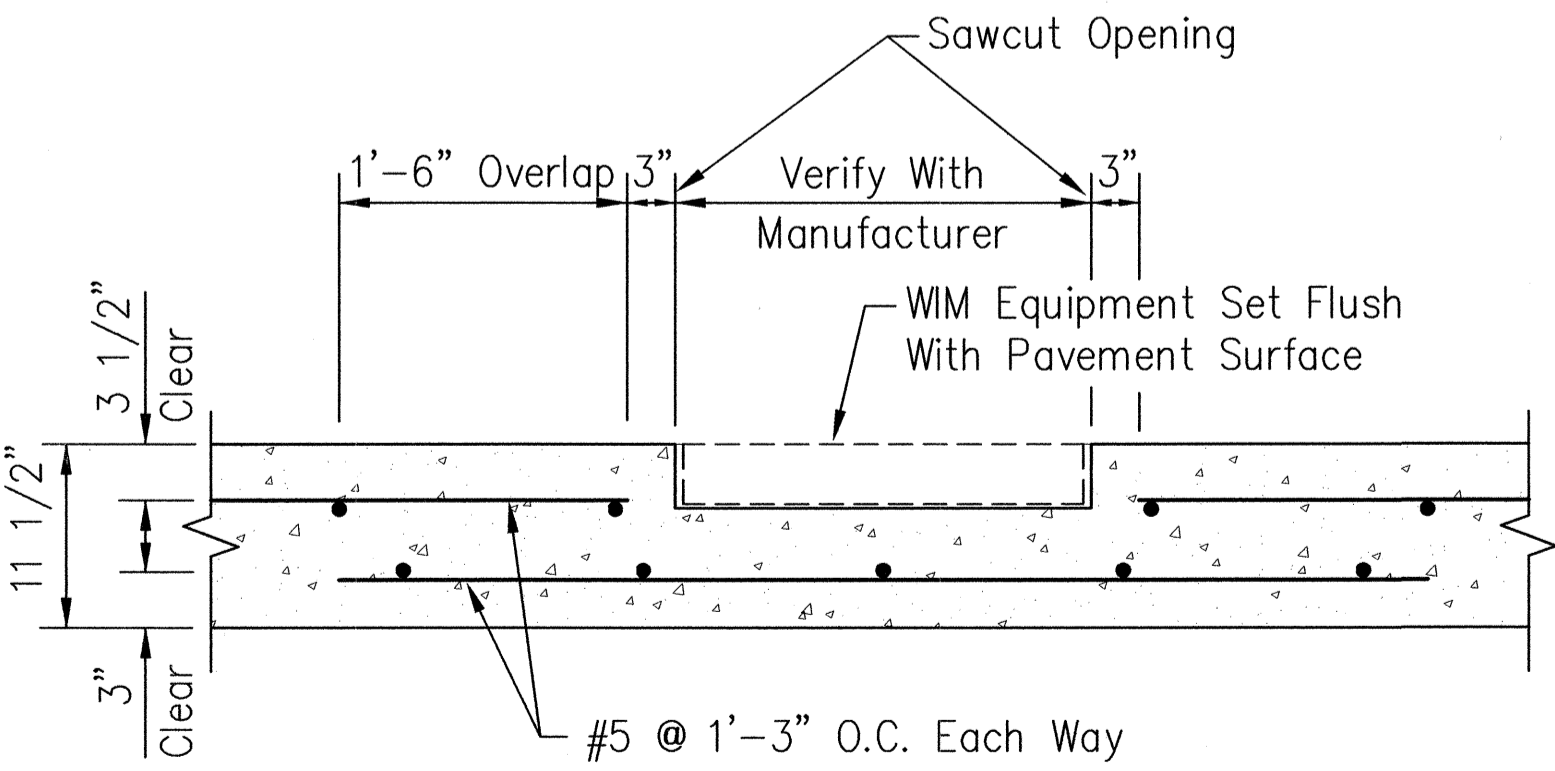

2  
33 SLAB REINFORCING AT WIM  
SCALE : 1" = 1' - 0"

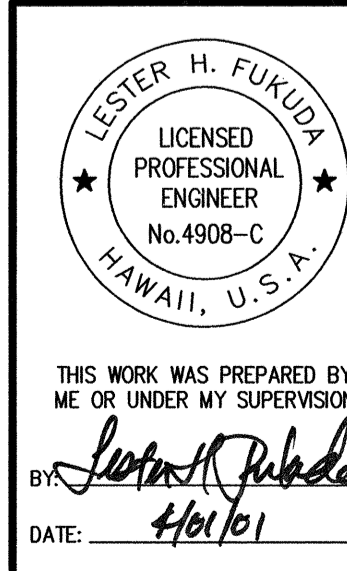
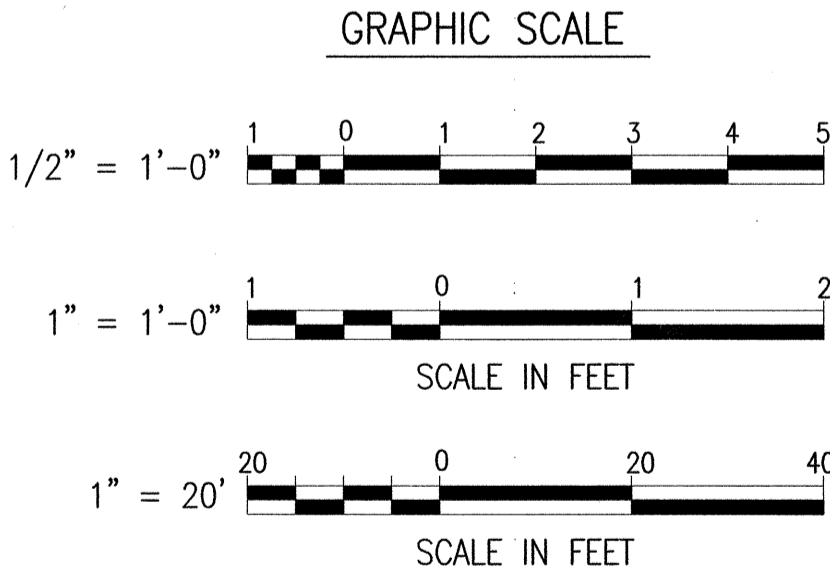

STATE OF HAWAII  
DEPARTMENT OF TRANSPORTATION  
HIGHWAYS DIVISION  
**PAVEMENT JOINTING PLANS**  
Kalaeloa Boulevard  
INTERSTATE ROUTE H-1  
Palailai Interchange Reconstruction  
F.A.I. Project No. IM-NH-H1-1(239)  
Scale: As Noted Date: 4/01/01  
SHEET NO. J10 OF 12 SHEETS

DATE: 11/11/98	JUN
SCALE: 1" = 1'	LKH/PT*/MAM
FILE: PI-layout joints.dwg	OPER:
REVISION: 04/25/01	REVISOR:
JOB NO: 9810B	CHECKED BY:
SURVEY PLOTTED BY:	DATE:
DRAWN BY:	DATE:
DESIGNED BY:	DATE:
CHECKED BY:	DATE:
ORIGINAL PLAN	DATE:
NOTES	DATE:
No.	DATE:



FED. ROAD DIST. NO.	STATE	FED. AID PROJ. NO.	FISCAL YEAR	SHEET NO.	TOTAL SHEETS
HAWAII	HAW.	IM-NH-H1-1(239)	2001	35	103

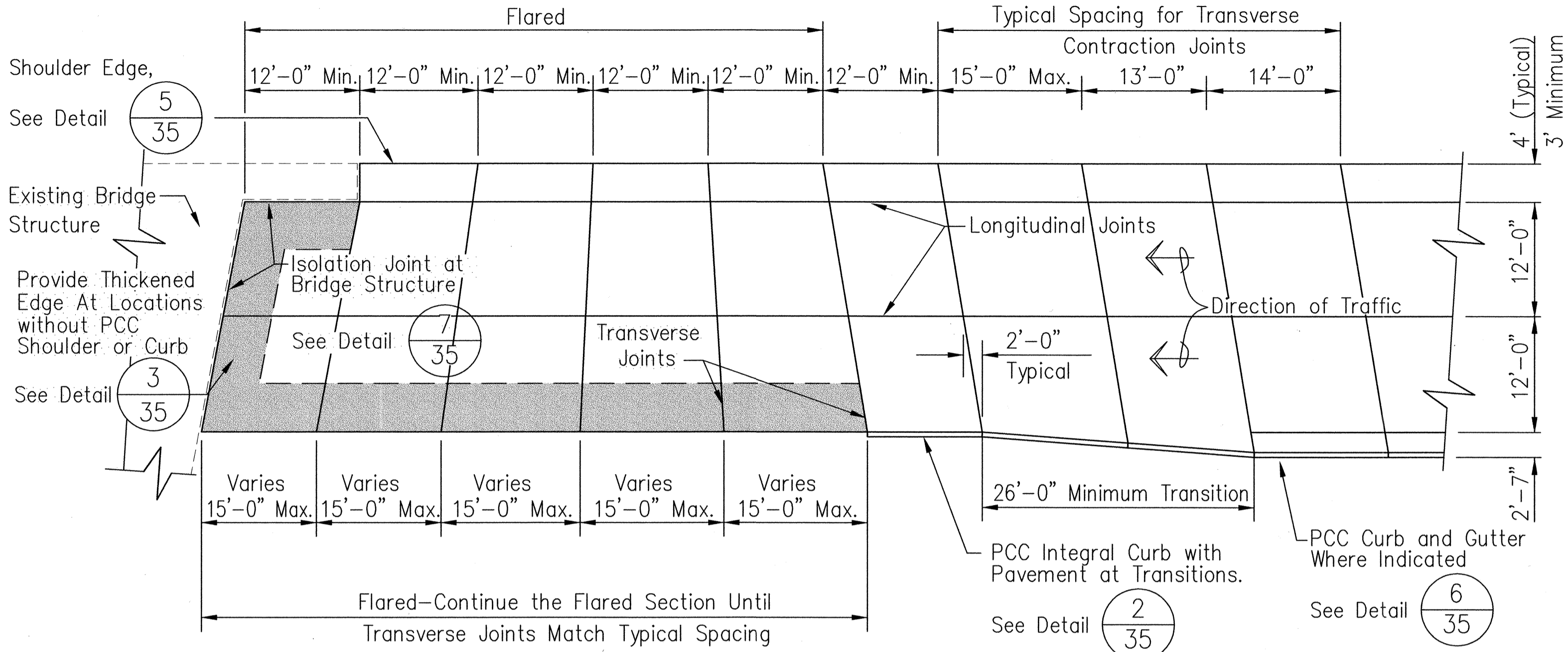

1 TYPICAL JOINT LOCATION AND LAYOUT PLAN  
Scale : 1" = 10'

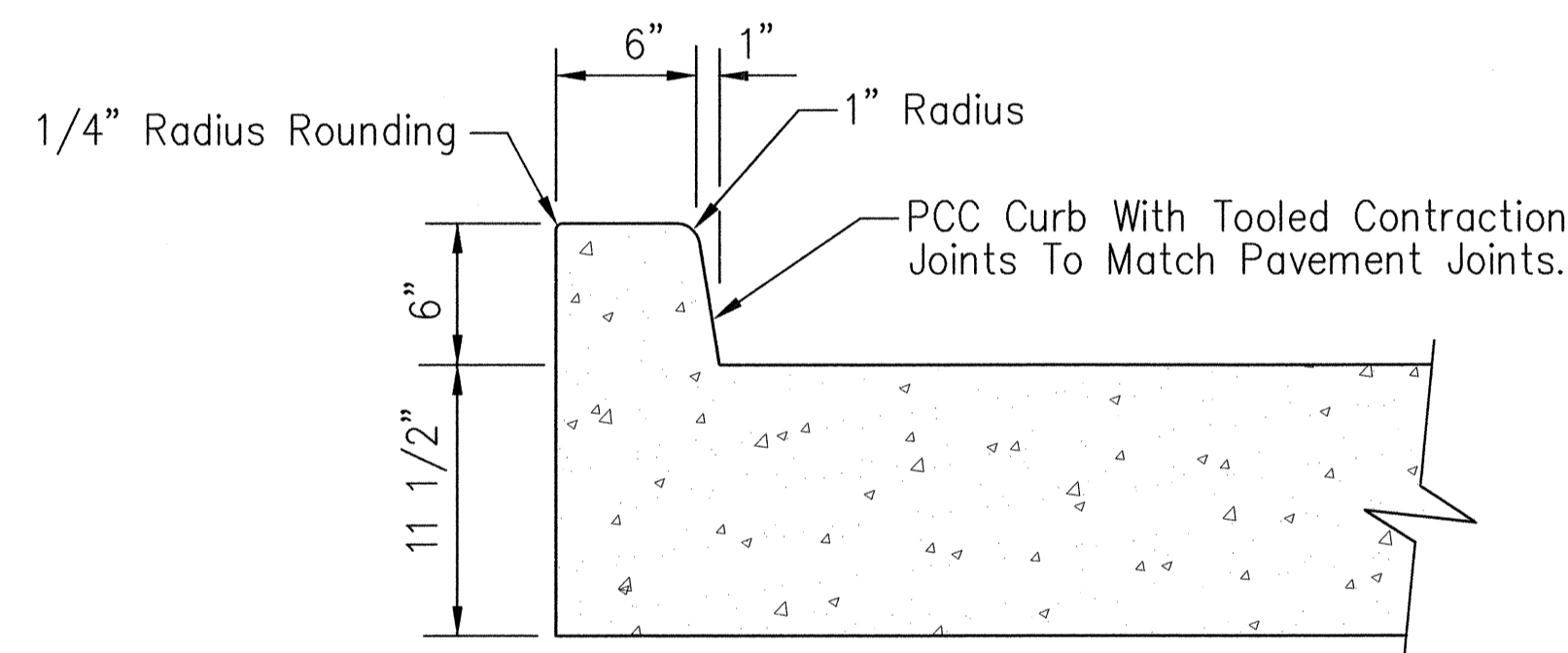

2 PCC INTEGRAL CURB DETAIL  
Scale : 1 1/2" = 1'-0"

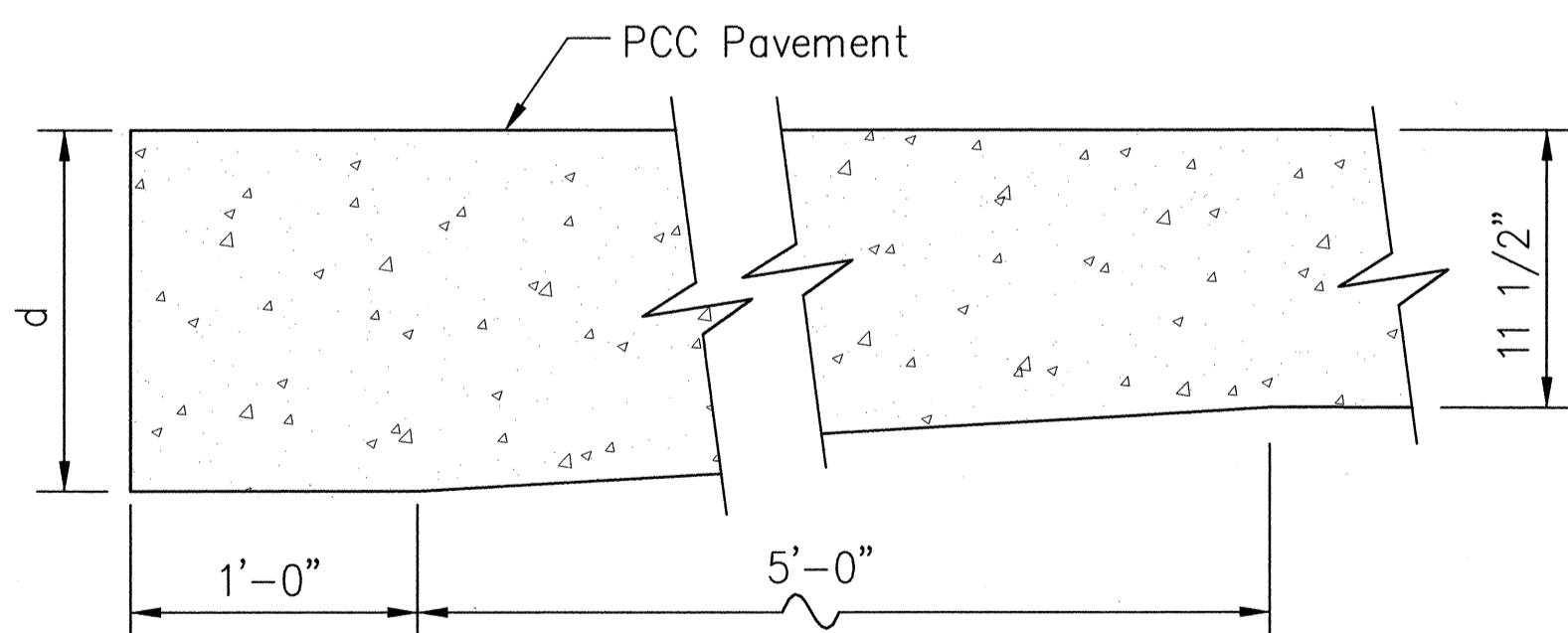

THICKENED EDGE DIMENSIONS	
CONDITION	d
Transition to 2" A.C. Pavement with 16 1/2" A.C. Base	1'-6 1/2"
Transition to 2" A.C. Pavement with 18" A.C. Base	1'-8"
All other Conditions	1'-3"

3 PAVEMENT THICKENED EDGE DETAIL  
Scale: 1 1/2" = 1'-0"

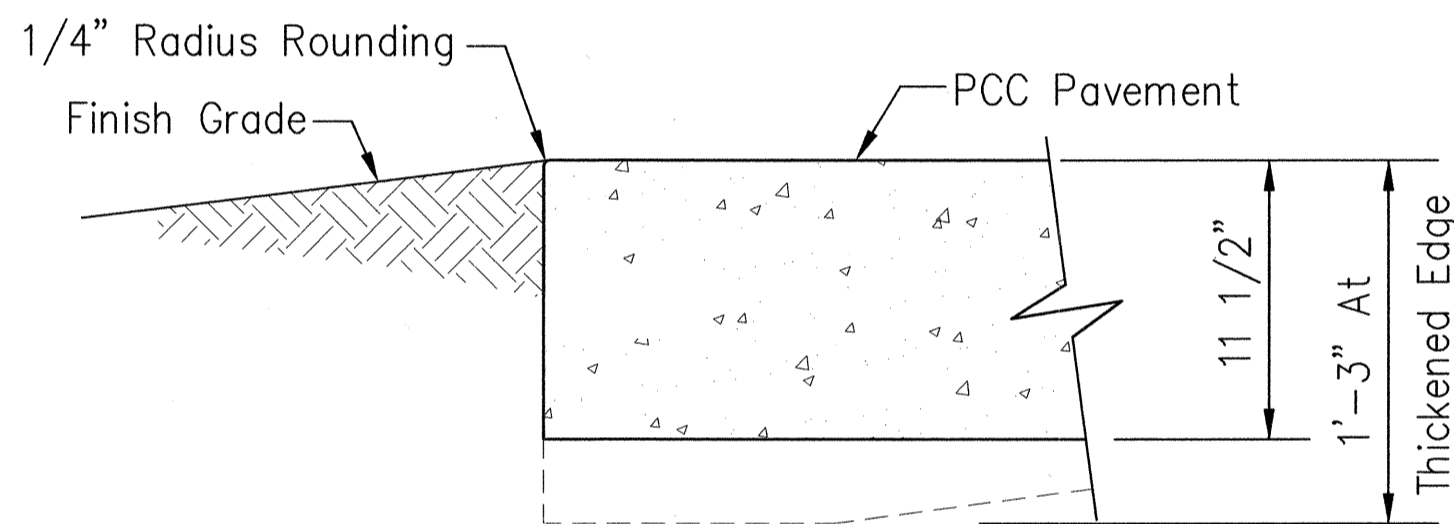

5 SHOULDER EDGE DETAIL  
Scale : 1 1/2" = 1'-0"

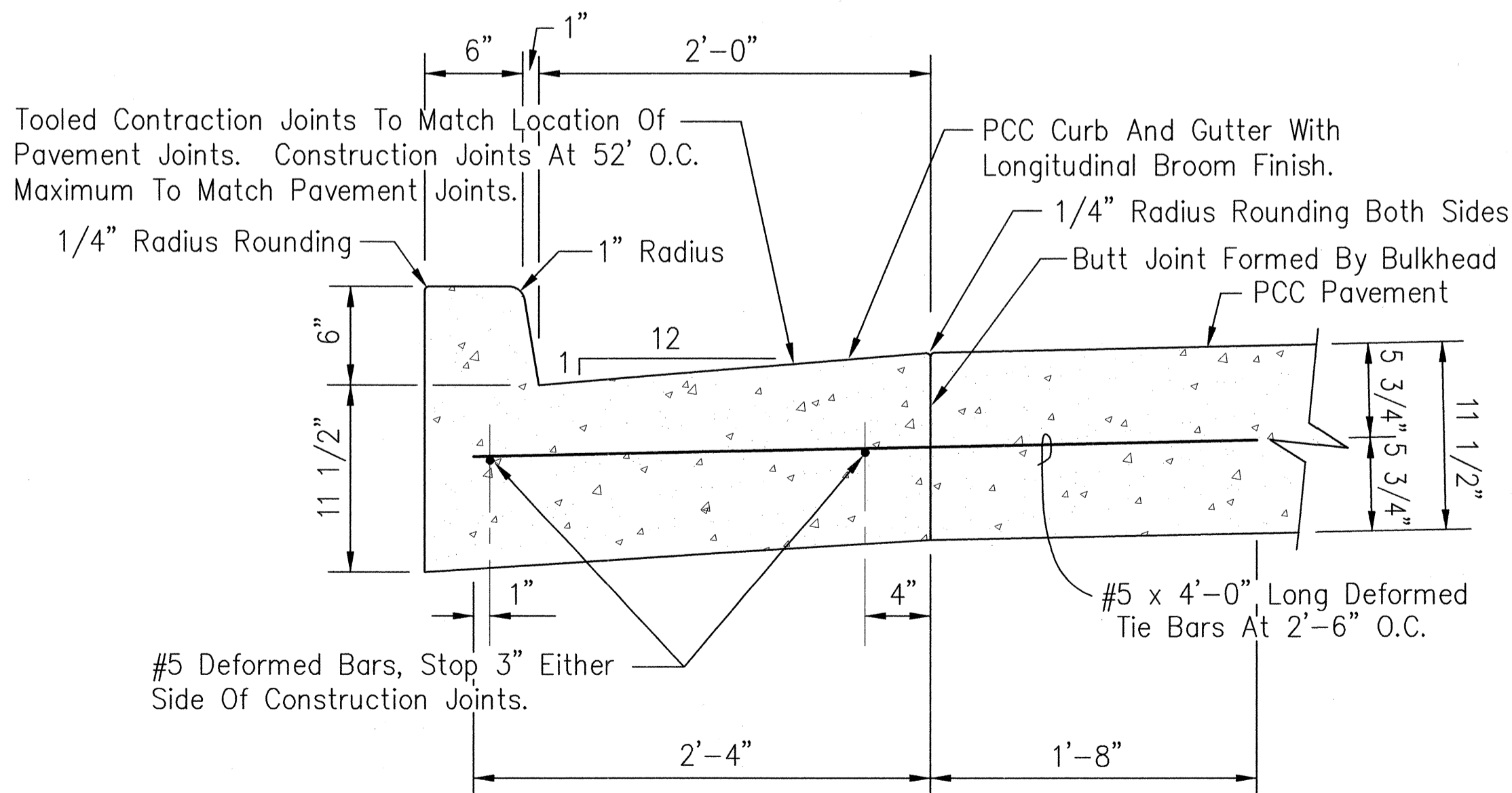

6 PCC CURB AND GUTTER DETAIL  
Scale : 1 1/2" = 1'-0"

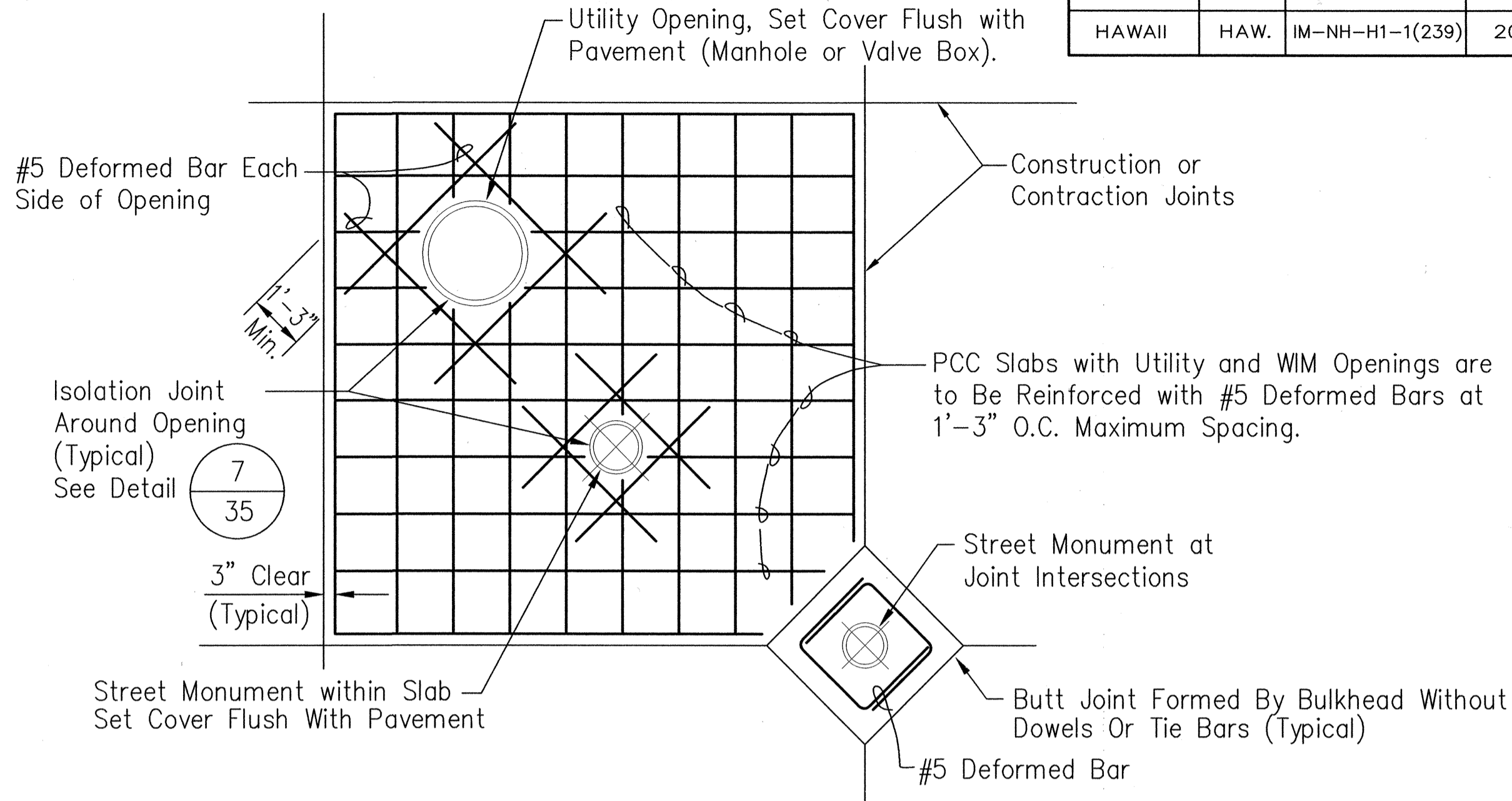

4 TYPICAL UTILITY OPENING DETAIL  
Scale : 3/8" = 1' - 0"

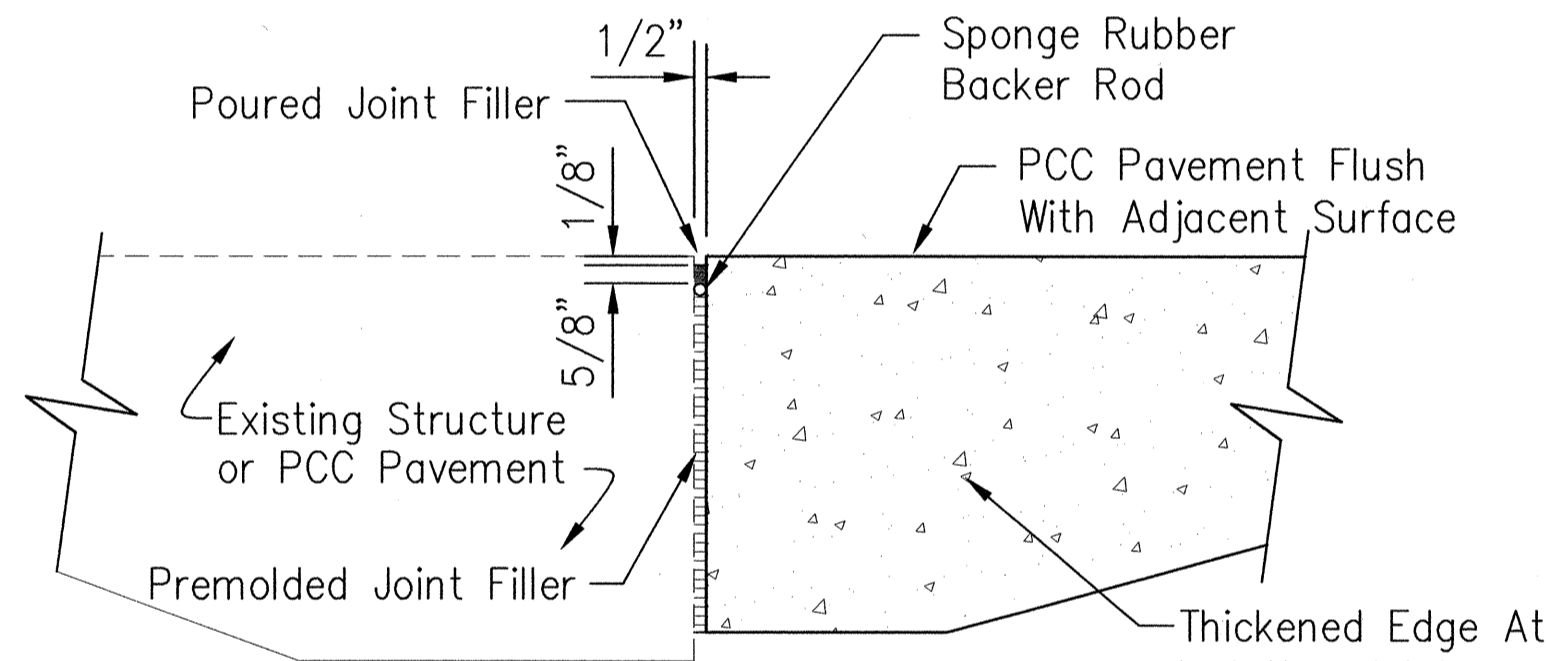

Note:  
Isolation Joints Are Considered  
Incidental To PCC Pavement.

7 ISOLATION JOINT DETAIL  
Scale : 1 1/2" = 1'-0"

GRAPHIC SCALE :

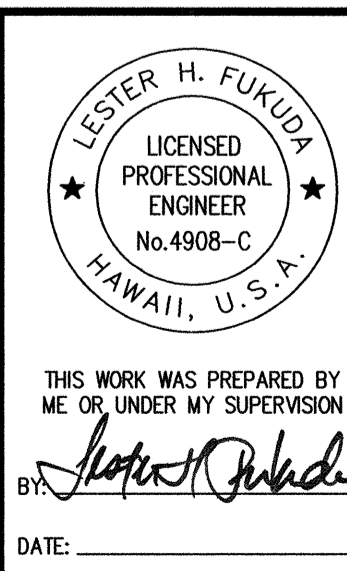
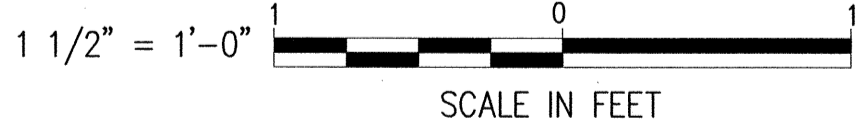
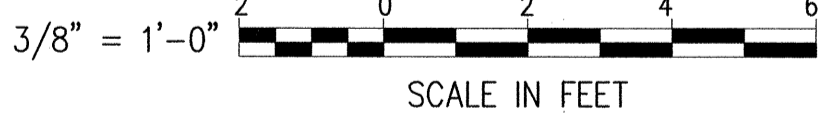
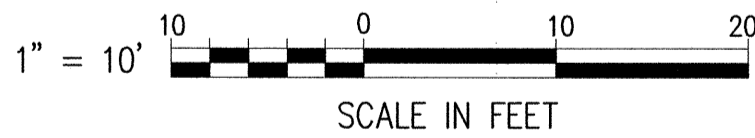

STATE OF HAWAII  
DEPARTMENT OF TRANSPORTATION  
HIGHWAYS DIVISION

MISCELLANEOUS DETAILS

INTERSTATE ROUTE H-1  
Palailai Interchange Reconstruction  
F.A.I. Project No. IM-NH-H1-1(239)

Scale: As Noted Date: 4/01/01

SHEET NO. J12 OF 12 SHEETS