

FED. ROAD DIST. NO.	STATE	FED. AID PROJ. NO.	FISCAL YEAR	SHEET NO.	TOTAL SHEETS
HAWAII	HAW.	NH-HI-1(235)	1999	22	84

LEGEND

- 4 each Type A Raised Pavement Markers
Type C Raised Pavement Markers @ 40'-0" o.c.
- 4 each Type J Raised Pavement Markers
Type D Raised Pavement Markers @ 40'-0" o.c.
- 8" White Stripe with Type C Raised Pavement Markers @ 20'-0" o.c. (Tape, Type I or Thermoplastic Extrusion)
- 4" Double Solid Yellow with Line with Type D Raised Pavement Markers @ 20'-0" o.c. (Tape, Type I or Thermoplastic Extrusion)
- 4" Double Solid Yellow Stripes with Type H Raised Pavement Markers @ 20'-0" o.c. (Tape, Type II or Thermoplastic Extrusion)
- 4" Yellow Edge Stripe with Type H Raised Pavement Markers @ 40'-0" o.c. (Tape, Type II or Thermoplastic Extrusion)
- 4" Double Solid White Stripes with Type C Raised Pavement Markers @ 20'-0" o.c. (Tape, Type I or Thermoplastic Extrusion)
- Lane Change Restriction Marking
4 each Type A Raised Pavement Markers
Type C Raised Pavement Markers @ 20'-0" o.c.
4" White Stripe (Tape, Type I or Thermoplastic Extrusion)
- 4" or 8" White Edge Stripe with Type C Raised Pavement Markers @ 40'-0" o.c. (Tape, Type II or Thermoplastic Extrusion)
- 4" White Guide Lines (Tape, Type III or Thermoplastic Extrusion except for bus bays)
- Transverse Median Marking (Tape, Type II or Thermoplastic Extrusion)
- Transverse Shoulder Marking (Tape, Type II or Thermoplastic Extrusion)
- Channelizing Island or Deceleration Lane Gore (Tape, Type II or Thermoplastic Extrusion)
- Crosswalk and Stop Line. All Stop Lines shall be 10'-0" from Crosswalk unless otherwise noted. The circled number indicates the number of lanes for payment (Tape, Type III or Thermoplastic Extrusion)
- Pavement Arrow (Tape, Type III or Thermoplastic Extrusion)
- Pavement Word (Tape, Type III or Thermoplastic Extrusion)
- 4 Each Type J Raised Pavement Markers
Type D Raised Pavement Markers @ 40'-0" o.c.
Type H Raised Pavement Markers (Reflective Surface Facing no-passing direction)
4" Single Solid Yellow Stripe (Tape, Type I or Thermoplastic Extrusion)
- Extension of Edge Line, 4" Wide x 2'-0" Long White Stripe @ 10'-0" o.c. w/Type C Markers @ 40'-0" o.c. (Tape, Type III or Thermoplastic Extrusion)

NOTES

1. Layout of pavement markings and striping shall be done by the Contractor and approved by the Engineer prior to any installation work.
2. Existing pavement markings not incorporated in the final traffic pattern shall be removed as directed by the Engineer. Costs shall be incidental to the various pavement marking items
3. Raised pavement markers shall not be installed within crosswalks.
4. Final locations of all signs shall be approved by the Engineer prior to any installation work
5. Existing signs not shown on these plans shall remain as posted unless otherwise directed by the Engineer. Removal and disposal of existing signs and/or posts as designated on these plans shall be incidental to the various signing items.
6. Final locations of all Stop Lines shall be approved by the Engineer prior to installation.
7. All pavement striping shall be as noted on the legend or plans.
8. All preformed pavement marking tapes over existing pavement shall be applied with an approved primer as recommended by the tape manufacturer and as approved by the Engineer. The primer shall be allowed to dry to the tacky stage prior to tape application.
9. Curb marking shall include top and front of curb.
10. Backing for all new Regulatory and Warning Signs shall not be spliced.
11. All sign panels shall conform to Section 621 of Special Provisions and the latest editions and amendments of the following FHWA publications.
 - a. "Manual on Uniform Traffic Control Devices for Streets and Highways"(MUTCD)
 - b. "Standard Highway Signs"
 - c. "Standard Alphabets for Highway Signs"
12. Border, messages, arrows, symbols and shields shall conform to details as shown on the plans and as specified in the MUTCD.
13. Sign messages shall be as indicated on the plan.
14. All panels shall be reflectorized in accordance with Section 712.20 of the Standard Specifications. Minimum width of panels shall be 2 feet, abutting edges of panels shall be in only one direction if vertical abutting edges are used, no horizontal abutting edges shall be allowed and vice versa.
15. All new and relocated signs and markers installed on pipe posts, light standard of expressway sign post are to be mounted with band brackets and steel braces.

16. All new signs installed on structure abutment, are to be mounted with 3/8" expansion bolt and washer. Existing holes shall be plugged with mortar as required.
17. Final location of all sign post installed within the sidewalk areas shall have a minimum of 36 inches passing distance.
18. Removing existing signs and reinstalling on new post shall not be paid for separately, but shall be considered incidental to the various signing items.
19. Supplemental plates used in conjunction with regulatory and warning signs shall not be paid for separately, but shall be considered incidental to the regulatory and warning sign.
20. The Contractor shall install construction signs as noted on the plans. At the project completion, these signs and posts shall become the property of the State. The Contractor shall remove and deliver these signs and posts to a location as directed by the Engineer. The contract price shall be full compensation for all excavation and backfilling, for furnishing, installing, removing and delivering all equipment, tools, labor and incidentals necessary to complete the work.

REFLECTOR MARKER LEGEND

- II-F Reflector Marker (RM-2, White) w/ Flexible Delineator Post
- II-S Reflector Marker (RM-2, White) w/ Steel Post
- III-S Reflector Marker RM-4 (L or R) w/ Steel Post
- III-S Reflector Marker (RM-5, White)
- III-S Reflector Marker (RM-5, Yellow)

LEGEND FOR AS-BUILT POSTINGS

- Squiggly line for as-built deletion
- Double line for as-built deletion
- Roadway Text for as-built posting

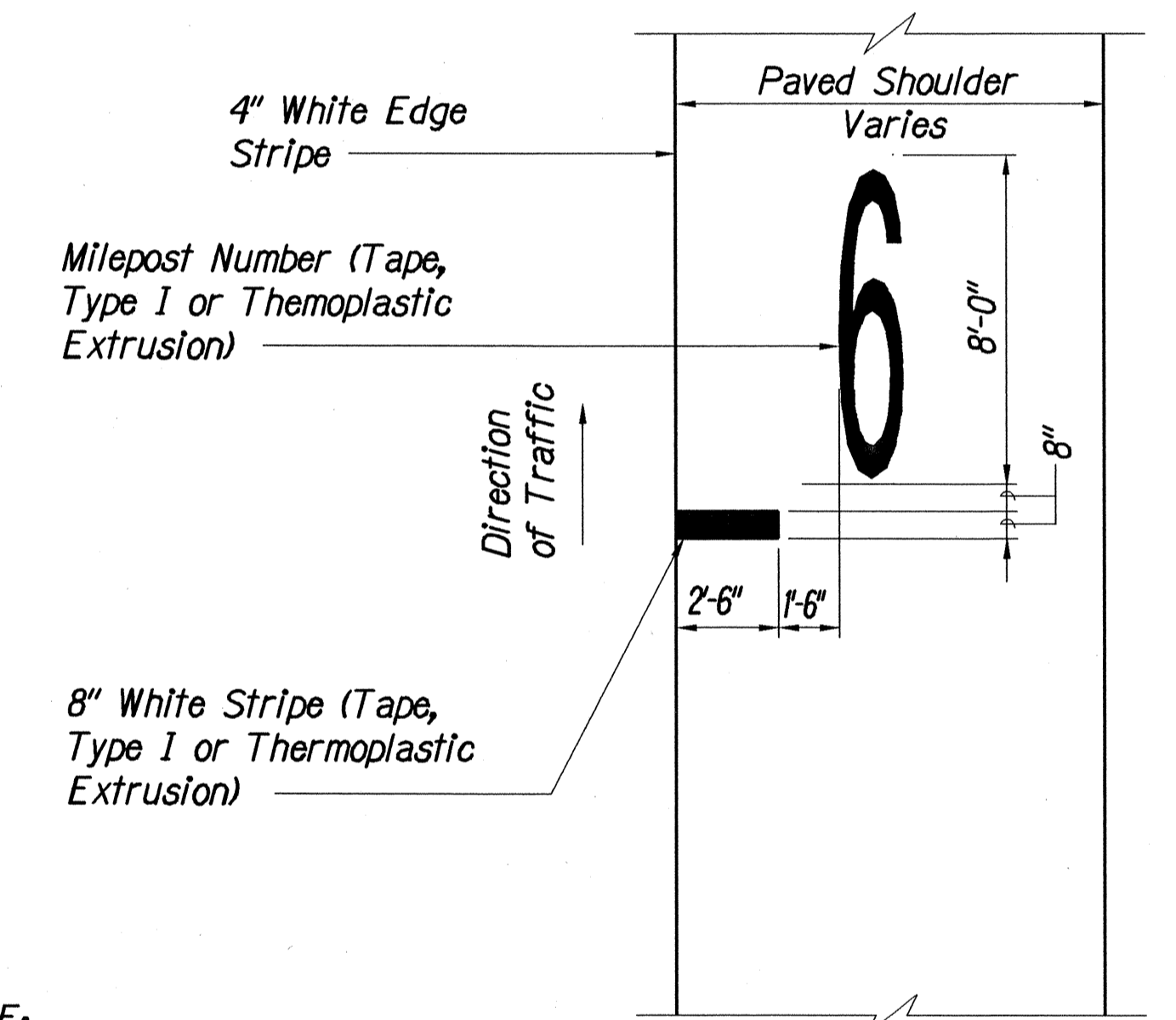

NOTE:
Payment to be made under Item No. 629J061 - Milepost Pavement Markings (Tape, Type I of Thermoplastic Extrusion)

TYPICAL MILEPOST PAVEMENT MARKINGS DETAIL

Scale: 1/4" = 1'-0"

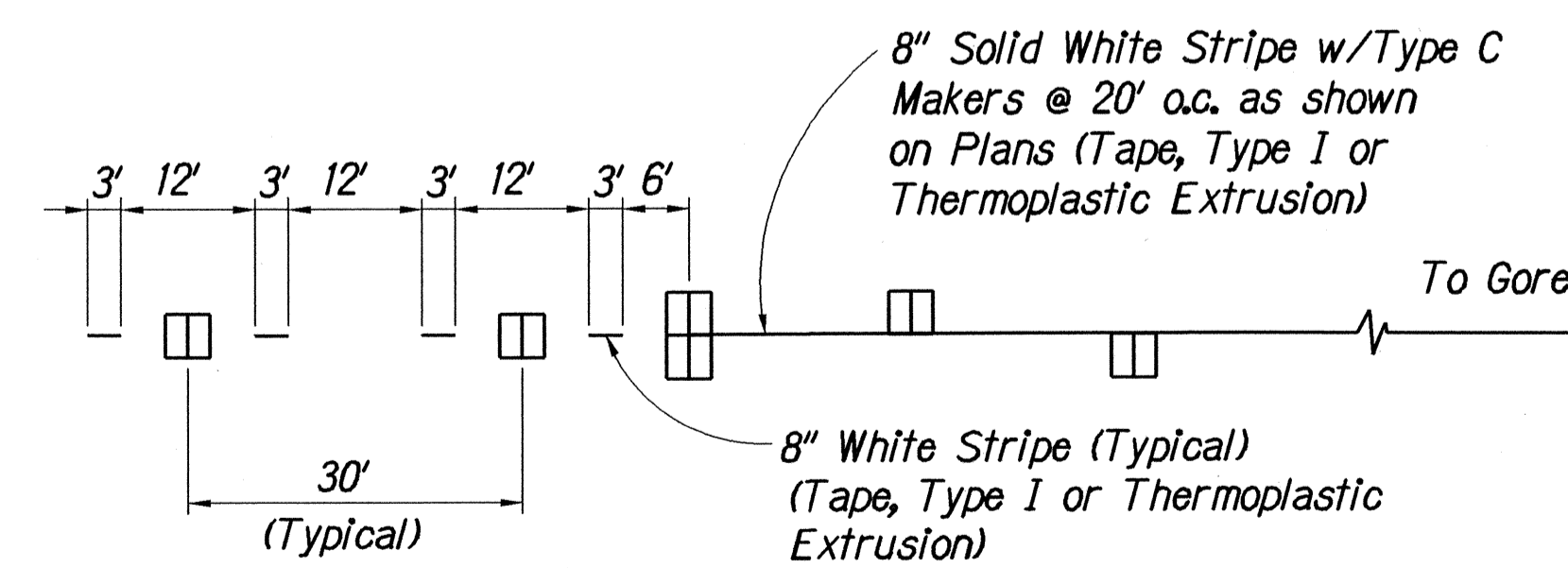

LANE DROP MARKING

Not to Scale

SURVEY PLOTTED BY: DATE: 01/27/99
 DESIGNED BY: BST
 TRACED BY: SHA*FAI
 NOTE BOOK: OPER: 1 = 1
 QUANTITIES BY: REVISIONS: 04/25/99
 CHECKED BY: FILE: 9804-78

THIS WORK WAS PREPARED BY ME OR UNDER MY SUPERVISION

STATE OF HAWAII
 DEPARTMENT OF TRANSPORTATION
 HIGHWAYS DIVISION
PAVEMENT MARKING
LEGEND, DETAILS & NOTES
INTERSTATE ROUTE H-1 RESURFACING
Kunia IC to Waikole Stream Bridge
F.A.I. Project No. NH-HI-1(235)
 Scale: As Shown Date: Apr. 30, 1999
 SHEET No. 71 OF 8 SHEETS

FED. ROAD DIST. NO.	STATE	FED. AID PROJ. NO.	FISCAL YEAR	SHEET NO.	TOTAL SHEETS
HAWAII	HAW.	NH-HI-1(235)	1999	25	84

TRUE NORTH
SCALE: 1" = 40'

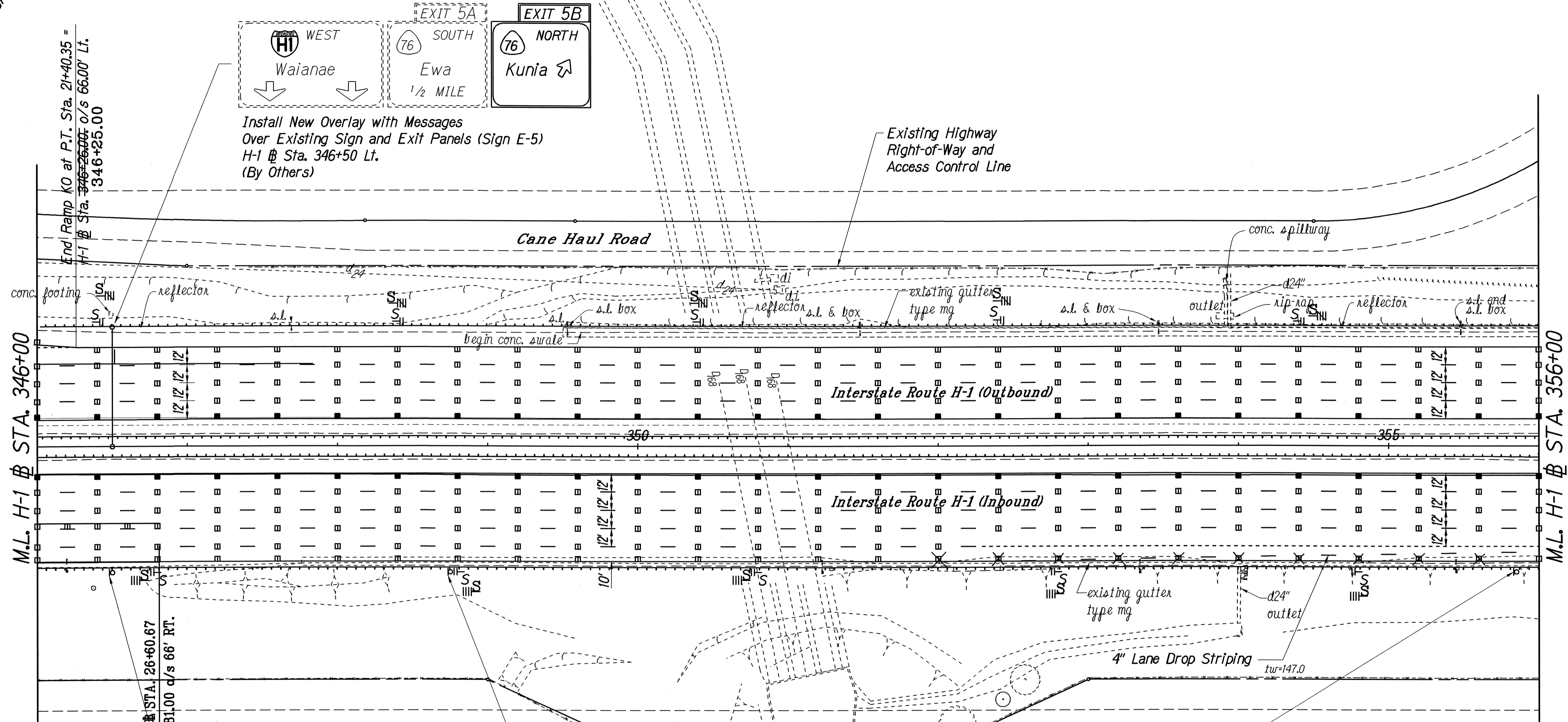

DATE: 06/06/98
SCALE: 1" = 40'
FILE: 981416

PM: BST/TCL
OPER: *SHAFALCDK
REVISED: 06/10/99

DATE	DESCRIPTION

LEGEND FOR AS-BUILT POSTINGS	
	Squiggly line for as-built deletion
	Double line for as-built deletion
Roadway	Text for as-built posting

D-2
ADOPT A HIGHWAY LITTER CONTROL NEXT 2 MILES (24"x48")
324 1S (12"x48")
Remove Existing Sign Panels and Install New Sign Panels on Existing Sign Supports H-1 @ Sta. 346+50± Rt.

SHOULDER LANE AHEAD 1000 FT. (48"x36")
R16-11(1,000') (48"x36")
Remove Existing Sign and Install New Sign on Existing Sign Supports H-1 @ Sta. 348+75± Rt. For Sign Detail, See Sheet T8

SHOULDER LANE AHEAD 500 FT. (48"x36")
R16-11(500') (48"x36")
Remove Existing Sign and Install New Sign on Existing Sign Supports H-1 @ Sta. 355+85± Rt. For Sign Detail, See Sheet T8

BENJAMIN S. TANAKA
LICENSED PROFESSIONAL ENGINEER
No. 2055-C
HAWAII, U.S.A.
THIS WORK WAS PREPARED BY ME OR UNDER MY SUPERVISION

STATE OF HAWAII
DEPARTMENT OF TRANSPORTATION
HIGHWAYS DIVISION
PAVEMENT MARKING AND SIGNING PLAN
INTERSTATE ROUTE H-1 RESURFACING
Kunia IC to Waikale Stream Bridge
F.A.I. Project No. NH-HI-1(235)
Scale: 1"=40' Date: Apr. 30, 1999
SHEET No. 74 OF 8 SHEETS

