

GENERAL NOTES FOR TRAFFIC CONTROL PLAN

1. The Permittee Shall Make Minor Adjustments at Ramp Junctions, Bridges, Structures, Etc., to Fit Field Conditions.
2. Cones or Delineators Shall be Extended to a Point Where They are Visible to Approaching Traffic.
3. Traffic Control Devices Shall be Installed Such That the Sign or Device Farthest From the Work Area Shall be Placed First. The Others Shall Then be Placed Progressively Toward the Work Area.
4. Regulatory and Warning Signs Within the Construction Zone that are in Conflict with the Traffic Control Plans Shall be Removed or Covered.
5. Flaggers and/or Police officers Shall be in Sight of Each Other or in direct Communication at all Times.
6. When Required by the Engineer, the Permittee Shall install a Flashing Arrow Signal as Shown on the Traffic Control Plans.
7. Sign Spacings (L), Taper Lengths (T) and Spacing of Cones or Delineators Shall be as Shown in Table 1, Unless Otherwise Noted on the Traffic Control Plans.
8. All Traffic Lanes Shall be a Minimum of 11 Feet Wide.
9. All Construction Warning Signs Shall be Promptly Removed or Covered Whenever the Message is not Applicable or not in Use.

10. The Backs of All Signs Used for Traffic Control Shall be Appropriately Covered to Preclude the Display of Inapplicable Sign Messages (i.e., When Signs Have Messages on Both Faces).
 11. At the End of Each Day's Work or as Soon as the Work is Completed, the Permittee Shall Remove all Traffic Control Devices no Longer Needed to Permit Free and Safe Passage of Public Traffic. Removal Shall be in the Reverse Order of Installation.
 12. Replace Permanent Pavement Markings and Traffic Signs Upon Completion of Each Phase of Work.
- ADDITIONAL NOTES FOR CONSTRUCTION PHASING PLAN
1. Existing Conflicting Pavement Markings Shall be Removed and Temporary Markings Shall be Installed Before Traffic Patterns are Changed. After Completion of the Work, Temporary Markings Shall be Removed.
 2. Lane Closures Shall Be Allowed to the Extent of Accomplishing Each Day's Work and Shall be Subject to the Approval of the Engineer.
 3. Night Work is Not Mandatory Except for a Short Section of Ramp KO. However, Should the Contractor Choose to Work at Night to Expedite the Work, Such Work Shall be Performed From 7:00 PM to 5:00 AM. The Contractor Will be Responsible for Developing the Traffic Control Plan for Such Night Work Which Will be Subject to Approval by the State. Also, the Contractor Will Not be Entitled to Extra Compensation for his Election to Perform the Work at Night.
 4. Cones and signs for Night Work Shall be Retroreflective.

FED. ROAD DIST. NO.	STATE	FED. AID PROJ. NO.	FISCAL YEAR	SHEET NO.	TOTAL SHEETS
HAWAII	HAW.	NH-H1-1(235)	1999	30	84

TABLE 1 FOR TRAFFIC CONTROL PLAN

Posted Speed Limit (M.P.H.)	Sign Spacing (D) (Feet)	Taper Length (T) (Feet)		Longitudinal Buffer Space (B) (Feet)	Spacing of Cones or Delineators (Feet)		
		W = 12' or Less	W = Greater Than 12'		Taper	Tangent	Work Area
20	250	200	Wx17	35	20	20	10
25	250	200	Wx17	55	25	25	10
30	250	250	Wx20	85	30	30	10
35	250	250	Wx20	120	35	35	10
40	500	350	Wx30	170	40	40	10
45	500	550	Wx45	220	45	45	10
50	1000	600	Wx50	280	50	50	10
55	1000	700	Wx55	335	55	55	10

W = Width of Lane, Shoulder or Offset

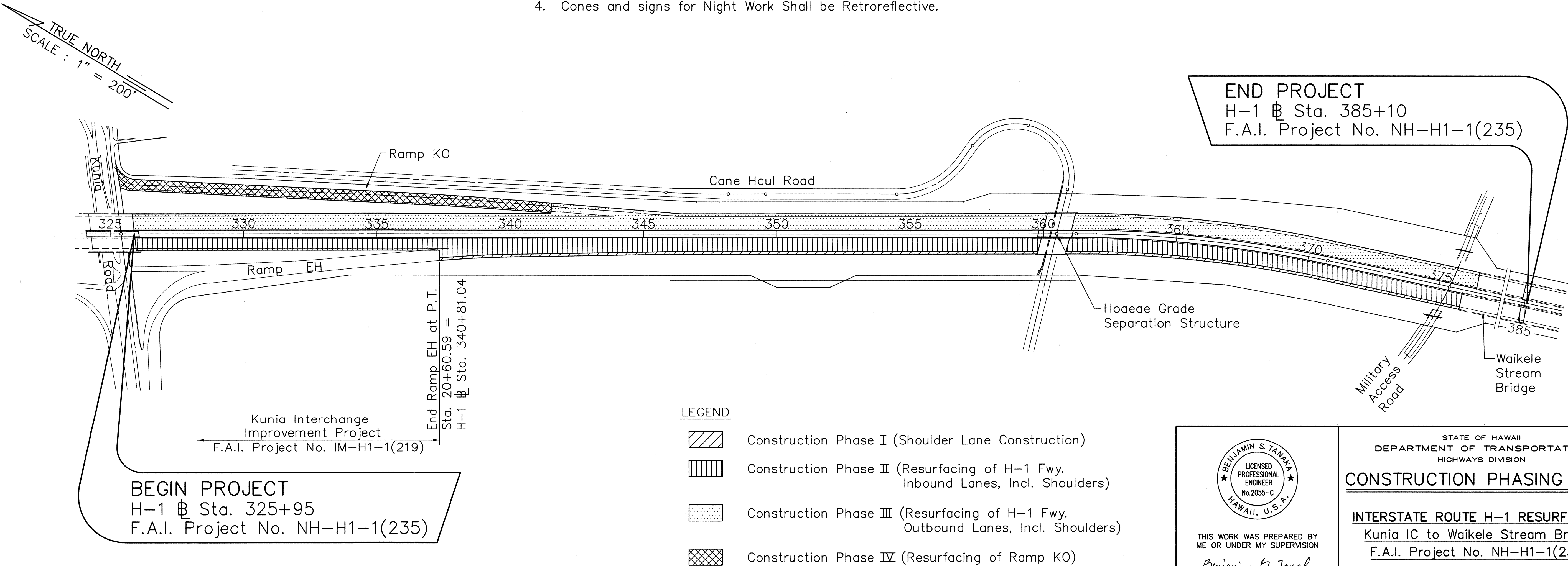

Benjamin S. Tanaka

LICENSED PROFESSIONAL ENGINEER

No. 2055-C

HAWAII, U.S.A.

THIS WORK WAS PREPARED BY ME OR UNDER MY SUPERVISION

Benjamin S. Tanaka

STATE OF HAWAII
DEPARTMENT OF TRANSPORTATION
HIGHWAYS DIVISION

CONSTRUCTION PHASING PLAN

INTERSTATE ROUTE H-1 RESURFACING
Kunia IC to Waiale Stream Bridge
F.A.I. Project No. NH-H1-1(235)

Scale: 1"=200' Date: Apr. 30, 1999

SHEET NO. F1 OF F14 SHEETS

FED. ROAD DIST. NO.	STATE	FED. AID PROJ. NO.	FISCAL YEAR	SHEET NO.	TOTAL SHEETS
HAWAII	HAW.	NH-H1-1(235)	1999	31	84

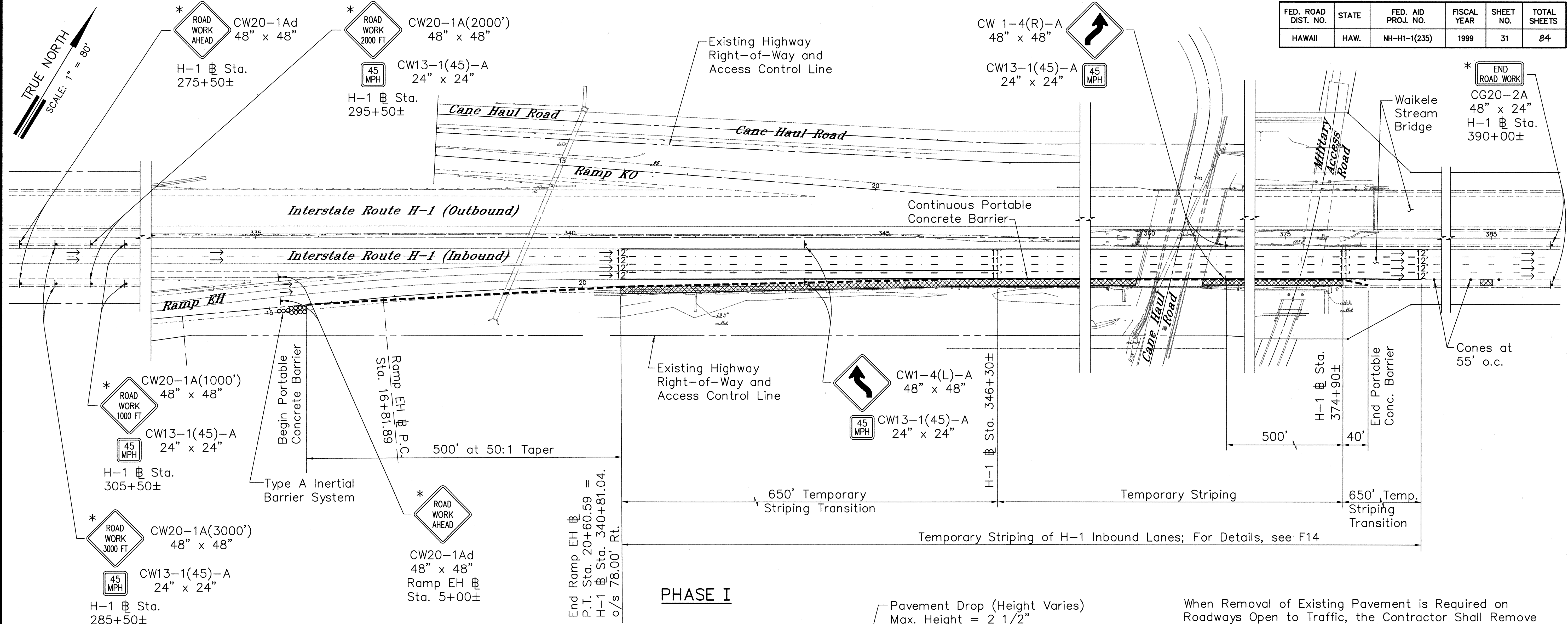

Description of Work:

1. Temporarily Stripe H-1 Inbound Lanes as Shown on the Plans.
2. Furnish and Install New Portable Concrete Barriers with Type A Inertial Barrier System.
3. Remove Existing Metal Beam Guardrails. Reconstruct Shoulder Lane Including Excavation and Embankment Work, Pavement Work, Drainage Improvements, Type 3-Single Metal Beam Guardrail Installation, Highway Lighting Work and Other Miscellaneous Work. Said Shoulder Lane Reconstruction Work can Proceed During the Normal Construction Hours Once the Portable Concrete Barriers are in Place.
4. Remove and Store Portable Concrete Barriers for Later Reuse (Location to be Determined by the Engineer). Provide Permanent Shoulder Lane Markings. Eradicate Temporary Stripping.

Estimated Quantities:

Pay Items:

Furnish and Install New Portable Concrete Barriers	-	175 Each
Construction Sign with 2 Posts	-	12 Each
Type A Inertial Barrier System	-	1 Each **

Incidental Items:

Temporary Stripping	-	21,000 Lineal Feet
---------------------	---	--------------------

** Refer to Details on Sht. F-14 for Number and Types of Barrels and Section 647 of the Specifications for Basis of Payment.

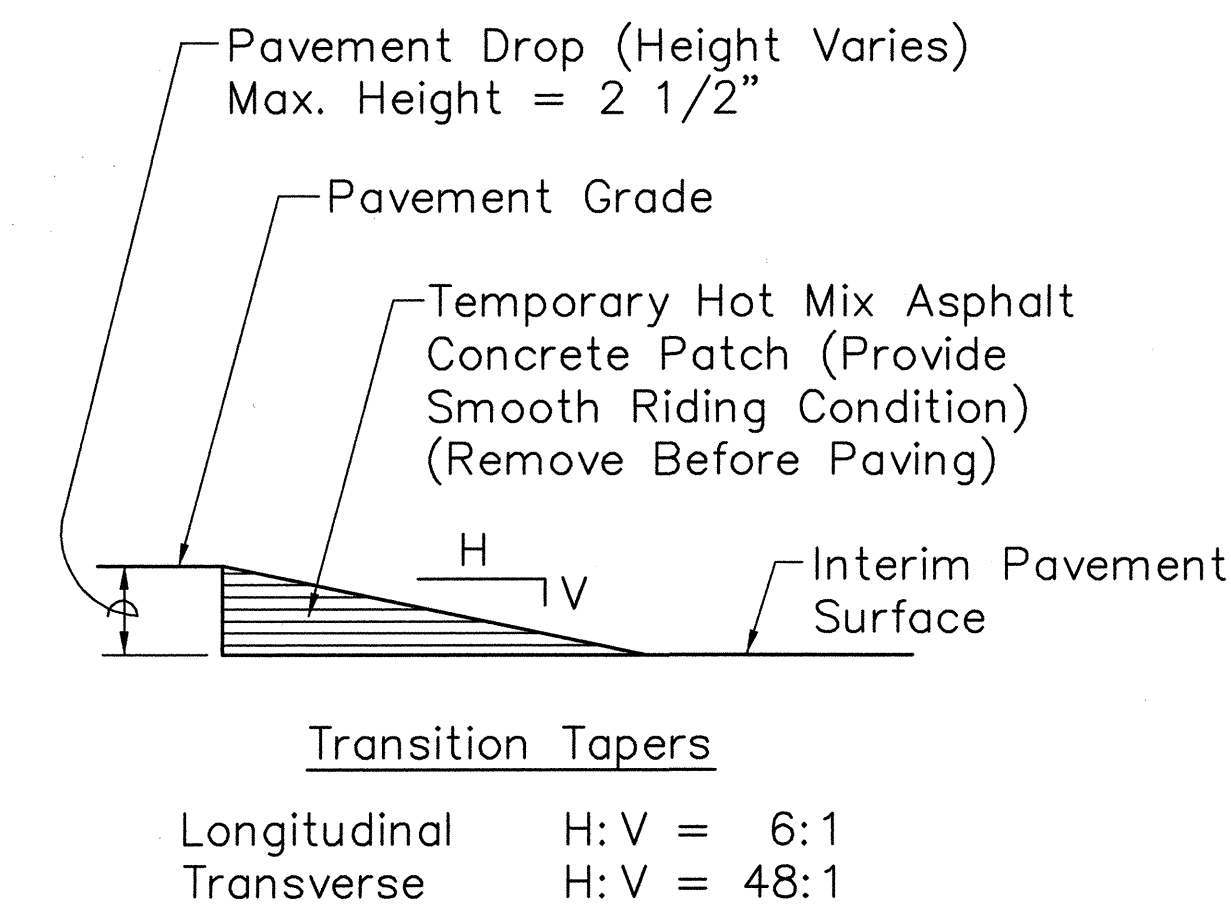

Transition Taper

Not to Scale

* Construction Signs with 2 Posts: To be Installed at the Start of Phase I and to be Removed at the End of Phase II. To be paid Under Item 621.7200, Construction Signs with 2 Posts.

When Removal of Existing Pavement is Required on Roadways Open to Traffic, the Contractor Shall Remove the Full Travelway width of Roadway Each Day so as Not to Leave a Hazardous Longitudinal Pavement Drop Between Lane Passes of the Removed Pavement. The Engineer May Allow the Contractor to Construct a Transition Taper at the Longitudinal Pavement Drop so as Not to Leave a Vertical face. The Transition Taper Shall be Along the Lane Line and Should Produce a Wedge with a Minimum Slope of 6:1. The Transverse Taper Should Produce a Wedge with a Minimum Slope of 48:1. The Contractor Shall Submit the Type of Materials and Construction of the Transition Taper for Acceptance by the Engineer. The Contractor Shall Remove and Dispose of the Removed Material. This Work Shall be Incidental to the Various Asphaltic Concrete Pavement Items.

THIS WORK WAS PREPARED BY ME OR UNDER MY SUPERVISION
Benjamin S. Tanaka

STATE OF HAWAII
DEPARTMENT OF TRANSPORTATION
HIGHWAYS DIVISION

CONSTRUCTION PHASING PLAN

INTERSTATE ROUTE H-1 RESURFACING
Kunua IC to Waikale Stream Bridge
F.A.I. Project No. NH-H1-1(235)

Scale: 1"=80' Date: Apr. 30, 1999

SHEET NO. F2 OF F14 SHEETS

FED. ROAD DIST. NO.	STATE	PROJ. NO.	FISCAL YEAR	SHEET NO.	TOTAL SHEETS
HAWAII	HAW.	NH-H1-1(235)	1999	32	84

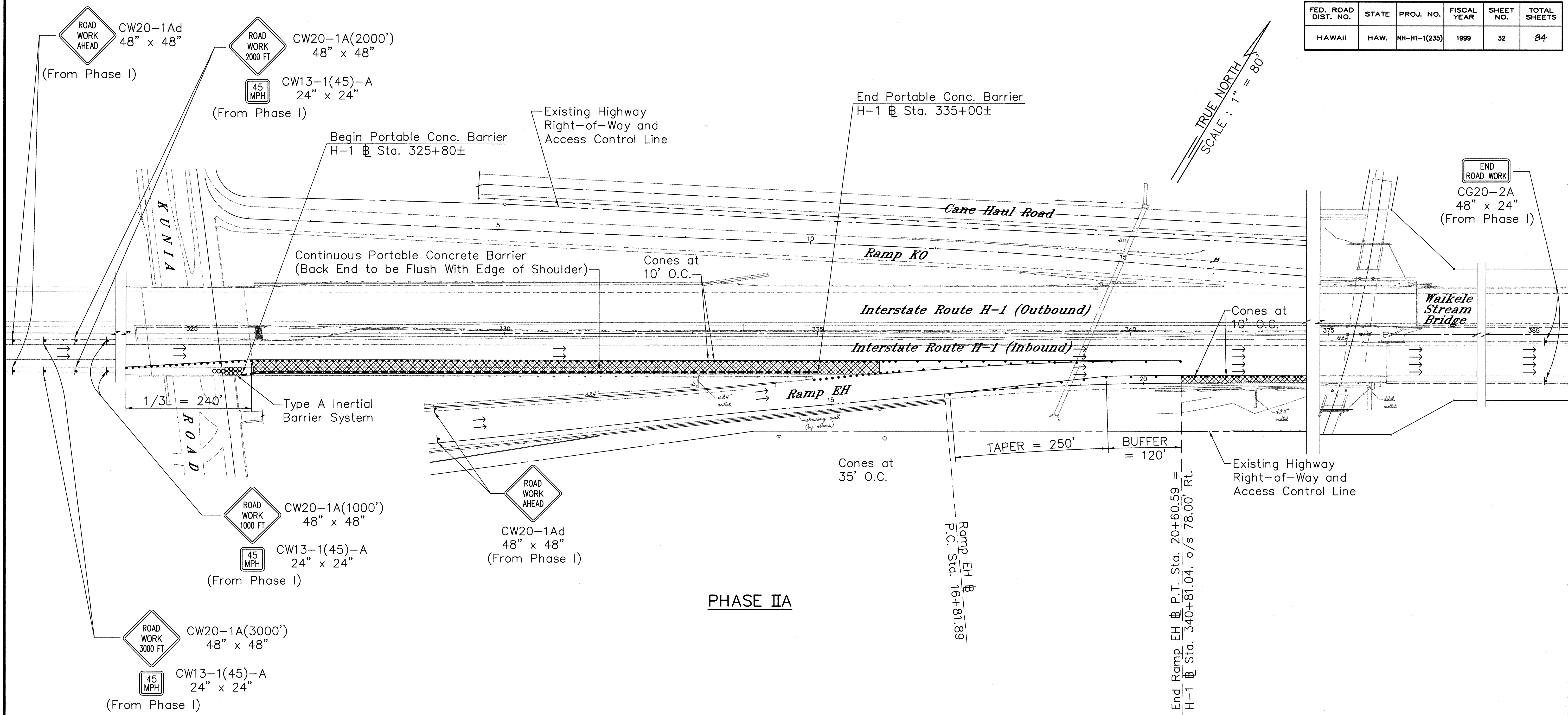

BST
PM: SHA #FALCDK
OPER: 04/26/99
REVISED:

DATE: 7/01/98
SCALE: 1" = 80'
FILE: 9814-30

SURVEY PLOTTED BY	DATE
DRAWN BY	
DESIGNED BY	
QUANTITIES BY	
CHECKED BY	
ORIGINAL PLAN	
NOTEBOOK	
No.	

Description of Work:

Cold Planing and Resurfacing of the H-1 Freeway (Inbound) Right Lane Plus Shoulder From H-1 Sta. 325+95± to H-1 Sta. 336+00±.

Either Before or After the Resurfacing Operations, the Contractor is to Install Continuous Portable Concrete Barriers to Facilitate Removal and Reinstallation of Type 3-Single Metal Beam Guardrails From the Kunia Road Grade Separation Structure to the H-1 Gore with Ramp EH.

The Intent of this Traffic Control Plan For This Phase is to Maintain Existing Traffic Without Any Lane Closures.

Estimated Quantities:

Pay Items:

Type A Inertial Barrier System - 1 Each*

Incidental Items:

Reset Portable Concrete Barriers - 46 Each

* Refer to Details on Sht. F-14 for Number and Types of Barrels and Section 647 of the Specifications for Basis of Payment.

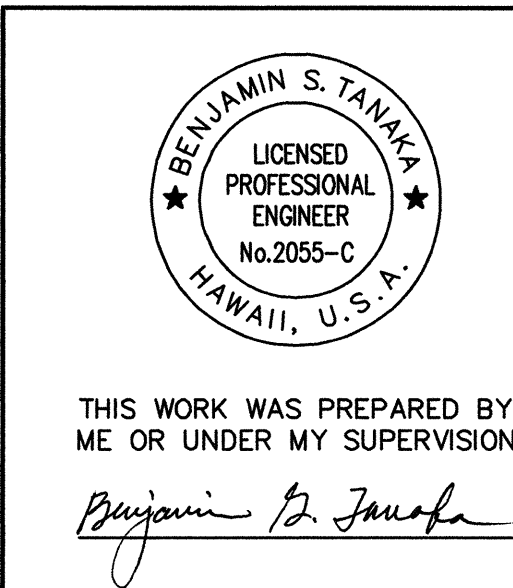

STATE OF HAWAII
DEPARTMENT OF TRANSPORTATION
HIGHWAYS DIVISION

CONSTRUCTION PHASING PLAN

INTERSTATE ROUTE H-1 RESURFACING
Kunia IC to Waikale Stream Bridge
F.A.I. Project No. NH-H1-1(235)

Scale: 1"=80' Date: Apr. 30, 1999
SHEET NO. F3 OF F14 SHEETS

FED. ROAD DIST. NO.	STATE	PROJ. NO.	FISCAL YEAR	SHEET NO.	TOTAL SHEETS
HAWAII	HAW.	NH-H1-1(235)	1999	33	84

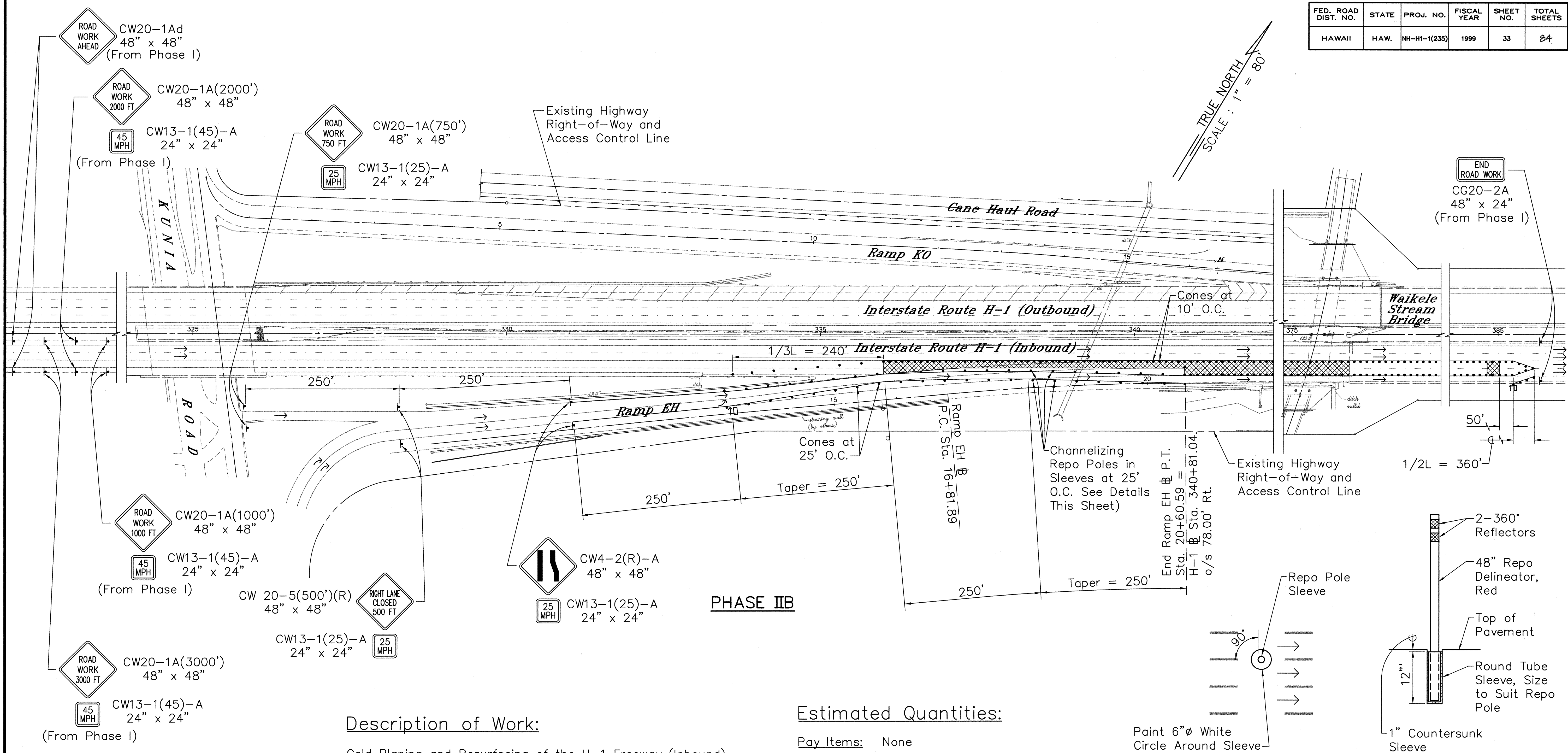

Description of Work:

Cold Planing and Resurfacing of the H-1 Freeway (Inbound), Right Two Lanes, From H-1 Sta. 336+00± to H-1 Sta. 384+90±, Excluding the Hoaeae Grade Separation Structure Bridge Deck.

The Intent of this Traffic Control Plan For This Phase is to Merge the Kunia Interchange Ramp EH Lanes to the Newly Resurfaced Shoulder Lane During the Hours From 8:30 AM to 3:00 PM, Monday Through Friday, Excluding Holidays. The Contractor is Required to Plan His Daily Work to Cold Plane and Pave in One Continuous Operation to Reopen the Lane to Traffic by 3:00 PM That Same Afternoon. The Contractor Will Also be Required to Place Temporary Striping on a Daily Basis to Restore Existing Striping of the Freeway Lanes. Upon Completion of All Paving for This Phase, the Contractor Will be Required to Install Permanent Pavement Markings For These Lanes.

Estimated Quantities:

Pay Items: None

Incidental Items:

- Traffic Control Signing - 6 Each
- Repo poles in sleeves - 30 Each

Note: Cover Shoulder Lane signs During This Phase

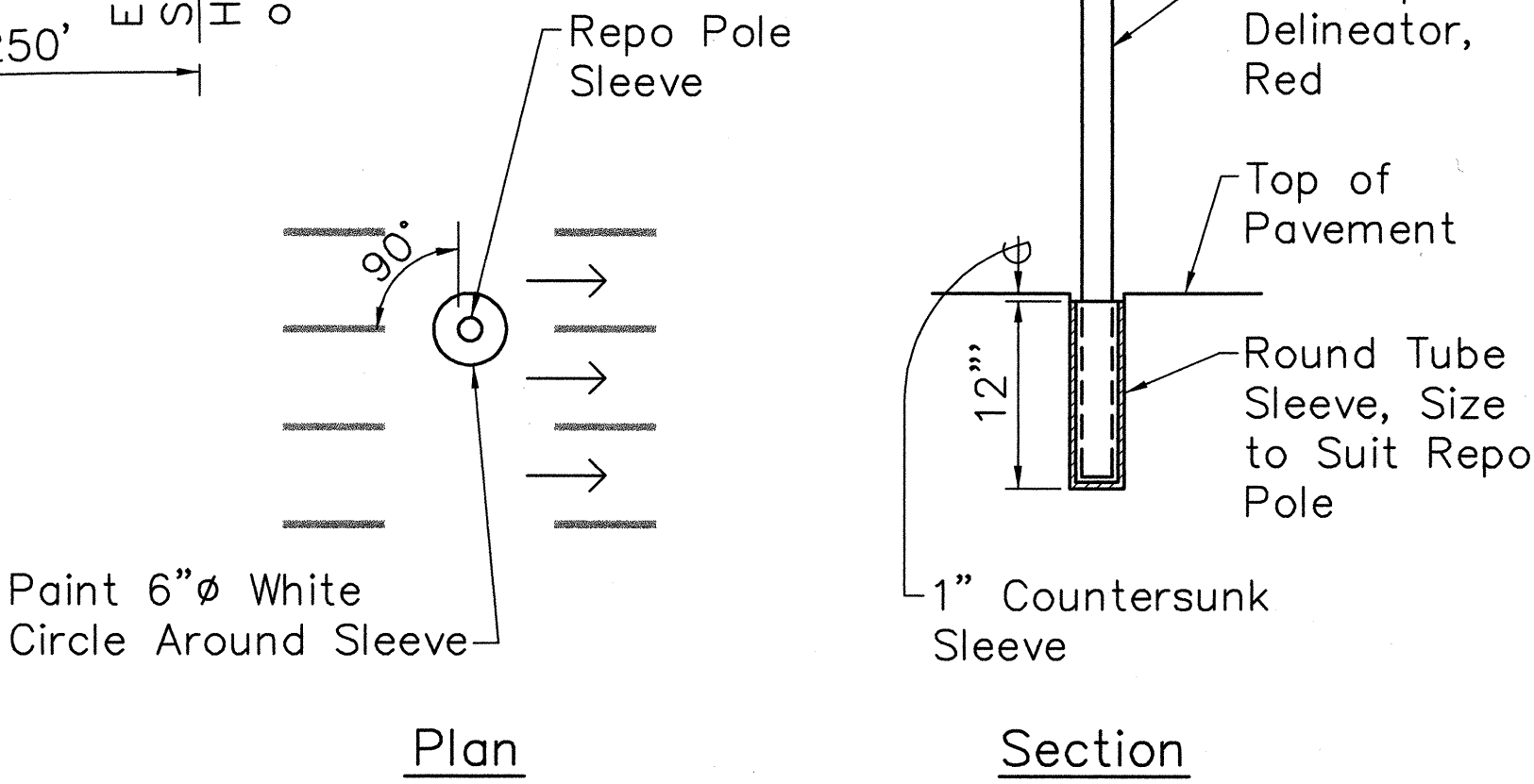

Detail
Not to Scale

SURVEY PLOTTED BY	DATE
DRAWN BY	
DESIGNED BY	
QUANTITIES BY	
CHECKED BY	
ORIGINAL PLAN	No.
NOTED	

DATE: 8/04/98
 SCALE: 1" = 80'
 FILE: 9815-57

PM: BST
 OPER: SHA,CDK,*FAI
 REVISED: 04/26/99

THIS WORK WAS PREPARED BY ME OR UNDER MY SUPERVISION
Benjamin S. Tanaka

STATE OF HAWAII
 DEPARTMENT OF TRANSPORTATION
 HIGHWAYS DIVISION

CONSTRUCTION PHASING PLAN

INTERSTATE ROUTE H-1 RESURFACING
 Kunia IC to Waikele Stream Bridge
 F.A.I. Project No. NH-H1-1(235)

Scale: 1"=80' Date: Apr. 30, 1999

SHEET NO. F4 OF F14 SHEETS

FED. ROAD DIST. NO.	STATE	PROJ. NO.	FISCAL YEAR	SHEET NO.	TOTAL SHEETS
HAWAII	HAW.	NH-H1-1(234)	1999	34	84

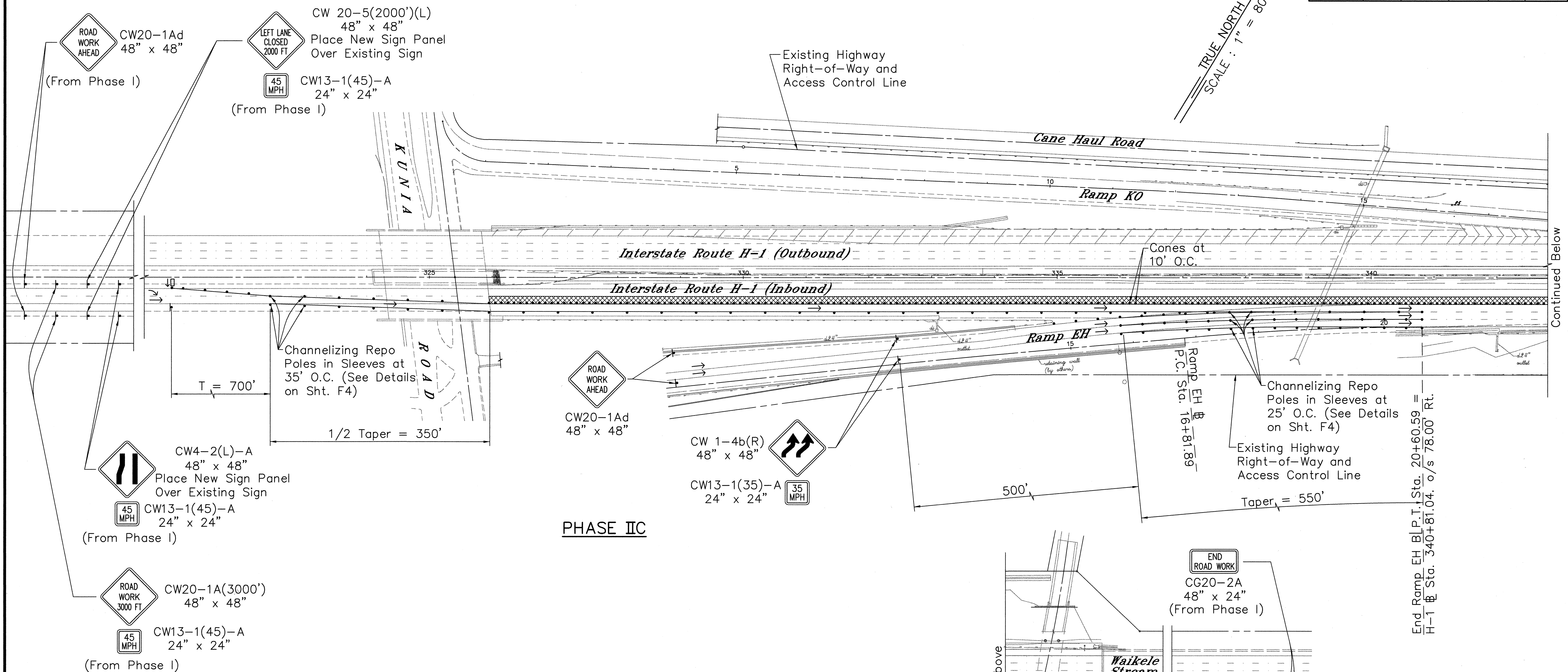

Description of Work:

Cold Planing and Resurfacing of the H-1 Freeway (Inbound) Second Lane From the Left From H-1 Sta. 325+95± to H-1 Sta. 384+90±, Excluding the Hoaeae Grade Separation Structure Bridge Deck.

The Intent of this Traffic Control Plan For This Phase is to Divert Both Lanes of the Kunia Interchange Ramp EH and the Freeway Right Lane to the Newly Resurfaced Right Two Lanes and the Shoulder Lane During the Hours From 8:30 AM to 3:00 PM, Monday Through Friday, Excluding Holidays. The Contractor is Required to Plan His Daily Work to Cold Plane and Pave in One Continuous Operation to Reopen the Lane to Traffic by 3:00 PM That Same Afternoon. The Contractor Will Also be Required to Place Temporary Striping on a Daily Basis to Restore Striping of the Freeway Lane. Upon Completion of All Paving for This Phase, the Contractor Will be Required to Install Permanent Pavement Markings For This Lane.

Estimated Quantities:

Pay Items: None

Incidental Items:

Repo Poles in Sleeve - 70 Each

Note: Cover Shoulder Lane Signs During This Phase.

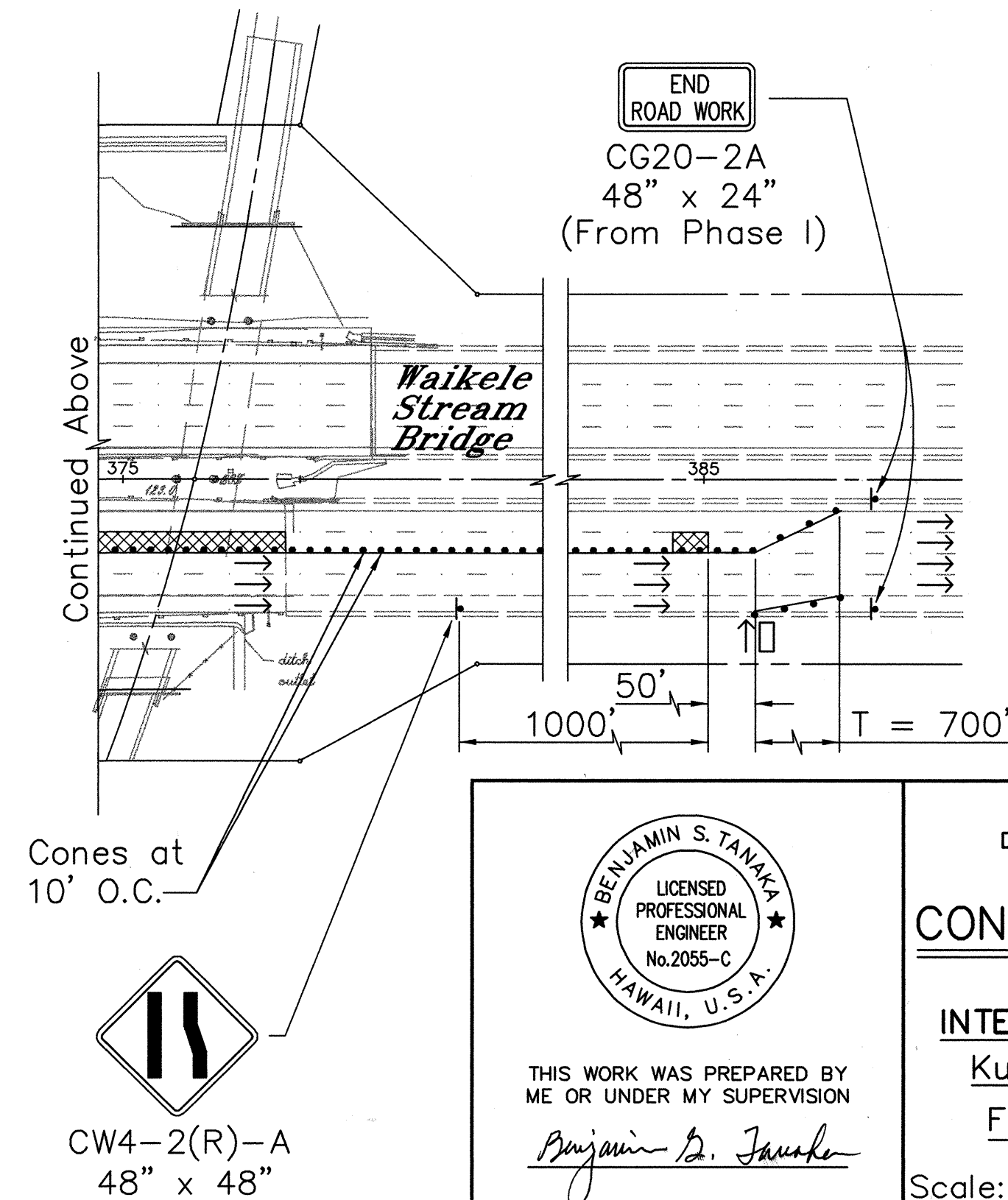

SURVEY PLOTTED BY	DATE
DRAWN BY	
DESIGNED BY	
QUANTITIES BY	
CHECKED BY	
ORIGINAL PLAN	
NO.	

DATE: 7/01/98
SCALE: 1" = 80'
FILE: 9814-32

PM: BST
OPER: SHA*FAJCDK
REVISED: 04/26/99

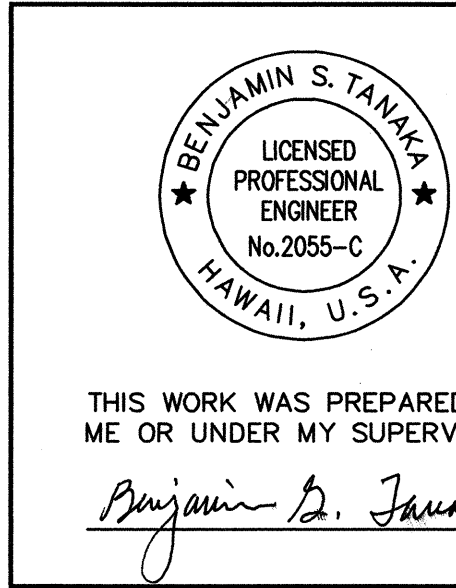

STATE OF HAWAII DEPARTMENT OF TRANSPORTATION HIGHWAYS DIVISION
CONSTRUCTION PHASING PLAN
INTERSTATE ROUTE H-1 RESURFACING Kunia IC to Waialeale Stream Bridge F.A.I. Project No. NH-H1-1(235)
Scale: 1"=80' Date: Apr. 30, 1999
SHEET NO. F5 OF F14 SHEETS

FED. ROAD DIST. NO.	STATE	FED. AID PROJ. NO.	FISCAL YEAR	SHEET NO.	TOTAL SHEETS
HAWAII	HAW.	NH-H1-1(234)	1999	35	84

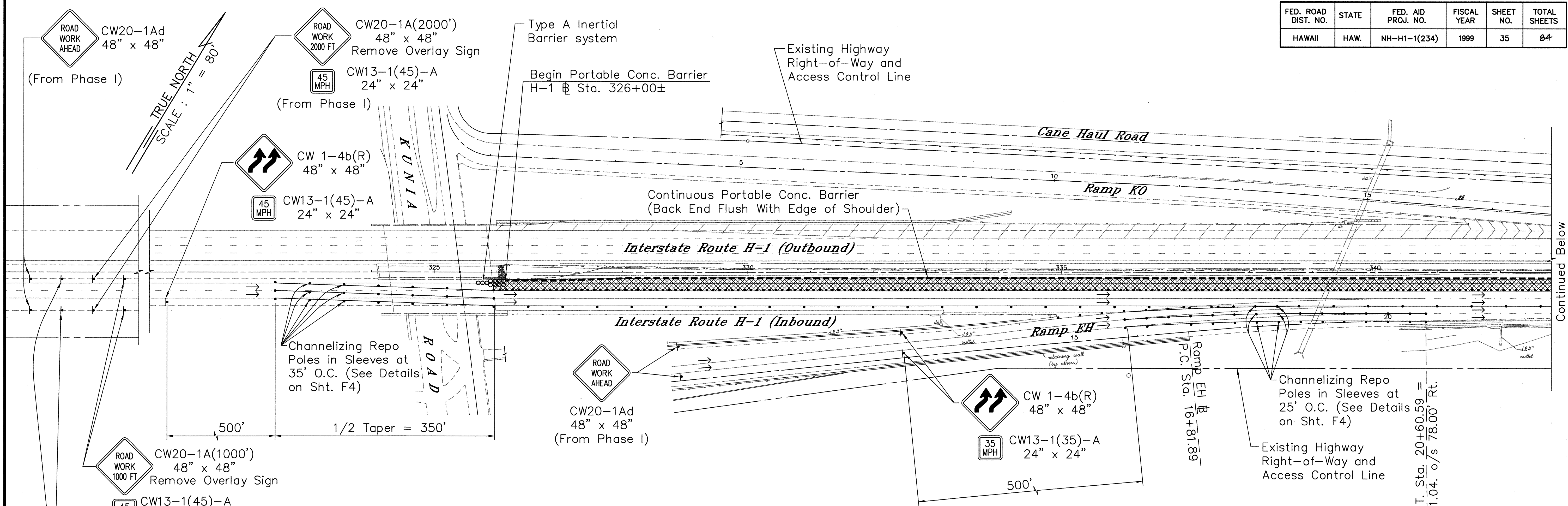

PHASE IID

Description of Work:

Cold Planing and Resurfacing of the H-1 Freeway (Inbound) Left Lane Plus Shoulder From H-1 Sta. 325+95± to H-1 Sta. 384+90±, Excluding the Hoaeae Grade Separation Structure Bridge Deck.

Either Before or After the Resurfacing Operations, the Contractor is to Install Continuous Portable Concrete Barriers to Facilitate Removal and Reinstallation of Type 3-Single Metal Beam Guardrails in the Median From Kunia Road Grade Separation Structure to the H-1 Sta. 376+00±.

The Intent of this Traffic Control Plan For This Phase is to Divert Both Lanes of the Kunia Interchange Ramp EH and the Freeway to the Newly Resurfaced Lanes During the Hours From 8:30 AM to 3:00 PM, Monday Through Friday, Excluding Holidays. The Contractor is Required to Plan His Daily Work to Cold Plane and Pave in One Continuous Operation to Reopen the Lane to Traffic by 3:00 PM That Same Afternoon. The Contractor Will Also be Required to Place Temporary Striping on a Daily Basis to Restore Striping of the Freeway Lane. Upon Completion of All Paving for This Phase, the Contractor Will be Required to Install Permanent Pavement Markings For This Lane.

Estimated Quantities:

- Pay Items:**
- Furnish and Install New Portable Concrete barriers - 75 Each
 - Type A Inertial Barrier System - 1 Each
- Incidental Items:**
- Reset Portable Concrete Barriers - 175 Each
 - Repo Poles in Sleeves - 80 Each

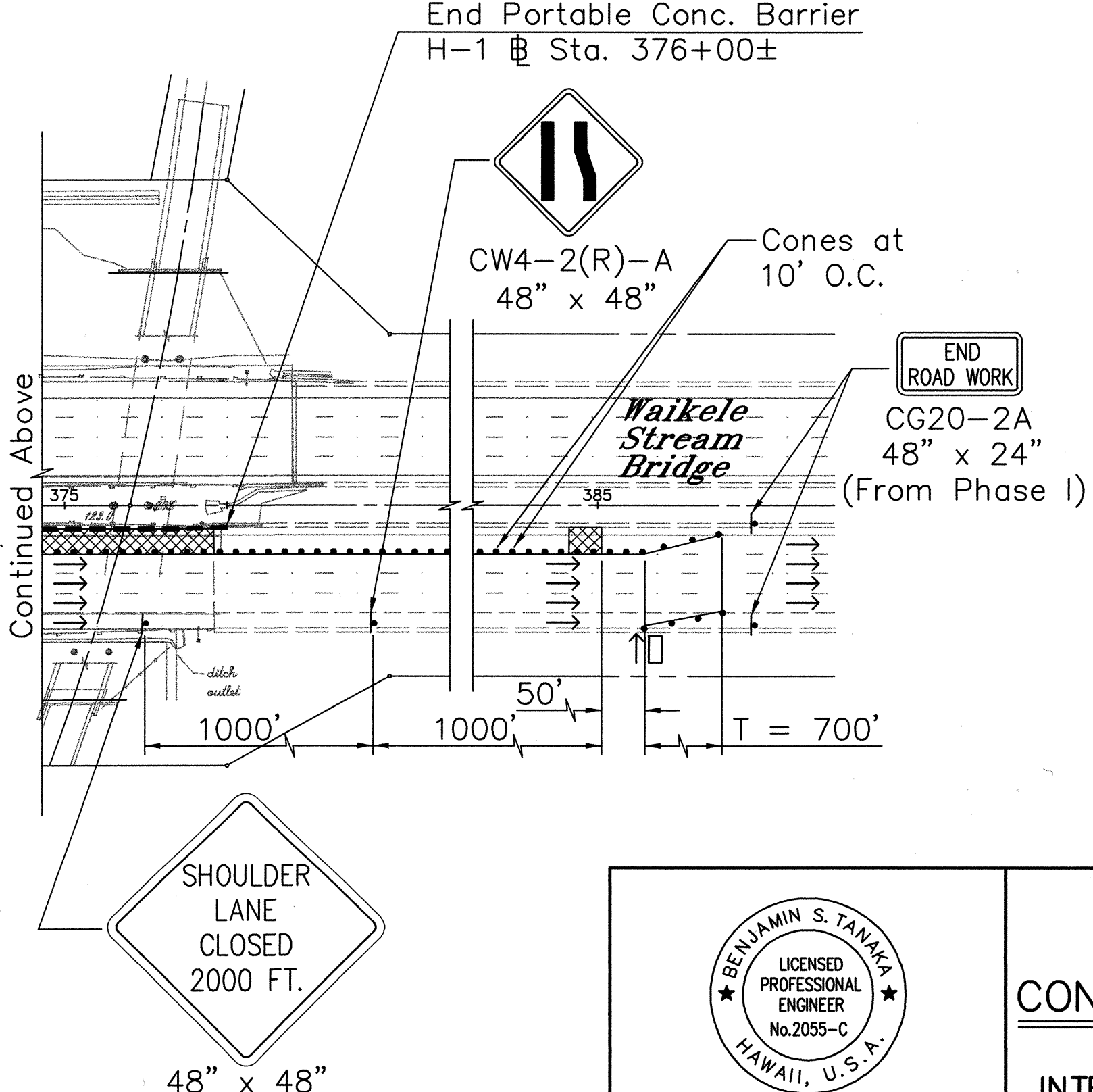

SURVEY PLOTTED BY	DATE
DRAWN BY	
DESIGNED BY	
QUANTITIES BY	
CHECKED BY	

ORIGINAL PLAN	NO.
NOTEBOOK	

DATE: 7/01/98
SCALE: 1" = 80'
FILE: 9814-33

BST
OPER: SHA*FAJ/CDK
REVISED: 04/26/99

BENJAMIN S. TANAKA
LICENSED PROFESSIONAL ENGINEER
No. 2055-C
HAWAII, U.S.A.

THIS WORK WAS PREPARED BY ME OR UNDER MY SUPERVISION

Benjamin S. Tanaka

STATE OF HAWAII
DEPARTMENT OF TRANSPORTATION
HIGHWAYS DIVISION

CONSTRUCTION PHASING PLAN

INTERSTATE ROUTE H-1 RESURFACING
Kunia IC to Waikale Stream Bridge
F.A.I. Project No. NH-H1-1(235)

Scale: 1"=80' Date: Apr. 30, 1999

SHEET NO. F6 OF F14 SHEETS

FED. ROAD DIST. NO.	STATE	FED. AID PROJ. NO.	FISCAL YEAR	SHEET NO.	TOTAL SHEETS
HAWAII	HAW.	NH-H1-1(234)	1999	36	84

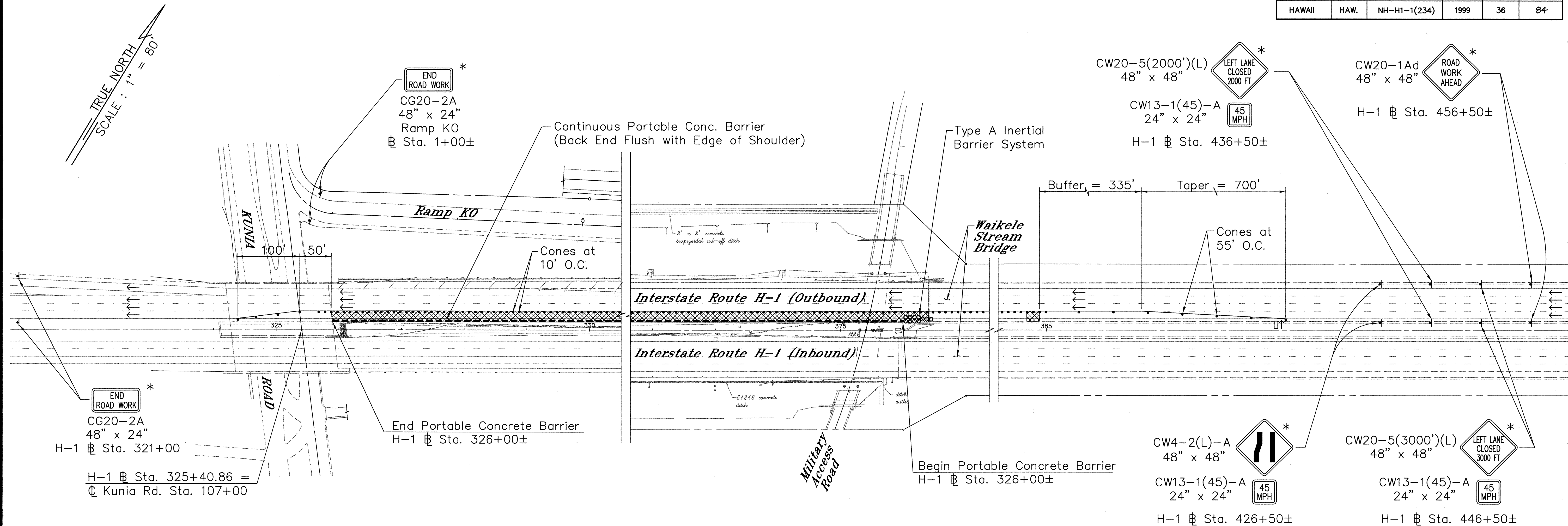

PHASE IIIA

Description of Work:

Cold Planing and Resurfacing of the H-1 Freeway (Outbound)
Left Lane H-1 Sta. 325+95± to H-1 Sta. 384+90±,
Excluding the Hoaeae Grade Separation Structure Bridge Deck.

Either Before or After the Resurfacing Operations, the Contractor is to Install Continuous Portable Concrete Barriers to Facilitate Removal and Reinstallation of Type 3-Single Metal Beam Guardrails in the Median From the Kunia Road Grade Separation Structure to the H-1 Sta. 376+00±.

A Message Board Programmed With the Words "ROAD WORK AHEAD", Shall be Installed for a 72-Hour Period Prior to the Phase IIIA Work. The Location shall be as Determined by the Engineer. To be Incidental to Asphalt Concrete Pavement, Mix No. IV.

The Intent of this Traffic Control Plan For This Phase is to Close the Freeway Left Lane During the Hours From 8:30 AM to 3:00 PM, Monday Through Friday, Excluding Holidays. The Contractor is Required to Plan His Daily Work to Cold Plane and Pave in One Continuous Operation to Reopen the Lane to Traffic by 3:00 PM That Same Afternoon. The Contractor Will Also be Required to Place Temporary Striping on a Daily Basis to Restore Striping of the Freeway Lane. Upon Completion of All Paving for This Phase, the Contractor Will be Required to Install Permanent Pavement Markings For This Lane.

Estimated Quantities:

Pay Items:

- Construction Signs With 2 Posts - 12 Each
- Type A Inertial Barrier System - 1 Each **

Incidental Items:

- Reset Portable Concrete Barriers - 250 Each

** Refer to Details on Sht. F-14 for Number and Types of Barrels and Section 647 of the Specifications for Basis of Payment.

* Construction Signs with 2 Posts:
To be Installed at the Start of Phase III and to be Removed at the End of Phase IV. To be paid Under Item 621.7200, Construction Signs with 2 Posts.

SURVEY PLOTTED BY	DATE
DRAWN BY	
DESIGNED BY	
QUANTITIES BY	
CHECKED BY	
ORIGINAL PLAN	NO.
NOTEBOOK	

DATE: 7/01/98
SCALE: 1" = 80'
FILE: 9814-31

PM: BST
OPER: *SHA,FAJ,CDK
REVISED: 04/28/99

THIS WORK WAS PREPARED BY ME OR UNDER MY SUPERVISION

Benjamin S. Tanaka

STATE OF HAWAII
DEPARTMENT OF TRANSPORTATION
HIGHWAYS DIVISION

CONSTRUCTION PHASING PLAN

INTERSTATE ROUTE H-1 RESURFACING
Kunia IC to Waiekele Stream Bridge
F.A.I. Project No. NH-H1-1(235)

Scale: 1"=80' Date: Apr. 30, 1999

SHEET NO. F7 OF F14 SHEETS

FED. ROAD DIST. NO.	STATE	FED. AID PROJ. NO.	FISCAL YEAR	SHEET NO.	TOTAL SHEETS
HAWAII	HAW.	NH-H1-1(234)	1999	37	84

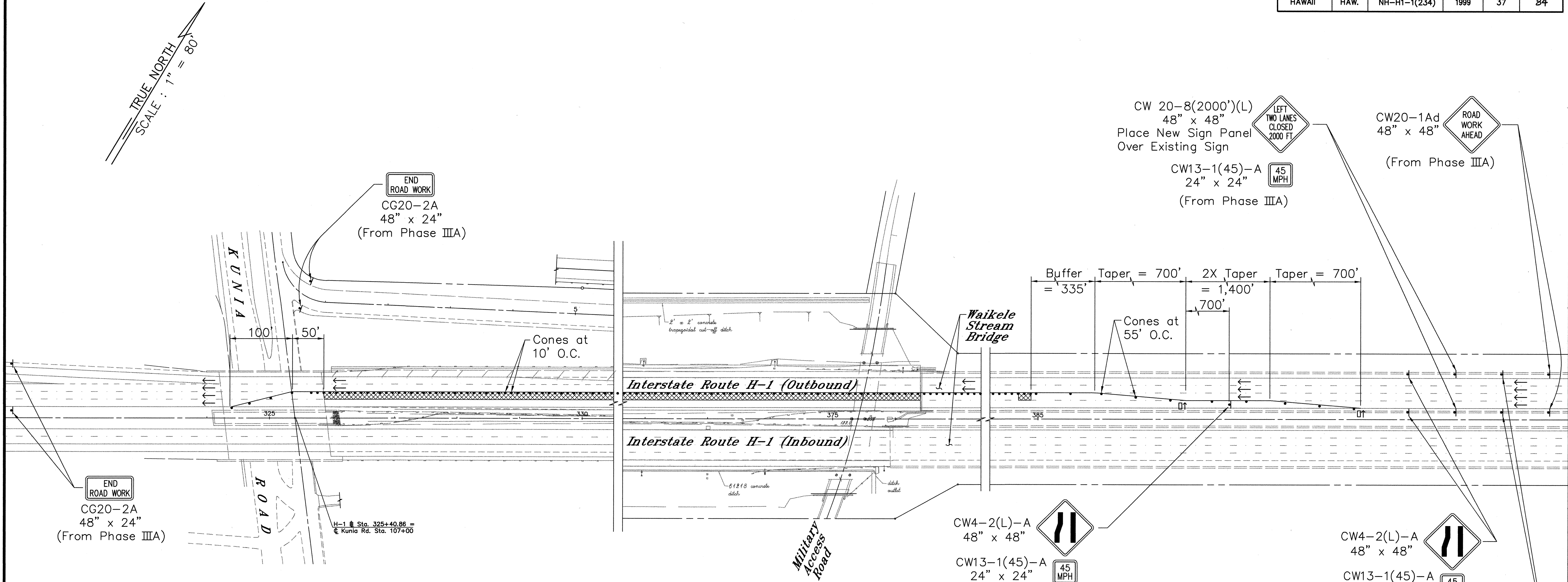

PHASE IIIB

Description of Work:

Cold Planing and Resurfacing of the H-1 Freeway (Outbound) Second Lane From the Left From H-1 Sta. 325+95± to H-1 Sta. 384+90±, Excluding the Hoaeae Grade Separation Structure Bridge Deck.

The Intent of this Traffic Control Plan For This Phase is to Close the Second Lane From the Left During the Hours From 8:30 AM to 3:00 PM, Monday Through Friday, Excluding Holidays. The Contractor is Required to Plan His Daily Work to Cold Plane and Pave in One Continuous Operation to Reopen the Lane to Traffic by 3:00 PM. The Contractor Will Also be Required to Place Temporary Striping on a Daily Basis to Restore Striping of the Freeway Lane. Upon Completion of All Paving for This Phase, the Contractor Will be Required to Install Permanent Pavement Markings For This Lane.

Estimated Quantities:

Pay Items: None

Incidental Items: None

SURVEY PLOTTED BY	DATE
DRAWN BY	
DESIGNED BY	
CHECKED BY	
ORIGINAL PLAN	NO.
NOTEBOOK	

THIS WORK WAS PREPARED BY ME OR UNDER MY SUPERVISION

Benjamin S. Tanaka

STATE OF HAWAII
DEPARTMENT OF TRANSPORTATION
HIGHWAYS DIVISION

CONSTRUCTION PHASING PLAN

INTERSTATE ROUTE H-1 RESURFACING
Kunia IC to Waialeale Stream Bridge
F.A.I. Project No. NH-H1-1(235)

Scale: 1"=80' Date: Apr. 30, 1999

SHEET NO. **F8** OF **F14** SHEETS

FED. ROAD DIST. NO.	STATE	FED. AID PROJ. NO.	FISCAL YEAR	SHEET NO.	TOTAL SHEETS
HAWAII	HAW.	NH-H1-1(234)	1999	38	84

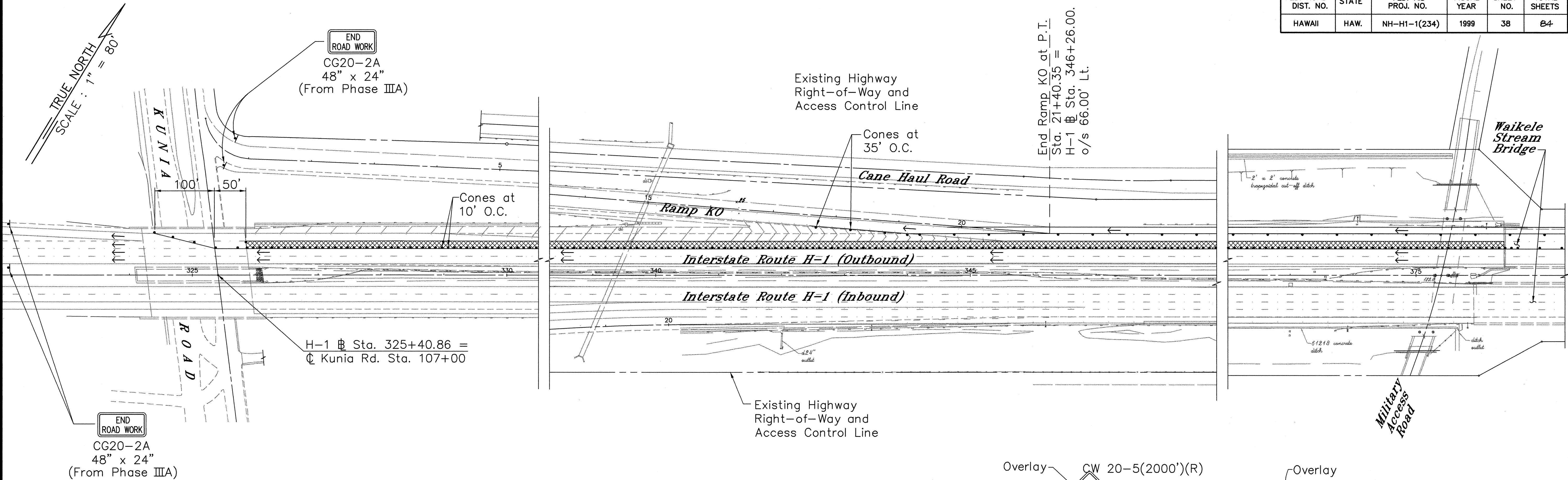

Description of Work:

Cold Planing and Resurfacing of the H-1 Freeway (Outbound) Second Lane From the Right From H-1 Sta. 325+95± to H-1 Sta. 384+90±, Excluding the Hooeae Grade Separation Structure Bridge Deck.

The Intent of this Traffic Control Plan For This Phase is to Close the Second Lane From the Right During the Hours From 8:30 AM to 3:00 PM, Monday Through Friday, Excluding Holidays. The Contractor is Required to Plan His Daily Work to Cold Plane and Pave in One Continuous Operation to Reopen the Lane to Traffic by 3:00 PM. The Contractor Will Also be Required to Place Temporary Striping on a Daily Basis to Restore Striping of the Freeway Lane. Upon Completion of All Paving for This Phase, the Contractor Will be Required to Install Permanent Pavement Markings For This Lane.

Estimated Quantities:

Pay Items: None

Incidental Items:

- Traffic Control Signs - 3 Each
- Message Boards - 2 Each

PHASE III

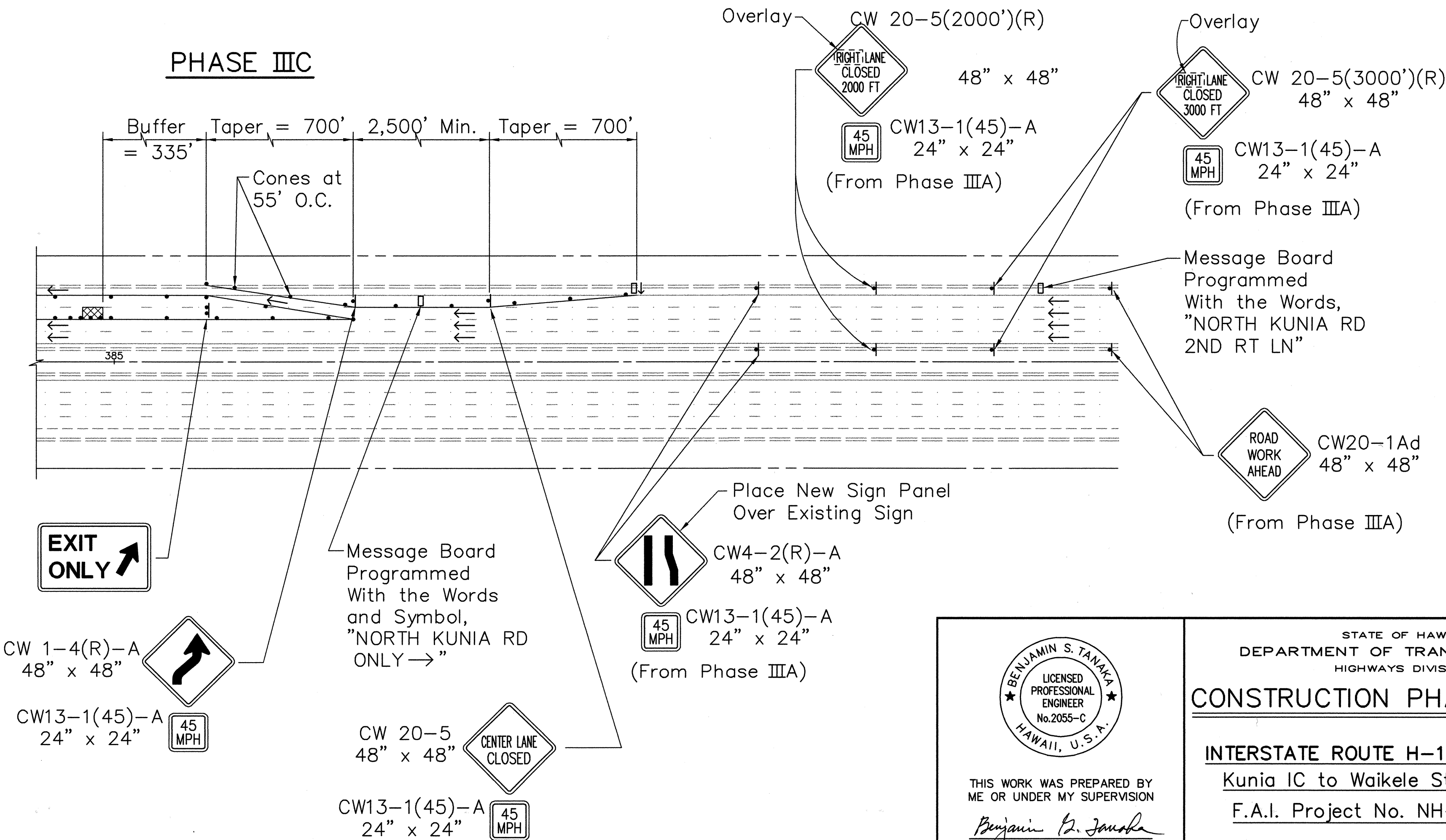

THIS WORK WAS PREPARED BY ME OR UNDER MY SUPERVISION

Benjamin S. Tanaka

STATE OF HAWAII
DEPARTMENT OF TRANSPORTATION
HIGHWAYS DIVISION

CONSTRUCTION PHASING PLAN

INTERSTATE ROUTE H-1 RESURFACING
Kunia IC to Waikele Stream Bridge
F.A.I. Project No. NH-H1-1(235)

Scale: 1"=80' Date: Apr. 30, 1999

SHEET NO. F9 OF F14 SHEETS

DATE: 7/01/98

SCALE: 1"=80'

FILE: 9814-35

PM: BST

OPER: *SHAFALCDK

REVISED: 04/28/99

SURVEY PLOTTED BY

DATE

DRAWN BY

DATE

DESIGNED BY

DATE

QUANTITIES BY

DATE

CHECKED BY

DATE

ORIGINAL PLAN

NO.

NOTEBOOK

NO.

FED. ROAD DIST. NO.	STATE	FED. AID PROJ. NO.	FISCAL YEAR	SHEET NO.	TOTAL SHEETS
HAWAII	HAW.	NH-H1-1(234)	1999	39	84

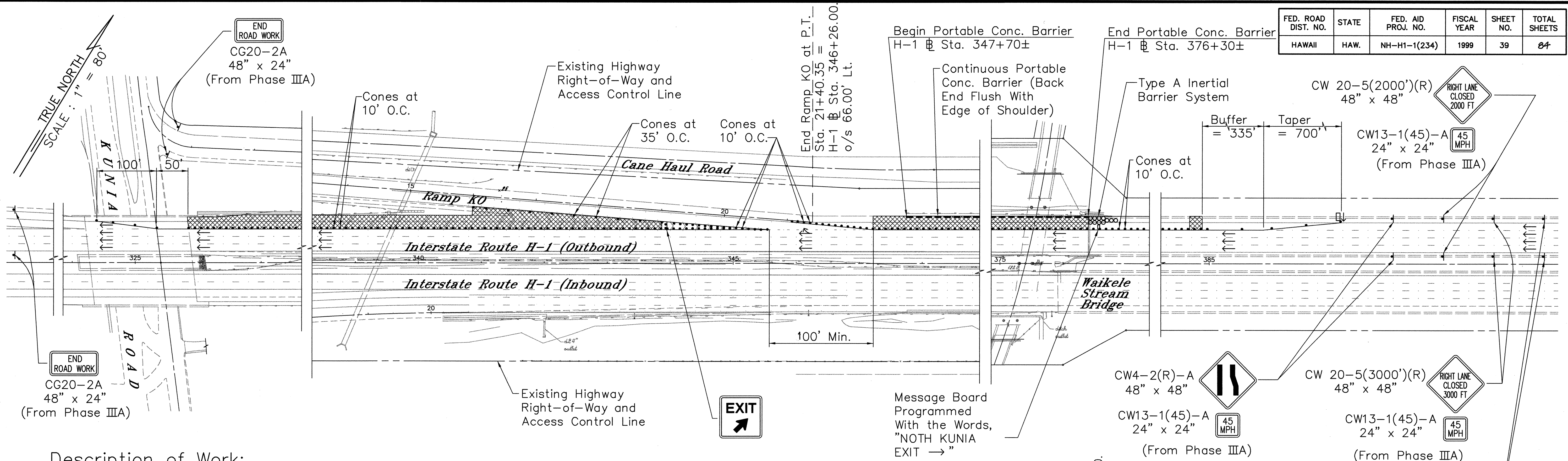

Description of Work:

Cold Planing and Resurfacing of the H-1 Freeway (Outbound) Right Lane Plus Shoulders From H-1 Sta. 325+95± to H-1 Sta. 384+90±, Excluding the Hoaeae Grade Separation Structure Bridge Deck. Also Cold Planing and Resurfacing of Ramp KO Gore Area to Ramp KO Sta. 16+00.

Before the Resurfacing Operations, the Contractor is to Install Continuous Portable Concrete Barriers to Facilitate Removal and Reinstallation of Type 3-Single Metal Beam Guardrails and to Construct New 61616 Concrete Ditch and Highway Lighting Near Waikele Stream Bridge.

The Intent of this Traffic Control Plan For This Phase is to Close the Freeway Right Lane During the Hours From 8:30 AM to 3:00 PM, Monday Through Friday, Excluding Holidays. The Contractor is Required to Plan His Daily Work to Cold Plane and Pave in One Continuous Operation to Reopen the Lane to Traffic by 3:00 PM. The Contractor Will Also be Required to Place Temporary Striping on a Daily Basis to Restore Striping of the Freeway Lane. Upon Completion of All Paving for This Phase, the Contractor Will be Required to Install Permanent Pavement Markings For This Lane.

Estimated Quantities:

Pay Items: None	
Type A Inertial Barrier System	- 1 Each **
Incidental Items:	
Reset Portable Concrete Barriers	- 145 Each
Traffic Control Sign	- 1 Each
Message Board	- 1 Each

** Refer to Details on Sht. F-14 for Number and Types of Barrels and Section 647 of the Specifications for Basis of Payment.

PHASE III D - INCREMENT A

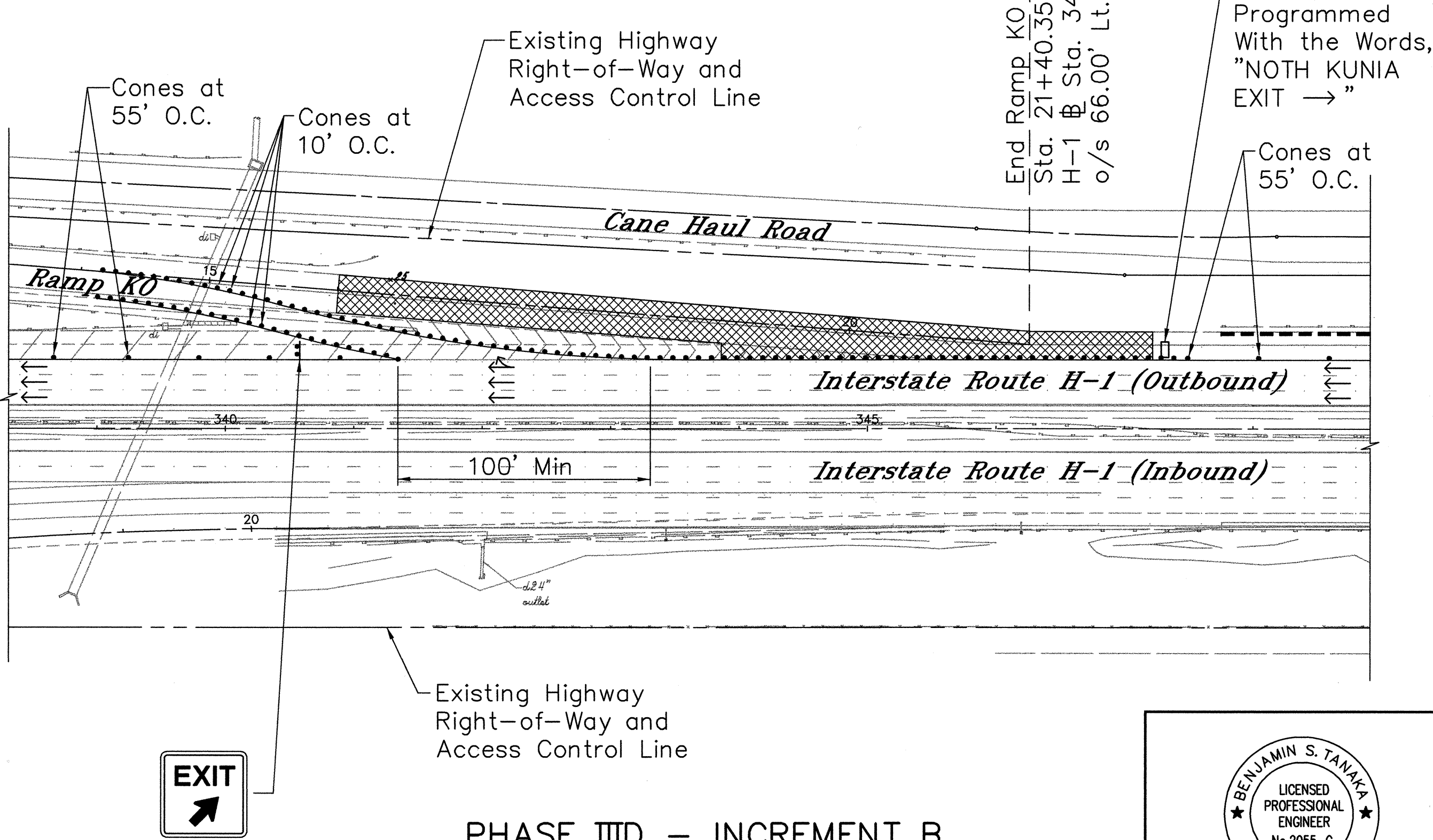

PHASE III D - INCREMENT B

THIS WORK WAS PREPARED BY ME OR UNDER MY SUPERVISION
Benjamin S. Tanaka

STATE OF HAWAII
DEPARTMENT OF TRANSPORTATION
HIGHWAYS DIVISION

CONSTRUCTION PHASING PLAN

INTERSTATE ROUTE H-1 RESURFACING
Kunia IC to Waikele Stream Bridge
F.A.I. Project No. NH-H1-1(235)

Scale: 1"=80' Date: Apr. 30, 1999

SHEET NO. F10 OF F14 SHEETS

DATE: 7/02/98
SCALE: 1" = 80'
FILE: 9814-36

BST
OPER: *SHA,FAI,CDK
REVISED: 04/28/99

SURVEY PLOTTED BY: _____ DATE: _____

DRAWN BY: _____

DESIGNED BY: _____

CHECKED BY: _____

ORIGINAL PLAN: _____

NOTEBOOK: _____

FED. ROAD DIST. NO.	STATE	FED. AID PROJ. NO.	FISCAL YEAR	SHEET NO.	TOTAL SHEETS
HAWAII	HAW.	NH-H1-1(234)	1999	40	84

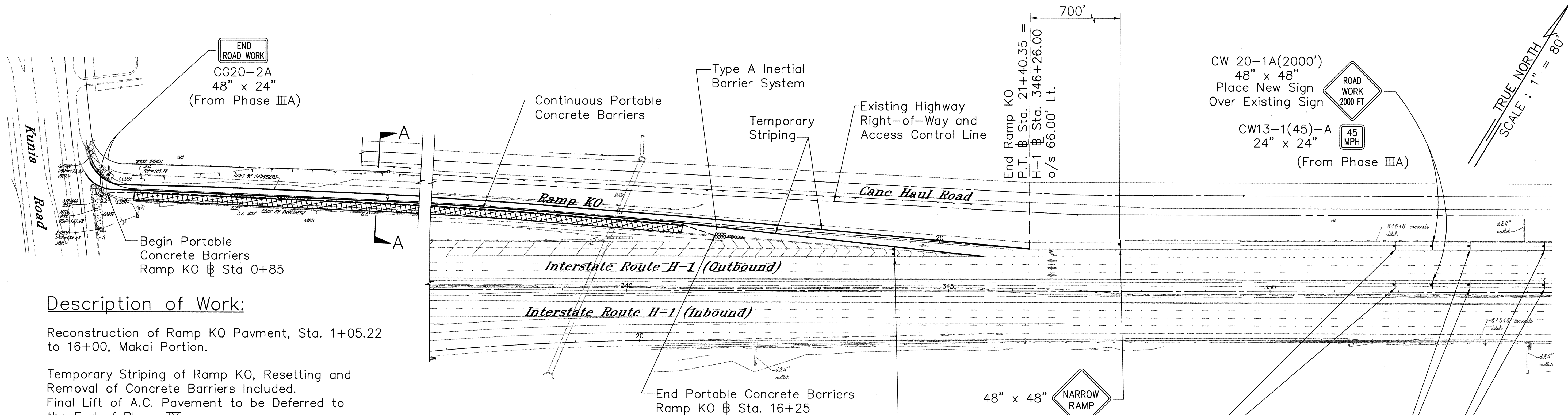

Description of Work:

Reconstruction of Ramp KO Pavment, Sta. 1+05.22 to 16+00, Makai Portion.

Temporary Striping of Ramp KO, Resetting and Removal of Concrete Barriers Included.
Final Lift of A.C. Pavement to be Deferred to the End of Phase IV.

Estimated Quantities:

Pay Items: Type A Inertial Barrier System – 1 Each **

Incidental Items:

- Temporary Striping – 4,200 Lineal Feet
- Reset Portable Concrete Barrier – 77 Each
- Traffic Control Sign – 5 Each

** Refer to Details on Sht. F-14 for Number and Types of Barrels and Section 647 of the Specifications for Basis of Payment.

PHASE IV A

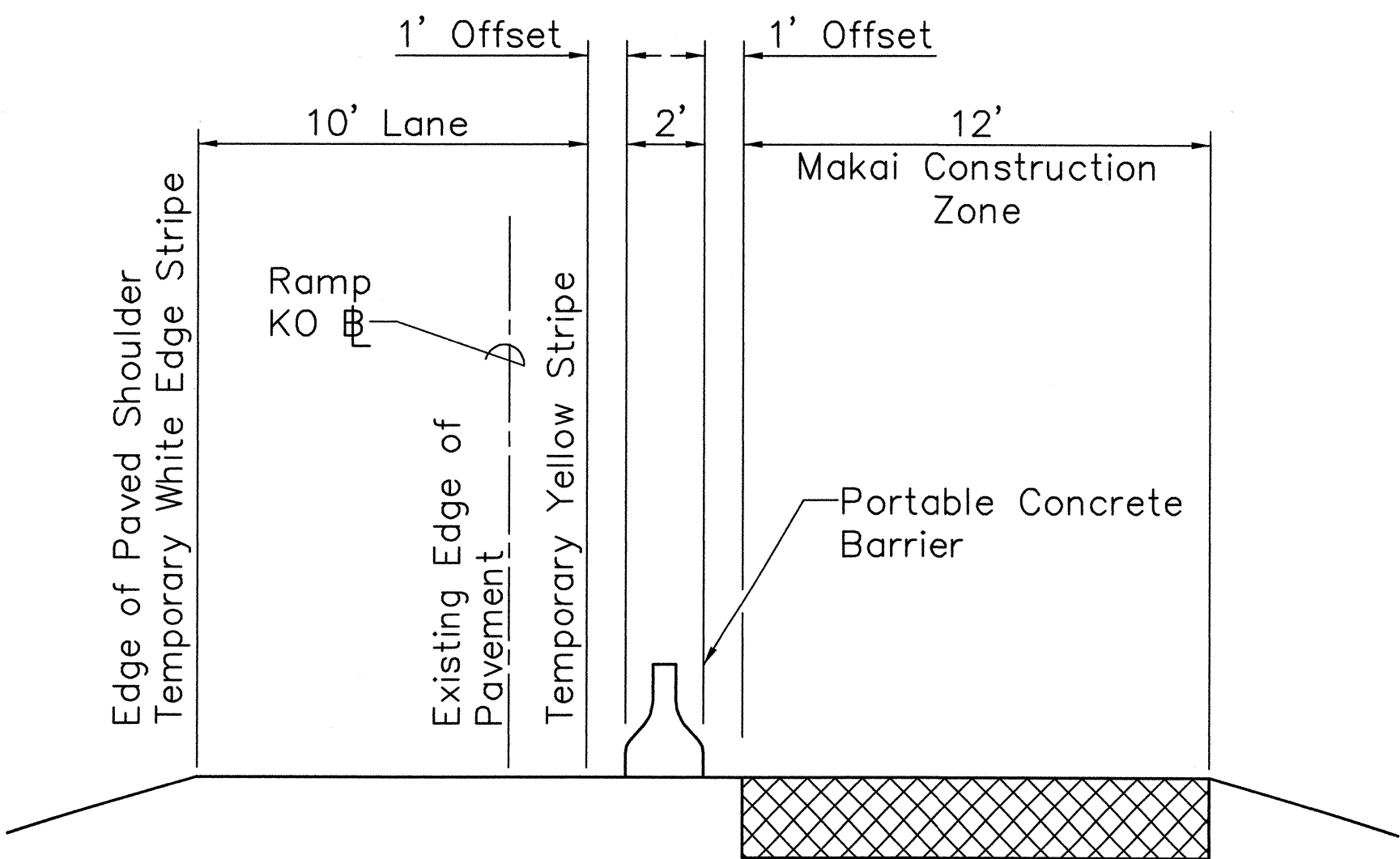

SECTION A-A
NOT TO SCALE

SURVEY PLOTTED BY	DATE
DRAWN BY	
DESIGNED BY	
CHECKED BY	
ORIGINAL PLAN	NO.
NOTEBOOK	

DATE: 7/02/98
SCALE: 1" = 80'
FILE: 9814-37A

BST
PM: OPER: *SHA,FAJ,CDK
REVISED: 04/28/99

THIS WORK WAS PREPARED BY ME OR UNDER MY SUPERVISION

Benjamin S. Tanaka

STATE OF HAWAII
DEPARTMENT OF TRANSPORTATION
HIGHWAYS DIVISION

CONSTRUCTION PHASING PLAN

INTERSTATE ROUTE H-1 RESURFACING
Kunia IC to Waialeale Stream Bridge
F.A.I. Project No. NH-H1-1(235)

Scale: 1"=80' Date: Apr. 30, 1999

SHEET NO. F11 OF F14 SHEETS

FED. ROAD DIST. NO.	STATE	FED. AID PROJ. NO.	FISCAL YEAR	SHEET NO.	TOTAL SHEETS
HAWAII	HAW.	NH-H1-1(234)	1999	42	84

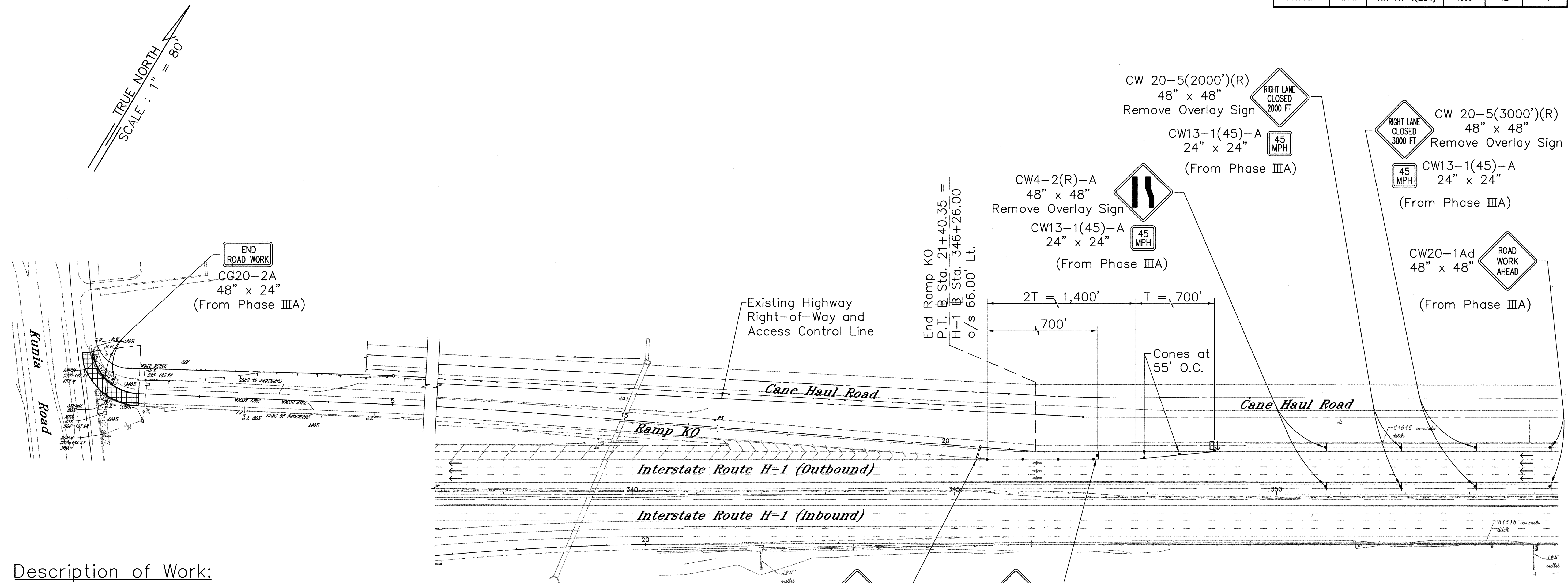

Description of Work:

Excavation and Resurfacing of Ramp KO, Sta. 0+00 to Sta. 1+05.22. Also Final Lift of A.C. Pavement, Sta. 0+00 to Sta. 16+00.

The Intent of the Traffic Control Plan For This Phase is to Close Ramp KO Completely During a Week Night, From 7:00 PM to 5:00 AM. The Contractor Will be Required to Place Temporary Striping to Restore Pavement Markings Temporarily With the Permanent Pavement Markings to Follow Later.

The Contractor Will be Required to Place a Legal Notice in the Newspaper for Three (3) Consecutive Days Informing the Public of the Ramp Closure. Also, a Message Board Shall be Placed for 72 Consecutive Hours Prior to the Ramp Closure.

Also, the Contractor Will be Required to Develop a Detour Plan to Re-route Traffic Affected by the Ramp Closure Via Waialeale Interchange Off-Ramp (Outbound), Paiwa Road, Farrington Highway, and Kunia Road. All Costs Related to Implementing the Detour Plan Shall be Incidental.

Estimated Quantities:

Pay Items:

Legal Ad - Force Account

Incidental Items:

Traffic Control Sign - 3 Each
Type III Barricade - 2 Each
Message Board - 72 Hours

Note:

Place Message Board Programmed With the Words, "Ramp Closed Ahead". Location to be Determined by the Engineer.

PHASE IV C

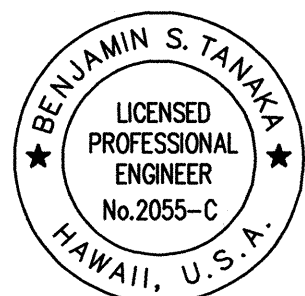
 <p>THIS WORK WAS PREPARED BY ME OR UNDER MY SUPERVISION <i>Benjamin S. Tanaka</i></p>	<p>STATE OF HAWAII DEPARTMENT OF TRANSPORTATION HIGHWAYS DIVISION</p> <p>CONSTRUCTION PHASING PLAN</p> <p>INTERSTATE ROUTE H-1 RESURFACING Kunia IC to Waialeale Stream Bridge F.A.I. Project No. NH-H1-1(235)</p> <p>Scale: 1"=80' Date: Apr. 30, 1999</p> <p>SHEET NO. F13 OF F14 SHEETS</p>
---	--

FED. ROAD DIST. NO.	STATE	FED. AID PROJ. NO.	FISCAL YEAR	SHEET NO.	TOTAL SHEETS
HAWAII	HAW.	NH-H1-1(234)	1999	43	84

TEMPORARY STRIPING NOTES:

- Temporary Striping Shall Progress in the Following Manner in Compliance With the State's Standard Traffic Control Plans:
 - Left Lane Closed
Follow Multi-lane Divided Highway - One Lane Closed, Figure 4 - Traffic Control Plan.
 - Left Center Lane Closed
Follow Multi-lane Highway - Center Lane Closed, Figure 5 - Traffic Control Plan.
 - Right Center Lane Closed
Follow Multi-lane Highway - Center Lane Closed, Figure 5 - Traffic Control Plan.
 - Right Lane Closed
Follow Multi-lane Highway - One Lane Closed, Figure 4 - Traffic Control Plan.
- Lane Closures For Temporary Striping Work Will Be Permitted From 8:30 AM to 3:00 PM, Monday to Friday, Excluding Holidays.
- Multi-lane Closures Will Not be Permitted During Temporary Striping Operations.
- A Message Board Programmed With the Words "ROAD WORK AHEAD", Shall be Installed For a 72-Hour Period Prior to the Temporary Striping Operations. The Location Shall be as Determined by the Engineer. To be Incidental to Asphaltic Concrete Pavement, Mix No. IV.
- A Minimum of Two Police Officers Shall be Present During the Entire Temporary Striping Operations.
- Unless Otherwise Indicated For Portable Concrete Barriers, All Work Related to Temporary Striping Shall be Incidental to Asphaltic Concrete Pavement, Mix No. IV.

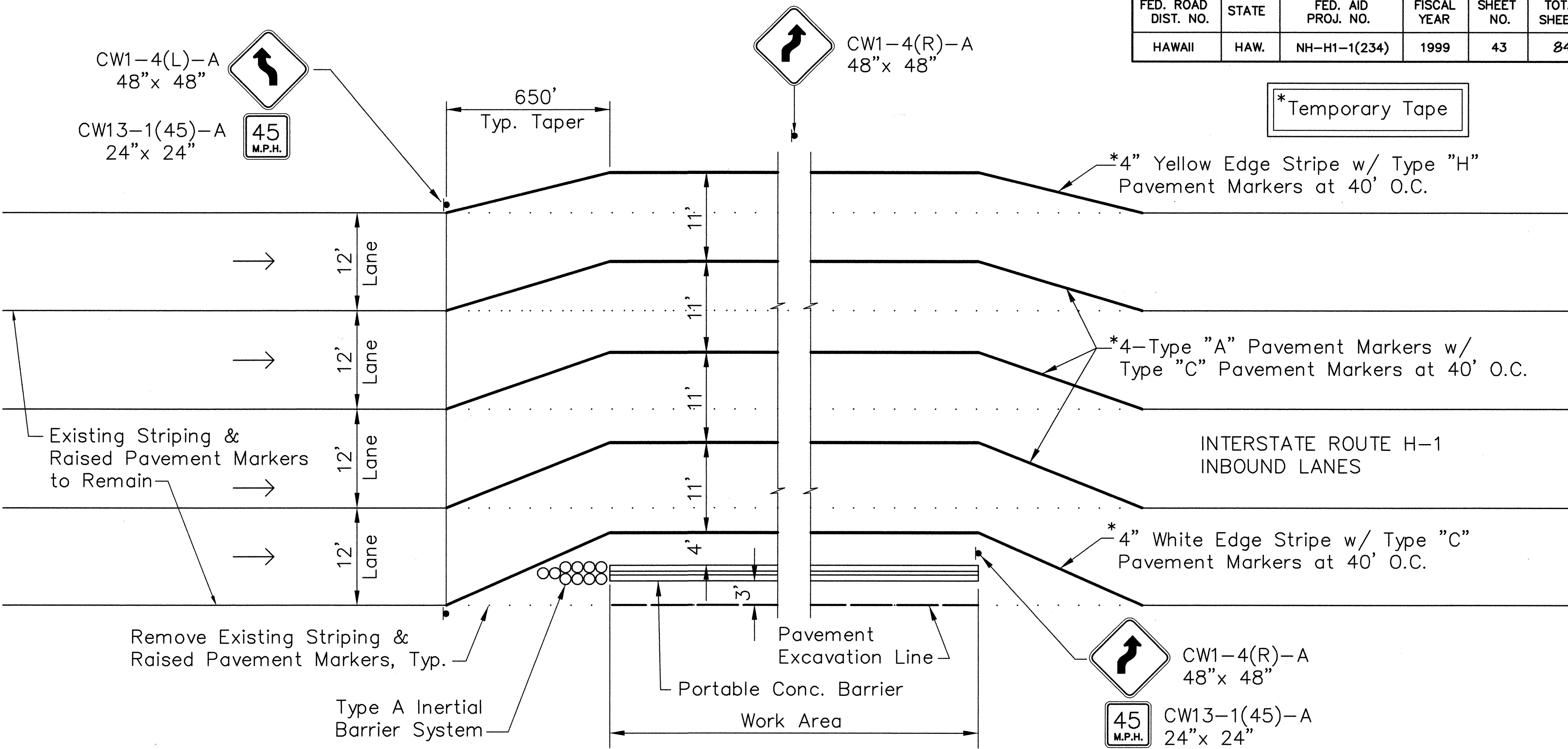

TEMPORARY STRIPING PLAN
Not to Scale

- ②
- ②
- ②
- ②
- ④
- ② ②
- ④ ④
- ④ ④
- ⑦ ⑦
- ⑭ ⑭
- ⑭ ⑭
- ⑳ ㉑

Direction of Travel

TYPE A (70 MPH)

Notes:

- Contractor to Install System Per Manufacture's Recommendation.
- Numbers Indicate Pounds of Sand in Hundreds.
- Refer to Section 647 of the Specifications for Basis of Payment

INERTIAL BARRIER SYSTEM LAYOUT
Not to Scale

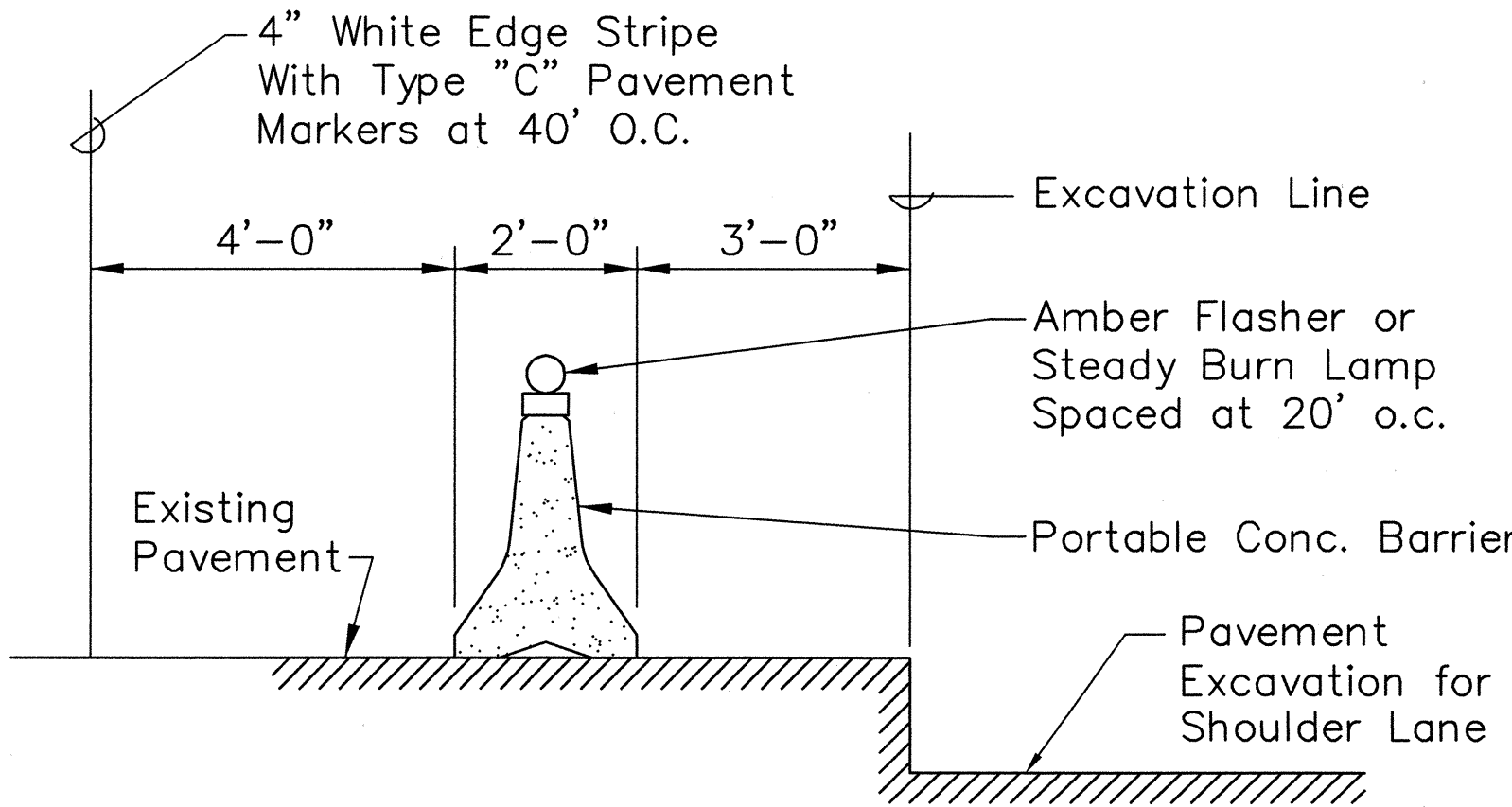

PLACEMENT OF PORTABLE CONC. BARRIER DURING ALL HOURS*
Not to Scale

<p>THIS WORK WAS PREPARED BY ME OR UNDER MY SUPERVISION <i>Benjamin S. Tanaka</i></p>	<p>STATE OF HAWAII DEPARTMENT OF TRANSPORTATION HIGHWAYS DIVISION CONSTRUCTION PHASING DETAILS & NOTES INTERSTATE ROUTE H-1 RESURFACING Kunia IC to Waialeale Stream Bridge F.A.I. Project No. NH-H1-1(235)</p>
	<p>Scale: As Shown Date: Apr. 30, 1999</p>
	<p>SHEET NO. F14 OF F14 SHEETS</p>
	<p>43</p>

DATE: 6/29/98	PM: BST
SCALE: 1" = 1'	OPER: *SHA, FAJ, ODK
FILE: 9814-27	REVISED: 04/28/99

SURVEY PLOTTED BY	DATE
DRAWN BY	
DESIGNED BY	
CHECKED BY	
ORIGINAL PLAN	
NO.	