

FED. ROAD DIST. NO.	STATE	PROJ. NO.	FISCAL YEAR	SHEET NO.	TOTAL SHEETS
HAWAII	HAW.	HIEFG-01-96	1998	155	344

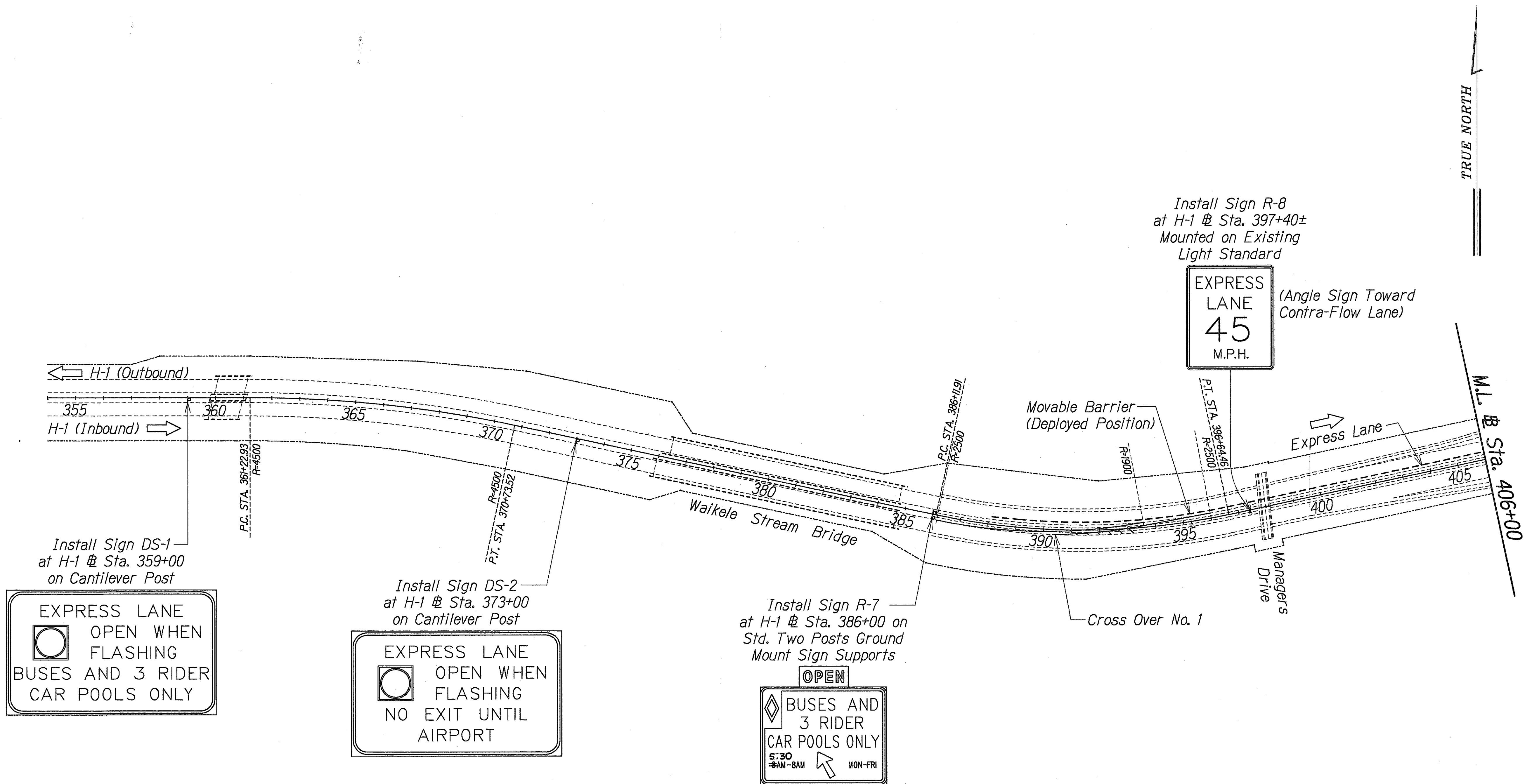

Install Sign DS-1 at H-1 @ Sta. 359+00 on Cantilever Post

EXPRESS LANE  
 OPEN WHEN FLASHING  
 BUSES AND 3 RIDER CAR POOLS ONLY

Install Sign DS-2 at H-1 @ Sta. 373+00 on Cantilever Post

EXPRESS LANE  
 OPEN WHEN FLASHING  
 NO EXIT UNTIL AIRPORT

Install Sign R-7 at H-1 @ Sta. 386+00 on Std. Two Posts Ground Mount Sign Supports

OPEN  
 BUSES AND 3 RIDER CAR POOLS ONLY  
 5:30 AM - 8AM MON-FRI

Install Sign R-8 at H-1 @ Sta. 397+40± Mounted on Existing Light Standard

EXPRESS LANE  
 45 M.P.H.  
 (Angle Sign Toward Contra-Flow Lane)

- Notes:**
- 1- For Mounting of Sign DS-1 and DS-2, See Sheet ST-7 to ST-9
  - 2- For Mounting of Sign R-7, See Standard Plan TE-23.
  - 3- For Mounting of Regulatory Sign R-8, See Standard Plan TE-01.

**SIGNING PLAN - CROSS-OVER NO. 1**  
 Scale: 1" = 200'

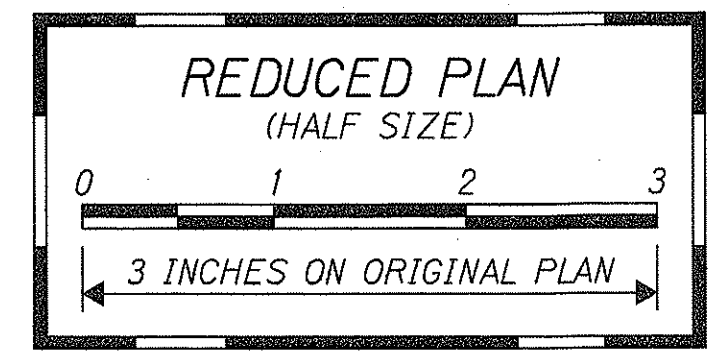

SURVEY PLOTTED BY	DATE
DRAWN BY	
DESIGNED BY	
QUANTITIES BY	
CHECKED BY	
ORIGINAL PLAN	
NOTE BOOK	
N.	



THIS WORK WAS PREPARED BY ME OR UNDER MY SUPERVISION  
*Derrick C. Elfman*  
 P.E., Inc.  
 dba PARK ENGINEERING

STATE OF HAWAII  
 DEPARTMENT OF TRANSPORTATION  
 HIGHWAYS DIVISION

**SIGNING PLAN**  
**CROSS-OVER NO. 1**

INTERSTATE ROUTE H-1  
 CONTRAFLOW AND SHOULDER LANE  
 PROJECT NO. HIEFG-01-96

Scale: 1" = 200' Date: October, 1997

SHEET No. VI OF 8 SHEETS

FED. ROAD DIST. NO.	STATE	PROJ. NO.	FISCAL YEAR	SHEET NO.	TOTAL SHEETS
HAWAII	HAW.	HIEFG-01-96	1998	156	344

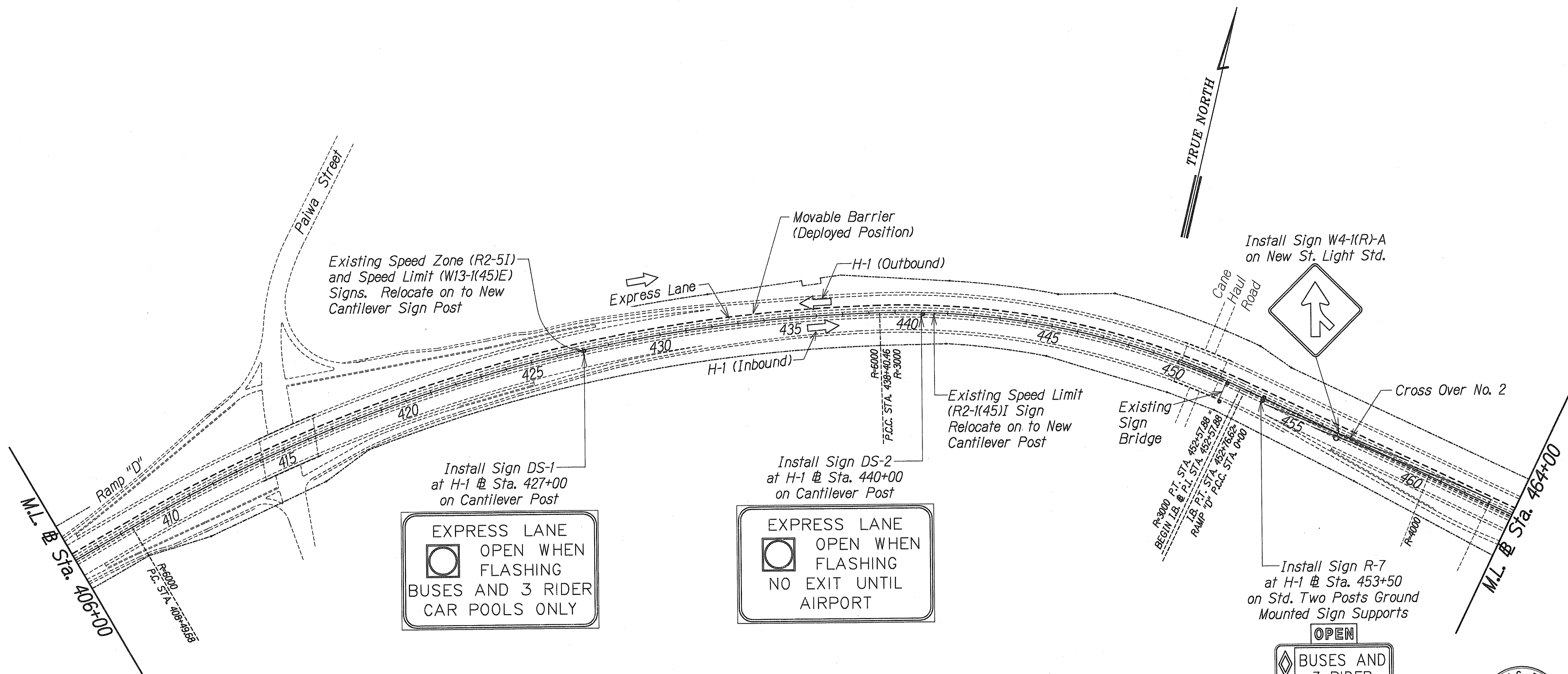

EXPRESS LANE  
 OPEN WHEN FLASHING  
 BUSES AND 3 RIDER CAR POOLS ONLY

EXPRESS LANE  
 OPEN WHEN FLASHING  
 NO EXIT UNTIL AIRPORT

OPEN  
 BUSES AND 3 RIDER CAR POOLS ONLY  
 5.30  
 8AM-8AM MON-FRI

**SIGNING PLAN - CROSS-OVER NO. 2**  
 Scale: 1" = 200'

- Notes:
- 1- For Mounting of Sign DS-1 and DS-2, See Sheet ST-7 to ST-9
  - 2- For Mounting of Sign R-7, See Standard Plan TE-23.

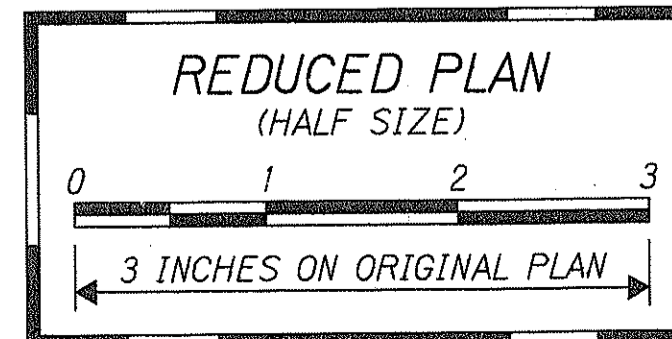

DATE	REVISION
7/06/98	Added Sign W4-1(R)-A

STATE OF HAWAII  
 DEPARTMENT OF TRANSPORTATION  
 HIGHWAYS DIVISION

**SIGNING PLAN**  
**CROSS-OVER NO. 2**

INTERSTATE ROUTE H-1  
 CONTRAFLOW AND SHOULDER LANE  
 PROJECT NO. HIEFG-01-96

Scale: 1" = 200' Date: October, 1997

SHEET No. V2 OF 8 SHEETS



THIS WORK WAS PREPARED BY ME OR UNDER MY SUPERVISION  
*Derrick C. Elfan*  
 PROFESSIONAL ENGINEER  
 dco PARK ENGINEERING

SURVEY PLOTTED BY	DATE
DESIGNED BY	
NOTED BY	
CHECKED BY	

"AS-BUILT"

C.O. 156

FED. ROAD DIST. NO.	STATE	PROJ. NO.	FISCAL YEAR	SHEET NO.	TOTAL SHEETS
HAWAII	HAW.	HIEFG-01-96	1998	157	344

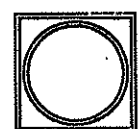
EXPRESS LANE  
  
 OPEN WHEN FLASHING  
 BUSES AND 3 RIDER CAR POOLS ONLY

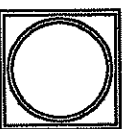
EXPRESS LANE  
  
 OPEN WHEN FLASHING  
 NO EXIT UNTIL AIRPORT

- Notes:**
- 1- For Mounting of Sign DS-1 and DS-2, See Sheet ST-7 to ST-9
  - 2- For Mounting of Sign R-7, See Standard Plan TE-23.
  - 3- For Mounting of Regulatory Sign R-8, See Standard Plan TE-01.

EXPRESS LANE  
 45  
 M.P.H.

Install Sign R-8 at H-1 @ Sta. 466+45± Mounted on Existing Light Standard

M.L. @ Sta. 464+00

Relocate existing "EXIT 8B" and "NORTH SHORE" sign to H-1 @ Sta. 465+00.

Install Sign W4-1(R)-A on existing Conc. Pier

Remove Existing Sign Bridge E-25 and Replace with New Sign Bridge E-25. See Details on Y4 and ST-1 to ST-3.

Install Sign R-7 at H-2 @ Sta. 475+50 on Std. Two Posts Ground Mounted Sign Supports

OPEN  
  
 BUSES AND 3 RIDER CAR POOLS ONLY  
 5:30 - 8AM - 8AM MON-FRI

Install Sign W4-1(R)-A on Overhead Sign Bridge Pier

**SIGNING PLAN - CROSS-OVER NO. 3**

Scale: 1" = 200'

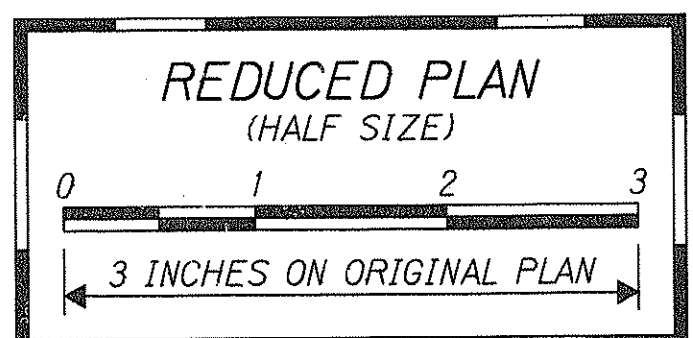

DATE	REVISION
7/06/98	Added New Sign W4-1(R)-A
1/16/98	Added note for relocated existing sign.

STATE OF HAWAII  
 DEPARTMENT OF TRANSPORTATION  
 HIGHWAYS DIVISION

**SIGNING PLAN**  
**CROSS-OVER NO. 3**

INTERSTATE ROUTE H-1  
 CONTRAFLOW AND SHOULDER LANE  
 PROJECT NO. HIEFG-01-96

Scale: 1" = 200' Date: October, 1997

SHEET No. V3 OF 8 SHEETS



THIS WORK WAS PREPARED BY ME OR UNDER MY SUPERVISION  
 [Signature]  
 PROFESSIONAL ENGINEER  
 dba PARK ENGINEERING

"AS-BUILT"

C.O. 157

SURVEY PLOTTED BY	DATE
DRAWN BY	
TRACED BY	
DESIGNED BY	
CHECKED BY	
NO. _____	

FED. ROAD DIST. NO.	STATE	PROJ. NO.	FISCAL YEAR	SHEET NO.	TOTAL SHEETS
HAWAII	HAW.	HIEFG-01-96	1998	158	344

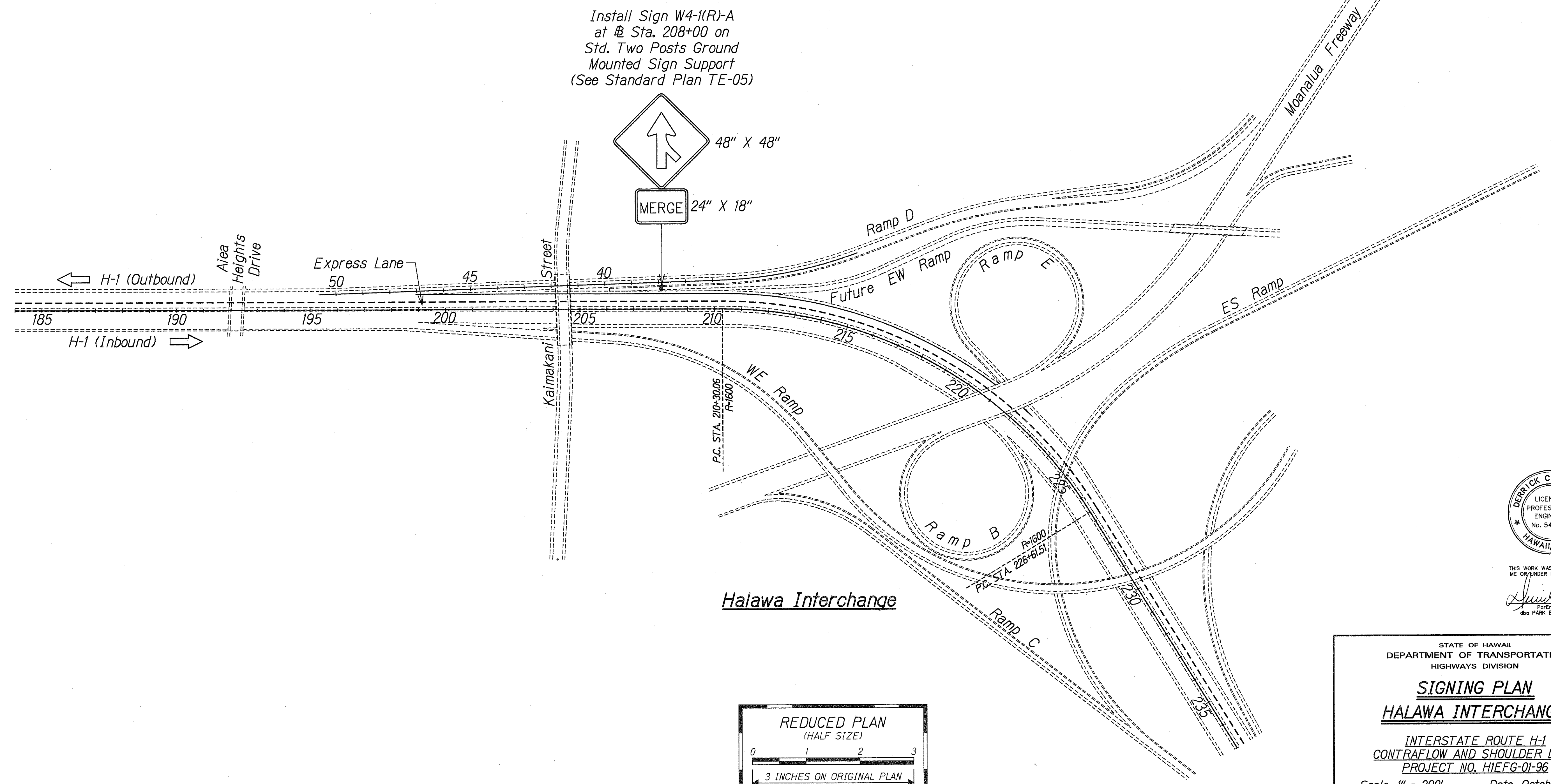
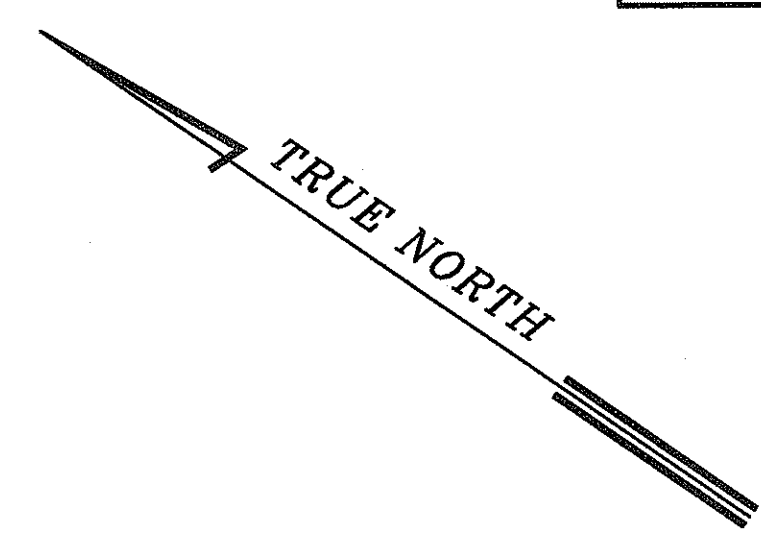

SURVEY PLOTTED BY	DATE
DRAWN BY	
TRACED BY	
CHECKED BY	
ORIGINAL PLAN	
NOTE BOOK	
No.	

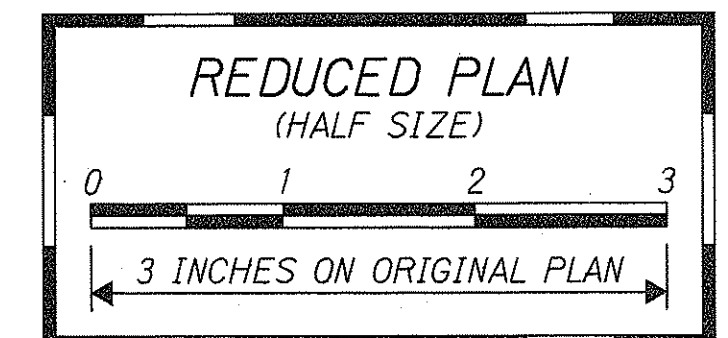

THIS WORK WAS PREPARED BY ME OR UNDER MY SUPERVISION.  
*Derrick C. Elftan*  
 DERRICK C. ELFTAN  
 P.E., INC.  
 280 PARK ENGINEERING

STATE OF HAWAII  
 DEPARTMENT OF TRANSPORTATION  
 HIGHWAYS DIVISION

**SIGNING PLAN**  
**HALAWA INTERCHANGE**

INTERSTATE ROUTE H-1  
 CONTRAFLOW AND SHOULDER LANE  
 PROJECT NO. HIEFG-01-96

Scale: 1" = 200'      Date: October, 1997

SHEET No. **V4** OF **8** SHEETS

FED. ROAD DIST. NO.	STATE	PROJ. NO.	FISCAL YEAR	SHEET NO.	TOTAL SHEETS
HAWAII	HAW.	HIEFG-01-96	1998	159	344

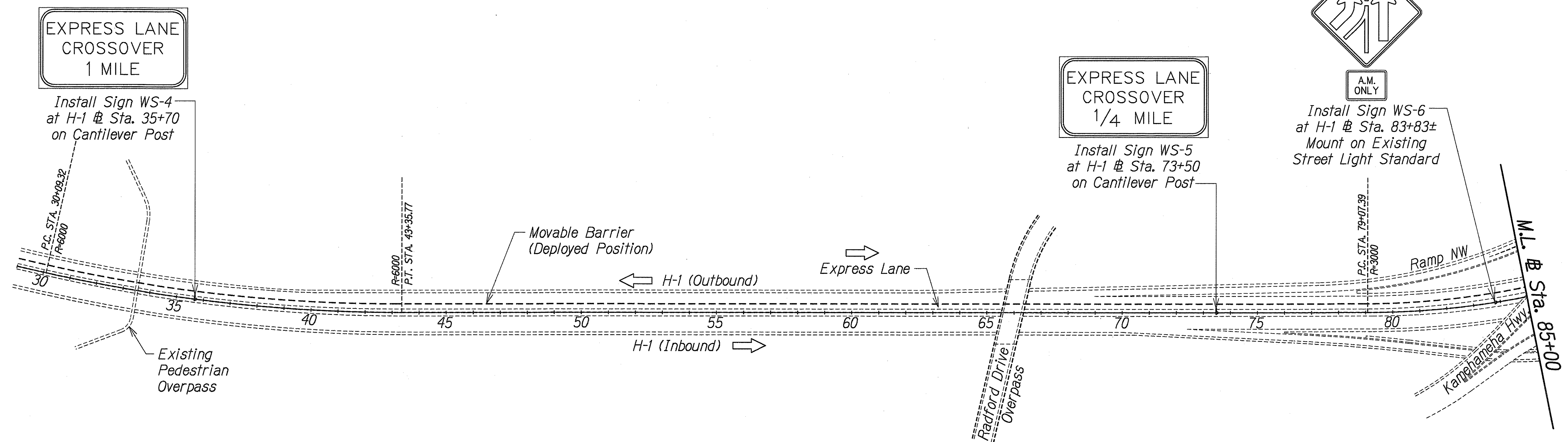
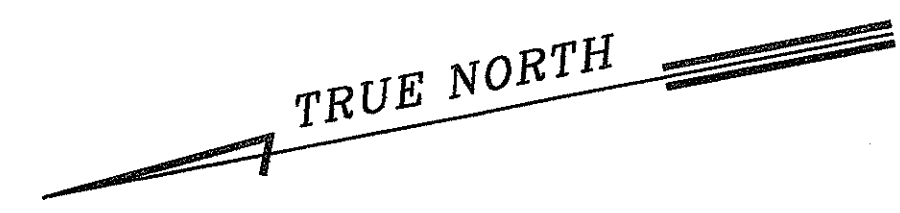

**Notes:**

- 1- For Mounting of Sign WS-4, See Sheet ST-7 to ST-9.
- 2- For Mounting of Sign WS-5, See Sheet ST-7 to ST-9.

**SIGNING PLAN - CROSS-OVER NO. 4**

Scale: 1" = 200'

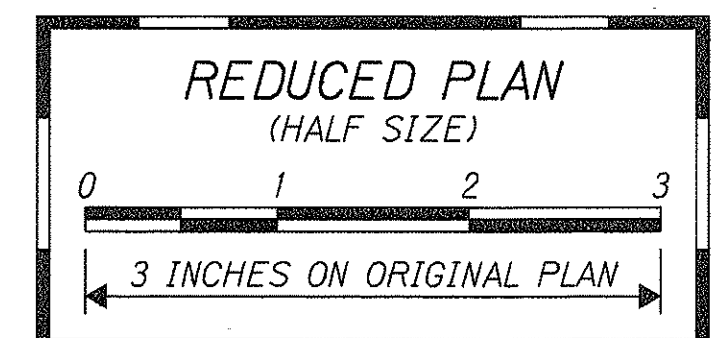

SURVEY PLOTTED BY	DATE
DRAWN BY	
TRACED BY	
QUANTITIES BY	
CHECKED BY	
ORIGINAL PLAN	
NOTE BOOK	
No.	

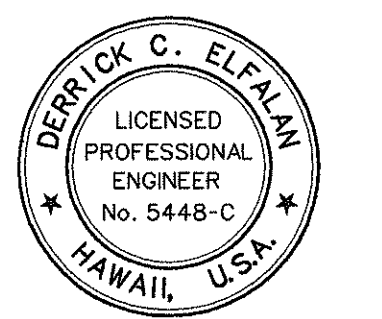

THIS WORK WAS PREPARED BY ME OR UNDER MY SUPERVISION  
*Derrick C. Elfalan*  
 Park Engineering

STATE OF HAWAII  
 DEPARTMENT OF TRANSPORTATION  
 HIGHWAYS DIVISION

**SIGNING PLAN**  
**CROSS-OVER NO. 4**

INTERSTATE ROUTE H-1  
 CONTRAFLOW AND SHOULDER LANE  
 PROJECT NO. HIEFG-01-96

Scale: 1" = 200'      Date: October, 1997

SHEET No. V5 OF 8 SHEETS

FED. ROAD DIST. NO.	STATE	PROJ. NO.	FISCAL YEAR	SHEET NO.	TOTAL SHEETS
HAWAII	HAW.	HIEFG-01-96	1998	C.O.160	344

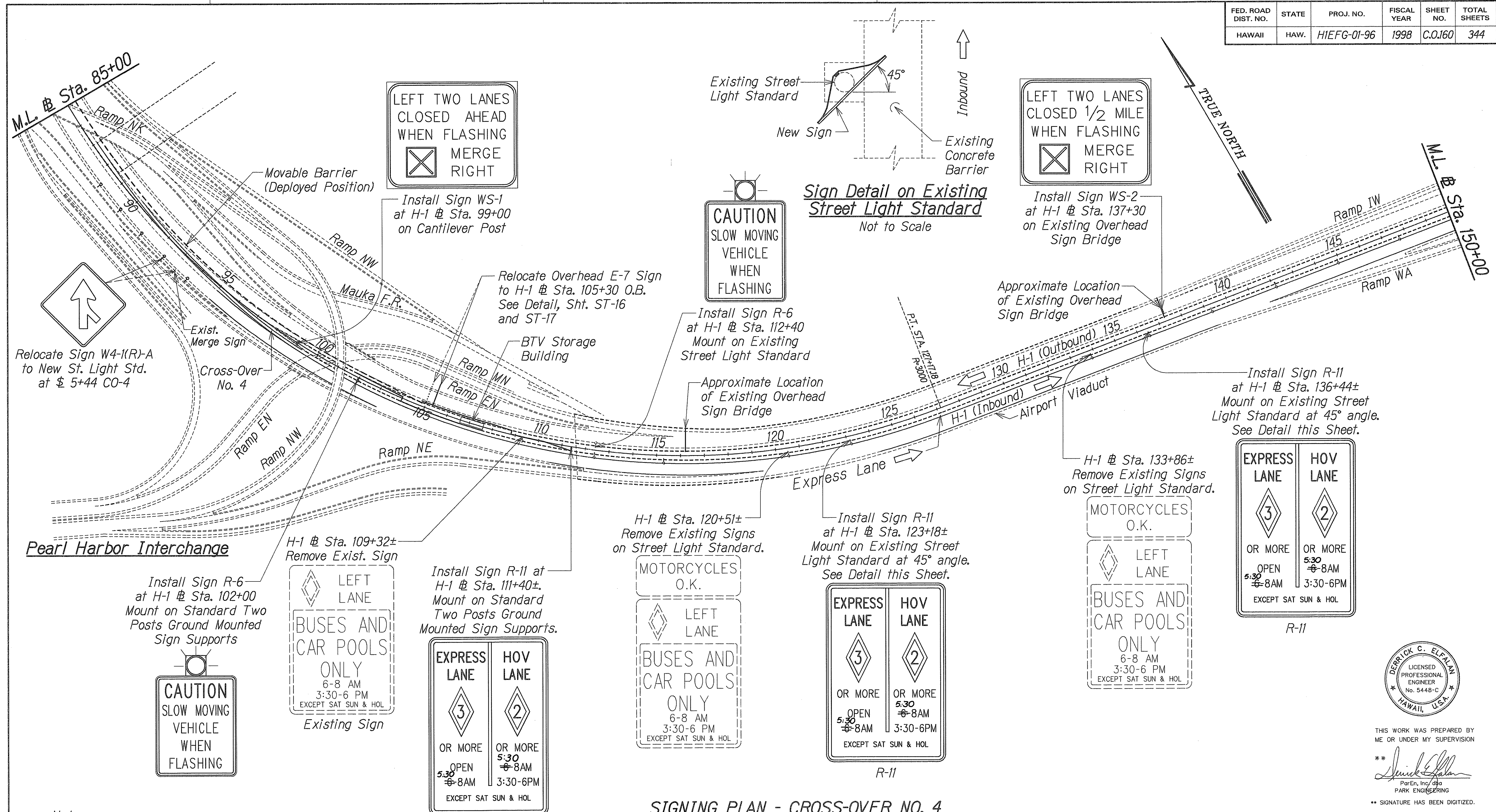

- Notes:**
- 1- For Mounting of Sign WS-1, See Sheets ST-7 to ST-9.
  - 2- For Mounting of Sign WS-2, See Sheets ST-7 to ST-9.
  - 3- For Ground Mounting Sign R-6, See Standard Plan TE-02.
  - 4- For Mounting of Sign on Existing Light Standards, See Standard Plan TE-01 and Detail this Sheet.

**SIGNING PLAN - CROSS-OVER NO. 4**  
Scale: 1" = 200'



DATE	.....
SURVEY PLOTTED BY	.....
DRAWN BY	.....
CHECKED BY	.....
NOTE BOOK	.....
CHECKED BY	.....



THIS WORK WAS PREPARED BY ME OR UNDER MY SUPERVISION  
\*\*  
Signature  
ParEn, Inc., dba  
PARK ENGINEERING  
\*\* SIGNATURE HAS BEEN DIGITIZED.

7/07/98	Relocate Exist. Sign W4-1(R)-A to New St. Light Standard at \$ 5+44 CO-4
6/18/98	Relocated New R-11 Sign from H-1 Sta. 109+32± to H-1 Sta. 111+40±
DATE	REVISION

STATE OF HAWAII  
DEPARTMENT OF TRANSPORTATION  
HIGHWAYS DIVISION

**SIGNING PLAN**  
**CROSS-OVER NO. 4**

INTERSTATE ROUTE H-1  
CONTRAFLOW AND SHOULDER LANE  
PROJECT NO. HIEFG-01-96  
Scale: 1" = 200' Date: October, 1997

SHEET No. V6 OF 8 SHEETS

"AS-BUILT"

C.O. 160

FED. ROAD DIST. NO.	STATE	PROJ. NO.	FISCAL YEAR	SHEET NO.	TOTAL SHEETS
HAWAII	HAW.	HIEFG-01-96	1998	161	344

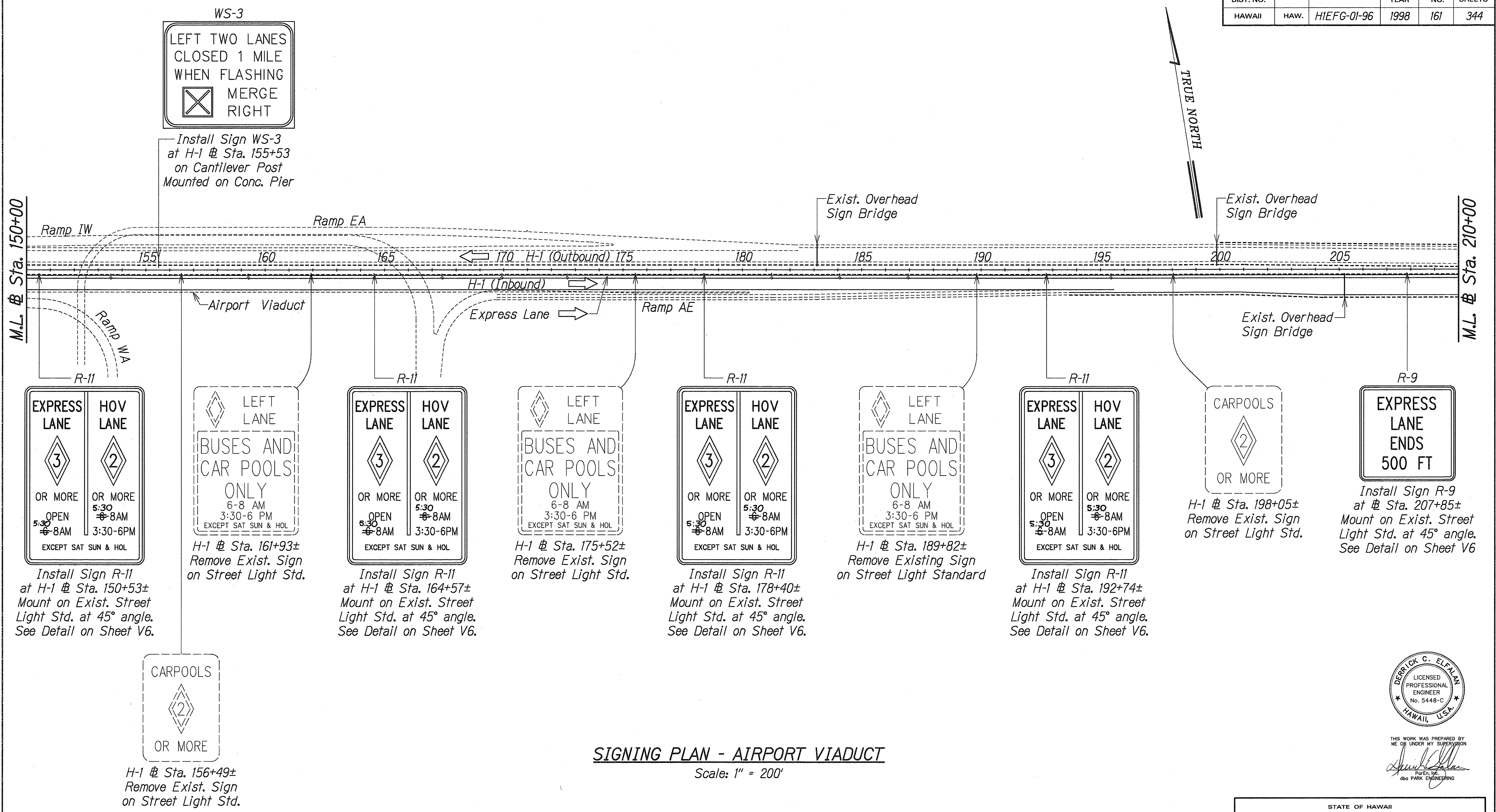

SURVEY PLOTTED BY	DATE
DRAWN BY	
DESIGNED BY	
CHECKED BY	
ORIGINAL PLAN	
NOTE BOOK	

- Notes:**
- 1- For Mounting of Sign WS-3, See Sheet ST-7 to ST-9.
  - 2- For Mounting of Sign on Existing Light Standards, See Standard Plan TE-01 and Detail on Sheet V6.

**SIGNING PLAN - AIRPORT VIADUCT**  
Scale: 1" = 200'

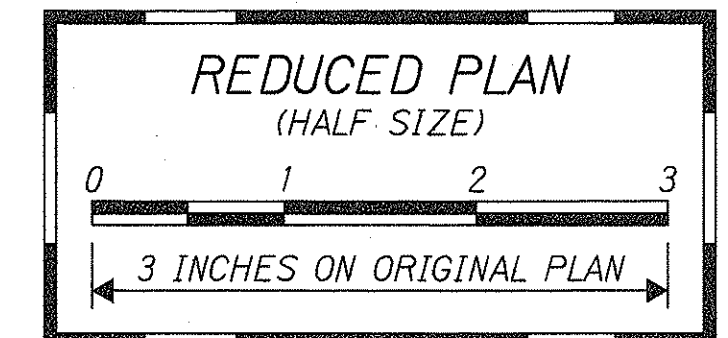

THIS WORK WAS PREPARED BY ME OR UNDER MY SUPERVISION  
*Derrick C. Elfalm*  
Derrick C. Elfalm  
P.O. Box 112  
dco PARK ENGINEERING

STATE OF HAWAII  
DEPARTMENT OF TRANSPORTATION  
HIGHWAYS DIVISION

**SIGNING PLAN**  
**AIRPORT VIADUCT**

INTERSTATE ROUTE H-1  
CONTRAFLOW AND SHOULDER LANE  
PROJECT NO. HIEFG-01-96

Scale: 1" = 200' Date: October, 1997

SHEET No. V7 OF 8 SHEETS

FED. ROAD DIST. NO.	STATE	PROJ. NO.	FISCAL YEAR	SHEET NO.	TOTAL SHEETS
HAWAII	HAW.	HIEFG-01-96	1998	C.O.162	344

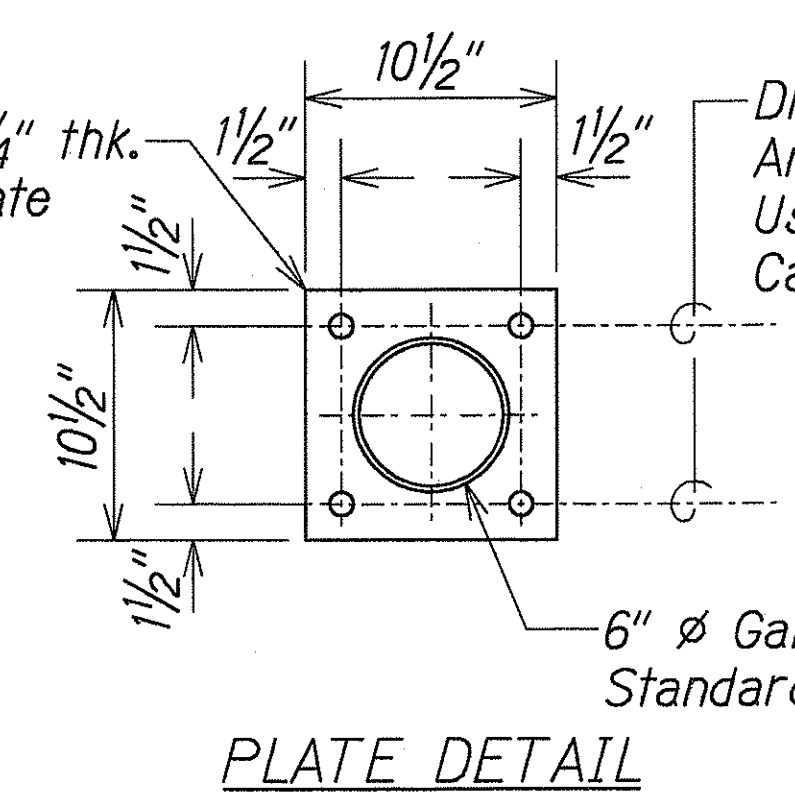
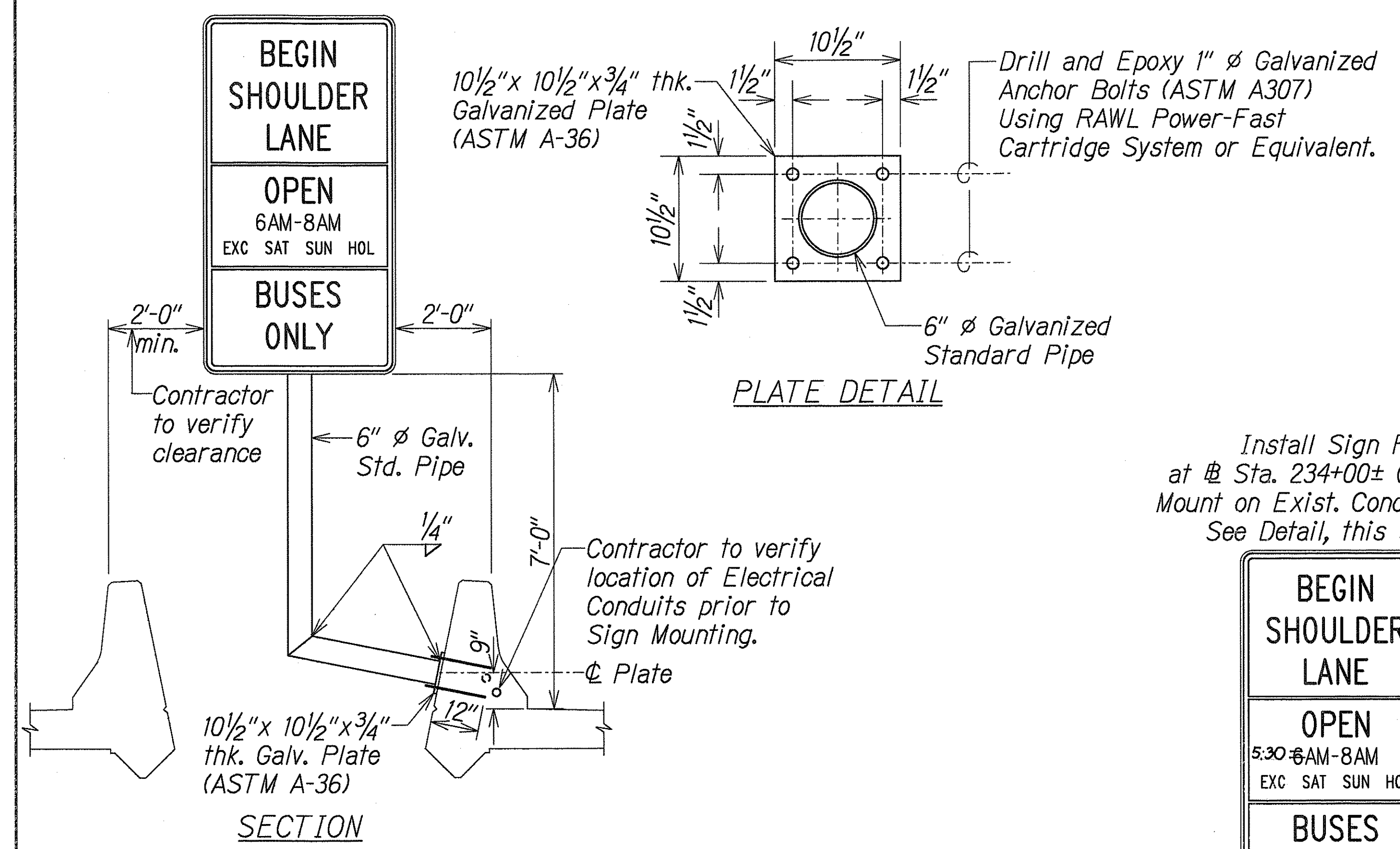

Install Sign R-2 at Sta. 234+00± (H-1 E.B.)  
Mount on Exist. Conc. Parapet.  
See Detail, this Sheet.

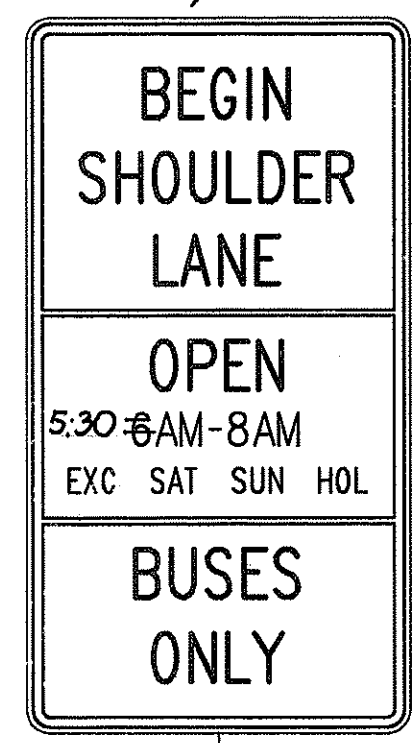

Install Sign R-3 at Sta. 247+07± (H-1 E.B.)  
Mount on Existing Light Std. at 45° angle.  
See Detail on Sheet V6.

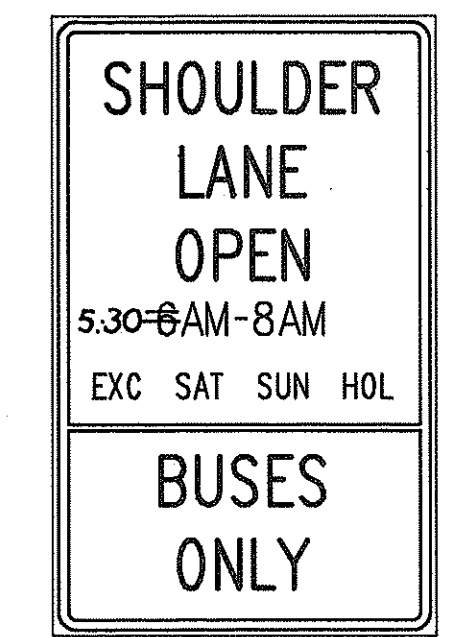

Install Sign R-5 at Sta. 261+45± (H-1 E.B.)  
Mount on Existing Light Std. at 45° angle.  
See Detail on Sheet V6.

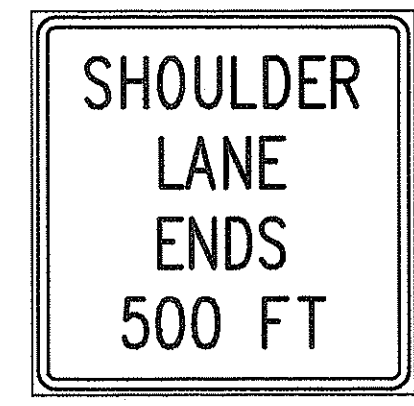

Install Sign R-4 at Sta. 265+75± (H-1 E.B.)  
Mount on Existing Light Std. at 45° angle.  
See Detail on Sheet V6.

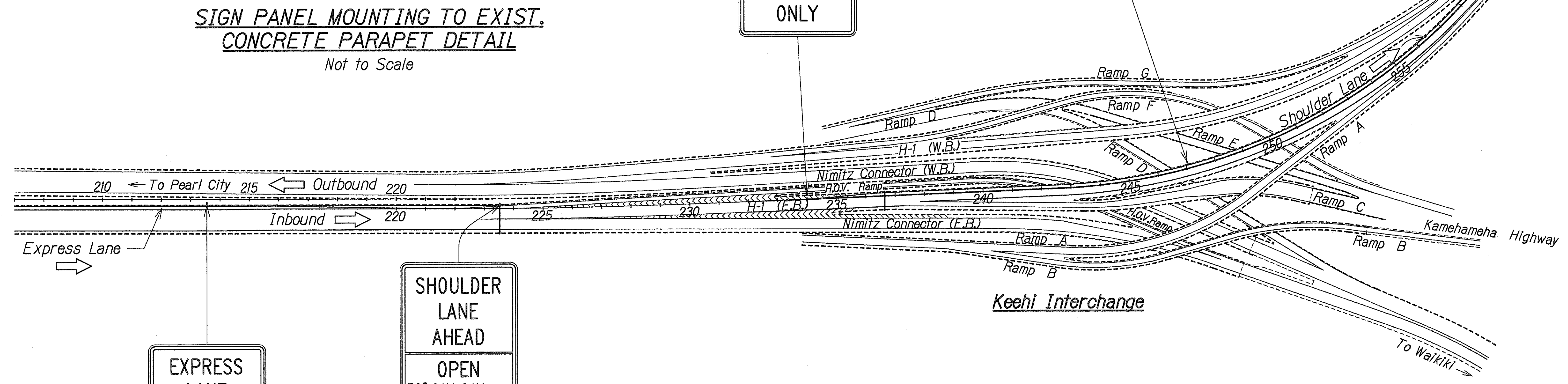
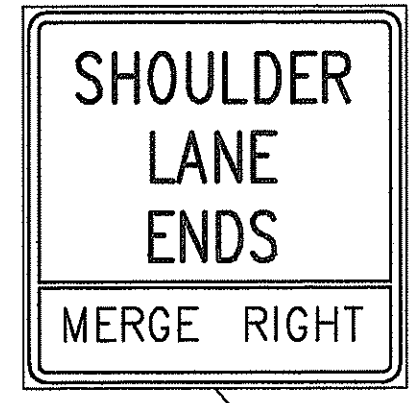

Install Sign R-10 at Sta. 213+55± (H-1 E.B.)  
Mount on Existing Light Std. at 45° angle  
See Detail on Sheet V6.

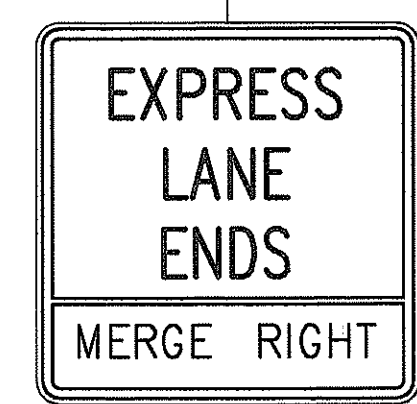

Install Sign R-1 at Sta. 223+52± (H-1 E.B.)  
Mount on Exist. Sign Bridge Post.  
For Mounting Details, See Std. Plan TE-01.

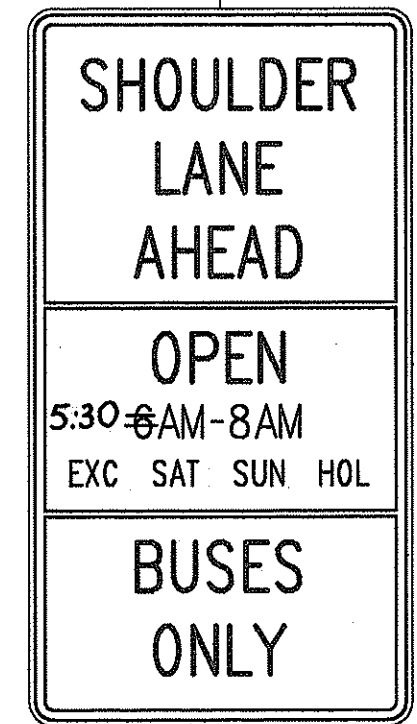

**Note:**  
For Sign on Existing Light Standard, See Standard Plan TE-01 and Detail on Sheet V6.

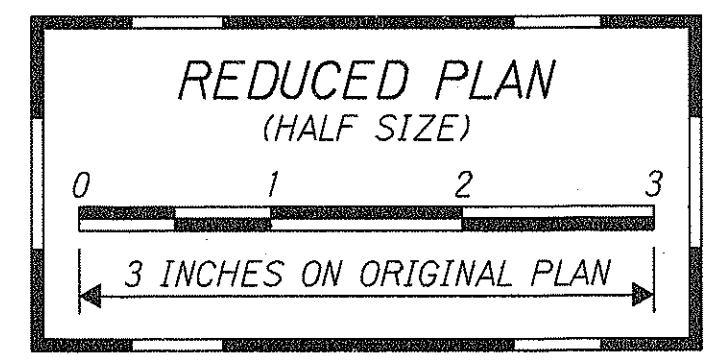

6/18/98	Revised Sign Mounting for R-1 and R-2 Signs.
DATE	REVISION

STATE OF HAWAII  
DEPARTMENT OF TRANSPORTATION  
HIGHWAYS DIVISION

**SIGNING PLAN**  
**KEEHI INTERCHANGE**

INTERSTATE ROUTE H-1  
CONTRAFLOW AND SHOULDER LANE  
PROJECT NO. HIEFG-01-96

Scale: 1" = 200' Date: October, 1997

SHEET No. **V8** OF **8** SHEETS

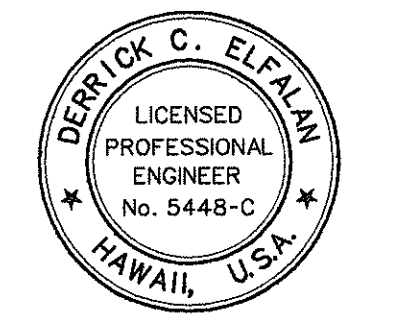

THIS WORK WAS PREPARED BY ME OR UNDER MY SUPERVISION  
*Derrick C. Elfalan*  
Derrick C. Elfalan  
dca PARK ENGINEERING

SURVEY PLOTTED BY	DATE
DRAWN BY	
CHECKED BY	
QUANTITIES BY	
REVISIONS BY	
ORIGINAL PLAN	
NOTE BOOK	
CHECKED BY	

**"AS-BUILT"**

**C.O. 162**