

FED. ROAD DIST. NO.	STATE	PROJ. NO.	FISCAL YEAR	SHEET NO.	TOTAL SHEETS
HAWAII	HAW.	HIH-01-97M	1997	16	26

LEGEND

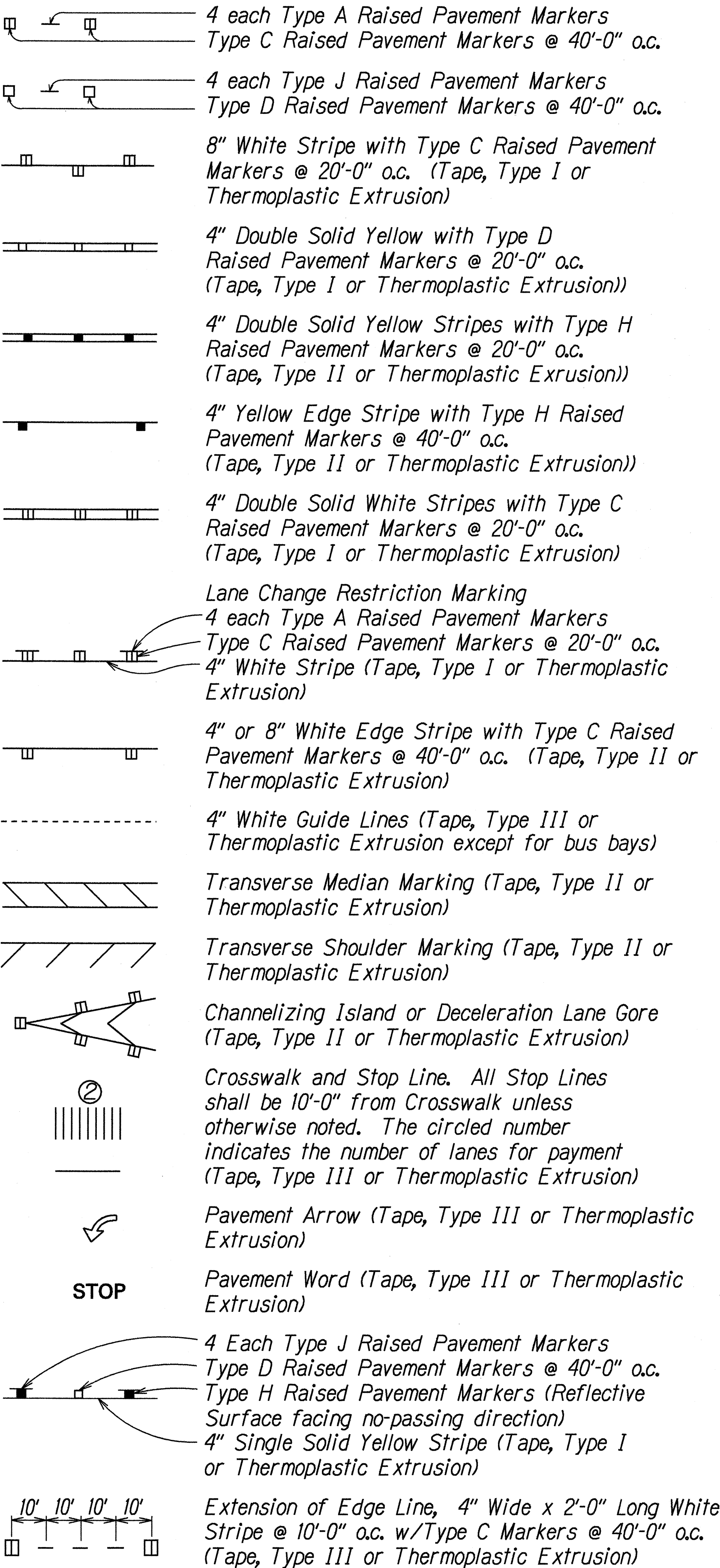

NOTES

- Layout of pavement markings and striping shall be done by the Contractor and approved by the Engineer prior to any installation work.
- Existing pavement markings not incorporated in the final traffic pattern shall be removed as directed by the Engineer. Costs shall be incidental to the various pavement marking items.
- Raised pavement markers shall not be installed within crosswalks.
- Final locations of all signs shall be approved by the Engineer prior to any installation work.
- Existing signs not shown on these plans shall remain as posted unless otherwise directed by the Engineer. Removal and disposal of existing signs and/or posts as designated on these plans shall be incidental to the various signing items.
- Final locations of all Stop Lines shall be approved by the Engineer prior to installation.
- All pavement striping shall be as noted on the legend or plans.
- All preformed pavement marking tapes over existing pavement shall be applied with an approved primer as recommended by the tape manufacturer and as approved by the Engineer. The primer shall be allowed to dry to the tacky stage prior to tape application.
- Backing for all new Regulatory and Warning Signs shall not be spliced.
- All sign panels shall conform to Section 62I of Special Provisions and the latest editions and amendments of the following FHWA publications:
 - "Manual on Uniform Traffic Control Devices for Streets and Highways" (MUTCD)
 - "Standard Highway Signs"
 - "Standard Alphabets for Highway Signs"
- Border, messages, arrows, symbols and shields shall conform to details as shown on the plans and as specified in the MUTCD.
- Sign messages shall be as indicated on the plan.
- All new and relocated signs and markers installed on pipe posts, light standard or expressway sign post are to be mounted with band brackets and steel braces.
- Final location of all sign post installed within the sidewalk areas shall maintain a minimum clearance width of 36 inches from sidewalk edge to provide for wheelchair accessibility.
- Signs placed along bikeways shall have a minimum height clearance of 10'-0".
- All existing sign post(s) to remain within the sidewalk area shall meet the minimum clear width of 36 inches from the sidewalk edge. Where necessary, the existing sign post(s) shall be relocated to meet the minimum clear width. This work shall not be paid for separately but shall be considered incidental to the various signing items.
- Removal of existing Delineators and Posts as directed by the Engineer shall be considered incidental to the various signing items.

REFLECTOR MARKER LEGEND

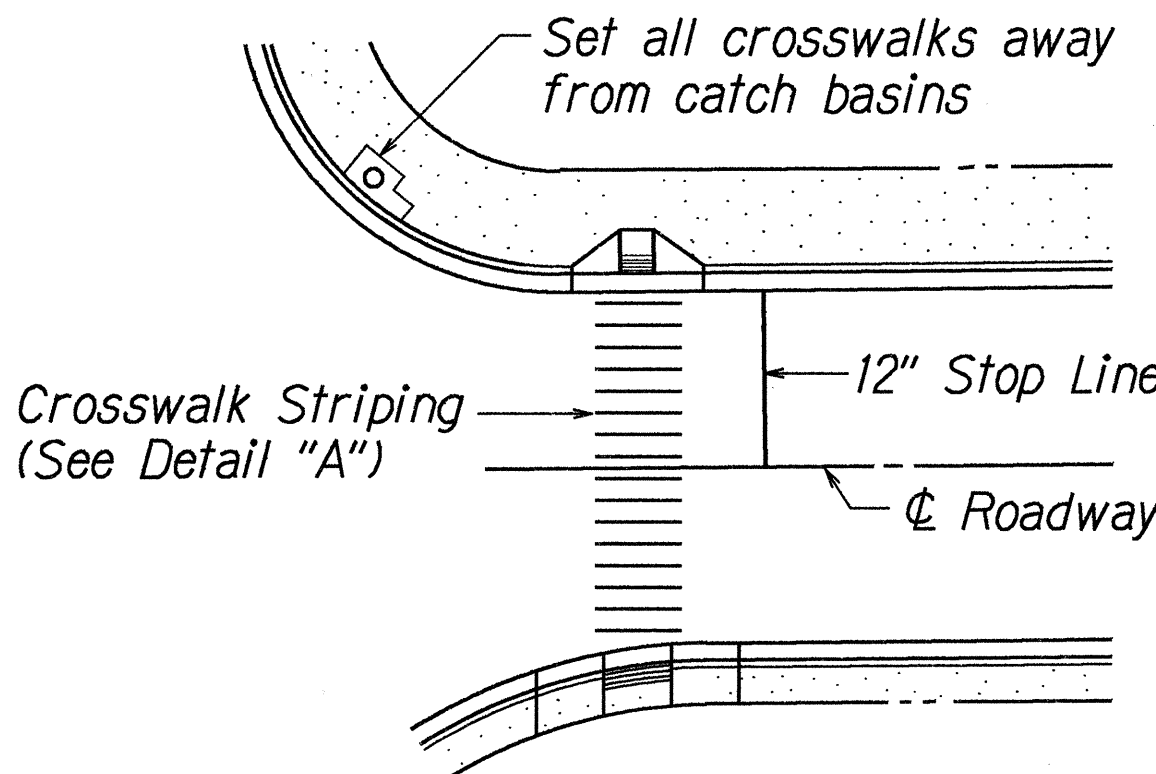
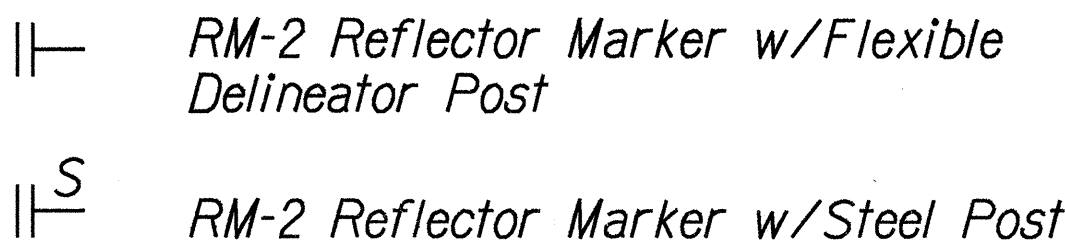

PLAN

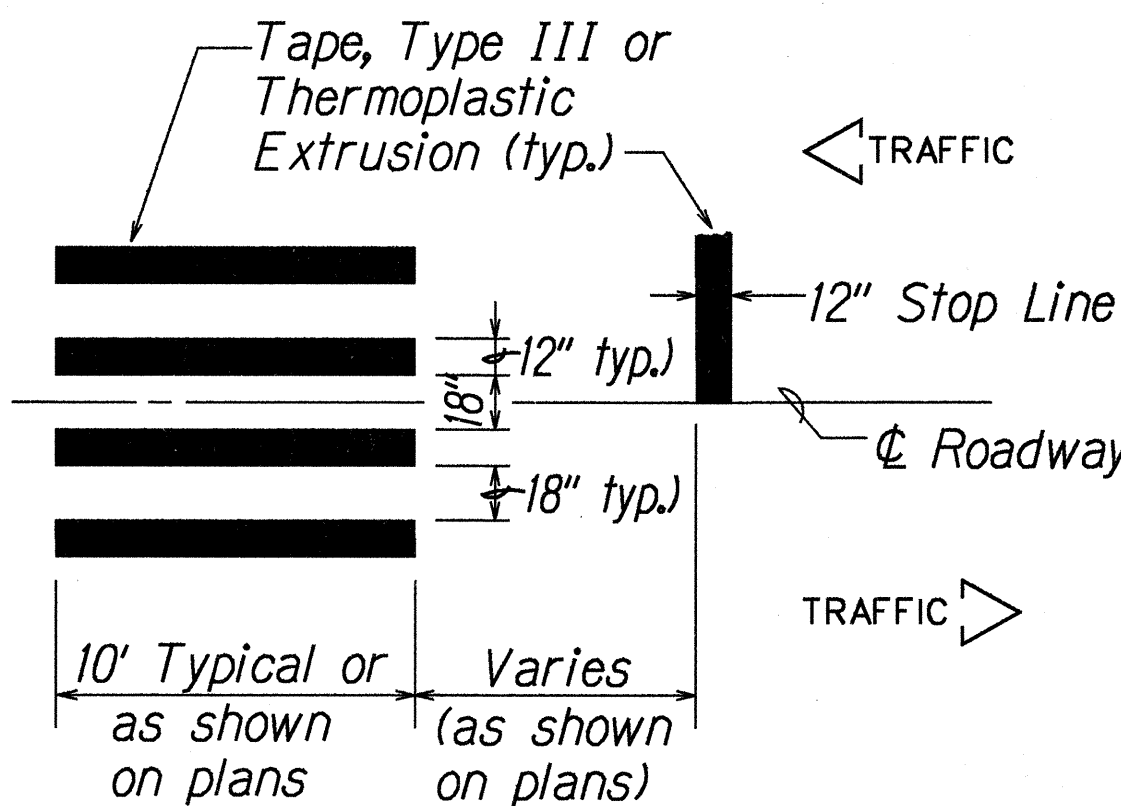

DETAIL "A"

CROSSWALK STRIPING DETAIL

Not to Scale

STATE OF HAWAII
DEPARTMENT OF TRANSPORTATION
HIGHWAYS DIVISION
**PAVEMENT MARKING
LEGEND, DETAILS & NOTES**
INTERSTATE ROUTE H-1
and MIDDLE STREET RESURFACING
North King St. to Kamehameha Hwy.
PROJECT NO. HIH-01-97M
Scale: As Noted Date: April, 1997
SHEET No. 11 OF 7 SHEETS

FED. ROAD DIST. NO.	STATE	PROJ. NO.	FISCAL YEAR	SHEET NO.	TOTAL SHEETS
HAWAII	HAW.	HIH-01-97M	1997	17	26

LEGEND FOR AS-BUILT POSTINGS

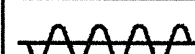
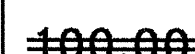
	Squiggly line for as-built deletion
	Double line for as-built deletion
Roadway	Text for as-built posting

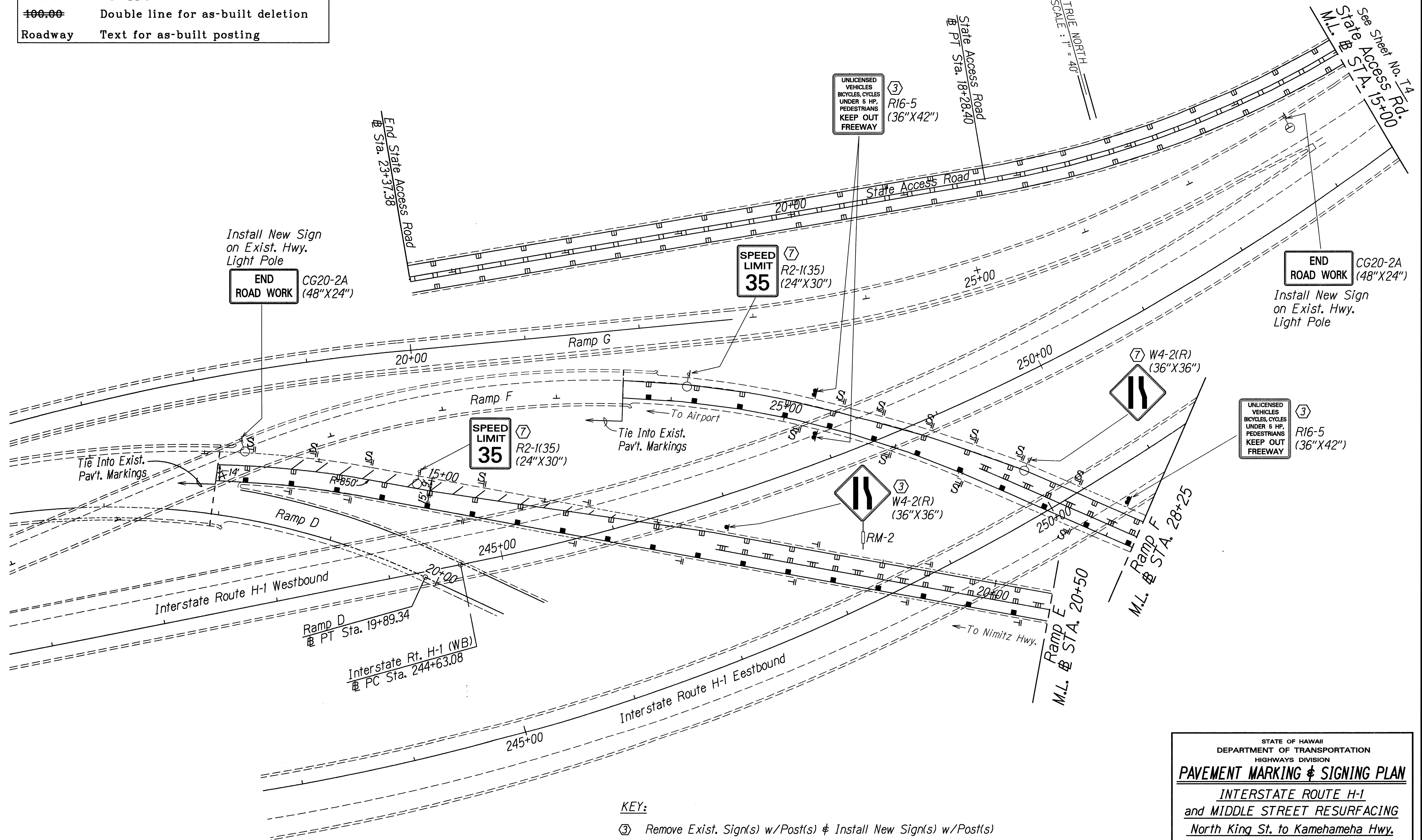

KEY:

- ③ Remove Exist. Sign(s) w/Post(s) & Install New Sign(s) w/Post(s)
- ⑦ Remove Exist. Sign(s) & Install New on Exist. Hwy. Lt. Pole

STATE OF HAWAII
DEPARTMENT OF TRANSPORTATION
HIGHWAYS DIVISION

PAVEMENT MARKING & SIGNING PLAN
INTERSTATE ROUTE H-1
and MIDDLE STREET RESURFACING
North King St. to Kamehameha Hwy.
PROJECT NO. HIH-01-97M
Scale: 1" = 40'
Date: May, 1997

SHEET No. T2 OF 7 SHEETS

DESIGNED BY	DATE
DRAWN BY	5/16/97
CHECKED BY	
IN CHARGE	
NOTED BY	
QUANTITIES BY	
REVISIONS	

FED. ROAD DIST. NO.	STATE	PROJ. NO.	FISCAL YEAR	SHEET NO.	TOTAL SHEETS
HAWAII	HAW.	HIH-01-97M	1997	19	26

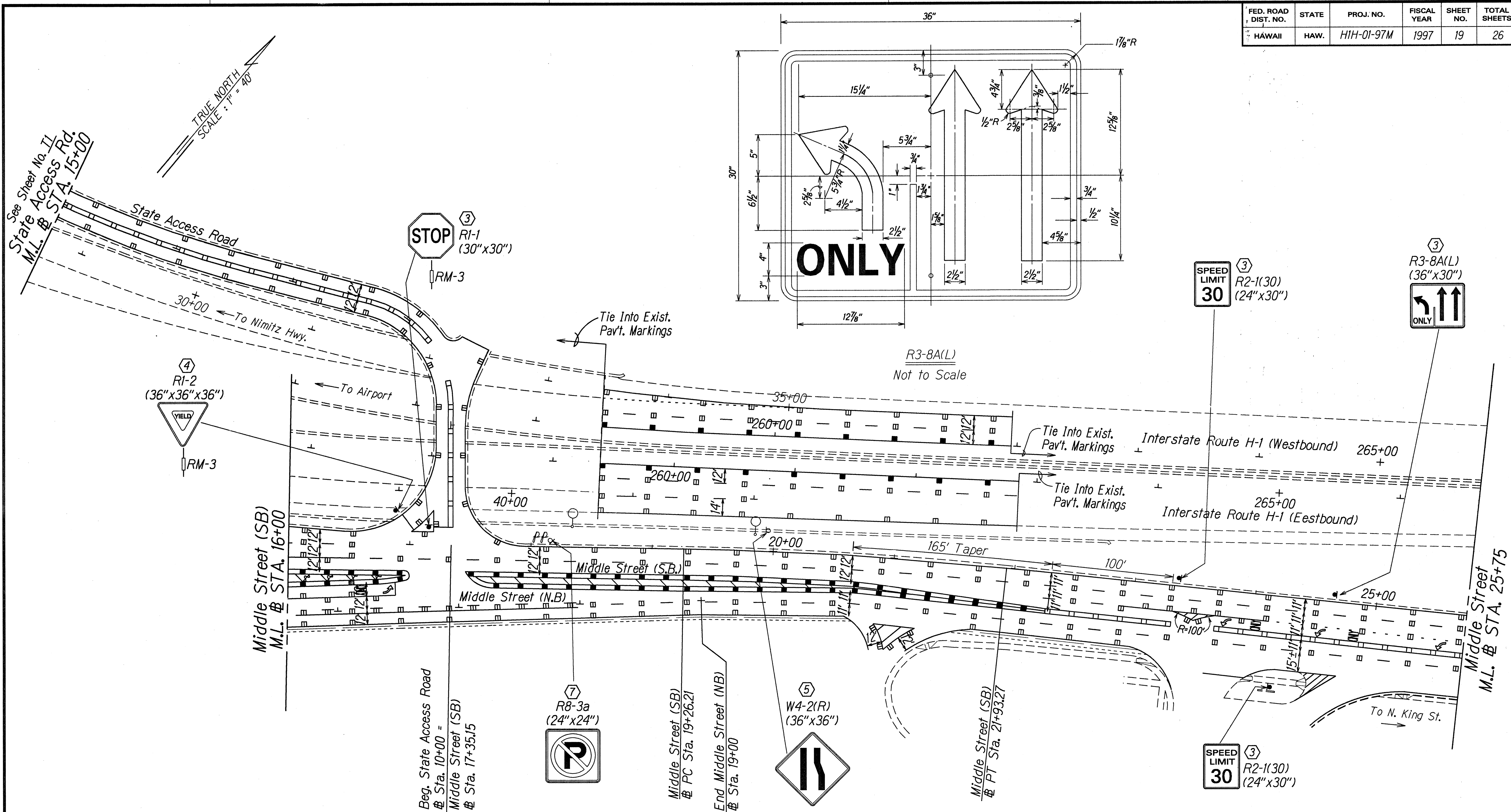

KEY:

- ③ Remove Exist. Sign(s) w/Post(s) & Install New Sign(s) w/Post(s)
- ④ Install New Sign w/Post(s)
- ⑤ Remove Exist. Sign(s) & Install New on Exist. Post(s)
- ⑦ Remove Exist. Sign & Install New on Hwy. Light Pole

LEGEND FOR AS-BUILT POSTINGS	
	Squiggly line for as-built deletion
	Double line for as-built deletion
Roadway	Text for as-built posting

STATE OF HAWAII
DEPARTMENT OF TRANSPORTATION
HIGHWAYS DIVISION

PAVEMENT MARKING & SIGNING PLAN

INTERSTATE ROUTE H-1
and MIDDLE STREET RESURFACING
North King St. to Kamehameha Hwy.
PROJECT NO. HIH-01-97M
Scale: 1" = 40' Date: May, 1997

SHEET No. T4 OF 7 SHEETS

ORIGINAL PLAN	DATE: 5/6/97
SURVEY PLANNED BY	
DRAWN BY	
DESIGNED BY	
CHECKED BY	
NOTED BY	
QUANTITIES BY	
CHECKED BY	

FED. ROAD DIST. NO.	STATE	PROJ. NO.	FISCAL YEAR	SHEET NO.	TOTAL SHEETS
HAWAII	HAW.	HIH-01-97M	1997	20	26

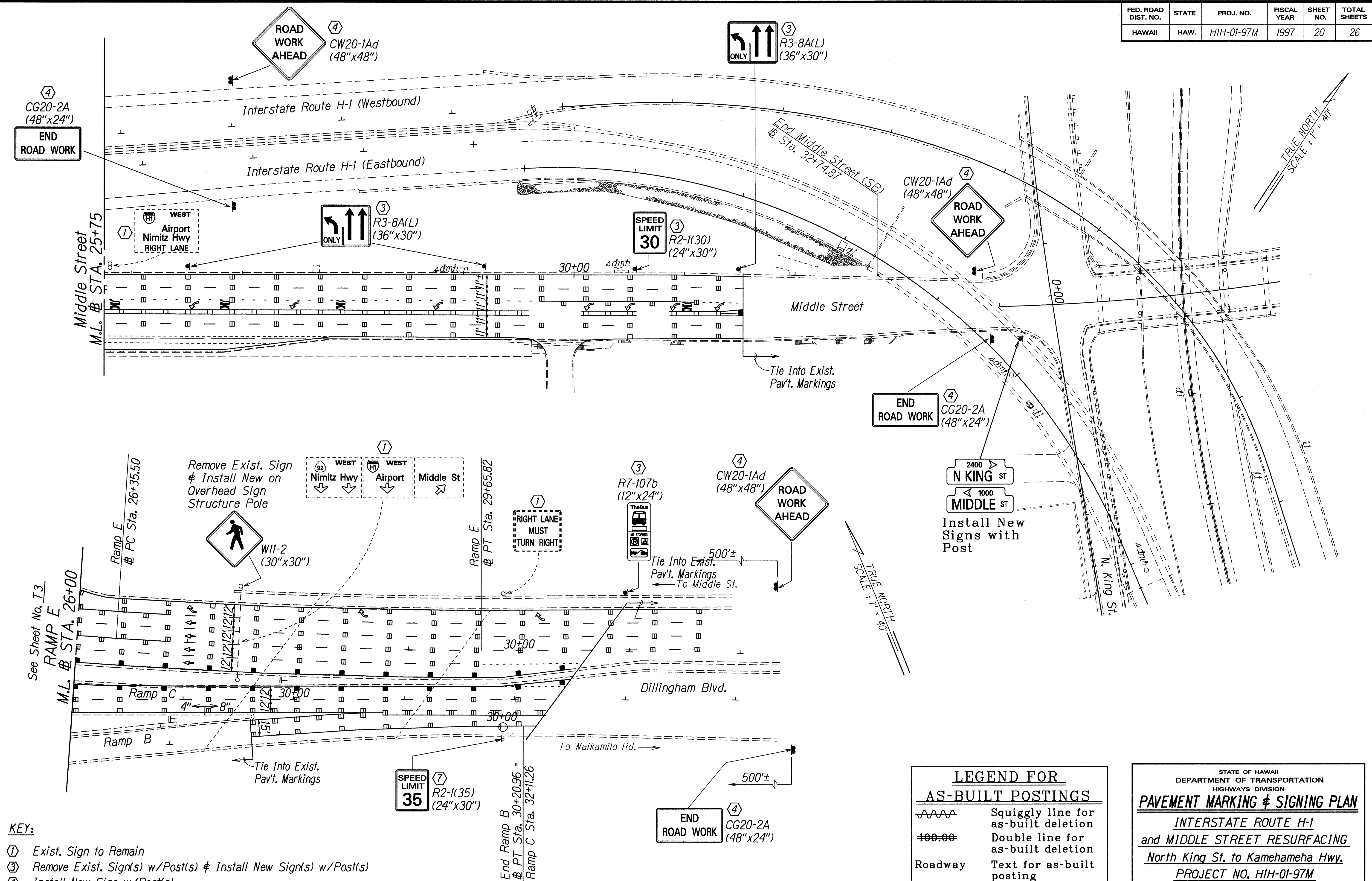

KEY:

- ① Exist. Sign to Remain
- ③ Remove Exist. Sign(s) w/Post(s) & Install New Sign(s) w/Post(s)
- ④ Install New Sign w/Post(s)
- ⑦ Remove Exist. Sign & Install New on Hwy. Light Pole

LEGEND FOR AS-BUILT POSTINGS	
	Squiggly line for as-built deletion
	Double line for as-built deletion
Roadway	Text for as-built posting

STATE OF HAWAII DEPARTMENT OF TRANSPORTATION HIGHWAYS DIVISION	
PAVEMENT MARKING & SIGNING PLAN	
INTERSTATE ROUTE H-1 and MIDDLE STREET RESURFACING	
North King St. to Kamehameha Hwy.	
PROJECT NO. HIH-01-97M	
Scale: 1" = 40'	Date: May, 1997
SHEET No. T5 OF 7 SHEETS	

ORIGINAL PLAN	DATE: 5/16/97
SURVEY PLOTTED BY: [Name]	DESIGNED BY: [Name]
NOTE BOOK	QUANTITIES BY: [Name]
TRACED BY: [Name]	CHECKED BY: [Name]
DATE: 5/16/97	

FED. ROAD DIST. NO.	STATE	PROJ. NO.	FISCAL YEAR	SHEET NO.	TOTAL SHEETS
HAWAII	HAW.	HIH-01-97M	1997	21	26

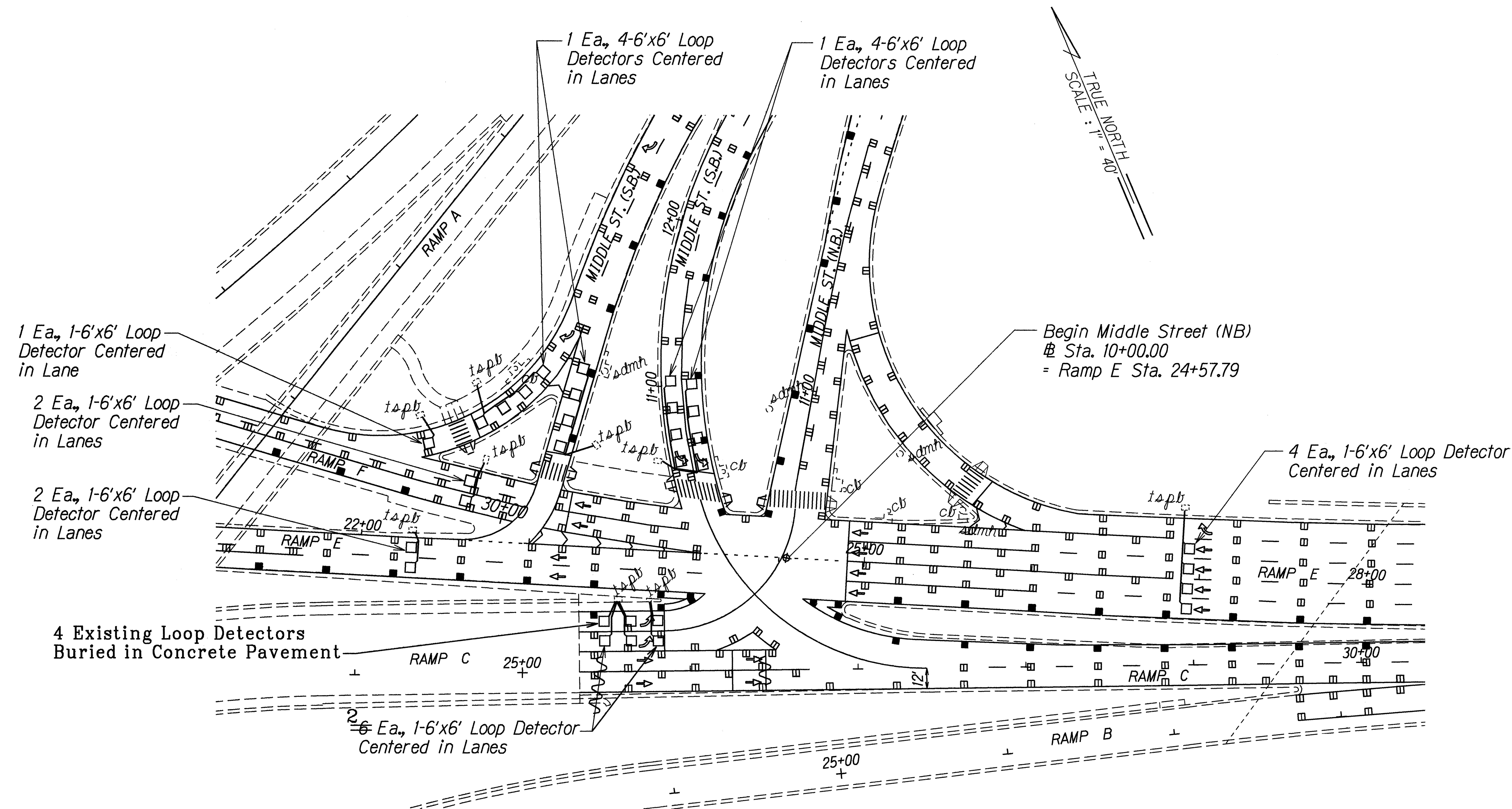

ORIGINAL PLAN	SURVEY LOCATED BY	DATE
NOTES BOOK	DRAWN BY	5/17/97
QUANTITIES BY	DESIGNED BY	
	CHECKED BY	

LEGEND FOR AS-BUILT POSTINGS

	Squiggly line for as-built deletion
	Double line for as-built deletion
Roadway	Text for as-built posting

STATE OF HAWAII
DEPARTMENT OF TRANSPORTATION
HIGHWAYS DIVISION

LOOP DETECTOR PLAN

INTERSTATE ROUTE H-1
and MIDDLE STREET RESURFACING
North King St. to Kamehameha Hwy.
PROJECT NO. HIH-01-97M













Scale: 1" = 40'

Date: May, 1997

SHEET No. T6 OF 7 SHEETS

AS-BUILT 21

PAVEMENT MARKING SUMMARY	
DESCRIPTION	QUANTITY
PAVEMENT MARKERS	
TYPE A _____	860 EA.
TYPE C _____	700 EA.
TYPE D _____	110 EA.
TYPE H _____	190 EA.
TAPE - TYPE I OR THERMOPLASTIC EXTRUSION	
4-INCH PAVEMENT STRIPE (WHITE) _____	1,500 L.F.
8-INCH PAVEMENT STRIPE (WHITE) _____	2,400 L.F.
DOUBLE 4-INCH PAVEMENT STRIPE (YELLOW) _____	2,000 L.F.
TAPE - TYPE II OR THERMOPLASTIC EXTRUSION	
4-INCH PAVEMENT STRIPE (WHITE) _____	10,200 L.F.
4-INCH PAVEMENT STRIPE (YELLOW) _____	4,700 L.F.
8-INCH PAVEMENT STRIPE (WHITE) _____	2,200 L.F.
12-INCH PAVEMENT STRIPE (WHITE) _____	300 L.F.
12-INCH PAVEMENT STRIPE (YELLOW) _____	220 L.F.
DOUBLE 4-INCH PAVEMENT STRIPE (YELLOW) _____	1,500 L.F.
TAPE - TYPE III OR THERMOPLASTIC EXTRUSION	
4-INCH PAVEMENT STRIPE (WHITE) _____	430 L.F.
4-INCH PAVEMENT STRIPE (YELLOW) _____	160 L.F.
12-INCH PAVEMENT STRIPE (WHITE) _____	320 L.F.
CROSSWALK MARKINGS _____	7 LANES
PAVEMENT ARROW _____	38 EA.
PAVEMENT WORD _____	7 EA.

TRAFFIC SIGN SUMMARY					
SIGN NO.	MESSAGE	QUANTITY			
		10 SQ. FT. OR LESS		GREATER THAN 10 SQ. FT.	
		W/POST	W/O POST	W/POSTS	W/O POSTS
R-1	STOP	1			
R1-2	YIELD	2			
R2-1(30)	SPEED LIMIT 30	4			
R2-1(35)	SPEED LIMIT 35		3		
R3-3	NO TURNS	1	2		
R3-4b		2			
R3-8A(L)	 ONLY	4			
R3-55(L)	 ONLY	1			
R5-1a	WRONG WAY	2			
R6-1(R)	ONE WAY		1		
R6-1(L)	ONE WAY		1		
R7-107b	 	1			
R8-3a			1		
R16-5	UNLICENSED VEHICLES BICYCLES, CYCLES UNDER 5HP, PEDESTRIANS KEEP OUT FREEWAY			3	
R17-4	 NO U TURN	2			
W3-3			2		
W4-1(R)		2			
W4-2(R)		1	2		
W9-2(L)	LANES ENDS MERGE LEFT	1			
W11-2			1		
W12-1		2			
D11-1	 BIKE ROUTE	2	2		
M4-11	BEGIN		2		
M4-12	END		2		
TOTAL		28	19	3	

CONSTRUCTION SIGN SUMMARY				
SIGN NO.	LOCATION	MESSAGE	W/POSTS	W/O POST
CG20-2A	Ramp F Sta. 20+25± Lt.	END ROAD WORK		1
CG20-2A	Ramp G Sta. 28+00± Lt.	END ROAD WORK		1
CW20-1Ad	Ramp C Sta. 22+70± Rt.	ROAD WORK AHEAD		1
CW20-1Ad	Middle St. & Sta. 33+60± Lt.	ROAD WORK AHEAD	1	
CG20-2A	Middle St. & Sta. 33+60± Rt.	END ROAD WORK	1	
CW20-1Ad	H-1 Westbound & Sta. 267+00± Lt.	ROAD WORK AHEAD	1	
CG20-2A	H-1 Eastbound & Sta. 267+80± Rt.	END ROAD WORK	1	
CW20-1Ad	Dillingham Blvd. Westbound & Sta. 36+00± Lt.	ROAD WORK AHEAD	1	
CG20-2A	Dillingham Blvd. Eastbound & Sta. 35+50± Rt.	END ROAD WORK	1	
TOTAL			6	3

REFLECTOR MARKER SUMMARY						
TYPE	QUANTITY					
	W/O POST		W/FLEXIBLE POST		W/STEEL POST	
	YELLOW	WHITE	YELLOW	WHITE	YELLOW	WHITE
RM-2	3		32	2	5	
RM-3	6					
RM-9					1	

ORIGINAL PLAN	SURVEY PLOTTED BY _____	DATE <u>5/21/97</u>
	DRAWN BY <u>R. Hill</u>	
	TRACED BY _____	
NOTE BOOK	DESIGNED BY <u>G. Kahni</u>	
<u>101.R/B</u>	QUANTITIES BY _____	
<u>lititsum</u>	CHECKED BY _____	
N _o _____		