

FED. ROAD DIST. NO.	STATE	FED. AID PROJ. NO.	FISCAL YEAR	SHEET NO.	TOTAL SHEETS
HAWAII	HAW.	HIC-01-90	1991	54	109

ROAD CONSTRUCTION
BEG. NOV. 15*, 1991 TO JULY 1992
M - F 8:30 AM - 3:30 PM
M - F 8:00 AM - 3:00 PM

* See Sign Notes 3.

DETAIL - ADVISORY SIGN

SHOULDER LANE ENDS
NEAR MANAGER'S DR.
EFFECTIVE : 5 AM, NOV. 15, 1991

Advisory Sign Note
 Sign to be used for both Outbound & Inbound phases of construction:
 1. Line reading: "M-F 8:30 AM - 3:30 PM" to be covered when sign is used for Inbound (to Honolulu) construction.
 2. Line reading: "M-F 8:00 AM - 3:00 PM" to be covered when sign relocated & used for Outbound (to Waianae) construction.

SIGN NOTES

1. Minimum size: 4'x8'
2. Letters shall be Series D, 8" high
3. Correct date of "Begin Construction" & "Shoulder Lane Closure" shall be included in the sign message as determined by the Contractor based on DOT approval.

- Notes:**
1. After construction and prior to opening of Ramp "C", remove 4' wide temp. white solid edge line & 4' wide white lane lines @ 40' o.c. and install 4' wide white solid edge stripe with Type CL markers.
 2. Remove "Shoulder Lane Ends, Merge Left" sign & relocate per sht. C-51.
 3. Flashing arrow signal as shown shall be required for the first two weeks of construction (min).
 4. Type II barricades w/ steady burn lamps & flashing arrow signal shall be placed well in advance of shoulder lane closure (5 am to 8 am) to provide early morning motorists w/ sufficient warning of shoulder lane closure.

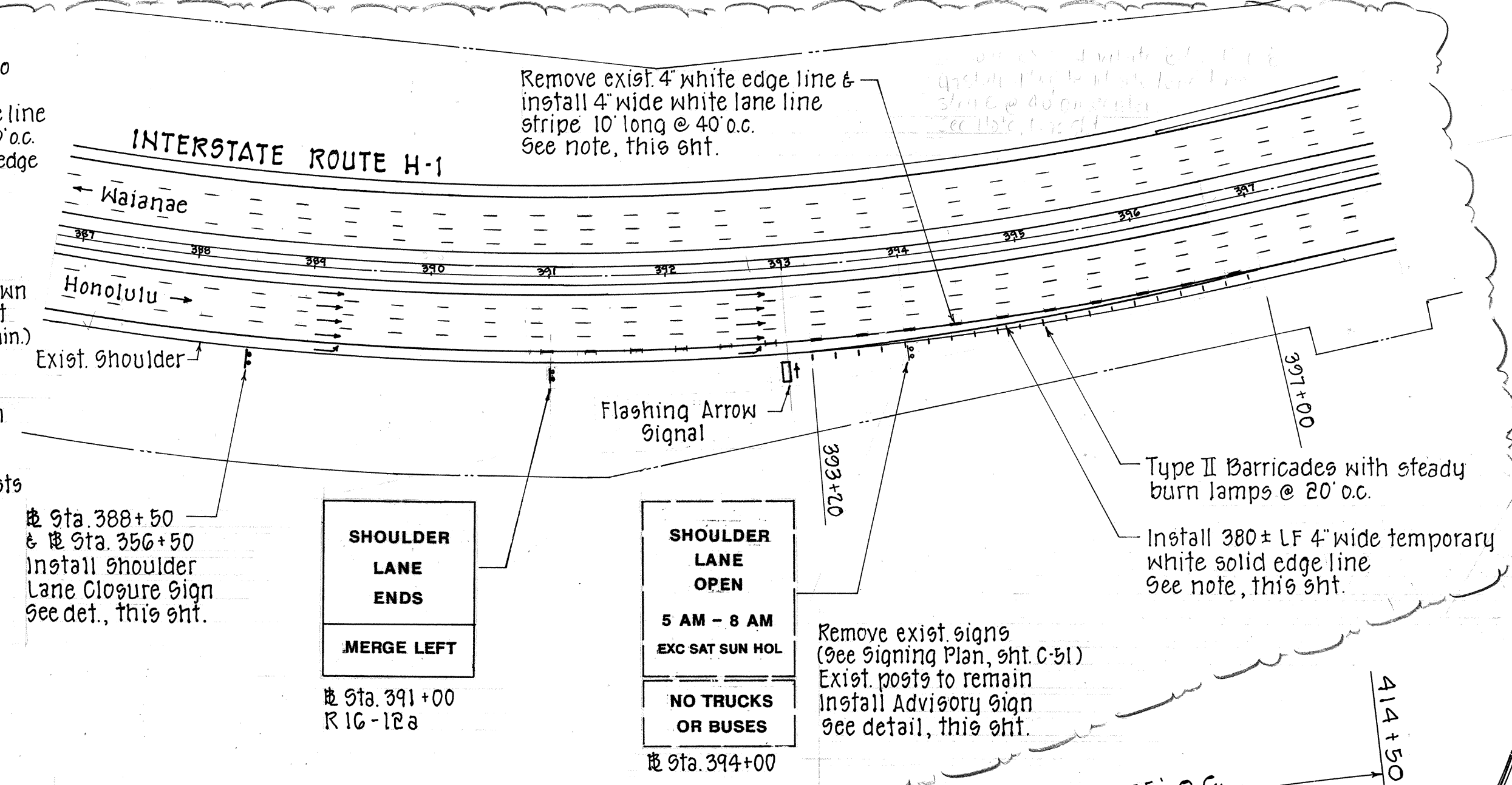

DETAIL - SHOULDER LANE CLOSURE SIGN

INSET - SHOULDER LANE MERGE DURING CONSTRUCTION
 Scale: 1" = 100'

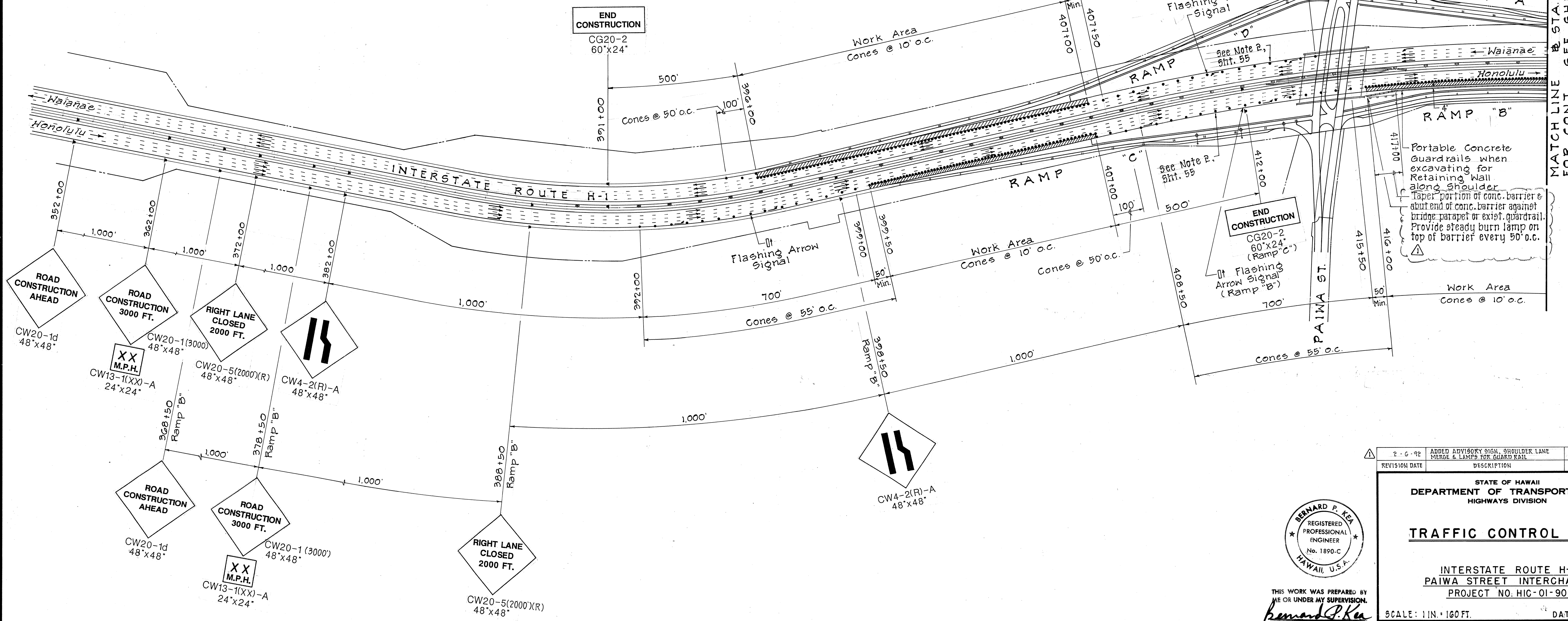

SURVEY PLOTTED BY	DATE
DESIGNED BY	
NOTED BY	
CHECKED BY	
ORIGINAL FILED	
NOTE BOOK	
QUANTITIES BY	
CHECKED BY	
No.	

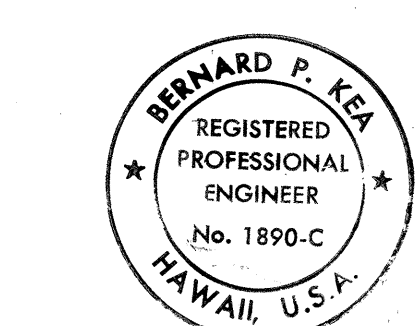

THIS WORK WAS PREPARED BY
 ME OR UNDER MY SUPERVISION.
Bernard P. Kea
 Signature

2-G-92	ADDED ADVISORY SIGN, SHOULDER LANE MERGE & LAMPS FOR GUARD RAIL	CP1	
REVISION DATE	DESCRIPTION	MADE BY	APPROVED

STATE OF HAWAII
 DEPARTMENT OF TRANSPORTATION
 HIGHWAYS DIVISION

TRAFFIC CONTROL PLAN

INTERSTATE ROUTE H-1
 PAIWA STREET INTERCHANGE
 PROJECT NO. HIC-01-90

SCALE: 1/4" = 100 FT. DATE: AUG., 1991

SHEET No. 1 OF 2 SHEETS

FED. ROAD DIST. NO.	STATE	FED. AID PROJ. NO.	FISCAL YEAR	SHEET NO.	TOTAL SHEETS
HAWAII	HAW.	HIC-01-90	1991	55	109

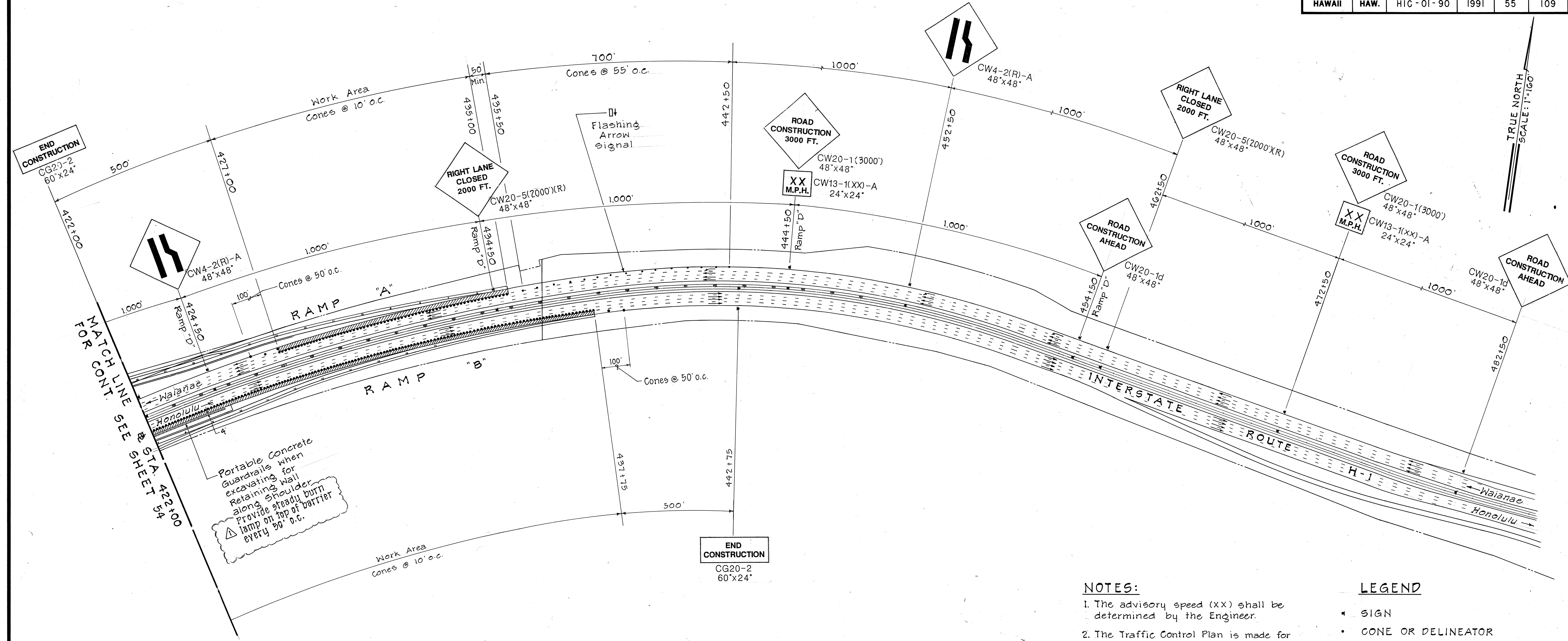

NOTES:

- The advisory speed (XX) shall be determined by the Engineer.
- The Traffic Control Plan is made for each ramp. Should the ramps in one direction (i.e. Ramps "A" & "D") be worked on at the same time, use one taper for ramp and extend the work area cones from the end of Ramp "A" work area to beginning of Ramp "D" work area.

LEGEND

- SIGN
- CONE OR DELINEATOR
- DIRECTION OF TRAFFIC
- FLASHING ARROW SIGNAL

SURVEY PLOTTED BY	DATE
DESIGNED BY	
TRACED BY	
NOTE BOOK	
QUANTITIES BY	
CHECKED BY	
No.	

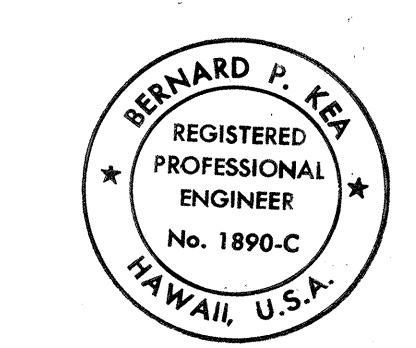

THIS WORK WAS PREPARED BY
ME OR UNDER MY SUPERVISION.
Bernard P. Kea
Signature

2-6-92	ADDED LAMPS FOR CONC. GUARD RAIL	CP1	
REVISION DATE	DESCRIPTION	MADE BY	APPROVED

STATE OF HAWAII
DEPARTMENT OF TRANSPORTATION
HIGHWAYS DIVISION

TRAFFIC CONTROL PLAN

INTERSTATE ROUTE H-1
PAIWA STREET INTERCHANGE
PROJECT NO. HIC-01-90

SCALE: 1/4" = 100 FT. DATE: AUG., 1991

SHEET NO. 2 OF 2 SHEETS