

FED. ROAD DIST. NO.	STATE	FED. AID PROJ. NO.	FISCAL YEAR	SHEET NO.	TOTAL SHEETS
HAWAII	HAW.	1-HI-1(146):16	1979	2	283

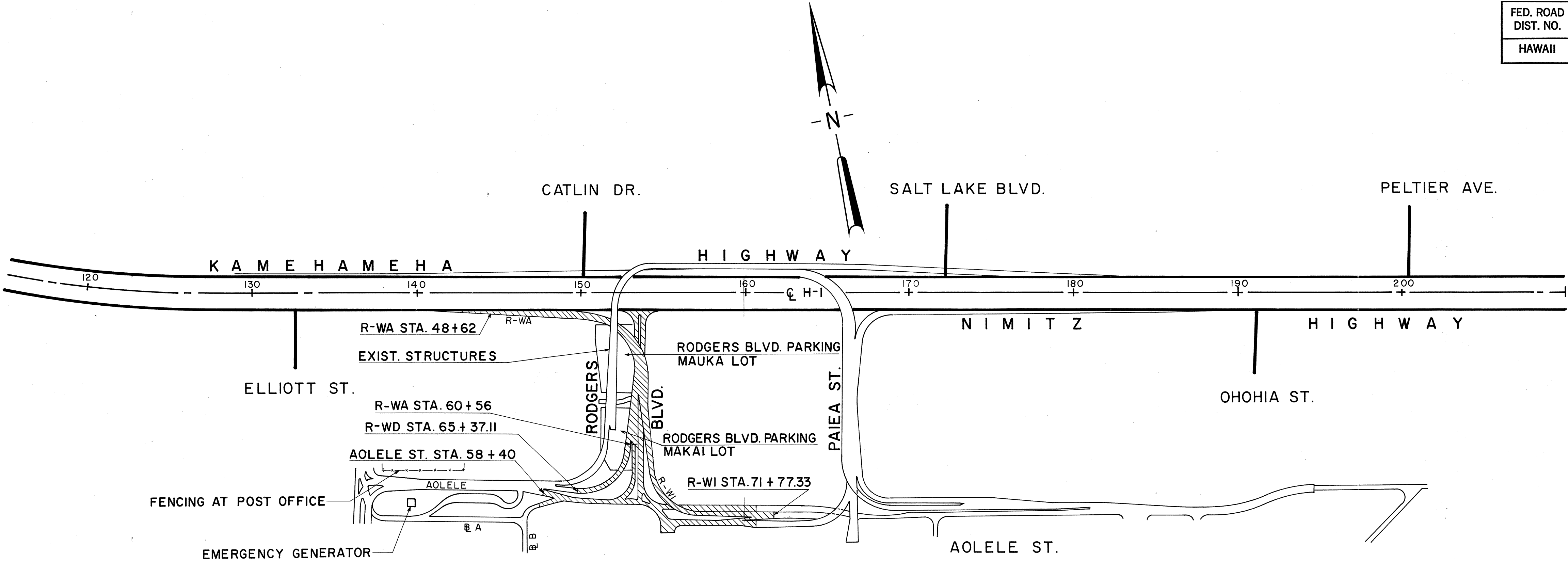

PHASE	WORK DESCRIPTION	WORKING DAYS																		
		40	80	120	160	200	240	280	320	360	400	440	480	520	560	600	640	680	720	760
I	RELOCATE UTILITIES - DEMOLISH STRUCTURES																			
	CONSTRUCT DETOUR I-A (BASELINE C)																			
	CONSTRUCT BOX CULVERTS																			
	CONSTRUCT RAMPS WA-WI TO STA. 57+58																			
	SIGNING, STRIPING, & TRANSPLANTING																			
	TRAFFIC ON DETOUR I-A																			
	CONSTRUCT DETOUR 2 (BASELINES A & B)																			
	CONSTRUCT DRAINAGE SYSTEM																			
	CONSTRUCT HIGHWAY LIGHTING SYSTEM																			
II	TRAFFIC ON DETOUR 2																			
	CONSTRUCT RAMPS WA-WD TO END																			
	CONSTRUCT RAMP WI TO STA. 62+47																			
	CONSTRUCT RAMP WI FOOTINGS TO STA. 65+15																			
	CONSTRUCT RODGERS BOULEVARD																			
	CONSTRUCT AOLELE STREET																			
III	TRAFFIC ON RODGERS BLVD. & AOLELE ST.																			
	CONSTRUCT RAMP WI TO END																			
	LANDSCAPING																			
	CONSTRUCT RAMP PF																			
	CONSTRUCT RODGERS BLVD. PARKING LOTS																			
	REMOVE SIGN BRIDGES																			



THIS WORK WAS PREPARED BY
ME OR UNDER MY SUPERVISION.
[Signature]
Signature

STATE OF HAWAII
DEPARTMENT OF TRANSPORTATION
LAND TRANSPORTATION FACILITIES DIVISION

RECOMMENDED
CONSTRUCTION PHASING

AIRPORT INTERCHANGE
F.A.I. PROJ. NO. 1-HI-1(146):16

SCALE: NONE DATE: JUNE 1, 1979
SHEET NO. 1 OF 1 SHEETS

DD-C-85	SURVEY PLOTTED BY	DATE
	ORIGINAL DRAWN BY	
	TRACED BY	
	DESIGNED BY	
	NOTE BOOK	
	QUANTITIES BY	
	CHECKED BY	
	No.	

FED. ROAD DIST. NO.	STATE	FED. AID PROJ. NO.	FISCAL YEAR	SHEET NO.	TOTAL SHEETS
HAWAII	HAW.	1-H-1(146)16	1979	2A	

- GRADING NOTES
- ALL GRADING WORK SHALL BE DONE IN ACCORDANCE WITH CHAPTER 23, GRADING, SOIL EROSION AND SEDIMENT CONTROL, OF THE REVISED ORDINANCES OF HONOLULU, 1969, AS AMENDED (ORDINANCE NOS. 3968, 4294 AND 4538). NO SOILS REPORT WAS MADE FOR THIS PROJECT.
 - THE CONTRACTOR SHALL REMOVE ALL SILT AND DEBRIS RESULTING FROM HIS WORK AND DEPOSITED IN DRAINAGE FACILITIES, ROADWAYS AND OTHER AREAS. THE COSTS INCURRED FOR ANY NECESSARY REMEDIAL ACTION BY THE CHIEF ENGINEER SHALL BE PAYABLE BY THE CONTRACTOR.
 - THE CONTRACTOR, AT HIS OWN EXPENSE, SHALL KEEP THE PROJECT AREA AND SURROUNDING AREA FREE FROM DUST NUISANCE. THE WORK SHALL BE IN CONFORMANCE WITH THE AIR POLLUTION CONTROL STANDARDS AND REGULATIONS OF THE STATE DEPARTMENT OF HEALTH.
 - THE CITY SHALL BE INFORMED OF THE LOCATION OF THE BORROW/DISPOSAL SITE FOR THE PROJECT WHEN THE APPLICATION FOR A GRADING PERMIT IS MADE. THE BORROW/DISPOSAL SITE MUST ALSO FULFILL THE REQUIREMENTS OF THE GRADING ORDINANCE.
 - NO GRADING WORK SHALL BE DONE ON SATURDAYS, SUNDAYS AND HOLIDAYS AT ANY TIME WITHOUT PRIOR NOTICE TO THE CHIEF ENGINEER.
 - THE LIMITS OF THE AREA TO BE GRADED SHALL BE FLAGGED BEFORE THE COMMENCEMENT OF THE GRADING WORK.
 - ALL GRADING OPERATIONS SHALL BE PERFORMED IN CONFORMANCE WITH THE APPLICABLE PROVISIONS OF THE WATER POLLUTION CONTROL AND WATER QUALITY STANDARDS CONTAINED IN THE PUBLIC HEALTH REGULATIONS, STATE DEPARTMENT OF HEALTH, ON WATER POLLUTION CONTROL AND WATER QUALITY STANDARDS.
 - TEMPORARY EROSION CONTROL PROCEDURES SHALL BE SUBMITTED FOR APPROVAL PRIOR TO APPLICATION FOR A GRADING PERMIT.
 - ALL SLOPES AND EXPOSED AREAS SHALL BE SODDED OR PLANTED IMMEDIATELY AFTER THE GRADING WORK HAS BEEN COMPLETED.

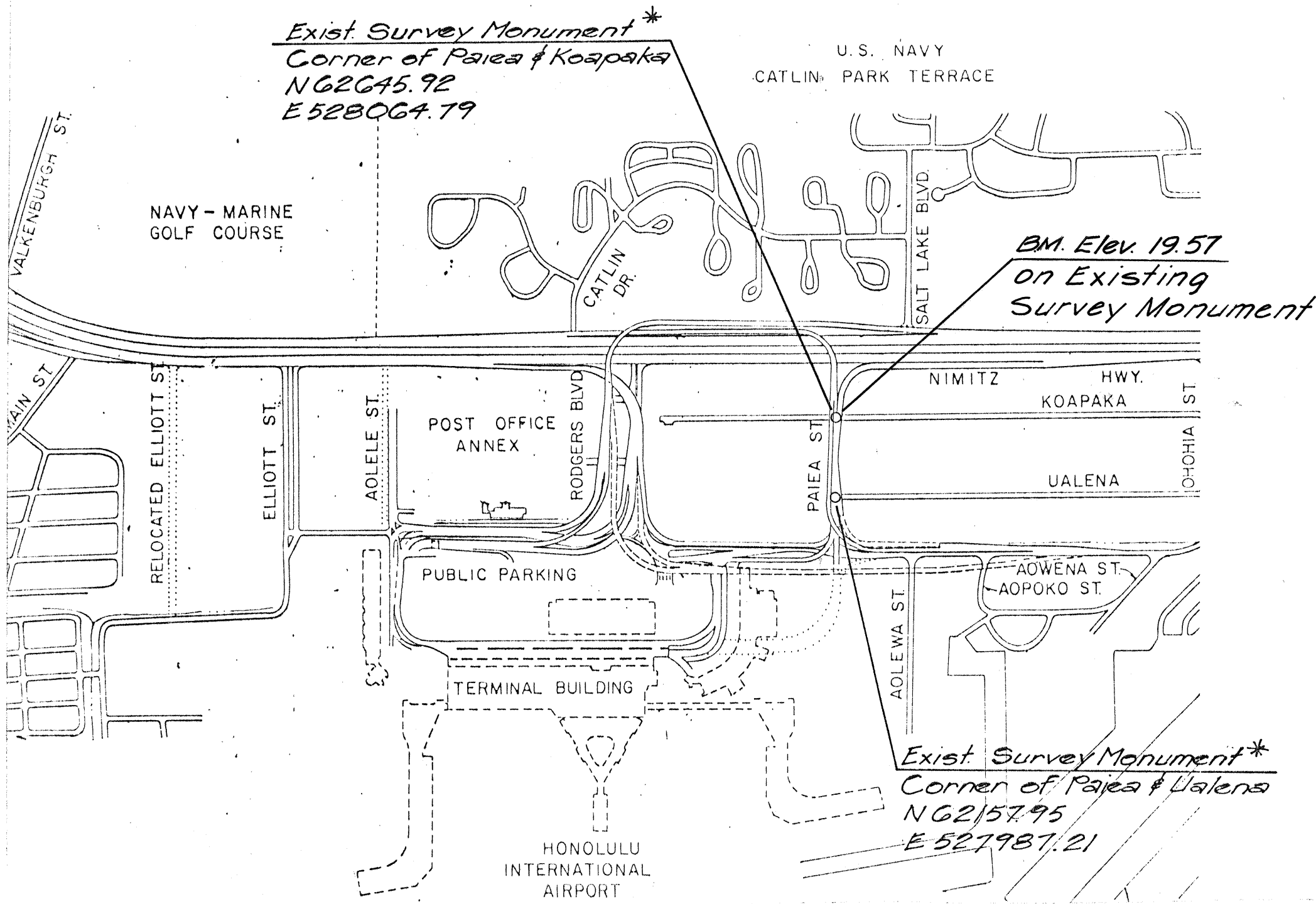

* Contractor to verify Monument Coordinates and Elevation with Engineer.

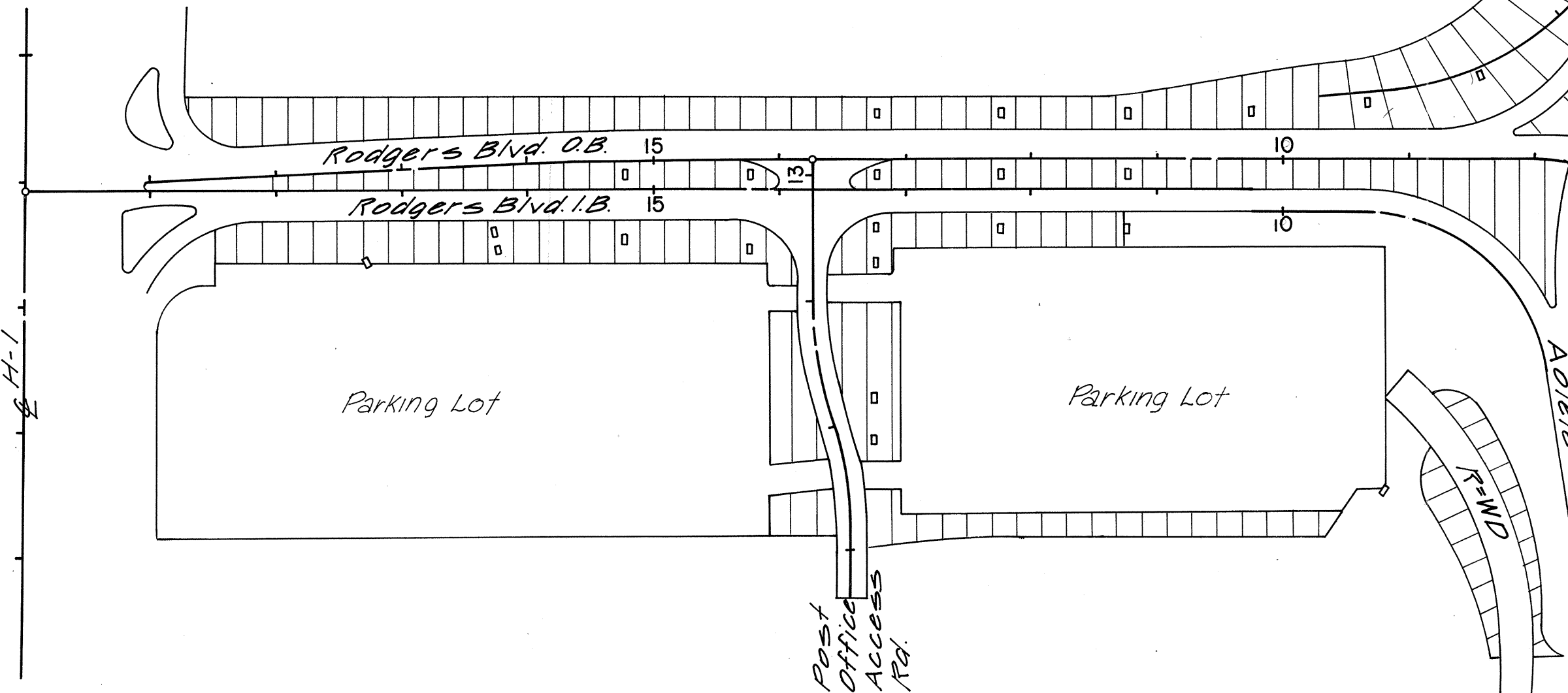

GRADING LIMITS

SCALE: 1" = 100'
TAX MAP KEY NO. 1-1-10-35
TOTAL GRADED AREA = 14.1 ACRES
TOTAL EXCAVATION = 17421 CU YD
TOTAL EMBANKMENT = 4500 CU YD

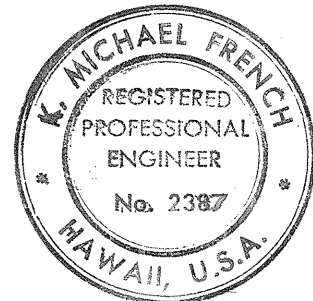

THIS WORK WAS PREPARED BY ME OR UNDER MY SUPERVISION.
Michael French
Signature

LEGEND:

Graded Area

APPROVED FOR GRADING ONLY:

Wallace Shigobawa 1/15/80
DIRECTOR & CHIEF ENGINEER, DPW DATE

William Z. H. Lee 1/15/80
CHIEF, DIVISION OF ENGINEERING, DPW DATE

STATE OF HAWAII
DEPARTMENT OF TRANSPORTATION
LAND TRANSPORTATION FACILITIES DIVISION

GRADING LIMITS AND NOTES

AIRPORT INTERCHANGE
F.A.I. PROJ. NO. 1-H-1(146)16

SCALE AS SHOWN DATE: AUG. 1, 1979
SHEET NO. 1 OF 1 SHEETS