

FED. ROAD DIST. NO.	STATE	FED-AID PROJ. NO.	FISCAL YEAR	SHEET NO.	TOTAL SHEETS
HAWAII	HAW.	NH-H1-1(279)	2021	121	304

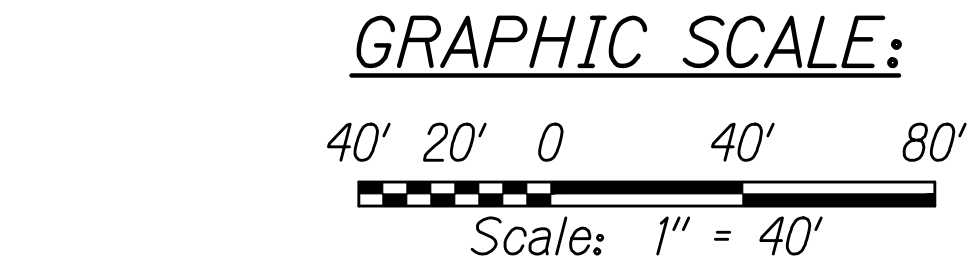

**NOTES:**

1. The source of pavement grades reflected on plans are from Control Point Surveying Inc. dated 08/02/18. The pavement (or finish) grades represent the existing grades and these grades are for informational purposes only. The Contractor shall verify in field.
2. Survey Control Data along with centerline and curve data are shown on Roadway Plans, sheets R1 - R23.
3. The Contractor shall survey and stake out the roadway work in accordance with Section 105.10 Construction Stakes, Lines and Grades from the HDOT Standard Specifications.

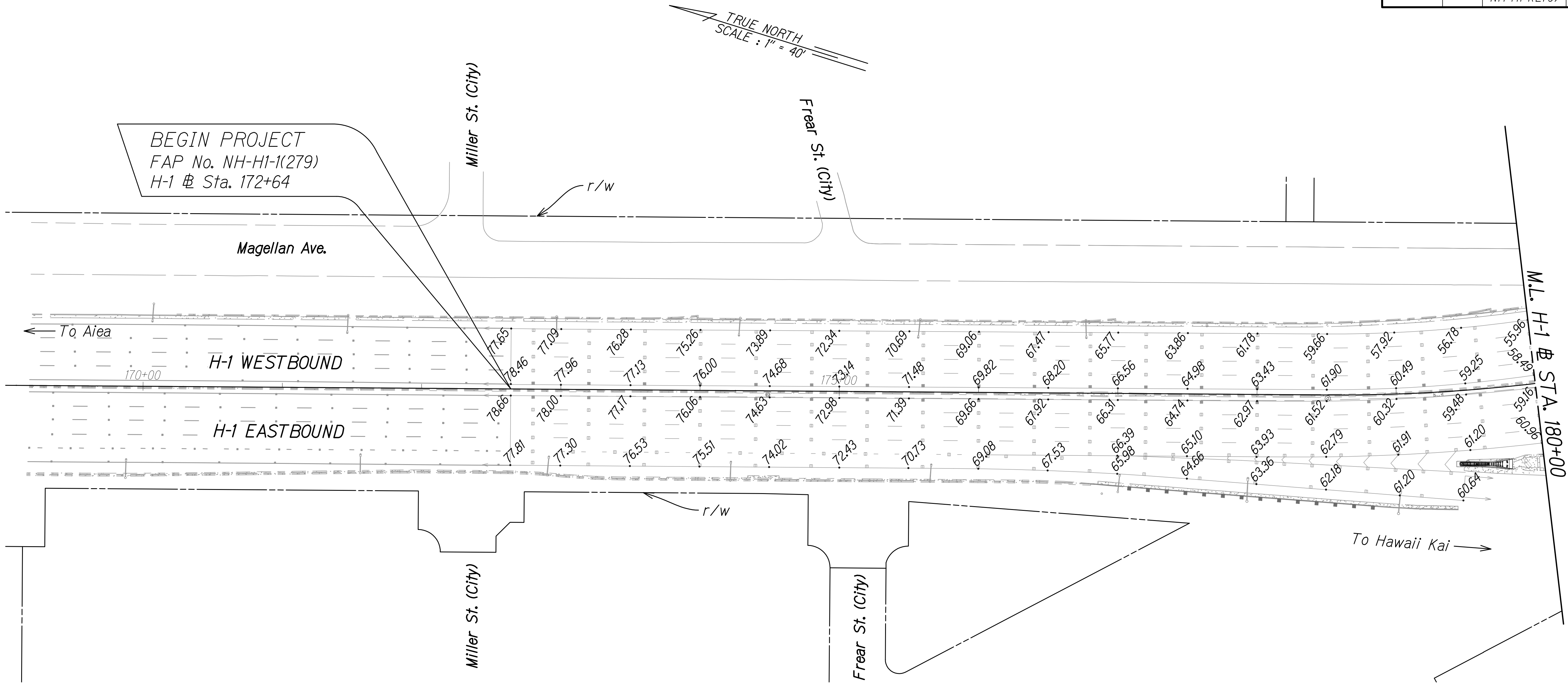

THIS WORK WAS PREPARED BY ME  
OR UNDER MY SUPERVISION

*[Signature]* 04/30/22

SIGNATURE EXPIRATION DATE  
OF THE LICENSE

STATE OF HAWAII  
DEPARTMENT OF TRANSPORTATION  
HIGHWAYS DIVISION

**PAVEMENT GRADE PLAN 01**

**INTERSTATE ROUTE H-1 RESURFACING**  
**Miller Pedestrian Overpass to Kapiolani Interchange**  
**Federal-Aid Project No. NH-H1-1(279)**

Scale: 1" = 40' Date: August 2021

SHEET No. GRI OF 21 SHEETS

FED. ROAD DIST. NO.	STATE	FED-AID PROJ. NO.	FISCAL YEAR	SHEET NO.	TOTAL SHEETS
HAWAII	HAW.	NH-H1-1(279)	2021	122	304

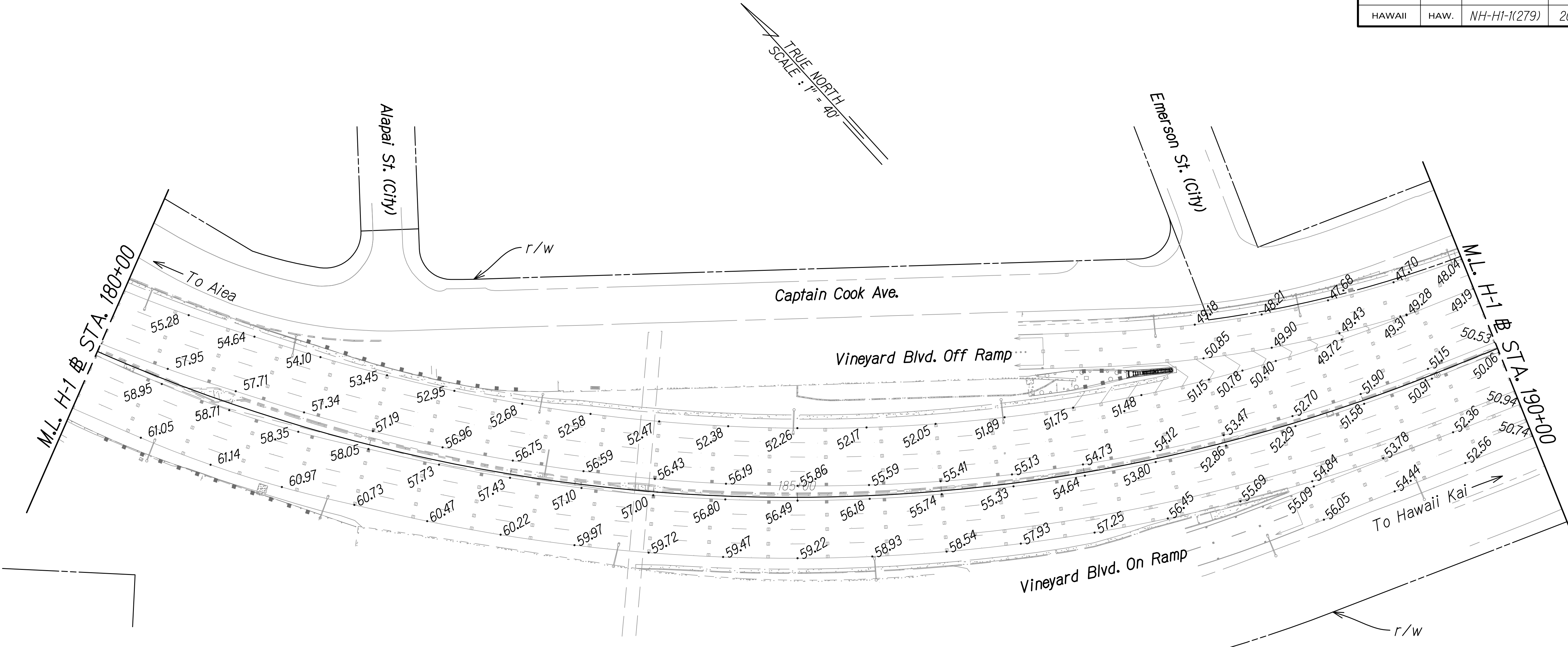

GRAPHIC SCALE:

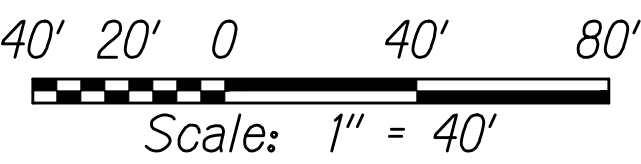

NOTES:

1. The source of pavement grades reflected on plans are from Control Point Surveying Inc. dated 08/02/18. The pavement (or finish) grades represent the existing grades and these grades are for informational purposes only. The Contractor shall verify in field.
2. Survey Control Data along with centerline and curve data are shown on Roadway Plans, sheets R1 - R23.
3. The Contractor shall survey and stake out the roadway work in accordance with Section 105.10 Construction Stakes, Lines and Grades from the HDOT Standard Specifications.



THIS WORK WAS PREPARED BY ME  
OR UNDER MY SUPERVISION

SIGNATURE

04/30/22  
EXPIRATION DATE  
OF THE LICENSE

STATE OF HAWAII  
DEPARTMENT OF TRANSPORTATION  
HIGHWAYS DIVISION

PAVEMENT GRADE PLAN 02

INTERSTATE ROUTE H-1 RESURFACING  
Miller Pedestrian Overpass to Kapiolani Interchange  
Federal-Aid Project No. NH-H1-1(279)

Scale: 1" = 40'      Date: August 2021

SHEET No. GR2 OF 21 SHEETS

FED. ROAD DIST. NO.	STATE	FED-AID PROJ. NO.	FISCAL YEAR	SHEET NO.	TOTAL SHEETS
HAWAII	HAW.	NH-H1-1(279)	2021	123	304

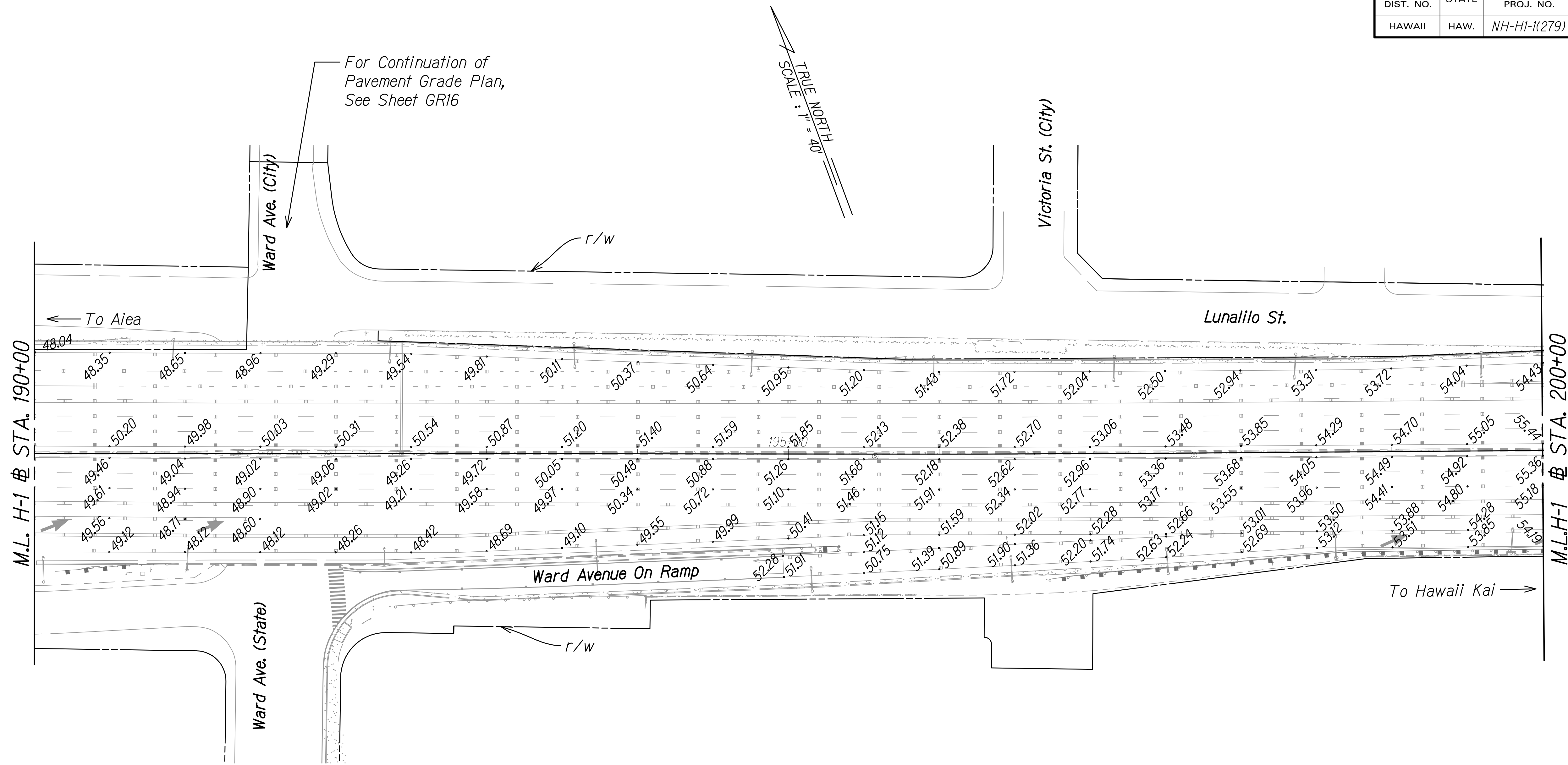

GRAPHIC SCALE:

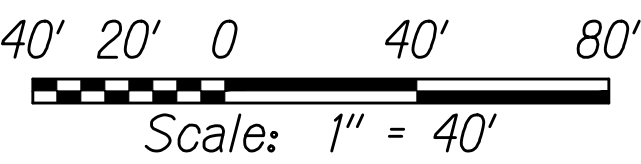

**NOTES:**

1. The source of pavement grades reflected on plans are from Control Point Surveying Inc. dated 08/02/18. The pavement (or finish) grades represent the existing grades and these grades are for informational purposes only. The Contractor shall verify in field.
2. Survey Control Data along with centerline and curve data are shown on Roadway Plans, sheets R1 - R23.
3. The Contractor shall survey and stake out the roadway work in accordance with Section 105.10 Construction Stakes, Lines and Grades from the HDOT Standard Specifications.

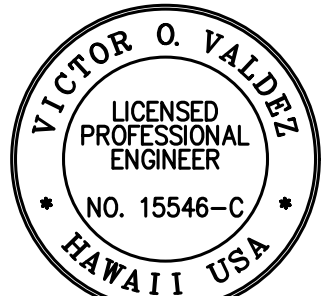

THIS WORK WAS PREPARED BY ME  
OR UNDER MY SUPERVISION

*[Signature]* 04/30/22  
SIGNATURE EXPIRATION DATE  
OF THE LICENSE

STATE OF HAWAII  
DEPARTMENT OF TRANSPORTATION  
HIGHWAYS DIVISION

**PAVEMENT GRADE PLAN 03**

INTERSTATE ROUTE H-1 RESURFACING  
Miller Pedestrian Overpass to Kapiolani Interchange  
Federal-Aid Project No. NH-H1-1(279)

Scale: 1" = 40' Date: August 2021

SHEET No. **GR3** OF **21** SHEETS

C:\CIVIL 3D PROJECTS\2016\_2022\000 DOT-HWYS H1 RESURFACING - MILLER TO KAPITV01 CIVIL DRAWINGS\GR1 - GR15 PAVEMENT GRADE PLANS.DWG 1/22/2021 1:39 PM

FED. ROAD DIST. NO.	STATE	FED-AID PROJ. NO.	FISCAL YEAR	SHEET NO.	TOTAL SHEETS
HAWAII	HAW.	NH-H1-1(279)	2021	124	304

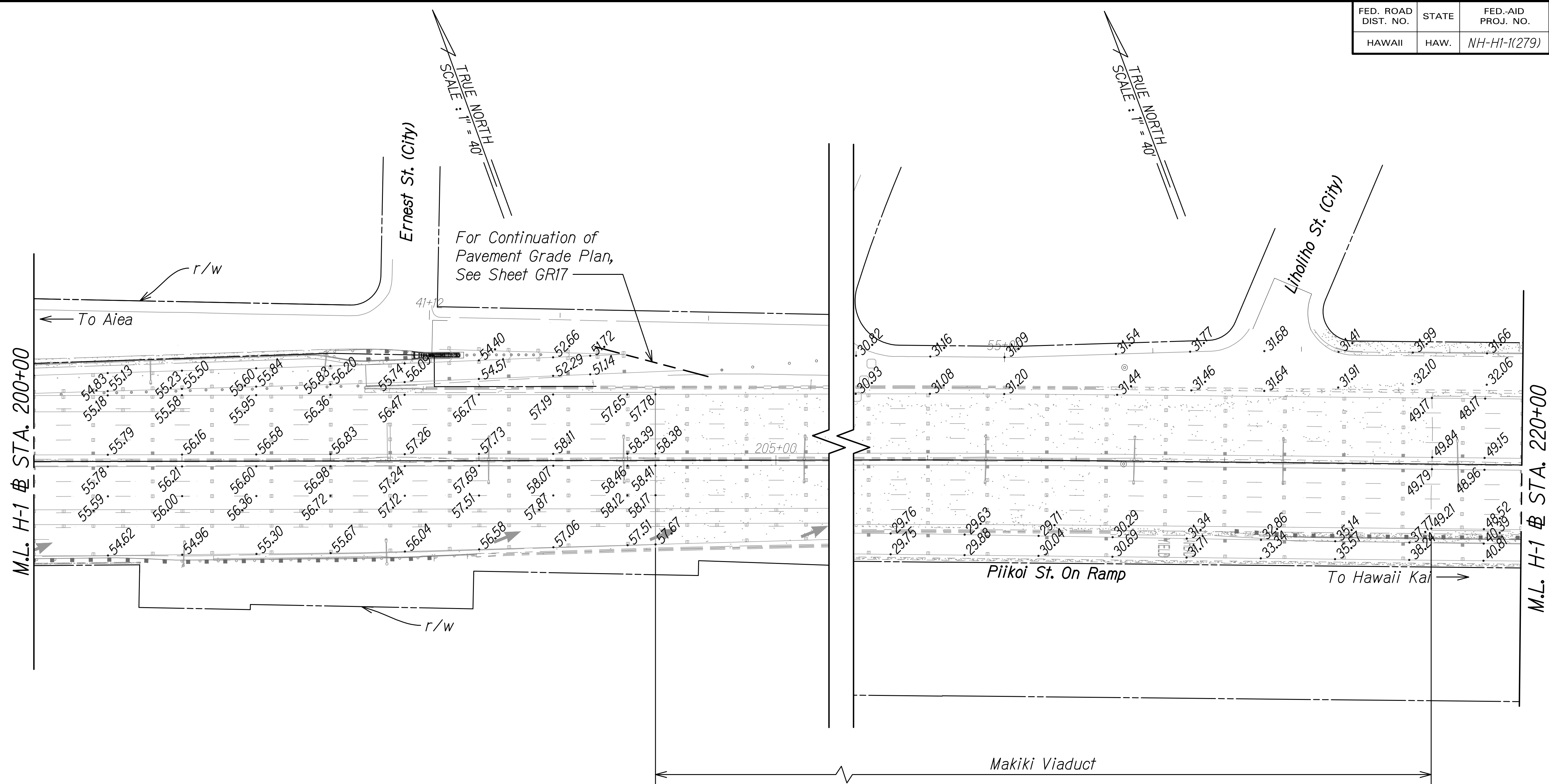

GRAPHIC SCALE:

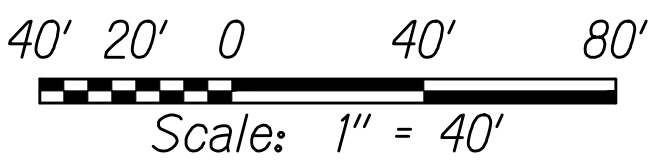

**NOTES:**

1. The source of pavement grades reflected on plans are from Control Point Surveying Inc. dated 08/02/18. The pavement (or finish) grades represent the existing grades and these grades are for informational purposes only. The Contractor shall verify in field.
2. Survey Control Data along with centerline and curve data are shown on Roadway Plans, sheets R1 - R23.
3. The Contractor shall survey and stake out the roadway work in accordance with Section 105.10 Construction Stakes, Lines and Grades from the HDOT Standard Specifications.



THIS WORK WAS PREPARED BY ME  
OR UNDER MY SUPERVISION

*[Signature]*  
SIGNATURE

04/30/22  
EXPIRATION DATE  
OF THE LICENSE

STATE OF HAWAII  
DEPARTMENT OF TRANSPORTATION  
HIGHWAYS DIVISION

**PAVEMENT GRADE PLAN 04**

INTERSTATE ROUTE H-1 RESURFACING  
Miller Pedestrian Overpass to Kapiolani Interchange  
Federal-Aid Project No. NH-H1-1(279)

Scale: 1" = 40'      Date: August 2021

SHEET No. **GR4** OF **21** SHEETS



FED. ROAD DIST. NO.	STATE	FED-AID PROJ. NO.	FISCAL YEAR	SHEET NO.	TOTAL SHEETS
HAWAII	HAW.	NH-H1-1(279)	2021	125	304

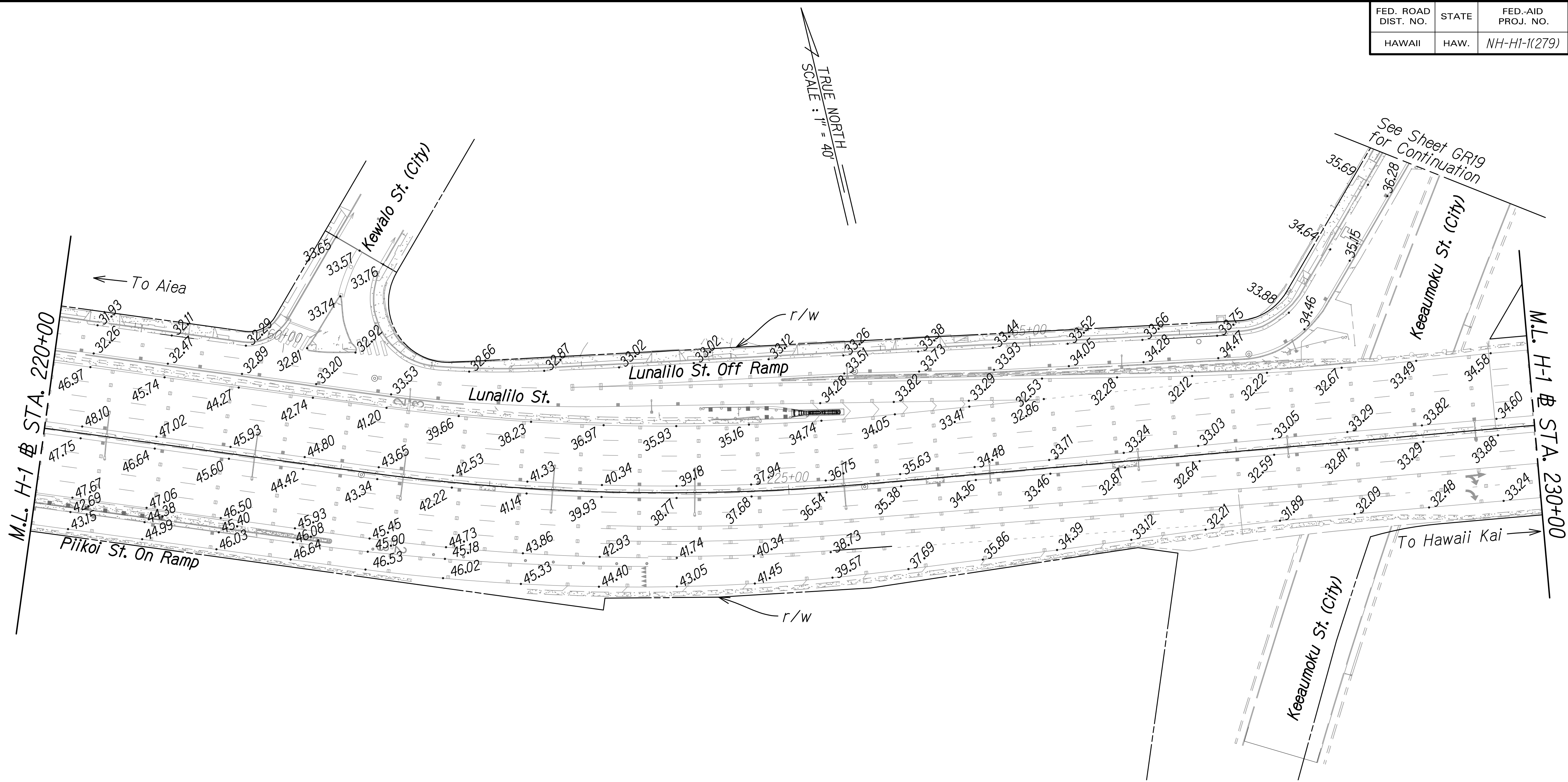

GRAPHIC SCALE:

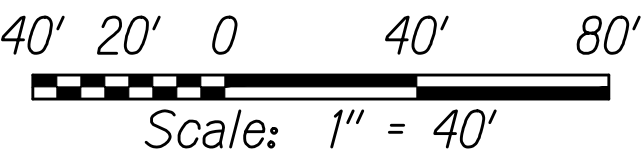

NOTES:

1. The source of pavement grades reflected on plans are from Control Point Surveying Inc. dated 08/02/18. The pavement (or finish) grades represent the existing grades and these grades are for informational purposes only. The Contractor shall verify in field.
2. Survey Control Data along with centerline and curve data are shown on Roadway Plans, sheets R1 - R23.
3. The Contractor shall survey and stake out the roadway work in accordance with Section 105.10 Construction Stakes, Lines and Grades from the HDOT Standard Specifications.



THIS WORK WAS PREPARED BY ME  
OR UNDER MY SUPERVISION

SIGNATURE

04/30/22  
EXPIRATION DATE  
OF THE LICENSE

STATE OF HAWAII  
DEPARTMENT OF TRANSPORTATION  
HIGHWAYS DIVISION

PAVEMENT GRADE PLAN 05

INTERSTATE ROUTE H-1 RESURFACING  
Miller Pedestrian Overpass to Kapiolani Interchange  
Federal-Aid Project No. NH-H1-1(279)

Scale: 1" = 40' Date: August 2021

SHEET No. GR5 OF 21 SHEETS

FED. ROAD DIST. NO.	STATE	FED-AID PROJ. NO.	FISCAL YEAR	SHEET NO.	TOTAL SHEETS
HAWAII	HAW.	NH-H1-1(279)	2021	126	304

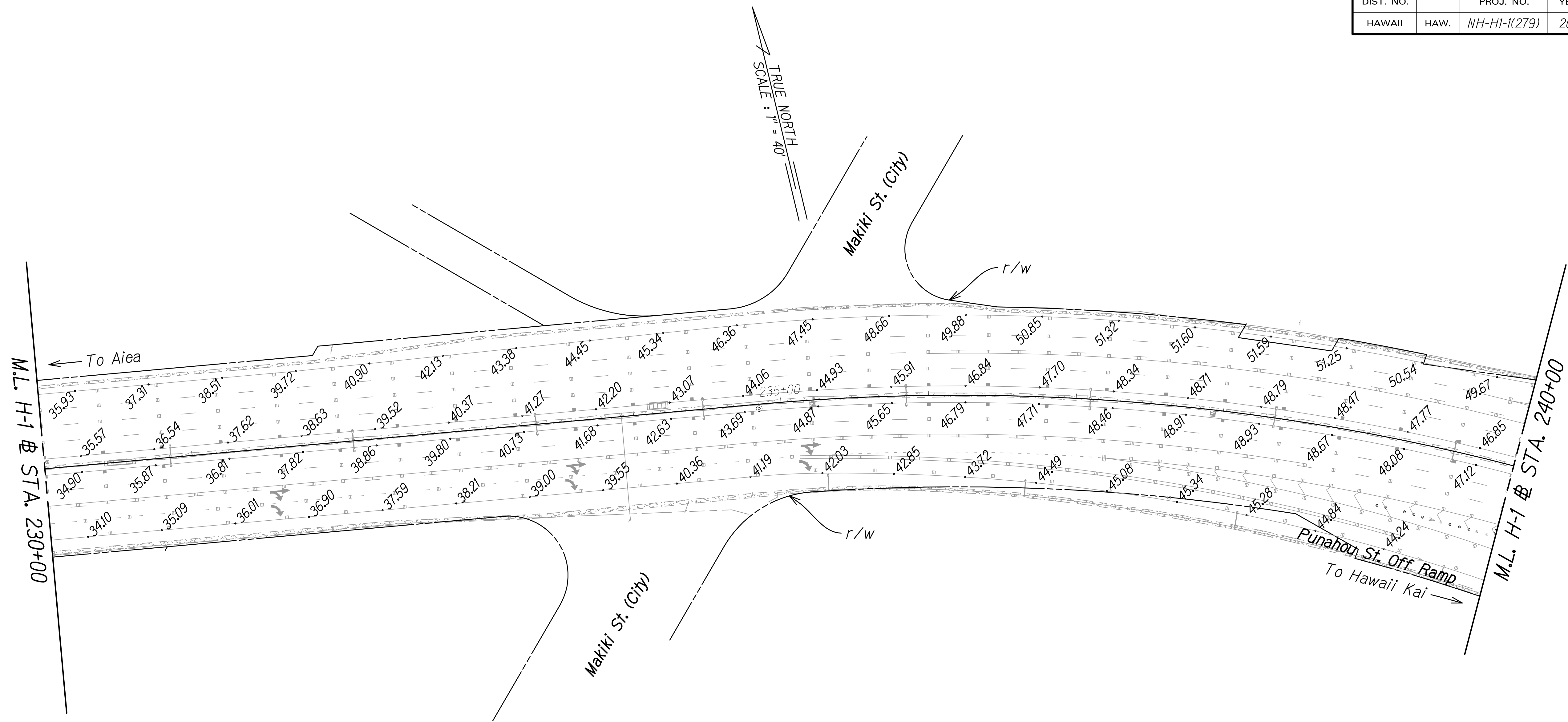

GRAPHIC SCALE:

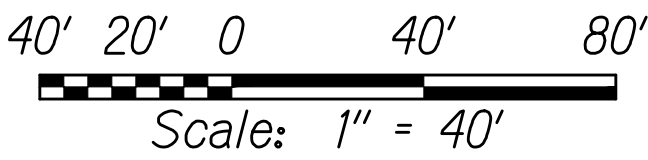

NOTES:

1. The source of pavement grades reflected on plans are from Control Point Surveying Inc. dated 08/02/18. The pavement (or finish) grades represent the existing grades and these grades are for informational purposes only. The Contractor shall verify in field.
2. Survey Control Data along with centerline and curve data are shown on Roadway Plans, sheets R1 - R23.
3. The Contractor shall survey and stake out the roadway work in accordance with Section 105.10 Construction Stakes, Lines and Grades from the HDOT Standard Specifications.



THIS WORK WAS PREPARED BY ME  
OR UNDER MY SUPERVISION

SIGNATURE

04/30/22  
EXPIRATION DATE  
OF THE LICENSE

STATE OF HAWAII  
DEPARTMENT OF TRANSPORTATION  
HIGHWAYS DIVISION

PAVEMENT GRADE PLAN 06

INTERSTATE ROUTE H-1 RESURFACING  
Miller Pedestrian Overpass to Kapiolani Interchange  
Federal-Aid Project No. NH-H1-1(279)

Scale: 1" = 40'      Date: August 2021

SHEET No. GR6 OF 21 SHEETS

FED. ROAD DIST. NO.	STATE	FED-AID PROJ. NO.	FISCAL YEAR	SHEET NO.	TOTAL SHEETS
HAWAII	HAW.	NH-H1-1(279)	2021	127	304

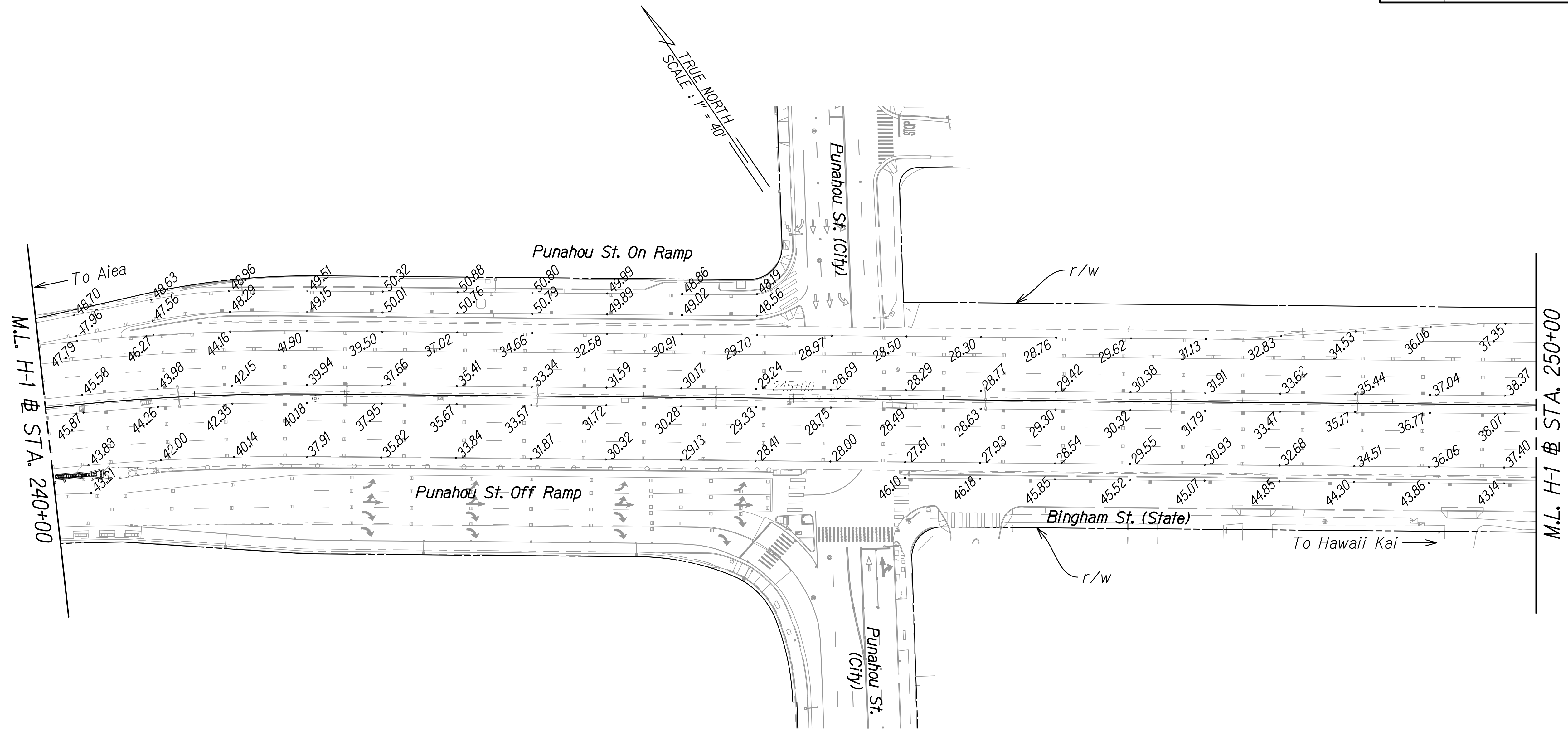

GRAPHIC SCALE:

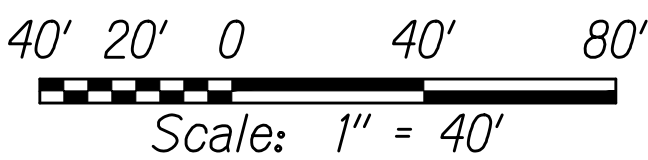

**NOTES:**

1. The source of pavement grades reflected on plans are from Control Point Surveying Inc. dated 08/02/18. The pavement (or finish) grades represent the existing grades and these grades are for informational purposes only. The Contractor shall verify in field.
2. Survey Control Data along with centerline and curve data are shown on Roadway Plans, sheets R1 - R23.
3. The Contractor shall survey and stake out the roadway work in accordance with Section 105.10 Construction Stakes, Lines and Grades from the HDOT Standard Specifications.



THIS WORK WAS PREPARED BY ME  
OR UNDER MY SUPERVISION

*[Signature]*  
SIGNATURE

04/30/22  
EXPIRATION DATE  
OF THE LICENSE

STATE OF HAWAII  
DEPARTMENT OF TRANSPORTATION  
HIGHWAYS DIVISION

**PAVEMENT GRADE PLAN 07**

INTERSTATE ROUTE H-1 RESURFACING  
Miller Pedestrian Overpass to Kapiolani Interchange  
Federal-Aid Project No. NH-H1-1(279)

Scale: 1" = 40'      Date: August 2021

SHEET No. **GR7** OF **21** SHEETS

FED. ROAD DIST. NO.	STATE	FED-AID PROJ. NO.	FISCAL YEAR	SHEET NO.	TOTAL SHEETS
HAWAII	HAW.	NH-H1-1(279)	2021	128	304

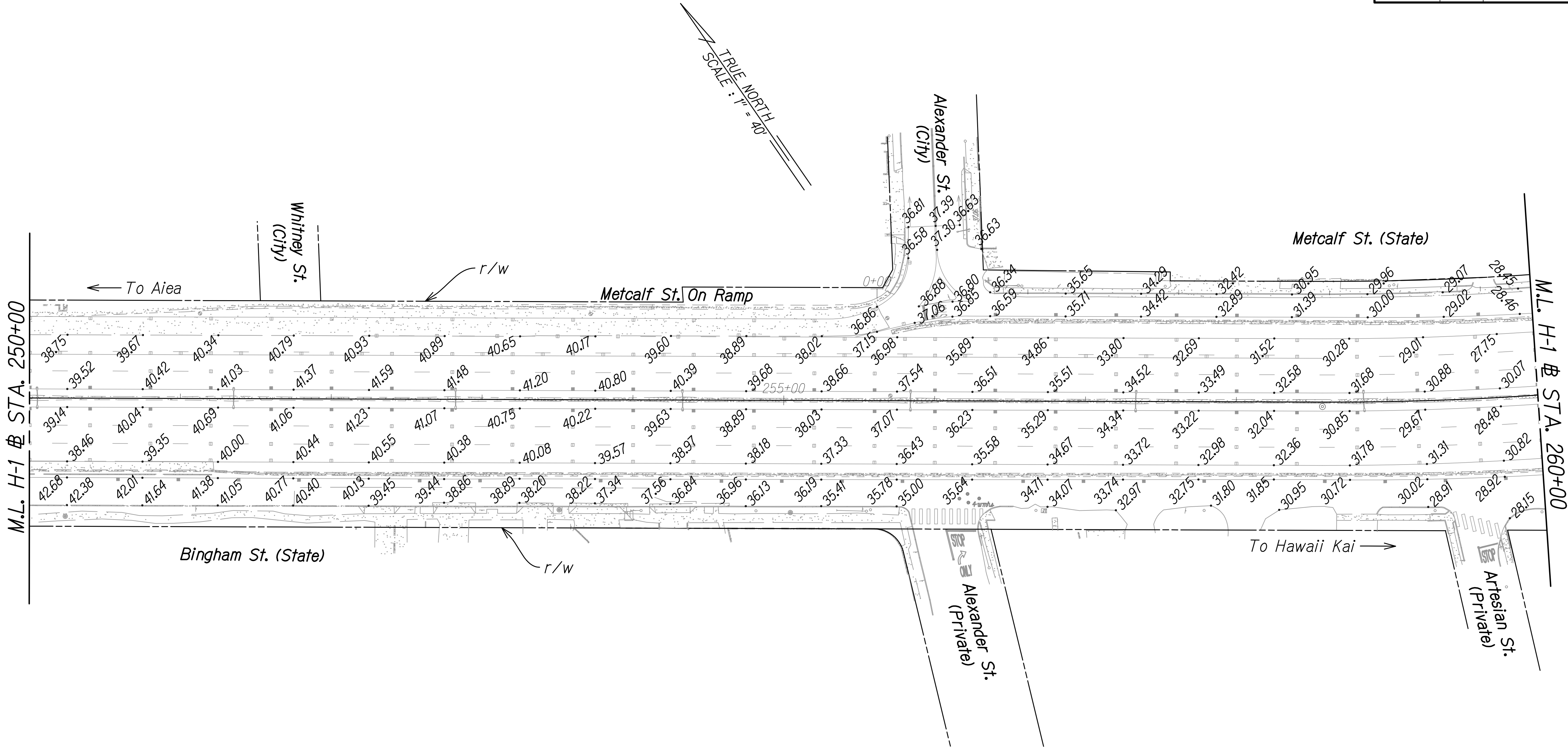

GRAPHIC SCALE:

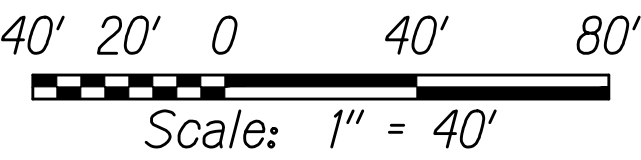

NOTES:

1. The source of pavement grades reflected on plans are from Control Point Surveying Inc. dated 08/02/18. The pavement (or finish) grades represent the existing grades and these grades are for informational purposes only. The Contractor shall verify in field.
2. Survey Control Data along with centerline and curve data are shown on Roadway Plans, sheets R1 - R23.
3. The Contractor shall survey and stake out the roadway work in accordance with Section 105.10 Construction Stakes, Lines and Grades from the HDOT Standard Specifications.



THIS WORK WAS PREPARED BY ME  
OR UNDER MY SUPERVISION

SIGNATURE

04/30/22  
EXPIRATION DATE  
OF THE LICENSE

STATE OF HAWAII  
DEPARTMENT OF TRANSPORTATION  
HIGHWAYS DIVISION

PAVEMENT GRADE PLAN 08

INTERSTATE ROUTE H-1 RESURFACING  
Miller Pedestrian Overpass to Kapiolani Interchange  
Federal-Aid Project No. NH-H1-1(279)

Scale: 1" = 40' Date: August 2021

SHEET No. 08 OF 21 SHEETS



FED. ROAD DIST. NO.	STATE	FED-AID PROJ. NO.	FISCAL YEAR	SHEET NO.	TOTAL SHEETS
HAWAII	HAW.	NH-H1-1(279)	2021	129	304

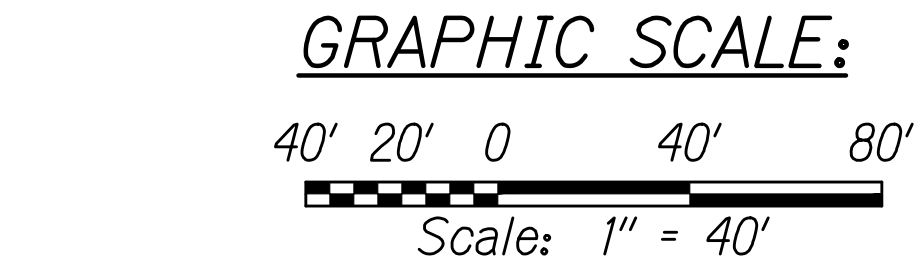
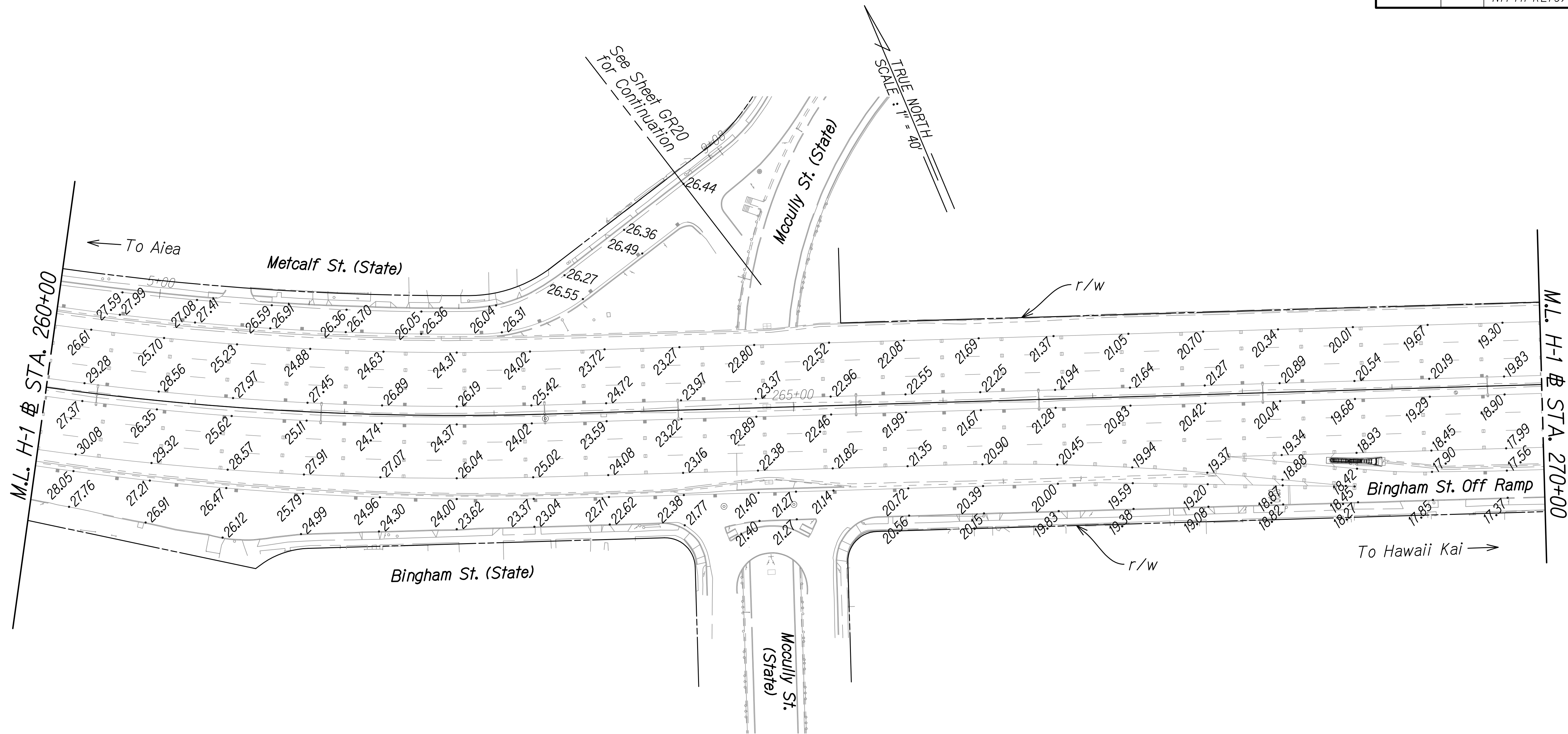

**NOTES:**

1. The source of pavement grades reflected on plans are from Control Point Surveying Inc. dated 08/02/18. The pavement (or finish) grades represent the existing grades and these grades are for informational purposes only. The Contractor shall verify in field.
2. Survey Control Data along with centerline and curve data are shown on Roadway Plans, sheets R1 - R23.
3. The Contractor shall survey and stake out the roadway work in accordance with Section 105.10 Construction Stakes, Lines and Grades from the HDOT Standard Specifications.



THIS WORK WAS PREPARED BY ME  
OR UNDER MY SUPERVISION

*[Signature]* 04/30/22

SIGNATURE EXPIRATION DATE  
OF THE LICENSE

STATE OF HAWAII  
DEPARTMENT OF TRANSPORTATION  
HIGHWAYS DIVISION

**PAVEMENT GRADE PLAN 09**  
**INTERSTATE ROUTE H-1 RESURFACING**  
**Miller Pedestrian Overpass to Kapiolani Interchange**  
**Federal-Aid Project No. NH-H1-1(279)**

Scale: 1" = 40' Date: August 2021

SHEET No. **GR9** OF **21** SHEETS

C:\CIVIL 3D PROJECTS\2016\_2022\000 DOT-HWYS H-1 RESURFACING - MILLER TO KAPITOLI CIVIL DRAWINGS\GR1 - GR15 PAVEMENT GRADE PLANS.DWG 1/22/2021 1:39 PM

FED. ROAD DIST. NO.	STATE	FED-AID PROJ. NO.	FISCAL YEAR	SHEET NO.	TOTAL SHEETS
HAWAII	HAW.	NH-H1-1(279)	2021	130	304

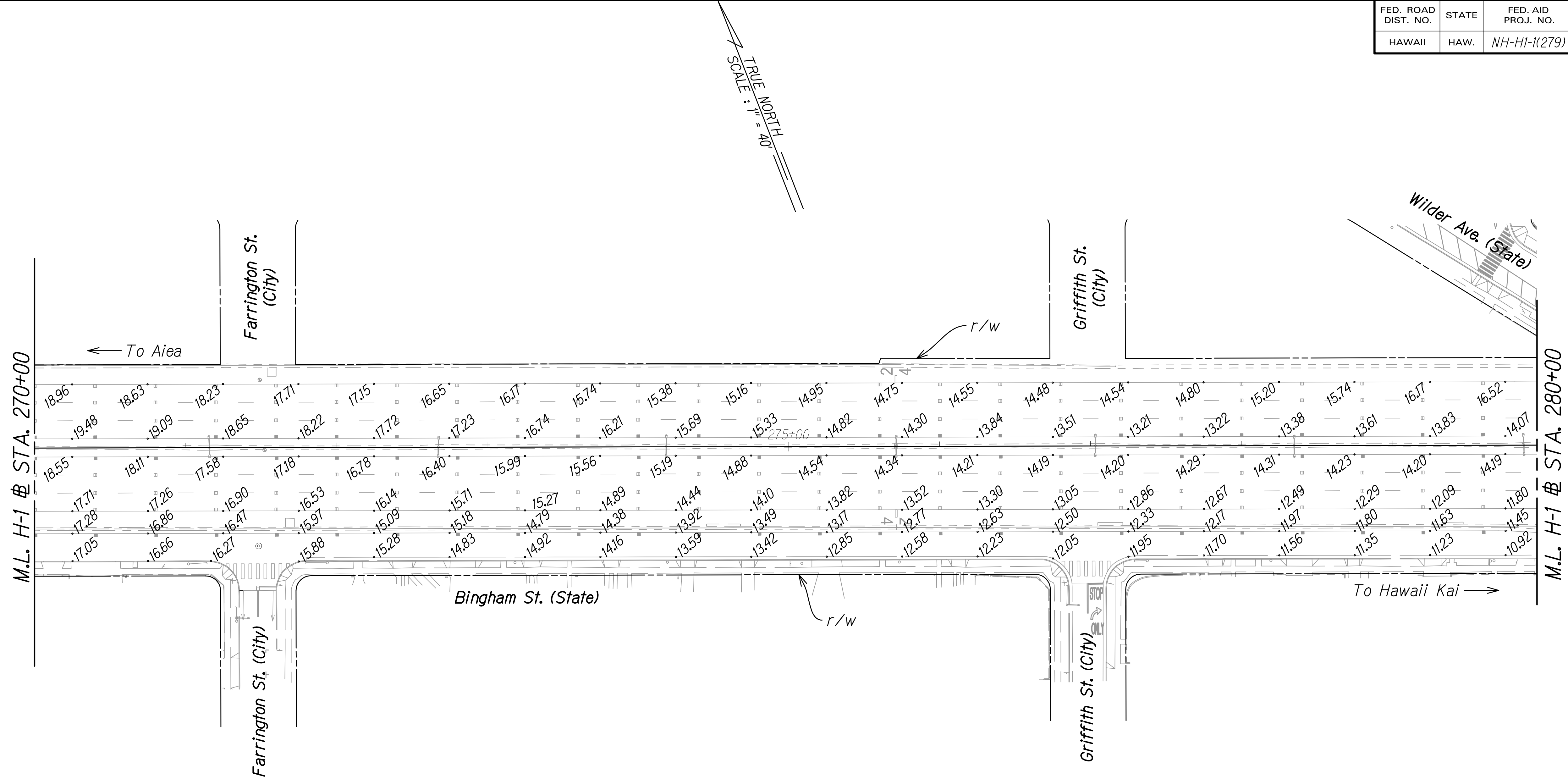

**NOTES:**

1. The source of pavement grades reflected on plans are from Control Point Surveying Inc. dated 08/02/18. The pavement (or finish) grades represent the existing grades and these grades are for informational purposes only. The Contractor shall verify in field.
2. Survey Control Data along with centerline and curve data are shown on Roadway Plans, sheets R1 - R23.
3. The Contractor shall survey and stake out the roadway work in accordance with Section 105.10 Construction Stakes, Lines and Grades from the HDOT Standard Specifications.

**GRAPHIC SCALE:**

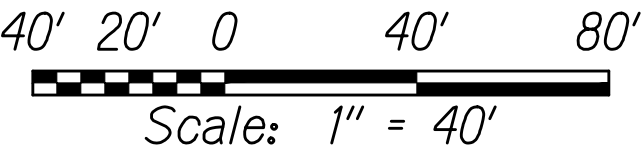

THIS WORK WAS PREPARED BY ME  
OR UNDER MY SUPERVISION  
  
SIGNATURE      04/30/22  
EXPIRATION DATE  
OF THE LICENSE

STATE OF HAWAII  
DEPARTMENT OF TRANSPORTATION  
HIGHWAYS DIVISION

**PAVEMENT GRADE PLAN 10**  
**INTERSTATE ROUTE H-1 RESURFACING**  
**Miller Pedestrian Overpass to Kapiolani Interchange**  
**Federal-Aid Project No. NH-H1-1(279)**

Scale: 1" = 40'      Date: August 2021

SHEET No. **GR10** OF **21** SHEETS

FED. ROAD DIST. NO.	STATE	FED-AID PROJ. NO.	FISCAL YEAR	SHEET NO.	TOTAL SHEETS
HAWAII	HAW.	NH-H1-1(279)	2021	131	304

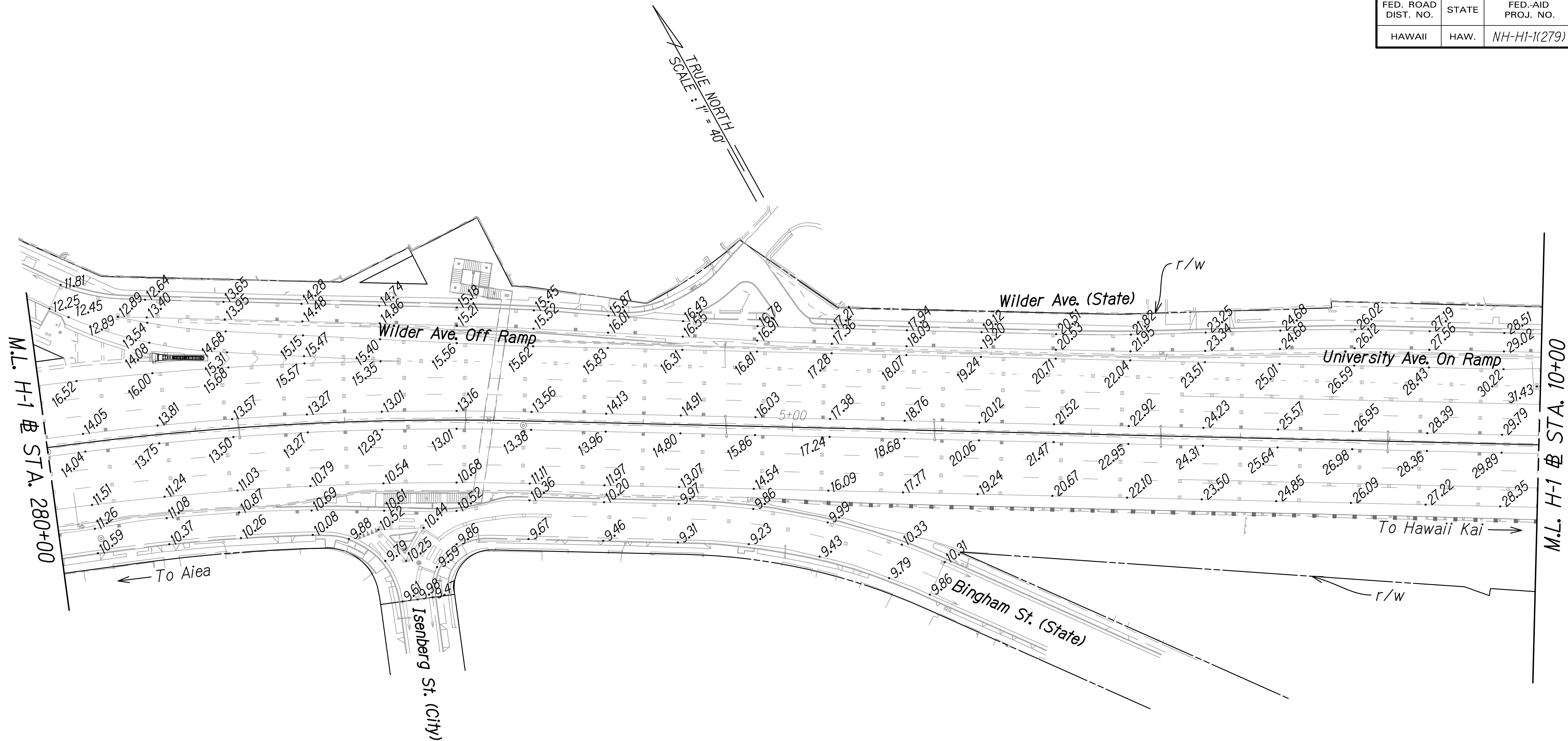

### NOTES:

1. The source of pavement grades reflected on plans are from Control Point Surveying Inc. dated 08/02/18. The pavement (or finish) grades represent the existing grades and these grades are for informational purposes only. The Contractor shall verify in field.
2. Survey Control Data along with centerline and curve data are shown on Roadway Plans, sheets R1 - R23.
3. The Contractor shall survey and stake out the roadway work in accordance with Section 105.10 Construction Stakes, Lines and Grades from the HDOT Standard Specifications.



THIS WORK WAS PREPARED BY ME  
OR UNDER MY SUPERVISION

SIGNATURE

04/30/22  
EXPIRATION DATE  
OF THE LICENSE

STATE OF HAWAII  
DEPARTMENT OF TRANSPORTATION  
HIGHWAYS DIVISION

**PAVEMENT GRADE PLAN 11**

**INTERSTATE ROUTE H-1 RESURFACING**  
**Miller Pedestrian Overpass to Kapiolani Interchange**  
**Federal-Aid Project No. NH-H1-1(279)**

Scale: 1" = 40' Date: August 2021

SHEET No. **GR11** OF **21** SHEETS



FED. ROAD DIST. NO.	STATE	FED-AID PROJ. NO.	FISCAL YEAR	SHEET NO.	TOTAL SHEETS
HAWAII	HAW.	NH-H1-1(279)	2021	132	304

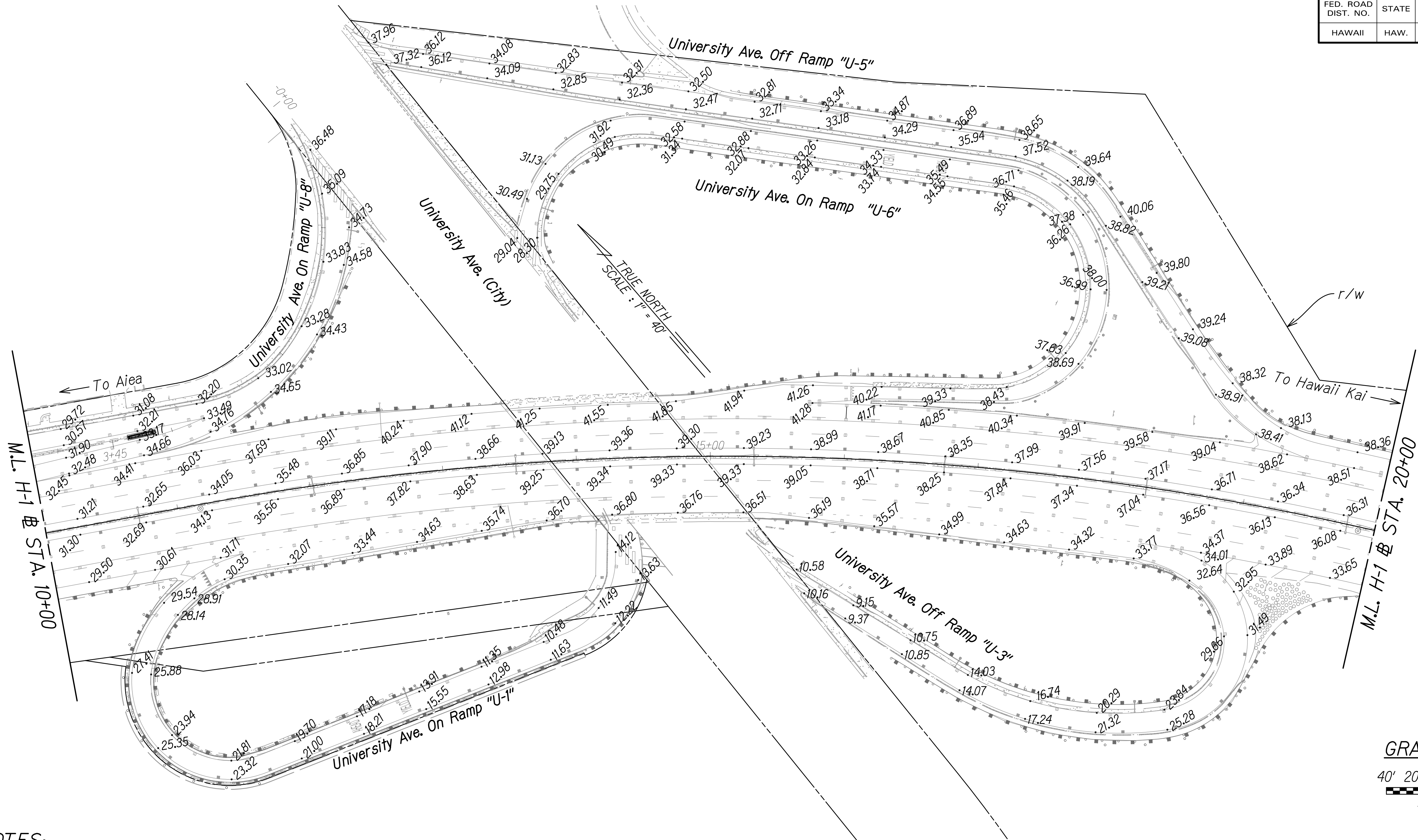

GRAPHIC SCALE:

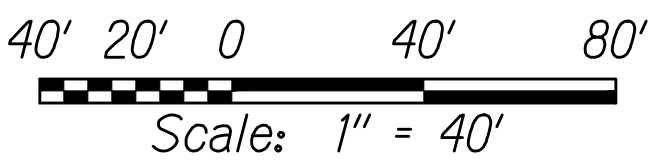

**NOTES:**

1. The source of pavement grades reflected on plans are from Control Point Surveying Inc. dated 08/02/18. The pavement (or finish) grades represent the existing grades and these grades are for informational purposes only. The Contractor shall verify in field.
2. Survey Control Data along with centerline and curve data are shown on Roadway Plans, sheets R1 - R23.
3. The Contractor shall survey and stake out the roadway work in accordance with Section 105.10 Construction Stakes, Lines and Grades from the HDOT Standard Specifications.



THIS WORK WAS PREPARED BY ME  
OR UNDER MY SUPERVISION

SIGNATURE

04/30/22  
EXPIRATION DATE  
OF THE LICENSE

STATE OF HAWAII  
DEPARTMENT OF TRANSPORTATION  
HIGHWAYS DIVISION

**PAVEMENT GRADE PLAN 12**

**INTERSTATE ROUTE H-1 RESURFACING**  
**Miller Pedestrian Overpass to Kapiolani Interchange**  
**Federal-Aid Project No. NH-H1-1(279)**

Scale: 1" = 40'

Date: August 2021

SHEET No. GR12 OF 21 SHEETS



FED. ROAD DIST. NO.	STATE	FED-AID PROJ. NO.	FISCAL YEAR	SHEET NO.	TOTAL SHEETS
HAWAII	HAW.	NH-H1-1(279)	2021	133	304

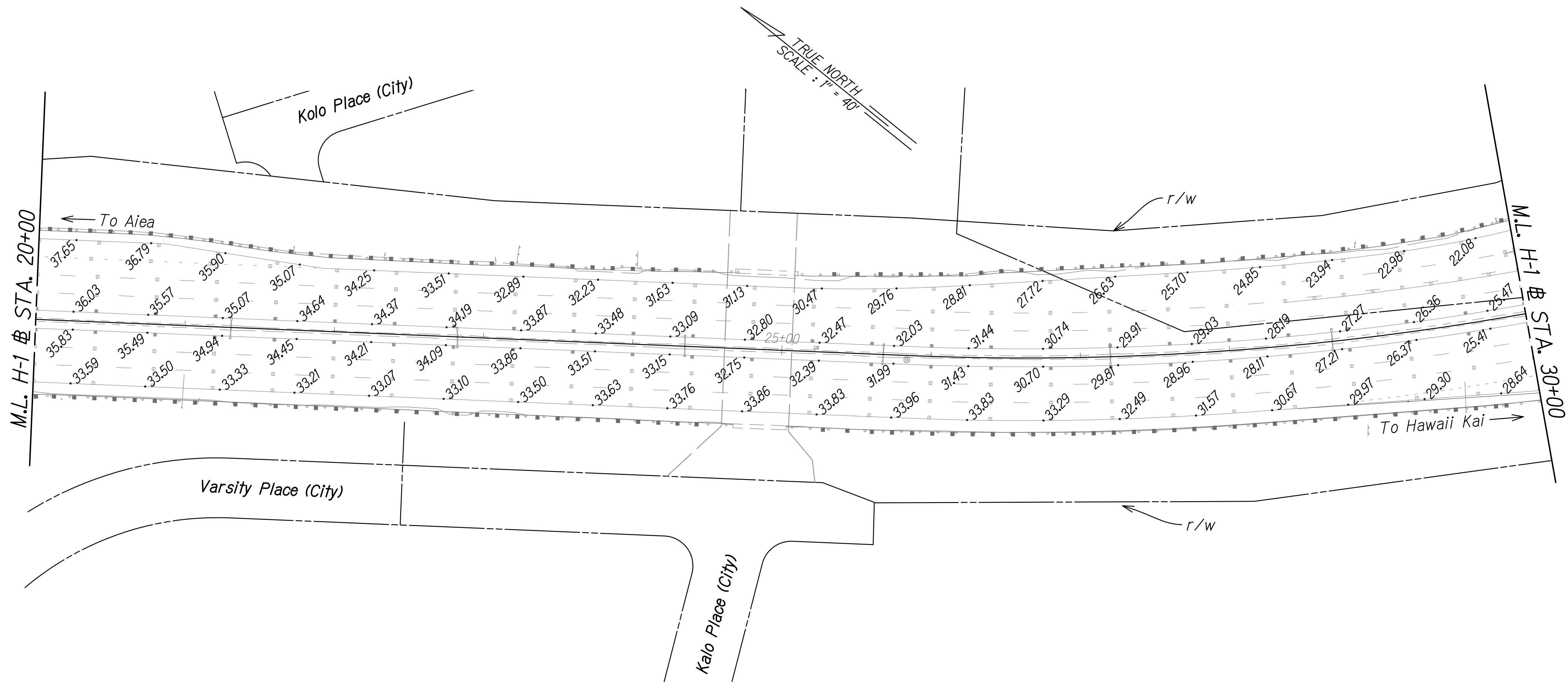

GRAPHIC SCALE:

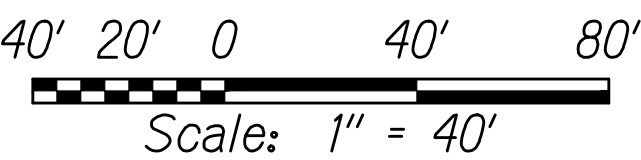

**NOTES:**

1. The source of pavement grades reflected on plans are from Control Point Surveying Inc. dated 08/02/18. The pavement (or finish) grades represent the existing grades and these grades are for informational purposes only. The Contractor shall verify in field.
2. Survey Control Data along with centerline and curve data are shown on Roadway Plans, sheets R1 - R23.
3. The Contractor shall survey and stake out the roadway work in accordance with Section 105.10 Construction Stakes, Lines and Grades from the HDOT Standard Specifications.



THIS WORK WAS PREPARED BY ME  
OR UNDER MY SUPERVISION

SIGNATURE

04/30/22  
EXPIRATION DATE  
OF THE LICENSE

STATE OF HAWAII  
DEPARTMENT OF TRANSPORTATION  
HIGHWAYS DIVISION

**PAVEMENT GRADE PLAN 13**

**INTERSTATE ROUTE H-1 RESURFACING**  
**Miller Pedestrian Overpass to Kapiolani Interchange**  
**Federal-Aid Project No. NH-H1-1(279)**

Scale: 1" = 40'

Date: August 2021

SHEET No. GR13 OF 21 SHEETS

FED. ROAD DIST. NO.	STATE	FED-AID PROJ. NO.	FISCAL YEAR	SHEET NO.	TOTAL SHEETS
HAWAII	HAW.	NH-H1-1(279)	2021	134	304

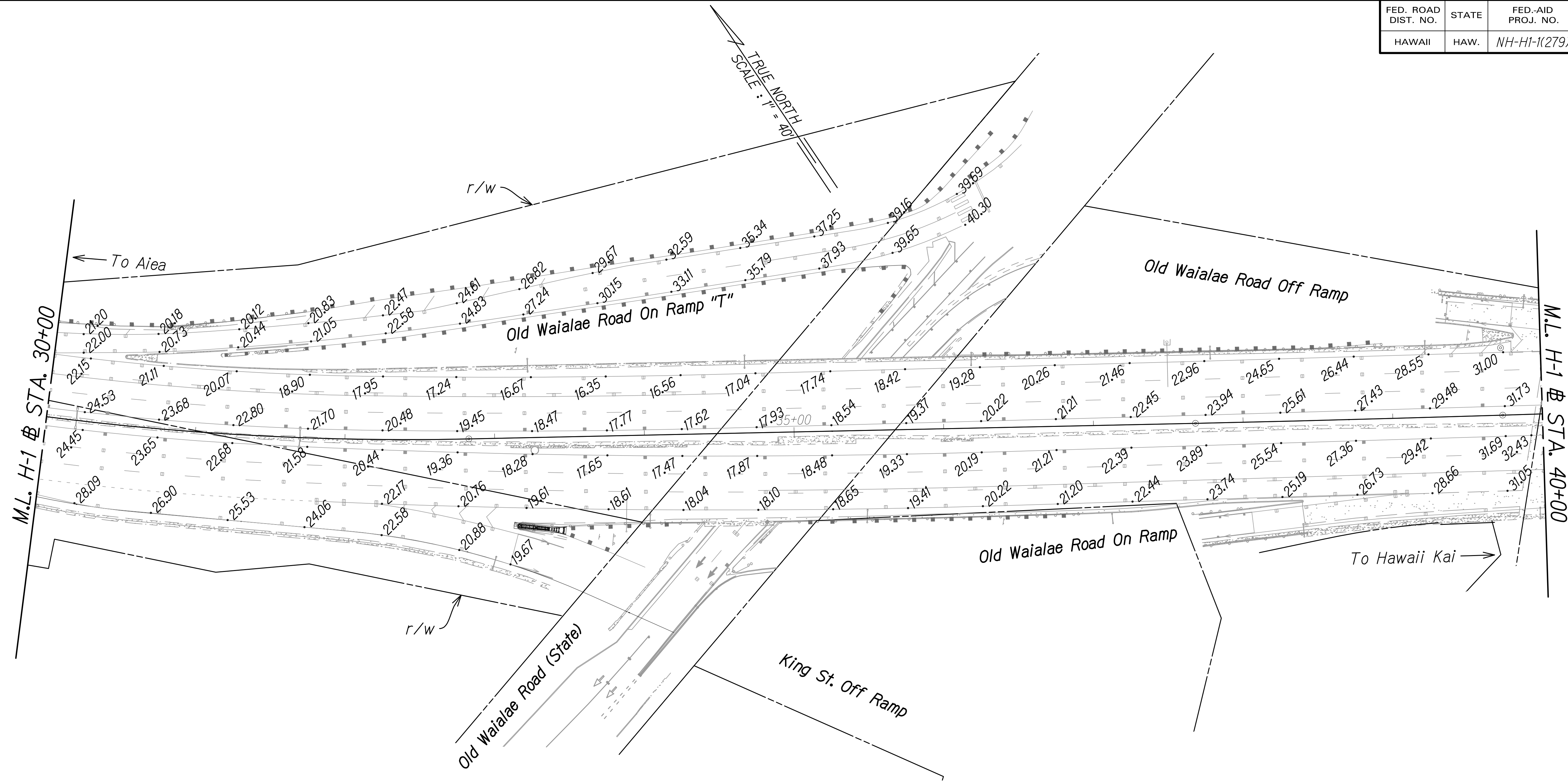

NOTES:

1. The source of pavement grades reflected on plans are from Control Point Surveying Inc. dated 08/02/18. The pavement (or finish) grades represent the existing grades and these grades are for informational purposes only. The Contractor shall verify in field.
2. Survey Control Data along with centerline and curve data are shown on Roadway Plans, sheets R1 - R23.
3. The Contractor shall survey and stake out the roadway work in accordance with Section 105.10 Construction Stakes, Lines and Grades from the HDOT Standard Specifications.

GRAPHIC SCALE:

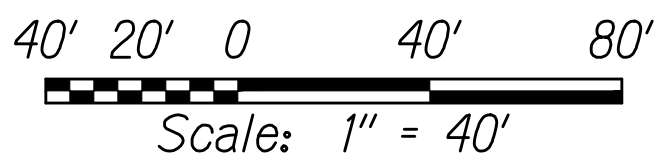

THIS WORK WAS PREPARED BY ME  
OR UNDER MY SUPERVISION  
*[Signature]* 04/30/22  
SIGNATURE EXPIRATION DATE  
OF THE LICENSE

STATE OF HAWAII  
DEPARTMENT OF TRANSPORTATION  
HIGHWAYS DIVISION

PAVEMENT GRADE PLAN 14

INTERSTATE ROUTE H-1 RESURFACING  
Miller Pedestrian Overpass to Kapiolani Interchange  
Federal-Aid Project No. NH-H1-1(279)

Scale: 1" = 40' Date: August 2021

SHEET No. GR14 OF 21 SHEETS

FED. ROAD DIST. NO.	STATE	FED-AID PROJ. NO.	FISCAL YEAR	SHEET NO.	TOTAL SHEETS
HAWAII	HAW.	NH-H1-1(279)	2021	135	304

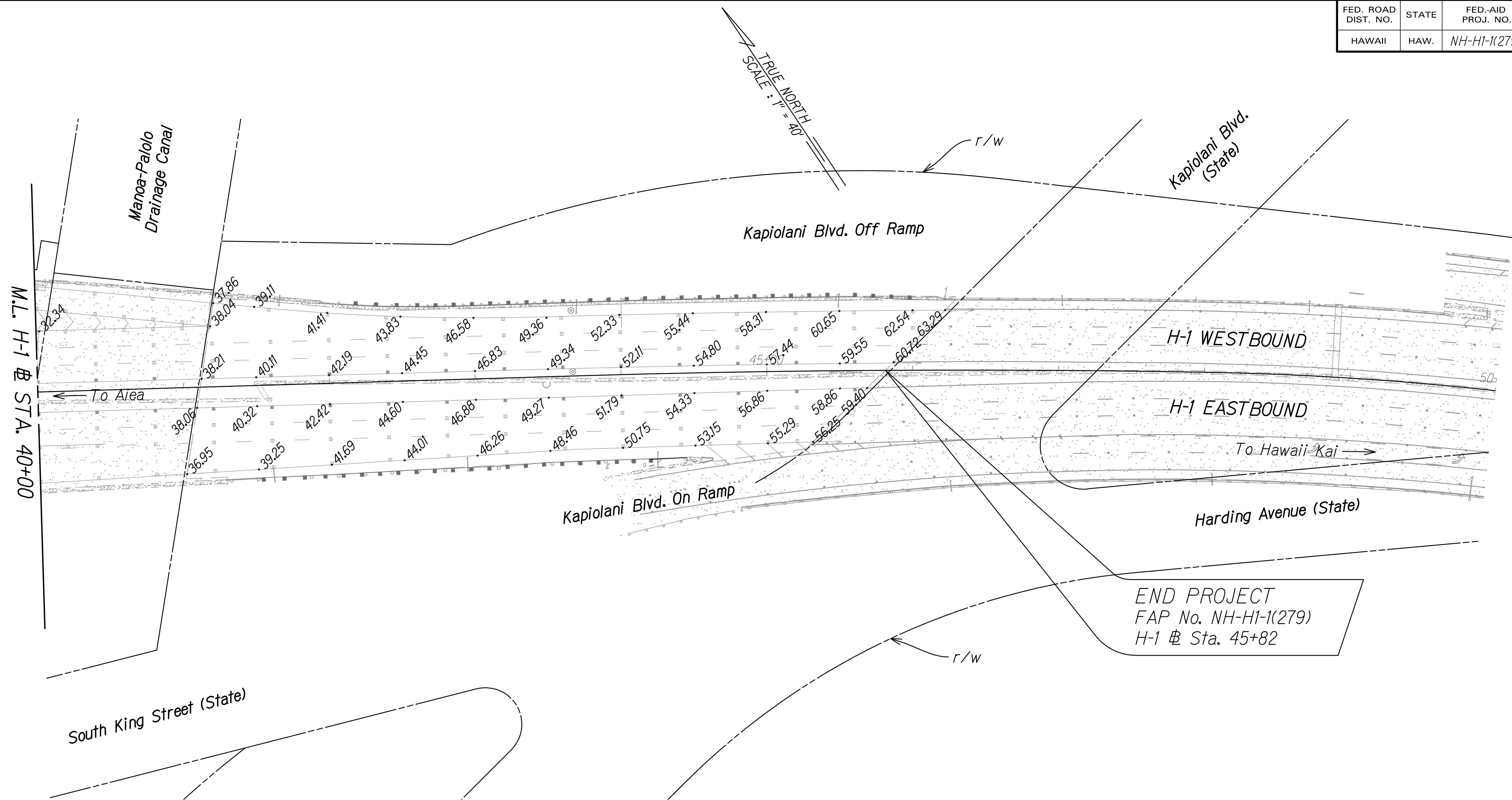

END PROJECT  
FAP No. NH-H1-1(279)  
H-1 @ Sta. 45+82

GRAPHIC SCALE:

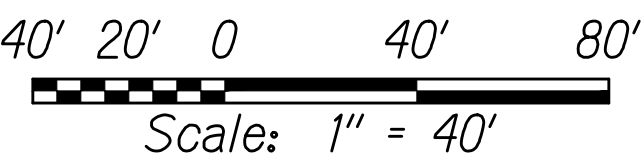

NOTES:

1. The source of pavement grades reflected on plans are from Control Point Surveying Inc. dated 08/02/18. The pavement (or finish) grades represent the existing grades and these grades are for informational purposes only. The Contractor shall verify in field.
2. Survey Control Data along with centerline and curve data are shown on Roadway Plans, sheets R1 - R23.
3. The Contractor shall survey and stake out the roadway work in accordance with Section 105.10 Construction Stakes, Lines and Grades from the HDOT Standard Specifications.



THIS WORK WAS PREPARED BY ME  
OR UNDER MY SUPERVISION

SIGNATURE

04/30/22  
EXPIRATION DATE  
OF THE LICENSE

STATE OF HAWAII  
DEPARTMENT OF TRANSPORTATION  
HIGHWAYS DIVISION

PAVEMENT GRADE PLAN 15

INTERSTATE ROUTE H-1 RESURFACING  
Miller Pedestrian Overpass to Kapiolani Interchange  
Federal-Aid Project No. NH-H1-1(279)

Scale: 1" = 40' Date: August 2021

SHEET No. GR15 OF 21 SHEETS





FED. ROAD DIST. NO.	STATE	FED-AID PROJ. NO.	FISCAL YEAR	SHEET NO.	TOTAL SHEETS
HAWAII	HAW.	NH-H1-1(279)	2021	137	304

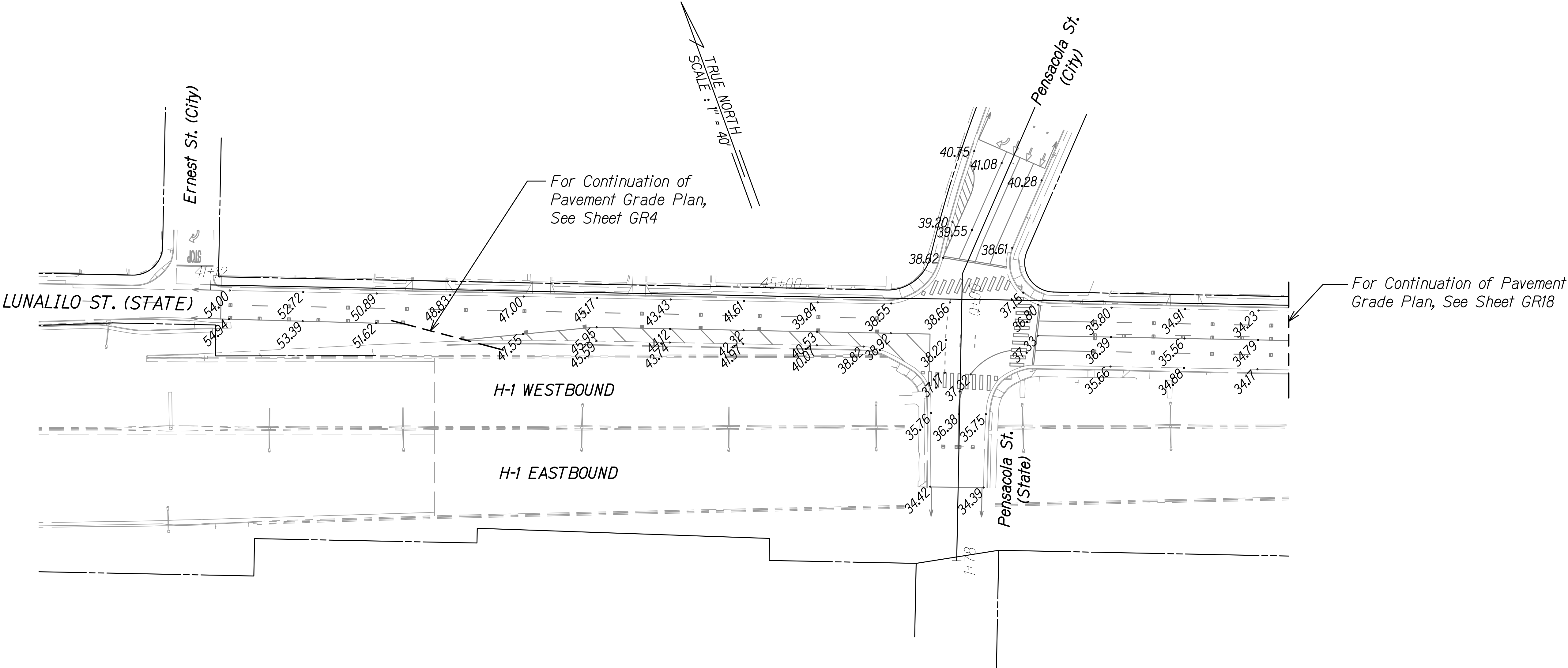

GRAPHIC SCALE:

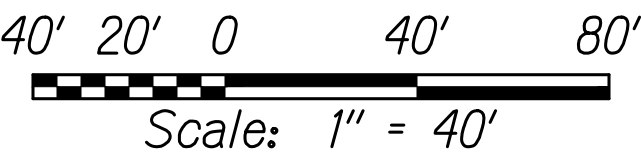

**NOTES:**

1. The source of pavement grades reflected on plans are from Control Point Surveying Inc. dated 08/02/18. The pavement (or finish) grades represent the existing grades and these grades are for informational purposes only. The Contractor shall verify in field.
2. Survey Control Data along with centerline and curve data are shown on Roadway Plans, sheets R1 - R23.
3. The Contractor shall survey and stake out the roadway work in accordance with Section 105.10 Construction Stakes, Lines and Grades from HDOT Standard Specifications.



THIS WORK WAS PREPARED BY ME  
OR UNDER MY SUPERVISION

SIGNATURE

04/30/22  
EXPIRATION DATE  
OF THE LICENSE

STATE OF HAWAII  
DEPARTMENT OF TRANSPORTATION  
HIGHWAYS DIVISION

**PAVEMENT GRADE PLAN 17**

INTERSTATE ROUTE H-1 RESURFACING  
Miller Pedestrian Overpass to Kapiolani Interchange  
Federal-Aid Project No. NH-H1-1(279)

Scale: 1" = 40'      Date: August 2021

SHEET No. **GR17** OF **21** SHEETS

FED. ROAD DIST. NO.	STATE	FED-AID PROJ. NO.	FISCAL YEAR	SHEET NO.	TOTAL SHEETS
HAWAII	HAW.	NH-H1-1(279)	2021	138	304

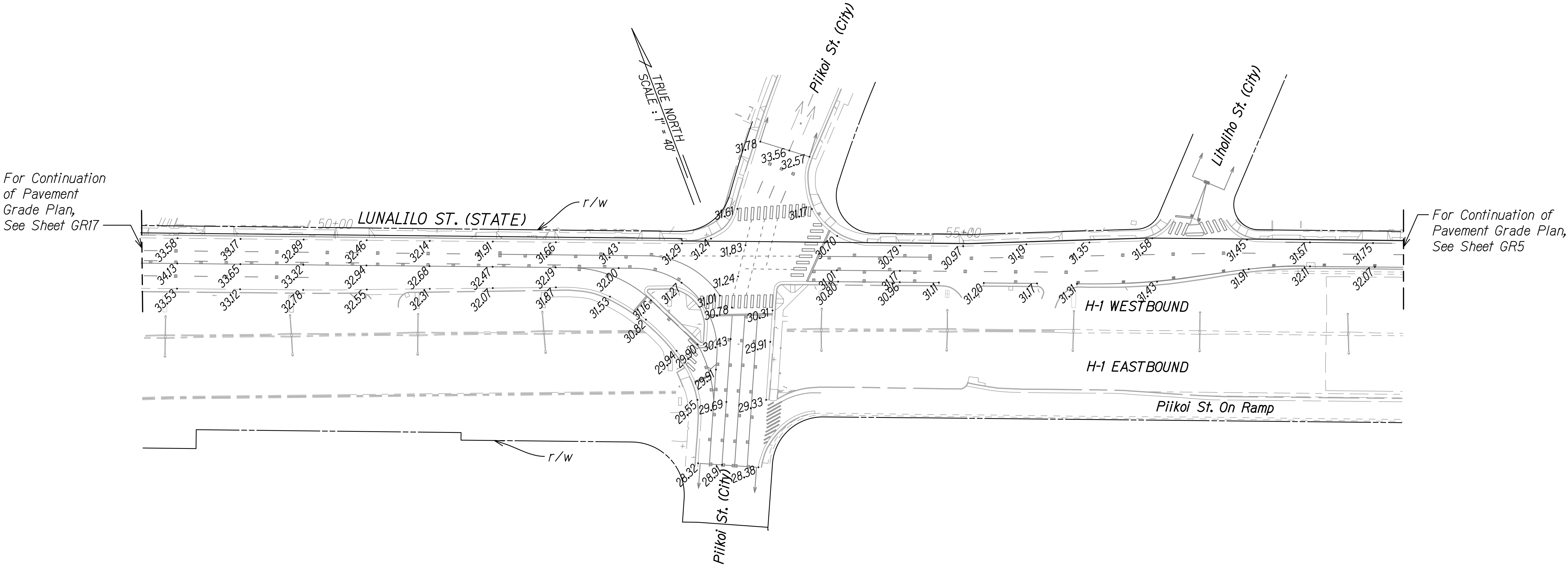

GRAPHIC SCALE:

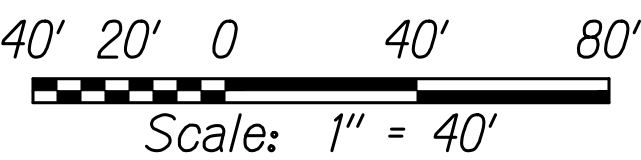

**NOTES:**

1. The source of pavement grades reflected on plans are from Control Point Surveying Inc. dated 08/02/18. The pavement (or finish) grades represent the existing grades and these grades are for informational purposes only. The Contractor shall verify in field.
2. Survey Control Data along with centerline and curve data are shown on Roadway Plans, sheets R1 - R23.
3. The Contractor shall survey and stake out the roadway work in accordance with Section 105.10 Construction Stakes, Lines and Grades from HDOT Standard Specifications.

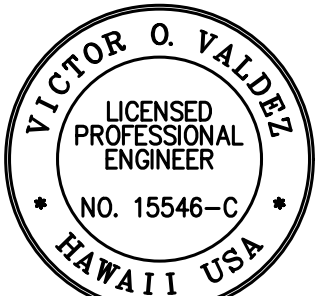

THIS WORK WAS PREPARED BY ME  
OR UNDER MY SUPERVISION

SIGNATURE

04/30/22  
EXPIRATION DATE  
OF THE LICENSE

STATE OF HAWAII  
DEPARTMENT OF TRANSPORTATION  
HIGHWAYS DIVISION

**PAVEMENT GRADE PLAN 18**

INTERSTATE ROUTE H-1 RESURFACING  
Miller Pedestrian Overpass to Kapiolani Interchange  
Federal-Aid Project No. NH-H1-1(279)

Scale: 1" = 40'

Date: August 2021

SHEET No. GR18 OF 21 SHEETS

FED. ROAD DIST. NO.	STATE	FED-AID PROJ. NO.	FISCAL YEAR	SHEET NO.	TOTAL SHEETS
HAWAII	HAW.	NH-H1-1(279)	2021	139	304

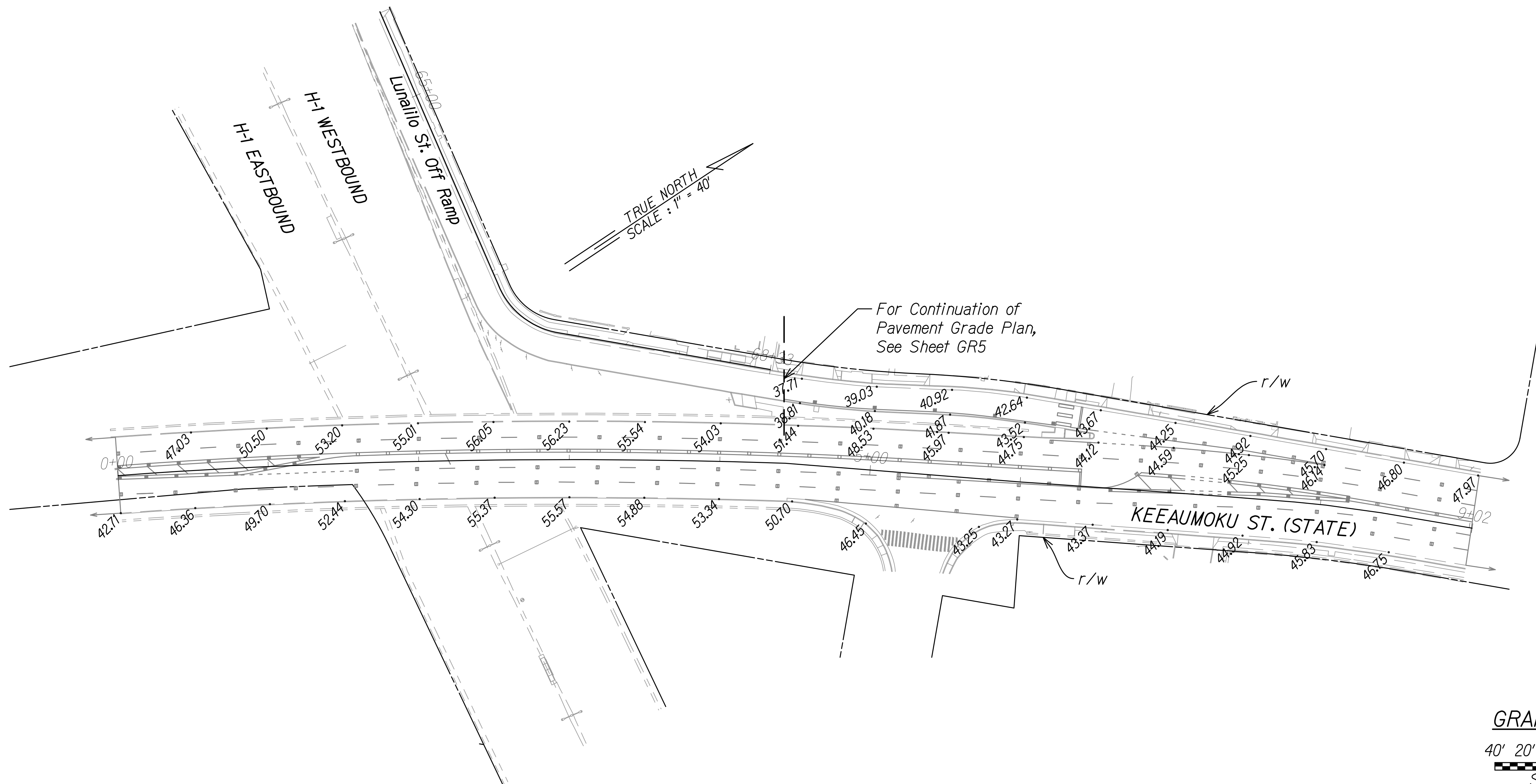

**NOTES:**

1. The source of pavement grades reflected on plans are from Control Point Surveying Inc. dated 08/02/18. The pavement (or finish) grades represent the existing grades and these grades are for informational purposes only. The Contractor shall verify in field.
2. Survey Control Data along with centerline and curve data are shown on Roadway Plans, sheets R1 - R23.
3. The Contractor shall survey and stake out the roadway work in accordance with Section 105.10 Construction Stakes, Lines and Grades from HDOT Standard Specifications.



THIS WORK WAS PREPARED BY ME  
OR UNDER MY SUPERVISION

*[Signature]* 04/30/22  
SIGNATURE EXPIRATION DATE  
OF THE LICENSE

STATE OF HAWAII  
DEPARTMENT OF TRANSPORTATION  
HIGHWAYS DIVISION

**PAVEMENT GRADE PLAN 19**

INTERSTATE ROUTE H-1 RESURFACING  
Miller Pedestrian Overpass to Kapiolani Interchange  
Federal-Aid Project No. NH-H1-1(279)

Scale: 1" = 40' Date: August 2021

SHEET No. GR19 OF 21 SHEETS

FED. ROAD DIST. NO.	STATE	FED-AID PROJ. NO.	FISCAL YEAR	SHEET NO.	TOTAL SHEETS
HAWAII	HAW.	NH-H1-1(279)	2021	140	304

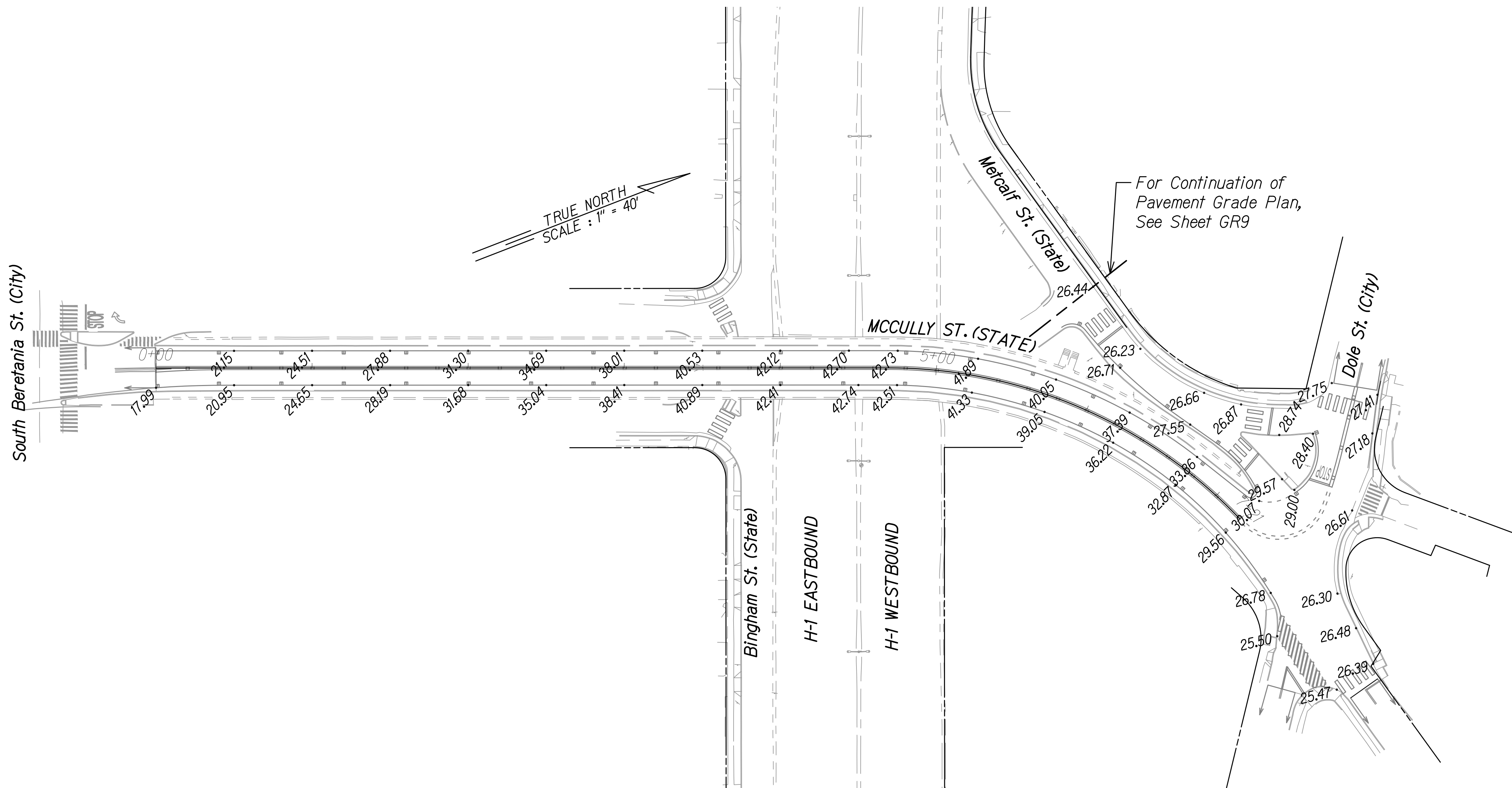

GRAPHIC SCALE:

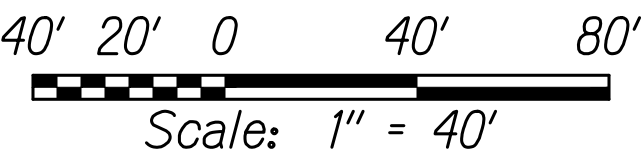

**NOTES:**

1. The source of pavement grades reflected on plans are from Control Point Surveying Inc. dated 08/02/18. The pavement (or finish) grades represent the existing grades and these grades are for informational purposes only. The Contractor shall verify in field.
2. Survey Control Data along with centerline and curve data are shown on Roadway Plans, sheets R1 - R23.
3. The Contractor shall survey and stake out the roadway work in accordance with Section 105.10 Construction Stakes, Lines and Grades from HDOT Standard Specifications.



THIS WORK WAS PREPARED BY ME  
OR UNDER MY SUPERVISION

SIGNATURE

04/30/22  
EXPIRATION DATE  
OF THE LICENSE

STATE OF HAWAII  
DEPARTMENT OF TRANSPORTATION  
HIGHWAYS DIVISION

**PAVEMENT GRADE PLAN 20**

**INTERSTATE ROUTE H-1 RESURFACING**  
**Miller Pedestrian Overpass to Kapiolani Interchange**  
**Federal-Aid Project No. NH-H1-1(279)**

Scale: 1" = 40' Date: August 2021

SHEET No. GR20 OF 21 SHEETS



FED. ROAD DIST. NO.	STATE	FED-AID PROJ. NO.	FISCAL YEAR	SHEET NO.	TOTAL SHEETS
HAWAII	HAW.	NH-H1-1(279)	2021	141	304

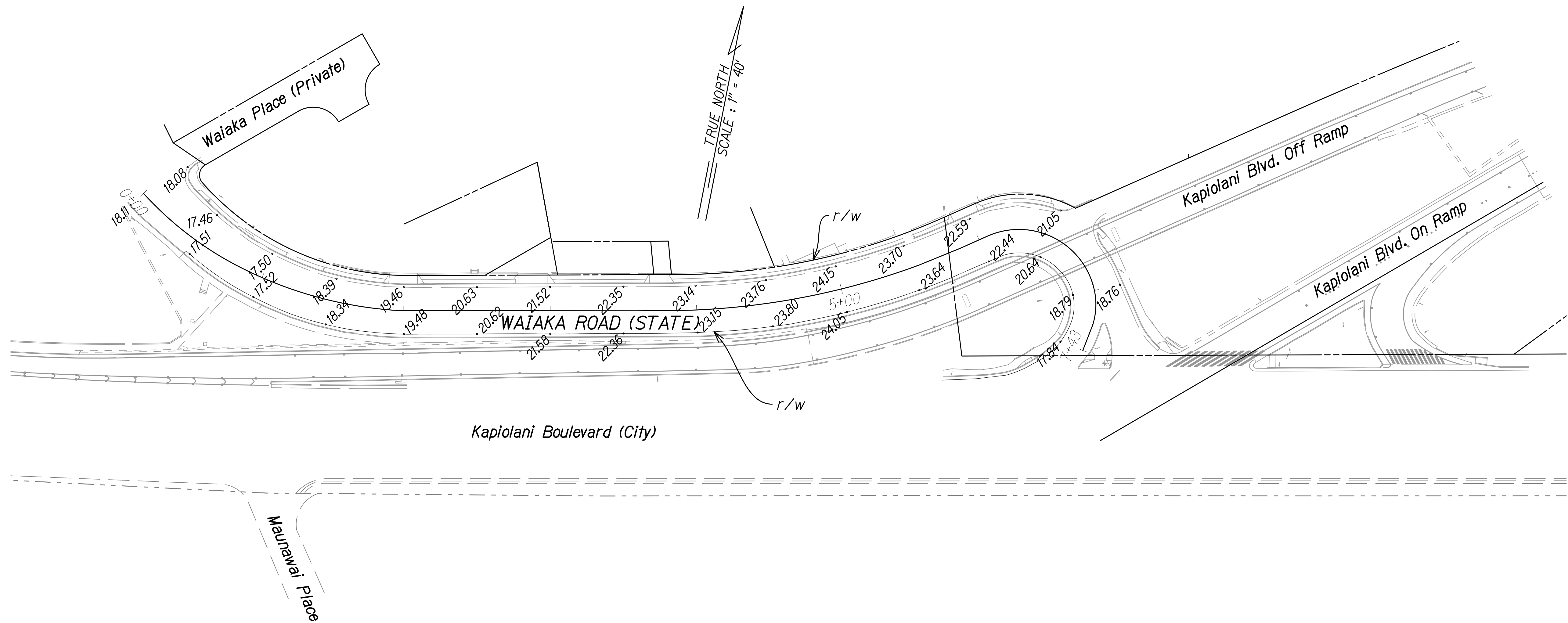

GRAPHIC SCALE:

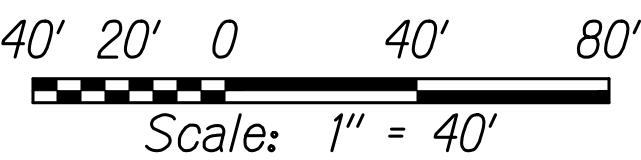

NOTES:

1. The source of pavement grades reflected on plans are from Control Point Surveying Inc. dated 08/02/18. The pavement (or finish) grades represent the existing grades and these grades are for informational purposes only. The Contractor shall verify in field.
2. Survey Control Data along with centerline and curve data are shown on Roadway Plans, sheets R1 - R23.
3. The Contractor shall survey and stake out the roadway work in accordance with Section 105.10 Construction Stakes, Lines and Grades from HDOT Standard Specifications.



THIS WORK WAS PREPARED BY ME  
OR UNDER MY SUPERVISION

SIGNATURE

04/30/22

EXPIRATION DATE  
OF THE LICENSE

STATE OF HAWAII  
DEPARTMENT OF TRANSPORTATION  
HIGHWAYS DIVISION

PAVEMENT GRADE PLAN 21

INTERSTATE ROUTE H-1 RESURFACING  
Miller Pedestrian Overpass to Kapiolani Interchange  
Federal-Aid Project No. NH-H1-1(279)

Scale: 1" = 40'

Date: August 2021

SHEET No. GR21 OF 21 SHEETS