

TRAFFIC CONTROL NOTES:

- The permittee shall make minor adjustments at intersections, driveways, bridges, structures, etc., to fit field conditions.
- Cones or delineators shall be extended to a point where they are visible to approaching traffic.
- Traffic control devices shall be installed such that the sign or device farthest from the work area is placed first. The others shall then be placed progressively toward the work area.
- Regulatory and warning signs within the construction zone that are in conflict with the traffic control plans shall be removed or covered.
- Flaggers and/or police officers shall be in sight of each other or in direct communications at all times.
- When required by the issuing office, the permittee shall install a flashing arrow signal as shown on the traffic control plans.
- All traffic lanes shall be a minimum of 10 feet wide.
- All construction warning signs shall be promptly removed or covered whenever the message is not applicable or not in use.
- The backs of all signs used for traffic control shall be appropriately covered to preclude the display of inapplicable sign message (i.e., when signs have messages on both faces).
- Lane closure shall be limited only to the extent of accomplishing each day's work. As soon as each day's work is completed, the permittee shall remove all traffic control devices no longer needed to permit free and safe passage of public traffic. Removal shall be in the reverse order of installation. Existing faded or obliterated pavement markings that are necessary for safe traffic flow in the construction area shall be replaced with temporary or permanent markings before opening the roadway to public traffic each day.
- Permanent pavement markings and traffic signs shall be placed upon completion of each phase of work.
- Buffer and taper areas on approach to any work shall be kept clear of vehicles and equipment.
- The night construction will be conducted on weekdays only, excluding holidays and furlough Fridays.
- All work zone traffic control devices shall comply with the "State Wide Guideline for Work Zone Traffic Control Devices", Dated September 13, 2000.
- The speed limit of all traffic on the inbound side of viaduct shall be 15 mph during concrete casting until the concrete has obtained a strength of 3,000 psi.
- The speed limit of all traffic on the inbound side of viaduct shall be no more than 25 mph when any work on the inbound side of viaduct is being performed.
- No traffic is allowed within 10' (one lane) of the portion of inbound side of deck being cast until the concrete has obtained 3,000 psi.

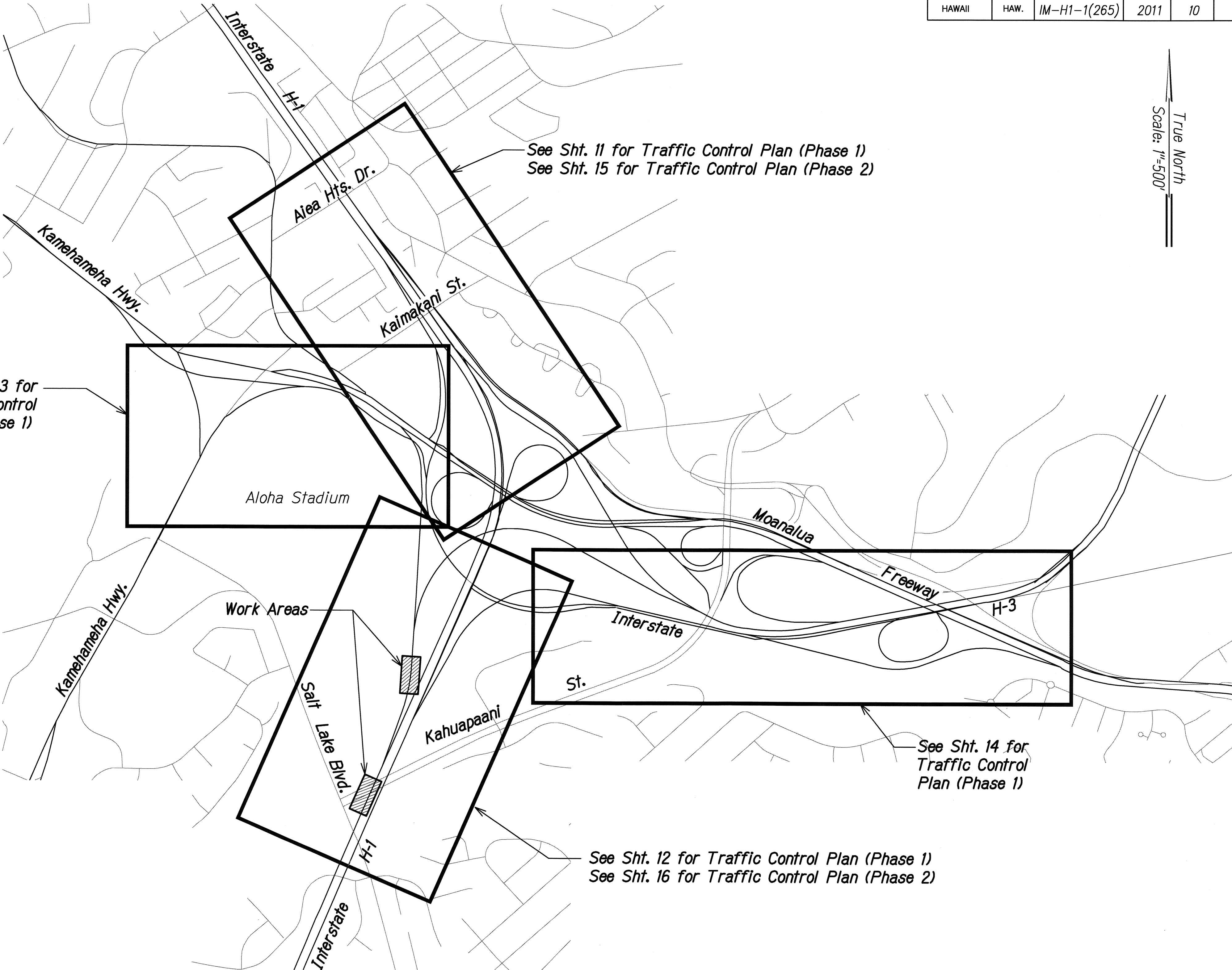

GENERAL TRAFFIC CONTROL PLAN
Scale: 1" = 500'

JARED N. MINURA
LICENSED PROFESSIONAL ENGINEER
No. 13224-C
HAWAII, U.S.A.

LICENSE EXPIRES: 4/30/12
THIS WORK WAS PREPARED BY ME OR UNDER MY SUPERVISION AND CONSTRUCTION OF THIS PROJECT WILL BE UNDER MY OBSERVATION AS DEFINED IN HAW. TITLE 16, CHAPTER 115, RULES OF THE BOARD OF PROFESSIONAL ENGINEERS, ARCHITECTS AND SURVEYORS, STATE OF HAWAII.

STATE OF HAWAII
DEPARTMENT OF TRANSPORTATION
HIGHWAYS DIVISION

GENERAL TRAFFIC CONTROL PLAN

INTERSTATE ROUTE H-1
Salt Lake Viaduct Deck Repair, Eastbound
Federal Aid Project No. IM-H1-1(265)

Scale: AS NOTED Date: May 2011

| | | | | | |
|---------------------|-------|--------------------|-------------|-----------|--------------|
| FED. ROAD DIST. NO. | STATE | FED. AID PROJ. NO. | FISCAL YEAR | SHEET NO. | TOTAL SHEETS |
| HAWAII | HAW. | IM-H1-1(265) | 2011 | 11 | 23 |

True North
Scale: 1"=80'

Alaea Heights Dr.
(Overpass)

MATCH LINE @ STA. 198+00
For Continuation, See Below

To Pearl City

Interstate Route H-1 (Outbound)

Interstate Route H-1 (Inbound)

To Honolulu

2600'

1600'

1000'

Ramp "D"

Ramp "EW"

Kaimakani St.
(Overpass)

Interstate Route H-1 (Outbound)

Interstate Route H-1 (Inbound)

200+00

205+00

210+00

215+00

220+00

222+00

1000'

700' Taper

Ramp "WE"

1400' Buffer

To Kaneohe/Honolulu

Flashing Arrow Board

Police Officer

Moanalua Freeway
(Overpass)

MATCH LINE @ STA. 198+00
For Continuation, See Above

MATCH LINE @ STA. 222+00
For Continuation, See Sheet 12

LEGEND

- ➔ Direction of Traffic Flow
- ◼ Retroreflective Sign
- ▨ Work Area
- ⬇ Flashing Arrow Board
- ⊗ Police Officer

Note:
1. Contractor shall provide regulatory speed reduction warning sign for each change in speed limit.

TRAFFIC CONTROL PLAN
Scale: 1" = 80'

TRAFFIC CONTROL PLAN
Scale: 1" = 80'

INTERSTATE ROUTE H-1
Salt Lake Viaduct Deck Repair, Eastbound
Federal Aid Project No. IM-H1-1(265)
Scale: AS NOTED Date: May 2011

SHEET No. 11 OF 23 SHEETS

11

| FED. ROAD DIST. NO. | STATE | FED. AID PROJ. NO. | FISCAL YEAR | SHEET NO. | TOTAL SHEETS |
|---------------------|-------|--------------------|-------------|-----------|--------------|
| HAWAII | HAW. | IM-H1-1(265) | 2011 | 12 | 23 |

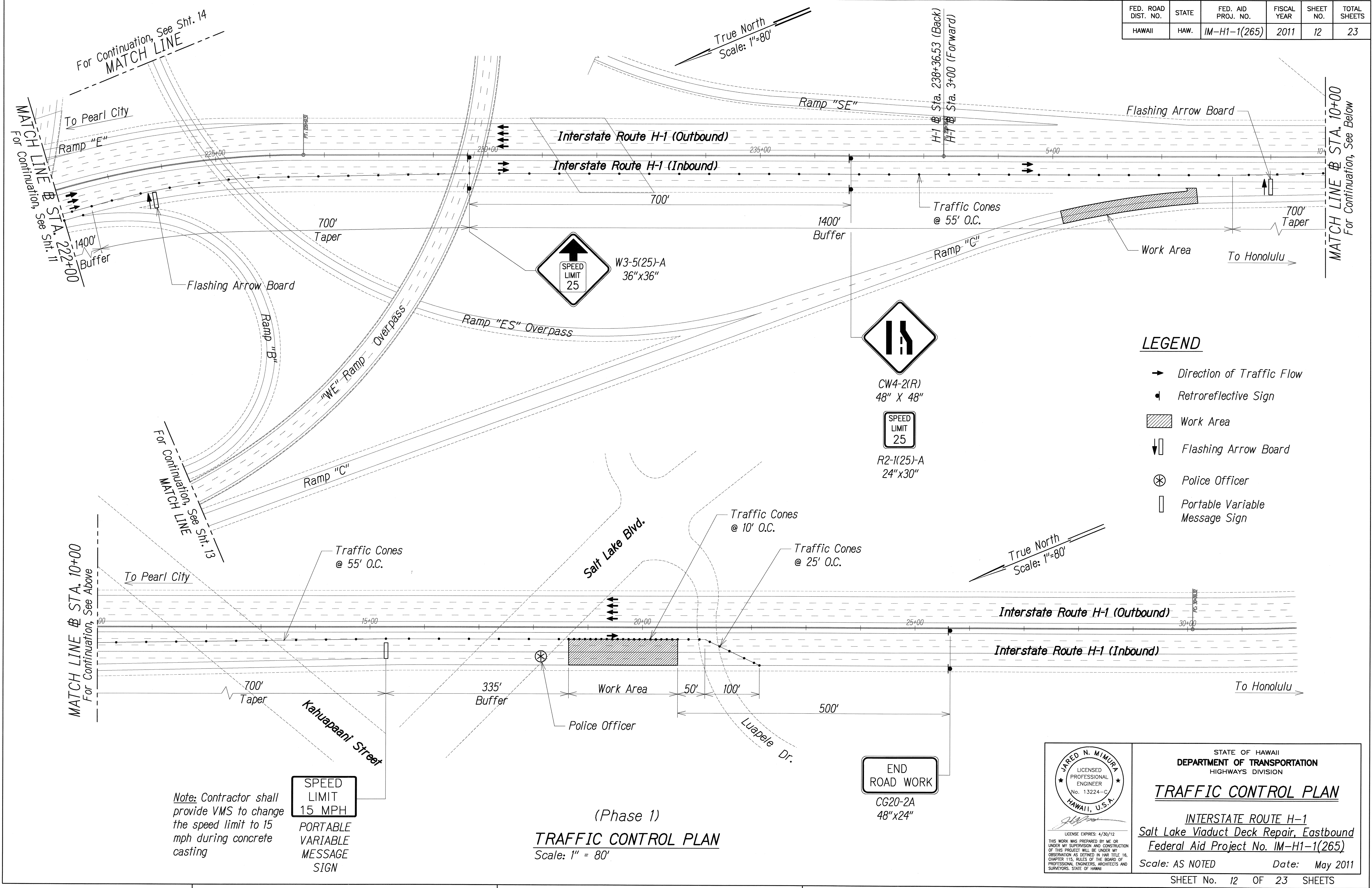

| | |
|-------------------|------|
| SURVEY PLOTTED BY | DATE |
| DESIGNED BY | |
| QUANTITIES BY | |
| CHECKED BY | |
| ORIGINAL PLAN | |
| NOTED | |
| NO. | |

LICENSE EXPIRES: 4/30/12

THIS WORK WAS PREPARED BY ME OR UNDER MY SUPERVISION AND CONSTRUCTION OF THIS PROJECT WILL BE UNDER MY OBSERVATION AS DEFINED IN H.A.R. TITLE 16, CHAPTER 115, RULES OF THE BOARD OF PROFESSIONAL ENGINEERS, ARCHITECTS AND SURVEYORS, STATE OF HAWAII.

STATE OF HAWAII
DEPARTMENT OF TRANSPORTATION
HIGHWAYS DIVISION

TRAFFIC CONTROL PLAN

INTERSTATE ROUTE H-1
Salt Lake Viaduct Deck Repair, Eastbound
Federal Aid Project No. IM-H1-1(265)

Scale: AS NOTED Date: May 2011

| FED. ROAD DIST. NO. | STATE | FED. AID PROJ. NO. | FISCAL YEAR | SHEET NO. | TOTAL SHEETS |
|---------------------|-------|--------------------|-------------|-----------|--------------|
| HAWAII | HAW. | IM-H1-1(265) | 2011 | 13 | 23 |

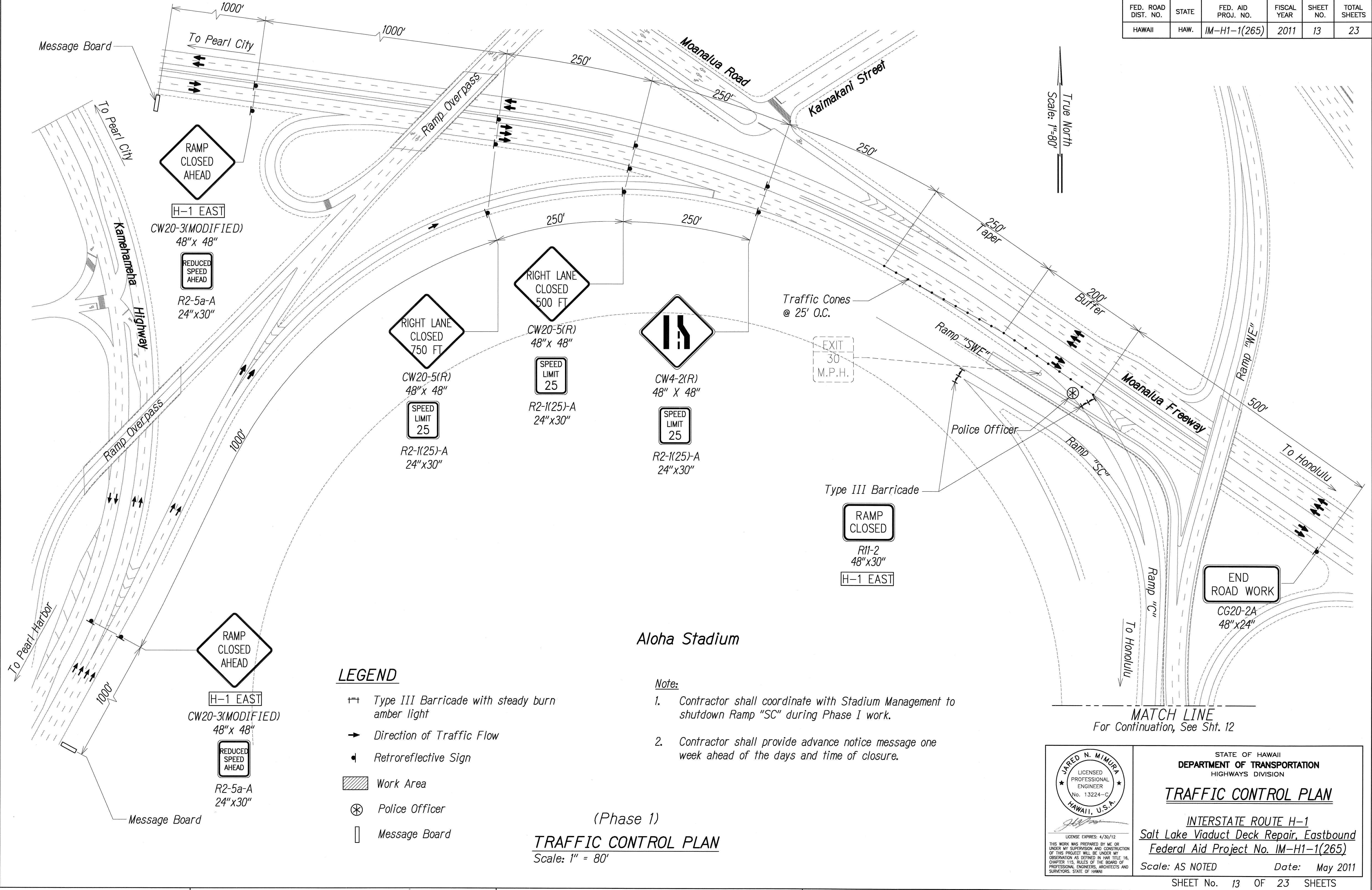

JARED N. MIMURA
LICENSED PROFESSIONAL ENGINEER
No. 13224-C
HAWAII, U.S.A.
LICENSE EXPIRES: 4/30/12
THIS WORK WAS PREPARED BY ME OR UNDER MY SUPERVISION AND CONSTRUCTION OF THIS PROJECT WILL BE UNDER MY OBSERVATION AS DEFINED IN HAW. TITLE 16, CHAPTER 115, RULES OF THE BOARD OF PROFESSIONAL ENGINEERS, ARCHITECTS AND SURVEYORS, STATE OF HAWAII.

STATE OF HAWAII
DEPARTMENT OF TRANSPORTATION
HIGHWAYS DIVISION
TRAFFIC CONTROL PLAN
INTERSTATE ROUTE H-1
Salt Lake Viaduct Deck Repair, Eastbound
Federal Aid Project No. IM-H1-1(265)
Scale: AS NOTED Date: May 2011
SHEET No. 13 OF 23 SHEETS

| FED. ROAD DIST. NO. | STATE | FED. AID PROJ. NO. | FISCAL YEAR | SHEET NO. | TOTAL SHEETS |
|---------------------|-------|--------------------|-------------|-----------|--------------|
| HAWAII | HAW. | IM-H1-1(265) | 2011 | 14 | 23 |

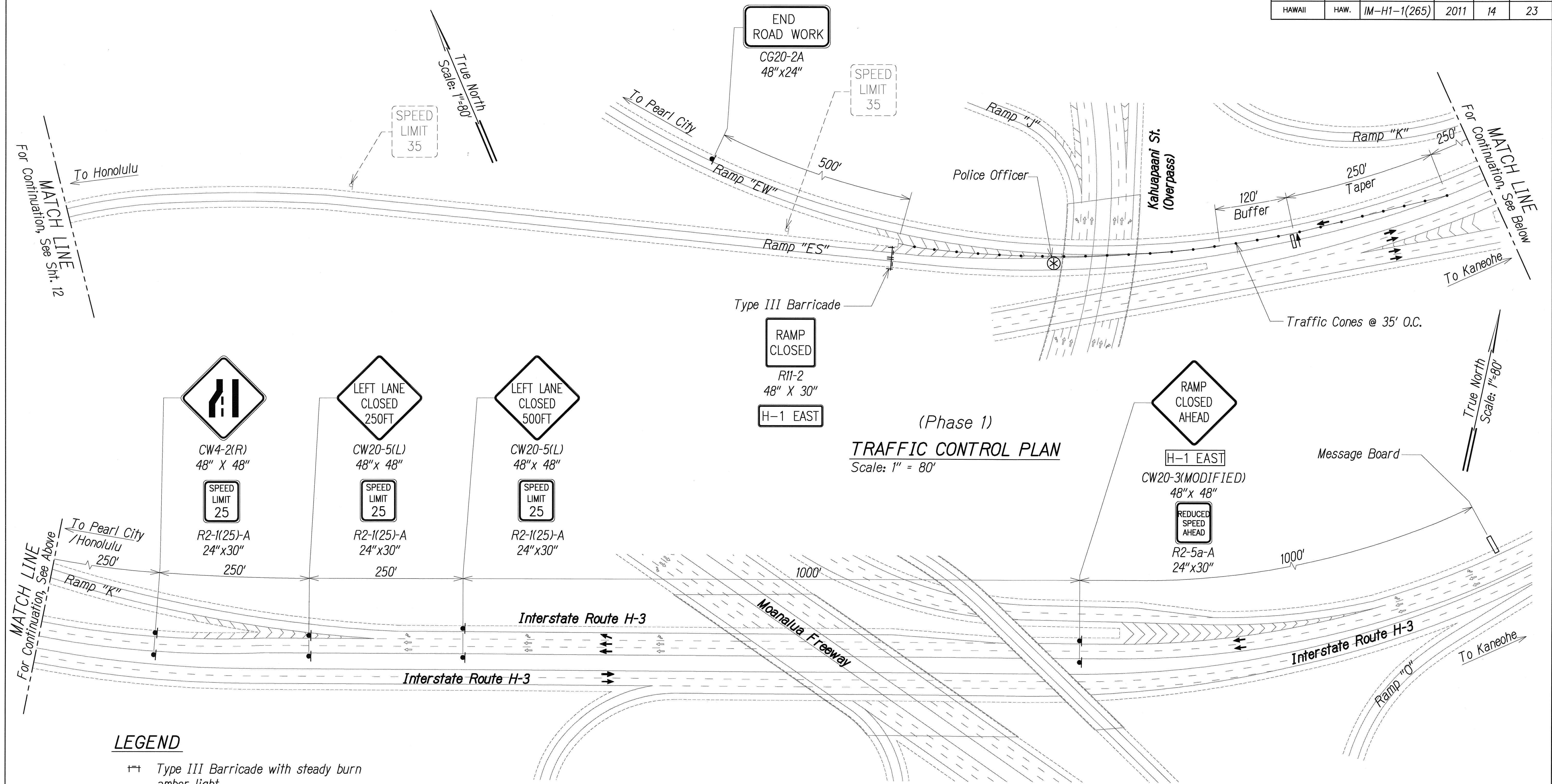

LEGEND

- Type III Barricade with steady burn amber light
- Direction of Traffic Flow
- Retroreflective Sign
- Work Area
- Flashing Arrow Board
- Police Officer
- Message Board

(Phase 1)
TRAFFIC CONTROL PLAN
Scale: 1" = 80'

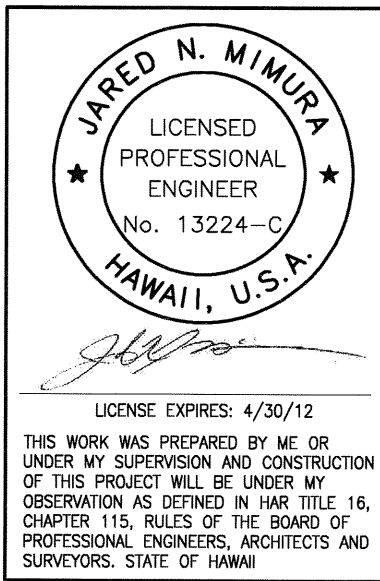

STATE OF HAWAII
DEPARTMENT OF TRANSPORTATION
HIGHWAYS DIVISION

TRAFFIC CONTROL PLAN

INTERSTATE ROUTE H-1
Salt Lake Viaduct Deck Repair, Eastbound
Federal Aid Project No. IM-H1-1(265)

Scale: AS NOTED Date: May 2011

SHEET No. 14 OF 23 SHEETS

| FED. ROAD DIST. NO. | STATE | FED. AID PROJ. NO. | FISCAL YEAR | SHEET NO. | TOTAL SHEETS |
|---------------------|-------|--------------------|-------------|-----------|--------------|
| HAWAII | HAW. | IM-H1-1(265) | 2011 | 15 | 23 |

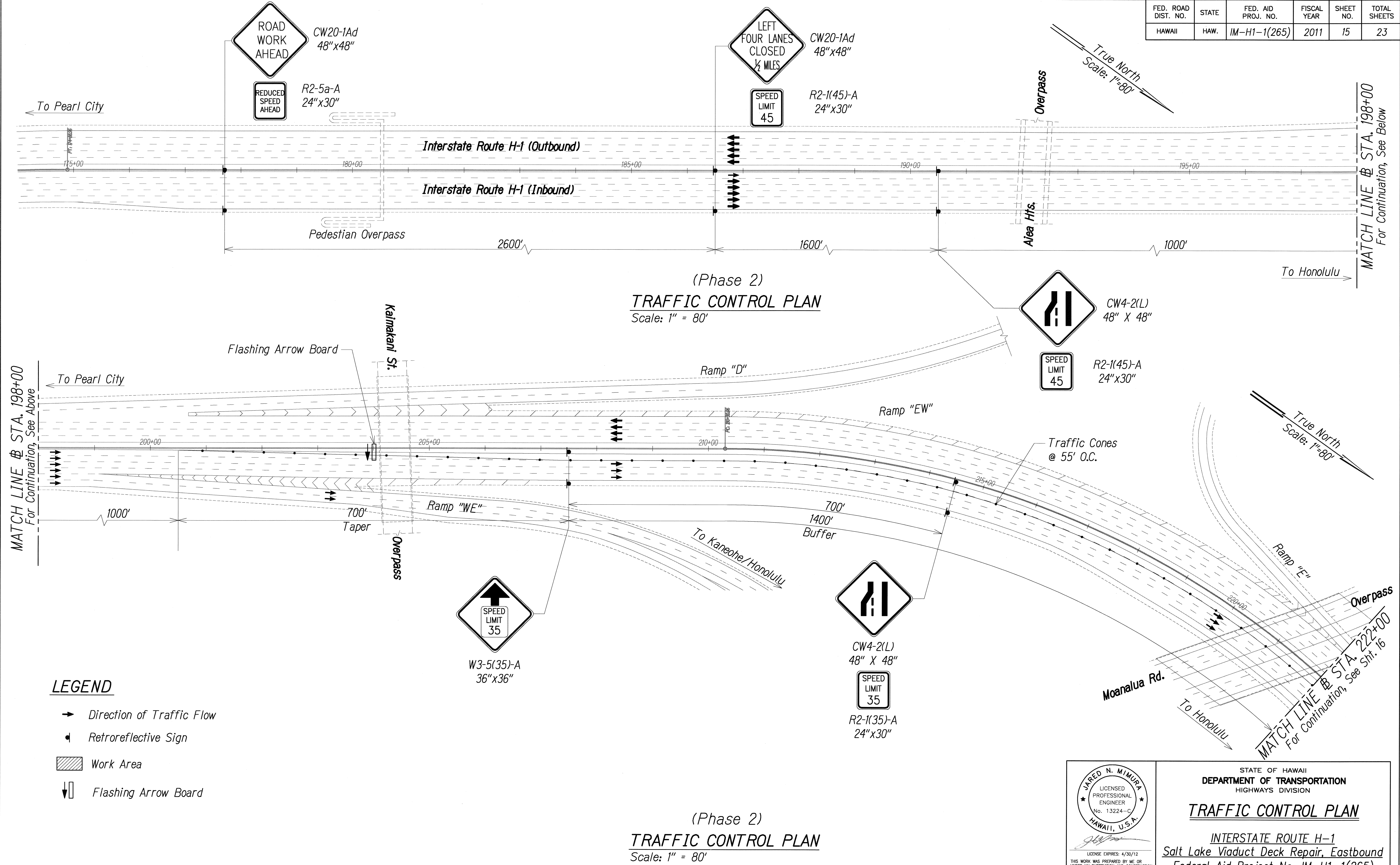

| | |
|---------------|------|
| DATE | ____ |
| DESIGNED BY | ____ |
| TRACED BY | ____ |
| DESIGNED BY | ____ |
| QUANTITIES BY | ____ |
| CHECKED BY | ____ |
| NO. | ____ |

JARED N. MINURA

LICENSED PROFESSIONAL ENGINEER

No. 13224-C

HAWAII, U.S.A.

LICENSE EXPIRES: 4/30/12

THIS WORK WAS PREPARED BY ME OR UNDER MY SUPERVISION AND CONSTRUCTION OF THIS PROJECT WILL BE UNDER MY OBSERVATION AS DEFINED IN HAWAII TITLE 16, CHAPTER 115, RULES OF THE BOARD OF PROFESSIONAL ENGINEERS, ARCHITECTS AND SURVEYORS, STATE OF HAWAII.

STATE OF HAWAII

DEPARTMENT OF TRANSPORTATION

HIGHWAYS DIVISION

TRAFFIC CONTROL PLAN

INTERSTATE ROUTE H-1

Salt Lake Viaduct Deck Repair, Eastbound

Federal Aid Project No. IM-H1-1(265)

Scale: AS NOTED

Date: May 2011

(Phase 2)
TRAFFIC CONTROL PLAN
Scale: 1" = 80'



Note: Contractor shall provide VMS to change the speed limit to 15 mph during concrete casting.

SPEED LIMIT 15 MPH
PORTABLE VARIABLE MESSAGE SIGN

(Phase 2)
TRAFFIC CONTROL PLAN
Scale: 1" = 80'

END ROAD WORK
CG20-2A
48"x24"

JARED N. MIM
LICENSED PROFESSIONAL ENGINEER
No. 13224-C
HAWAII, U.S.
LICENSE EXPIRES: 4/30/2025

- ➔ *Direction of Traffic Flow*
- ⬆ *Retroreflective Sign*
-  *Work Area*
-  *Flashing Arrow Board*
- ⊗ *Police Officer*
-  *Portable Variable Message Sign*

True North
Scale: 1"=80'

JARED N. MIMURA

LICENSED
PROFESSIONAL
ENGINEER

No. 13224-C

HAWAII, U.S.A.

J. Mimura

LICENSE EXPIRES: 4/30/12

THIS WORK WAS PROVIDED BY ME OR
UNDER MY SUPERVISION AND CONSTRUCTION
OF THIS PROJECT WILL BE UNDER MY
OBSERVATION AS DEFINED IN HAWAII TITLE 16,
CHAPTER 165, RULES OF THE BOARD OF
PROFESSIONAL ENGINEERS, ARCHITECTS AND
SURVEYORS, STATE OF HAWAII

STATE OF HAWAII
DEPARTMENT OF TRANSPORTATION
HIGHWAYS DIVISION

TRAFFIC CONTROL PLAN

INTERSTATE ROUTE H-1
Salt Lake Viaduct Deck Repair, Eastbound
Federal Aid Project No. 1M-H1-1(265)

Scale: AS NOTED Date: May 2011

| FED. ROAD DIST. NO. | STATE | FED. AID PROJ. NO. | FISCAL YEAR | SHEET NO. | TOTAL SHEETS |
|---------------------|-------|--------------------|-------------|-----------|--------------|
| HAWAII | HAW. | IM-H1-1(265) | 2011 | 17 | 23 |





DETOUR NOTES:

- Markers prefixed with "IM" shall have a white legend on a blue background except the Interstate shield which shall be a red, white and blue design.
- Markers prefixed with "C" shall have a black legend on orange background.
- Contractor to provide up to 3 (one per approach) changeable message boards per each road/ ramp closure as part of the traffic control lump sum item. Message boards shall be set up one week prior to any road/ ramp closure at the location specified by the Engineer.
- In addition to the detour signs shown on this plan, Contractor shall install appropriate traffic controls for each road/ ramp closure.
- Contractor shall furnish a minimum of one (1) uniformed police officer with vehicle equipped with blue strobe light at each roadway approach to the road/ ramp closure area.
- The Contractor shall publish "Notice to Motorists" 1 week prior to the start of construction. Public notice shall be coordinated with the Department of Transportation, Highways Division.

DETOUR ROUTE PLAN
Scale: 1" = 1000'

1





CW20-2
(36"x36")

IM3-4
(24"x12")

IM-1(H1)
(24"x24")

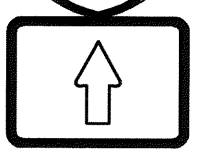
2





CM4-8
(24"x12")

IM3-4
(24"x12")

IM-1(H1)
(24"x24")

IM6-3
(21"x15")

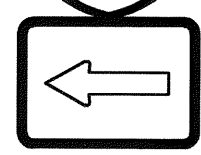
3

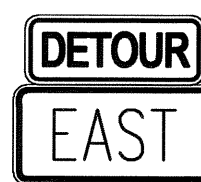



CM4-8
(24"x12")

IM3-4
(24"x12")

IM-1(H1)
(24"x24")

IM6-3(L)
(21"x15")

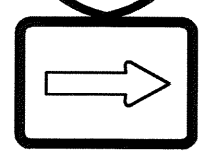
4





CM4-8
(24"x12")

IM3-4
(24"x12")

IM-1(H1)
(24"x24")

IM6-3(R)
(21"x15")

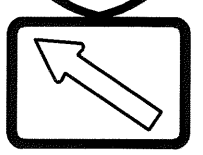
5





CM4-8
(24"x12")

IM3-4
(24"x12")

IM-1(H1)
(24"x24")

IM6-2(L)
(21"x15")

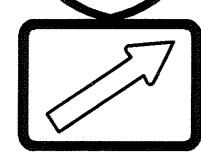
6

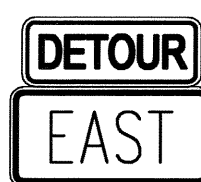



CM4-8
(24"x12")

IM3-4
(24"x12")

IM-1(H1)
(24"x24")

IM6-2(R)
(21"x15")

7



CM4-8
(24"x12")

IM3-4
(24"x12")

IM-1(H1)
(24"x24")

IM4-6
(24"x12")

| | |
|-------------------|------|
| SURVEY PLOTTED BY | DATE |
| DESIGNED BY | |
| NOTED BY | |
| QUANTITIES BY | |
| CHECKED BY | |
| NO. | |

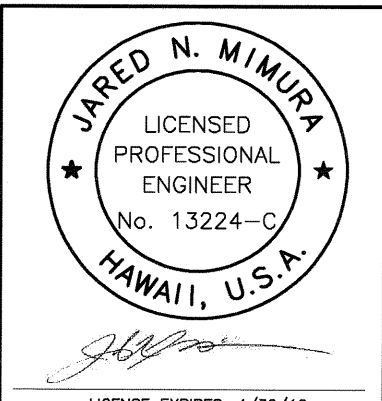

LICENSE EXPIRES: 4/30/12

THIS WORK WAS PREPARED BY ME OR UNDER MY SUPERVISION AND CONSTRUCTION OF THIS PROJECT WILL BE UNDER MY OBSERVATION AS DEFINED IN HAWAII TITLE 16, CHAPTER 115, RULES OF THE BOARD OF PROFESSIONAL ENGINEERS, ARCHITECTS AND SURVEYORS, STATE OF HAWAII.

STATE OF HAWAII
DEPARTMENT OF TRANSPORTATION
HIGHWAYS DIVISION

DETOUR ROUTE PLAN

INTERSTATE ROUTE H-1
Salt Lake Viaduct Deck Repair, Eastbound
Federal Aid Project No. IM-H1-1(265)

Scale: AS NOTED Date: May 2011

SHEET No. 17 OF 23 SHEETS