

INDEX TO DRAWINGS	
SHEET NO.	DESCRIPTION
2	TITLE SHEET
3	STANDARD PLANS SUMMARY
4	GENERAL NOTES & LEGEND
5 - 6	WATER POLLUTION & EROSION CONTROL NOTES
7	ROADWAY PLAN
8	LANDSCAPING DETAILS
9 - 42	STRUCTURAL PLANS
43 - 50	TRAFFIC PLANS
51 - 55	ELECTRICAL PLANS

FED. ROAD DIST. NO.	STATE	FED. AID PROJ. NO.	FISCAL YEAR	SHEET NO.	TOTAL SHEETS
HAWAII	HAW.	H1I-01-08	2009	2	73

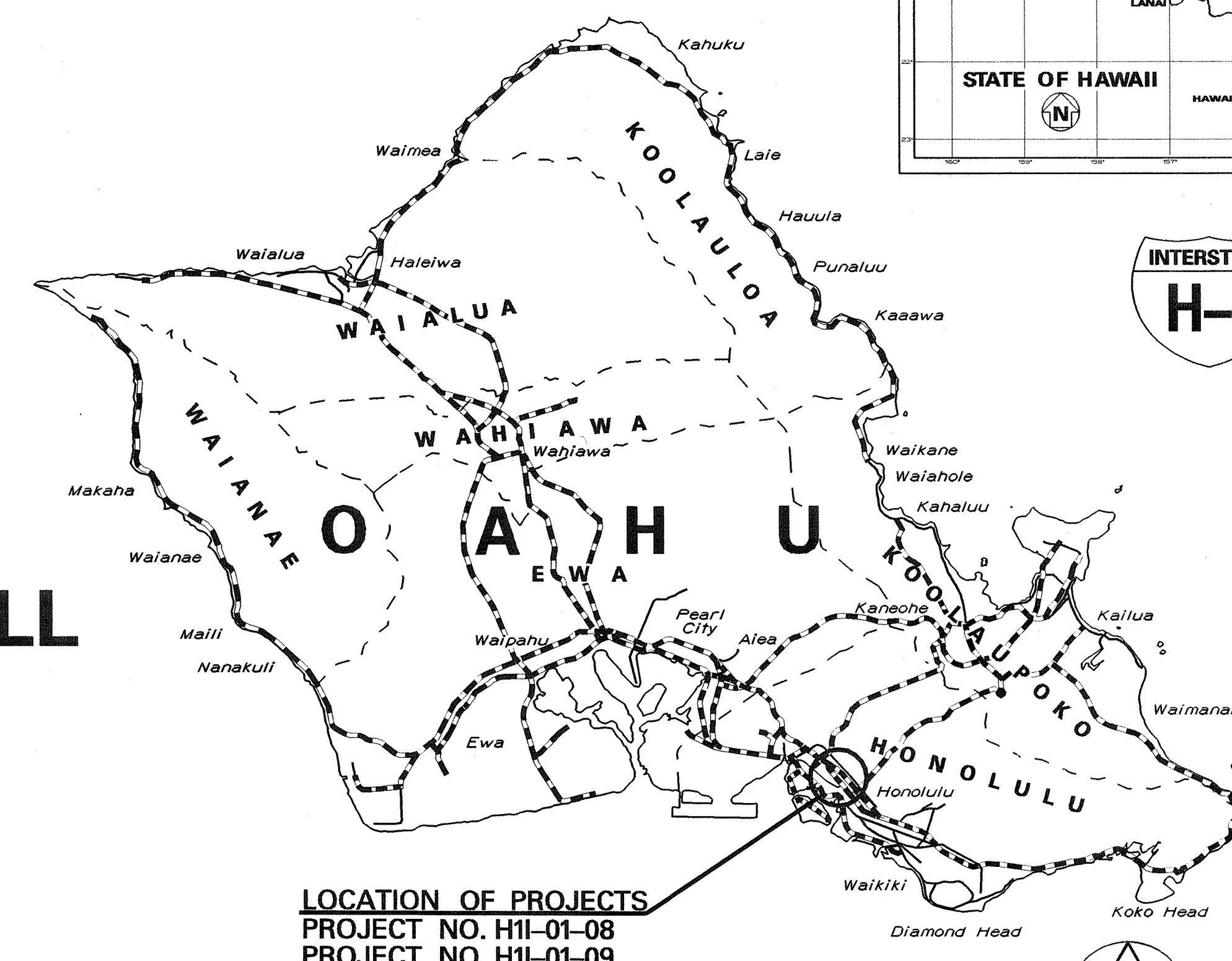

LOCATION OF PROJECTS
PROJECT NO. H1I-01-08
PROJECT NO. H1I-01-09

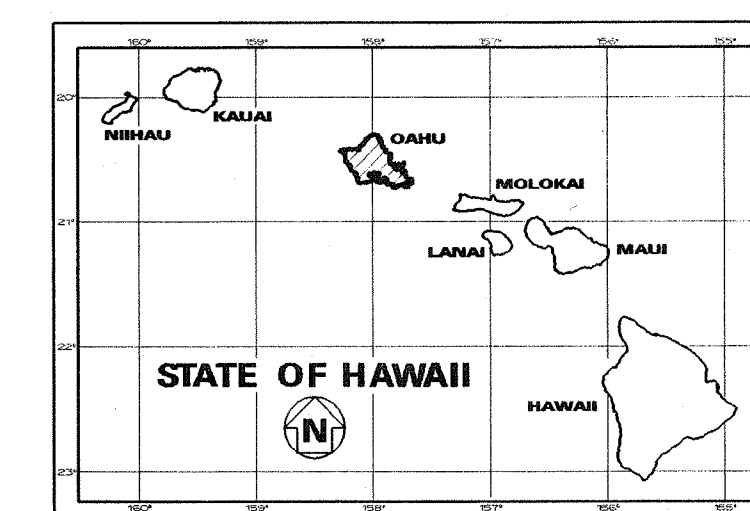
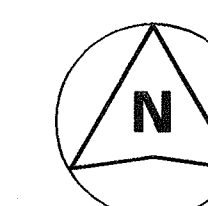

SCALE IN MILES

----- FEDERAL AID PROJECTS PREVIOUSLY CONSTRUCTED
OR UNDER CONSTRUCTION

MILE POST 20.75 TO MILE POST 20.88

CHANGES MADE DURING CONSTRUCTION HAVE BEEN
INCORPORATED ON THESE PLANS EXCEPT CHANGES
IN THE ORIGINAL THEORETICAL QUANTITIES. FOR
ACTUAL QUANTITIES, REFER TO PROJECT LEDGER
AND/OR COMPUTATION BOOK.

Samuel P. Pimenta 3/21/13
RESIDENT ENGINEER DATE

DEPARTMENT OF TRANSPORTATION
STATE OF HAWAII
APPROVED:
David M. Goss 3-17-09
DIR. OF TRANSPORTATION DATE

STATE OF HAWAII
DEPARTMENT OF TRANSPORTATION
HIGHWAYS DIVISION
HONOLULU, HAWAII
"AS-BUILT"
PLANS FOR

**INTERSTATE ROUTE H-1
EXTENSION AND REPAIR OF
SCHOOL STREET ON-RAMP RETAINING WALL
PROJECT NO. H1I-01-08**

DISTRICT OF HONOLULU
ISLAND OF OAHU

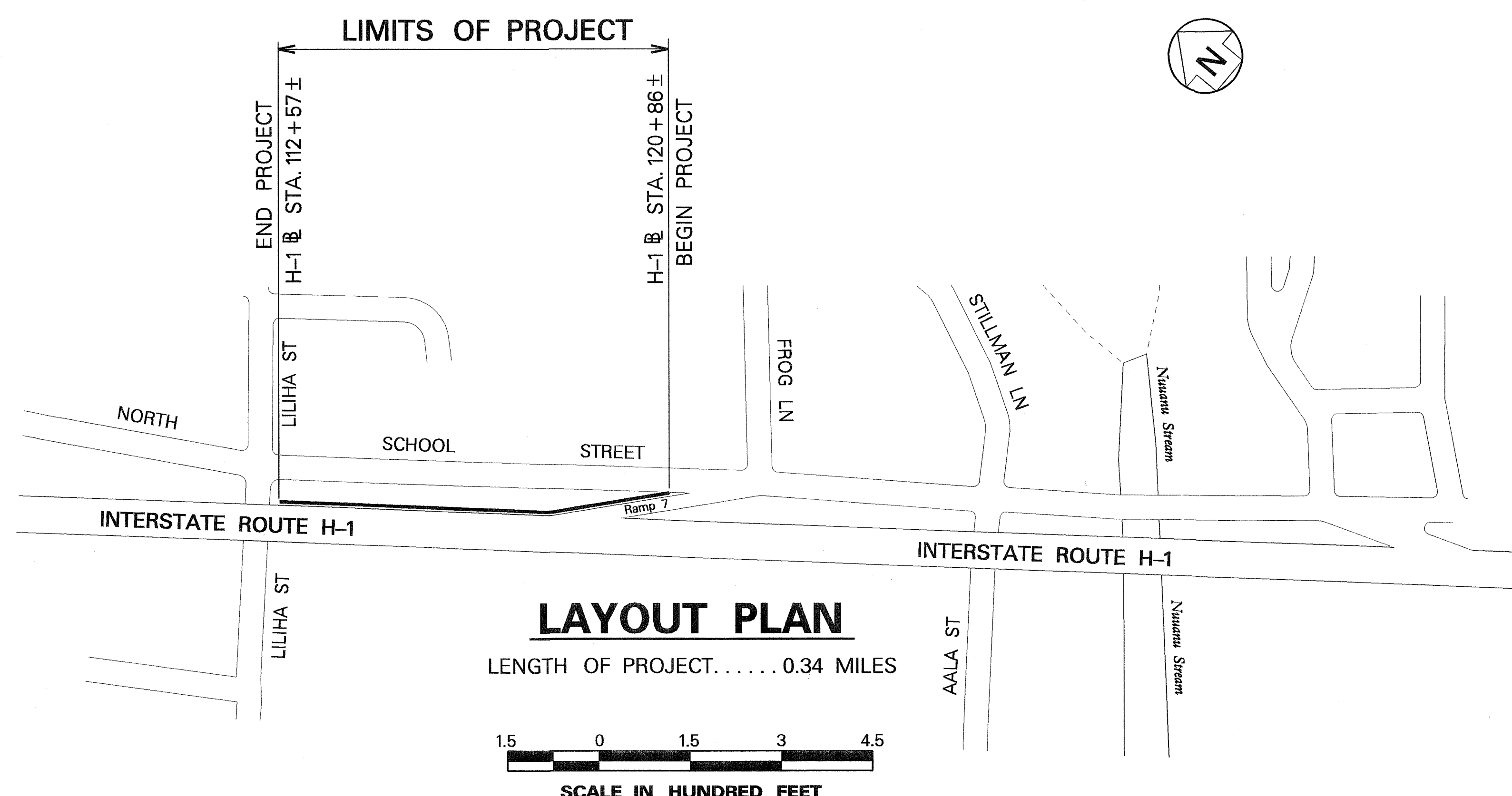

LAYOUT PLAN

LENGTH OF PROJECT..... 0.34 MILES

SCALE IN HUNDRED FEET

HWY-D
DESIGNED BY
HWY-DD
MANAGED BY
692-7570
PHONE
Mar. 2009
DATE