

FED. ROAD DIST. NO.	STATE	PROJ. NO.	FISCAL YEAR	SHEET NO.	TOTAL SHEETS
HAWAII	HAW.	IM-HI-1(255)	2006	23	40

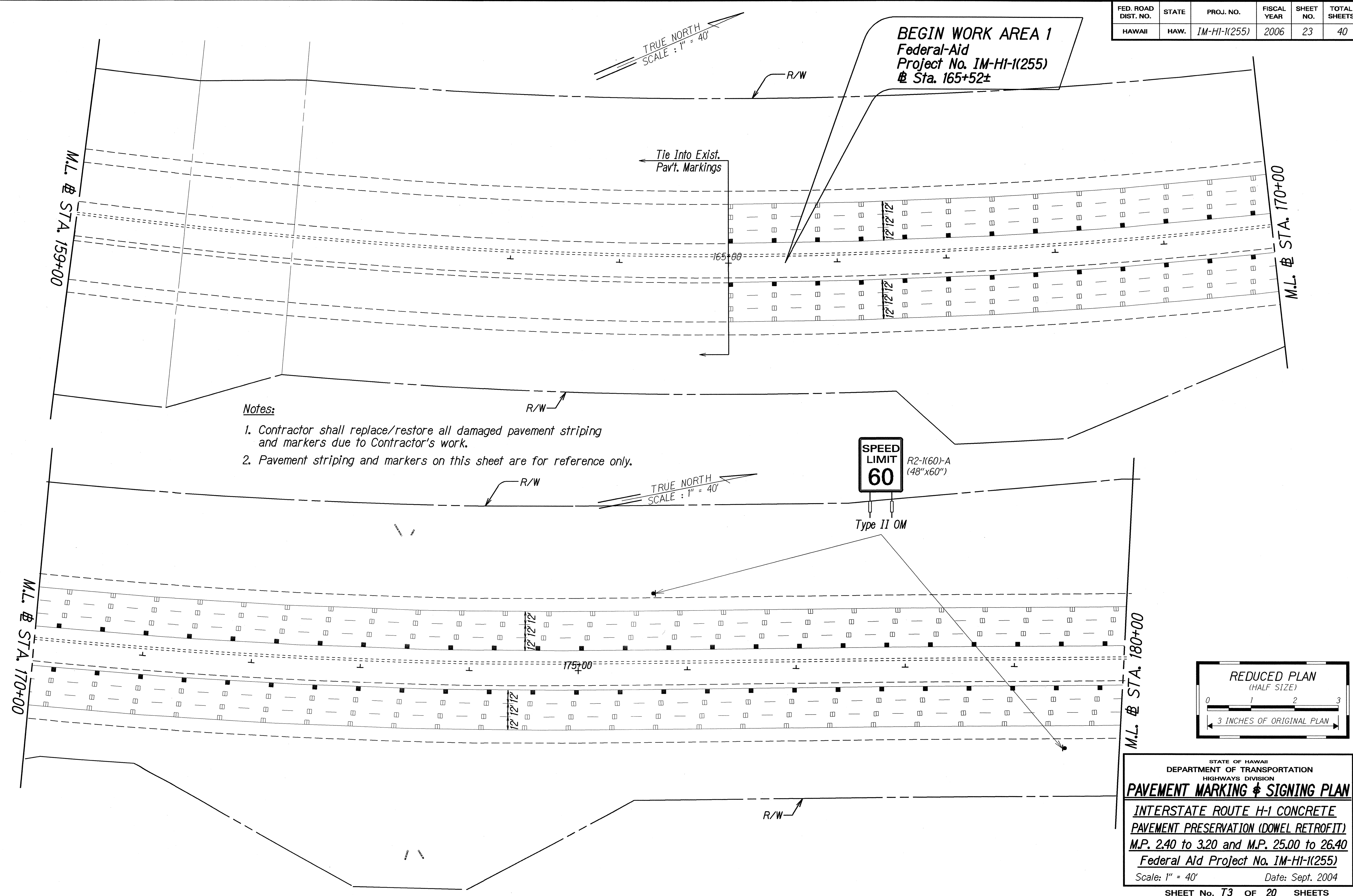

ORIGINAL PLAN	DATE
DESIGNED BY	
CHECKED BY	
DATE	

FED. ROAD DIST. NO.	STATE	PROJ. NO.	FISCAL YEAR	SHEET NO.	TOTAL SHEETS
HAWAII	HAW.	IM-HI-1(255)	2006	24	40

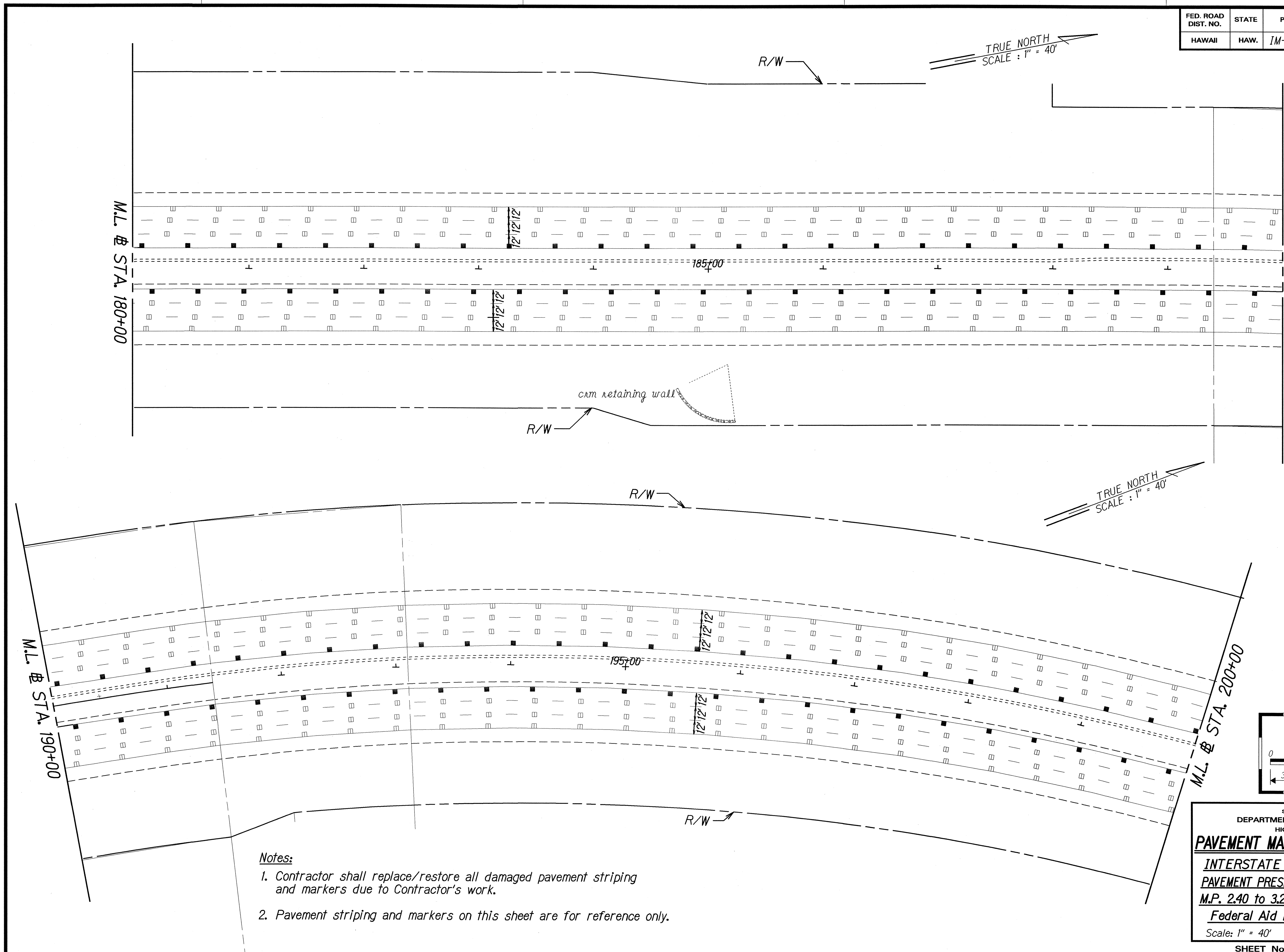

ORIGINAL PLAN	DATE
NOTES	
DESIGNED BY	
QUANTITIES BY	
CHECKED BY	

- Notes:**
1. Contractor shall replace/restore all damaged pavement striping and markers due to Contractor's work.
 2. Pavement striping and markers on this sheet are for reference only.



STATE OF HAWAII
DEPARTMENT OF TRANSPORTATION
HIGHWAYS DIVISION

PAVEMENT MARKING & SIGNING PLAN

**INTERSTATE ROUTE H-1 CONCRETE
PAVEMENT PRESERVATION (DOWEL RETROFIT)**
M.P. 2.40 to 3.20 and M.P. 25.00 to 26.40
Federal Aid Project No. IM-HI-1(255)

Scale: 1" = 40' Date: Sept. 2004

SHEET No. T4 OF 20 SHEETS

FED. ROAD DIST. NO.	STATE	PROJ. NO.	FISCAL YEAR	SHEET NO.	TOTAL SHEETS
HAWAII	HAW.	IM-HI-1(255)	2006	26	40

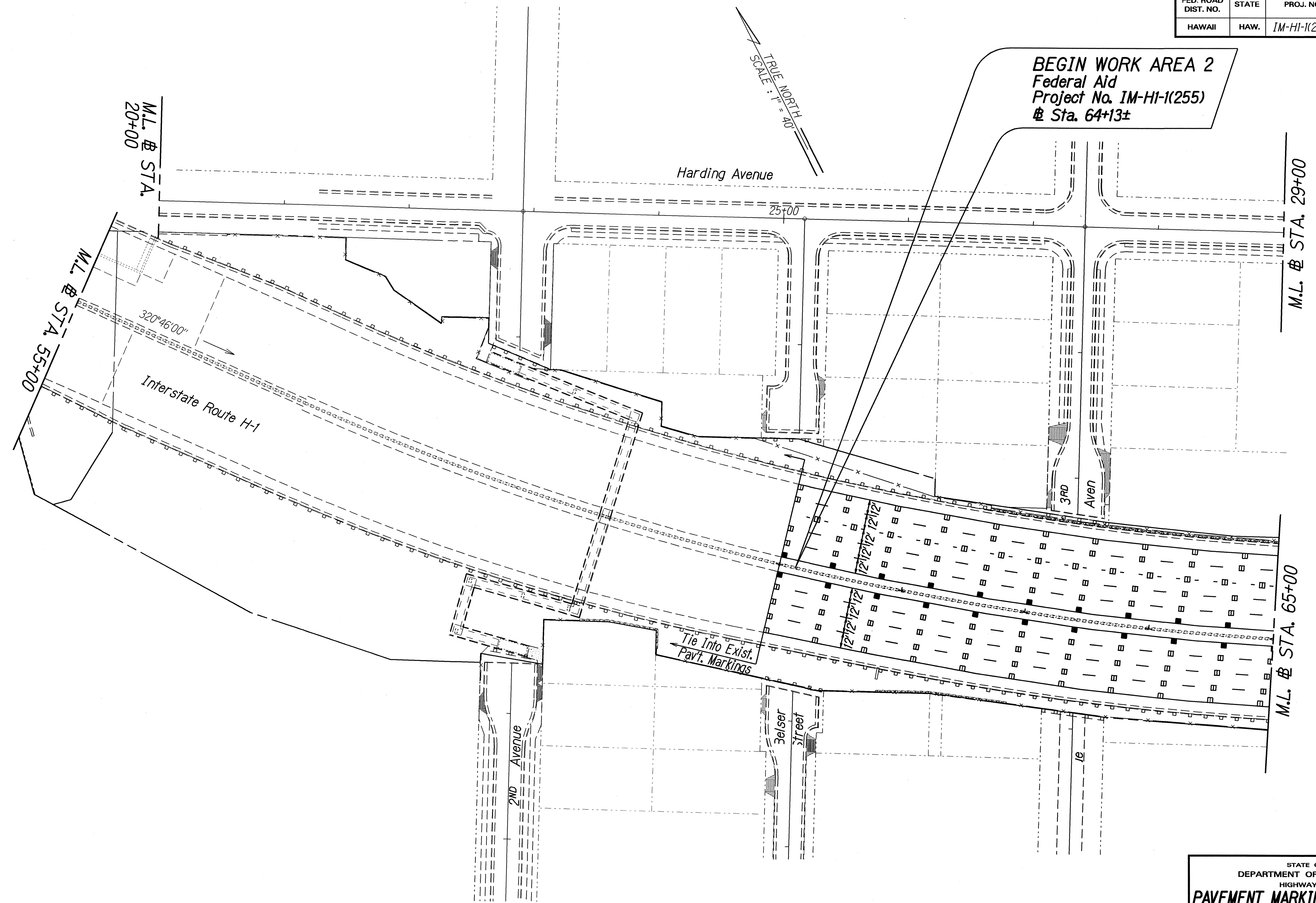

ORIGINAL PLAN	DATE
NOTED BY	
DESIGNED BY	
QUANTITIES BY	
CHECKED BY	

STATE OF HAWAII
DEPARTMENT OF TRANSPORTATION
HIGHWAYS DIVISION
PAVEMENT MARKING & SIGNING PLAN
INTERSTATE ROUTE H-1 CONCRETE
PAVEMENT PRESERVATION (DOWEL RETROFIT)
M.P. 2.40 to 3.20 and M.P. 25.00 to 26.40
Federal Aid Project No. IM-HI-1(255)
Scale: 1" = 40' Date: Sept. 2004
SHEET No. T6 OF 20 SHEETS

FED. ROAD DIST. NO.	STATE	PROJ. NO.	FISCAL YEAR	SHEET NO.	TOTAL SHEETS
HAWAII	HAW.	IM-HI-1(255)	2006	27	40

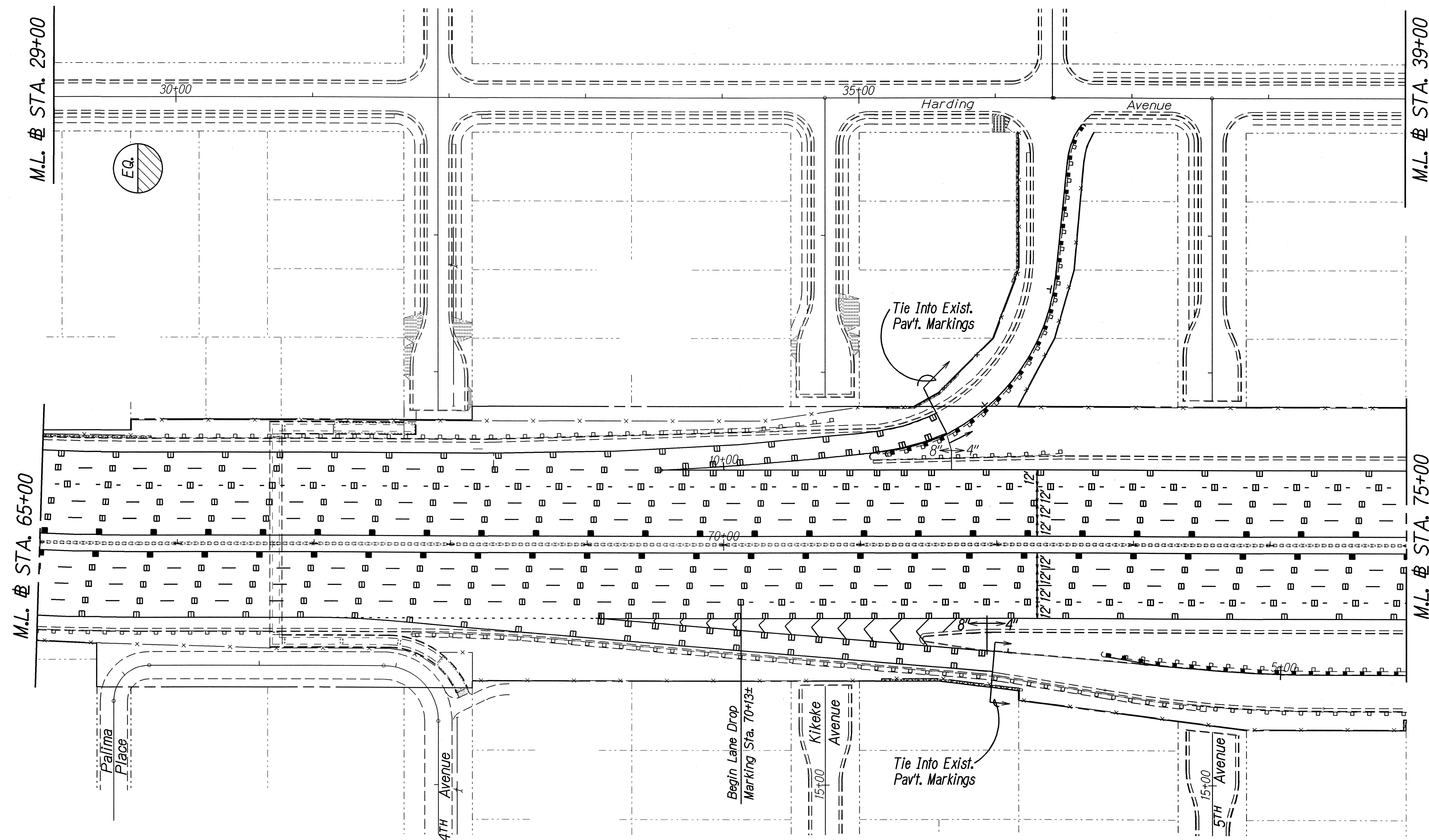

ORIGINAL PLAN	DATE	
DESIGNED BY		
TRACED BY		
DESIGNED BY		
QUANTITIES BY		
CHECKED BY		

STATE OF HAWAII
DEPARTMENT OF TRANSPORTATION
HIGHWAYS DIVISION
PAVEMENT MARKING & SIGNING PLAN
INTERSTATE ROUTE H-1 CONCRETE
PAVEMENT PRESERVATION (DOWEL RETROFIT)
M.P. 2.40 to 3.20 and M.P. 25.00 to 26.40
Federal Aid Project No. IM-HI-1(255)
Scale: 1" = 40' Date: Sept. 2004

FED. ROAD DIST. NO.	STATE	PROJ. NO.	FISCAL YEAR	SHEET NO.	TOTAL SHEETS
HAWAII	HAW.	IM-HI-1(255)	2006	28	40

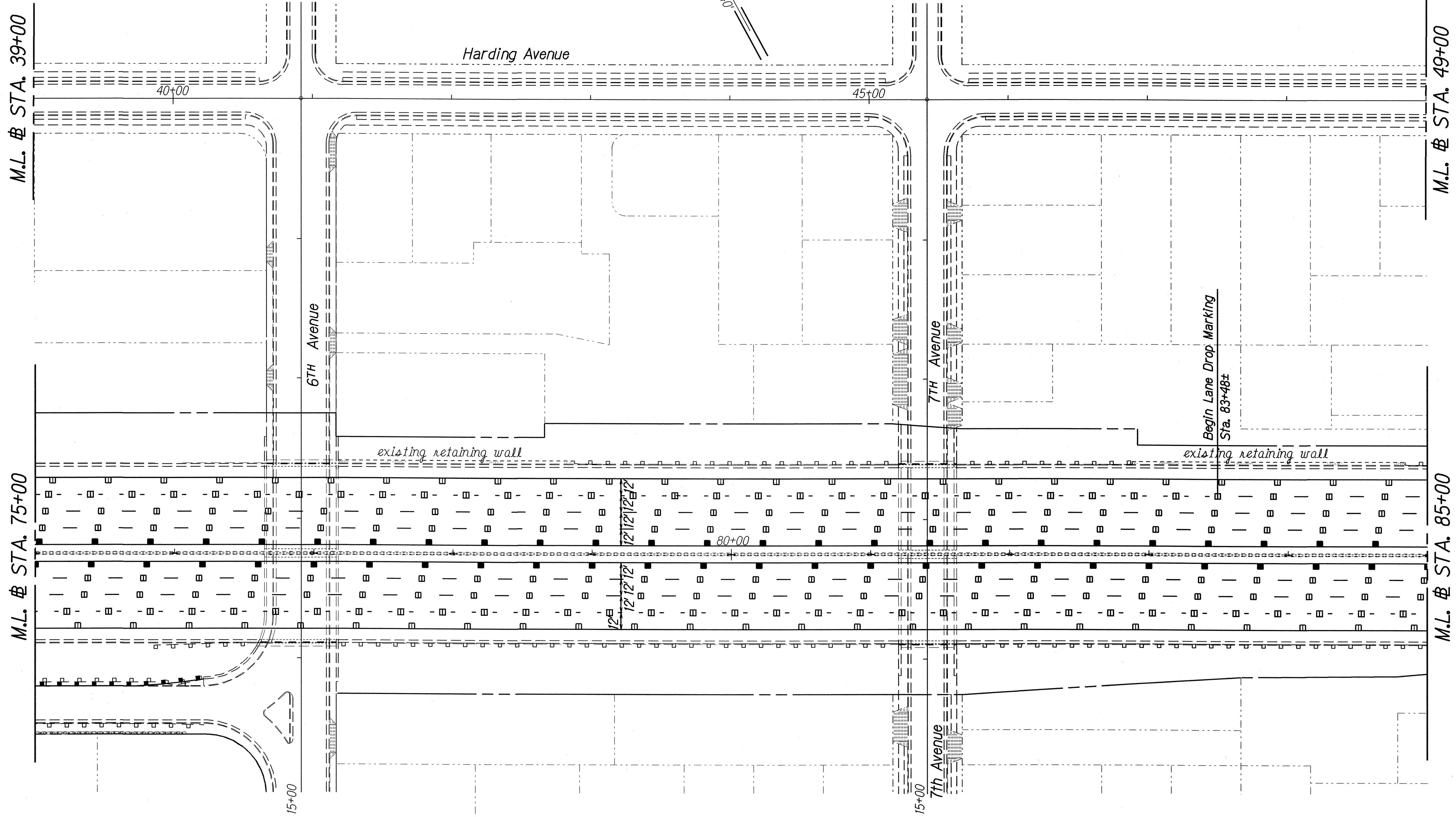

DESIGNED BY	DATE
TRACED BY	
DESIGNED BY	
QUANTITIES BY	
CHECKED BY	

STATE OF HAWAII
DEPARTMENT OF TRANSPORTATION
HIGHWAYS DIVISION

PAVEMENT MARKING & SIGNING PLAN

*INTERSTATE ROUTE H-1 CONCRETE
PAVEMENT PRESERVATION (DOWEL RETROFIT)*

M.P. 2.40 to 3.20 and M.P. 25.00 to 26.40

Federal Aid Project No. IM-HI-1(255)

Scale: 1" = 40' Date: Sept. 2004

SHEET No. 28 OF 20 SHEETS

FED. ROAD DIST. NO.	STATE	PROJ. NO.	FISCAL YEAR	SHEET NO.	TOTAL SHEETS
HAWAII	HAW.	IM-HI-1(255)	2006	29	40

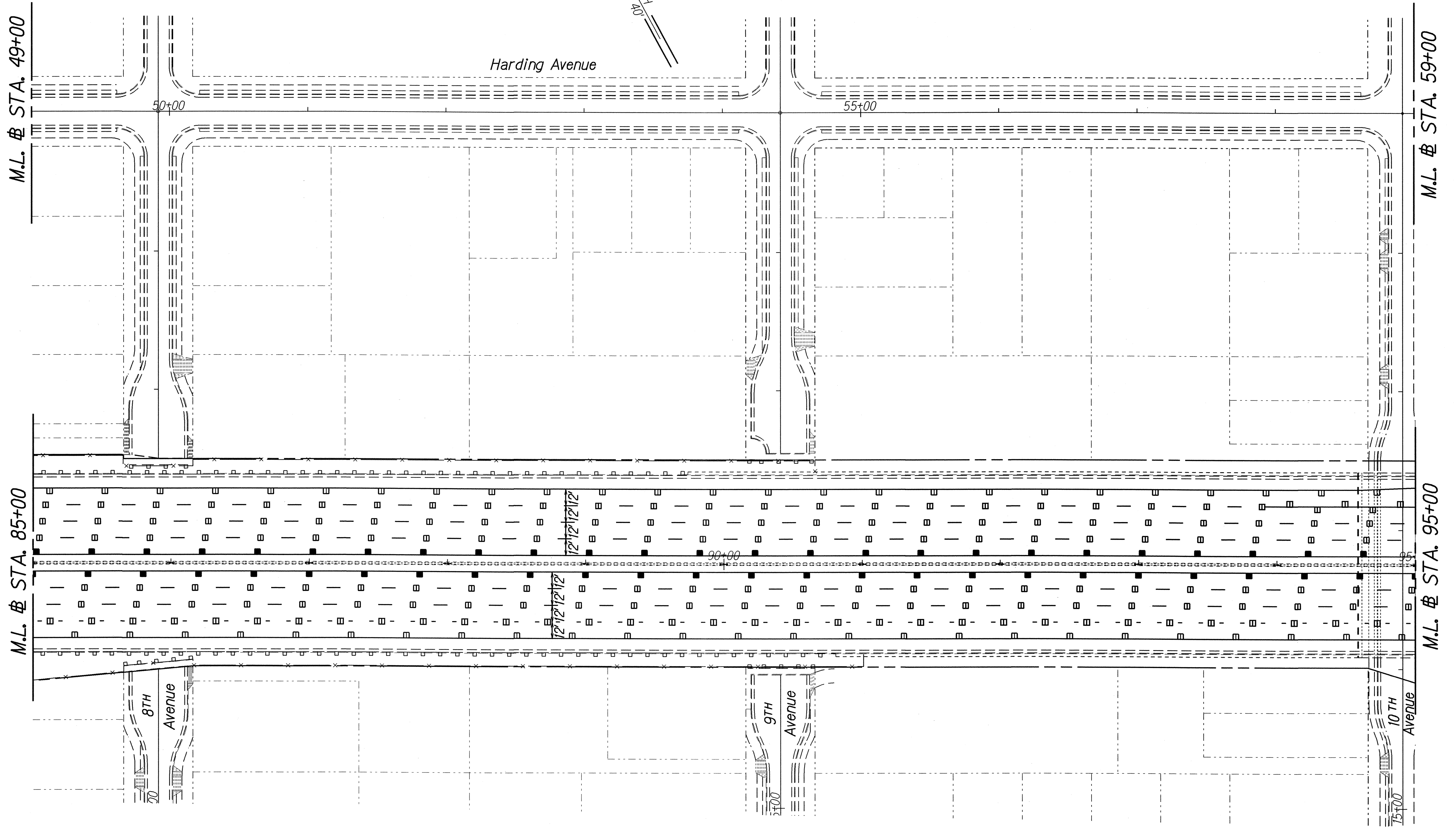

ORIGINAL PLAN	DATE
DESIGNED BY	
TRACED BY	
DESIGNED BY	
QUANTITIES BY	
CHECKED BY	

STATE OF HAWAII
DEPARTMENT OF TRANSPORTATION
HIGHWAYS DIVISION

PAVEMENT MARKING & SIGNING PLAN

*INTERSTATE ROUTE H-1 CONCRETE
PAVEMENT PRESERVATION (DOWEL RETROFIT)
M.P. 2.40 to 3.20 and M.P. 25.00 to 26.40
Federal Aid Project No. IM-HI-1(255)*

Scale: 1" = 40' Date: Sept. 2004

SHEET No. 29 OF 20 SHEETS

FED. ROAD DIST. NO.	STATE	PROJ. NO.	FISCAL YEAR	SHEET NO.	TOTAL SHEETS
HAWAII	HAW.	IM-HI-1(255)	2006	30	40

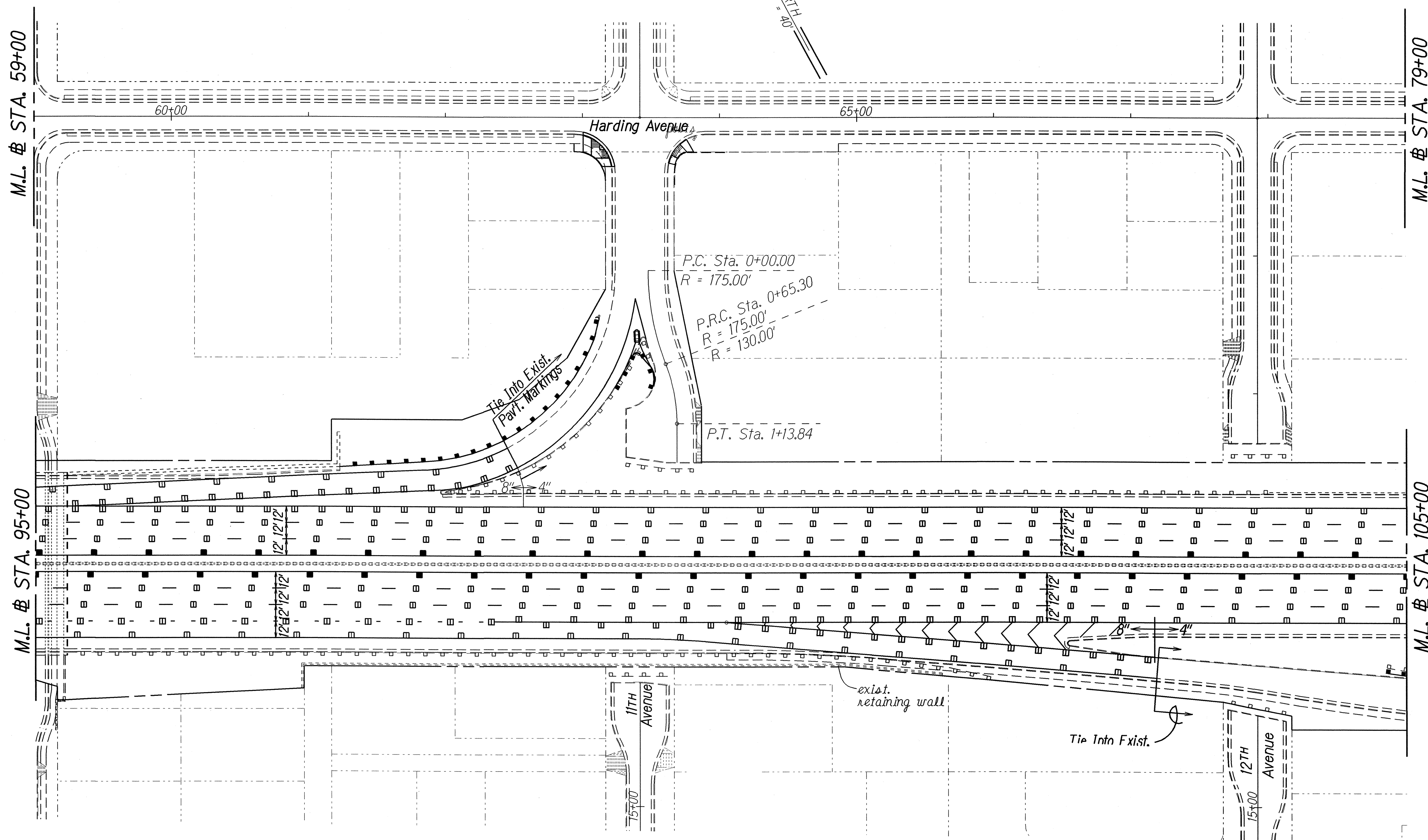

ORIGINAL PLAN	DATE	X
DESIGNED BY	DATE	
TRACED BY	DATE	
DESIGNED BY	DATE	
QUANTITIES BY	DATE	
CHECKED BY	DATE	

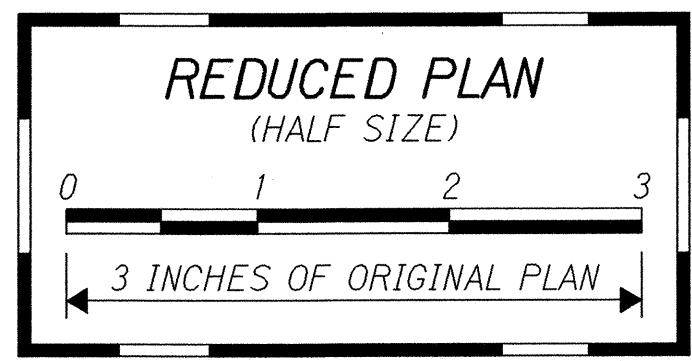

STATE OF HAWAII
DEPARTMENT OF TRANSPORTATION
HIGHWAYS DIVISION
PAVEMENT MARKING & SIGNING PLAN
INTERSTATE ROUTE H-1 CONCRETE
PAVEMENT PRESERVATION (DOWEL RETROFIT)
M.P. 2.40 to 3.20 and M.P. 25.00 to 26.40
Federal Aid Project No. IM-HI-1(255)
Scale: 1" = 40' Date: Sept. 2004
SHEET No. 110 OF 20 SHEETS

FED. ROAD DIST. NO.	STATE	PROJ. NO.	FISCAL YEAR	SHEET NO.	TOTAL SHEETS
HAWAII	HAW.	IM-HI-1(255)	2006	31	40

TRUE NORTH
SCALE: 1" = 40'

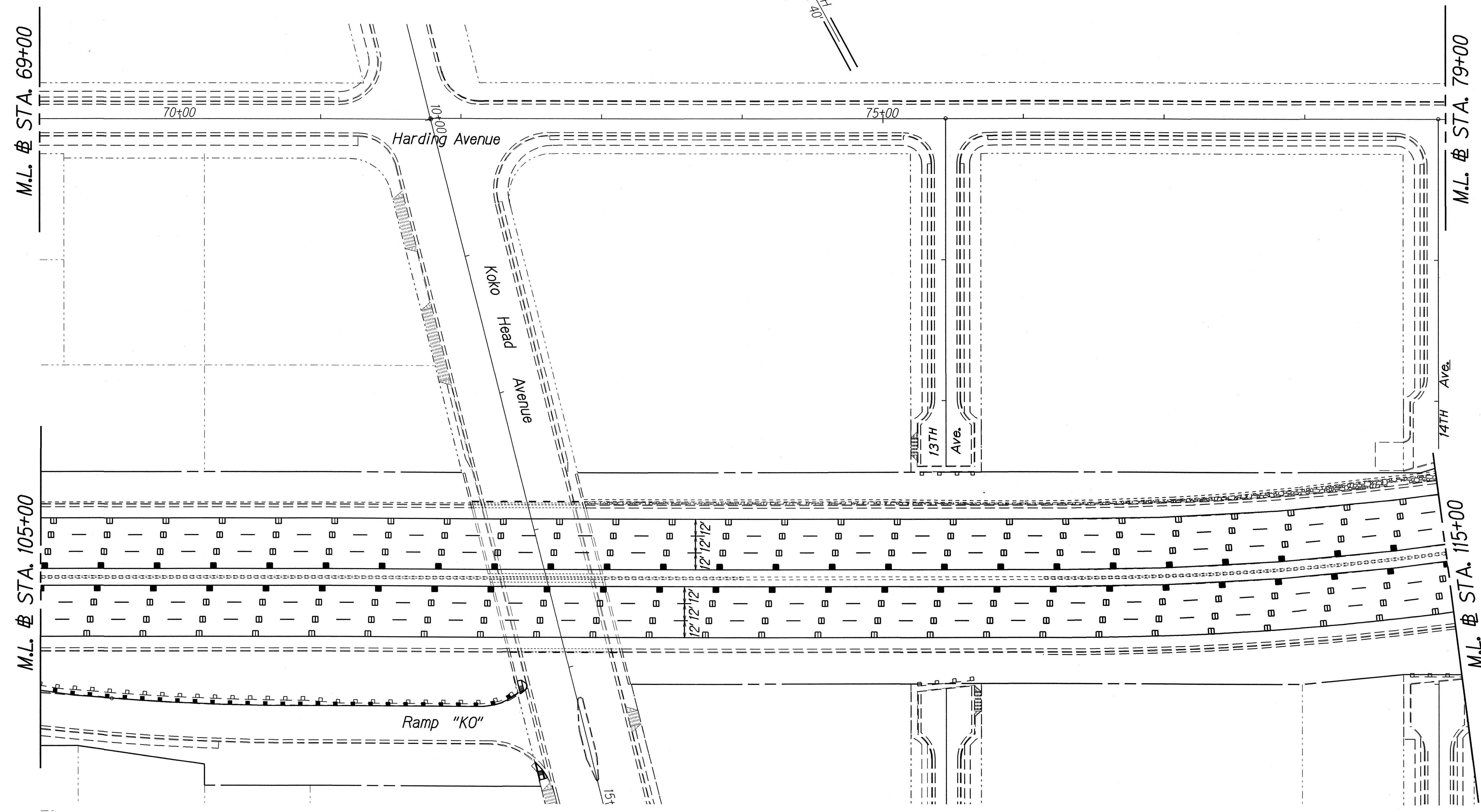

DESIGNED BY	DATE
TRACED BY	
DESIGNED BY	
QUANTITIES BY	
CHECKED BY	

STATE OF HAWAII
DEPARTMENT OF TRANSPORTATION
HIGHWAYS DIVISION
PAVEMENT MARKING & SIGNING PLAN
INTERSTATE ROUTE H-1 CONCRETE
PAVEMENT PRESERVATION (DOWEL RETROFIT)
M.P. 2.40 to 3.20 and M.P. 25.00 to 26.40
Federal Aid Project No. IM-HI-1(255)
Scale: 1" = 40' Date: Sept. 2004

FED. ROAD DIST. NO.	STATE	PROJ. NO.	FISCAL YEAR	SHEET NO.	TOTAL SHEETS
HAWAII	HAW.	IM-HI-1(255)	2006	32	40

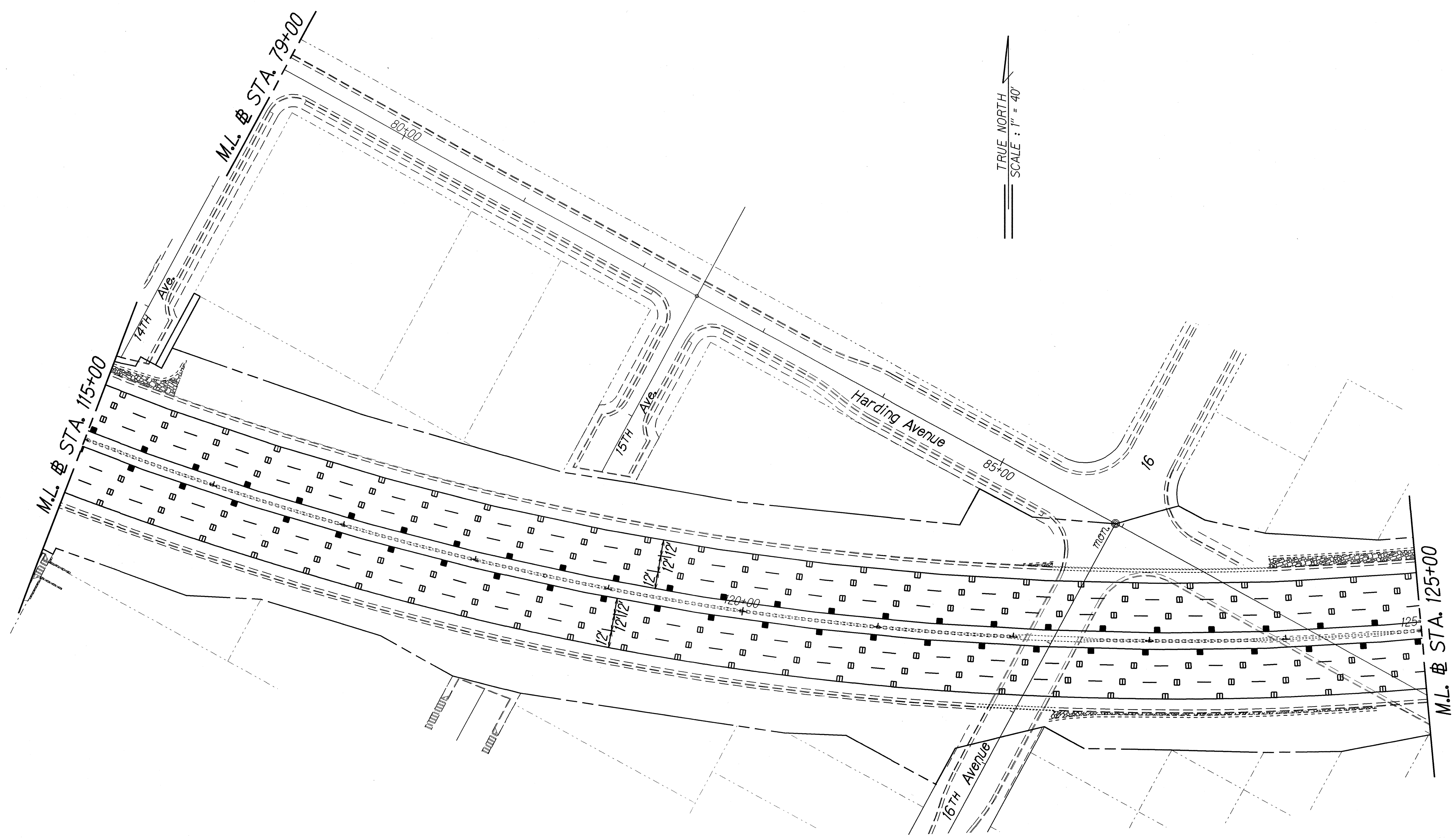

ORIGINAL PLANS	DATE	BY
TRACED BY		
DESIGNED BY		
QUANTITIES BY		
CHECKED BY		

STATE OF HAWAII
DEPARTMENT OF TRANSPORTATION
HIGHWAYS DIVISION
PAVEMENT MARKING & SIGNING PLAN
INTERSTATE ROUTE H-1 CONCRETE
PAVEMENT PRESERVATION (DOWEL RETROFIT)
M.P. 2.40 to 3.20 and M.P. 25.00 to 26.40
Federal Aid Project No. IM-HI-1(255)
Scale: 1" = 40' Date: Sept. 2004
SHEET No. T12 OF 20 SHEETS

FED. ROAD DIST. NO.	STATE	PROJ. NO.	FISCAL YEAR	SHEET NO.	TOTAL SHEETS
HAWAII	HAW.	IM-HI-1(255)	2006	33	40

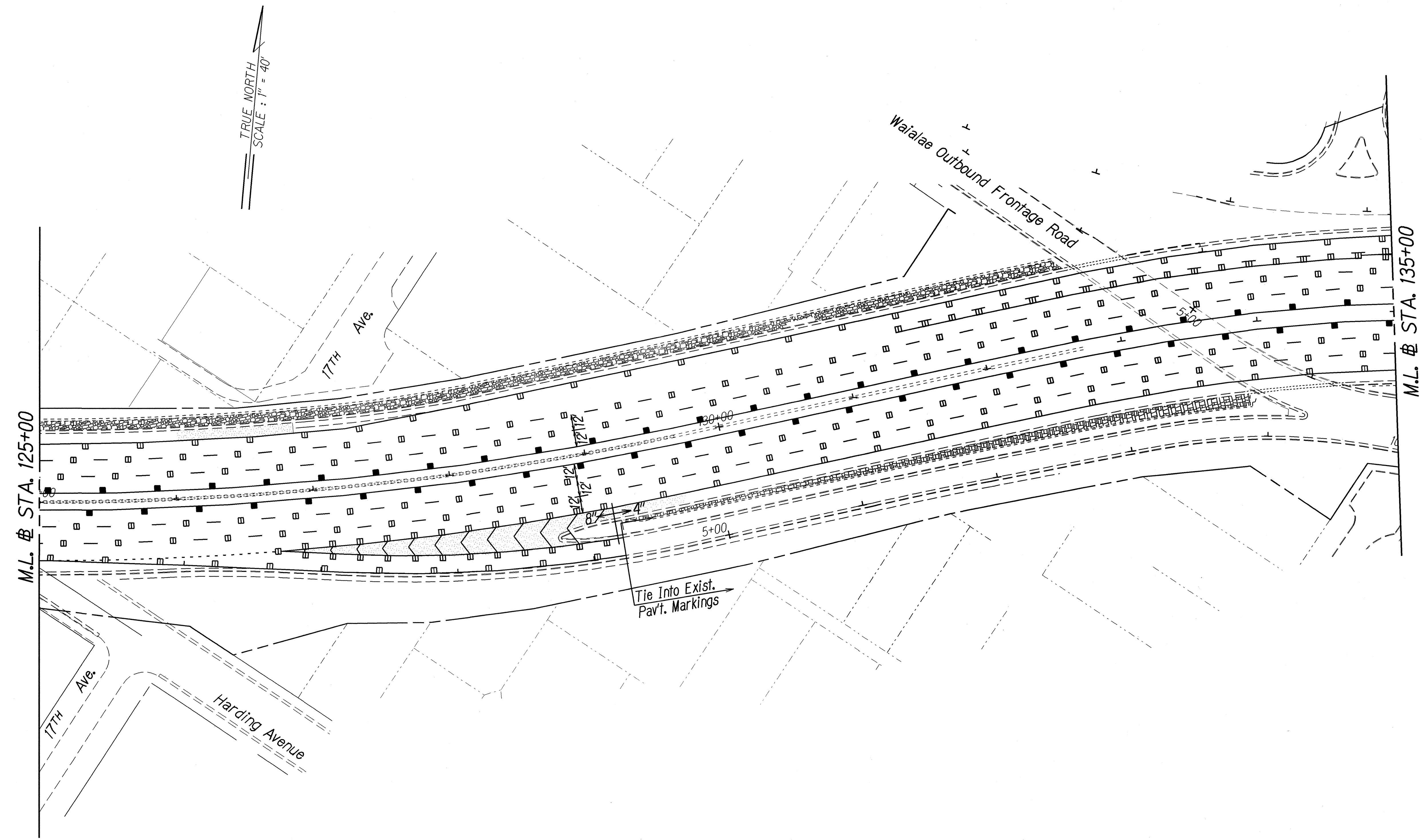

ORIGINAL PLANS	DATE	BY
DESIGNED BY		
TRACED BY		
DESIGNED BY		
QUANTITIES BY		
CHECKED BY		

STATE OF HAWAII
DEPARTMENT OF TRANSPORTATION
HIGHWAYS DIVISION
PAVEMENT MARKING & SIGNING PLAN
INTERSTATE ROUTE H-1 CONCRETE
PAVEMENT PRESERVATION (DOWEL RETROFIT)
M.P. 2.40 to 3.20 and M.P. 25.00 to 26.40
Federal Aid Project No. IM-HI-1(255)
Scale: 1" = 40' Date: Sept. 2004
SHEET No. T13 OF 20 SHEETS

FED. ROAD DIST. NO.	STATE	PROJ. NO.	FISCAL YEAR	SHEET NO.	TOTAL SHEETS
HAWAII	HAW.	IM-HI-1(255)	2006	34	40

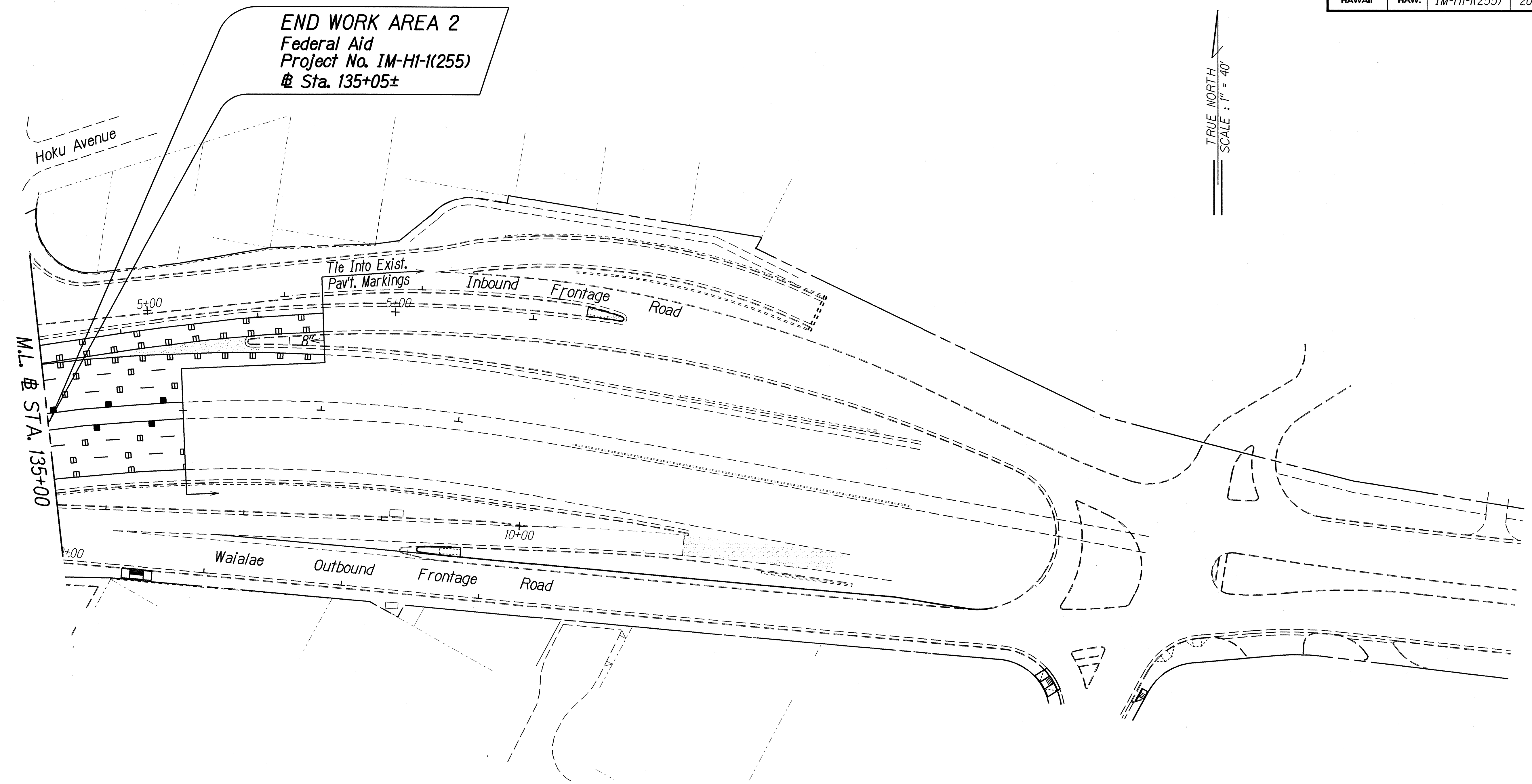

TRUE NORTH
SCALE: 1" = 40'

DESIGNED BY	DATE
PLANNED BY	
CHECKED BY	
NOTED BY	
QUANTITIES BY	
CHECKED BY	

STATE OF HAWAII
DEPARTMENT OF TRANSPORTATION
HIGHWAYS DIVISION

PAVEMENT MARKING & SIGNING PLAN

**INTERSTATE ROUTE H-1 CONCRETE
PAVEMENT PRESERVATION (DOWEL RETROFIT)**
M.P. 2.40 to 3.20 and M.P. 25.00 to 26.40
Federal Aid Project No. IM-HI-1(255)
Scale: 1" = 40' Date: Sept. 2004