

FED. ROAD DIST. NO.	STATE	FEDERAL AID PROJ. NO.	FISCAL YEAR	SHEET NO.	TOTAL SHEETS
HAWAII	HAW.	IM-HI-1(245)	2005	52	183

NOTES:

1. The Contractor shall provide portable concrete guardrail to shield the construction staging area. Stabilization pins shall be provided to minimize barrier deflection. The barriers shall meet NCHRP 350 Test Level 3 standards and be accepted by the Engineer. Payment for fabrication of the barriers shall be made under Item No. 649.1000-Portable Concrete Guardrail-Intermediate. Payment for placement and removal of the portable concrete guardrail sections shall be made under Item No. 672.1000-Reset Portable Concrete Guardrail section.
2. Crash cushions shall be appropriate for the portable concrete guardrail and shall be accepted by the Engineer. The end treatments shall meet NCHRP 350 Standards Test Level 3. Payment for placement, maintenance, and removal of crash cushions shall be made under Item No. 645.1000-Traffic Control.
3. Upon completion of construction, the Contractor shall restore the area disturbed by his operations to a condition equal to or better than existing. The staging area shall be grassed and the irrigation system restored. All existing trees and shrubs shall be restored or replaced. Payment for restoration of staging area shall be considered incidental to the various contract items.
4. The Contractor shall not change the configuration of the staging area without the permission of the Engineer.
5. See Existing Conditions on Sheets F1 and F2 for as-built plans and notes of irrigation system.

TRUE NORTH
SCALE: 1" = 40'

WAI'AU INTERCHANGE

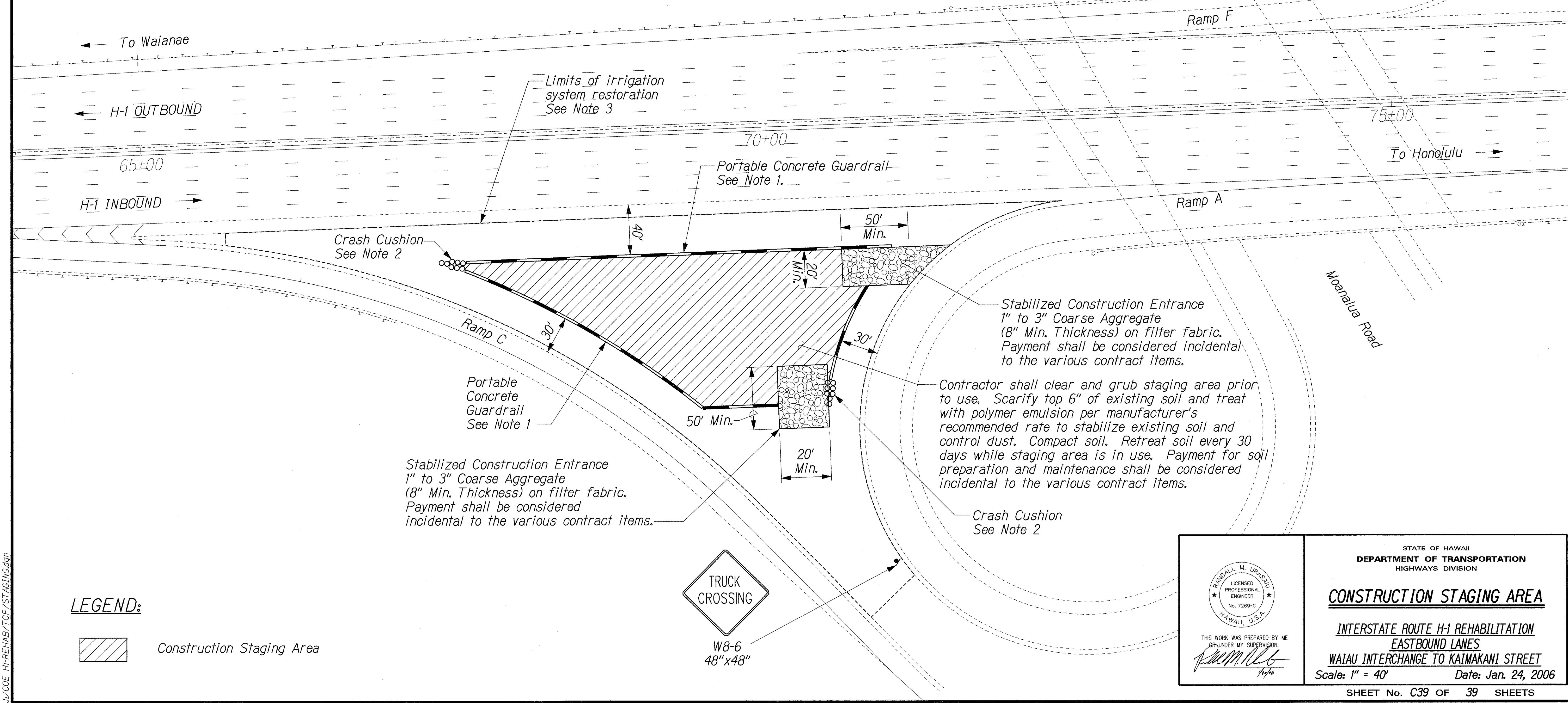

LEGEND:

Construction Staging Area

ORIGINAL PLAN	SURVEY PLOTTED BY	DATE
NOTE BOOK	DRAWN BY	
	DESIGNED BY	
	CHECKED BY	

THIS WORK WAS PREPARED BY ME OR UNDER MY SUPERVISION.

R. M. Urasaki

STATE OF HAWAII
DEPARTMENT OF TRANSPORTATION
HIGHWAYS DIVISION

CONSTRUCTION STAGING AREA

INTERSTATE ROUTE H-1 REHABILITATION
EASTBOUND LANES
WAI'AU INTERCHANGE TO KAIMAKANI STREET

Scale: 1" = 40' Date: Jan. 24, 2006

SHEET No. C39 OF 39 SHEETS