

GENERAL NOTES FOR TRAFFIC CONTROL PLAN

FED. ROAD DIST. NO.	STATE	FEDERAL AID PROJ. NO.	FISCAL YEAR	SHEET NO.	TOTAL SHEETS
HAWAII	HAW.	NH-HI-1(276)	2020	36	214

- Only Traffic Control Plans for major construction activities are shown. The Contractor shall develop his own Traffic Control Plans in accordance with Section 645 of the Special Provisions for activities to complete work not covered by the Traffic Control Plans. The Contractor shall submit the Traffic Control Plans to the Engineer for acceptance. Payment for development and implementation of the Traffic Control Plans shall be included in pay item 645.1000 - Traffic Control.
- All lane closures and traffic pattern changes (detours) not shown on the plan shall be submitted to the Engineer for acceptance in accordance with Specifications Section 645 - Work Zone Traffic Control. For restrictions on lane closures, detours, construction work during peak hours, and other requirements regarding maintaining vehicular and pedestrian traffic, see Subsection 107.03 - Working Hours; Night Work and Section 645 -Work Zone Traffic Control.
- The Contractor shall make minor adjustments at intersections, driveways, bridges, structures, etc. to fit field conditions.
- Cones or delineators shall be extended to a point where they are visible to approaching traffic.
- Traffic control devices shall be installed such that the sign or device farthest from the work area shall be placed first. The others shall then be placed progressively toward the work area.
- Flaggers and/or police officers shall be in sight of each other or in direct communications at all times. Flaggers and/or police officers working at night shall be illuminated as required by the MUTCD.
- Sign spacings (L), taper lengths (T), and spacings of cones or delineators shall be as shown in Table 645-1 - For Traffic Control Plan of Section 645 in the Specifications, unless otherwise noted on HDOT's Traffic Control Plans.
- All traffic lanes shall be a minimum of 10 feet wide.
- All signs shall be promptly removed or covered whenever the message is not applicable or not in use.
- The backs of all signs for traffic control shall be appropriately covered to preclude the display of inapplicable sign messages (i.e., when signs have messages on both faces).
- Replace permanent pavement markings and traffic signs that are missing, damaged, or have been removed upon completion of each day's work. Payment for replacing permanent pavement markings and signs shall be considered incidental to the various contract items.
- At the end of each day's work or as soon as the work is completed, the Contractor shall remove all traffic control devices no longer needed to permit free and safe passage of public traffic. Removal shall be in the reverse order of installation. Signs and temporary control devices shall not be stored within the roadway right-of-way.
- The locations of pavement markings, signs, and delineators used in the Traffic Control shall be as shown on the plans, Contractor's accepted Traffic Control Plans, and/or as determined in the field by the Engineer.
- Damage to signs, pavement markers, and delineators caused by the Contractor's negligence shall be repaired or replaced by the Contractor as directed by the Engineer at no cost to the State.
- Signs for night work shall be retroreflective and shall be mounted with a Type B high intensity flasher. The sign and flasher will be paid under Pay Item No. 645.1000-Traffic Control.

- The Contractor shall limit the extent of trench and excavation work for pavement reconstruction to an area that can be satisfactorily backfilled in one work day.
- Work zone limits shown for each traffic control phase encompass all work items to be completed in that particular phase. The length of the work zone may be reduced to accommodate the Contractor's actual work zone for that time period, provided it has been accepted by the Engineer, and all tangents, tapers, and buffer lengths are maintained.
- For intermittent work zones within a particular traffic control phase, only cones along the actual work zone need to be placed at 10' o.c. The intermittent work zone shall include a 335' buffer area along the leading edge of traffic flow. All other traffic control cones can be placed at 35' o.c. Each work zone shall have one CW20-1Ad sign, one R2-1(XX)-A sign, and two police officers. See typical detail below.

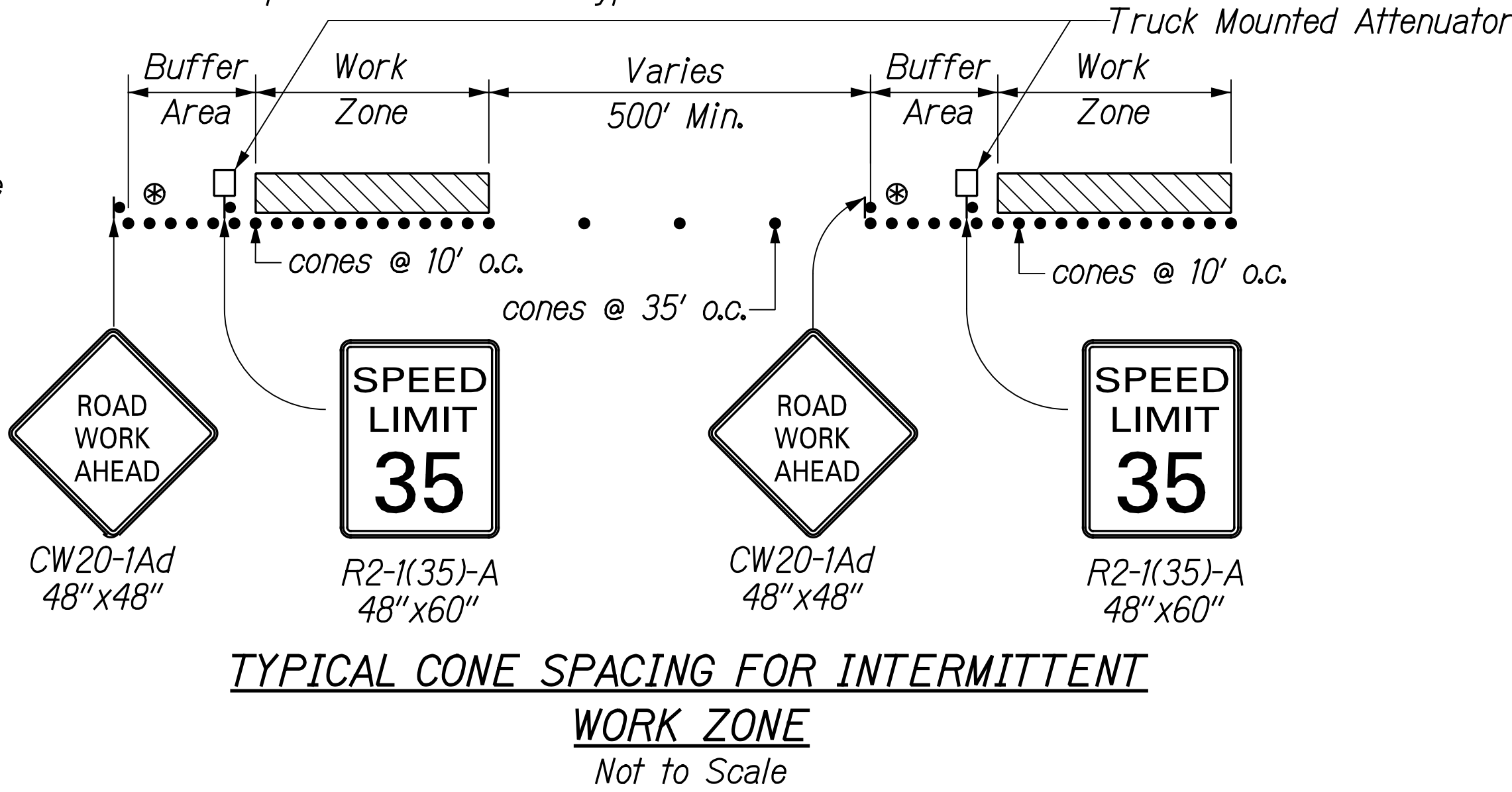

- The Contractor shall provide all sign supports and/or posts for construction warning signs, including median barrier mounting brackets.
- The Contractor shall provide and maintain portable message boards as shown on the traffic control plans to provide advanced warning of freeway lane closures. Message boards shall display closure dates and times and shall be operational 24 hours a day for three (3) days prior to the first freeway lane closure. Signs shall remain for the duration of the anticipated lane closures. The Contractor shall provide appropriate traffic control devices (barricades, cones, etc.) to protect the message boards. Installation, maintenance, and removal of message boards shall be paid under Pay Item No. 645.1000 - Traffic Control.
- The Contractor shall furnish, install, maintain, and remove all traffic control devices shown on the traffic control plans. Payment for all work shown, including furnishing all police officers shown on the traffic control plans, shall be under Pay Item No. 645.1000 - Traffic Control.
- The Contractor shall maintain a buffer lane.
- Signs shall not be partially covered. If a sign needs to be covered, the entire sign shall be covered.

- The Contractor shall coordinate with the Airport Duty Manager (808-836-4634) two (2) weeks prior to construction for all work on the Interstate Route H-1 airport access ramps and all work that revises traffic patterns to and from the airport on Interstate Route H-1 and Nimitz Highway.

Legend:

- Work Area
- Traffic Cones @ 35' o.c.
- Traffic Cones @ 10' o.c.
- Sign
- Existing Sign
- Flashing Arrow Signal
- Portable Message Board
- Direction of Traffic
- Police Officer and Police Vehicle with Visible Blue Light
- Type II Barricade with Steady Burn Warning Light
- Type III Barricade with Flashing Warning Light

ORIGINAL PLAN	SURVEY PLOTTED BY	DATE
NOTE BOOK	DRAWN BY	
	DESIGNED BY	
	CHECKED BY	

RANDALL M. URAKAWA

LICENSED PROFESSIONAL ENGINEER

No. 7289-C

HAWAII, U.S.A.

THIS WORK WAS PREPARED BY ME OR UNDER MY SUPERVISION.

Signature

04/30/22

EXPIRATION DATE OF THE LICENSE

STATE OF HAWAII

DEPARTMENT OF TRANSPORTATION

HIGHWAYS DIVISION

TRAFFIC CONTROL NOTES

AND LEGEND

INTERSTATE ROUTE H-1 AIRPORT VIADUCT IMPROVEMENTS

VICINITY OF VALKENBURGH ST. TO MIDDLE ST., PH. 2

FEDERAL-AID PROJECT NO. NH-HI-1(276)

Scale: None

Date: Aug. 2020

SHEET No. T-1 OF 123 SHEETS

36

FED. ROAD DIST. NO.	STATE	FEDERAL AID PROJ. NO.	FISCAL YEAR	SHEET NO.	TOTAL SHEETS
HAWAII	HAW.	NH-HI-1(276)	2020	37	214

GENERAL NOTES FOR
TRAFFIC CONTROL PLAN (WITHIN CITY R/W)

1. The Permittee shall make minor adjustments at intersections, driveways, bridges, structures, etc. to fit field conditions.
2. Cones or delineators shall be extended to a point where they are visible to approaching traffic.
3. Traffic control devices shall be installed such that the sign or device farthest from the work area is placed first. The others shall then be placed progressively toward the work area.
4. Regulatory and Warning Signs within the construction zone that are in conflict with the traffic control plans shall be removed or covered.
5. Flaggers and/or police officers shall be in sight of each other or in direct communication at all times.
6. When required by the issuing office, the Permittee shall install a flashing arrow signal as shown on the traffic control plans.
7. All traffic lanes shall be a minimum of 10 feet wide.
8. All construction warning signs shall be promptly removed or covered whenever the message is not applicable or not in use.
9. The backs of all signs used for traffic control shall be appropriately covered to preclude the display of inapplicable sign messages (i.e., when signs have messages on both faces).
10. Lane closure shall be limited only to the extent of accomplishing each day's work. As soon as each day's work is completed, the Permittee shall remove all traffic control devices no longer needed to permit free and safe passage of public traffic. Removal shall be in the reverse order of installation. Existing faded or obliterated pavement markings that are necessary for safe traffic flow in the construction area shall be replaced with temporary or permanent markings before opening the roadway to public traffic each day.
11. Permanent pavement markings and traffic signs shall be replaced upon completion of each phase of work.
12. Cones and delineators shall be spaced at a maximum distance of 20 feet apart. A minimum of six channelizing devices shall be used for each taper length.
13. Driveways shall be kept open unless the owners of the property using the driveway are otherwise provided for satisfactorily. Further, the Permittee shall control traffic going into and out of driveways.
14. Buffer and taper area on approach to any work area shall be kept clear of vehicles and equipment.
15. A high level warning device (flag tree) shall be installed on approach to all work areas.
16. "No Parking" signs shall be posted within any work area and for the buffer and taper areas approaching the work area.
17. Contractor shall obtain approval from DPP, Traffic Review Branch, for work or traffic control within City R/W.

ORIGINAL PLAN	SURVEY PLOTTED BY	DATE
	DRAWN BY	
	DESIGNED BY	
	QUANTITIES BY	
NOTE BOOK	CHECKED BY	
N ^o .		

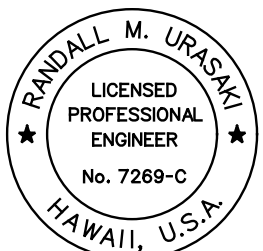
<div><p>THIS WORK WAS PREPARED BY ME OR UNDER MY SUPERVISION.</p><p><i>R. M. Uragami</i> SIGNATURE</p><p>04/30/22 EXPIRATION DATE OF THE LICENSE</p></div>	STATE OF HAWAII DEPARTMENT OF TRANSPORTATION HIGHWAYS DIVISION
	<u>TRAFFIC CONTROL NOTES</u>
	INTERSTATE ROUTE H-1 AIRPORT VIADUCT IMPROVEMENTS VICINITY OF VALKENBURGH ST. TO MIDDLE ST., PH. 2 FEDERAL-AID PROJECT NO. NH-HI-1(276)
	Scale: None
	Date: Aug. 2020