

Attachment A  
Pavement Grades Plans

FED. ROAD DIST. NO.	STATE	FED. AID PROJ. NO.	FISCAL YEAR	SHEET NO.	TOTAL SHEETS
HAWAII	HAW.	1M-HI-1	2013	28	381

Ramp KA-1 @ Sta. 31+68.68 =  
Ramp KA-1 @ Sta. 15+62.85 =  
Access Road @ Sta. 0+00

True North  
Scale: 1" = 20'

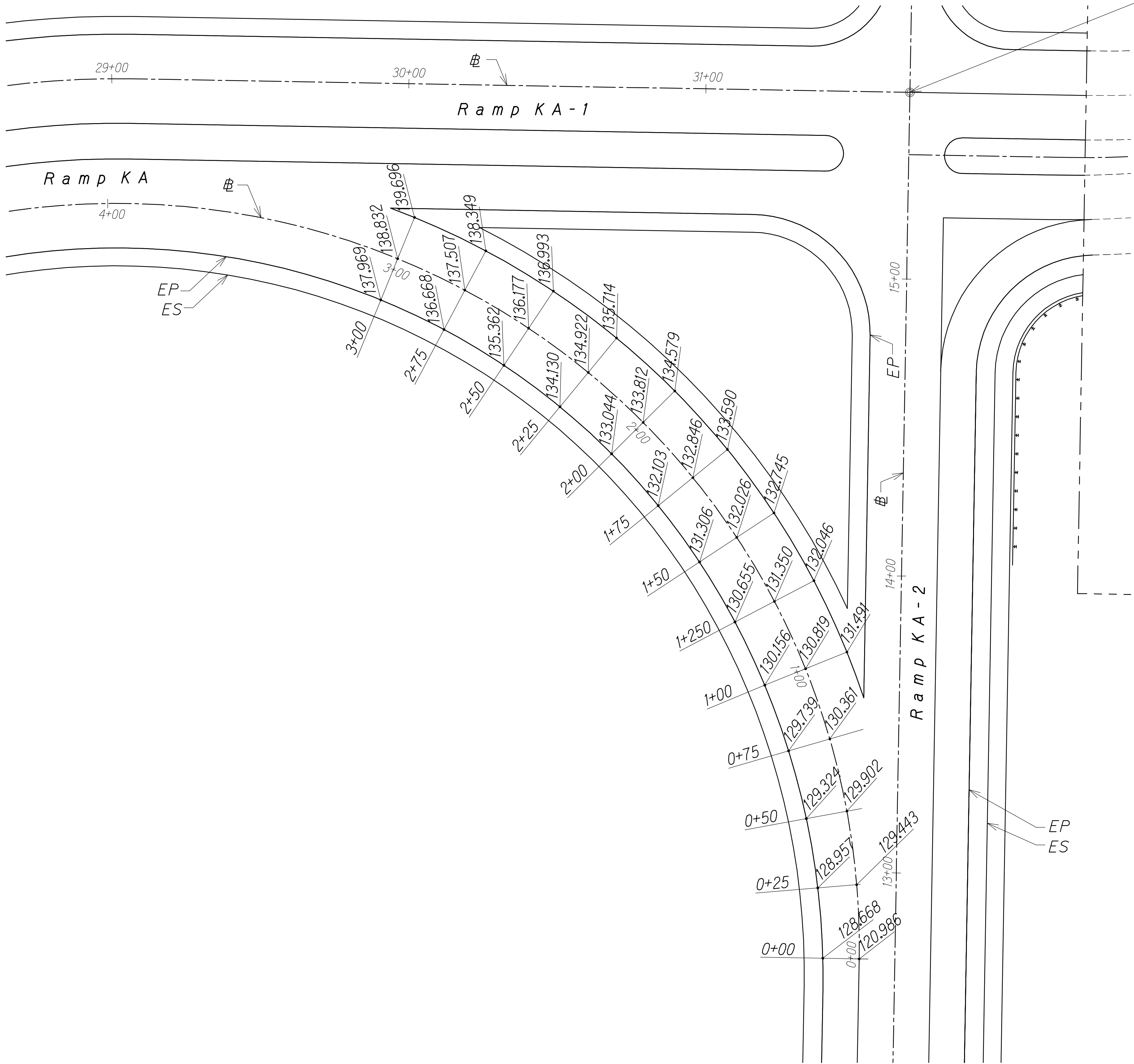

ORIGINAL PLAN	DATE
SURVEY PLOTTED BY	
DRAWN BY	
TRACED BY	
DESIGNED BY	
QUANTITIES BY	
CHECKED BY	
No.	

GRAPHIC SCALES:  
20' 10' 0 20' 40'  
SCALE: 1" = 20'

RAMP KA  
Scale: 1" = 20'

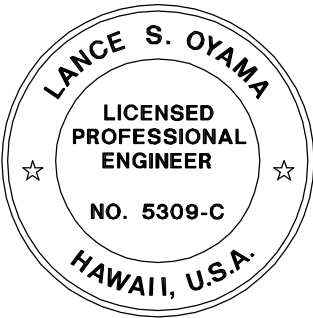

THIS WORK WAS PREPARED BY ME  
OR UNDER MY SUPERVISION.

WILSON OKAMOTO CORPORATION APRIL 30, 2014  
LIC. EXP. DATE

STATE OF HAWAII  
DEPARTMENT OF TRANSPORTATION  
HIGHWAYS DIVISION  
**PAVEMENT GRADES**  
INTERSTATE ROUTE H-1  
ADDITION AND MODIFICATION OF FREEWAY ACCESS  
(Kapolei Interchange Complex), Phase 2  
Federal-Aid Project No. 1M-HI-1  
Scale: As Noted Date: October 26, 2012  
SHEET No. C-16 OF 33 SHEETS

DATE	REVISION
------	----------

FED. ROAD DIST. NO.	STATE	FED. AID PROJ. NO.	FISCAL YEAR	SHEET NO.	TOTAL SHEETS
HAWAII	HAW.	1M-HI-1	2013	29	381

True North  
Scale: 1" = 20'

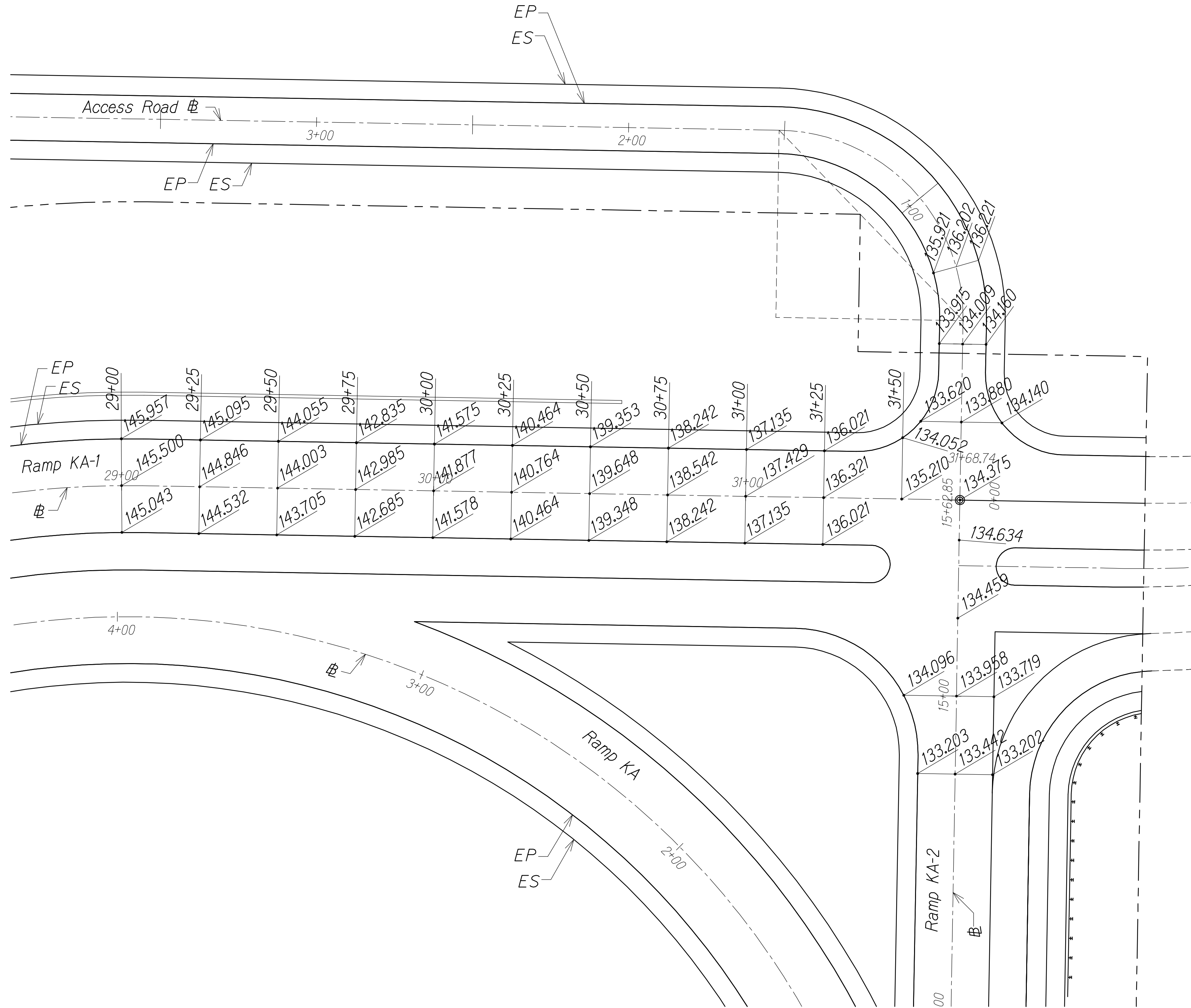

ORIGINAL PLAN	SURVEY PLOTTED BY	DATE
NOTE BOOK	DRAWN BY	
No.	DESIGNED BY	
	QUANTITIES BY	
	CHECKED BY	

GRAPHIC SCALES:  
20' 10' 0 20' 40'  
SCALE: 1" = 20'

RAMP KA-1, KA-2 & ACCESS ROAD  
Scale: 1" = 20'

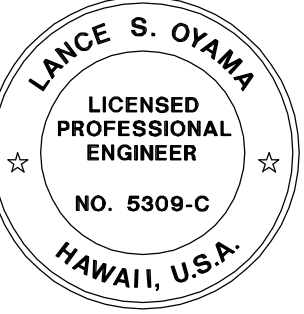

THIS WORK WAS PREPARED BY ME  
OR UNDER MY SUPERVISION.

APRIL 30, 2014  
WILSON OKAMOTO CORPORATION LIC. EXP. DATE

STATE OF HAWAII  
DEPARTMENT OF TRANSPORTATION  
HIGHWAYS DIVISION  
**PAVEMENT GRADES**  
INTERSTATE ROUTE H-1  
ADDITION AND MODIFICATION OF FREEWAY ACCESS  
(Kapolei Interchange Complex), Phase 2  
Federal-Aid Project No. 1M-HI-1  
Scale: As Noted Date: October 26, 2012  
SHEET No. C-17 OF 33 SHEETS

DATE	REVISION
------	----------

FED. ROAD DIST. NO.	STATE	FED. AID PROJ. NO.	FISCAL YEAR	SHEET NO.	TOTAL SHEETS
HAWAII	HAW.	1M-HI-1	2013	30	381

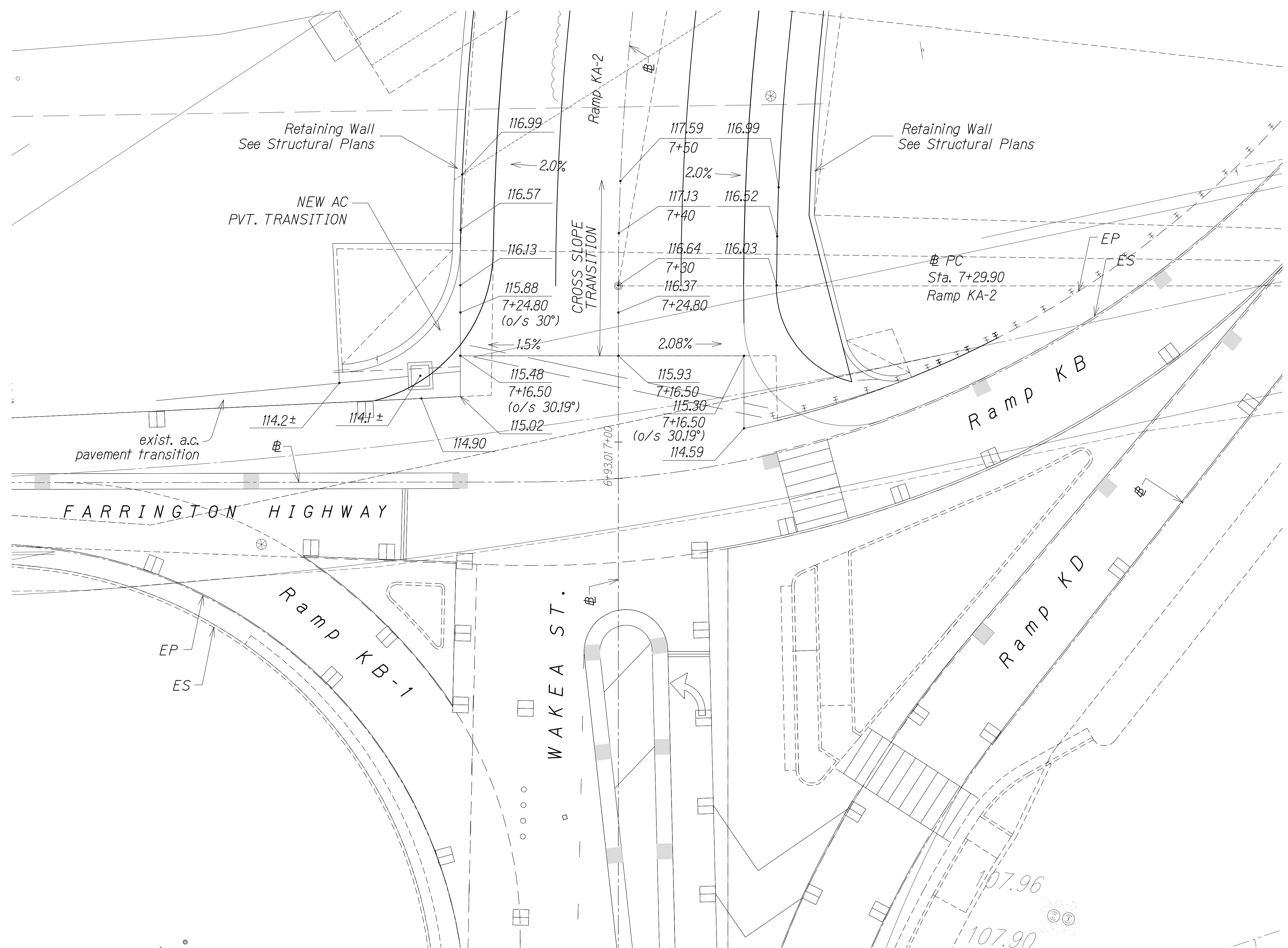

True North  
Scale: 1" = 10'

ORIGINAL PLAN	DATE
SURVEY PLOTTED BY	
DRAWN BY	
TRACED BY	
DESIGNED BY	
QUANTITIES BY	
CHECKED BY	
No.	

GRAPHIC SCALES:  
10' 5' 0 10' 20'  
SCALE: 1" = 10'

WAKEA ST. & RAMP KA-2  
Scale: 1" = 10'

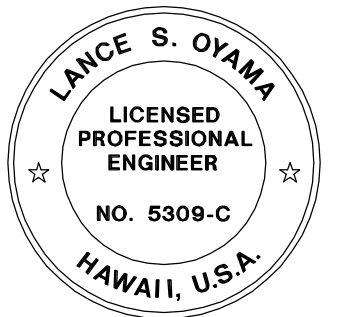

THIS WORK WAS PREPARED BY ME  
OR UNDER MY SUPERVISION.

APRIL 30, 2014  
WILSON OKAMOTO CORPORATION LIC. EXP. DATE

STATE OF HAWAII  
DEPARTMENT OF TRANSPORTATION  
HIGHWAYS DIVISION  
**PAVEMENT GRADES**  
INTERSTATE ROUTE H-1  
ADDITION AND MODIFICATION OF FREEWAY ACCESS  
(Kapolei Interchange Complex), Phase 2  
Federal-Aid Project No. 1M-HI-1  
Scale: As Noted Date: October 26, 2012  
SHEET No. C-18 OF 33 SHEETS

DATE	REVISION

FED. ROAD DIST. NO.	STATE	FED. AID PROJ. NO.	FISCAL YEAR	SHEET NO.	TOTAL SHEETS
HAWAII	HAW.	1M-HI-1	2013	31	381

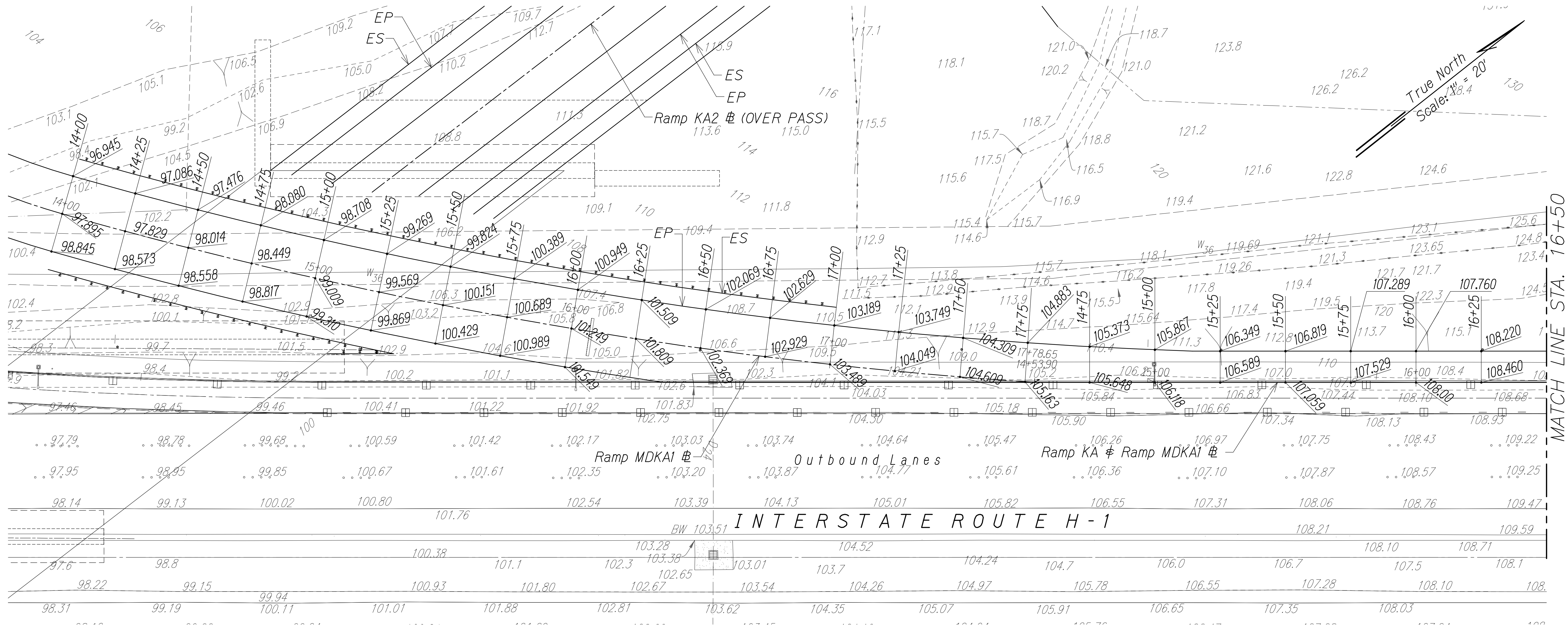

MATCH LINE STA. 16+50

ORIGINAL PLAN	SURVEY PLOTTED BY	DATE
NOTE BOOK	DRAWN BY	
DESIGNED BY		
QUANTITIES BY		
CHECKED BY		

GRAPHIC SCALES:  
20' 10' 0 20' 40'  
SCALE: 1" = 20'

RAMP KA/RAMP MDKA1  
Scale: 1" = 20'

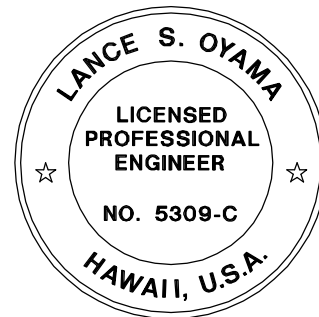

THIS WORK WAS PREPARED BY ME  
OR UNDER MY SUPERVISION.

APRIL 30, 2014  
WILSON OKAMOTO CORPORATION LIC. EXP. DATE

STATE OF HAWAII  
DEPARTMENT OF TRANSPORTATION  
HIGHWAYS DIVISION  
**PAVEMENT GRADES**  
INTERSTATE ROUTE H-1  
ADDITION AND MODIFICATION OF FREEWAY ACCESS  
(Kapolei Interchange Complex), Phase 2  
Federal-Aid Project No. 1M-HI-1  
Scale: As Noted Date: October 26, 2012  
SHEET No. C-19 OF 33 SHEETS

DATE	REVISION
------	----------



FED. ROAD DIST. NO.	STATE	FED. AID PROJ. NO.	FISCAL YEAR	SHEET NO.	TOTAL SHEETS
HAWAII	HAW.	IM-HI-1	2013	32	381

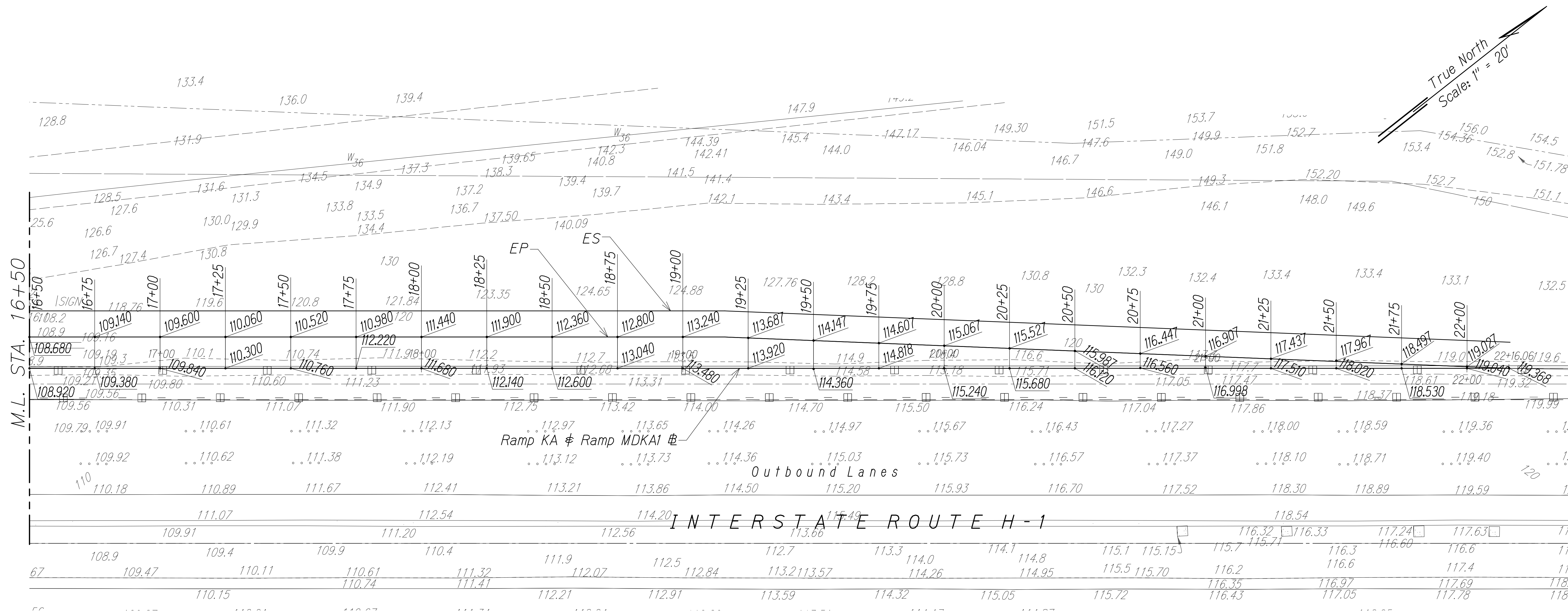

ORIGINAL PLAN	SURVEY PLOTTED BY	DATE
NOTE BOOK	DRAWN BY	
DESIGNED BY	TRACED BY	
QUANTITIES BY	CHECKED BY	
No.		

GRAPHIC SCALES:  
20' 10' 0' 20' 40'  
SCALE: 1" = 20'

RAMP KA/RAMP MDKAI  
Scale: 1" = 20'

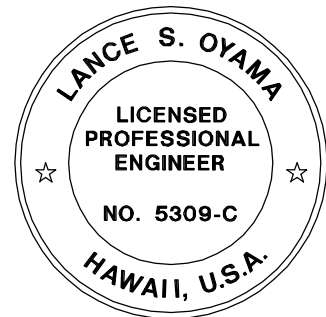

THIS WORK WAS PREPARED BY ME  
OR UNDER MY SUPERVISION.

APRIL 30, 2014  
WILSON OKAMOTO CORPORATION LIC. EXP. DATE

STATE OF HAWAII  
DEPARTMENT OF TRANSPORTATION  
HIGHWAYS DIVISION  
**PAVEMENT GRADES**  
INTERSTATE ROUTE H-1  
ADDITION AND MODIFICATION OF FREEWAY ACCESS  
(Kapolei Interchange Complex), Phase 2  
Federal-Aid Project No. IM-HI-1  
Scale: As Noted Date: October 26, 2012  
SHEET No. C-20 OF 33 SHEETS

DATE	REVISION
------	----------

FED. ROAD DIST. NO.	STATE	FED. AID PROJ. NO.	FISCAL YEAR	SHEET NO.	TOTAL SHEETS
HAWAII	HAW.	1M-HI-1	2013	34	381

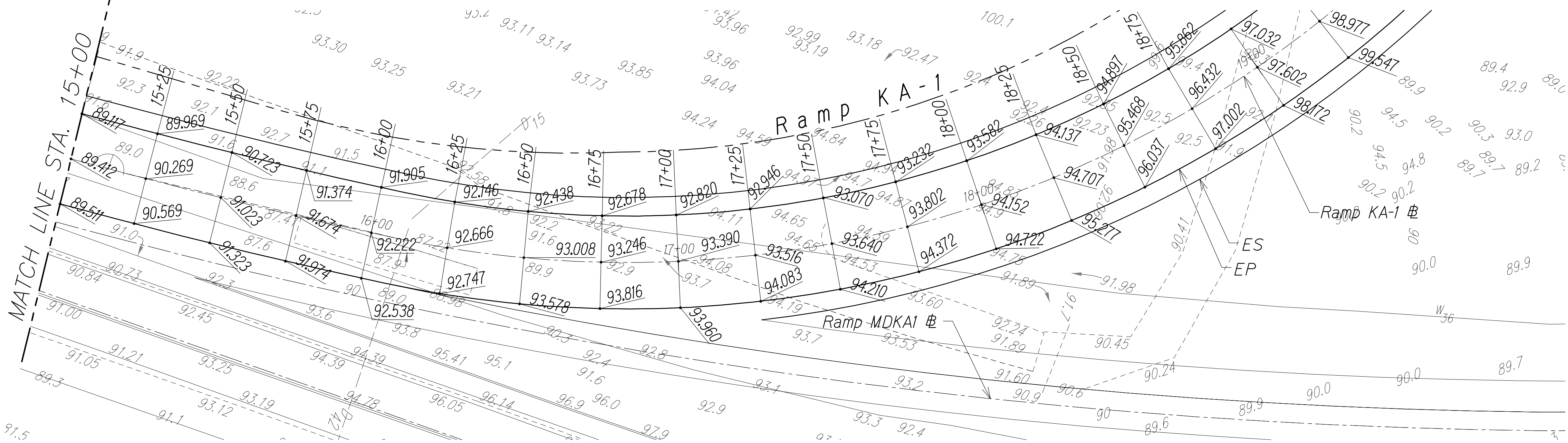
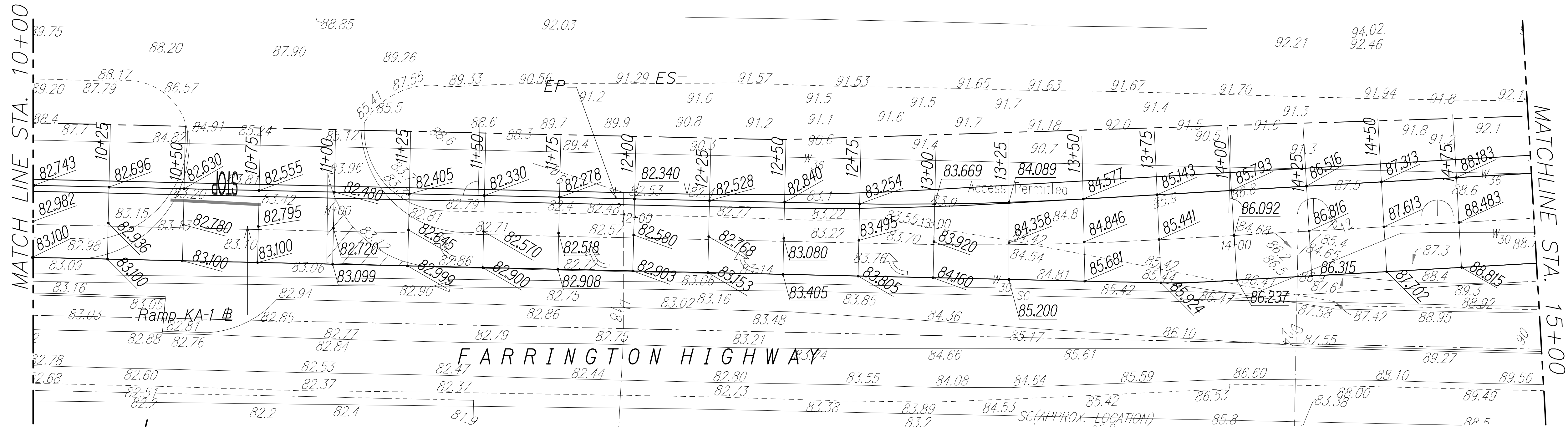

DATE	DATE
ORIGINAL PLAN	DATE
DESIGNED BY	DATE
TRACED BY	DATE
NOTED BY	DATE
CHECKED BY	DATE

GRAPHIC SCALES:  
20' 10' 0 20' 40'  
SCALE: 1" = 20'

RAMP KA-1 & FARRINGTON HIGHWAY  
Scale: 1" = 20'

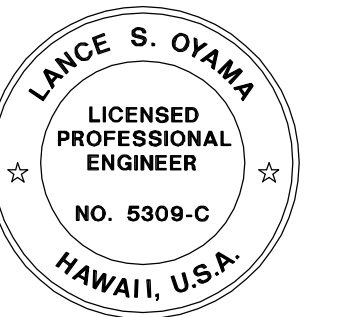

THIS WORK WAS PREPARED BY ME  
OR UNDER MY SUPERVISION.

APRIL 30, 2014  
WILSON OKAMOTO CORPORATION LIC. EXP. DATE

STATE OF HAWAII  
DEPARTMENT OF TRANSPORTATION  
HIGHWAYS DIVISION  
**PAVEMENT GRADES**  
INTERSTATE ROUTE H-1  
ADDITION AND MODIFICATION OF FREEWAY ACCESS  
(Kapolei Interchange Complex), Phase 2  
Federal-Aid Project No. 1M-HI-1  
Scale: As Noted Date: October 26, 2012  
SHEET No. C-22 OF 33 SHEETS

DATE	REVISION
------	----------





FED. ROAD DIST. NO.	STATE	FED. AID PROJ. NO.	FISCAL YEAR	SHEET NO.	TOTAL SHEETS
HAWAII	HAW.	1M-HI-1	2013	35	381

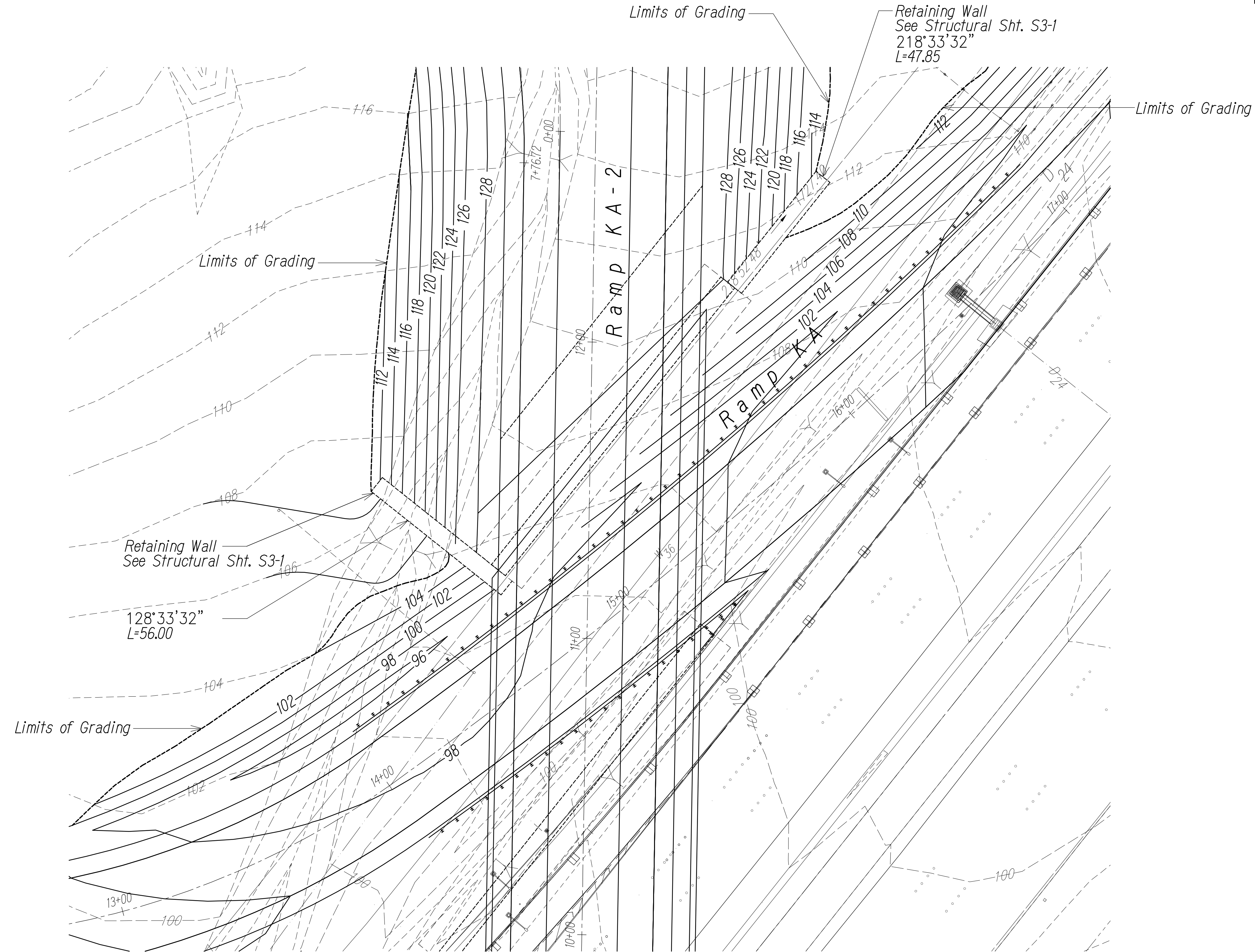

True North  
Scale: 1"=20'

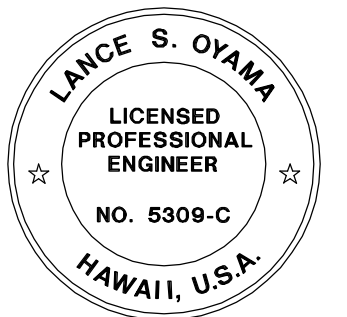

THIS WORK WAS PREPARED BY ME  
OR UNDER MY SUPERVISION.

WILSON OKAMOTO CORPORATION LIC. EXP. DATE  
APRIL 30, 2014

STATE OF HAWAII  
DEPARTMENT OF TRANSPORTATION  
HIGHWAYS DIVISION

GRADING - ABUTMENT 1  
INTERSTATE ROUTE H-1  
ADDITION AND MODIFICATION OF FREEWAY ACCESS  
(Kapolei Interchange Complex), Phase 2  
Federal-Aid Project No. 1M-HI-1

Scale: As Noted      Date: October 26, 2012

SHEET No. C-23 OF 33 SHEETS

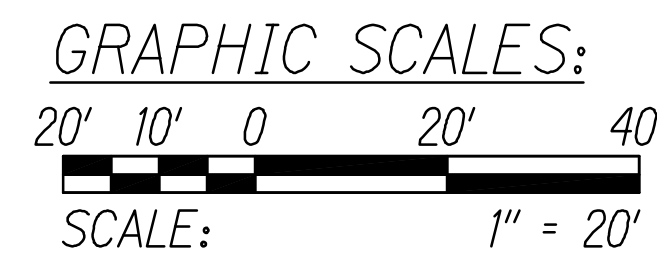

ORIGINAL PLAN	SURVEY PLOTTED BY	DATE
NOTE BOOK	DRAWN BY	
No.	DESIGNED BY	
	QUANTITIES BY	
	CHECKED BY	

DATE	REVISION
------	----------

FED. ROAD DIST. NO.	STATE	FED. AID PROJ. NO.	FISCAL YEAR	SHEET NO.	TOTAL SHEETS
HAWAII	HAW.	1M-HI-1	2013	36	381

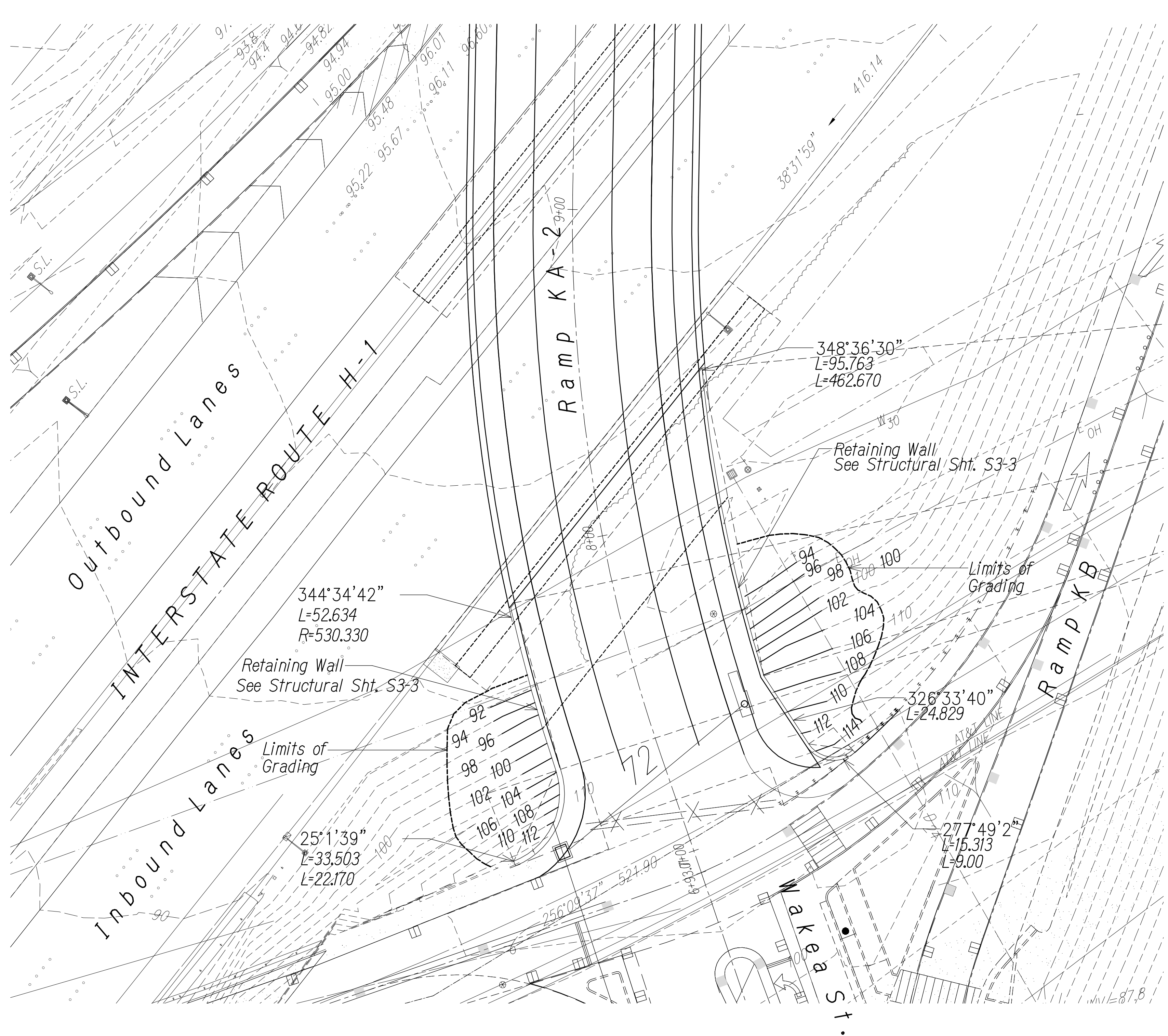

GRADING - ABUTMENT 2

Scale: 1" = 20'

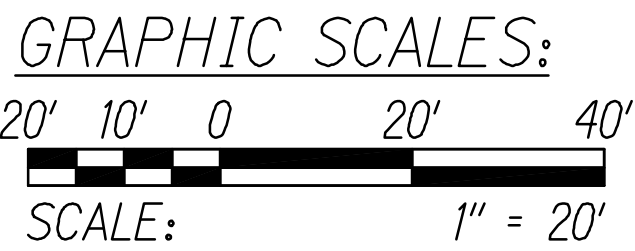

ORIGINAL PLAN	SURVEY PLOTTED BY	DATE
NOTE BOOK	DRAWN BY	
No.	DESIGNED BY	
	QUANTITIES BY	
	CHECKED BY	

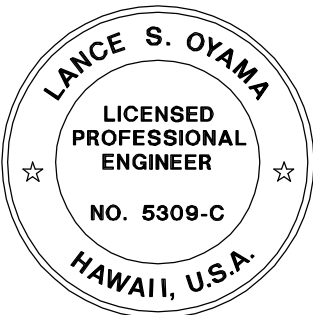

THIS WORK WAS PREPARED BY ME  
OR UNDER MY SUPERVISION.

WILSON OKAMOTO CORPORATION LIC. EXP. DATE  
APRIL 30, 2014

STATE OF HAWAII  
DEPARTMENT OF TRANSPORTATION  
HIGHWAYS DIVISION

GRADING - ABUTMENT 2  
INTERSTATE ROUTE H-1  
ADDITION AND MODIFICATION OF FREEWAY ACCESS  
(Kapolei Interchange Complex), Phase 2  
Federal-Aid Project No. 1M-HI-1

Scale: As Noted      Date: October 26, 2012

SHEET No. C-24 OF 33 SHEETS

DATE	REVISION
------	----------