

Attachment A
Erosion Control Plans and Details

FED. ROAD DIST. NO.	STATE	FED. AID PROJ. NO.	FISCAL YEAR	SHEET NO.	TOTAL SHEETS
HAWAII	HAW.	IM-HI-1	2013	47	381

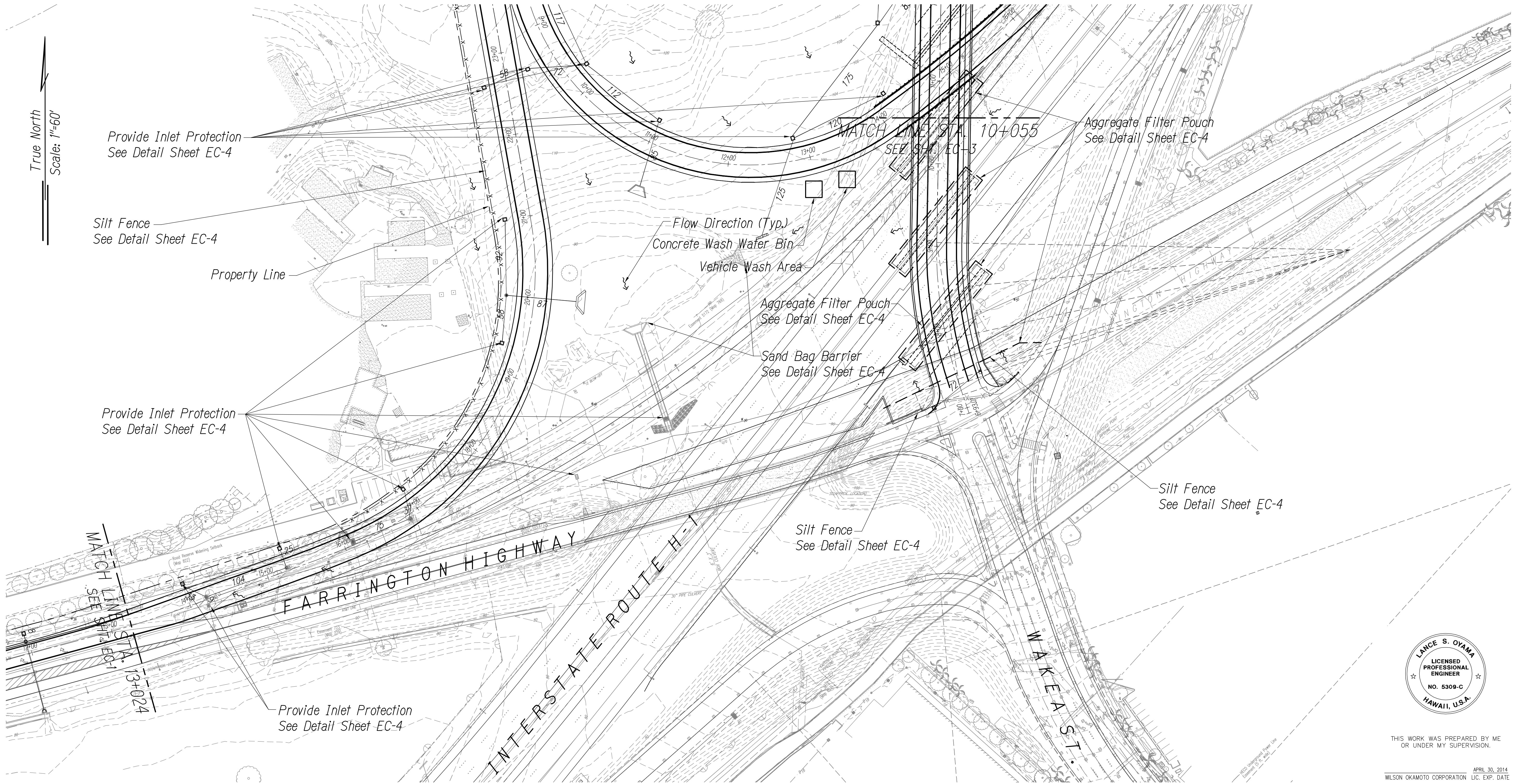

SURVEY PLOTTED BY	DATE
DRAWN BY	
DESIGNED BY	
QUANTITIES BY	
CHECKED BY	
ORIGINAL PLAN	
NOTE BOOK	
No.	

Legend:

- x-x-x- Temporary Silt Fence
- o-o-o- Barricade Fence with Dust Screen
- Aggregate Filter Pouch
- Surface Flow Direction
- Stabilized Construction Entrance

GRAPHIC SCALES:

60' 30' 0 60' 120'

SCALE: 1" = 60'

EROSION CONTROL PLAN

Scale: 1" = 60'

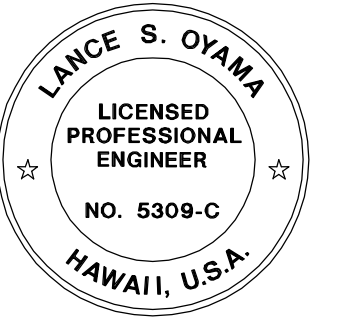

THIS WORK WAS PREPARED BY ME
OR UNDER MY SUPERVISION.

APRIL 30, 2014
WILSON OKAMOTO CORPORATION LIC. EXP. DATE

STATE OF HAWAII
DEPARTMENT OF TRANSPORTATION
HIGHWAYS DIVISION

EROSION CONTROL PLAN
INTERSTATE ROUTE H-1
ADDITION AND MODIFICATION OF FREEWAY ACCESS
(Kapolei Interchange Complex), Phase 2
Federal-Aid Project No. IM-HI-1

Scale: As Noted Date: October 26, 2012

SHEET No. BMP-2 OF 4 SHEETS

DATE	REVISION
------	----------

FED. ROAD DIST. NO.	STATE	FED. AID PROJ. NO.	FISCAL YEAR	SHEET NO.	TOTAL SHEETS
HAWAII	HAW.	IM-HI-1	2013	48	381

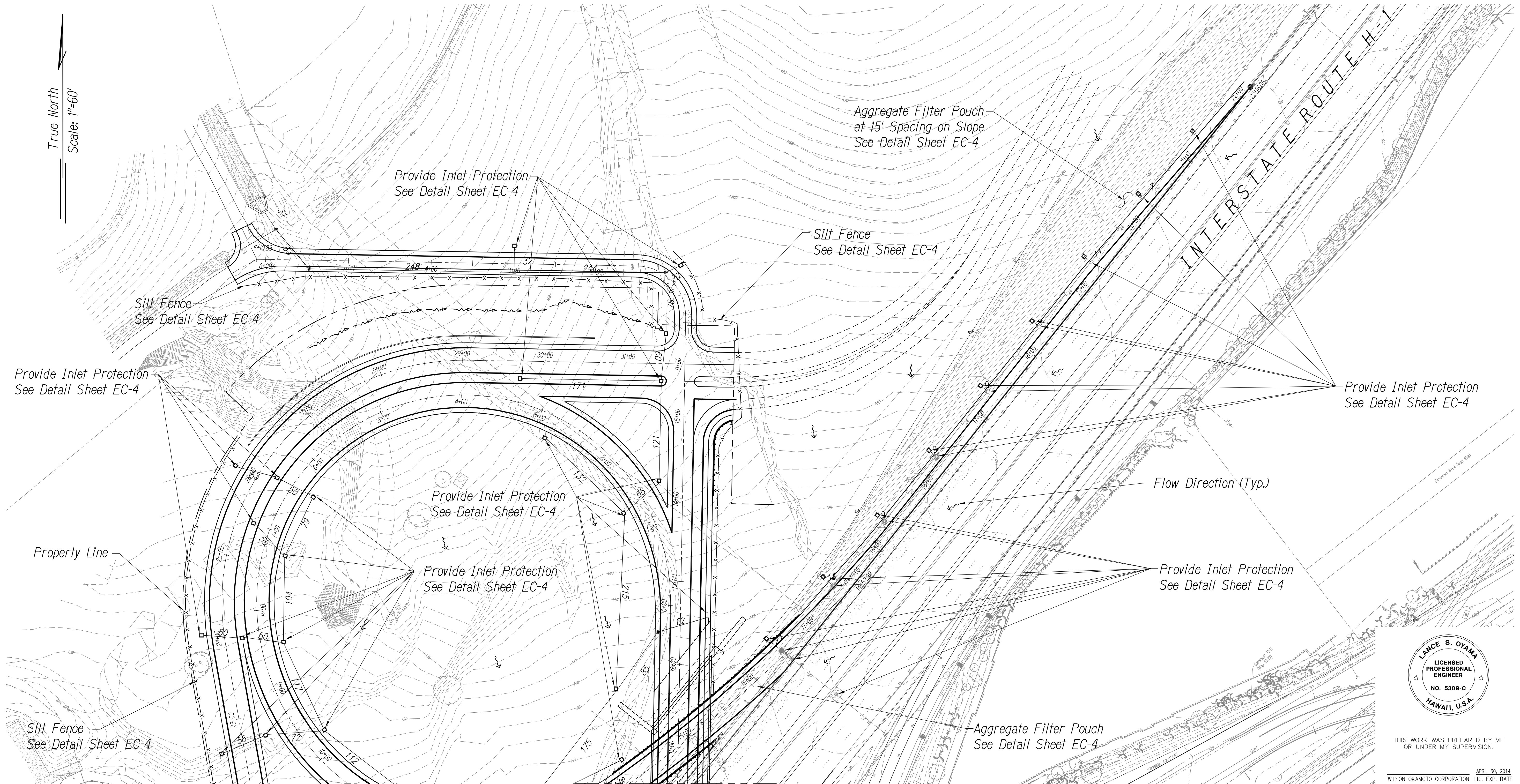

True North
Scale: 1"=60'

- Legend:**
- x-x-x- Temporary Silt Fence
 - o-o-o- Barricade Fence with Dust Screen
 - Aggregate Filter Pouch
 - Surface Flow Direction
 - Stabilized Construction Entrance

GRAPHIC SCALES:
60' 30' 0 60' 120'
SCALE: 1" = 60'

MATCH LINE STA. 10+055
SEE SHT. EC-2

EROSION CONTROL PLAN

Scale: 1" = 60'

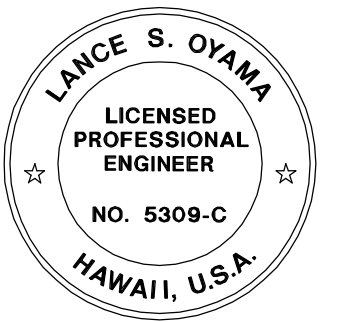

THIS WORK WAS PREPARED BY ME
OR UNDER MY SUPERVISION.

APRIL 30, 2014
WILSON OKAMOTO CORPORATION LIC. EXP. DATE

STATE OF HAWAII
DEPARTMENT OF TRANSPORTATION
HIGHWAYS DIVISION

EROSION CONTROL PLAN

INTERSTATE ROUTE H-1
ADDITION AND MODIFICATION OF FREEWAY ACCESS
(Kapolei Interchange Complex), Phase 2
Federal-Aid Project No. IM-HI-1

Scale: As Noted Date: October 26, 2012

SHEET No. BMP-30F 4 SHEETS

ORIGINAL PLAN	SURVEY PLOTTED BY	DATE
	DRAWN BY	"
	TRACED BY	"
	DESIGNED BY	"
NOTE BOOK	QUANTITIES BY	"
	CHECKED BY	"
	No.	

DATE	REVISION

FED. ROAD DIST. NO.	STATE	FED. AID PROJ. NO.	FISCAL YEAR	SHEET NO.	TOTAL SHEETS
HAWAII	HAW.	IM-HI-1	2013	49	381

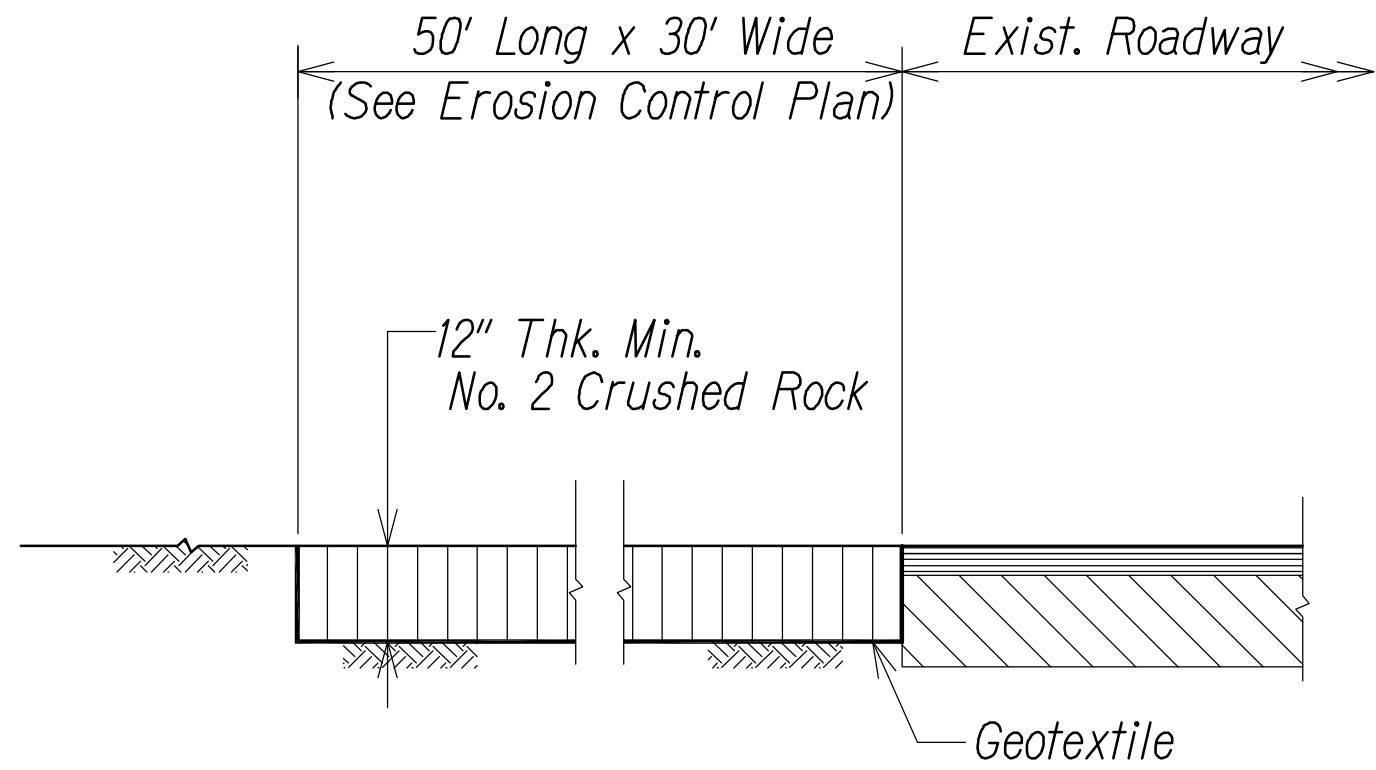

Note :
 12" Thick Minimum No. 2 Crushed Layer Shall Be Removed Immediately Prior To Installation Of Roadway base Course.

STABILIZED CONSTRUCTION ENTRANCE
Not to Scale

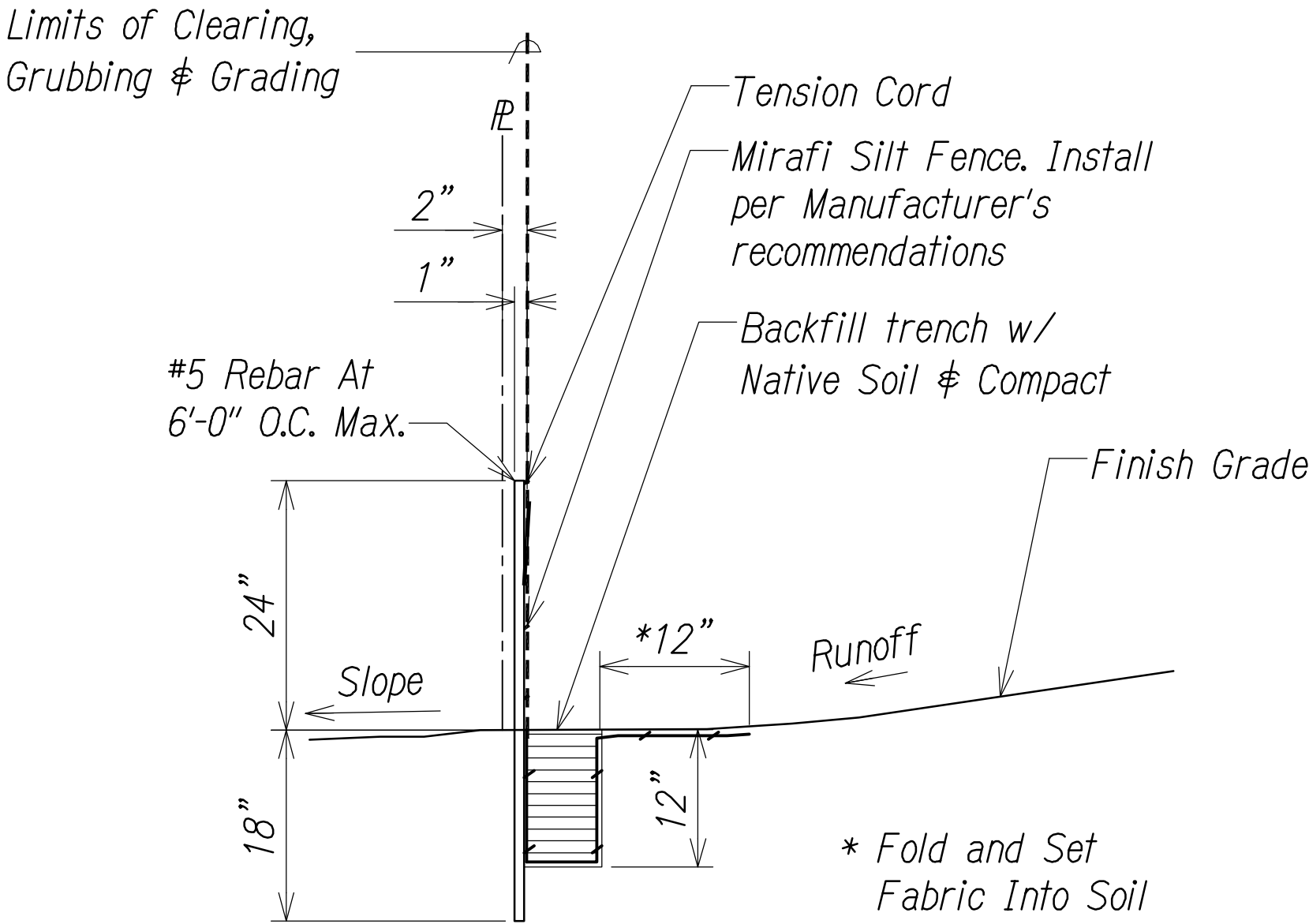

TEMPORARY SILT FENCE
Not to Scale

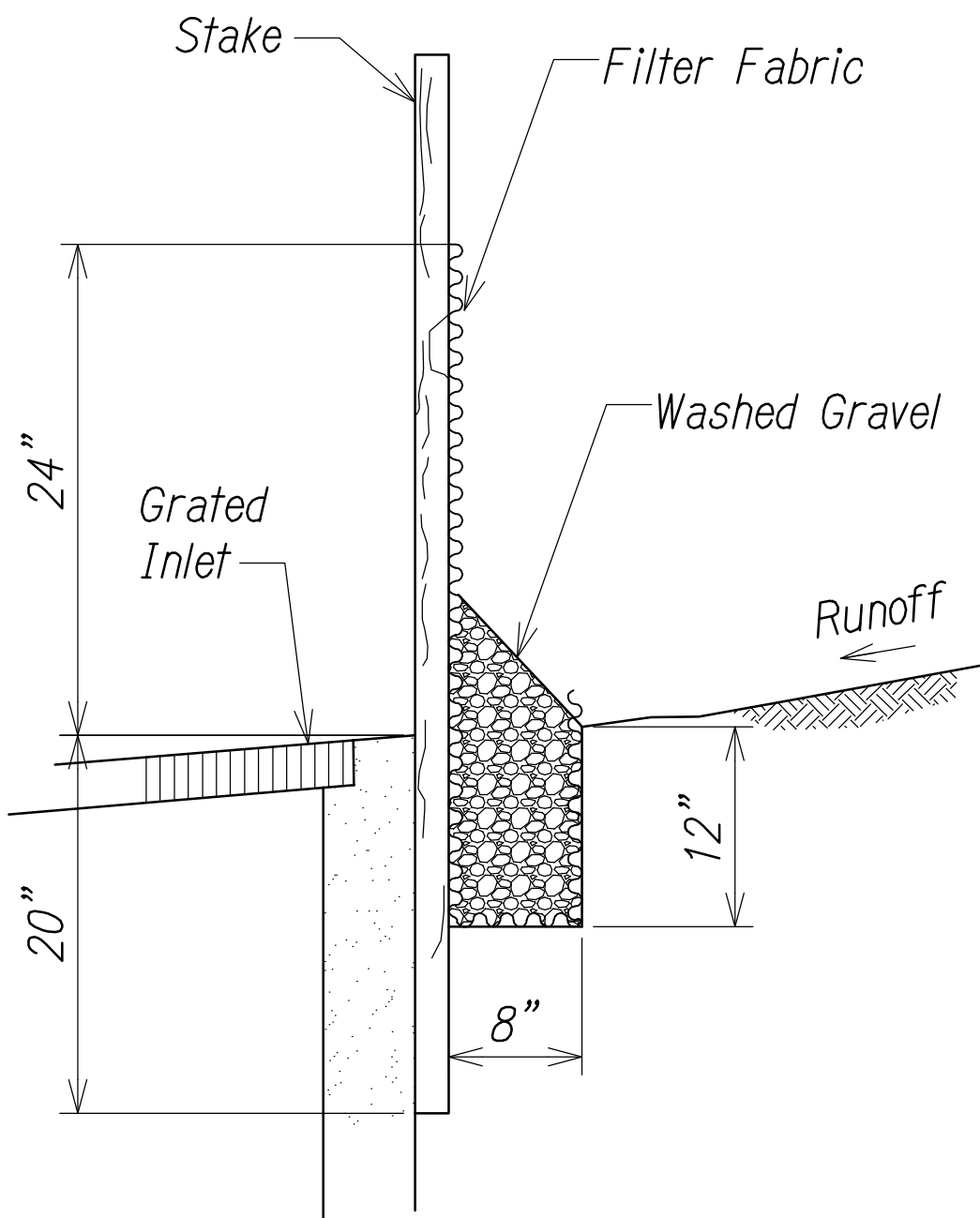

GRATED INLET PROTECTION
Not to Scale

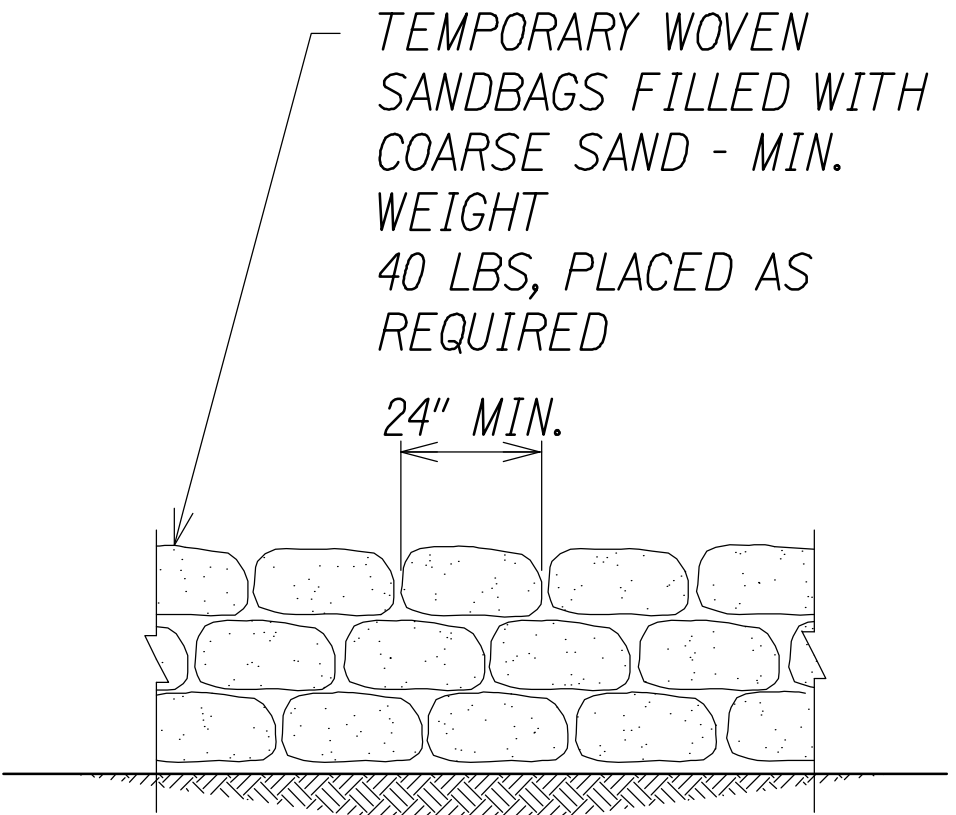

FRONT VIEW

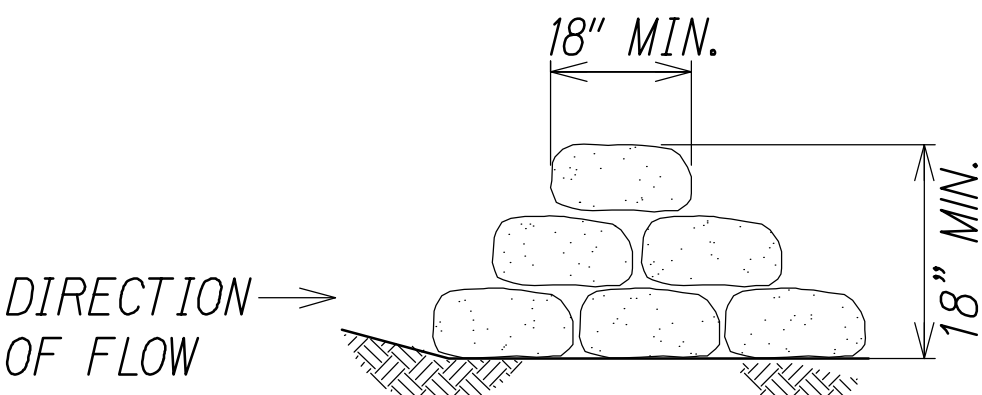

CROSS SECTION

SAND BAG BARRIER
Not to Scale

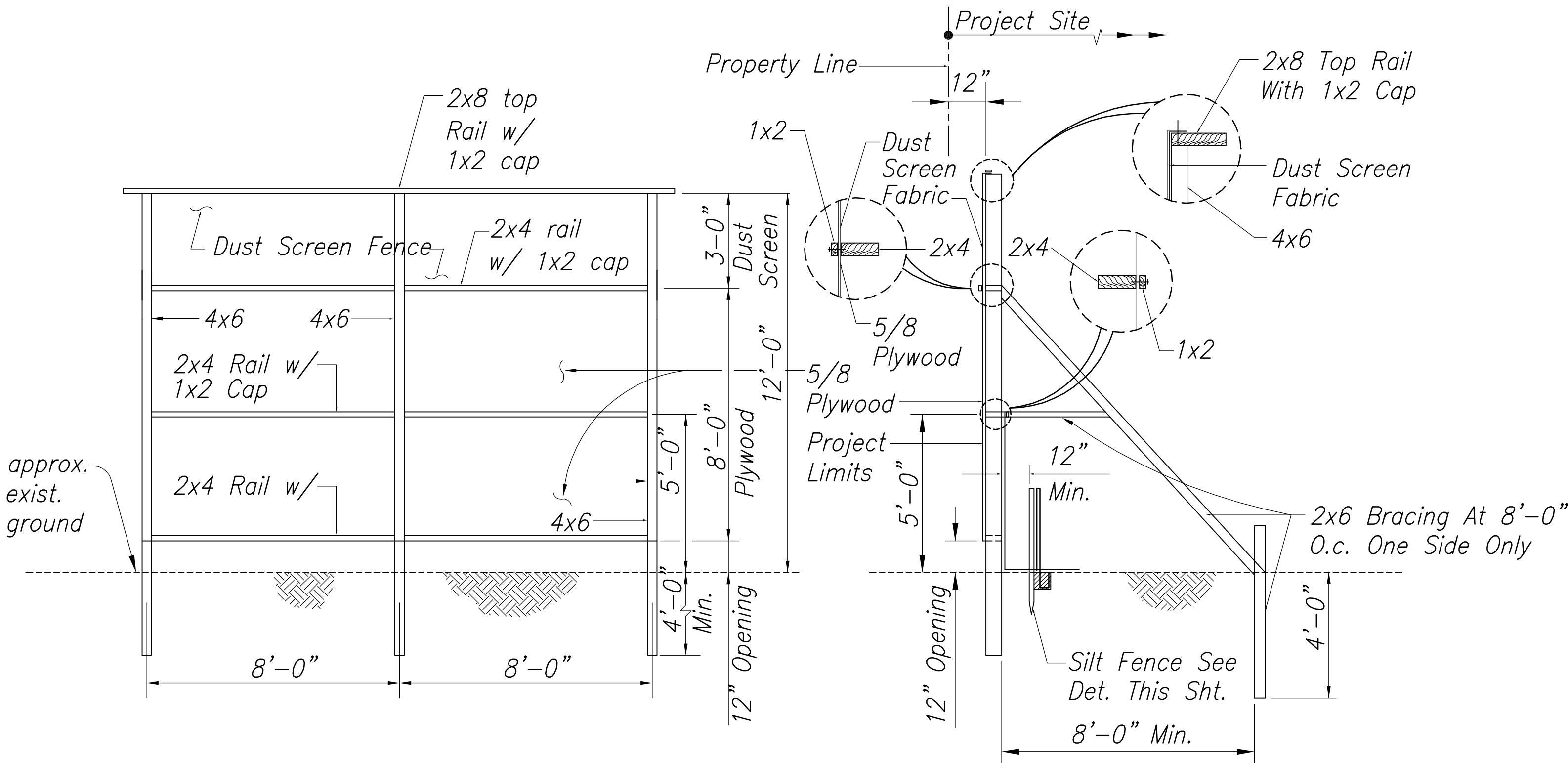

**8' HIGH PLYWOOD BARRICADE FENCE
 WITH DUST SCREEN DETAIL**
Not to Scale

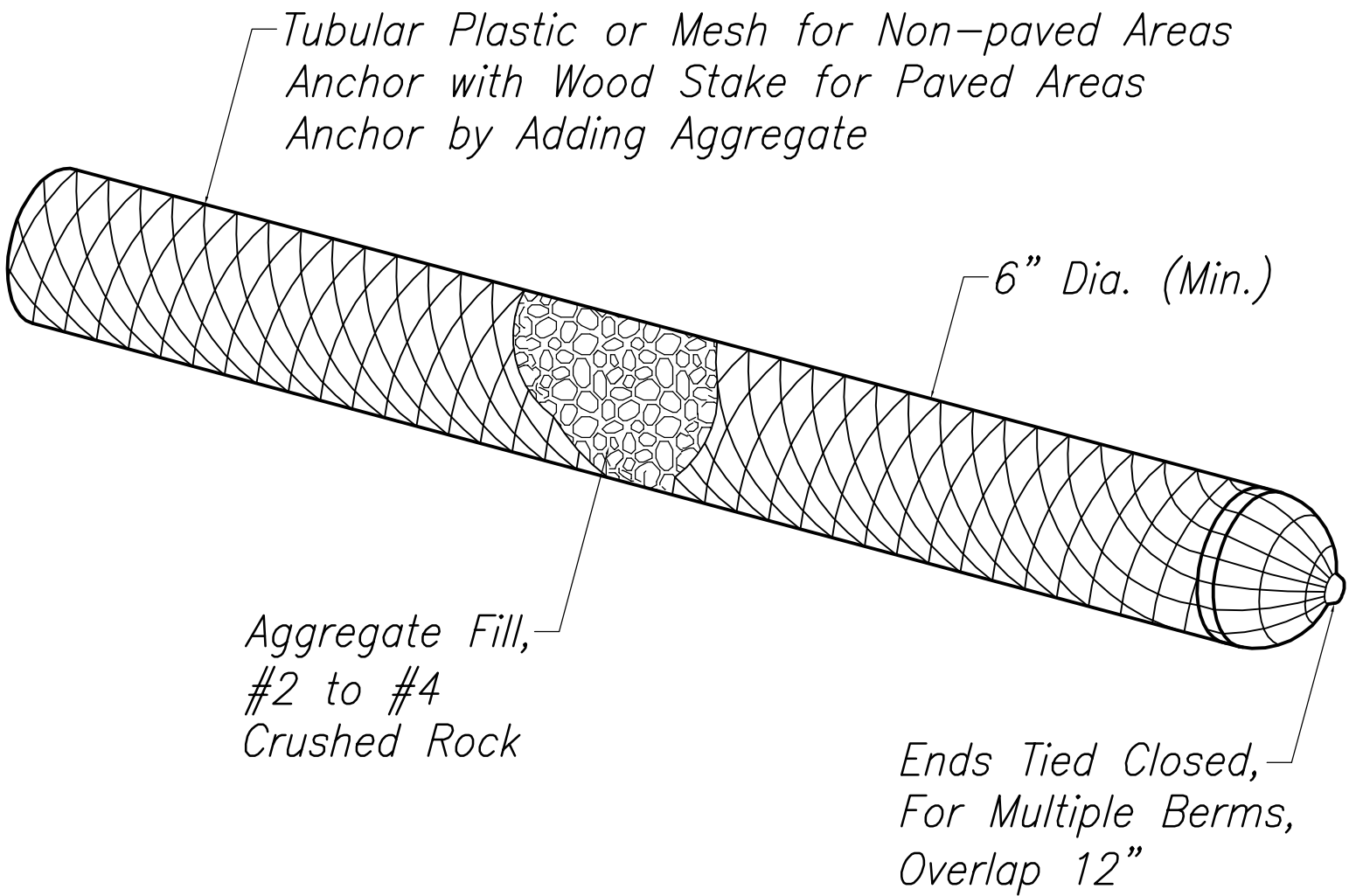

AGGREGATE FILTER POUCH
Not to Scale

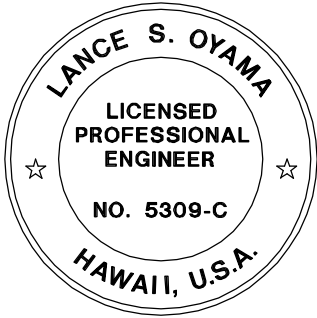

THIS WORK WAS PREPARED BY ME
 OR UNDER MY SUPERVISION.

APRIL 30, 2014
 WILSON OKAMOTO CORPORATION L.C. EXP. DATE

STATE OF HAWAII

DEPARTMENT OF TRANSPORTATION

HIGHWAYS DIVISION

EROSION CONTROL DETAILS

INTERSTATE ROUTE HI-1

ADDITION AND MODIFICATION OF FREEWAY ACCESS

(Kapolei Interchange Complex), Phase 2

Federal-Aid Project No. IM-HI-1

Scale: As Noted

Date: October 26, 2012

SURVEY PLOTTED BY	DATE
DRAWN BY	
DESIGNED BY	
QUANTITIES BY	
CHECKED BY	
ORIGINAL PLAN	
NOTE BOOK	
No.	

DATE	REVISION