

FED. ROAD DIST. NO.	STATE	FED. AID PROJ. NO.	FISCAL YEAR	SHEET NO.	TOTAL SHEETS
HAWAII	HAW.	IM-H1-1(242)	2016	325	354

SCALE: 1" = 300'
TRUE NORTH

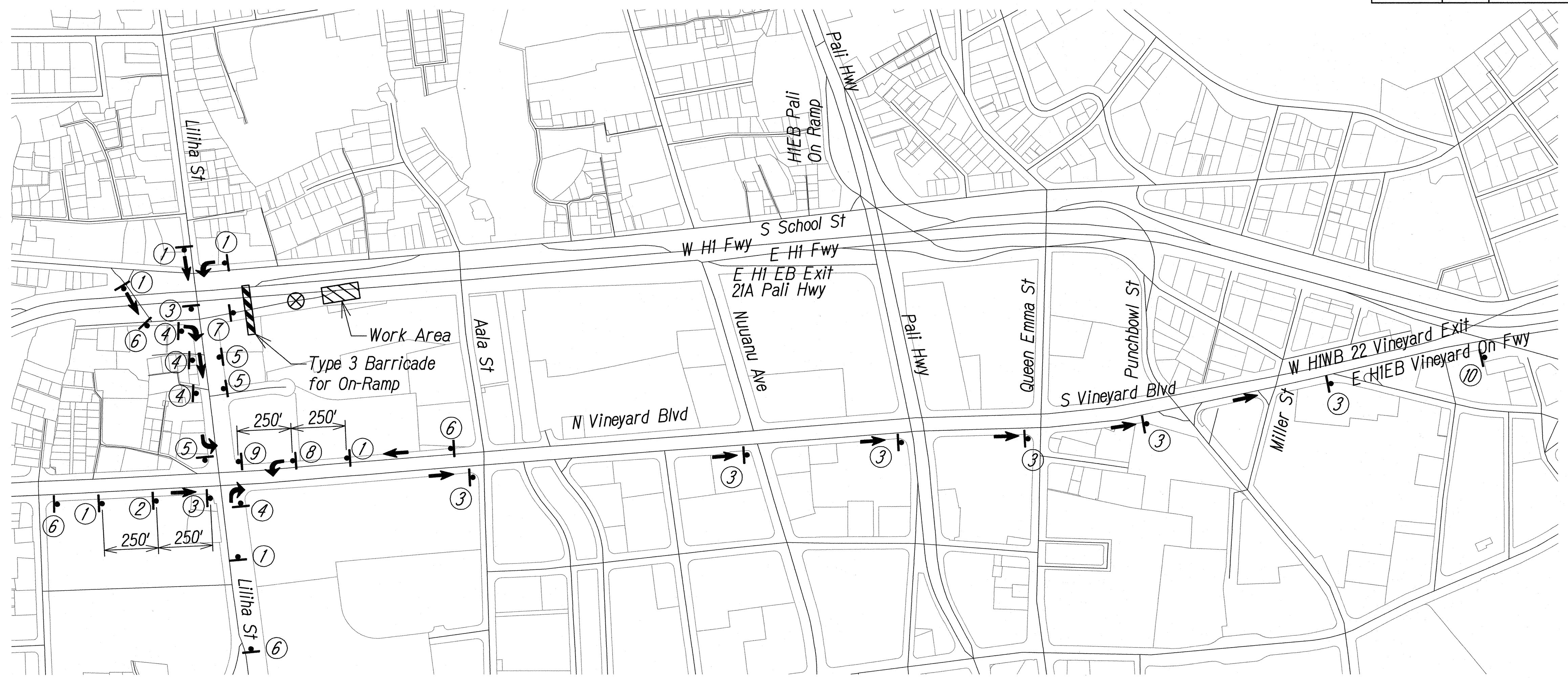

①

H-1 EB

DETOUR AHEAD

CW20-2D
48" X 48"

②

H-1 EB

DETOUR AHEAD

CUSTOM
30" X 30"
R3-17aP 24" X 8"

③

H-1 EB

DETOUR

CUSTOM
30" X 30"

④

H-1 EB

DETOUR

CM4-9R
30" X 24"

⑤

H-1 EB

DETOUR

CM4-9L
30" X 24"

⑥

H-1 EAST RAMP CLOSED

Variable Message Sign
Phase 1

⑥

USE DETOUR

Variable Message Sign
Phase 2

⑦

H-1 EAST RAMP CLOSED

Variable Message Sign
Phase 1

⑦

USE ALT ROUTE

Variable Message Sign
Phase 2

⑧

H-1 EB

DETOUR

U-turn

AHEAD

CM4-9
30" X 24"
W17-1L
30" X 30"
R3-17aP
24" X 8"

⑨

H-1 EB

DETOUR

U-turn

CM4-9
30" X 24"
W17-1L
30" X 30"

⑩

END DETOUR

CM4-8A
24" X 18"

- Legend:**
- ⊗ Special Duty Officer
 - Sign
 - ➔ Flow of Traffic
 - ▨ Type 3 Barricade

GRAPHIC SCALE:
300' 150' 0 300' 600'

SCALE: 1" = 300'

- NOTES:**
1. Work hours to occur between 9:00 p.m. and 4:00 a.m. (Friday night through Monday morning).
 2. Directional detour signs shall be placed on both sides of the travel way when medians are present on multi-lanes streets.
 3. See TC-26, and TC-27 for lane closure.
 4. See TCD-1 for street name sign detail.

PHASE 4 - LILIHA ST ON-RAMP EASTBOUND
TEMPORARY CLOSURE
(DURATION: 3 DAYS)
(FRIDAY 9:30 AM TO MONDAY 4:00 AM)
SCALE: 1" = 300'

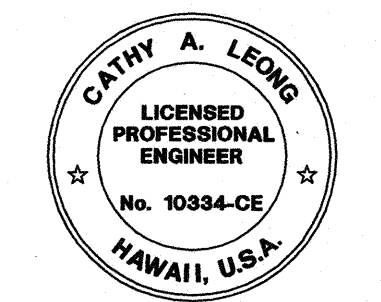

THIS WORK WAS PREPARED BY ME
OR UNDER MY SUPERVISION.

Cathy A. Leong APRIL 30, 2018
WILSON OKAMOTO CORPORATION LIC. EXP. DATE

STATE OF HAWAII
DEPARTMENT OF TRANSPORTATION
HIGHWAYS DIVISION

DETOUR PLAN

INTERSTATE ROUTE H-1
GUARDRAIL AND SHOULDER IMPROVEMENTS
Middle Street to Punchbowl Off-Ramp
Fed. Aid Project No. IM-H1-1(242)
Scale: 1" = 300' Date: Mar. 2016

SHEET No. TD-1 OF 8 SHEETS

SURVEY PLOTTED BY	DATE
DRAWN BY	
TRACED BY	
DESIGNED BY	
QUANTITIES BY	
CHECKED BY	
ORIGINAL PLAN	No.
NOTE BOOK	

FED. ROAD DIST. NO.	STATE	FED. AID PROJ. NO.	FISCAL YEAR	SHEET NO.	TOTAL SHEETS
HAWAII	HAW.	1M-H1-1(242)	2016	326	354

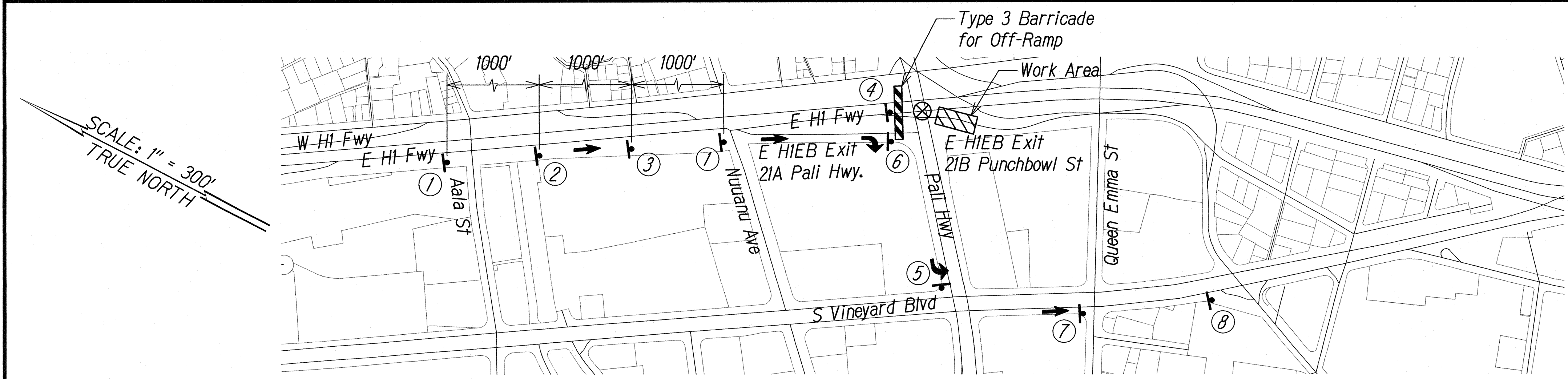

①

 Variable Message Sign
 Phase 1

①

 Variable Message Sign
 Phase 2

②

 CW20-2(2000)
 48" X 48"

③

 CW20-2(1000)
 48" X 48"

④

 Variable Message Sign
 Phase 1

④

 Variable Message Sign
 Phase 2

⑤

 CM4-9L
 30" X 24"

⑥

 CM4-9R
 30" X 24"

⑦

 CUSTOM
 30" X 30"

⑧

 CM4-8A
 24" X 18"

- Legend:**
- ⊗ Special Duty Officer
 - Sign
 - Flow of Traffic
 - ▤ Type 3 Barricade

GRAPHIC SCALE:
 300' 150' 0 300' 600'
 SCALE: 1" = 300'

- NOTES:**
1. Work hours to occur between 9:00 p.m. and 4:00 a.m. (Monday night through Friday morning).
 2. Directional detour signs shall be placed on both sides of the travel way when medians are present on multi-lanes streets.
 3. See TC-33, TC-34, TC-35 and TC-36 for lane closure.
 4. See TCD-1 for street name sign detail.

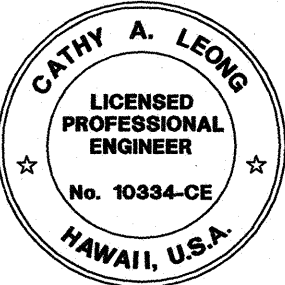

THIS WORK WAS PREPARED BY ME
 OR UNDER MY SUPERVISION.
Cathy A. Leong APRIL 30, 2016
 WILSON OKAMOTO CORPORATION LIC. EXP. DATE

STATE OF HAWAII
DEPARTMENT OF TRANSPORTATION
HIGHWAYS DIVISION

DETOUR PLAN
INTERSTATE ROUTE H-1
GUARDRAIL AND SHOULDER IMPROVEMENTS
Middle Street to Punchbowl Off-Ramp
Fed. Aid Project No. 1M-H1-1(242)
Scale: 1" = 300' Date: Mar. 2016
SHEET No. TD-2 OF 8 SHEETS

PHASE 5 - PUNCHBOWL ST OFF-RAMP EASTBOUND
 TEMPORARY CLOSURE
 (DURATION: 1 WEEK)
 SCALE: 1" = 300'

SURVEY PLOTTED BY	DATE
DRAWN BY	
TRACED BY	
DESIGNED BY	
QUANTITY BY	
CHECKED BY	
ORIGINAL PLAN	
NOTE BOOK	
No.	

FED. ROAD DIST. NO.	STATE	FED. AID PROJ. NO.	FISCAL YEAR	SHEET NO.	TOTAL SHEETS
HAWAII	HAW.	1M-H1-1(242)	2016	327	354

SCALE: 1" = 300'
TRUE NORTH



1

ROAD WORK AHEAD

CW21-4D
48" X 48"

2

DETOUR 1000 FT

CW20-2(1000)
48" X 48"

3

FREEWAY ON-RAMP CLOSED

Variable Message Sign
Phase 1

3

USE ALT ROUTE

Variable Message Sign
Phase 2

4

H-1 EB
DETOUR

CM4-9L
30" X 24"

5

H-1 EB
DETOUR
AHEAD

CM4-9L
30" X 24"
R3-17aP
24" X 8"

6

H-1 EB
DETOUR

CUSTOM
30" X 30"

7

END DETOUR

CM4-8A
24" X 18"

8

FREEWAY ON-RAMP CLOSED

Variable Message Sign
Phase 1

8

USE DETOUR

Variable Message Sign
Phase 2

- Legend:**
- ⊗ Special Duty Officer
 - Sign
 - Flow of Traffic
 - ▨ Type 3 Barricade

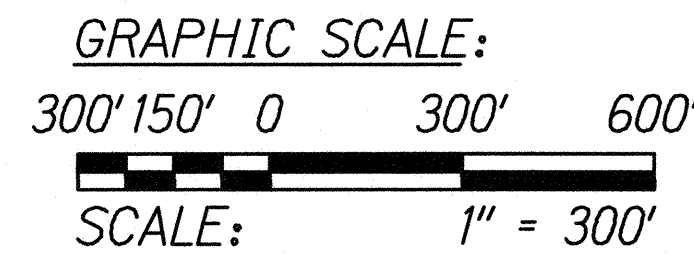

PHASE 5 - PALI HWY ON-RAMP EASTBOUND
TEMPORARY CLOSURE
(DURATION: 1 WEEK)
SCALE: 1" = 300'

- NOTES:**
- Work hours to occur between 9:00 p.m. and 4:00 a.m. (Monday night through Friday morning).
 - Directional detour signs shall be placed on both sides of the travel way when medians are present on multi-lanes streets.
 - See TC-39, TC-40, and TC-41 for lane closure.
 - See TCD-1 for street name sign detail.

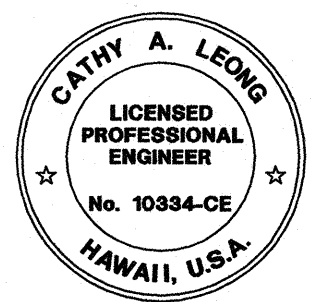

THIS WORK WAS PREPARED BY ME
OR UNDER MY SUPERVISION.
Cathy A. Leong
WILSON OKAMOTO CORPORATION APRIL 30, 2016
LIC. EXP. DATE

STATE OF HAWAII
DEPARTMENT OF TRANSPORTATION
HIGHWAYS DIVISION

DETOUR PLAN

INTERSTATE ROUTE H-1
GUARDRAIL AND SHOULDER IMPROVEMENTS
Middle Street to Punchbowl Off-Ramp
Fed. Aid Project No. 1M-H1-1(242)
Scale: 1" = 300' Date: Mar. 2016

SHEET No. TD-3 OF 8 SHEETS

SURVEY PLOTTED BY	DATE
DRAWN BY	
TRACED BY	
DESIGNED BY	
QUANTITIES BY	
CHECKED BY	
ORIGINAL PLAN	No.
NOTE BOOK	

FED. ROAD DIST. NO.	STATE	FED. AID PROJ. NO.	FISCAL YEAR	SHEET NO.	TOTAL SHEETS
HAWAII	HAW.	1M-H1-1(242)	2016	328	354

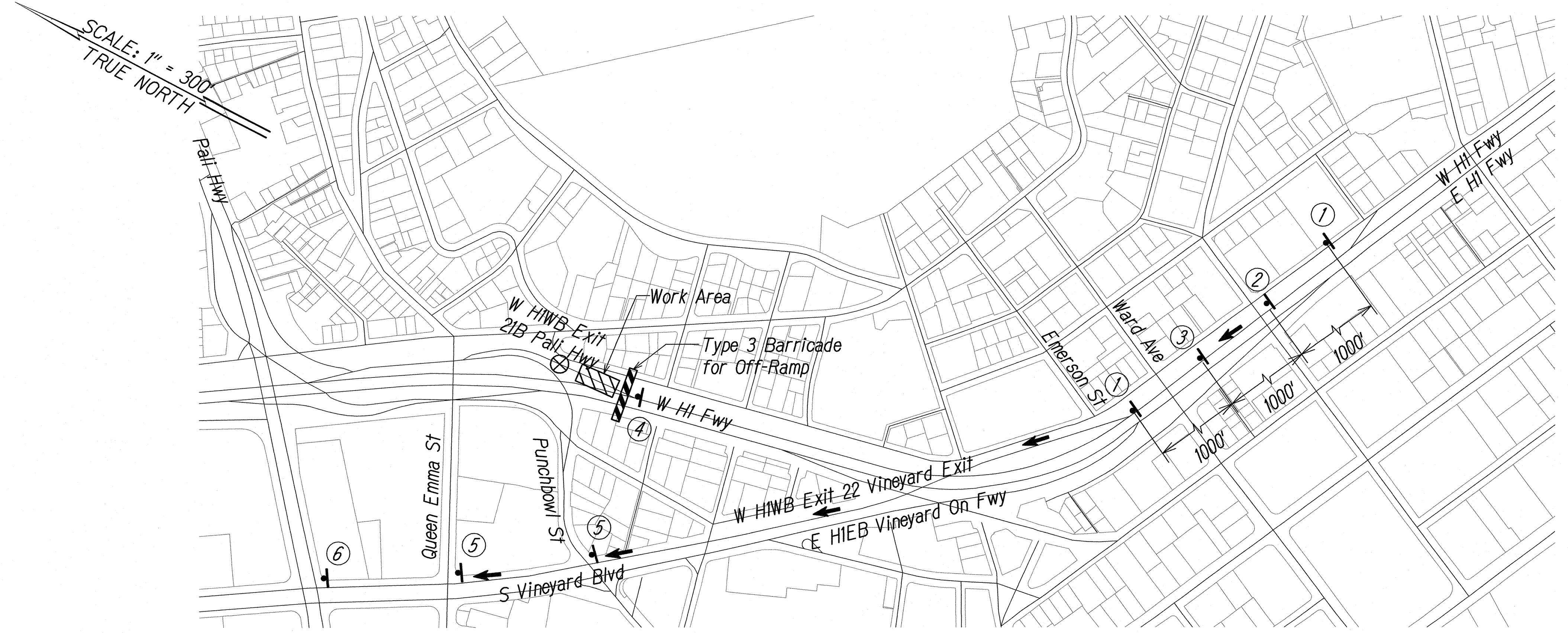

1

PALI HWY
RAMP
CLOSED

Variable Message Sign
Phase 1

1

USE
VINEYARD
OFF RAMP

Variable Message Sign
Phase 2

2

DETOUR
2000 FT

CW20-2(2000)
48" X 48"

3

DETOUR
1000 FT

CW20-2(1000)
48" X 48"

1

RAMP
CLOSED

Variable Message Sign
Phase 1

1

USE
ALT
ROUTE

Variable Message Sign
Phase 2

5

Pali Hwy
DETOUR
↑
CUSTOM
30" X 30"

6

END
DETOUR

CM4-8A
24" X 18"

- Legend:
- ⊗ Special Duty Officer
 - Sign
 - ➔ Flow of Traffic
 - ▨▨▨ Type 3 Barricade

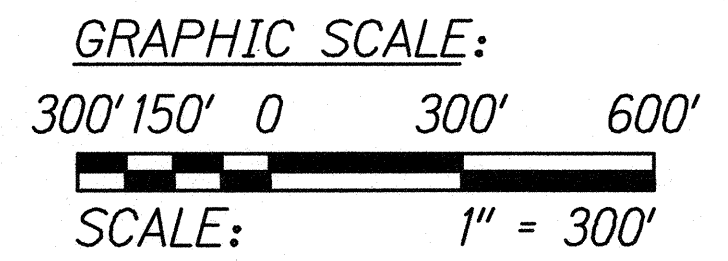

- NOTES:
1. Work hours to occur between 9:00 p.m. and 4:00 a.m. (Monday night through Friday morning).
 2. Directional detour signs shall be placed on both sides of the travel way when medians are present on multi-lanes streets.
 3. See TC-46 and TC-47 for lane closure.
 4. See TCD-1 for street name sign detail.

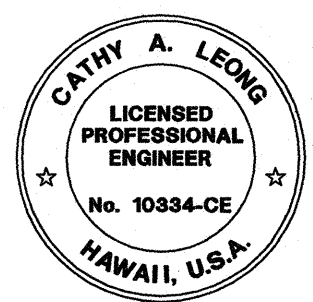

THIS WORK WAS PREPARED BY ME
OR UNDER MY SUPERVISION.
Cathy A. Leong
WILSON OKAMOTO CORPORATION APRIL 30, 2016
LIC. EXP. DATE

SURVEY PLOTTED BY	DATE
DRAWN BY	
TRACED BY	
DESIGNED BY	
QUANTITIES BY	
CHECKED BY	
ORIGINAL PLAN	
NOTE BOOK	
No.	

PHASE 6 - PALI HWY OFFRAMP EASTBOUND
TEMPORARY CLOSURE
(DURATION: 1 WEEK)
SCALE: 1" = 300'

STATE OF HAWAII
DEPARTMENT OF TRANSPORTATION
HIGHWAYS DIVISION

DETOUR PLAN

INTERSTATE ROUTE H-1
GUARDRAIL AND SHOULDER IMPROVEMENTS
Middle Street to Punchbowl Off-Ramp
Fed. Aid Project No. 1M-H1-1(242)
Scale: 1" = 300' Date: Mar. 2016

SHEET No. TD-4 OF 8 SHEETS

FED. ROAD DIST. NO.	STATE	FED. AID PROJ. NO.	FISCAL YEAR	SHEET NO.	TOTAL SHEETS
HAWAII	HAW.	IM-HI-1(242)	2016	329	354



1

Pali Hwy
H-1 WB

CW20-2D
48" X 48"

2

Pali Hwy
H-1 WB

CM4-9L
30" X 24"

3

Pali Hwy
H-1 WB

CUSTOM
30" X 30"

4

Pali Hwy
H-1 WB

CM4-9L
30" X 24"
W17-1L
30" X 30"

5

Pali Hwy
H-1 WB

CM4-9
30" X 24"
W17-1L
30" X 30"
R3-17aP
24" X 8"

6

Pali Hwy
H-1 WB

CM4-9
30" X 24"
W17-1L
30" X 30"

7

Pali Hwy
H-1 WB

CM4-9R
30" X 24"

8

Variable Message Sign
Phase 1

8

Variable Message Sign
Phase 2

9

H-1 WB

CUSTOM
30" X 30"

10

CM4-8A
24" X 18"

- Legend:**
- ⊗ Special Duty Officer
 - Sign
 - ➔ Direction of Traffic
 - ▨ Type 3 Barricade

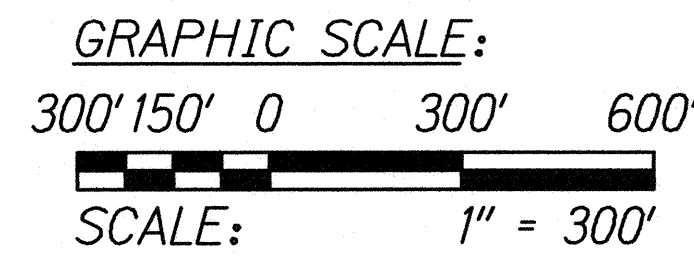

- NOTES:**
1. Work hours to occur between 9:00 p.m. and 4:00 a.m. (Monday night through Friday morning).
 2. Directional detour signs shall be placed on both sides of the travel way when medians are present on multi-lanes streets.
 3. See TC-50 and TC-51 for lane closure.
 4. See TCD-1 for street name sign detail.

PHASE 6 - PUNCHBOWL ST UNDERPASS
 TEMPORARY CLOSURE
 (DURATION: 1 WEEK)
 SCALE: 1" = 300'

Variable Message Sign
Phase 1

Variable Message Sign
Phase 2

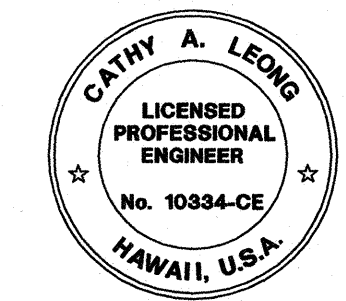

THIS WORK WAS PREPARED BY ME
 OR UNDER MY SUPERVISION.
Cathy A. Leong
 WILSON OKAMOTO CORPORATION APRIL 30, 2016
 LIC. EXP. DATE

STATE OF HAWAII
 DEPARTMENT OF TRANSPORTATION
 HIGHWAYS DIVISION

DETOUR PLAN

INTERSTATE ROUTE H-1
 GUARDRAIL AND SHOULDER IMPROVEMENTS
 Middle Street to Punchbowl Off-Ramp
 Fed. Aid Project No. IM-HI-1(242)
 Scale: 1" = 300' Date: Mar. 2016

SHEET No. TD-5 OF 8 SHEETS

SURVEY PLOTTED BY	DATE
DRAWN BY	
TRACED BY	
DESIGNED BY	
QUANTITIES BY	
CHECKED BY	
ORIGINAL PLAN	No.
NOTE BOOK	

FED. ROAD DIST. NO.	STATE	FED. AID PROJ. NO.	FISCAL YEAR	SHEET NO.	TOTAL SHEETS
HAWAII	HAW.	1M-HI-1(242)	2016	330	354



①

H-1 WB

DETOUR AHEAD

CW20-2D
48" X 48"

②

H-1 WB

DETOUR

CM4-9L
30" X 24"

③

H-1 WB

DETOUR

CUSTOM
30" X 30"

④

H-1 WB

DETOUR AHEAD

CM4-9L
30" X 24"
W17-1L
30" X 30"

⑤

H-1 WB

DETOUR

AHEAD

CM4-9
30" X 24"
W17-1L
30" X 30"
R3-17aP
24" X 8"

⑥

H-1 WB

DETOUR

CM4-9
30" X 24"
W17-1L
30" X 30"

⑦

H-1 WB

DETOUR

CM4-9R
30" X 24"

⑧

FREEWAY ON-RAMP CLOSED

Variable Message Sign
Phase 1

⑧

USE ALT ROUTE

Variable Message Sign
Phase 2

⑨

END DETOUR

CM4-8A
24" X 18"

⑩

FREEWAY ON-RAMP CLOSED

Variable Message Sign
Phase 1

⑩

USE DETOUR

Variable Message Sign
Phase 2

- Legend:**
- ⊗ Special Duty Officer
 - Sign
 - ➔ Direction of Traffic
 - ▨ Type 3 Barricade

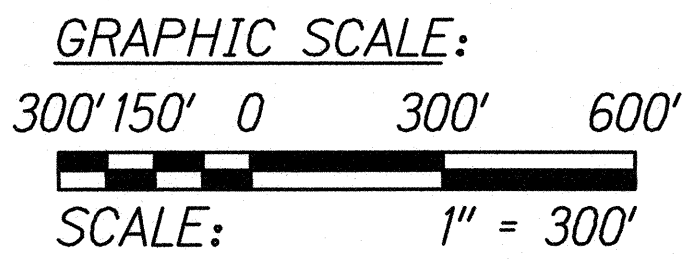

- NOTES:**
1. Work hours to occur between 9:00 p.m. and 4:00 a.m. (Monday night through Friday morning).
 2. Directional detour signs shall be placed on both sides of the travel way when medians are present on multi-lanes streets.
 3. See TC-54 and TC-55 for lane closure.
 4. See TCD-1 for street name sign detail.

PHASE 7 - PUNCHBOWL ST ON-RAMP WESTBOUND
TEMPORARY CLOSURE
(DURATION: 1 WEEK)
SCALE: 1" = 300'

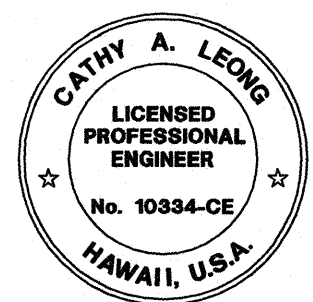

THIS WORK WAS PREPARED BY ME
OR UNDER MY SUPERVISION.
Cathy A. Leong
WILSON OKAMOTO CORPORATION LIC. EXP. DATE

STATE OF HAWAII
DEPARTMENT OF TRANSPORTATION
HIGHWAYS DIVISION

DETOUR PLAN

INTERSTATE ROUTE H-1
GUARDRAIL AND SHOULDER IMPROVEMENTS
Middle Street to Punchbowl Off-Ramp
Fed. Aid Project No. 1M-HI-1(242)
Scale: 1" = 300' Date: Mar. 2016

SHEET No. TD-6 OF 8 SHEETS

FED. ROAD DIST. NO.	STATE	FED. AID PROJ. NO.	FISCAL YEAR	SHEET NO.	TOTAL SHEETS
HAWAII	HAW.	IM-HI-1(242)	2016	331	354

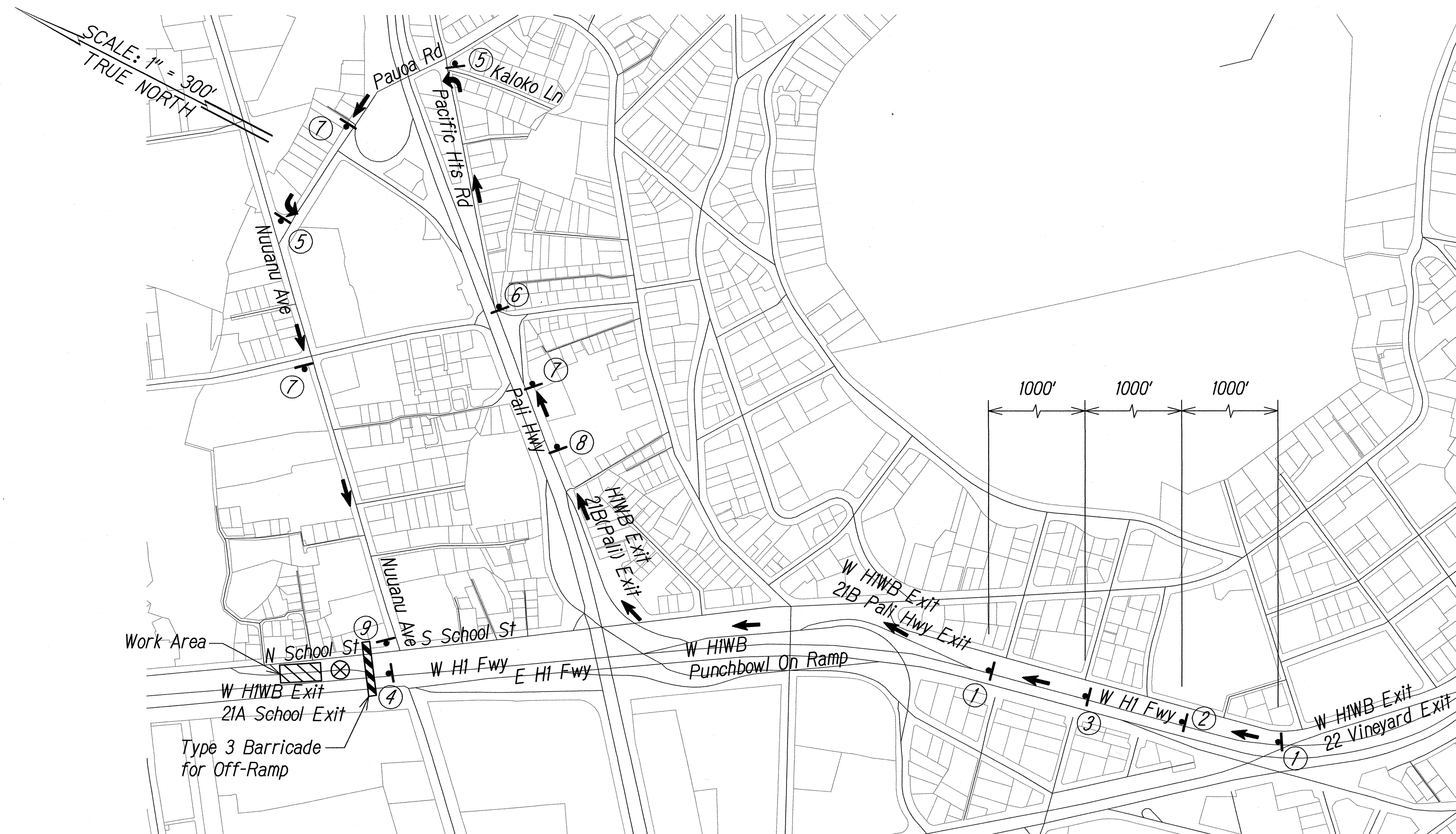

Legend:

- ⊗ Special Duty Officer
- Sign
- Flow of Traffic
- ▨ Type 3 Barricade

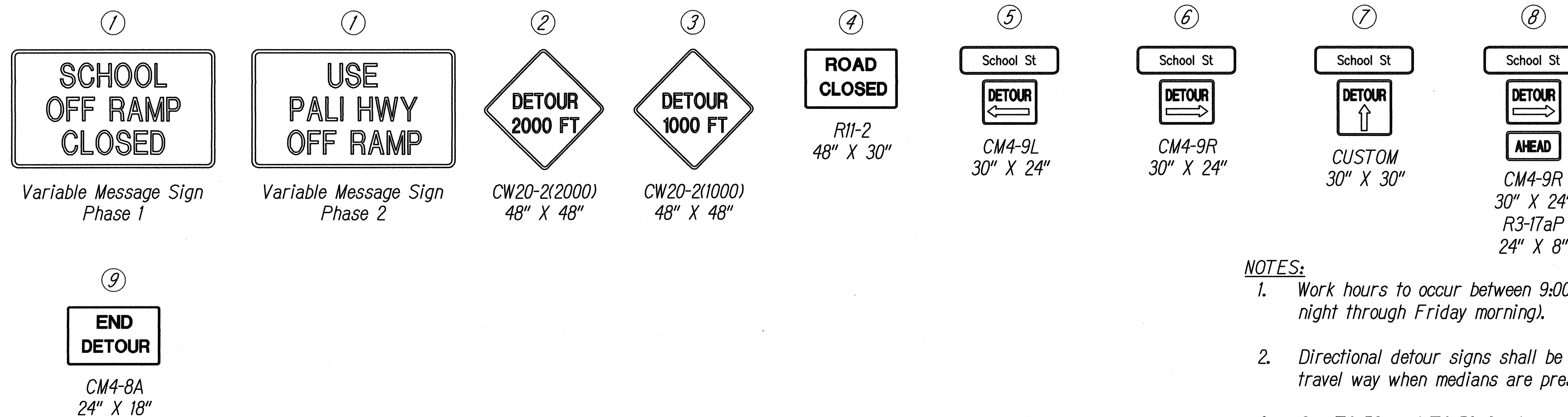

NOTES:

1. Work hours to occur between 9:00 p.m. and 4:00 a.m. (Monday night through Friday morning).
2. Directional detour signs shall be placed on both sides of the travel way when medians are present on multi-lanes streets.
3. See TC-58, and TC-59 for lane closure.
4. See TCD-1 for street name sign detail.

PHASE 8 - SCHOOL ST OFF-RAMP WESTBOUND

TEMPORARY CLOSURE
(DURATION: 1 WEEK)
SCALE: 1" = 300'

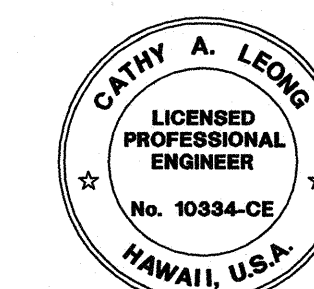

THIS WORK WAS PREPARED BY ME
OR UNDER MY SUPERVISION.
Cathy A. Leong
WILSON OKAMOTO CORPORATION LIC. EXP. DATE

STATE OF HAWAII
DEPARTMENT OF TRANSPORTATION
HIGHWAYS DIVISION

DETOUR PLAN

INTERSTATE ROUTE H-1
GUARDRAIL AND SHOULDER IMPROVEMENTS
Middle Street to Punchbowl Off-Ramp
Fed. Aid Project No. IM-HI-1(242)
Scale: 1" = 300' Date: Mar. 2016

SHEET No. *TD-7* OF 8 SHEETS

FED. ROAD DIST. NO.	STATE	FED. AID PROJ. NO.	FISCAL YEAR	SHEET NO.	TOTAL SHEETS
HAWAII	HAW.	IM-HI-1(242)	2016	332	354

SCALE: 1" = 300'
TRUE NORTH

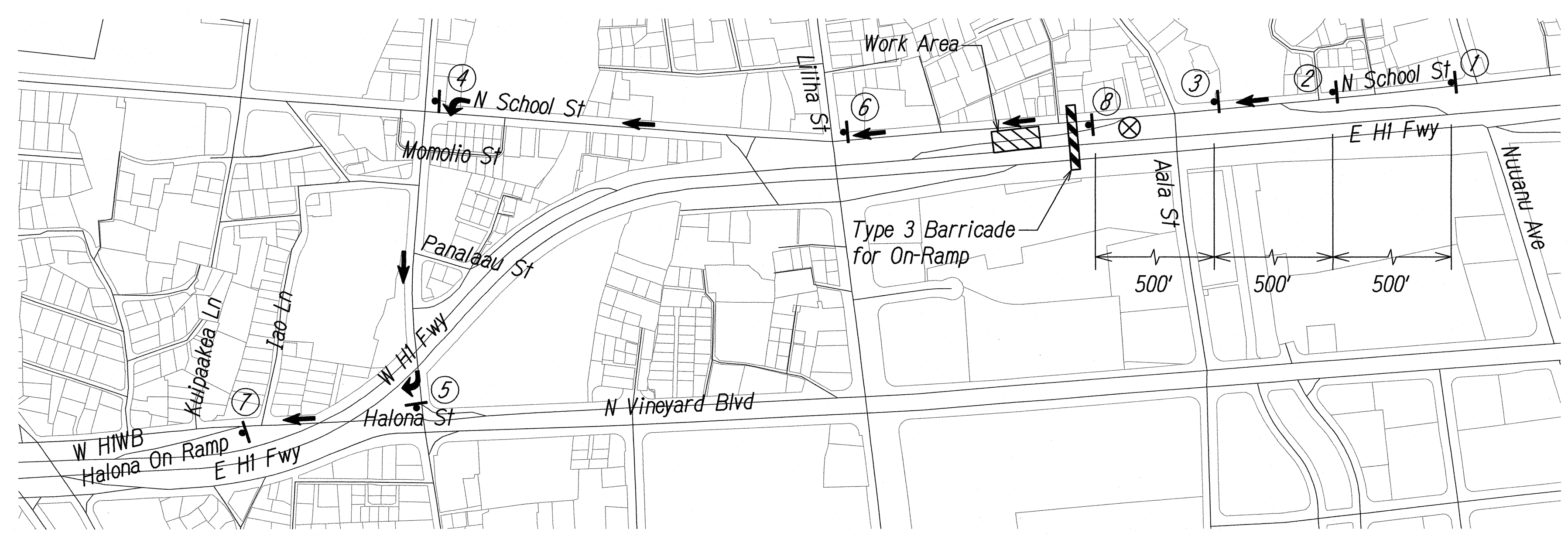

1

 ROAD WORK AHEAD
 CW21-4D
 48" X 48"

2

 DETOUR 1000 FT
 CW20-2(1000)
 48" X 48"

3

 RAMP CLOSED 500 FT
 CW20-3(500)
 48" X 48"

4

 H-1 WB
 DETOUR
 CM4-9L
 30" X 24"

5

 H-1 WB
 DETOUR
 CM4-9R
 30" X 24"

6

 H-1 WB
 DETOUR
 CUSTOM
 30" X 30"

7

 END DETOUR
 CM4-8A
 24" X 18"

8

 FREEWAY ON-RAMP CLOSED
 Variable Message Sign
 Phase 1

8

 USE DETOUR
 Variable Message Sign
 Phase 2

SURVEY PLOTTED BY	DATE
DRAWN BY	
TRACED BY	
DESIGNED BY	
QUANTITIES BY	
CHECKED BY	
ORIGINAL PLAN	No.
NOTE BOOK	

- Legend:**
- ⊗ Special Duty Officer
 - Sign
 - ➡ Flow of Traffic
 - ▨ Type 3 Barricade

GRAPHIC SCALE:
300' 150' 0 300' 600'
SCALE: 1" = 300'

- NOTES:**
1. Work hours to occur between 9:00 p.m. and 4:00 a.m. (Monday night through Friday morning).
 2. Directional detour signs shall be placed on both sides of the travel way when medians are present on multi-lanes streets.
 3. See TC-67, TC-68, TC-69 and TC-70 for lane closure.
 4. See TCD-1 for street name sign detail.

PHASE 10 - SCHOOL ST ON-RAMP WESTBOUND
TEMPORARY CLOSURE
(DURATION: 1 WEEK)
SCALE: 1" = 300'

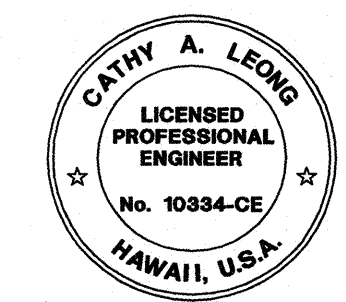

THIS WORK WAS PREPARED BY ME
OR UNDER MY SUPERVISION.
Cathy A. Leong
WILSON OKAMOTO CORPORATION LIC. EXP. DATE

STATE OF HAWAII
DEPARTMENT OF TRANSPORTATION
HIGHWAYS DIVISION

DETOUR PLAN
INTERSTATE ROUTE H-1
GUARDRAIL AND SHOULDER IMPROVEMENTS
Middle Street to Punchbowl Off-Ramp
Fed. Aid Project No. IM-HI-1(242)
Scale: 1" = 300' Date: Mar. 2016

SHEET No. TD-8 OF 8 SHEETS