

FED. ROAD DIST. NO.	STATE	FED. AID PROJ. NO.	FISCAL YEAR	SHEET NO.	TOTAL SHEETS
HAWAII	HAW.	BR-HI-1(225)	2000	34	37

CONSTRUCTION PHASING NOTES

- The Contractor's attention is directed to Subsection 108.08 - Failure to Complete on Time and Liquidated Damages of the Special Provisions.
- Relocation and/or removal of temporary signs, posts, and portable concrete barriers used for construction phasing shall be considered incidental to their respective contract items.
- Install Steady Burn Amber Lamps on portable concrete barriers @ 20' O.C. Installing, maintaining and charging barriers of the portable mounted Steady Burn Amber Lamps shall be considered to Item No. 606.4230 - State Furnished Portable Concrete Barrier (Intermedite Panel).
- All temporary signs and delineators for the purposes of Construction Phasing shall become the property of the Contractor at the completion of the project.
- The Contractor shall delete the use of the ground anchorage steel pin for State Furnished Portable Concrete Barrier.
- Portable concrete barrier panels not in use during construction work shall not be stockpiled or otherwise stored within the highway rights-of-way except at locations approved by the Engineer.
- The location of pavement markings and signs, delineators and portable concrete barrier panels used in the Construction Phasing shall be as shown on the plans and/or as determined in the field by the Engineer.
- Damage to signs, temporary pavement markers, delineators and portable concrete barriers caused by the public shall be immediately repaired or replaced by the Contractor as directed by the Engineer. This work shall be paid for under Item No. 645.0400 - Police Officers and/or Additional Traffic Control Devices. Damage caused by the Contractor's operation shall be immediately repaired or replaced at the Contractor's expense.
- Work required in the State's Construction Phase Plans will be paid for under applicable contract items or as otherwise specified here in. All other traffic control work shall be in accordance with Section 645 - Traffic Control. Work required for lane closures during working hours will not be paid for but shall be considered incidental to various contract items. Advance Construction Warning Signs as required under Section 645 of the Special Provisions shall be installed on all approaches to construction areas including on-ramps. This work shall be considered incidental to the various contract items.
- The Type II Barricades with stedy amber lamp used during Construction Phase shall be considered incidental to the various contract items.

LEGEND

- Portable Concrete Barrier
- Work Area
- Inertial Barrier System (Numbers indicate weight of sand in 100 lb. units)
- Type II Barricades with Amber Flasher @ 10.00' O.C.

DETOUR PAVEMENT MARKING LEGEND

- 4 each Type A Raised Pavement Markers
Type C Raised Pavement Markers @ 40'-0" o.c.
- 4" Yellow Edge Stripe with Type H Raised Pavement Markers @ 40'-0" o.c. (Tape)
- 4" or 8" White Edge Stripe with Type C Raised Pavement Markers @ 40'-0" o.c. (Tape)
- Channelizing Island or Deceleration Lane Gore (Tape)

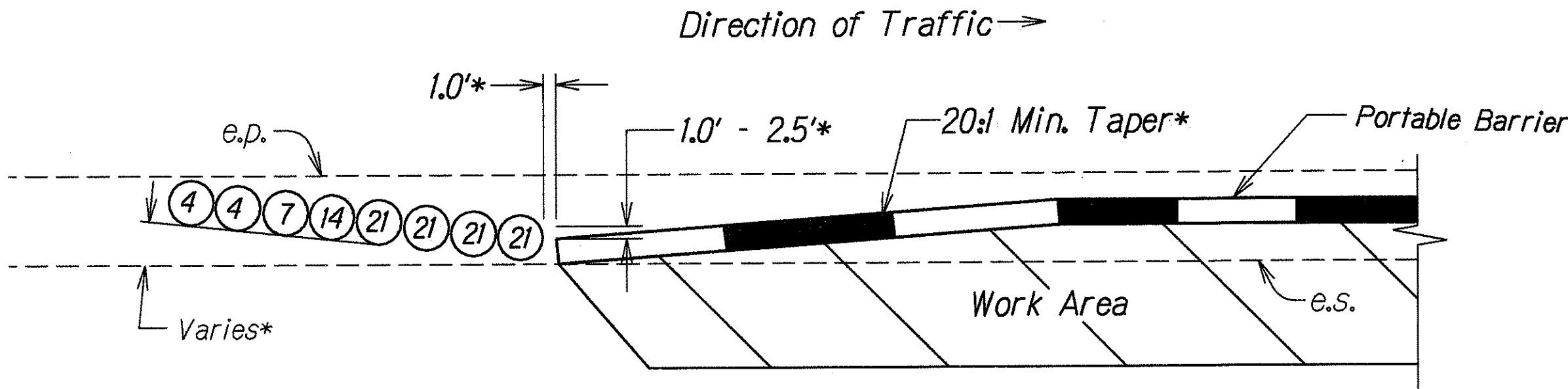

TYPICAL DETAIL

8-MODULE INERTIAL BARRIER (V = 56 mph)

Not to Scale

NOTES:

- Typical layout will vary based on speed and manufacturer of system used. Installation shall conform to Manufacturer's recommendations.
- The numbers inside the circles indicate the weight of sand in 100 lb. unit. Installation shall conform to Manufacturer's recommendations.
- Ends of portable barriers shall be protected with Intertial Barriers as shown above.

ORIGINAL PLAN	DATE
DESIGNED BY	1-22-99
DRAWN BY	B-2-99/2
CHECKED BY	
APPROVED BY	

STATE OF HAWAII
DEPARTMENT OF TRANSPORTATION
HIGHWAYS DIVISION

CONSTRUCTION PHASING
NOTES, LEGEND & DETAIL

INTERSTATE ROUTE H-1
Seismic Retrofit for Lunalilo-Vineyard Off-Ramp,
Makiki Viaduct and Palama Separation
Federal Aid Project No. BR-HI-1(225)
Date: Aug., 1999

SHEET No. 1 OF 2 SHEETS

FED. ROAD DIST. NO.	STATE	FED. AID PROJ. NO.	FISCAL YEAR	SHEET NO.	TOTAL SHEETS
HAWAII	HAW.	BR-HI-1(225)	2000	35	37

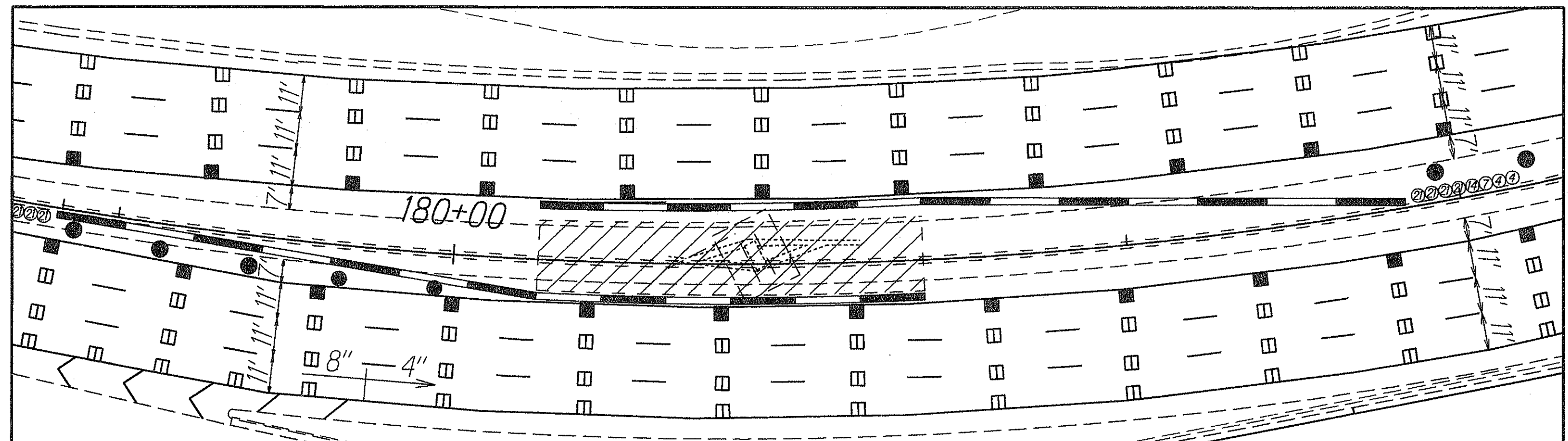
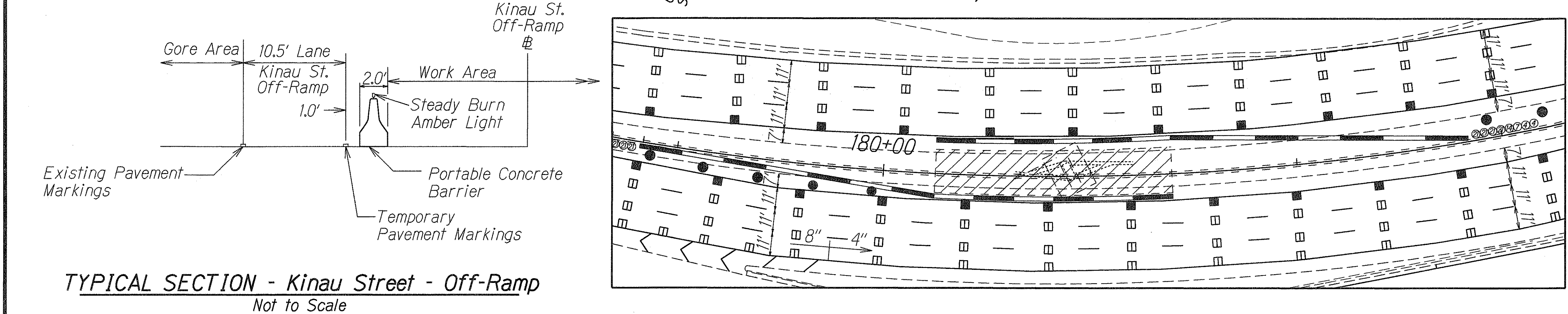
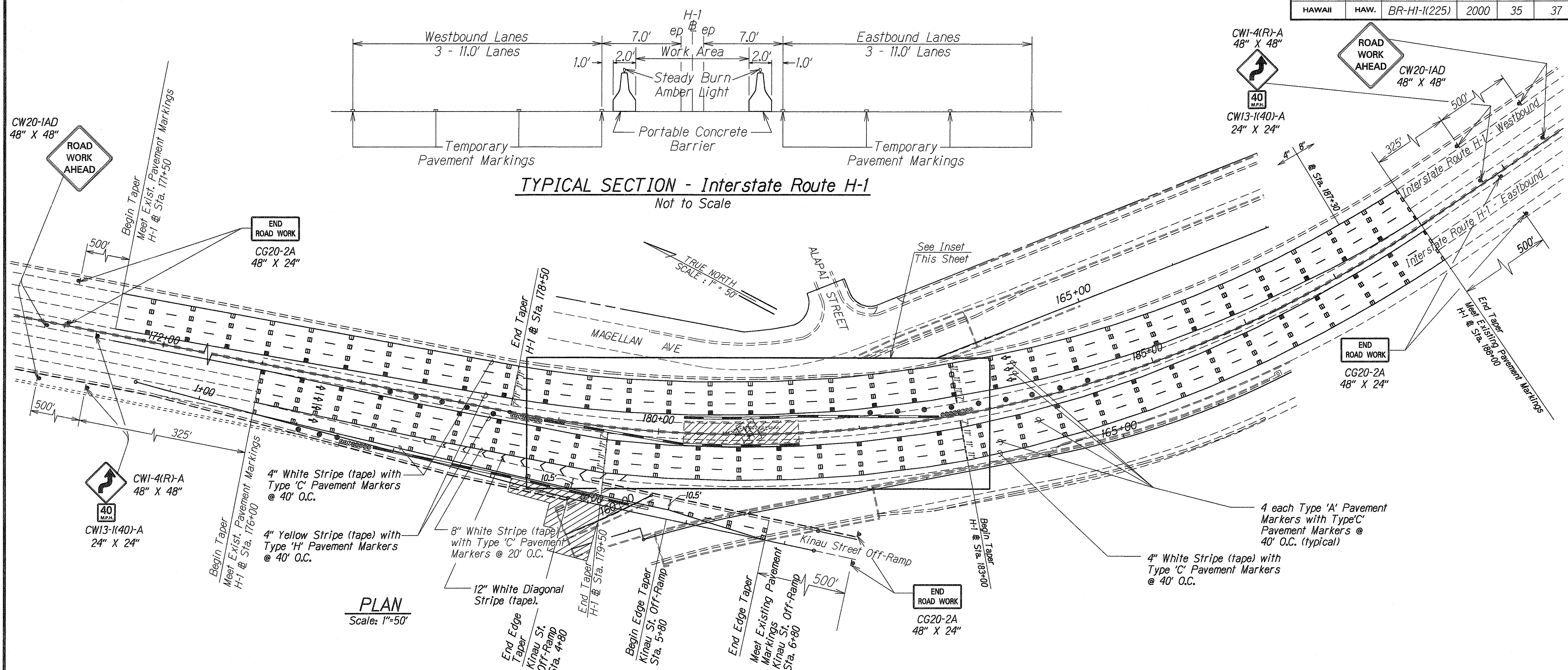

SURVEY PLOTTED BY	DATE
DRAWN BY	8/22/99
DESIGNED BY	
NOTED BY	
QUANTITIES BY	
CHECKED BY	

STATE OF HAWAII
DEPARTMENT OF TRANSPORTATION
HIGHWAYS DIVISION

CONSTRUCTION PHASING PLAN

INTERSTATE ROUTE H-1

Seismic Retrofit for Lunalilo-Vineyard Off-Ramp,
Makiki Viaduct and Palama Separation

Federal Aid Project No. BR-HI-1(225)

Scale: As Shown Date: Aug., 1999

SHEET No. 2 OF 2 SHEETS