

FED. ROAD DIST. NO.	STATE	FED. AID PROJ. NO.	FISCAL YEAR	SHEET NO.	TOTAL SHEETS
HAWAII	HAW.	I-H-1(128)17	1975	25	78

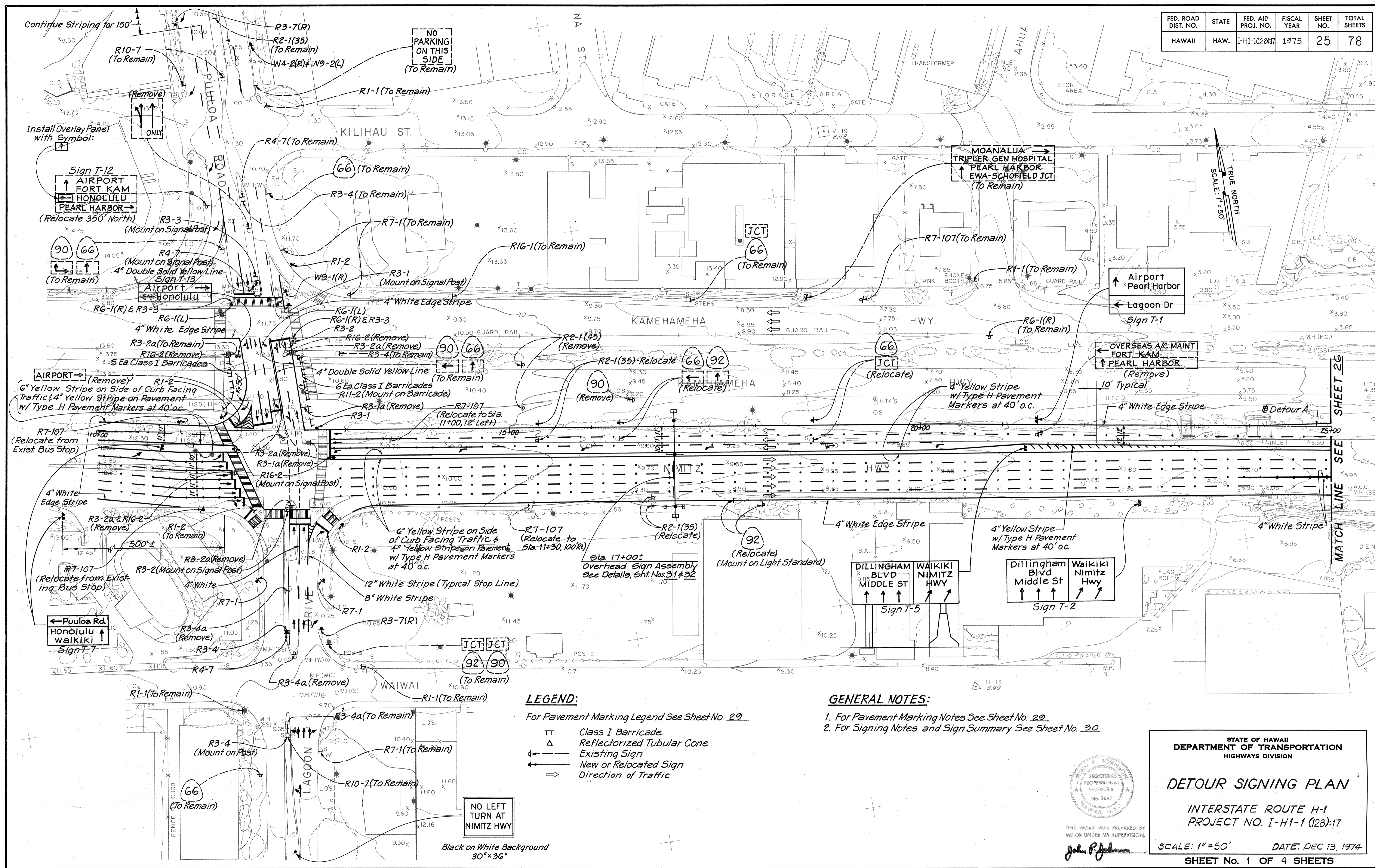

SURVEY PLOTTED BY: \_\_\_\_\_  
 DATE: \_\_\_\_\_  
 ORIGINAL PLAN DESIGNED BY: \_\_\_\_\_  
 NOTE BOOK QUANTITIES BY: \_\_\_\_\_  
 CHECKED BY: \_\_\_\_\_

- LEGEND:**
- For Pavement Marking Legend See Sheet No. 29
- TT Class I Barricade
  - Δ Reflectorized Tubular Cone
  - ← Existing Sign
  - ↔ New or Relocated Sign
  - Direction of Traffic

- GENERAL NOTES:**
- For Pavement Marking Notes See Sheet No. 29
  - For Signing Notes and Sign Summary See Sheet No. 30

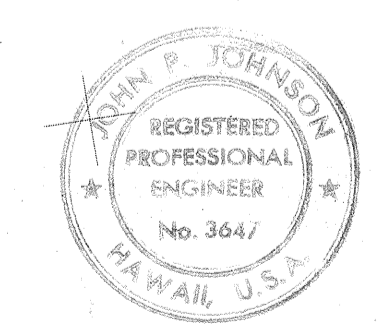

THIS WORK WAS PREPARED BY ME OR UNDER MY SUPERVISION.  
 John P. Johnson

STATE OF HAWAII  
 DEPARTMENT OF TRANSPORTATION  
 HIGHWAYS DIVISION  
**DETOUR SIGNING PLAN**  
 INTERSTATE ROUTE H-1  
 PROJECT NO. I-H-1 (128)17  
 SCALE: 1" = 50' DATE: DEC 13, 1974  
 SHEET No. 1 OF 4 SHEETS

FED. ROAD DIST. NO.	STATE	FED. AID PROJ. NO.	FISCAL YEAR	SHEET NO.	TOTAL SHEETS
HAWAII	HAW.	I-HI-1(128)17	1975	26	78

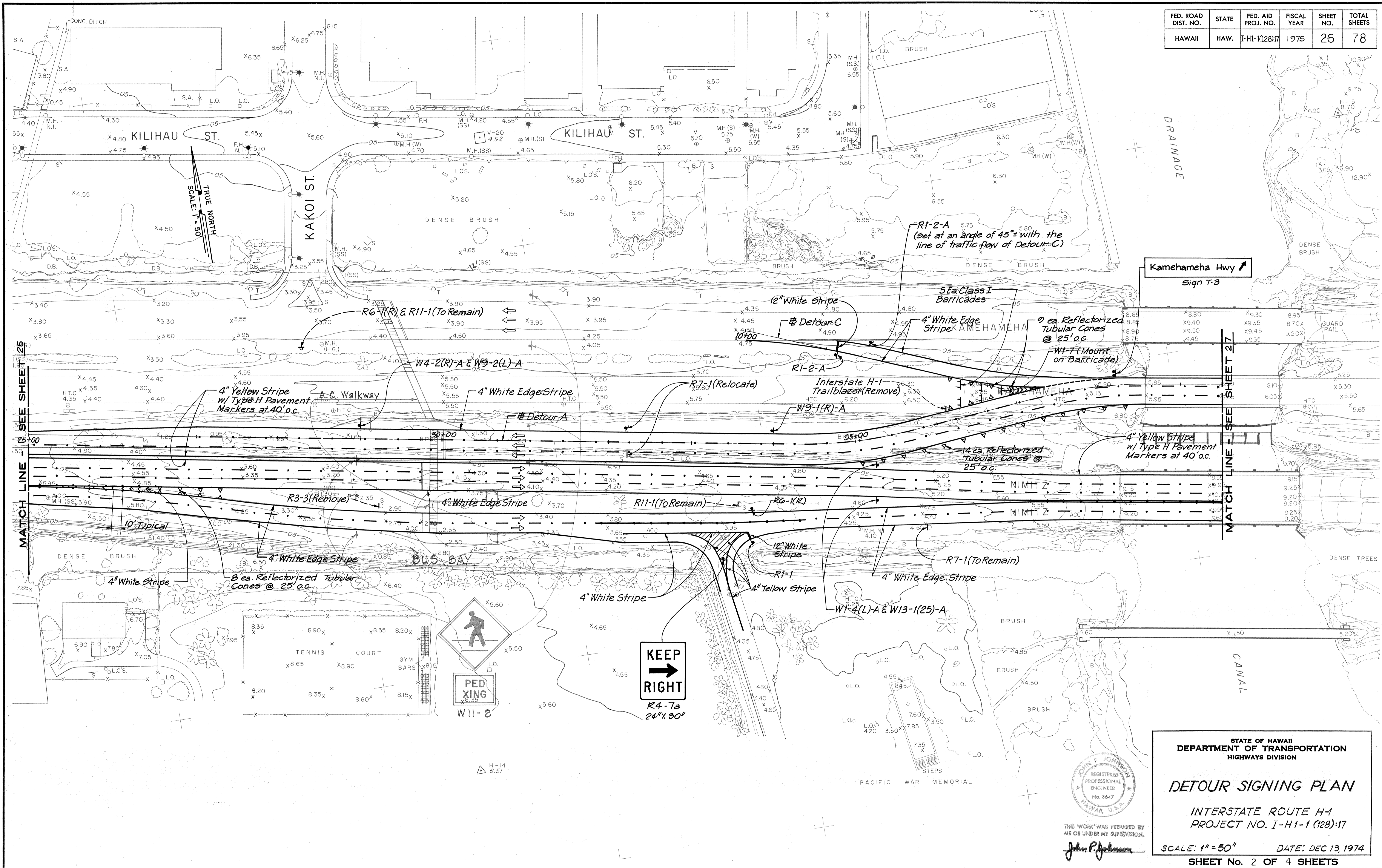

DATE	_____
DESIGNED BY	_____
DRAWN BY	_____
CHECKED BY	_____
NO.	_____

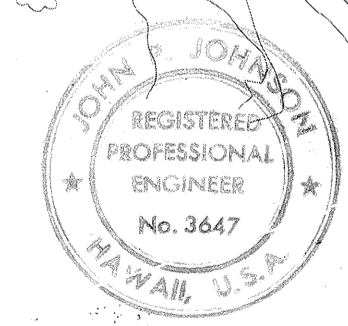

STATE OF HAWAII  
DEPARTMENT OF TRANSPORTATION  
HIGHWAYS DIVISION

**DETOUR SIGNING PLAN**

INTERSTATE ROUTE H-1  
PROJECT NO. I-HI-1(128)17

SCALE: 1" = 50"      DATE: DEC 13, 1974

SHEET No. 2 OF 4 SHEETS



FED. ROAD DIST. NO.	STATE	FED. AID PROJ. NO.	FISCAL YEAR	SHEET NO.	TOTAL SHEETS
HAWAII	HAW.	I-H1-1028/17	1975	28	78

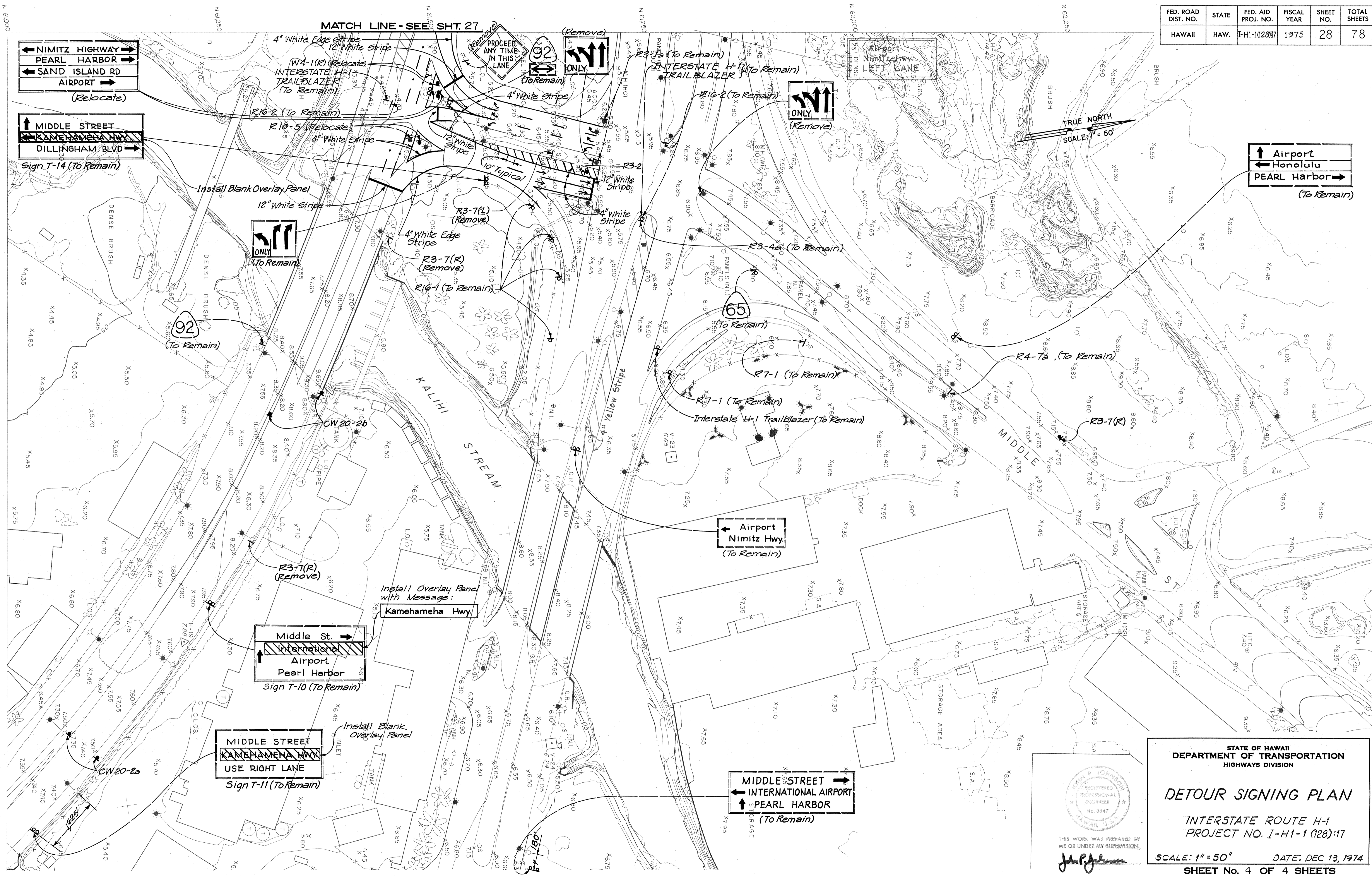

DESIGNED BY: \_\_\_\_\_  
 DRAWN BY: \_\_\_\_\_  
 CHECKED BY: \_\_\_\_\_  
 DATE: \_\_\_\_\_  
 ORIGINAL PLAN NO. \_\_\_\_\_  
 NOTE BOOK NO. \_\_\_\_\_

JOHN P. JOHNSON  
 REGISTERED PROFESSIONAL ENGINEER  
 No. 3647  
 HAWAII, U.S.A.  
 THIS WORK WAS PREPARED BY ME OR UNDER MY SUPERVISION.  
 John P. Johnson

STATE OF HAWAII  
 DEPARTMENT OF TRANSPORTATION  
 HIGHWAYS DIVISION  
**DETOUR SIGNING PLAN**  
 INTERSTATE ROUTE H-1  
 PROJECT NO. I-H1-1 (128)/17  
 SCALE: 1" = 50' DATE: DEC. 13, 1974  
 SHEET No. 4 OF 4 SHEETS