

GENERAL NOTES:

1. ELEVATION DATUM BASED ON MEAN SEA LEVEL DATUM
2. EXISTING UNDERGROUND UTILITIES AND STRUCTURES AS SHOWN ON THE PLANS ARE FROM THE LATEST AVAILABLE DATA BUT ARE NOT GUARANTEED. AS TO THE LOCATION SHOWN OR THAT OTHER OBSTACLES MAY NOT BE ENCOUNTERED IN THE COURSE OF THE WORK.
3. ALL EXISTING UTILITIES WHETHER OR NOT SHOWN ON THE PLANS SHALL BE PROTECTED AT ALL TIMES BY THE CONTRACTOR DURING CONSTRUCTION AND ANY DAMAGE TO THE EXISTING UTILITIES SHALL BE REPAIRED AND PAID FOR BY THE CONTRACTOR. THE EXISTING UTILITIES MUST BE KEPT OPERABLE AT ALL TIMES AND CONNECTIONS TO EXISTING SYSTEM AND IMPROVEMENTS SHALL BE SCHEDULED AND PLANNED FOR MINIMUM INTERFERENCE.
4. ALL EXISTING WATER, SEWER AND GAS LINES TO REMAIN UNLESS OTHERWISE NOTED.
5. THE CONTRACTOR HAS THE OPTION OF EITHER PLUGGING OR REMOVING ABANDONED UTILITIES, UNLESS REMOVAL IS REQUIRED FOR CONSTRUCTION OF THE FACILITY.
6. ITEMS INDICATED AS "RELOCATE" ON THE PLANS SHALL BE REMOVED, CLEANED, PAINTED AND REINSTALLED AT THE NEW LOCATION BY THE CONTRACTOR UNLESS OTHERWISE SPECIFIED.
7. CONTRACTOR SHALL REFER TO SECTION 202, "REMOVAL OF STRUCTURES AND OBSTRUCTIONS OF THE SPECIAL PROVISIONS."
8. ALL EXISTING CONCRETE WITHIN THE ROADBED AREAS SHALL BE REMOVED TO A DEPTH OF AT LEAST 3 FEET BELOW SUBGRADE. ALL OTHER CONCRETE SHALL BE REMOVED TO A DEPTH OF AT LEAST 12 INCHES BELOW FINISHED GRADE UNLESS SHOWN OTHERWISE.
9. SEE SHEETS 157 TO 161 FOR REMOVAL OF ELECTRIC, TELEPHONE, ACC AND NCC FACILITIES.
10. CUTTING & PLUGGING INCIDENTAL TO VARIOUS CONTRACT ITEMS.

FED. ROAD DIST. NO.	STATE	FED. AID PROJ. NO.	FISCAL YEAR	SHEET NO.	TOTAL SHEETS
HAWAII	HAW.	I-HH(73)15	1974	84	369

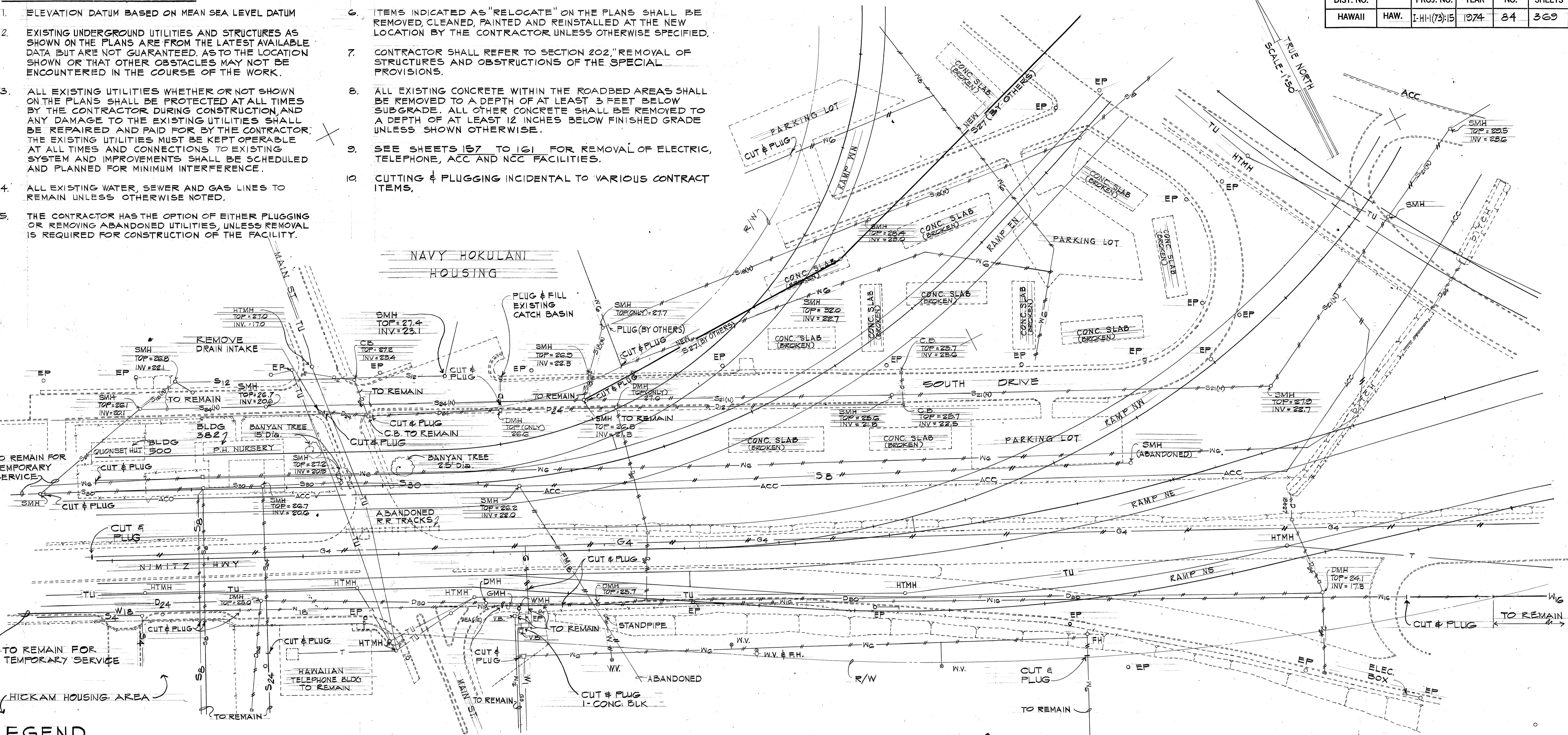

LEGEND

- | | | | |
|----------|---------------------------------------|-------|--------------------------------|
| — S — | SEWER | HTMH | HAWAIIAN TELEPHONE CO. MANHOLE |
| — FM — | FORCE MAIN (SEWER) | E | ELECTRIC LINE UNDERGROUND |
| — W — | WATER LINE | D.I. | STORM DRAIN DROP INTAKE |
| — D — | DRAIN LINE | SMH | SEWER MANHOLE |
| — G — | GAS LINE | CB | STORM DRAIN CATCH BASIN |
| — / / — | UTILITY LINE TO BE ABANDONED | DMH | STORM DRAIN MANHOLE |
| ○ EP | UTILITY POLE | — x — | CHAIN LINK FENCE |
| — ○ EP — | UTILITY POLE W/ GUY & ANCHOR | E.BOX | ELECTRIC BOX OR MANHOLE |
| — ACC — | ARMY COMMUNICATIONS CABLE UNDERGROUND | | |
| — NCC — | NAVY COMMUNICATIONS CABLE UNDERGROUND | | |
| — TU — | TELEPHONE CABLE UNDERGROUND | | |
| ○ FH | FIRE HYDRANT | | |
| ○ VB | WATER VALVE W/ VALVE BOX | | |
| ○ WMH | WATER MANHOLE | | |

PLAN
SCALE: 1"=50'

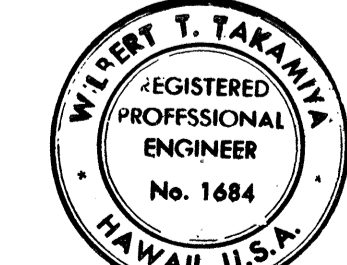
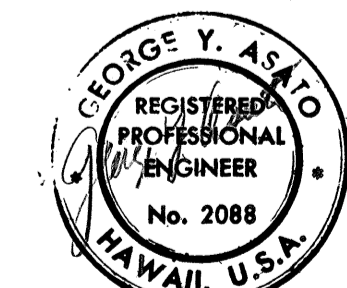

THIS WORK WAS PREPARED BY ME
OR UNDER MY SUPERVISION

STATE OF HAWAII
DEPARTMENT OF TRANSPORTATION
HIGHWAYS DIVISION

EXISTING CONDITIONS
PLAN

PEARL HARBOR INTERCHANGE
F.A.T. Proj. No. I-HH-1(73)15

Scale: As Shown Date: DEC. 7, 1973

SHEET NO. 1 OF 4 SHEETS

FED. ROAD DIST. NO.	STATE	FED. AID PROJ. NO.	FISCAL YEAR	SHEET NO.	TOTAL SHEETS
HAWAII	HAW.	I-H-1(73)15	1974	85	369

ORIGINAL PLAN	SURVEY PLOTTED BY	DATE
PLAN	DRAWN BY	"
NOTE BOOK	DESIGNED BY	"
No.	CHECKED BY	"

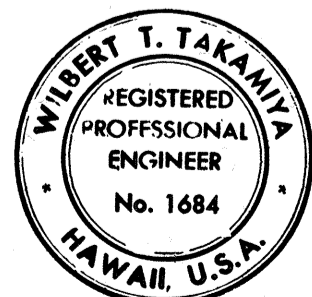
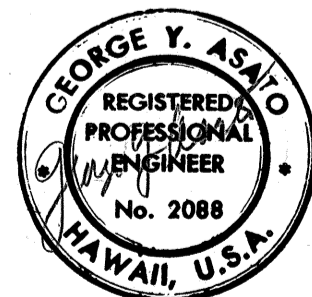
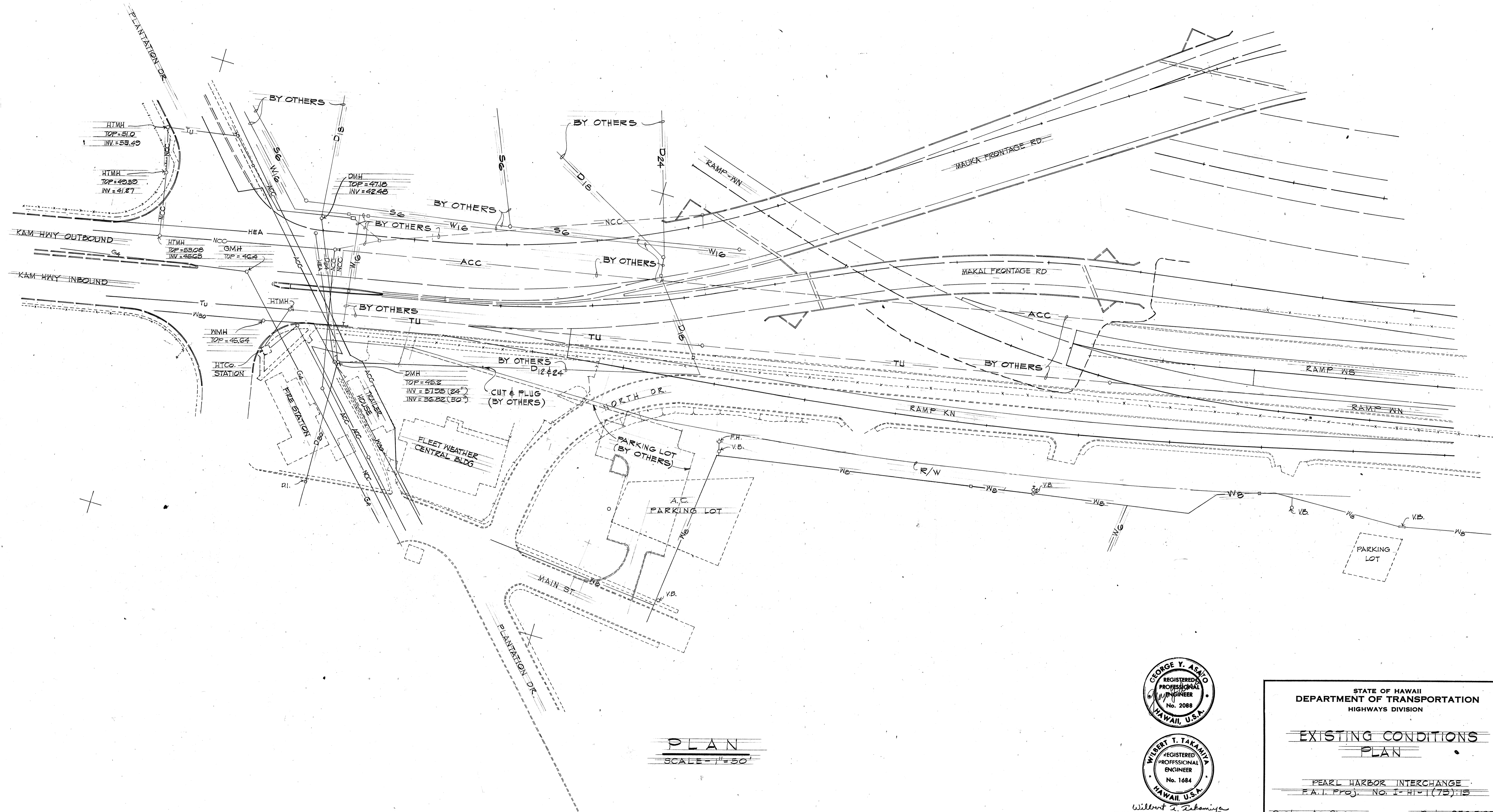

Willbert T. Takamiya
THIS WORK WAS PREPARED BY ME
OR UNDER MY SUPERVISION

STATE OF HAWAII DEPARTMENT OF TRANSPORTATION HIGHWAYS DIVISION	
EXISTING CONDITIONS PLAN	
PEARL HARBOR INTERCHANGE F.A.I. Proj. No. I-H-1(73)15	
Scale: As Shown	Date: DEC. 7, 1973
SHEET NO. 2 OF 4 SHEETS	

FED. ROAD DIST. NO.	STATE	FED. AID PROJ. NO.	FISCAL YEAR	SHEET NO.	TOTAL SHEETS
HAWAII	HAW.	I-HI-1(73)15	1974	86	369

ORIGINAL PLAN	SURVEY PLOTTED BY	DATE
TRACED BY		
NOTE BOOK		
QUANTITIES BY		
CHECKED BY		

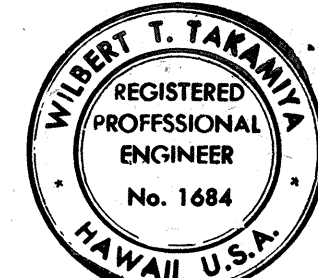
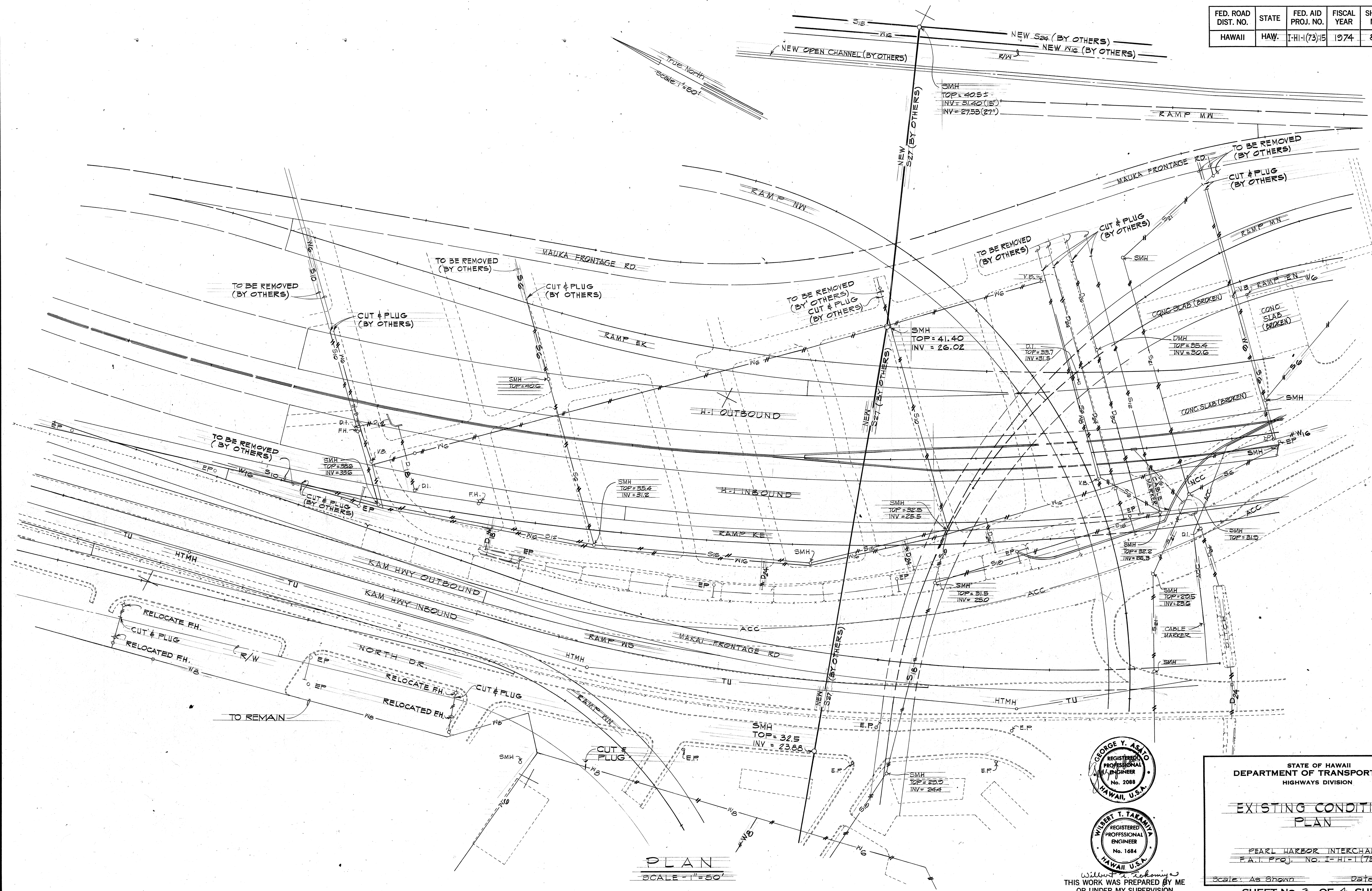

THIS WORK WAS PREPARED BY ME
OR UNDER MY SUPERVISION

STATE OF HAWAII
DEPARTMENT OF TRANSPORTATION
HIGHWAYS DIVISION

**EXISTING CONDITIONS
PLAN**

PEARL HARBOR INTERCHANGE
F.A.I. PROJ. NO. I-HI-1(73)15

Scale: As Shown Date: DEC. 7, 1973

SHEET NO. 3 OF 4 SHEETS

FED. ROAD DIST. NO.	STATE	FED. AID PROJ. NO.	FISCAL YEAR	SHEET NO.	TOTAL SHEETS
HAWAII	HAW.	I-H-1(73)15	1974	87	369

ORIGINAL PLAN	DATE
DESIGNED BY	
TRACED BY	
NOTED BY	
CHECKED BY	

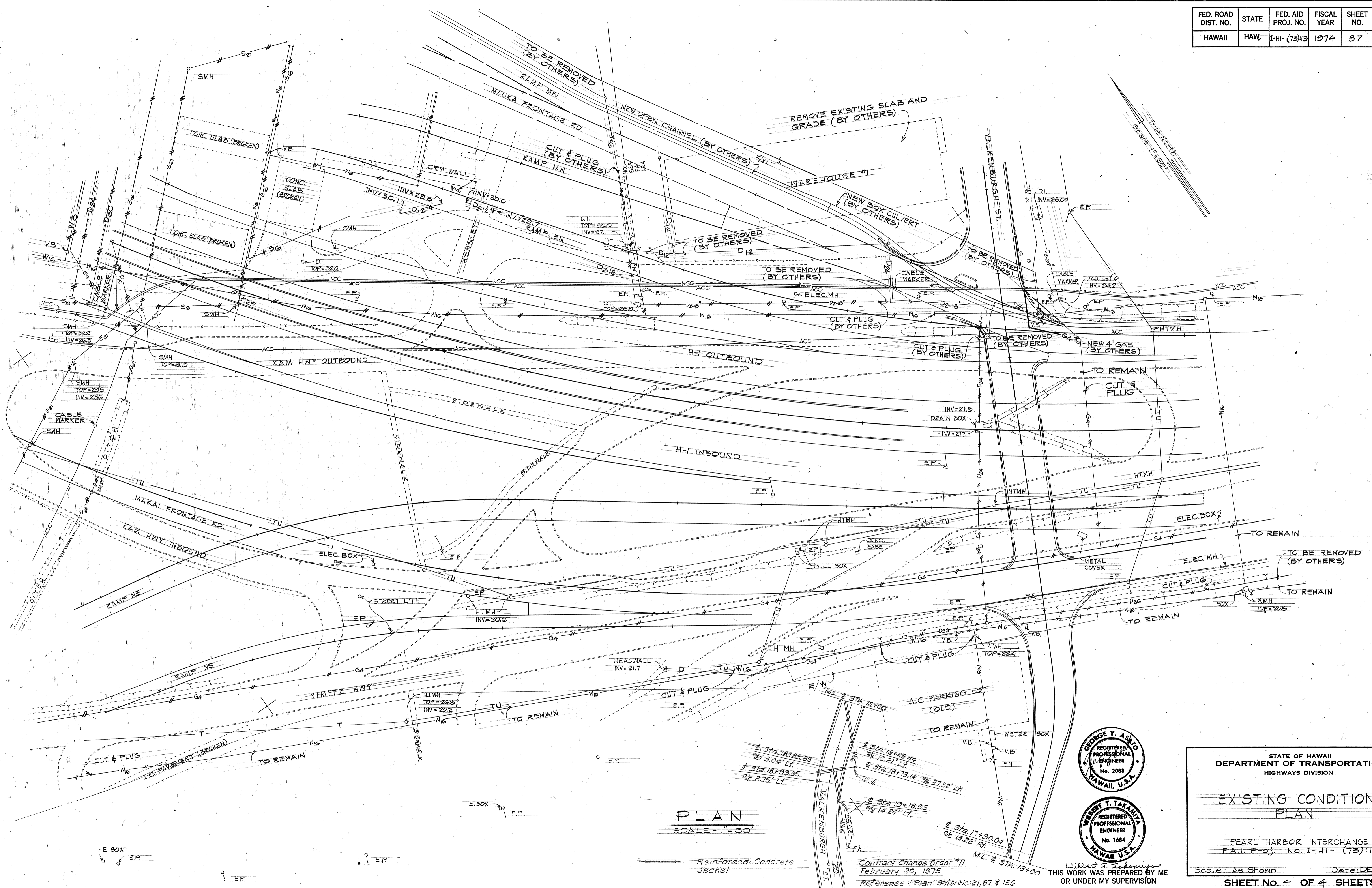

PLAN
SCALE - 1" = 50'

GEORGE Y. ASANO
REGISTERED PROFESSIONAL ENGINEER
No. 2088
HAWAII, U.S.A.

WILBERT T. TAKAMURA
REGISTERED PROFESSIONAL ENGINEER
No. 1684
HAWAII, U.S.A.

STATE OF HAWAII
DEPARTMENT OF TRANSPORTATION
HIGHWAYS DIVISION

EXISTING CONDITIONS
PLAN

PEARL HARBOR INTERCHANGE
F.A.I. Proj. No. I-H-1(73)15

Scale: As Shown Date: DEC. 7, 1973

SHEET No. 4 OF 4 SHEETS

Contract Change Order #11
February 20, 1975
Reference: Plan Sheets No. 21, 87, & 156

THIS WORK WAS PREPARED BY ME
OR UNDER MY SUPERVISION