

| FED. ROAD DIST. NO. | STATE | FED. AID PROJ. NO. | FISCAL YEAR | SHEET NO. | TOTAL SHEETS |
|---------------------|-------|--------------------|-------------|-----------|--------------|
| HAWAII              | HAW.  | I-HI-1(47):9       | 1968        | 4B        | 227          |

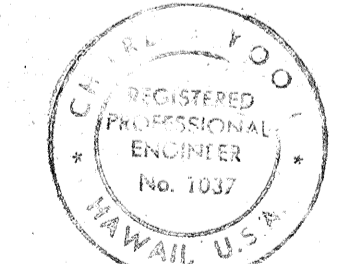
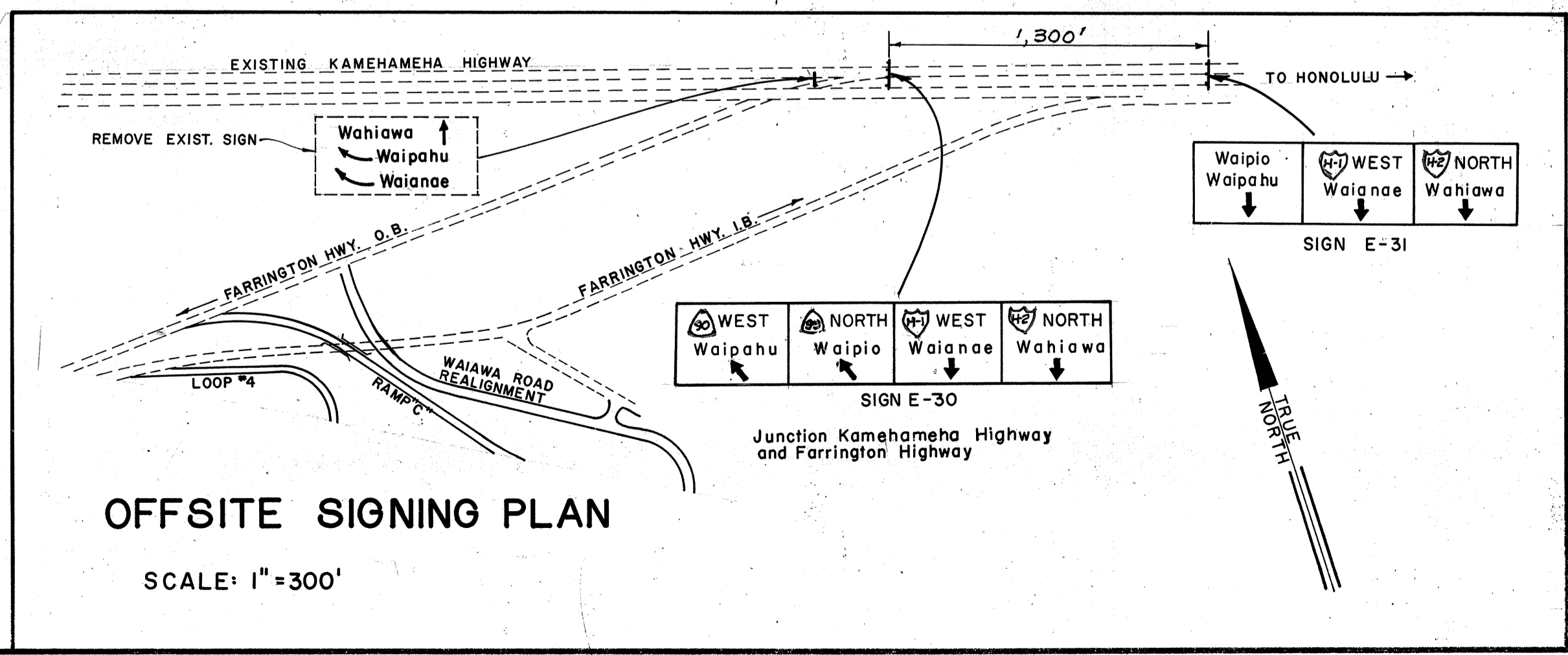
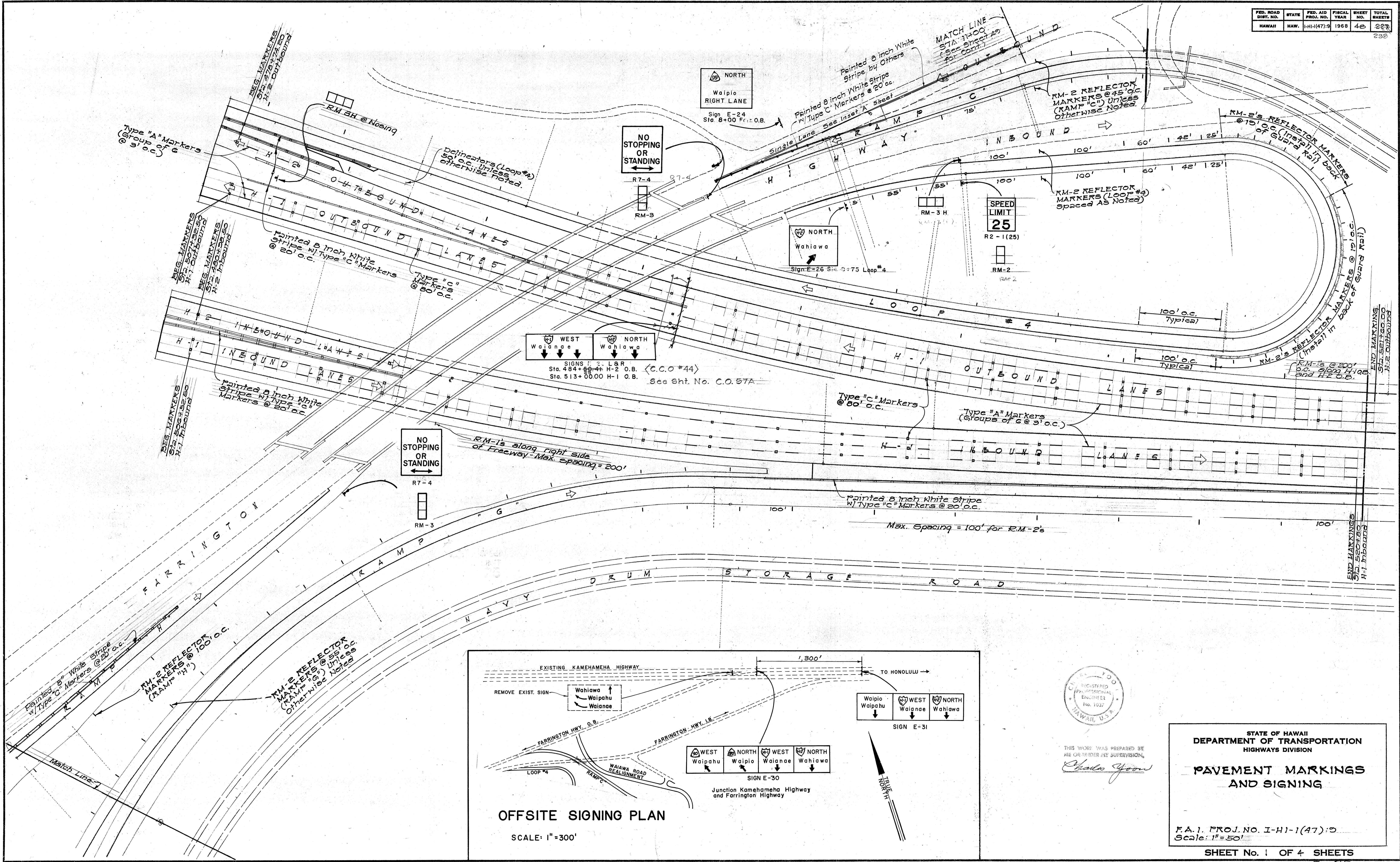

THIS WORK WAS PREPARED BY ME OR UNDER MY SUPERVISION.  
*Chalo Yoon*

STATE OF HAWAII  
 DEPARTMENT OF TRANSPORTATION  
 HIGHWAYS DIVISION

**PAVEMENT MARKINGS  
 AND SIGNING**

F.A.1. PROJ. NO. I-HI-1(47):9  
 Scale: 1"=50'

SHEET No. 1 OF 4 SHEETS

|             |       |
|-------------|-------|
| DATE        | ..... |
| DESIGNED BY | ..... |
| CHECKED BY  | ..... |
| NO. BOOK    | ..... |
| NO. SHEET   | ..... |

DS-2-34

| FED. ROAD DIST. NO. | STATE | FED. AID PROJ. NO. | FISCAL YEAR | SHEET NO. | TOTAL SHEETS |
|---------------------|-------|--------------------|-------------|-----------|--------------|
| HAWAII              | HAW.  | 1-11-1(47)D        | 1988        | 40        | 227          |

238

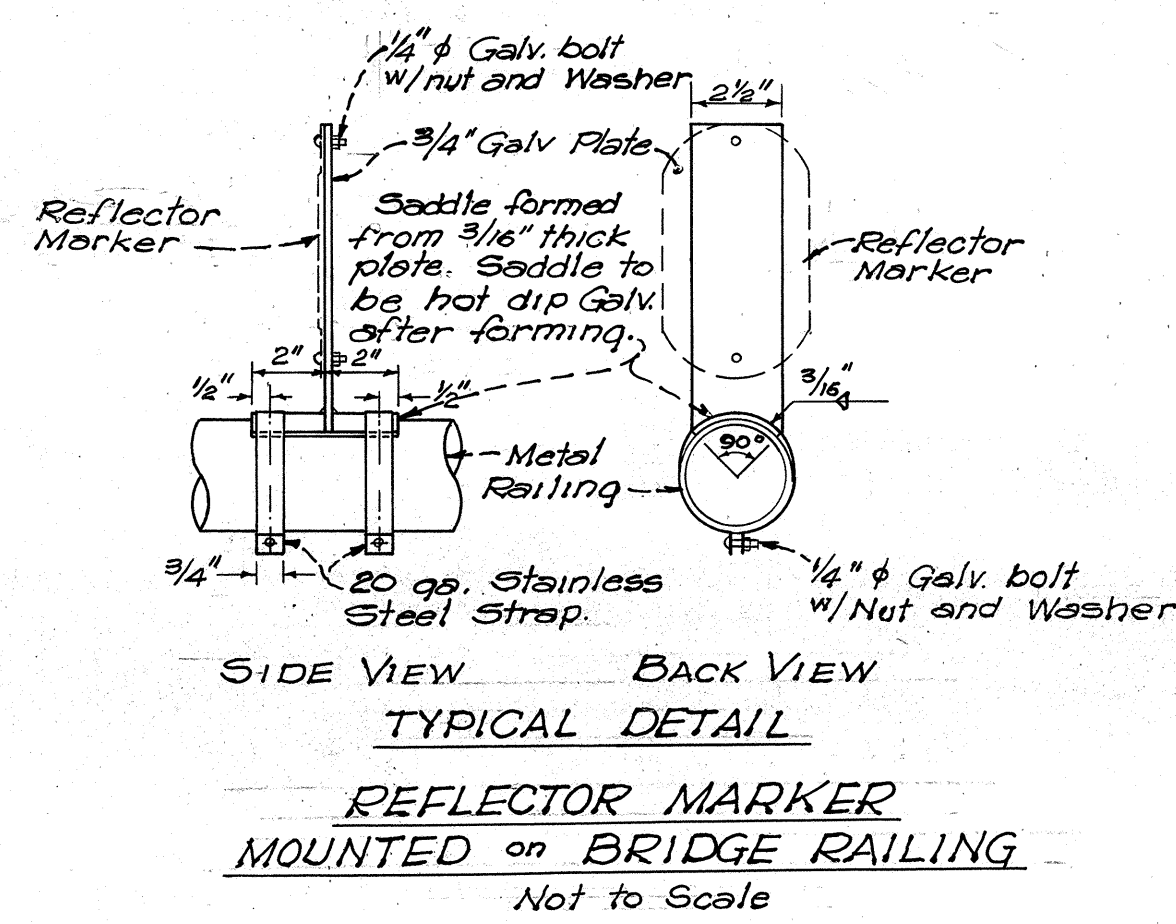
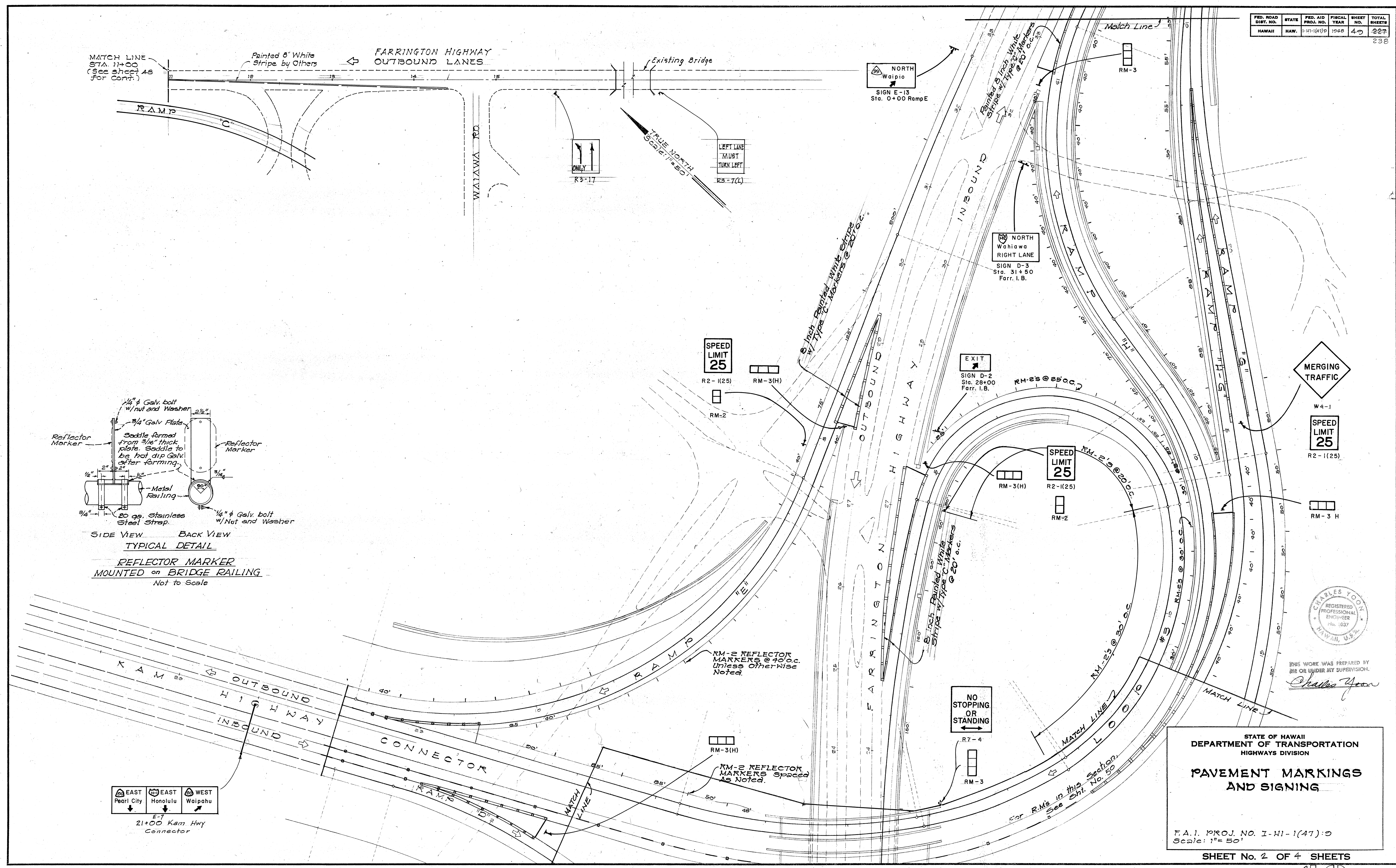

|                   |       |
|-------------------|-------|
| DATE              | _____ |
| SURVEY PLOTTED BY | _____ |
| DRAWN BY          | _____ |
| DESIGNED BY       | _____ |
| NOTED BY          | _____ |
| CHECKED BY        | _____ |
| NO.               | _____ |

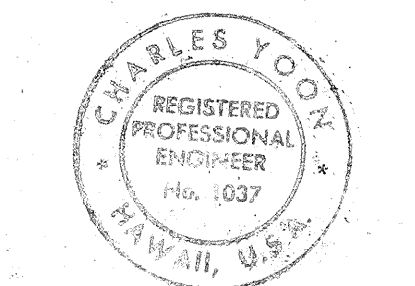
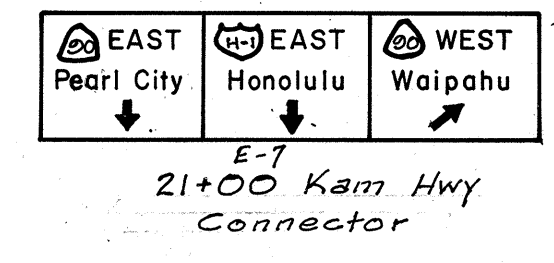

THIS WORK WAS PREPARED BY ME OR UNDER MY SUPERVISION.  
*Charles York*

STATE OF HAWAII  
DEPARTMENT OF TRANSPORTATION  
HIGHWAYS DIVISION

**PAVEMENT MARKINGS AND SIGNING**

F.A.I. PROJ. NO. I-HI-1(47)D  
Scale: 1"=50'

**SHEET No. 2 OF 4 SHEETS**

**SUMMARY OF REGULATORY AND WARNING SIGNS**

| TYPE     | DESCRIPTION              | QUANTITY |       |
|----------|--------------------------|----------|-------|
|          |                          | W/POST   | %POST |
| R2-1(25) | SPEED LIMIT (25)         | 5        |       |
| R7-4     | NO STOPPING OR STANDING  | 5        |       |
| W4-1     | MERGING TRAFFIC          | 2        |       |
| R3-7L    | LEFT LANE MUST TURN LEFT | 1        |       |
| R3-17    | ↑                        | 1        |       |
| TOTAL    |                          | 14       |       |

**SUMMARY OF RAISED PAVEMENT MARKERS**

| ROADWAY   | STATION                       | TYPE A | TYPE C |
|-----------|-------------------------------|--------|--------|
| H-14H20B  | 506+52.50 to 520+80 (H-1.B.)  | 639    | 116    |
| H-14H21B  | " " "                         | 648    | 112    |
| RAMP H    | 15+00 to 18+40                |        | 18     |
| RAMP H G  | 0+00 to 4+00 & 5+10 to 9+20   |        | 81     |
| RAMP C    | AT FARRINGTON HWY.            |        | 11     |
| RAMP E    | 3+30 to 4+75 & 10+65 to 11+80 |        | 23     |
| RAMP D-1  | 1+37 to 2+55 & 10+00 to 13+75 |        | 23     |
| KAM I.B.  | 22+14 to 26+30                | 60     | 23     |
| RAMP H    | 0+00 to 5+36                  | 90     | 8      |
| RAMP G    | 0+00 to 5+20                  |        | 35     |
| FARR O.B. | 12+75 to 16+50                |        | 20     |
| Loop 3    | 2+40 to 5+00                  |        | 27     |
| TOTALS -  |                               | 1,437  | 497    |

**SUMMARY OF REFLECTOR MARKERS**

| TYPE     | DESCRIPTION               | W/POST | %POST |
|----------|---------------------------|--------|-------|
| RM-1     | SINGLE UNIT AMBER         | 10     |       |
| RM-2     | DOUBLE UNIT AMBER         | 320    | 4     |
| RM-3     | TRIPLE UNIT AMBER         | 3      | 3     |
| RM-3H    | TRIPLE UNIT AMBER (HORIZ) | 6      |       |
| TOTALS - |                           | 339    | 7     |

SEE PROJECT LEDGER FOR FINAL QUANTITIES

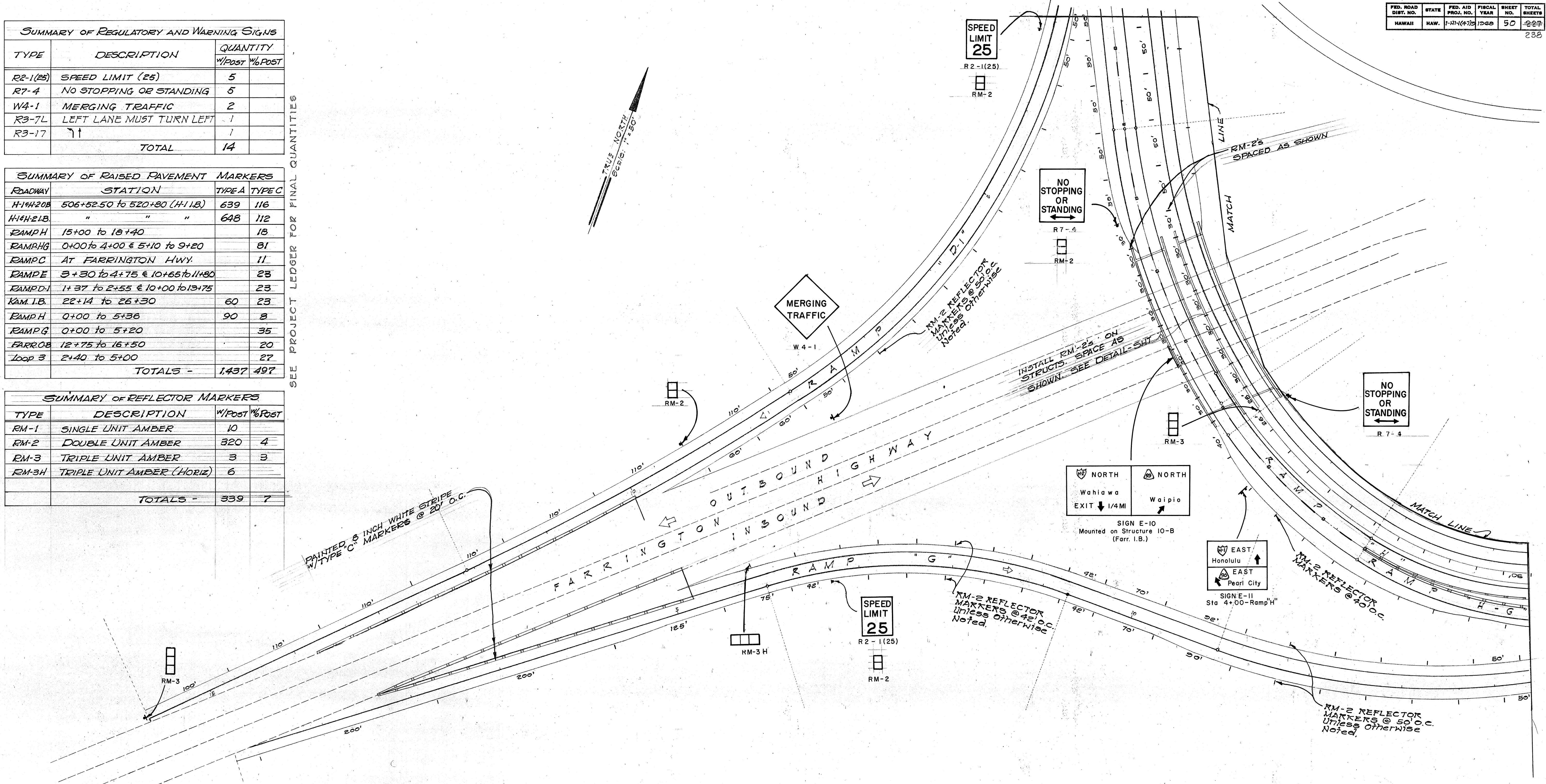
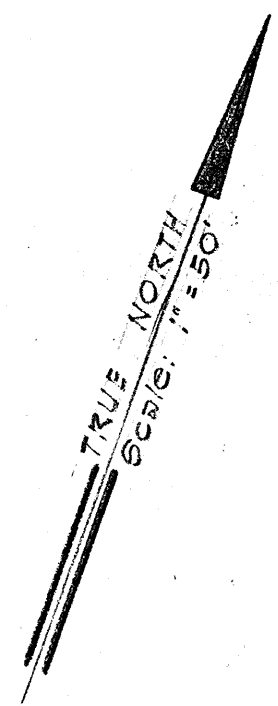

NOTE: All signs must conform to the Standard Details on Sheets 209 to 212 and/or the "Manual on Uniform Traffic Control Devices for Streets and Highways" dated June 1961.

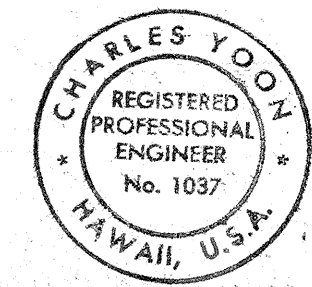

THIS WORK WAS PREPARED BY ME OR UNDER MY SUPERVISION.  
*Charles Yoon*

STATE OF HAWAII  
DEPARTMENT OF TRANSPORTATION  
HIGHWAYS DIVISION

**PAVEMENT MARKINGS AND SIGNING**

F.A.I. PROJ. NO. I-HI-1(47)-D  
Scale: 1"=50'

SHEET No. 3 OF 4 SHEETS

SURVEY PLOTTED BY: \_\_\_\_\_  
 DATE: \_\_\_\_\_  
 ORIGINAL PLAN: \_\_\_\_\_  
 DRAWN BY: \_\_\_\_\_  
 NOTE BOOK: \_\_\_\_\_  
 DESIGNED BY: \_\_\_\_\_  
 QUANTITIES BY: \_\_\_\_\_  
 CHECKED BY: \_\_\_\_\_  
 NO. \_\_\_\_\_

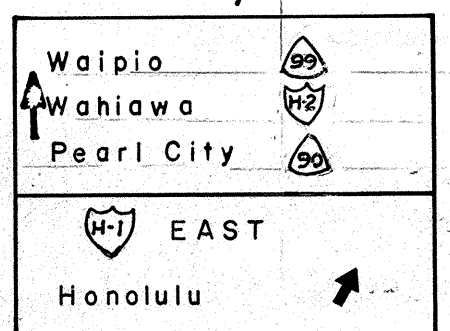

SIGN E-8  
Sta. 11+00 Farr. I.B.

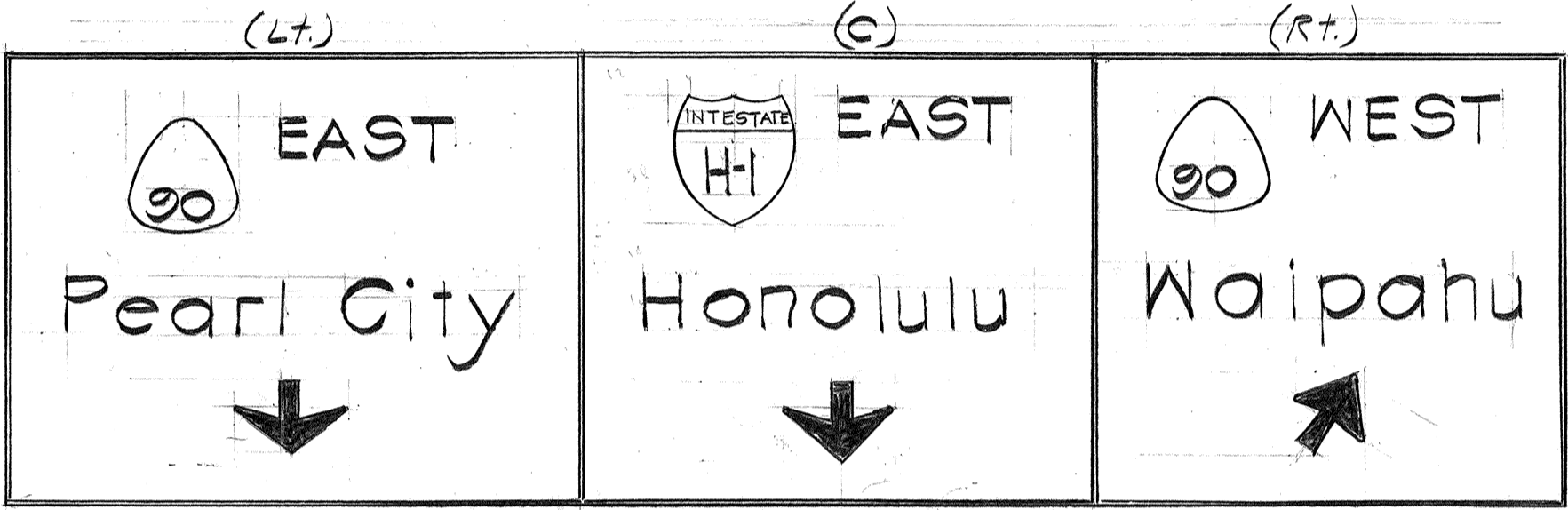
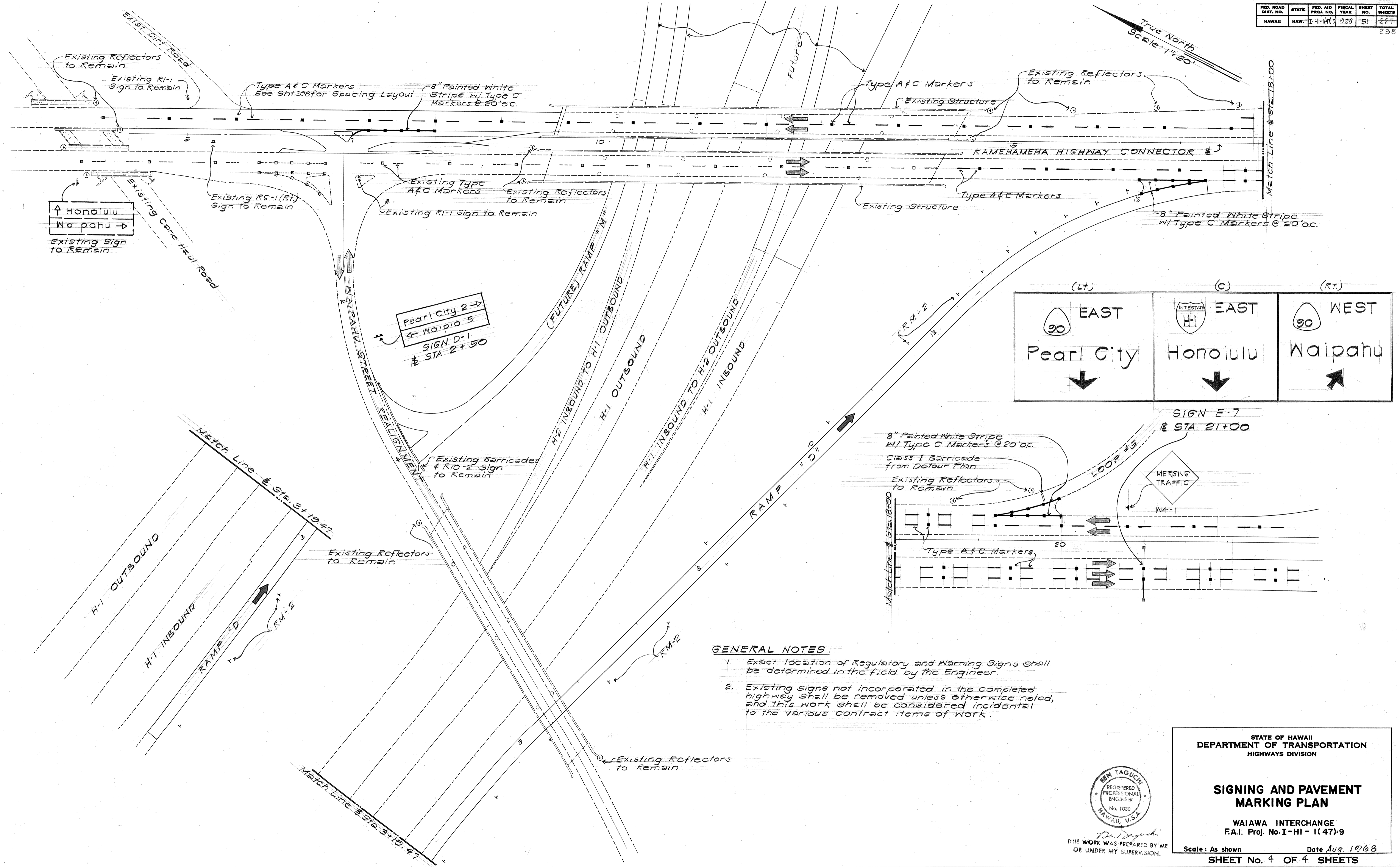

- GENERAL NOTES:**
1. Exact location of Regulatory and Warning Signs shall be determined in the field by the Engineer.
  2. Existing signs not incorporated in the completed highway shall be removed unless otherwise noted, and this work shall be considered incidental to the various contract items of work.

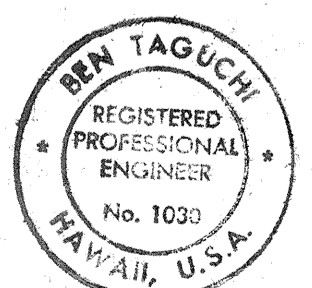

THIS WORK WAS PREPARED BY ME OR UNDER MY SUPERVISION.

STATE OF HAWAII  
DEPARTMENT OF TRANSPORTATION  
HIGHWAYS DIVISION

**SIGNING AND PAVEMENT MARKING PLAN**

WAIAWA INTERCHANGE  
F.A.I. Proj. No. I-HI-1(47):9

Scale: As shown Date Aug. 1968  
SHEET No. 4 OF 4 SHEETS

|                   |  |
|-------------------|--|
| DATE              |  |
| SURVEY PLOTTED BY |  |
| DESIGNED BY       |  |
| QUANTITIES BY     |  |
| CHECKED BY        |  |
| ORIGINAL PLAN     |  |
| NOTE BOOK         |  |
| No.               |  |