

FED. ROAD DIST. NO.	STATE	FED. AID PROJ. NO.	FISCAL YEAR	SHEET NO.	TOTAL SHEETS
HAWAII	HAW.	STP-BW-0300(8)	2019	83	171

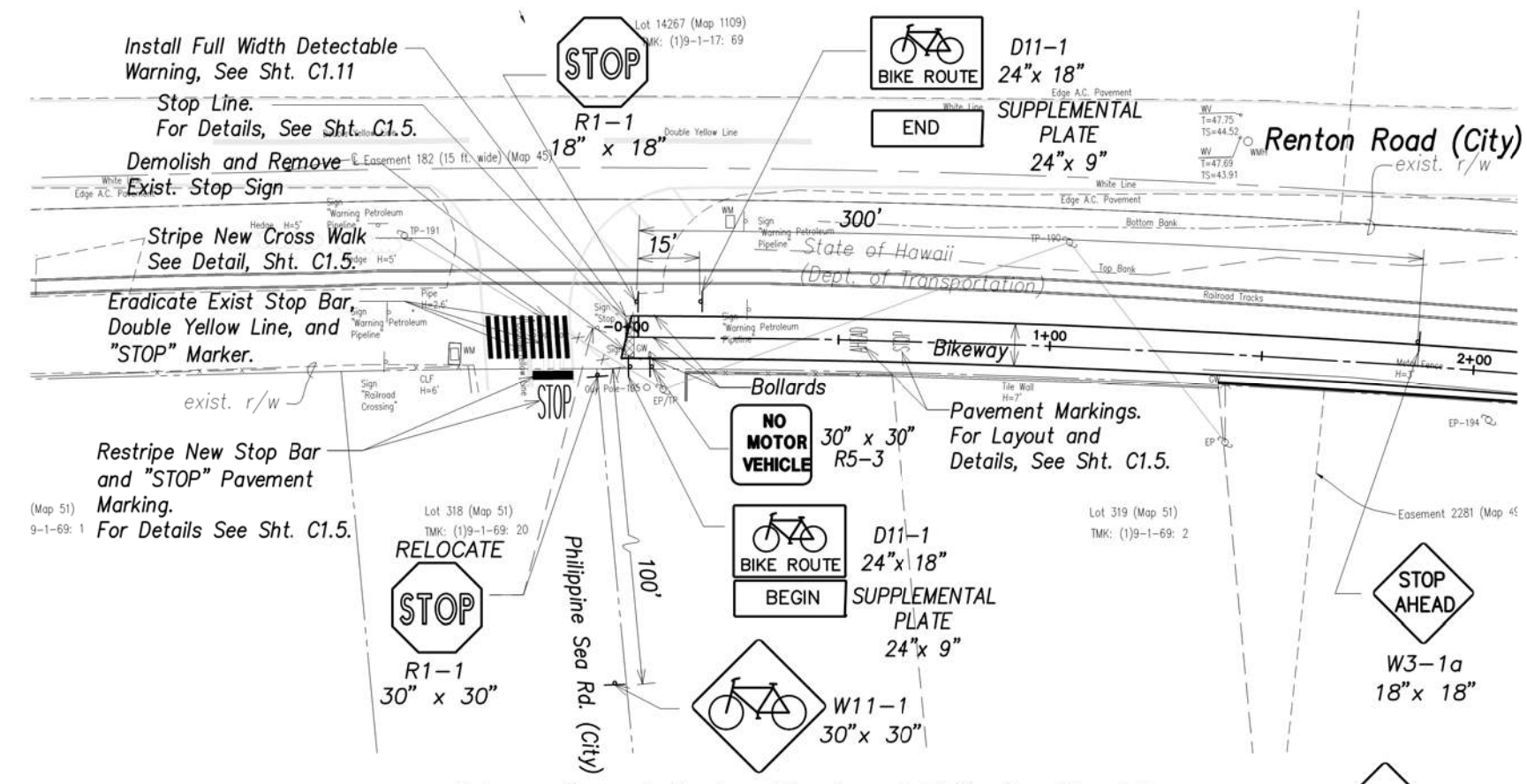

Intersection at Renton Road and Philippine Sea St.
Scale: 1" = 20'

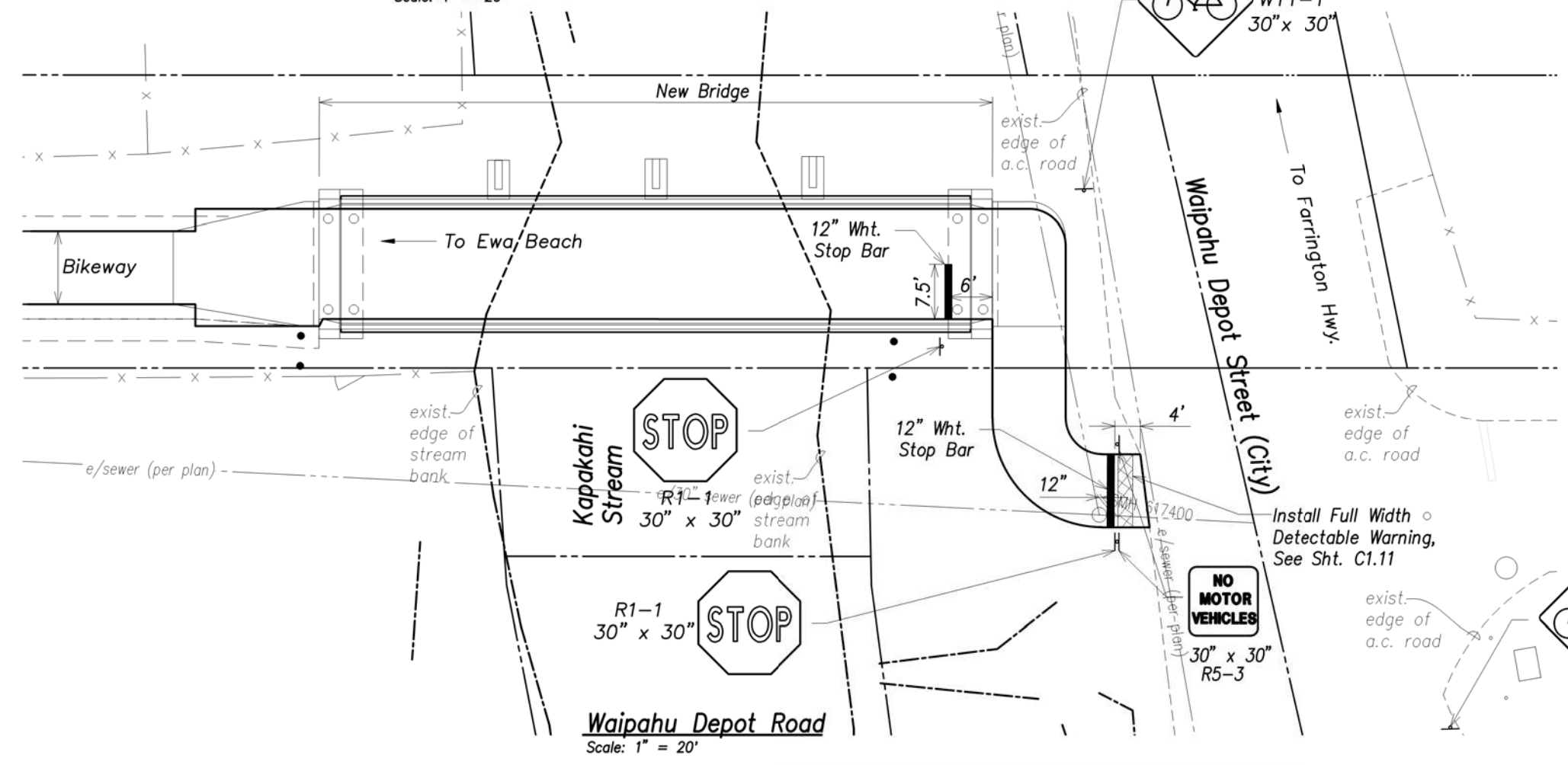

Waipahu Depot Road
Scale: 1" = 20'

APPROVED BY

Chief, Traffic Review Branch, DPP Date
(For Work within City R/W only)

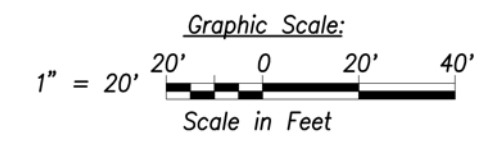

SURVEY PLOTTED BY	DATE
DRAWN BY	
DESIGNED BY	
QUANTITIES BY	
CHECKED BY	
ORIGINAL PLAN	
NOTE BOOK	
No.	

STACY K. YOKOJIMA
LICENSED PROFESSIONAL ENGINEER
No. 8863-C
HAWAII, U.S.A.
APR 30 2020
DATE OF LICENSE EXPIRY

STATE OF HAWAII
DEPARTMENT OF TRANSPORTATION
HIGHWAYS DIVISION

SIGNING AND STRIPING PLAN - 1

LEEWARD BIKEWAY
Philippine Sea Rd. to Waipahu Depot Street
Fed. Aid Proj. No. STP-BW-0300(8)

Date: July 1, 2019

SHEET No. C6.1 OF 3 SHEETS

FED. ROAD DIST. NO.	STATE	FED. AID PROJ. NO.	FISCAL YEAR	SHEET NO.	TOTAL SHEETS
HAWAII	HAW.	STP-BW-0300(8)	2019	84	171

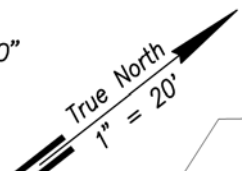

Exist. Type H Marker and Edge Stripe to Remain, Typ.

Pavt. Markings See Details, Sht. C1.5.

Mount on Exist. Lt. Pole #16, @ KP Sta. 49+95

exist. r/w (City)

Pedestrian Flashing Beacons and Ped. Push Button, For Details, See Shts. C1.13 and E1.4

Stripe New Crosswalks See Details, Sht. C1.5, Typ.

Remove Exist. Sign and Post

Pedestrian Flashing Beacons and Ped. Push Button, For Details, See Shts. C1.13 and E1.4

Stripe New Stop Bar See Details, Sht. C1.5, Typ.

exist. r/w (State)

Stripe New Stop Bar See Details, Sht. C1.5, Typ.



R1-5C 24" x 18"



R9-5 12" x 18"

M7-1 12" x 9"



R1-1 18" x 18"



W3-1 18" x 18"

Pavement Markings. For Layout and Details, See Sht. C1.5.



30" x 30" R5-3



K111-15P 24" x 12"

W16-9p 24" x 12"



W11-15 30" x 30"



K111-15P 24" x 12"



W16-9p 24" x 12"



W3-1 18" x 18"



R1-5C 24" x 18"



D11-1 24" x 18"

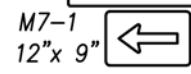

M7-1 12" x 9"

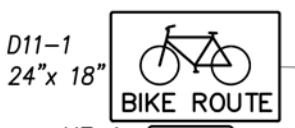

D11-1 24" x 18"

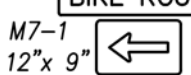

M7-1 12" x 9"



30" x 30" R5-3



18" x 18" R1-1

Kapolei Parkway Intersection
Scale: 1" = 20'

APPROVED BY

Chief, Traffic Review Branch, DPP Date
(For Work within City R/W only)

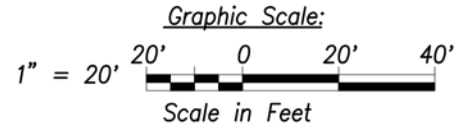

SURVEY PLOTTED BY	DATE
DRAWN BY	
DESIGNED BY	
QUANTITIES BY	
CHECKED BY	
ORIGINAL PLAN	
NOTE BOOK	
No.	



THIS WORK WAS PREPARED BY ME OR UNDER MY SUPERVISION AND CONSTRUCTION OF THIS PROJECT WILL BE UNDER MY OBSERVATION. OBSERVATION OF CONSTRUCTION IS DEFINED BY CHAPTER 10-115, HAWAII ADMINISTRATIVE RULES, ENTITLED "PROFESSIONAL ENGINEERS, ARCHITECTS, SURVEYORS AND LANDSCAPE ARCHITECTS."
DATE OF LICENSE EXPIRY

STATE OF HAWAII
DEPARTMENT OF TRANSPORTATION
HIGHWAYS DIVISION

SIGNING AND STRIPING PLAN - 2

LEEWARD BIKEWAY
Philippine Sea Rd. to Waipahu Depot Street
Fed. Aid Proj. No. STP-BW-0300(8)

Date: July 1, 2019

SHEET No. C6.2 OF 3 SHEETS

FED. ROAD DIST. NO.	STATE	FED. AID PROJ. NO.	FISCAL YEAR	SHEET NO.	TOTAL SHEETS
HAWAII	HAW.	STP-BW-0300(8)	2019	85	171

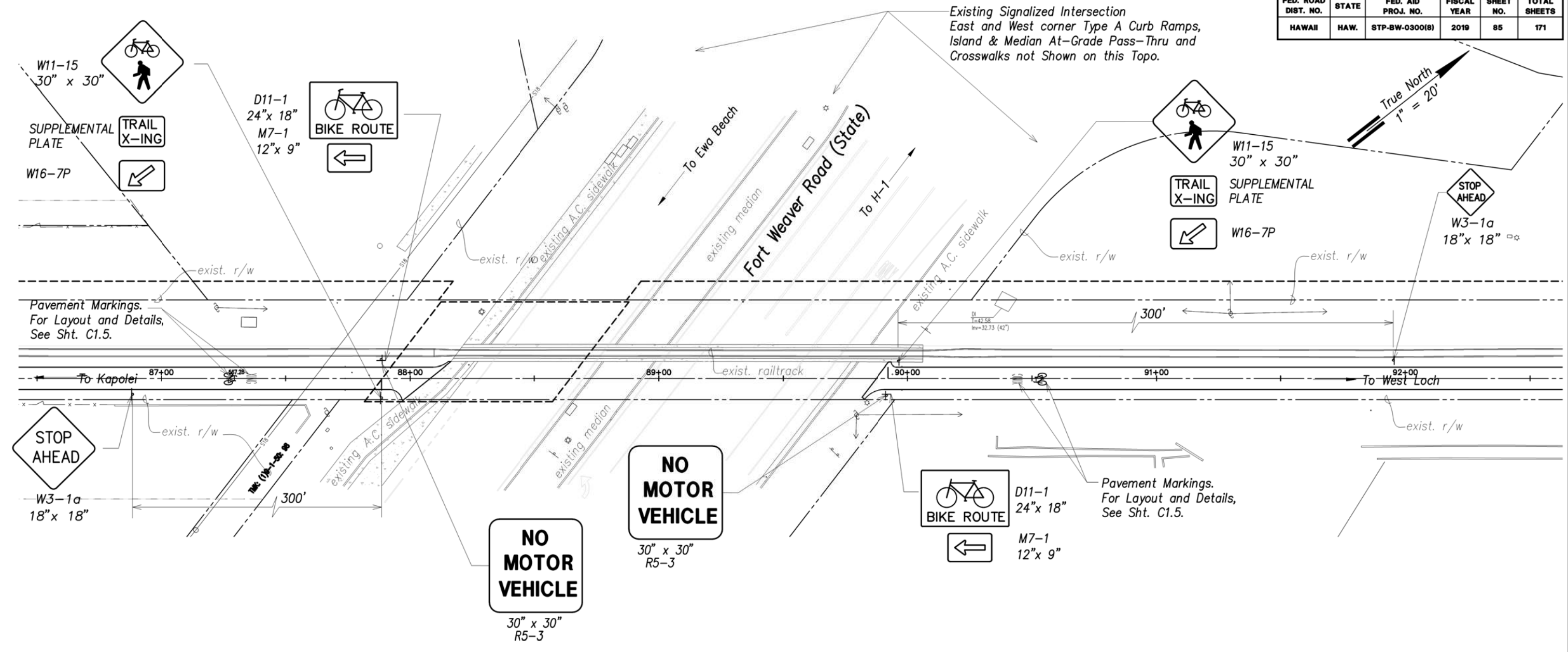

Fort Weaver Road Intersection
Scale: 1" = 20'

SURVEY PLOTTED BY	DATE
DRAWN BY	
DESIGNED BY	
QUANTITIES BY	
CHECKED BY	
ORIGINAL PLAN	
NOTE BOOK	
No.	

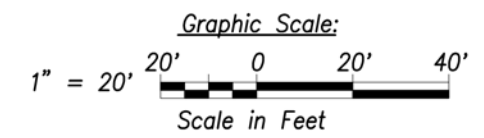

STATE OF HAWAII
DEPARTMENT OF TRANSPORTATION
HIGHWAYS DIVISION

SIGNING AND STRIPING PLAN - 3

LEEWARD BIKEWAY
Philippine Sea Rd. to Waipahu Depot Street
Fed. Aid Proj. No. STP-BW-0300(8)

Date: July 1, 2019

SHEET No. C6.3 OF 3 SHEETS