

FED. ROAD DIST. NO.	STATE	FED. AID PROJ. NO.	FISCAL YEAR	SHEET NO.	TOTAL SHEETS
HAWAII	HAW.	STP-8930(2)	2007	102	331

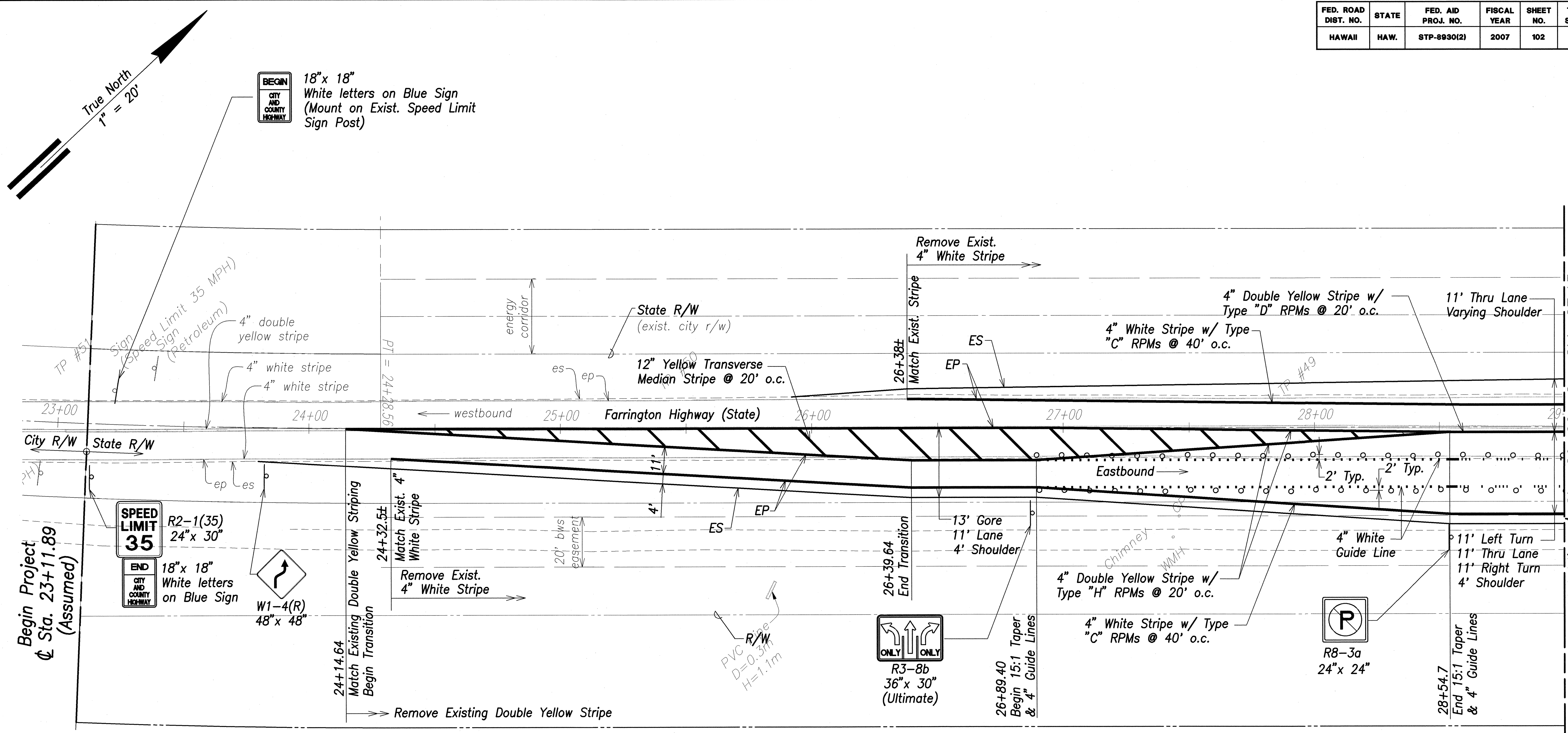

**Striping Plan - @ Sta. 23+11.89 (Assumed) to @ Sta. 29+00**  
Scale: 1" = 20'

**Legend**

- o Temporary 28" High White Tubular Markers @ 10' o.c., Typ.

**Notes:**

1. All New Striping Shall Be Tape, Type I, Type III or Thermoplastic Extrusion
2. Signs designated "Ultimate" shall be covered until North-South Road is open for operations, temporary tubular delineators are removed and the intersection signalization is activated.
3. Temporary tubular delineators shall be removed once North-South Road is open for operations.

SURVEY PLOTTED BY	DATE
DRAWN BY	
DESIGNED BY	
QUANTITIES BY	
CHECKED BY	
ORIGINAL PLAN	
NOTE BOOK	
No.	

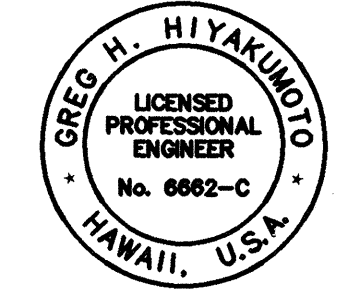
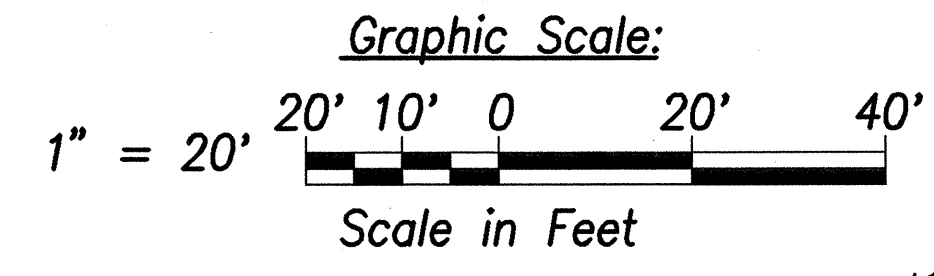

THIS WORK WAS PREPARED BY ME OR UNDER MY SUPERVISION.  
*Greg H. Hiyakundo* APR 30, 2008  
DATE OF SIGNATURE LICENSE EXPIRY

STATE OF HAWAII  
DEPARTMENT OF TRANSPORTATION  
HIGHWAYS DIVISION  
**FARRINGTON HWY.**  
**SIGNING & STRIPING PLAN - 1**  
North-South Road  
Phase 1B  
F.A.I. Proj. No. STP-8930(2)  
Scale: As Shown Date: Feb 21, 2007  
SHEET No. C7.12 OF 150 SHEETS

FED. ROAD DIST. NO.	STATE	FED. AID PROJ. NO.	FISCAL YEAR	SHEET NO.	TOTAL SHEETS
HAWAII	HAW.	STP-8930(2)	2007	103	331

①	②	③
$\Delta = 134^{\circ}35'57''$	$\Delta = 22^{\circ}24'02''$	$\Delta = 22^{\circ}42'02''$
$\frac{1}{2} = 67^{\circ}17'59''$	$\frac{1}{2} = 11^{\circ}21'01''$	$\frac{1}{2} = 11^{\circ}21'01''$
R = 4.00'	R = 75.00'	R = 75.00'
T = 9.56'	T = 15.05'	T = 15.05'
C = 7.38'	C = 29.52'	C = 29.52'
L <sub>c</sub> = 9.40'	L <sub>c</sub> = 29.71'	L <sub>c</sub> = 29.71'

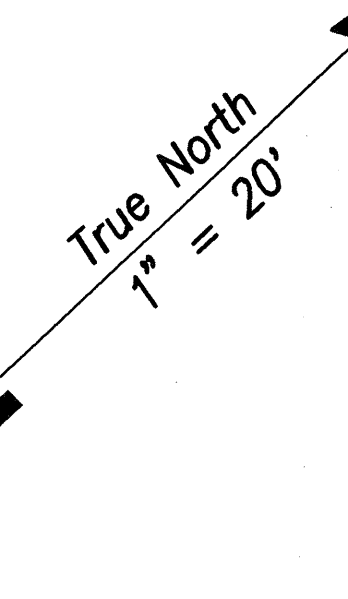

Matchline @ Sta. 29+00  
See Sht. C7.12

Matchline @ Sta. 34+00  
See Sht. 7.14

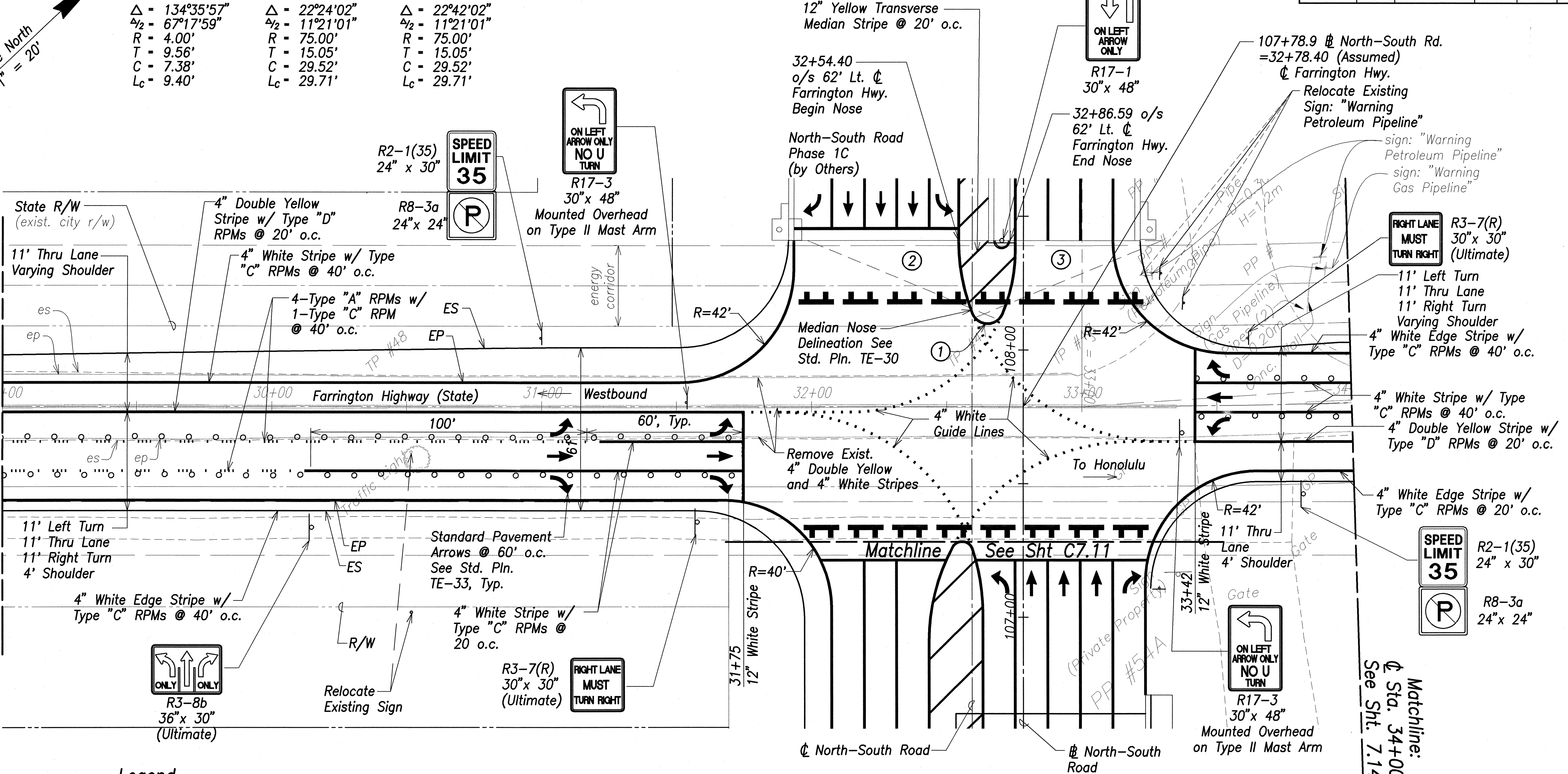

**Legend**

- Type III Barricade w/ Steady Burn Amber lamp. Install one R11-2 per barricade.
- Temporary 28" High White Tubular Markers @ 10' o.c., Typ.

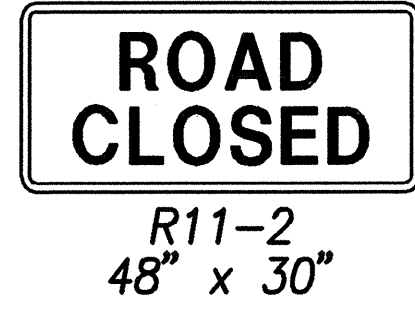

**Striping Plan - @ Sta. 29+00 to @ Sta. 34+00**  
Scale: 1" = 20'

**Notes:**

1. All New Striping Shall Be Tape, Type I, Type III or Thermoplastic Extrusion
2. Signs designated "Ultimate" shall be covered until North-South Road is open for operations, temporary tubular delineators are removed and the intersection signalization is activated.
3. Type III Barricades shall remain in place until North-South Road is open for operations.
4. Temporary tubular delineators shall remain in place until North-South Road is open for operations.

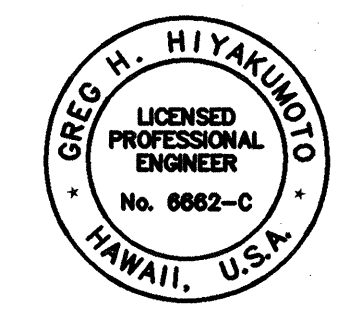
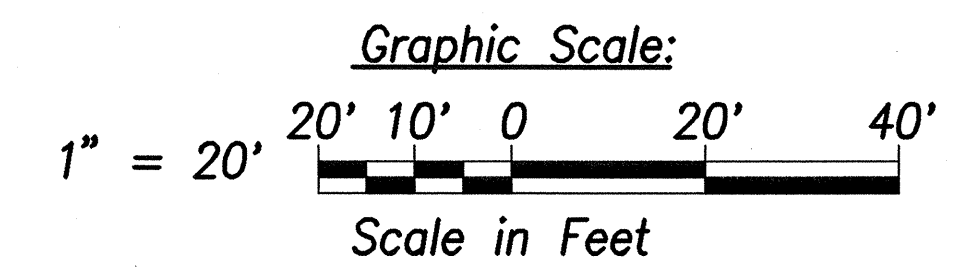

THIS WORK WAS PREPARED BY ME OR UNDER MY SUPERVISION  
DATE OF LICENSE EXPIRY: APR 30, 2008

STATE OF HAWAII  
DEPARTMENT OF TRANSPORTATION  
HIGHWAYS DIVISION  
**FARRINGTON HWY.**  
**SIGNING & STRIPING PLAN - 2**  
North-South Road  
Phase 1B  
F.A.I. Proj. No. STP-8930(2)  
Scale: As Shown Date: Feb 21, 2007  
SHEET No. C7.13 OF 150 SHEETS

SURVEY PLOTTED BY	DATE
DESIGNED BY	
DESIGNED BY	
QUANTITIES BY	
CHECKED BY	
ORIGINAL PLAN	No.
NOTE BOOK	

FED. ROAD DIST. NO.	STATE	FED. AID PROJ. NO.	FISCAL YEAR	SHEET NO.	TOTAL SHEETS
HAWAII	HAW.	STP-8930(2)	2007	104	331

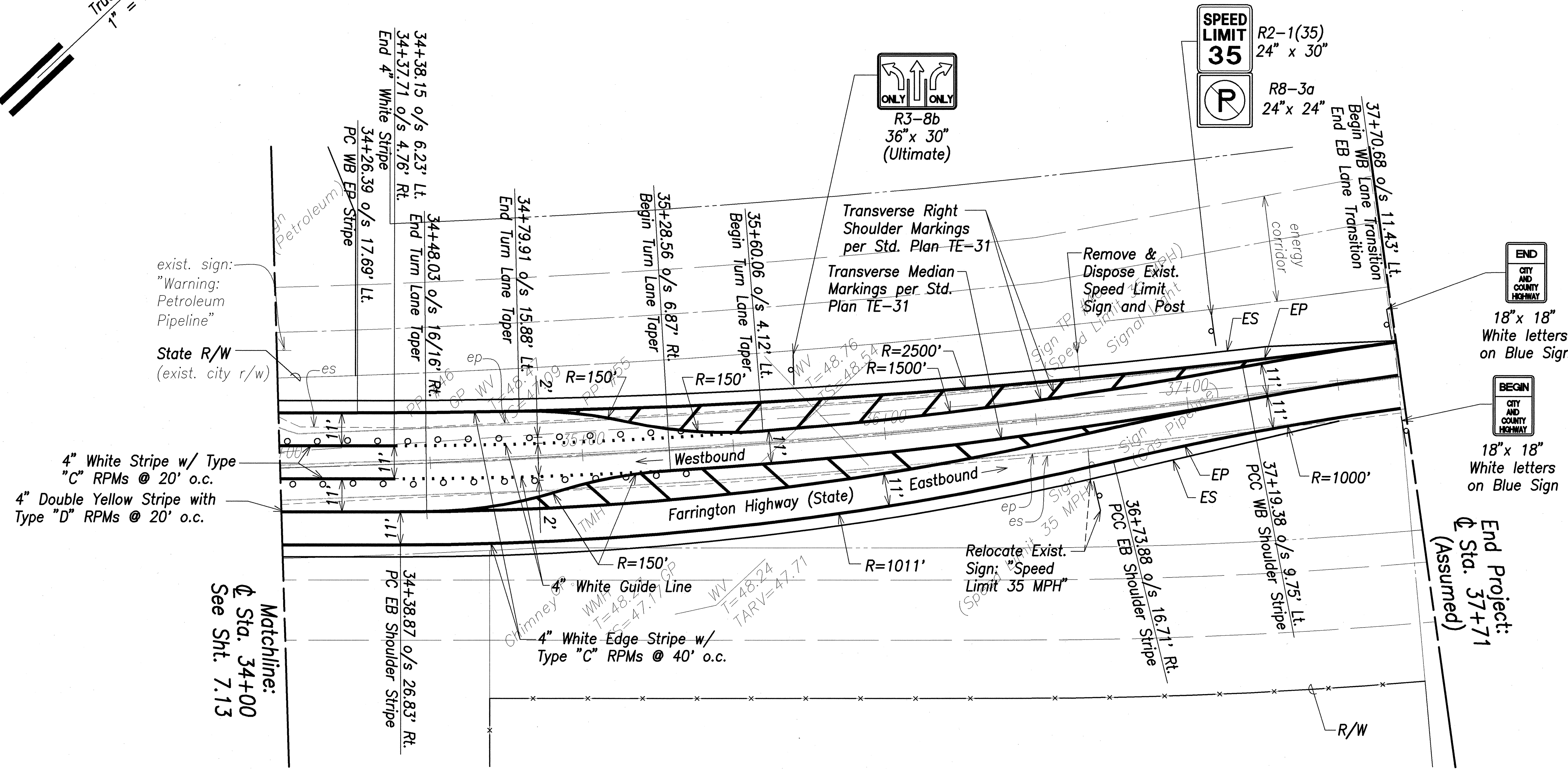
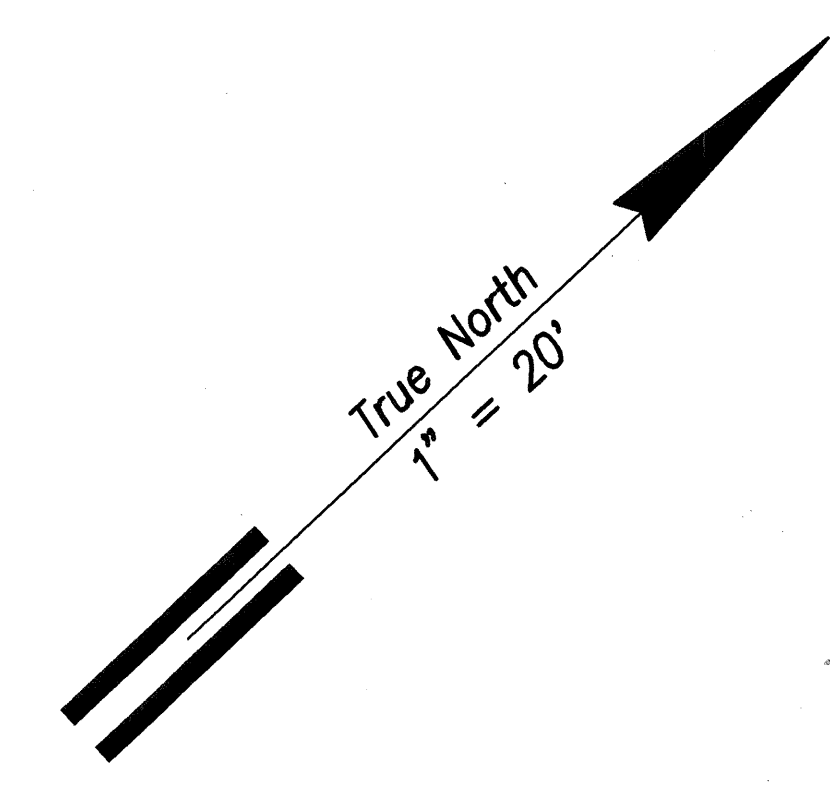

**Striping Plan -  $\phi$  Sta. 34+00 to  $\phi$  Sta. 37+71 (Assumed)**  
Scale: 1" = 20'

- Notes:**
1. All New Striping Shall Be Tape, Type I, Type III or Thermoplastic Extrusion
  2. Signs designated "Ultimate" shall be covered until North-South Road is open for operations, temporary tubular delineators are removed and the intersection signalization is activated.
  3. Temporary tubular delineators shall be removed once North-South Road is open for operations.

- Legend**
- o Temporary 28" High White Tubular Markers @ 10' o.c., Typ.

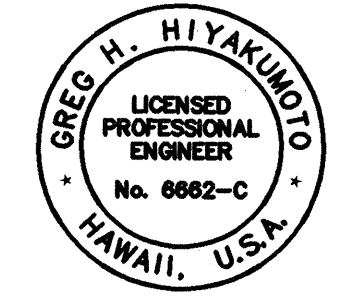
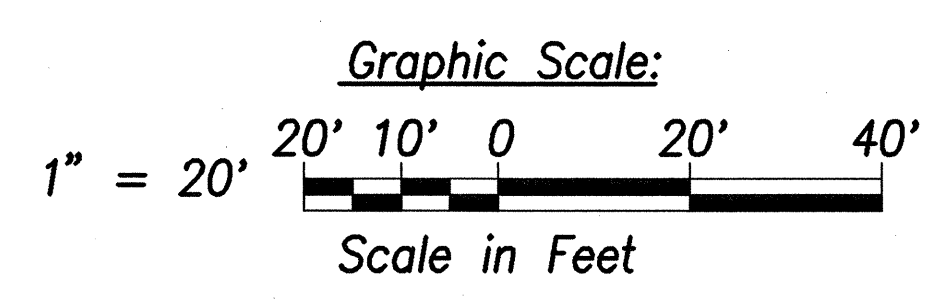

STATE OF HAWAII  
DEPARTMENT OF TRANSPORTATION  
HIGHWAYS DIVISION  
**FARRINGTON HWY.**  
**SIGNING & STRIPING PLAN - 3**  
North-South Road  
Phase 1B  
F.A.I. Proj. No. STP-8930(2)

Scale: As Shown      Date: Feb 21, 2007  
SHEET No. C7.14 OF 150 SHEETS

SURVEY PLATTED BY	DATE
DRAWN BY	
DESIGNED BY	
QUANTITIES BY	
CHECKED BY	
ORIGINAL PLAN	
NOTE BOOK	
No.	