

FED. ROAD DIST. NO.	STATE	PROJ. NO.	FISCAL YEAR	SHEET NO.	TOTAL SHEETS
HAWAII	HAW.	7601A-01-09	2010	37	41

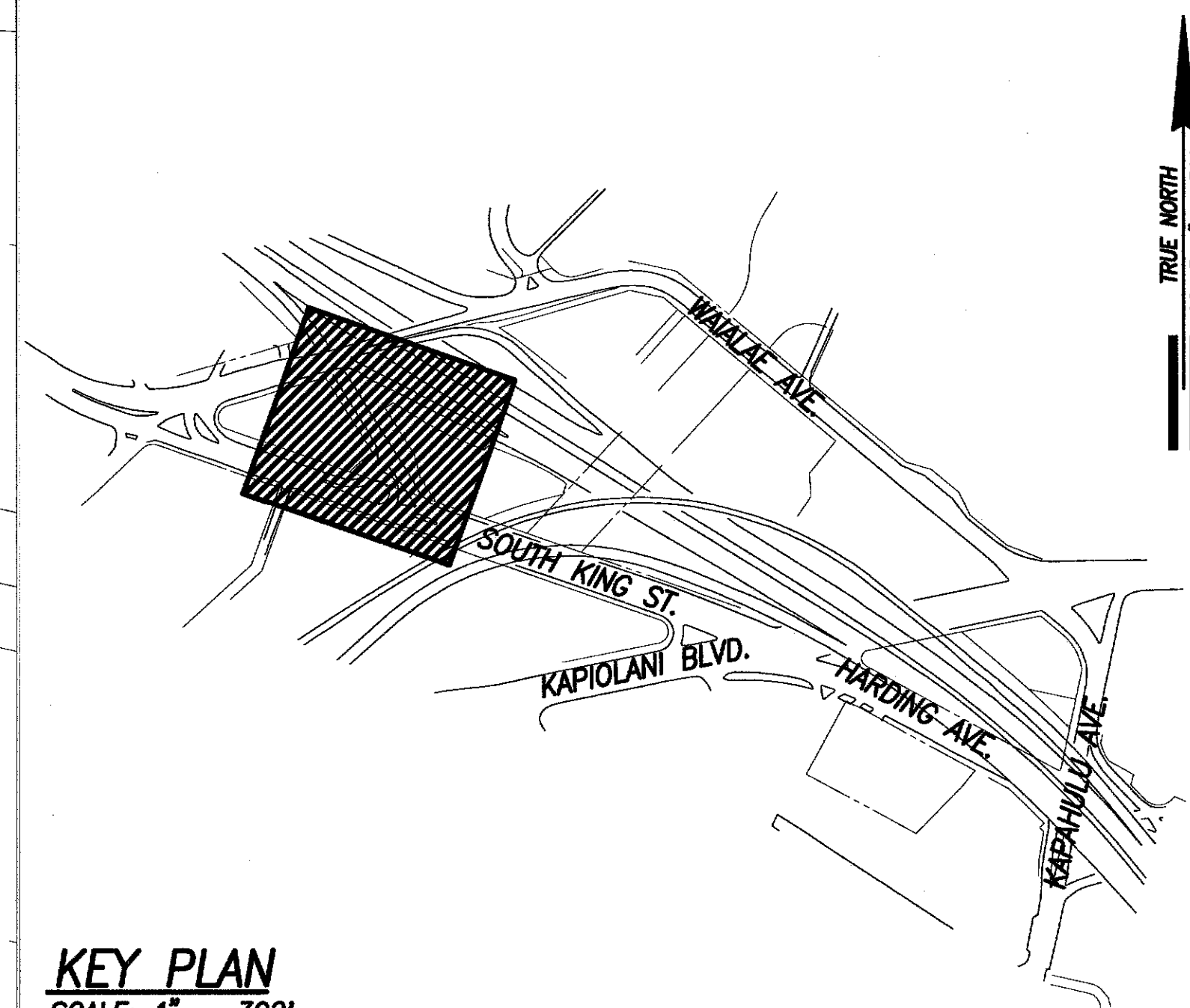

KEY PLAN
SCALE: 1" = 300'

LEGEND

- TRAFFIC CONE (RETROREFLECTIVE)
- TRAFFIC FLOW DIRECTION
- ⚠ WARNING SIGN (RETROREFLECTIVE)
- ▨ WORK AREA WITH 10' O.C. CONES

NOTES:

1. TRAFFIC CONES SHALL BE SPACED AT 20' O.C. ALONG TAPERS, TANGENTS AND AT 10' O.C. IN BUFFER ZONE AND WORK AREAS AND OPPOSING TRAFFIC.
2. THE CONTRACTOR SHALL PROVIDE VEHICLE AND SAFE PEDESTRIAN ACCESS TO ALL DRIVEWAYS AFFECTED BY THE CONSTRUCTION OF THIS PROJECT AT ALL TIMES.
3. POSTED SPEED LIMIT IS 25 MPH.

GRAPHIC SCALE

1" = 20' 20' 10' 0' 20' 40'

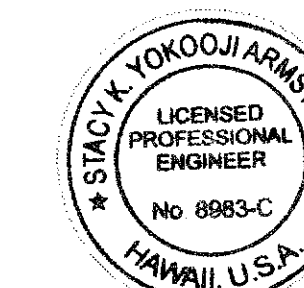

THIS WORK WAS PREPARED BY ME OR UNDER MY SUPERVISION AND CONSTRUCTION OF THIS PROJECT WILL BE UNDER MY OBSERVATION.

Signature: *Staci K. Yokooji* DATE: April 30, 2012

"OBSERVATION OF CONSTRUCTION" IS DEFINED IN CHAPTER 16-115, HAWAII ADMINISTRATIVE RULES ENTITLED "PROFESSIONAL ENGINEERS, ARCHITECTS, SURVEYORS AND LANDSCAPE ARCHITECTS".

STATE OF HAWAII
DEPARTMENT OF TRANSPORTATION
HIGHWAYS DIVISION

TRAFFIC CONTROL PLAN
S. KING ST. AT H-1 E.B. OFF-RAMP
Pedestrian Facilities & ADA Compliance,
Vicinity of Old Waialae Rd. and S. King St.
Proj. No. 7601A-01-09

Scale: 1" = 20'
Date: March 2010

SHEET No. C-36 OF 41 SHEETS

TRAFFIC CONTROL PLAN - SOUTH KING ST. AT H-1 E.B. OFF-RAMP
SCALE: 1" = 20'

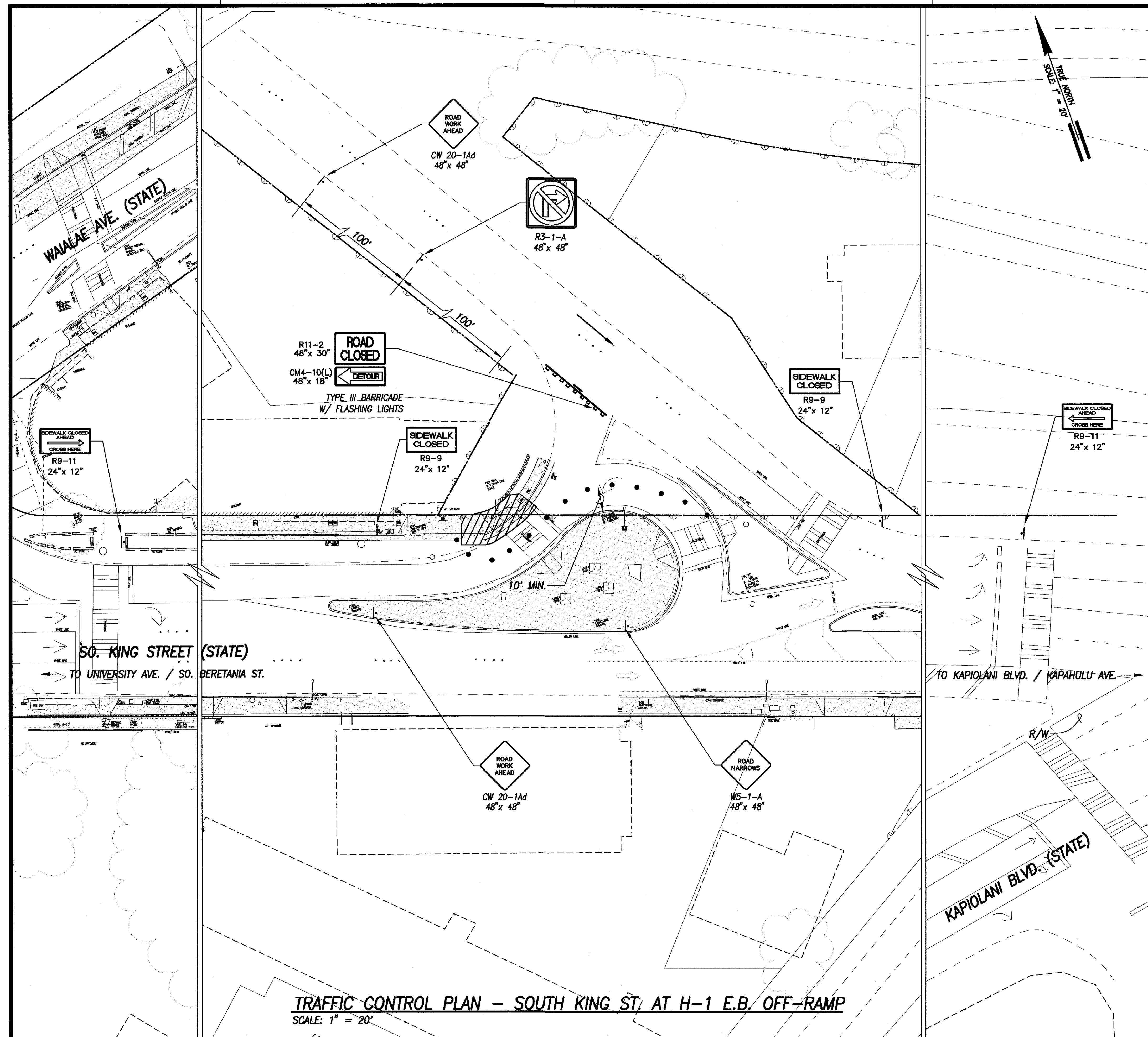

SURVEY PLOTTED BY	DATE
DRAWN BY	
TRACED BY	
NOTES BOOK	
QUANTITIES BY	
CHECKED BY	
No.	

FED. ROAD DIST. NO.	STATE	PROJ. NO.	FISCAL YEAR	SHEET NO.	TOTAL SHEETS
HAWAII	HAW.	7601A-01-09	2010	38	41

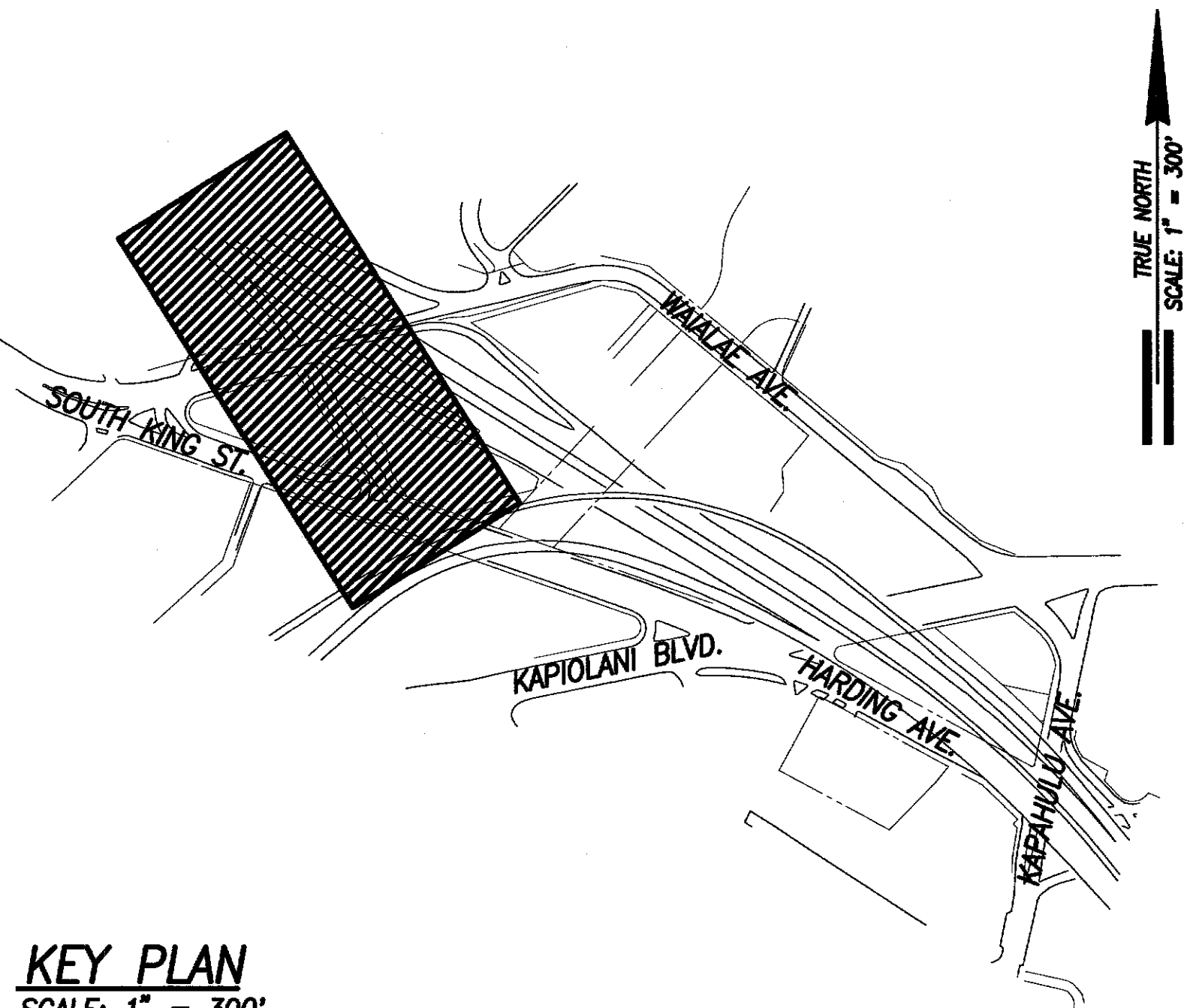

KEY PLAN
SCALE: 1" = 300'

LEGEND

- TRAFFIC CONE (RETROREFLECTIVE)
- TRAFFIC FLOW DIRECTION
- ⚠ WARNING SIGN (RETROREFLECTIVE)
- ▨ WORK AREA WITH 10' O.C. CONES

NOTES:

1. TRAFFIC CONES SHALL BE SPACED AT 20' O.C. ALONG TAPERS, TANGENTS AND AT 10' O.C. IN BUFFER ZONE AND WORK AREAS AND OPPOSING TRAFFIC.
2. THE CONTRACTOR SHALL PROVIDE VEHICLE AND SAFE PEDESTRIAN ACCESS TO ALL DRIVEWAYS AFFECTED BY THE CONSTRUCTION OF THIS PROJECT AT ALL TIMES.
3. POSTED SPEED LIMIT IS 25 MPH.

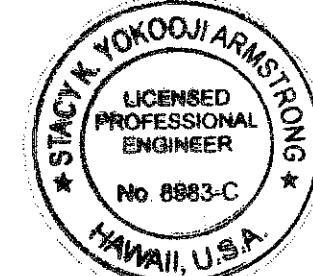
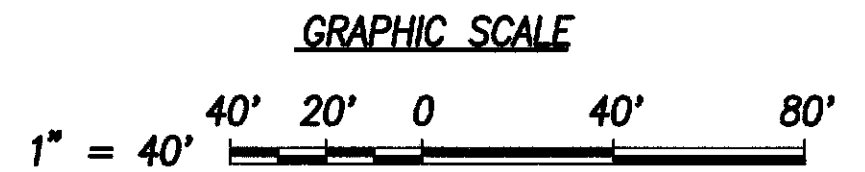

THIS WORK WAS PREPARED BY ME OR UNDER MY SUPERVISION AND CONSTRUCTION OF THIS PROJECT WILL BE UNDER MY OBSERVATION.

Stacy K. Yokooj Armstrong April 30, 2012
SIGNATURE DATE

"OBSERVATION OF CONSTRUCTION" IS DEFINED IN CHAPTER 16-115, HAWAII ADMINISTRATIVE RULES ENTITLED "PROFESSIONAL ENGINEERS, ARCHITECTS, SURVEYORS AND LANDSCAPE ARCHITECTS".

STATE OF HAWAII
DEPARTMENT OF TRANSPORTATION
HIGHWAYS DIVISION
TRAFFIC CONTROL PLAN
H-1 OFF-RAMP SIGNING & STRIPING
Pedestrian Facilities & ADA Compliance,
Vicinity of Old Waiālae Rd. and S. King St.
Proj. No. 7601A-01-09
Scale: 1" = 10' Date: March 2010
SHEET No. C-37 OF 41 SHEETS

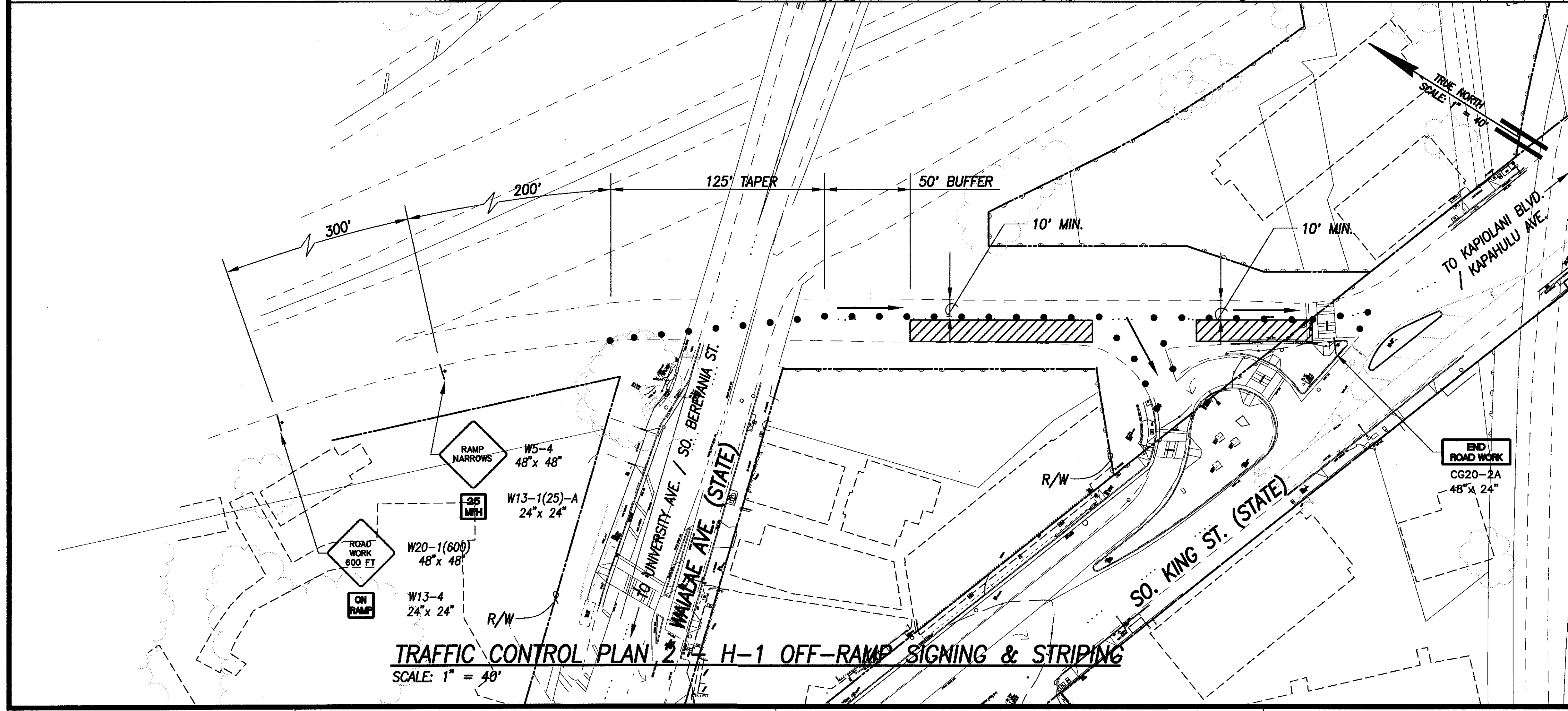
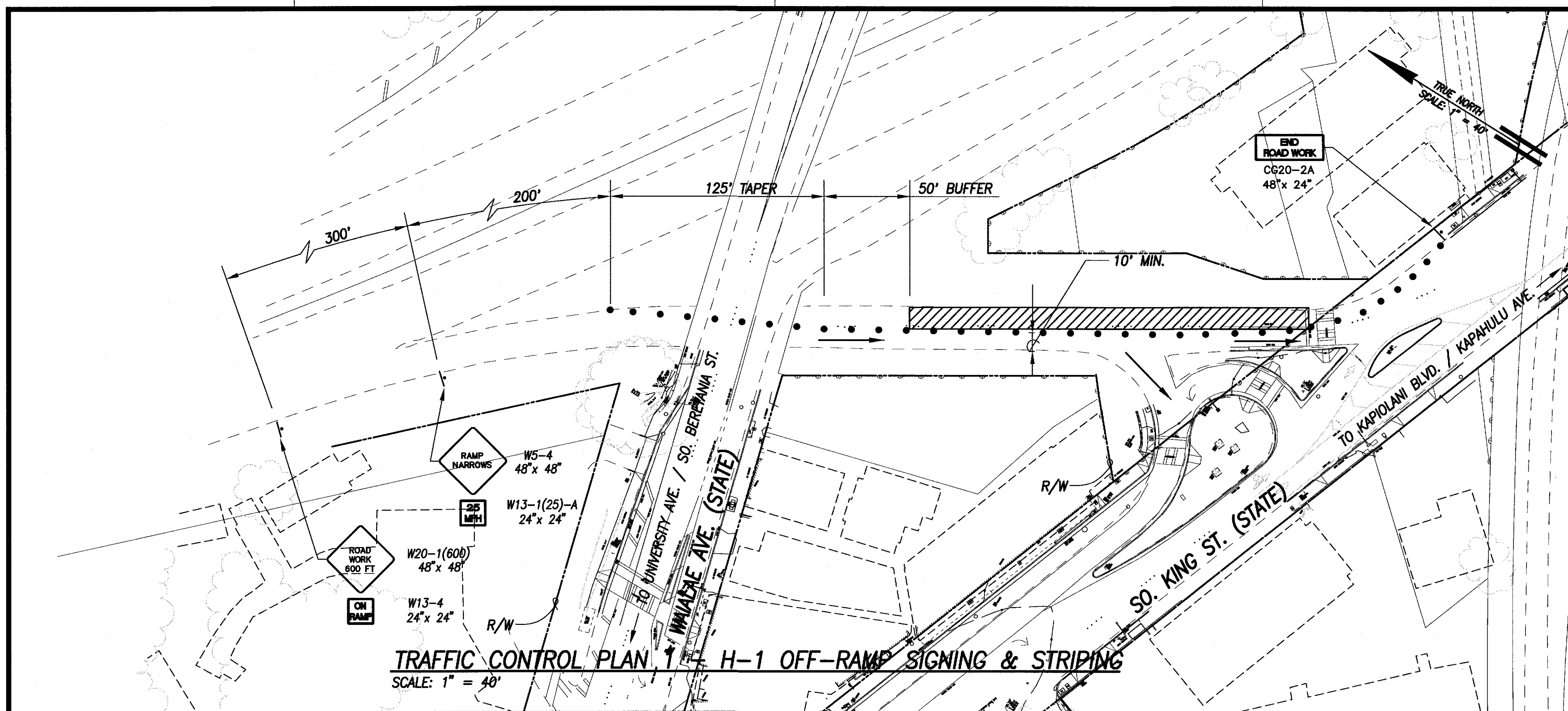

SURVEY PLOTTED BY	DATE
DESIGNED BY	
QUANTITIES BY	
CHECKED BY	
ORIGINAL PLAN	
NOTE BOOK	
No.	

FED. ROAD DIST. NO.	STATE	PROJ. NO.	FISCAL YEAR	SHEET NO.	TOTAL SHEETS
HAWAII	HAW.	7601A-01-09	2010	39	41

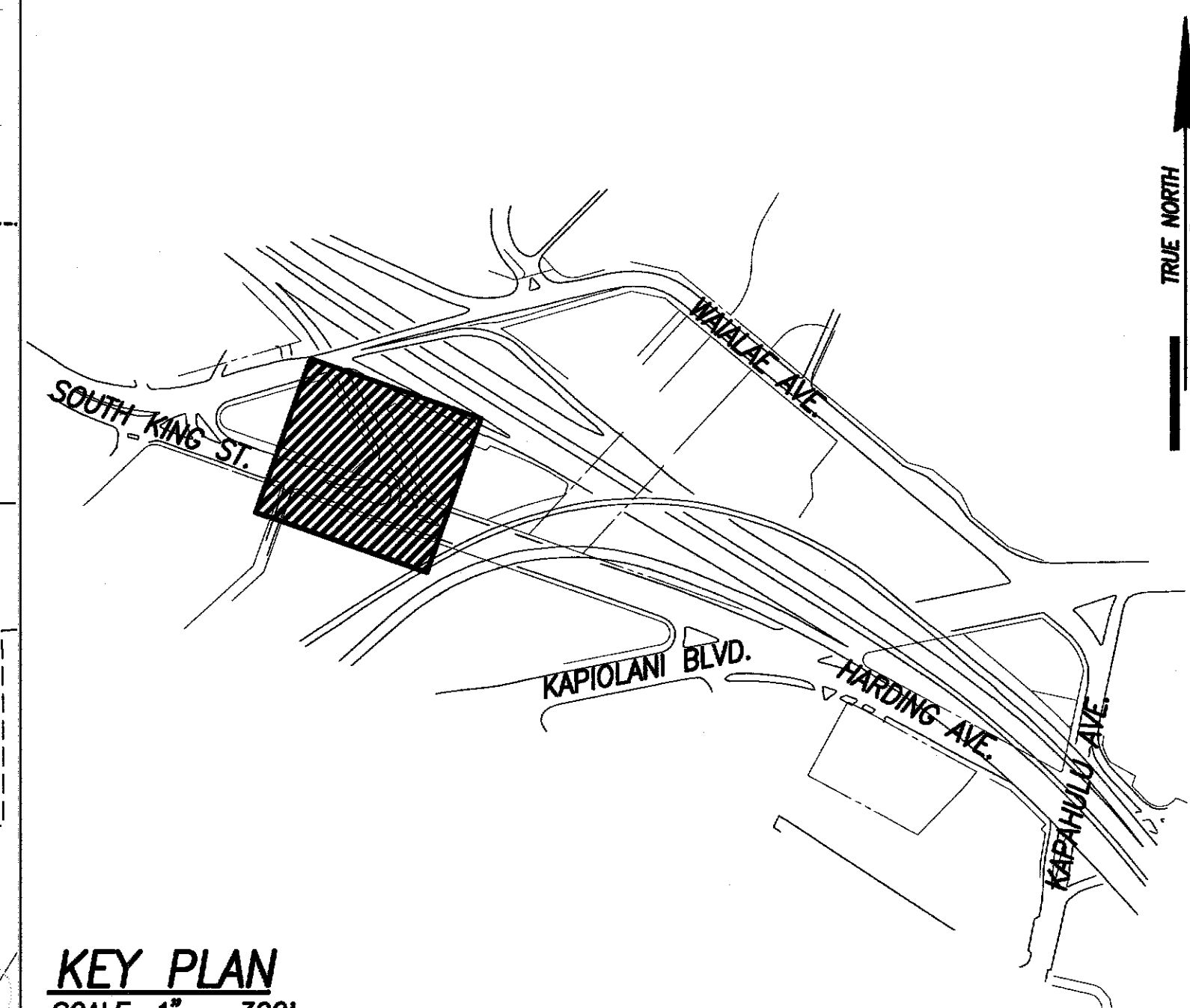

KEY PLAN
SCALE: 1" = 300'

LEGEND

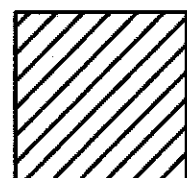
- TRAFFIC CONE (RETROREFLECTIVE)
- TRAFFIC FLOW DIRECTION
- ⚠ WARNING SIGN (RETROREFLECTIVE)
-  WORK AREA WITH 10' O.C. CONES

SURVEY PLOTTED BY	DATE
DRAWN BY	
TRACED BY	
CHECKED BY	
NOTE BOOK	
NO.	

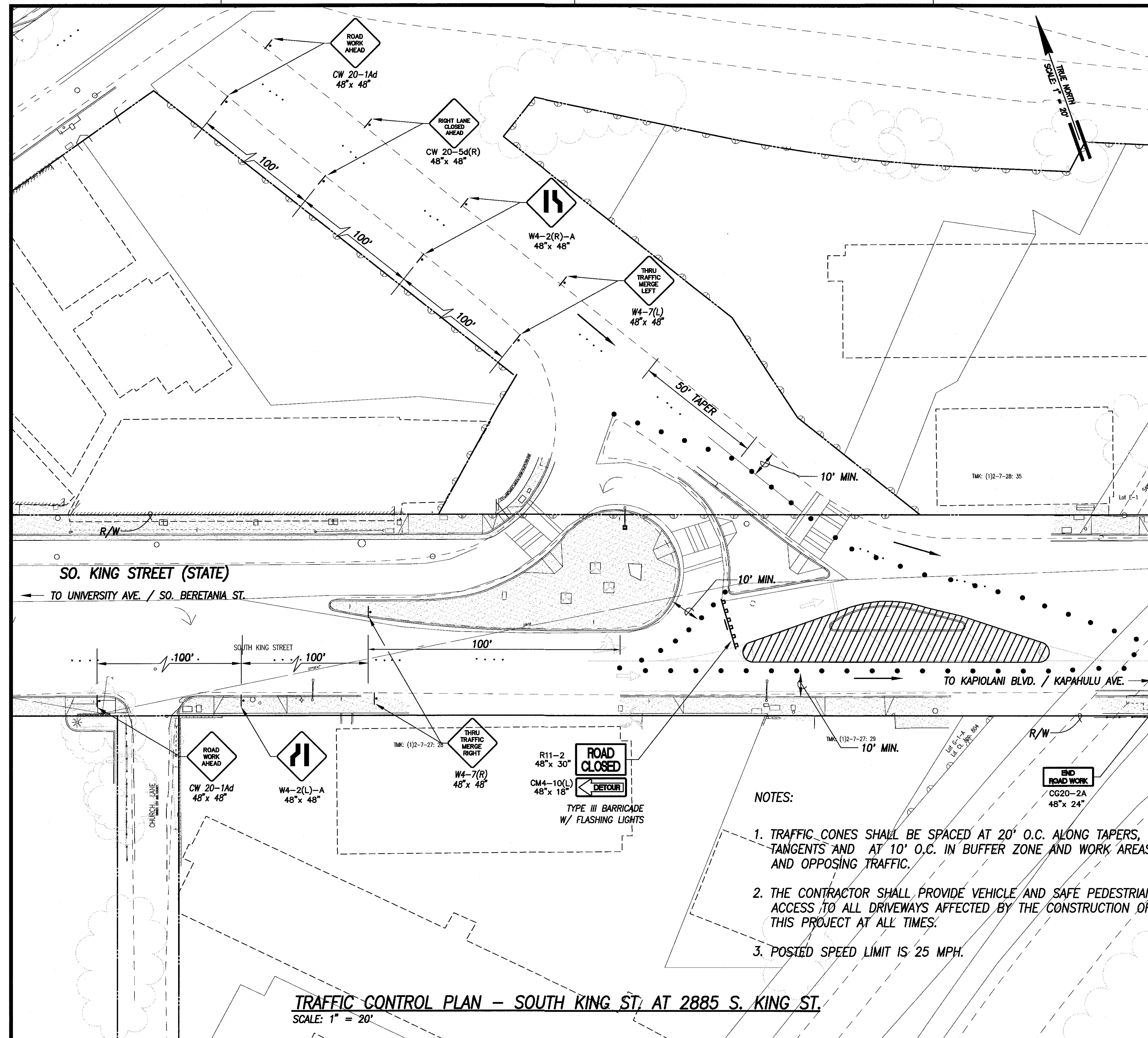

TRAFFIC CONTROL PLAN – SOUTH KING ST. AT 2885 S. KING ST.
SCALE: 1" = 20'

NOTES:

1. TRAFFIC CONES SHALL BE SPACED AT 20' O.C. ALONG TAPERS, TANGENTS AND AT 10' O.C. IN BUFFER ZONE AND WORK AREAS AND OPPOSING TRAFFIC.
2. THE CONTRACTOR SHALL PROVIDE VEHICLE AND SAFE PEDESTRIAN ACCESS TO ALL DRIVEWAYS AFFECTED BY THE CONSTRUCTION OF THIS PROJECT AT ALL TIMES.
3. POSTED SPEED LIMIT IS 25 MPH.

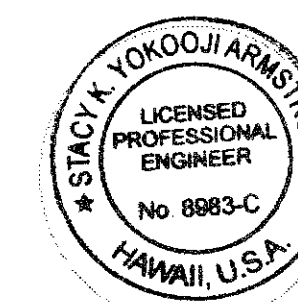

THIS WORK WAS PREPARED BY ME OR UNDER MY SUPERVISION AND CONSTRUCTION OF THIS PROJECT WILL BE UNDER MY OBSERVATION.

SIGNATURE: *Stacy K. Yokooji* DATE: April 30, 2012

"OBSERVATION OF CONSTRUCTION" IS DEFINED IN CHAPTER 16-115, HAWAII ADMINISTRATIVE RULES ENTITLED "PROFESSIONAL ENGINEERS, ARCHITECTS, SURVEYORS AND LANDSCAPE ARCHITECTS".

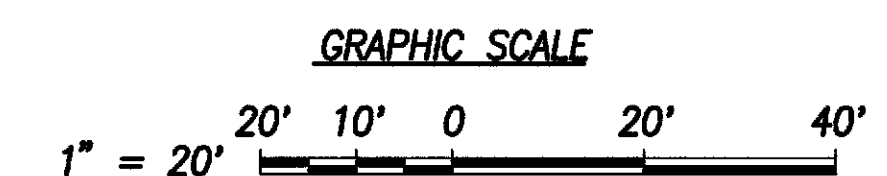

STATE OF HAWAII
DEPARTMENT OF TRANSPORTATION
HIGHWAYS DIVISION

TRAFFIC CONTROL PLAN
S. KING ST. AT 2885 S. KING ST.
*Pedestrian Facilities & ADA Compliance,
Vicinity of Old Waialae Rd. and S. King St.*
Proj. No. 7601A-01-09

Scale: 1" = 20' Date: March 2010

SHEET No. C-38 OF 41 SHEETS

FED. ROAD DIST. NO.	STATE	PROJ. NO.	FISCAL YEAR	SHEET NO.	TOTAL SHEETS
HAWAII	HAW.	7601A-01-09	2010	40	41

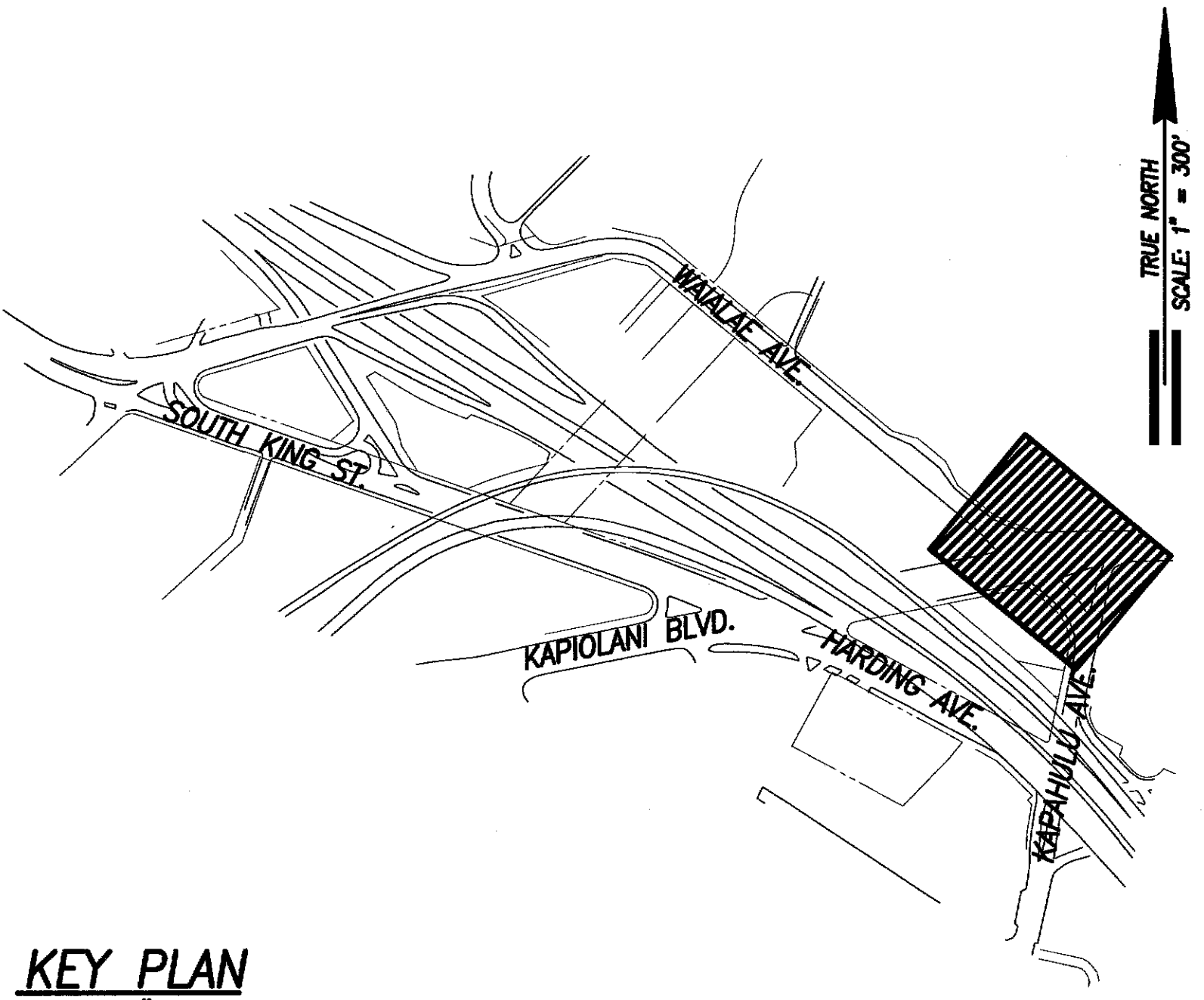

KEY PLAN
SCALE: 1" = 300'

LEGEND

36.13	EXIST. SPOT ELEVATION
52.58	FINISHED SPOT GRADE
51.50 TC	FINISHED TOP OF CURB
51.00 BC	FINISHED BOTTOM OF CURB

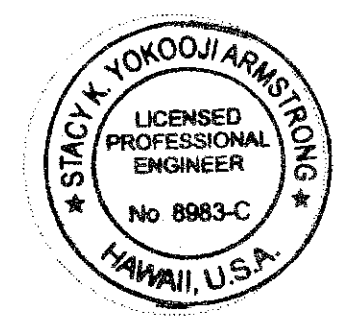
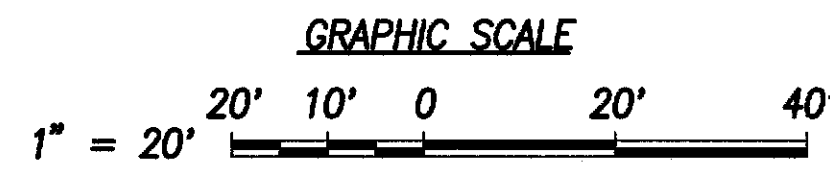

THIS WORK WAS PREPARED BY ME OR UNDER MY SUPERVISION AND CONSTRUCTION OF THIS PROJECT WILL BE UNDER MY OBSERVATION.

Stacy K. Yokojima April 30, 2012
SIGNATURE DATE

"OBSERVATION OF CONSTRUCTION" IS DEFINED IN CHAPTER 16-115, HAWAII ADMINISTRATIVE RULES ENTITLED "PROFESSIONAL ENGINEERS, ARCHITECTS, SURVEYORS AND LANDSCAPE ARCHITECTS".

STATE OF HAWAII
DEPARTMENT OF TRANSPORTATION
HIGHWAYS DIVISION

TRAFFIC CONTROL PLAN
WAIALAE AVE. & KAPAHULU AVE.

*Pedestrian Facilities & ADA Compliance,
Vicinity of Old Waialae Rd. and S. King St.*
Proj. No. 7601A-01-09

Scale: 1" = 20'-0" Date: March 2010

SHEET No. C-39 OF 41 SHEETS

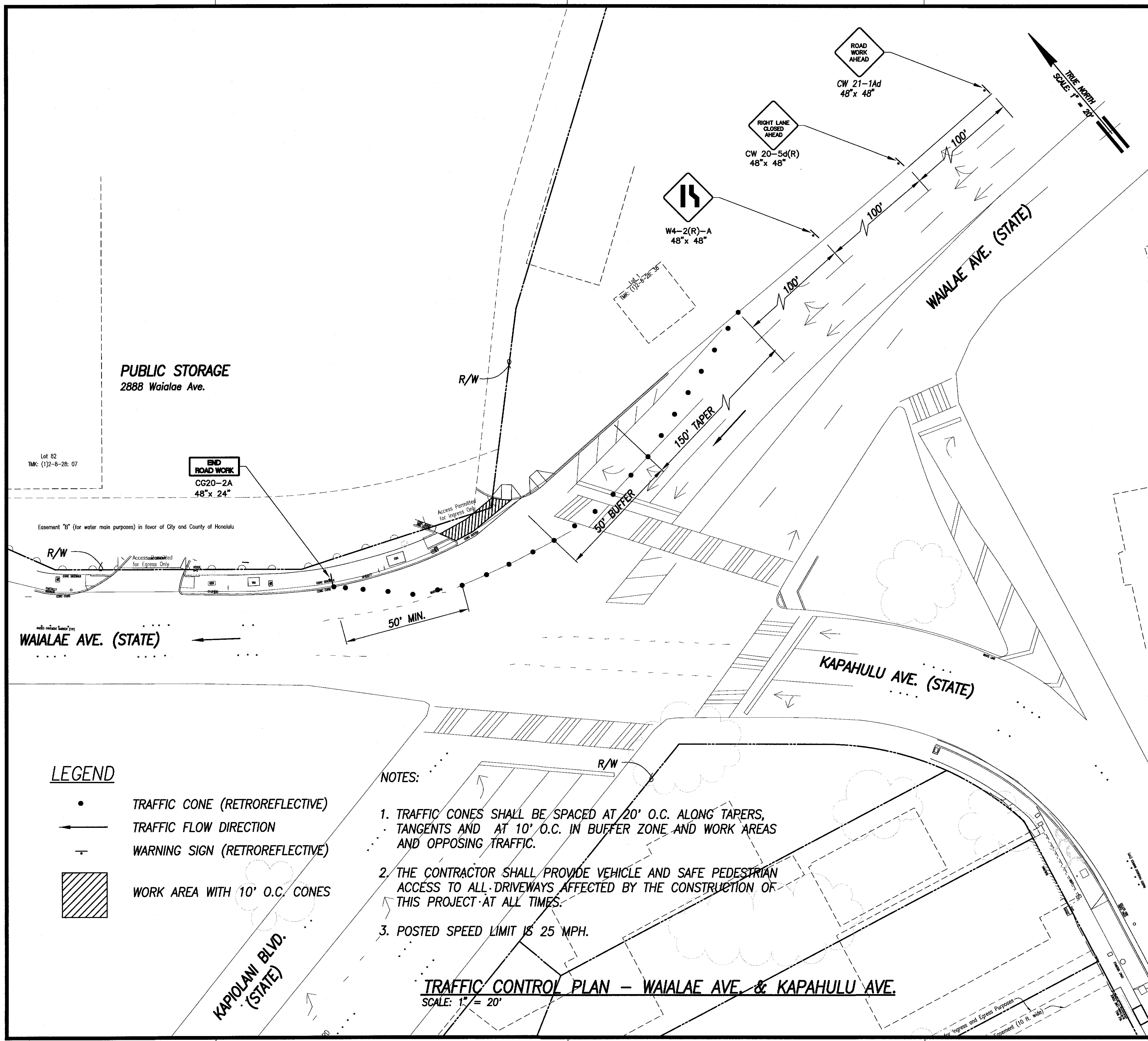

LEGEND

•	TRAFFIC CONE (RETROREFLECTIVE)
→	TRAFFIC FLOW DIRECTION
⚠	WARNING SIGN (RETROREFLECTIVE)
	WORK AREA WITH 10' O.C. CONES

- NOTES:**
1. TRAFFIC CONES SHALL BE SPACED AT 20' O.C. ALONG TAPERS, TANGENTS AND AT 10' O.C. IN BUFFER ZONE AND WORK AREAS AND OPPOSING TRAFFIC.
 2. THE CONTRACTOR SHALL PROVIDE VEHICLE AND SAFE PEDESTRIAN ACCESS TO ALL DRIVEWAYS AFFECTED BY THE CONSTRUCTION OF THIS PROJECT AT ALL TIMES.
 3. POSTED SPEED LIMIT IS 25 MPH.

TRAFFIC CONTROL PLAN - WAIALAE AVE. & KAPAHULU AVE.
SCALE: 1" = 20'

SURVEY PLOTTED BY	DATE
DESIGNED BY	
NOTED BY	
CHECKED BY	
NO.	

FED. ROAD DIST. NO.	STATE	PROJ. NO.	FISCAL YEAR	SHEET NO.	TOTAL SHEETS
HAWAII	HAW.	7601A-01-09	2010	41	41

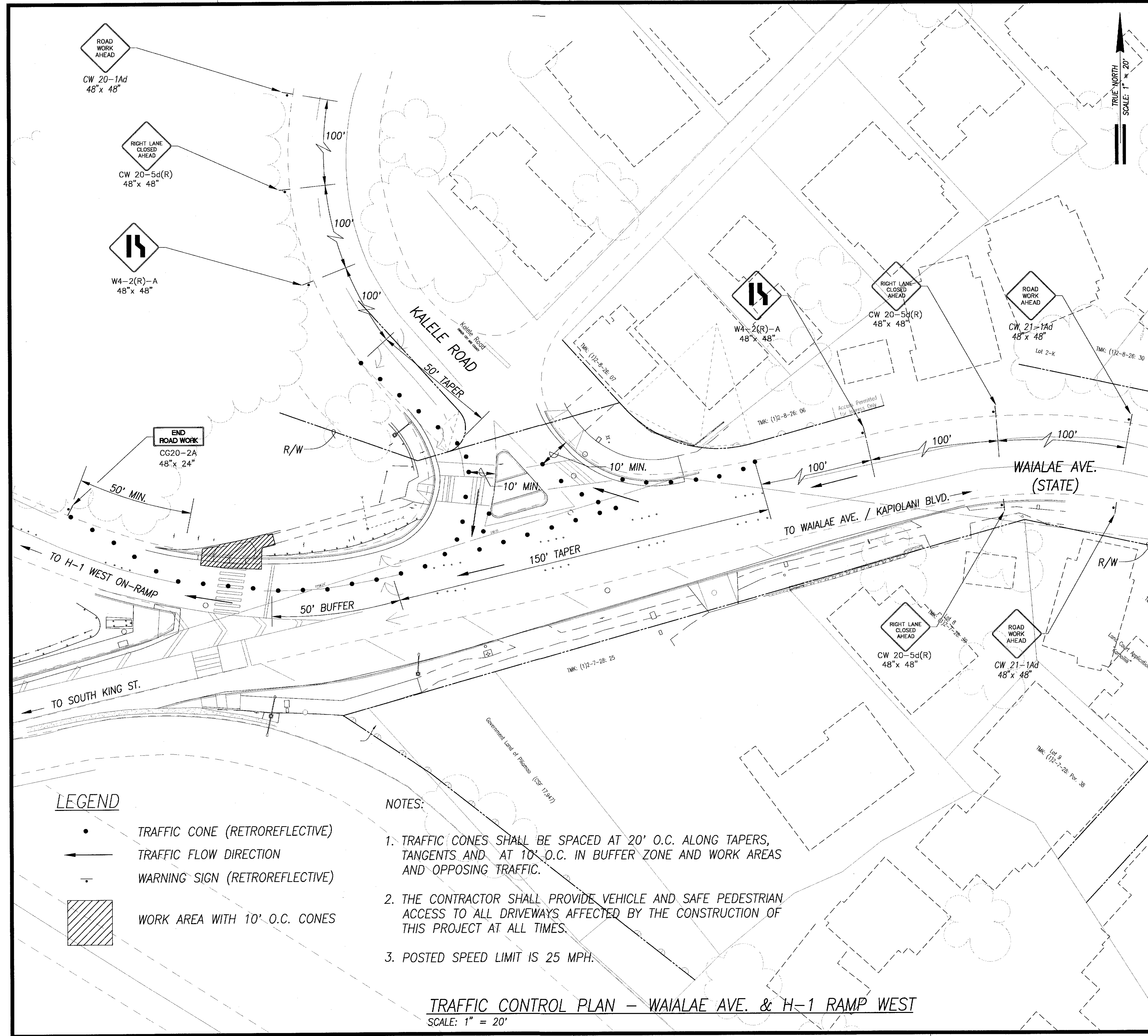
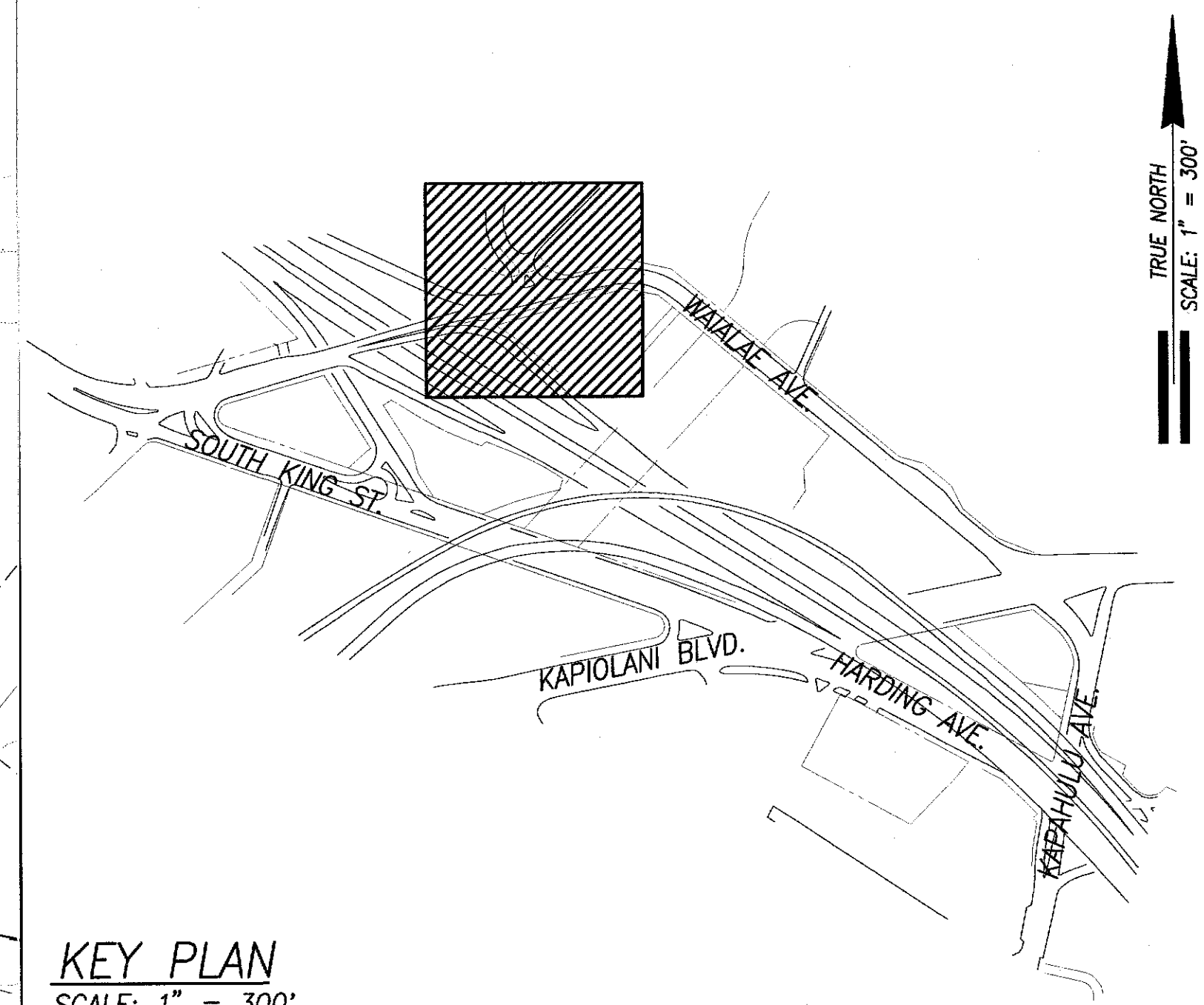

- LEGEND**
- TRAFFIC CONE (RETROREFLECTIVE)
 - ← TRAFFIC FLOW DIRECTION
 - WARNING SIGN (RETROREFLECTIVE)
 - WORK AREA WITH 10' O.C. CONES

- NOTES:**
1. TRAFFIC CONES SHALL BE SPACED AT 20' O.C. ALONG TAPERS, TANGENTS AND AT 10' O.C. IN BUFFER ZONE AND WORK AREAS AND OPPOSING TRAFFIC.
 2. THE CONTRACTOR SHALL PROVIDE VEHICLE AND SAFE PEDESTRIAN ACCESS TO ALL DRIVEWAYS AFFECTED BY THE CONSTRUCTION OF THIS PROJECT AT ALL TIMES.
 3. POSTED SPEED LIMIT IS 25 MPH.

TRAFFIC CONTROL PLAN - WAIALAE AVE. & H-1 RAMP WEST
 SCALE: 1" = 20'

- LEGEND**
- 36.13 EXIST. SPOT ELEVATION
 - 52.58 FINISHED SPOT GRADE
 - 51.50 TC FINISHED TOP OF CURB
 - 51.00 BC FINISHED BOTTOM OF CURB

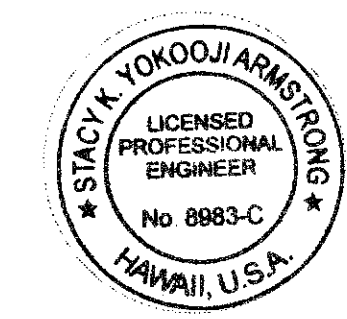
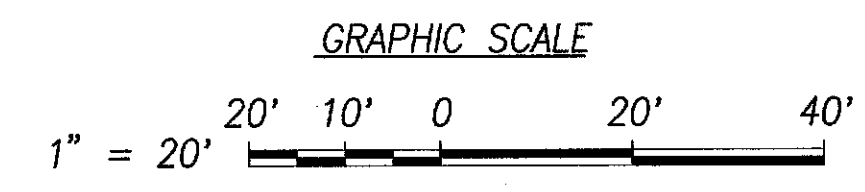

THIS WORK WAS PREPARED BY ME OR UNDER MY SUPERVISION AND CONSTRUCTION OF THIS PROJECT WILL BE UNDER MY OBSERVATION.

Stacy K. Yokoo April 30, 2012
 SIGNATURE DATE

OBSERVATION OF CONSTRUCTION IS DEFINED IN CHAPTER 18-115, HAWAII ADMINISTRATIVE RULES ENTITLED "PROFESSIONAL ENGINEERS, ARCHITECTS, SURVEYORS AND LANDSCAPE ARCHITECTS".

STATE OF HAWAII
DEPARTMENT OF TRANSPORTATION
HIGHWAYS DIVISION

TRAFFIC CONTROL PLAN
WAIALAE AVE. AT H-1 W.B. ON-RAMP
Pedestrian Facilities & ADA Compliance,
Vicinity of Old Waialae Rd. and S. King St.
Proj. No. 7601A-01-09
Scale: 1" = 20'-0" Date: March 2010

SHEET No. C-40 OF 41 SHEETS

SURVEY PLOTTED BY	DATE
DRAWN BY	
DESIGNED BY	
QUANTITIES BY	
CHECKED BY	
ORIGINAL PLAN	
NOTE BOOK	
No.	