

### **A-5: Topography**

- **Erosion Control Plan, Sheet EC-1/3 – Middle Street  
Pavement Reconstruction, North King Street to  
Kamehameha**
- **Erosion Control Plan, Sheet EC-2/3 – Middle Street  
Pavement Reconstruction, North King Street to  
Kamehameha**

FED. ROAD DIST. NO.	STATE	FEDERAL AID PROJ. NO.	FISCAL YEAR	SHEET NO.	TOTAL SHEETS
HAWAII	HAW.	7415A-01-14M	2014	XX	-

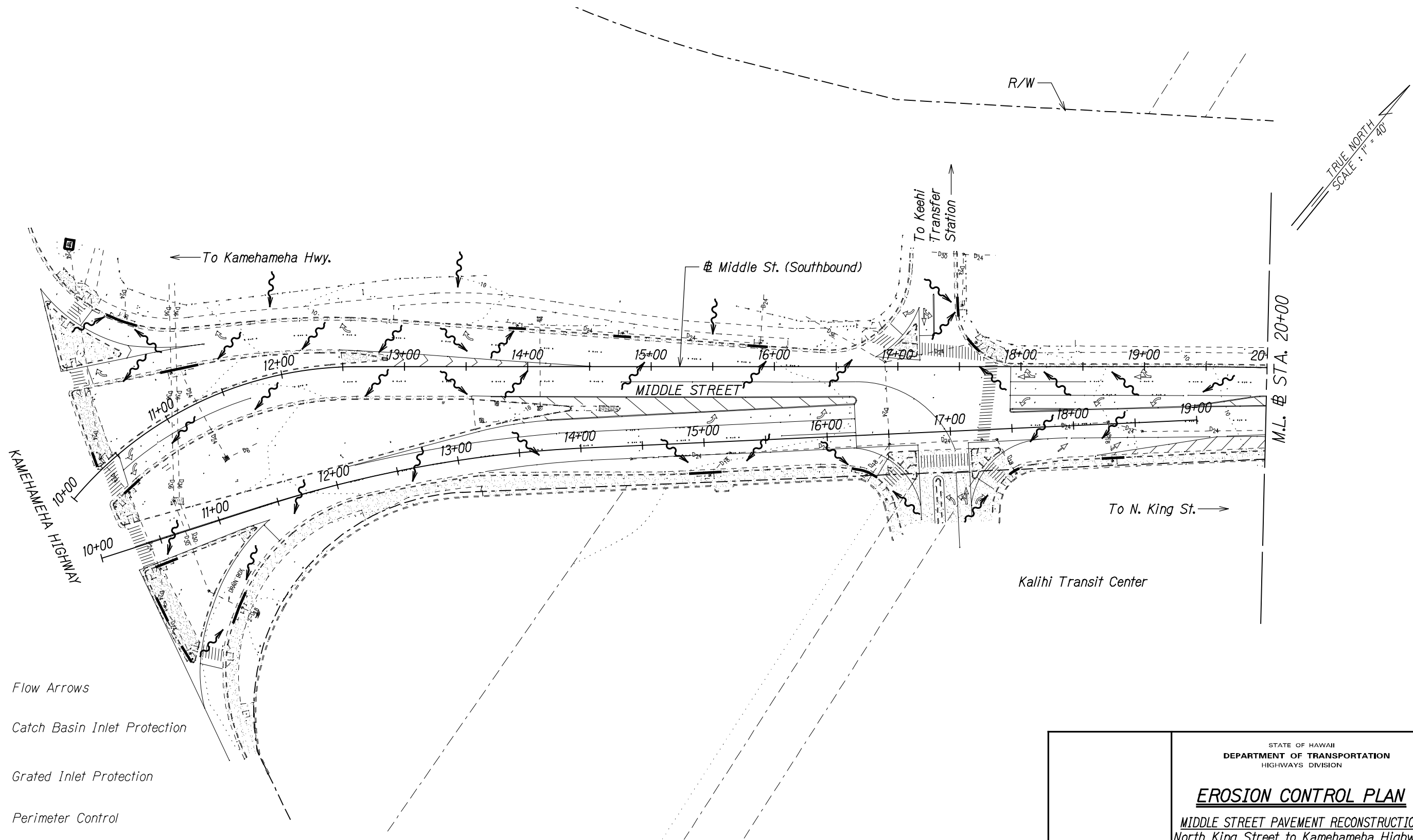

**LEGEND:**

- Flow Arrows
- Catch Basin Inlet Protection
- Grated Inlet Protection
- Perimeter Control
- Stabilized Construction Entrance

ORIGINAL PLAN	SURVEY PLOTTED BY	DATE
NOTE BOOK	DRAWN BY	
	CHECKED BY	
	QUANTITIES BY	
	CHECKED BY	

T:\16543A\_MIDDLE\_ST\_CADD\SHEETS\EC-01.dgn

STATE OF HAWAII  
DEPARTMENT OF TRANSPORTATION  
HIGHWAYS DIVISION

**EROSION CONTROL PLAN**  
MIDDLE STREET PAVEMENT RECONSTRUCTION  
North King Street to Kamehameha Highway  
FAP NO. 7415A-01-14M  
Scale: 1"=40'      Date: Jan. 24, 2014

SHEET No. EC-1 OF 3 SHEETS

FED. ROAD DIST. NO.	STATE	FEDERAL AID PROJ. NO.	FISCAL YEAR	SHEET NO.	TOTAL SHEETS
HAWAII	HAW.	7415A-01-14M	2014	XX	-

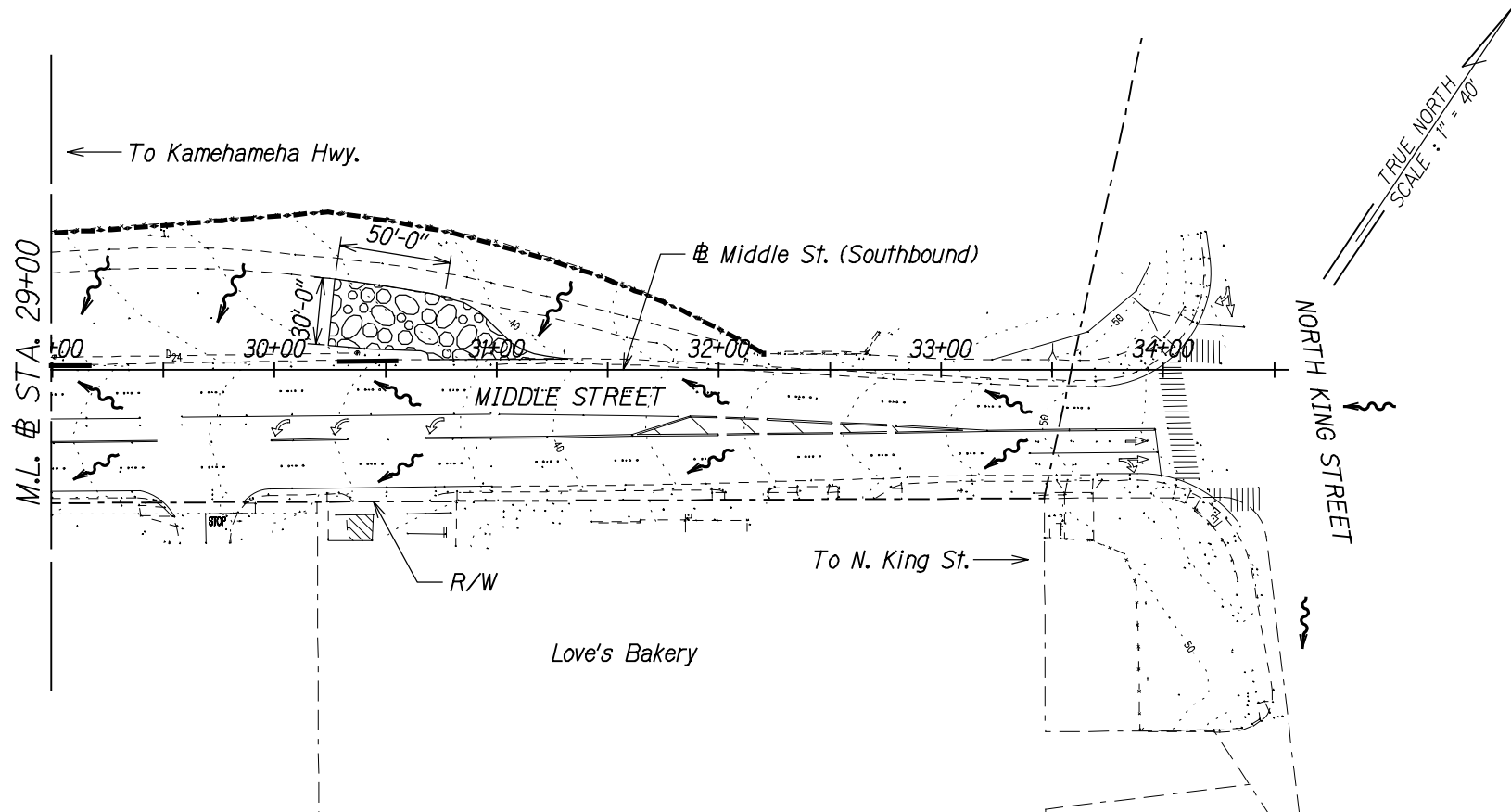
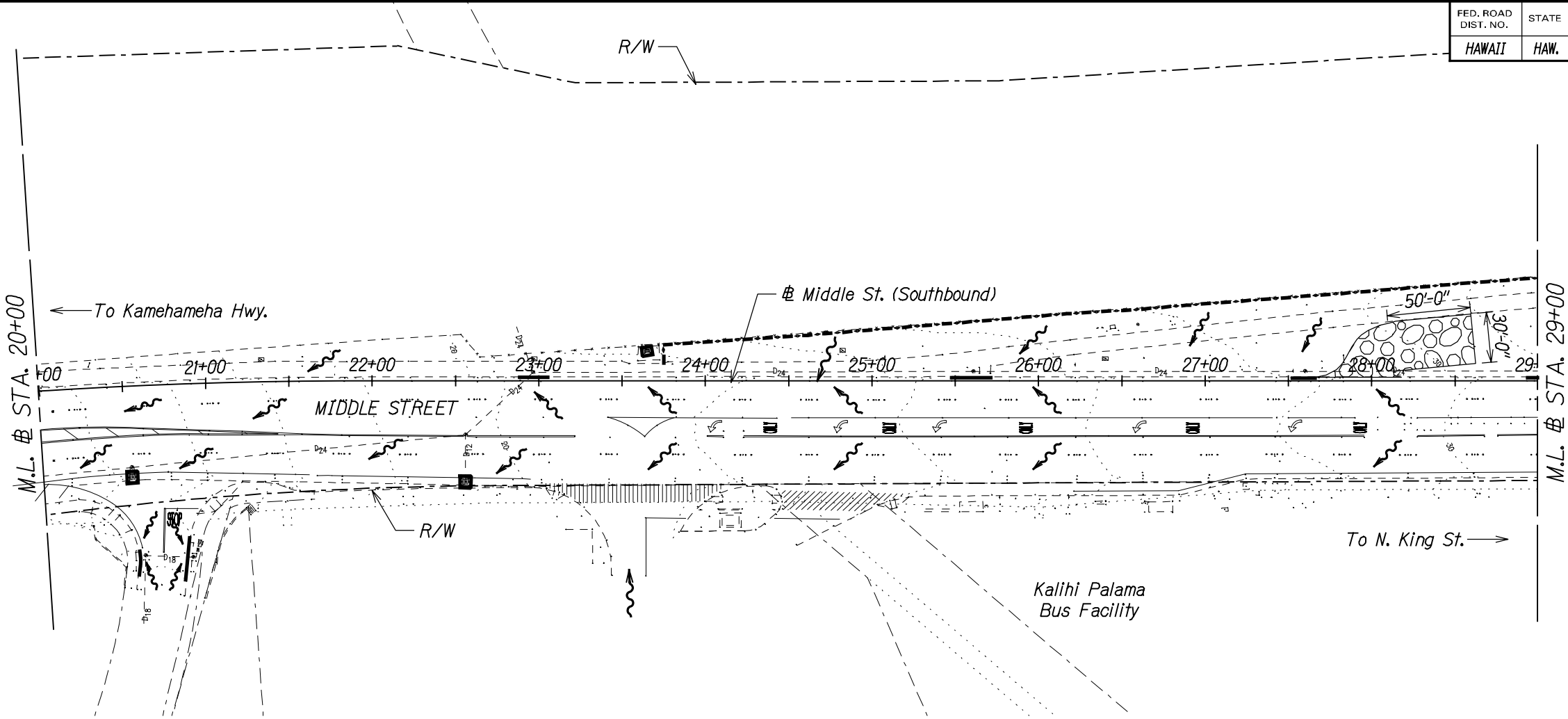

- LEGEND:**
- Flow Arrows
  - Catch Basin Inlet Protection
  - Grated Inlet Protection
  - Perimeter Control
  - Stabilized Construction Entrance

ORIGINAL PLAN	SURVEY PLOTTED BY	DATE
NOTE BOOK	DRAWN BY	
	TRACED BY	
	QUANTITIES BY	
	CHECKED BY	

T:\16543A\_MIDDLE\_ST./CADD/SHEETS/EC-02.dgn

STATE OF HAWAII  
DEPARTMENT OF TRANSPORTATION  
HIGHWAYS DIVISION

**EROSION CONTROL PLAN**  
MIDDLE STREET PAVEMENT RECONSTRUCTION  
North King Street to Kamehameha Highway  
FAP NO. 7415A-01-14M  
Scale: 1"=40'      Date: Jan. 24, 2014

SHEET No. EC-2 OF 3 SHEETS