

A-4: Project Area

- **Sheet 1/2 – Middle Street Pavement Reconstruction, North King Street to Kamehameha Highway, FAP No. 7415A-01-14M**
- **Sheet 2/2 – Middle Street Pavement Reconstruction, North King Street to Kamehameha Highway, FAP No. 7415A-01-14M**

FED. ROAD DIST. NO.	STATE	FEDERAL AID PROJ. NO.	FISCAL YEAR	SHEET NO.	TOTAL SHEETS
HAWAII	HAW.	7415A-01-14M	2014	-	-

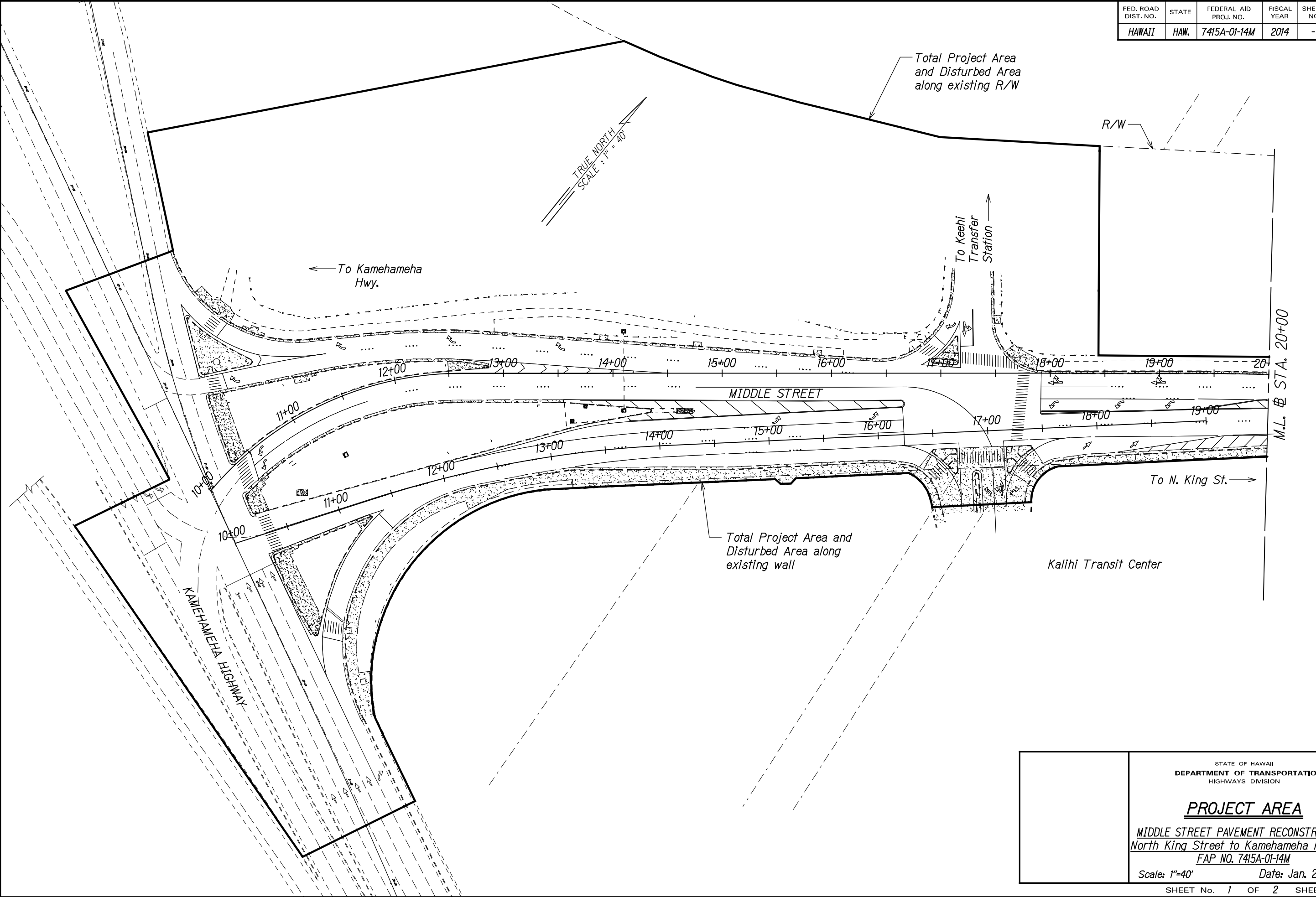

ORIGINAL PLAN	SURVEY PLOTTED BY	DATE
NOTE BOOK	DRAWN BY	
	TRACED BY	
	QUANTITIES BY	
	CHECKED BY	

STATE OF HAWAII
DEPARTMENT OF TRANSPORTATION
HIGHWAYS DIVISION

PROJECT AREA

MIDDLE STREET PAVEMENT RECONSTRUCTION
North King Street to Kamehameha Highway
FAP NO. 7415A-01-14M

Scale: 1"=40' Date: Jan. 24, 2014

FED. ROAD DIST. NO.	STATE	FEDERAL AID PROJ. NO.	FISCAL YEAR	SHEET NO.	TOTAL SHEETS
HAWAII	HAW.	7415A-01-14M	2014	-	-

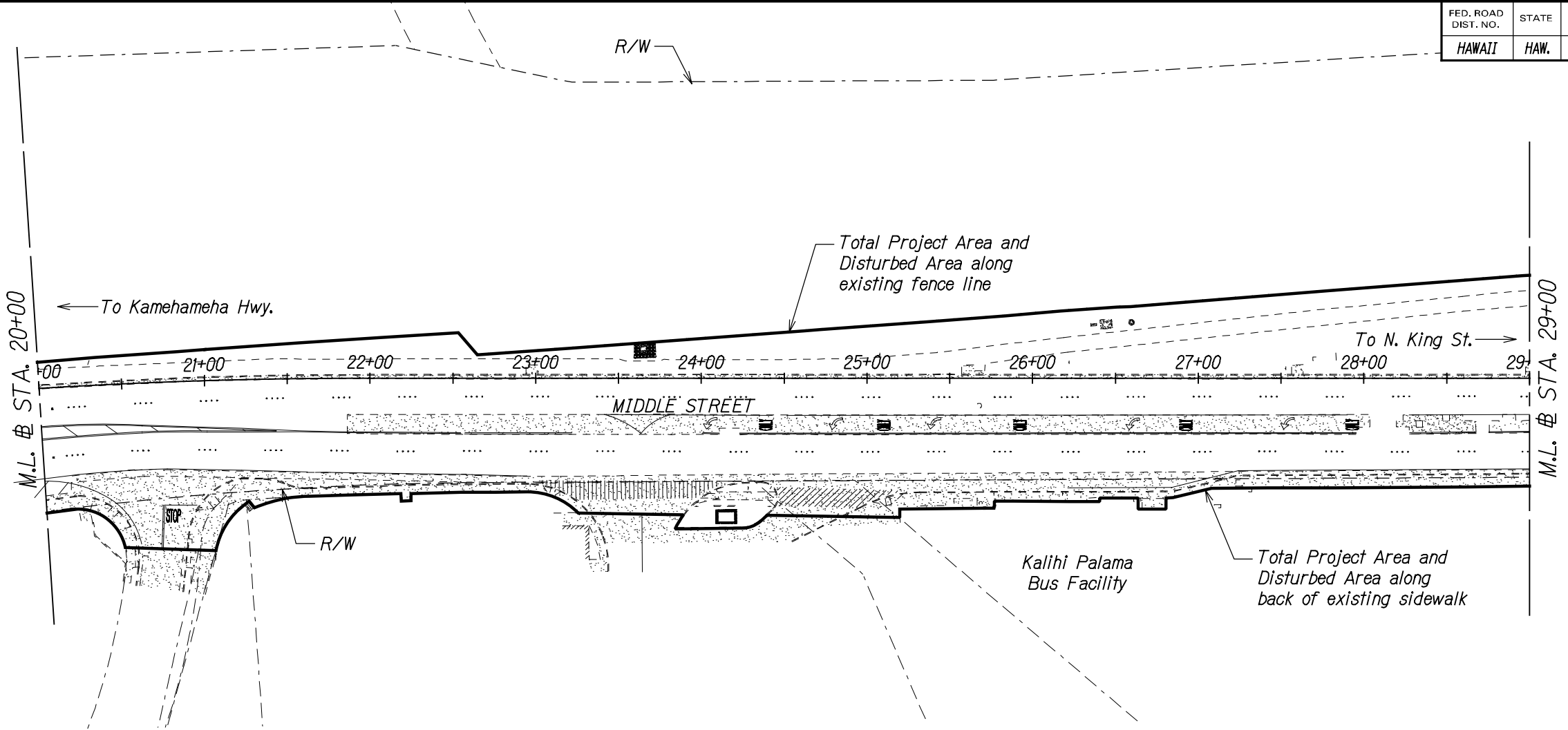

TRUE NORTH
SCALE: 1" = 40'

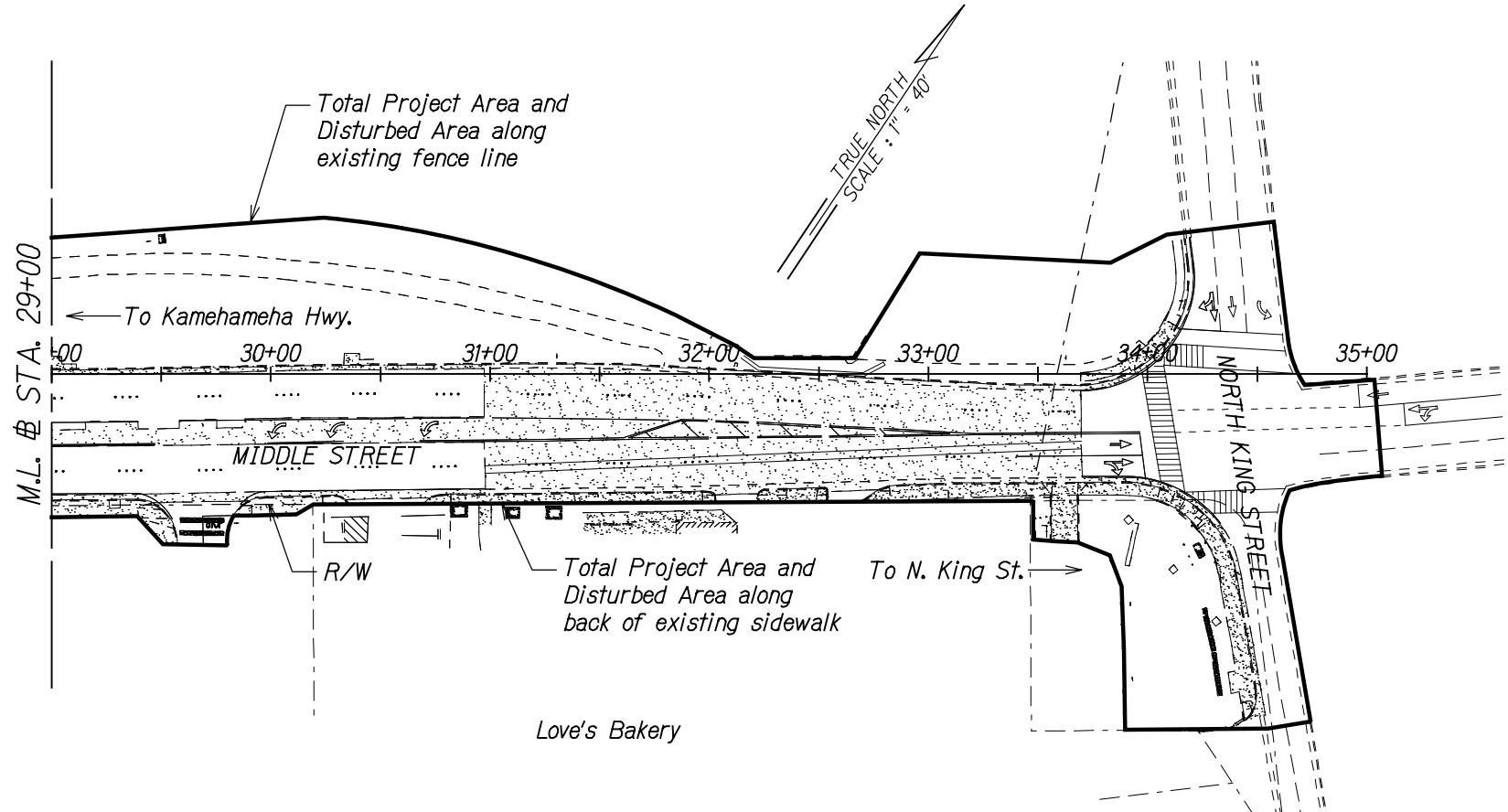

TRUE NORTH
SCALE: 1" = 40'

ORIGINAL PLAN	SURVEY PLOTTED BY	DATE
NOTE BOOK	DRAWN BY	
	TRACED BY	
	QUANTITIES BY	
	CHECKED BY	

STATE OF HAWAII
DEPARTMENT OF TRANSPORTATION
HIGHWAYS DIVISION

PROJECT AREA

MIDDLE STREET PAVEMENT RECONSTRUCTION
North King Street to Kamehameha Highway
FAP NO. 7415A-01-14M

Scale: 1"=40' Date: Jan. 24, 2014