

FED. ROAD DIST. NO.	STATE	FED. AID PROJ. NO.	FISCAL YEAR	SHEET NO.	TOTAL SHEETS
HAWAII	HAW.	HSIP-7413(2)	2011	ADD.14	29

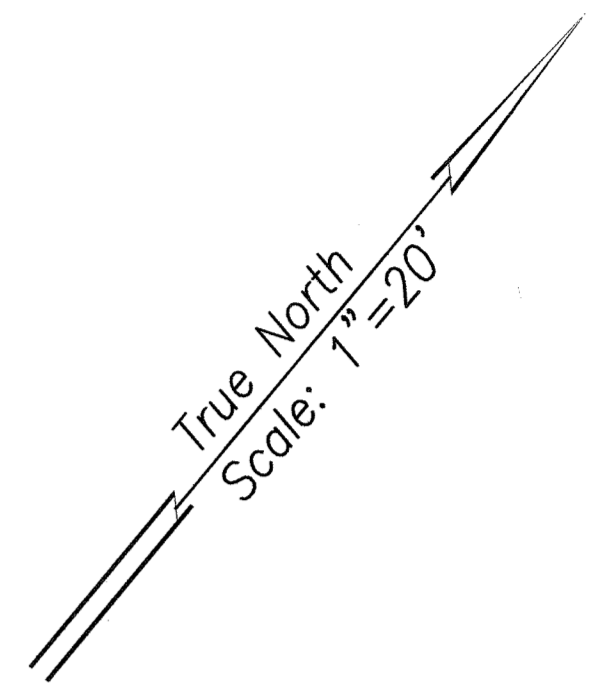
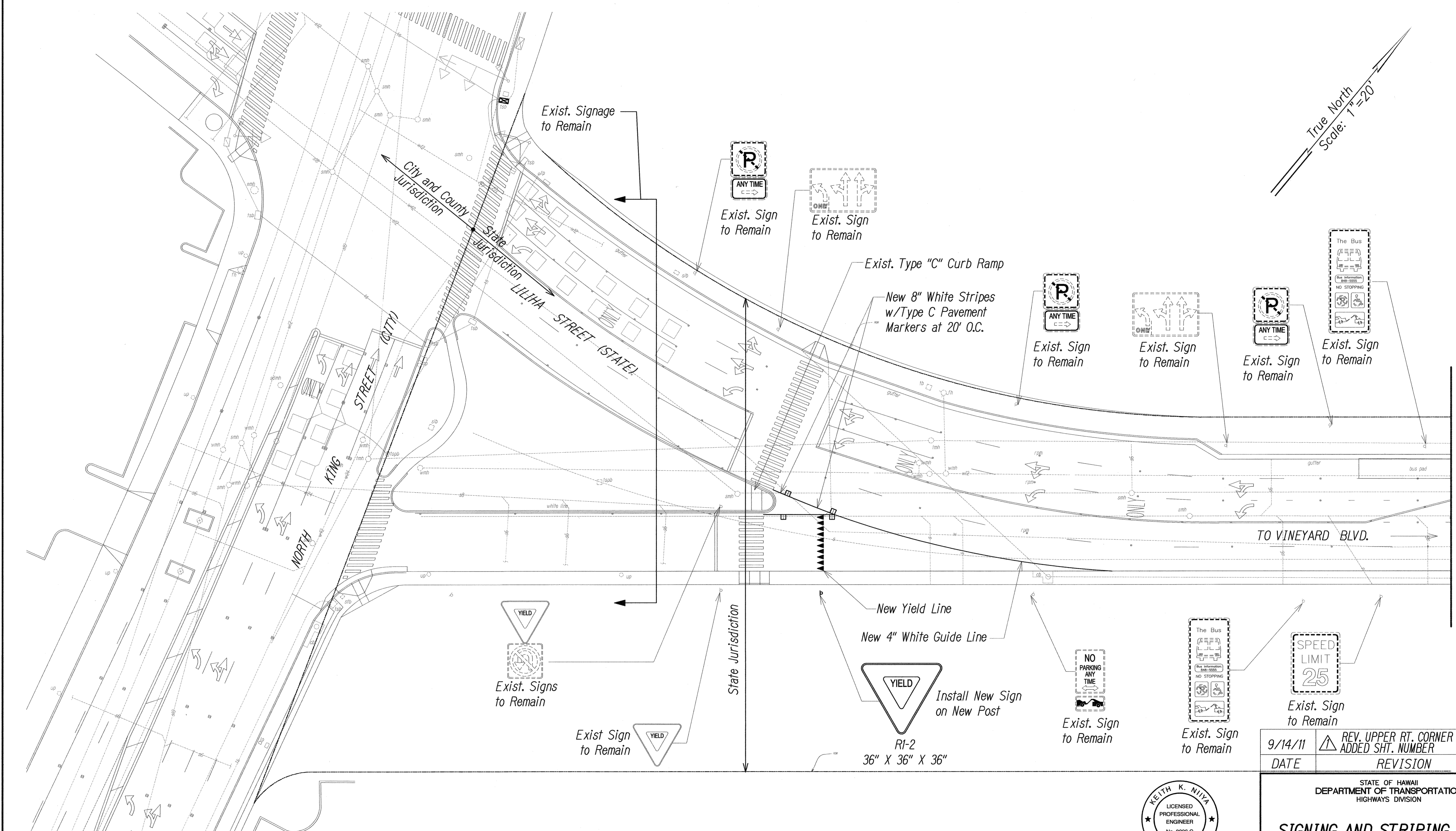

MATCH LINE
For Continuation, See Sht. No. 15

DATE	_____
SURVEY PLOTTED BY	_____
ORIGINAL PLAN	_____
DESIGNED BY	_____
TRACED BY	_____
CHECKED BY	_____
NO.	_____

SIGNING AND STRIPING PLAN
LILIIHA STREET AND KUKUI STREET
SCALE: 1"=20'



This work was prepared by me or under my supervision and construction of this project will be under my observation. (Observation of construction as defined in Chapter 16-115 Subchapter 1 Definitions of the Hawaii Administrative Rules "Professional Engineers, Architects, Surveyors, and Landscape Architects.")

DATE	REVISION
9/14/11	REV. UPPER RT. CORNER BLOCK; ADDED SHT. NUMBER

STATE OF HAWAII
DEPARTMENT OF TRANSPORTATION
HIGHWAYS DIVISION

SIGNING AND STRIPING PLAN 1

LILIIHA STREET
TRAFFIC SIGNAL AT KUKUI STREET
FEDERAL AID PROJECT NO. HSIP-7413(2)

Scale: As Noted Date: July 2011

SHEET No. 14 OF 29 SHEETS

FED. ROAD DIST. NO.	STATE	FED. AID PROJ. NO.	FISCAL YEAR	SHEET NO.	TOTAL SHEETS
HAWAII	HAW.	HSIP-7413(2)	2011	ADD.15	29

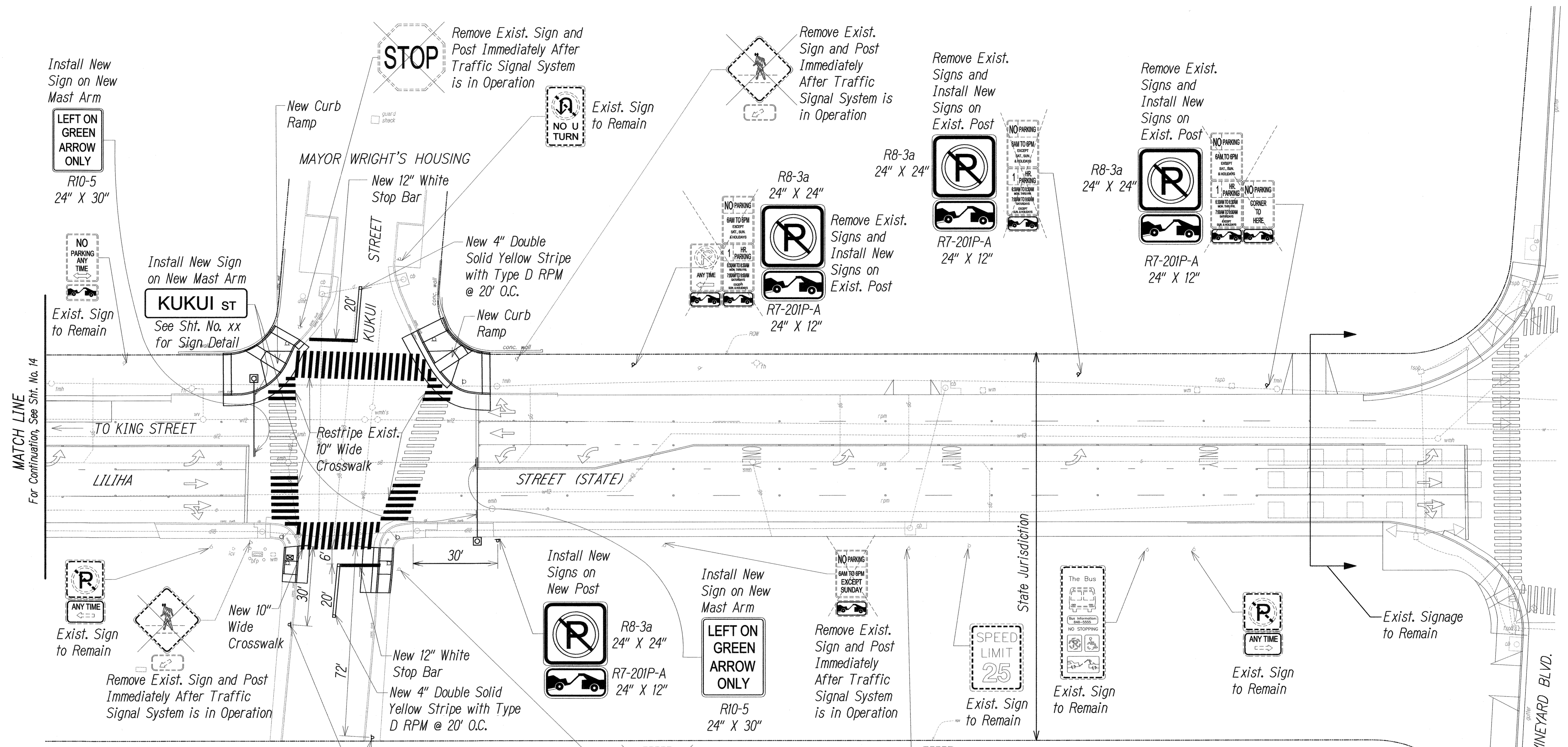

- Notes:**
1. Street name signs shall have white message and border on green background.
 2. All sign faces shall be completely reflectorized with type "B" reflective sheeting.
 3. The sign shall be in conformance with the requirements of section 750.01 of the standard specification.
 4. For sign mounting details, see the State of Hawaii Department of Transportation "Standard Plans" 2008.

SIGNING AND STRIPING PLAN
LILIHA STREET AND KUKUI STREET
 SCALE: 1"=20'

SURVEY PLOTTED BY	DATE
DESIGNED BY	
TRACED BY	
NOTE BOOK	
QUANTITIES BY	
CHECKED BY	
No.	

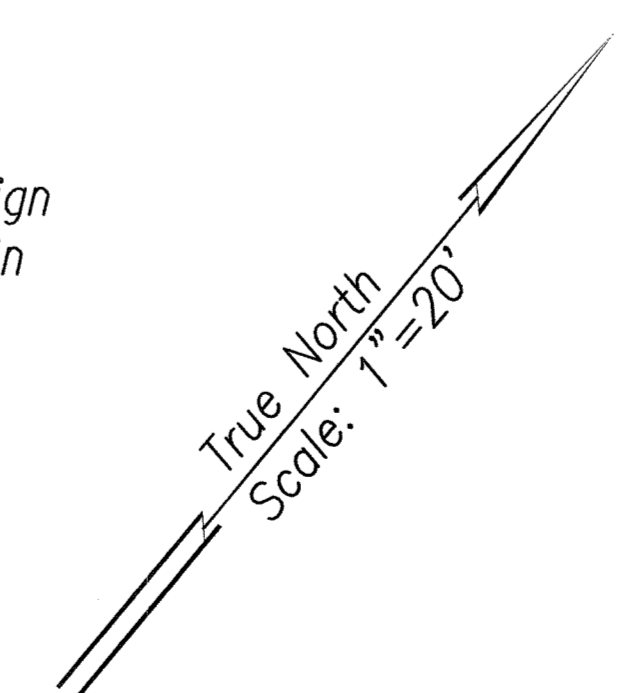

9/14/11	REV. UPPER RT. CORNER BLOCK; ADDED SHT. NUMBER
DATE	REVISION
STATE OF HAWAII DEPARTMENT OF TRANSPORTATION HIGHWAYS DIVISION	
SIGNING AND STRIPING PLAN 2	
LILIHA STREET TRAFFIC SIGNAL AT KUKUI STREET FEDERAL AID PROJECT NO. HSIP-7413(2)	
Scale: As Noted	Date: July 2011
SHEET No. 15 OF 29 SHEETS	