

FED. ROAD DIST. NO.	STATE	PROJ. NO.	FISCAL YEAR	SHEET NO.	TOTAL SHEETS
HAWAII	HAW.	HWY-0-01-91	1992	5	6

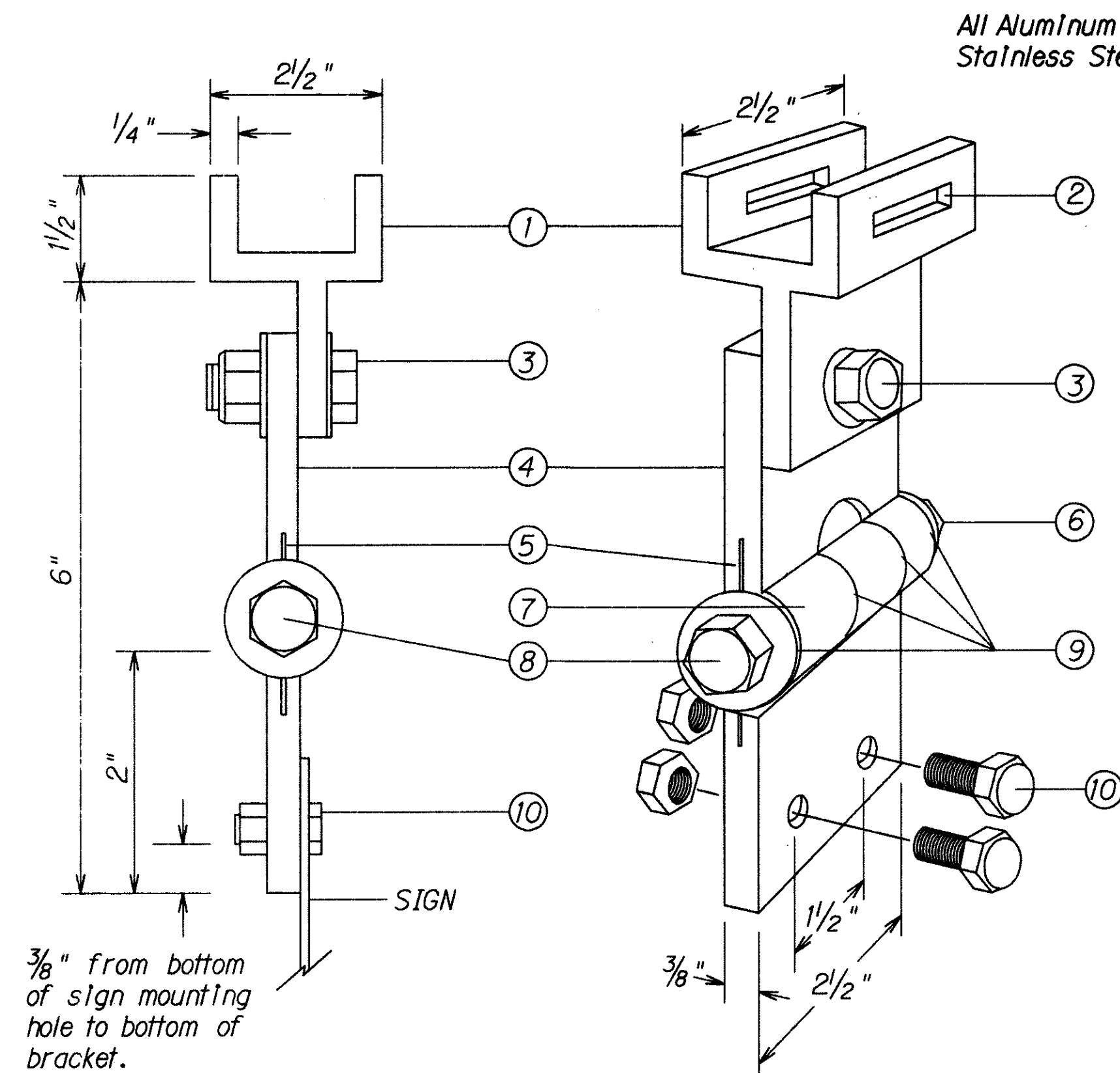

**FIXED LENGTH NON-ADJUSTABLE  
SWING SIGN BRACKET**

- ① Pivotal Upper Bracket
- ② 1 5/8" x 1/4" Slot for double strapping to electroliner mast arm. (M2G-34S(HD) .030" x 3/4" Heavy Duty Stainless Steel Strap with M2G-34B(HD) Buckle recommended.)
- ③ 1/2" - 13 x 1 1/2" Stainless Steel Hex Head Bolt with Stainless Steel Hex Lock Nut and 1/16" Stainless Steel Washer (both sides). Allows upper bracket to pivot and align with electroliner mast arm.
- ④ 6" Overall drop with Fixed Length Sign Bracket
- ⑤ Stainless Steel Dampener Spring (Removable)
- ⑥ Stainless Steel Hex Lock Nut with 1/16" Stainless Steel Washer
- ⑦ 1" O.D. Axle Housing
- ⑧ 1/2" - 13 x 4" Stainless Steel Hex Head Bolt with 1/16" Stainless Steel Washer
- ⑨ Ollite Bushing
- ⑩ Sign Mounting Sets, consisting of two each 5/16" - 18 x 1" Stainless Steel Hex Head Bolt with Stainless Steel Hex Lock Nut. Two holes on 1/2" centers provide positive lock sign mounting to bracket.

Dimensions may vary slightly.

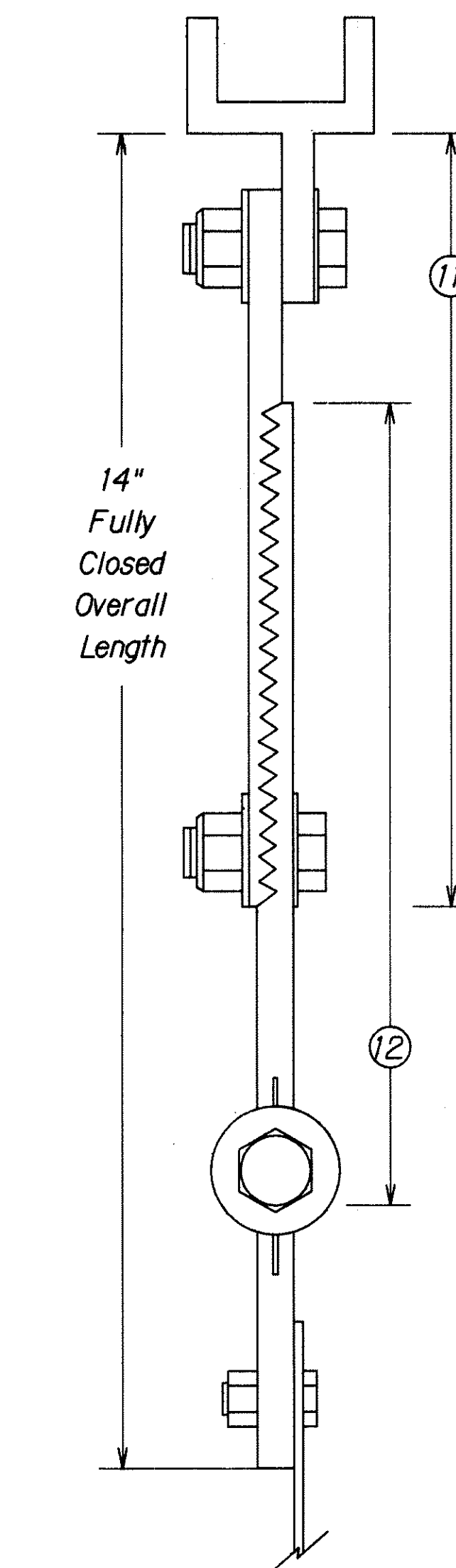
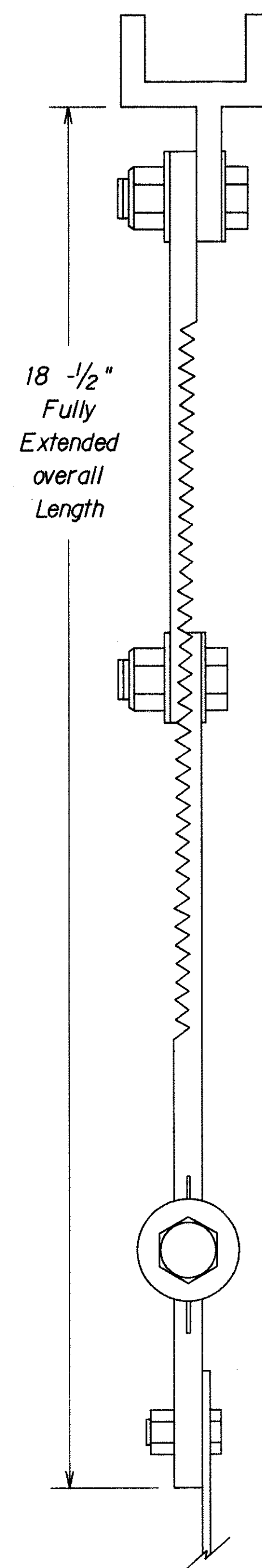

Allows  
Length  
Adjustment  
of 4 1/2"

**ADJUSTABLE LENGTH  
SWING SIGN BRACKET**

- ⑪ 8 1/4" overall length Upper Adjustable Sign Bracket section
- ⑫ 9" overall length Lower Adjustable Sign Bracket section, including Axle Housing (8" overall length to top of Axle Housing)
- ⑬ 1/2" - 13 x 1 1/2" Stainless Steel Hex Bolt with Stainless Steel Hex Lock Nut and 1/16" Stainless Steel Washers (both sides). Loosen lock nut, adjust bracket teeth to level sign.

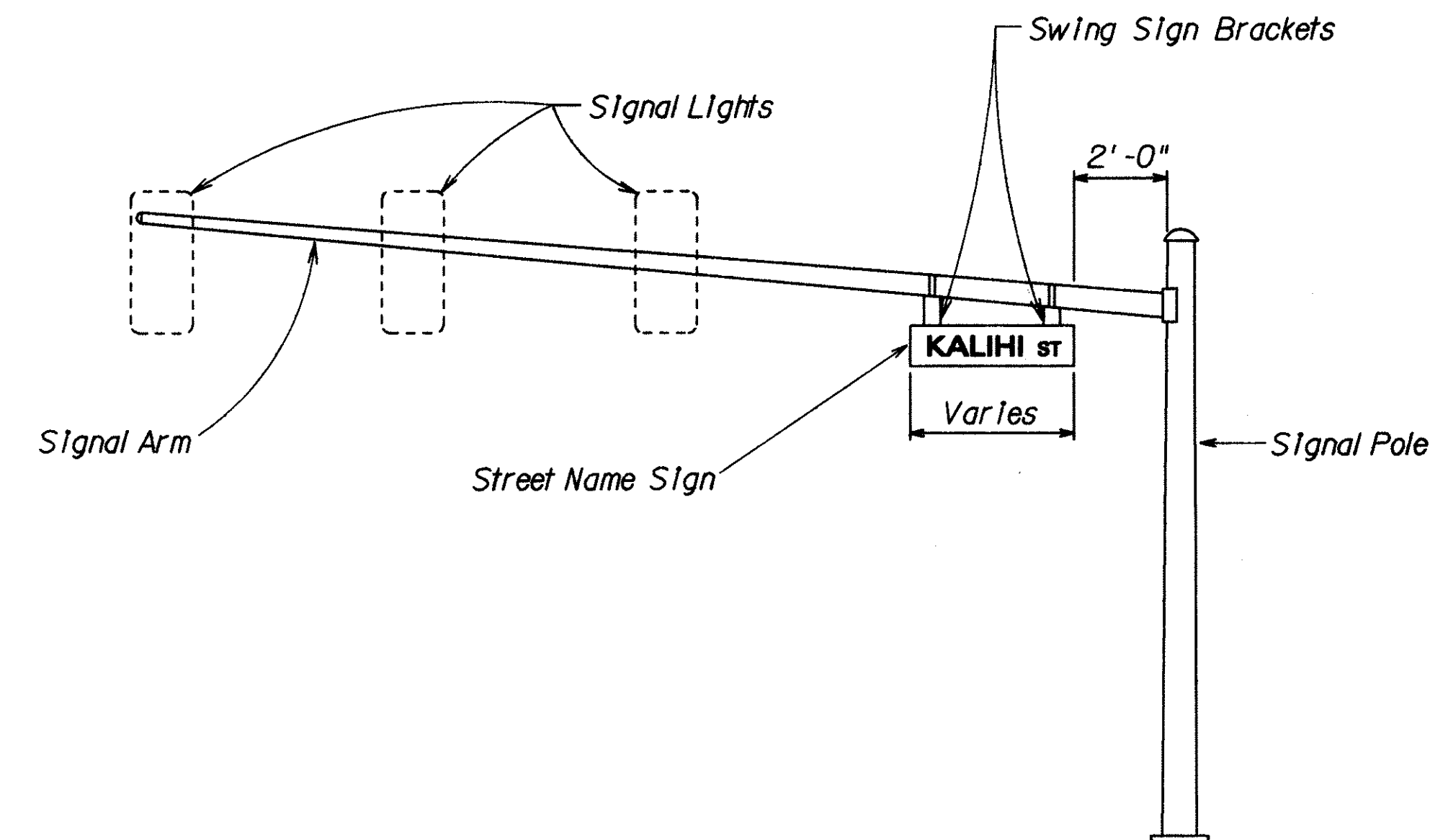

**STREET NAME SIGN MOUNTING  
ON MAST ARM**

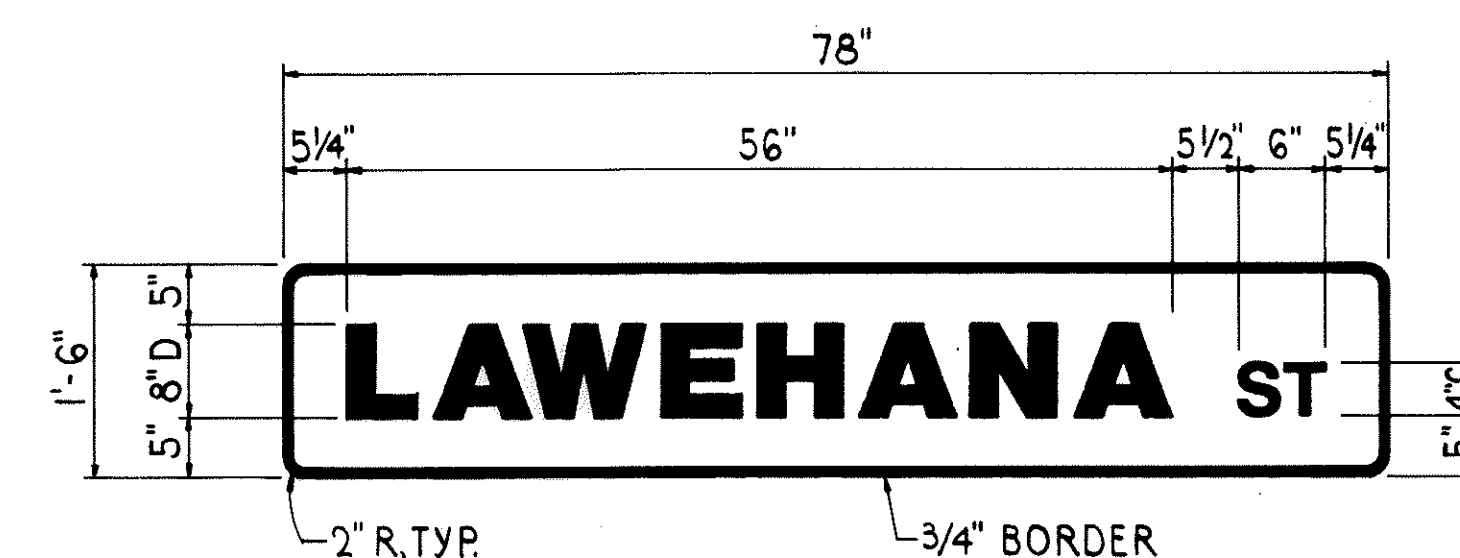

**STREET NAME SIGN DETAIL  
NOT TO SCALE**

**NOTES:**

1. Street name signs shall have white message and border on green background.
2. Provide the same message on both sides of each sign.
3. All sign faces shall be completely reflectorized with Type "B" reflective sheeting.
4. The sign shall be in conformance with the requirements of Section 712.20 of the Standard Specification.

STATE OF HAWAII  
DEPARTMENT OF TRANSPORTATION  
HIGHWAYS DIVISION

**STREET SIGN DETAIL**  
  
BOUGAINVILLE DRIVE  
TRAFFIC SIGNALS AT  
LAWEHANA STREET  
PROJECT NO. HWY-0-01-91

SCALE: AS NOTED  
SHEET No. 1 OF 1 SHEETS

DATE: JAN. 1992

DESIGNED BY	DATE
DRAWN BY	
CHECKED BY	
NOTED BY	
ORIGINAL PLAN	