

FED. ROAD DIST. NO.	STATE	PROJ. NO.	FISCAL YEAR	SHEET NO.	TOTAL SHEETS
HAWAII	HAW.	7345A-01-91	1991	4	6

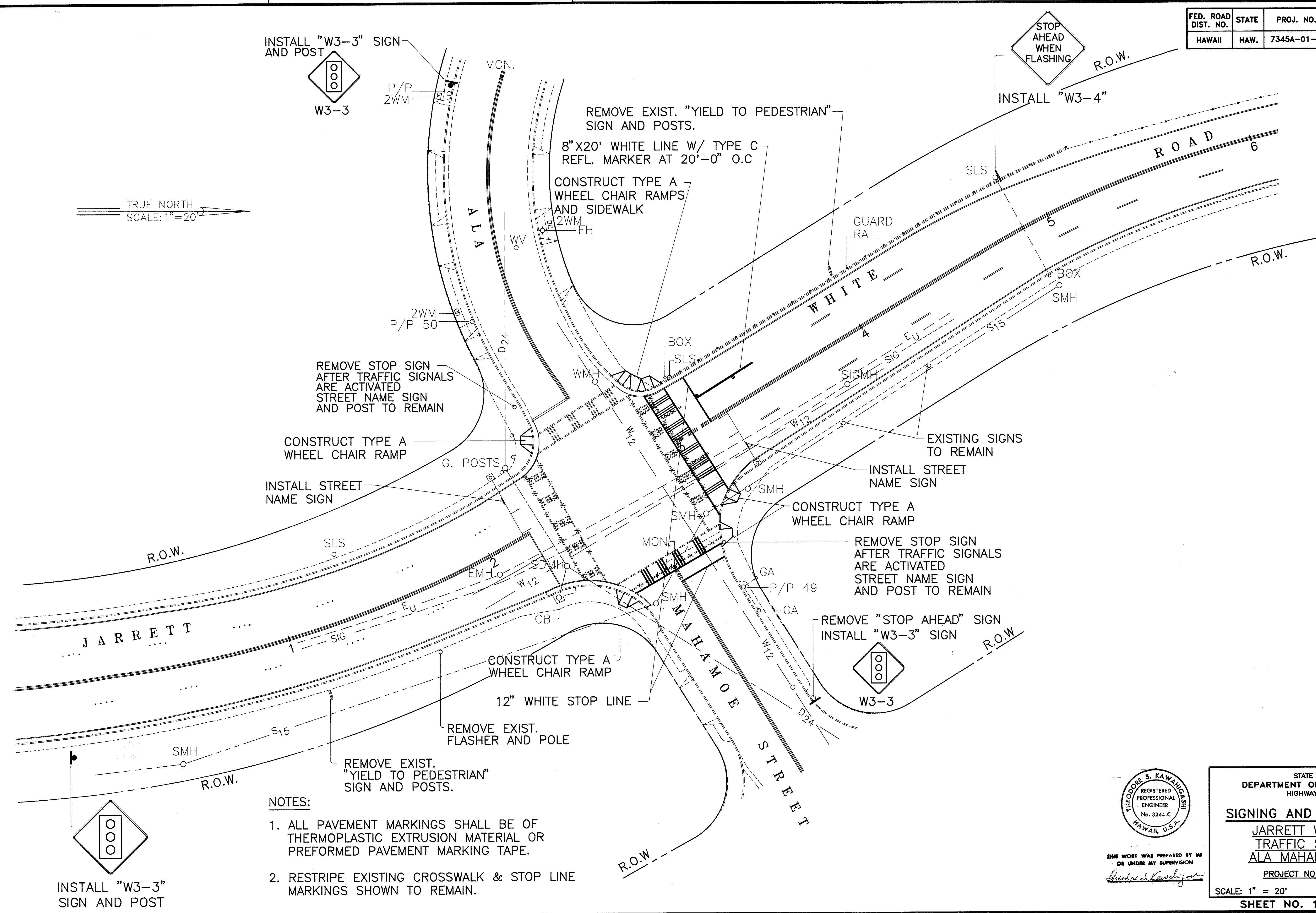
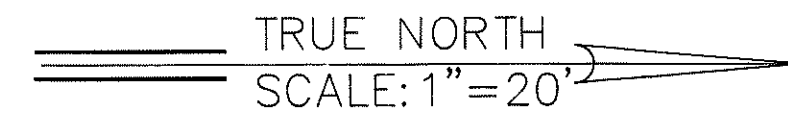

NOTES:

1. ALL PAVEMENT MARKINGS SHALL BE OF THERMOPLASTIC EXTRUSION MATERIAL OR PREFORMED PAVEMENT MARKING TAPE.
2. RESTRIPE EXISTING CROSSWALK & STOP LINE MARKINGS SHOWN TO REMAIN.

INSTALL "W3-3" SIGN AND POST

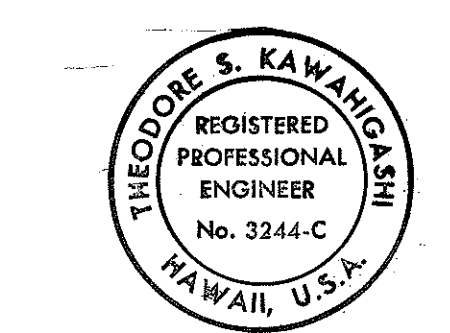

THIS WORK WAS PREPARED BY ME OR UNDER MY SUPERVISION
Theodore S. Kawahigami

STATE OF HAWAII
DEPARTMENT OF TRANSPORTATION
HIGHWAYS DIVISION

SIGNING AND STRIPING PLAN

JARRETT WHITE ROAD
TRAFFIC SIGNALS AT
ALA MAHAMOE STREET

PROJECT NO. 7345A-01-91
SCALE: 1" = 20' DATE: AUGUST 1991
SHEET NO. 1 OF 1 SHEETS