

| FED. ROAD DIST. NO. | STATE | FED. AID PROJ. NO. | FISCAL YEAR | SHEET NO. | TOTAL SHEETS |
|---------------------|-------|--------------------|-------------|-----------|--------------|
| HAWAII              | HAW.  | STP-724(1)         | 1995        | 36        | 42           |

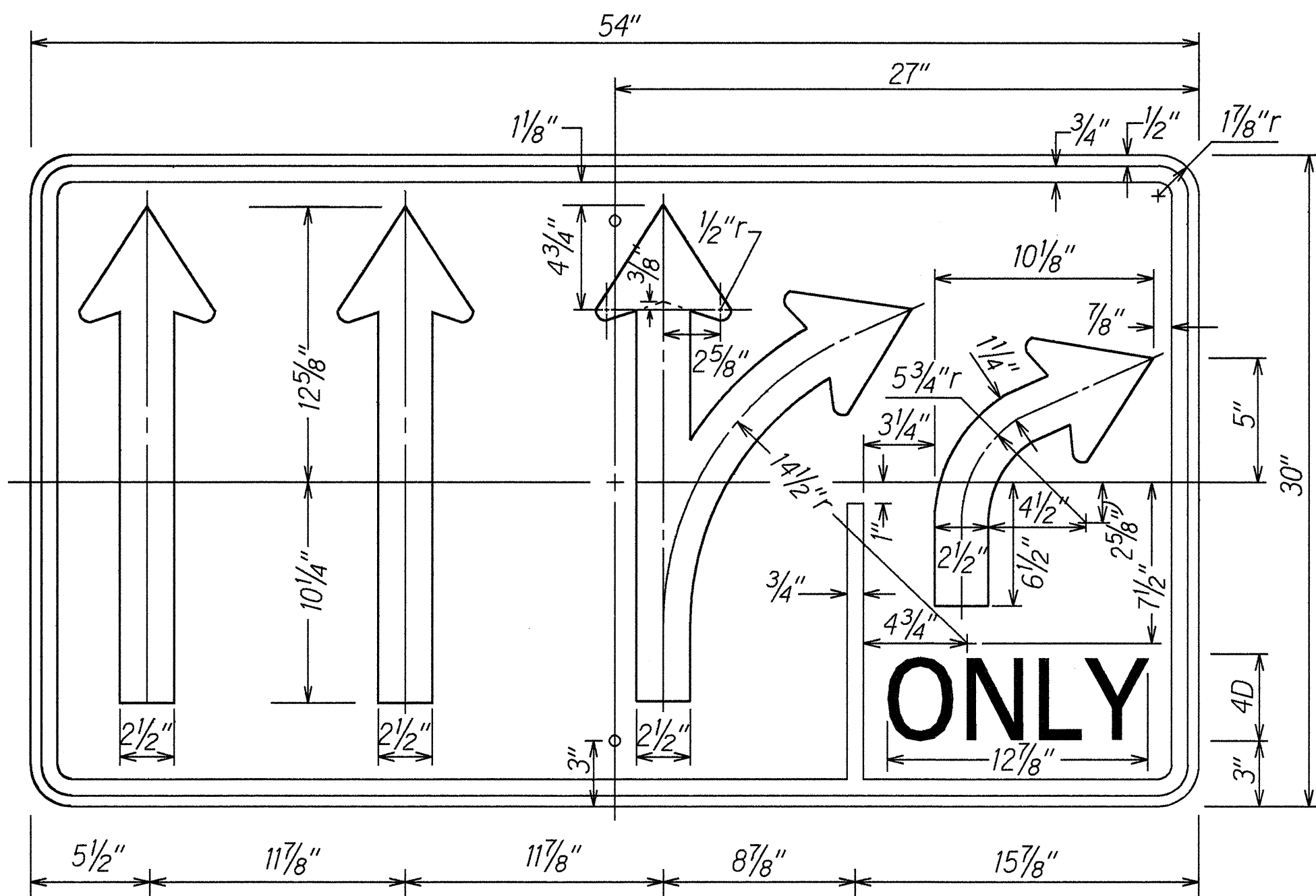

R3-11(R) \*  
Not to Scale

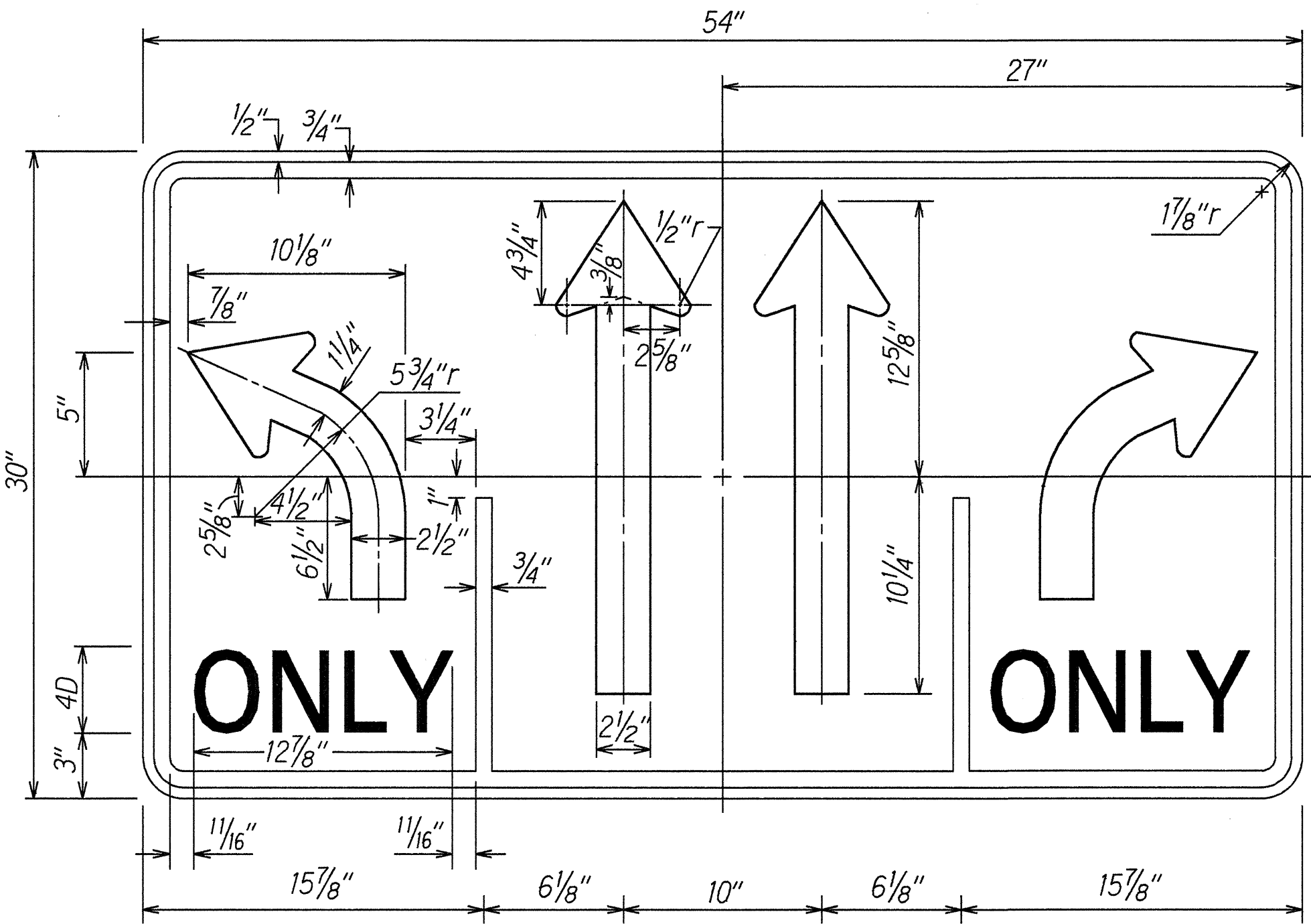

R3-38 \*  
Not to Scale

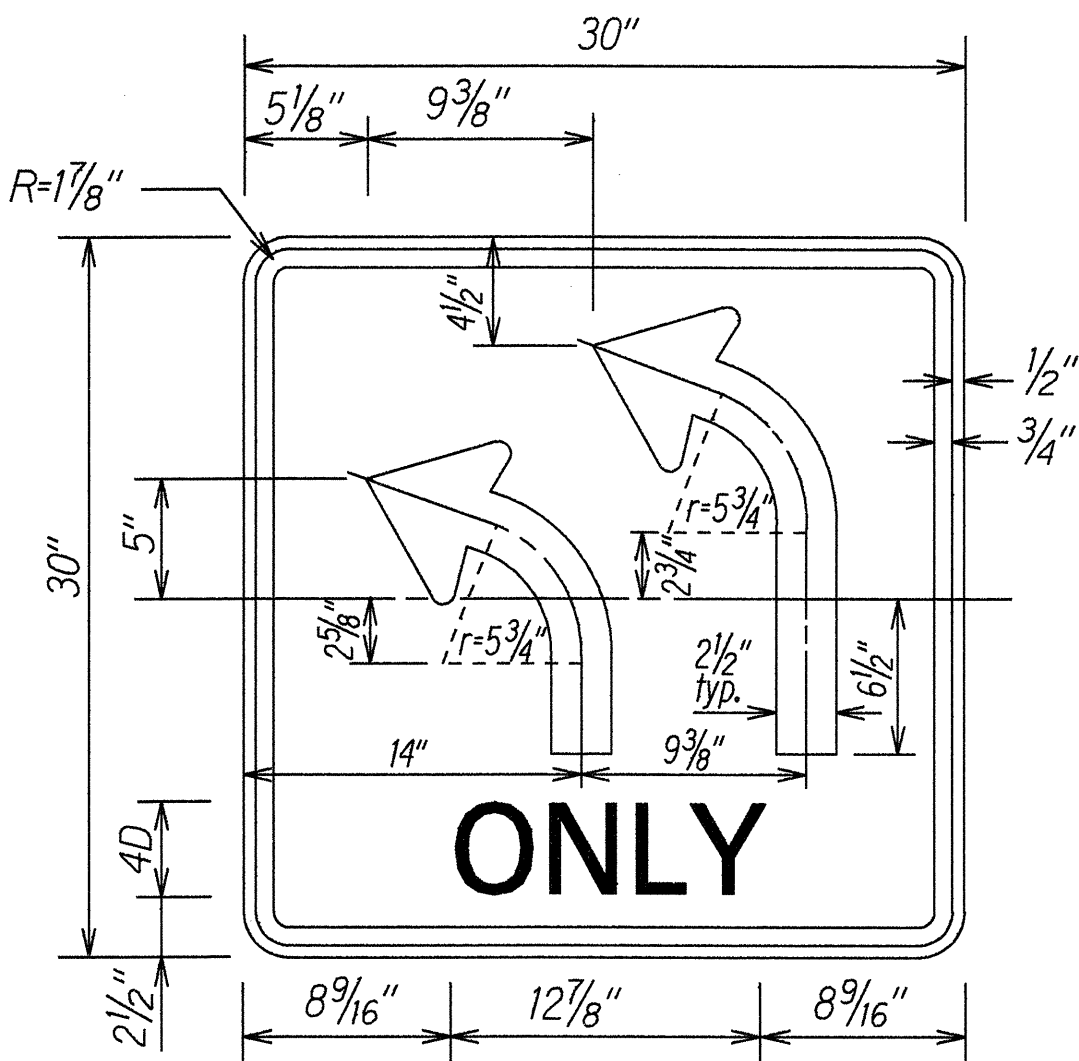

R3-55(L) \*  
Not to Scale

\* NOTE:

1. Plate and arrow details shall conform to Sign R3-8.

|               |                   |         |
|---------------|-------------------|---------|
| ORIGINAL PLAN | SURVEY PLOTTED BY | DATE    |
| NOTE BOOK     | DRAWN BY          | 5/18/95 |
| 10/1/95       | DESIGNED BY       |         |
| 12/1/95       | CHECKED BY        |         |

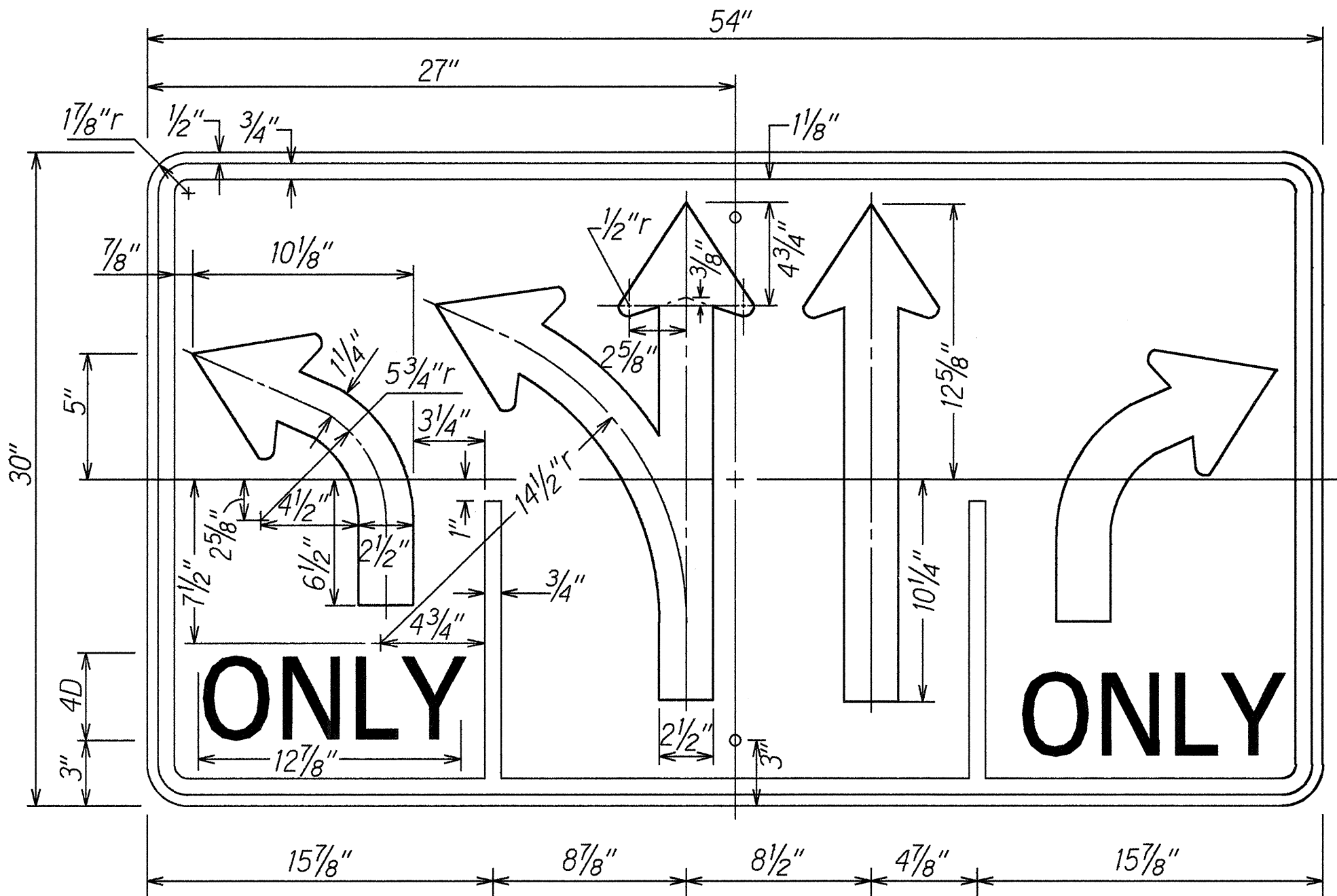

R3-39 \*  
Not to Scale

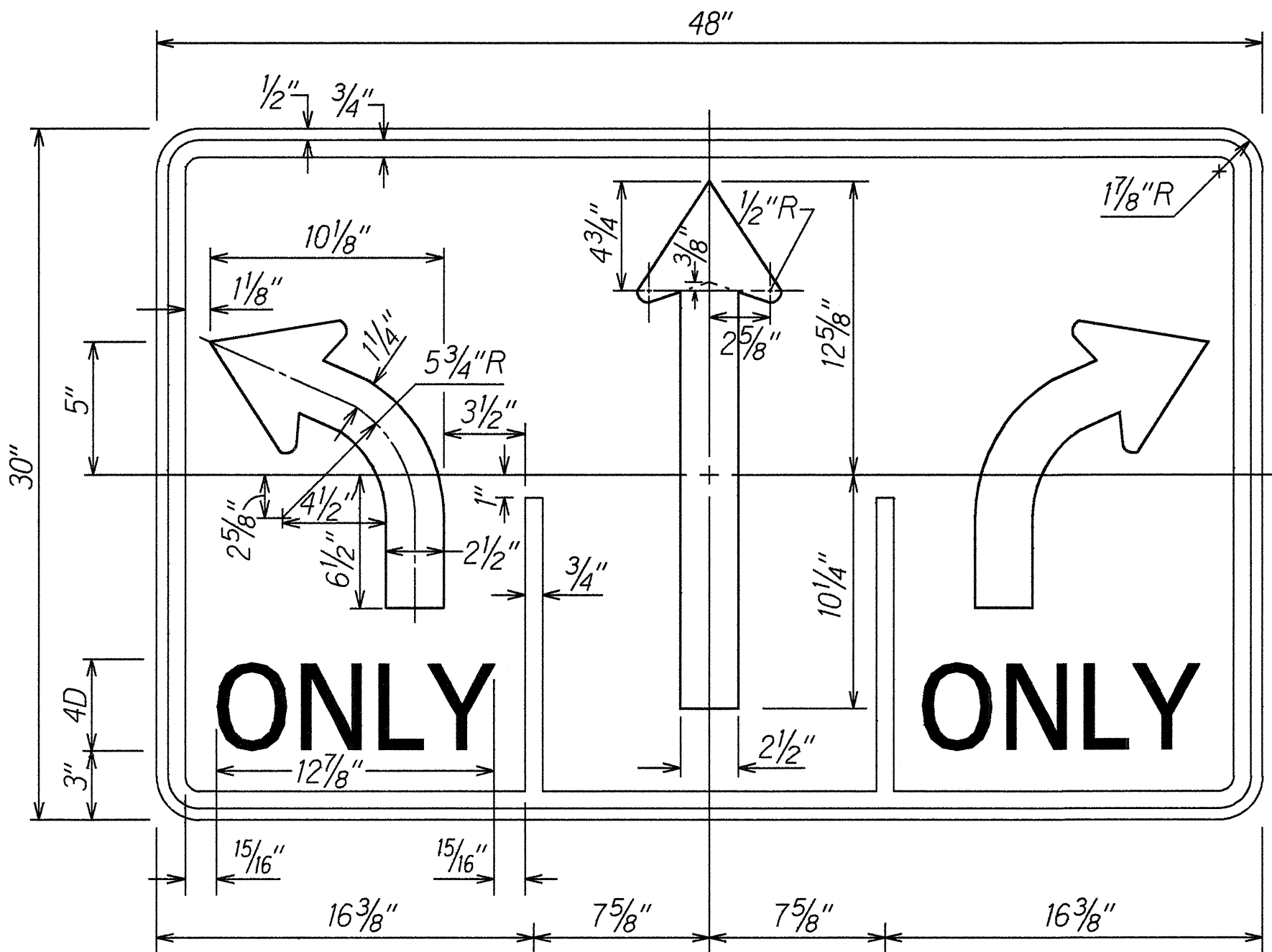

R3-44 \*  
Not to Scale

| 6/16/95   | Add Sign R3-55(L) |
|---|-------------------|
| DATE  | REVISION          |
| STATE OF HAWAII<br>DEPARTMENT OF TRANSPORTATION<br>HIGHWAYS DIVISION<br><br><b>SIGN DETAILS</b><br><br><b>KAHUAPAANI ST. RESURFACING</b><br><b>Ulune St. to Salt Lake Blvd.</b><br><b>Fed. Aid Project No. STP-724(1)</b><br>Scale: As noted Date: June, 1995<br>SHEET No. T10 OF 16 SHEETS |                   |

| FED. ROAD DIST. NO. | STATE | FED. AID PROJ. NO. | FISCAL YEAR | SHEET NO. | TOTAL SHEETS |
|---------------------|-------|--------------------|-------------|-----------|--------------|
| HAWAII              | HAW.  | STP-724(1)         | 1995        | 37        | 42           |

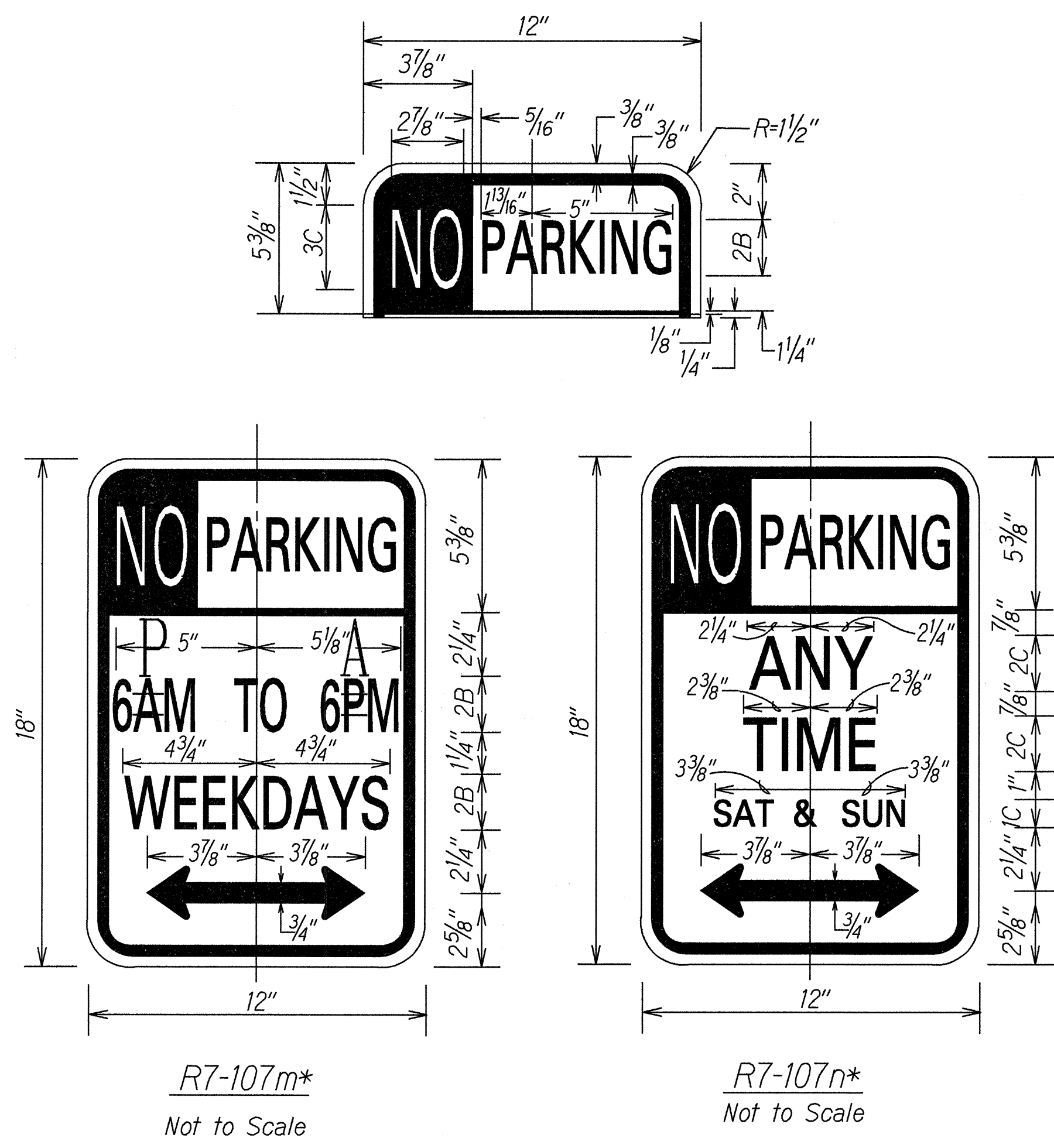

\*COLORS:  
Legend - Red  
Background - White

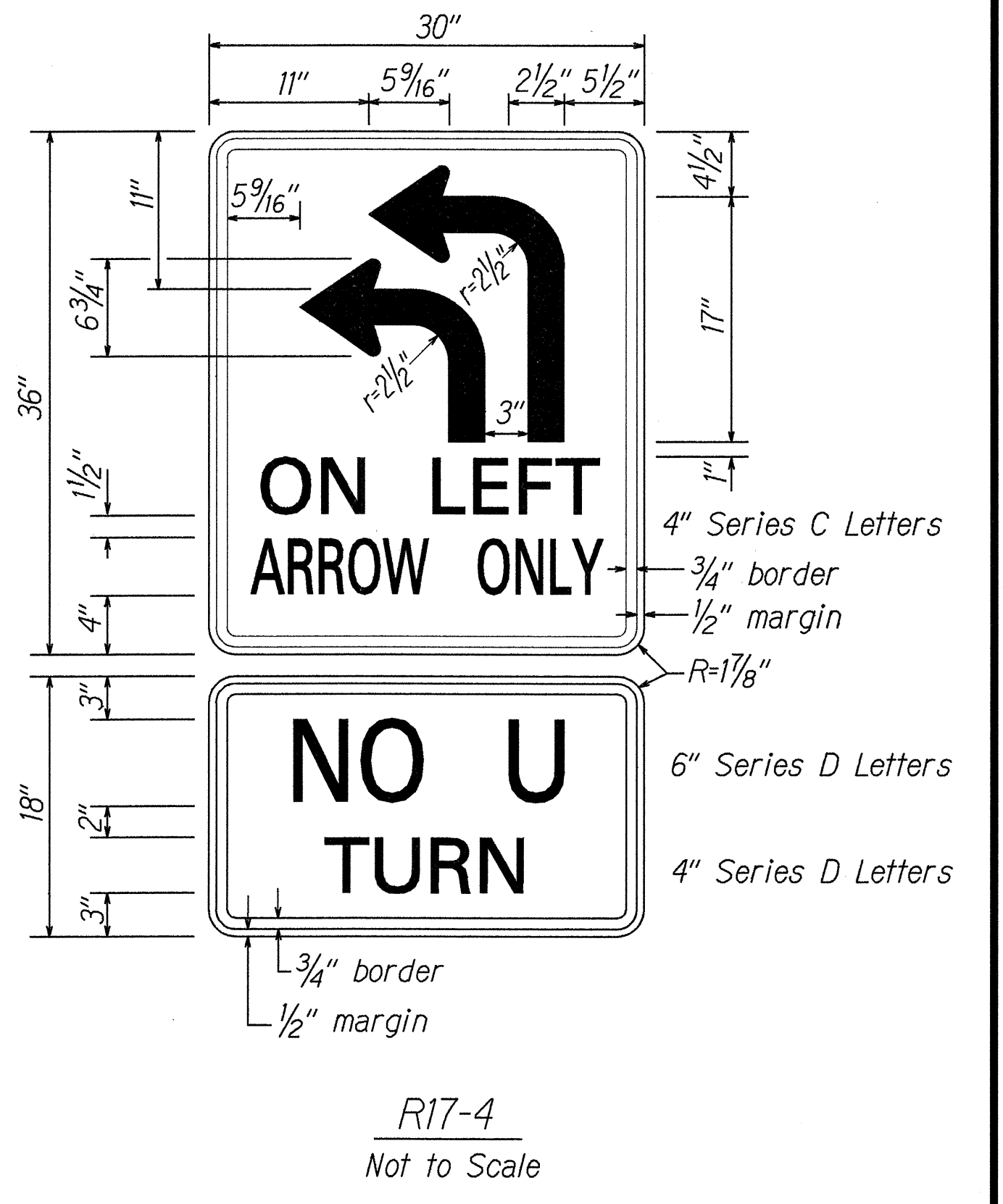
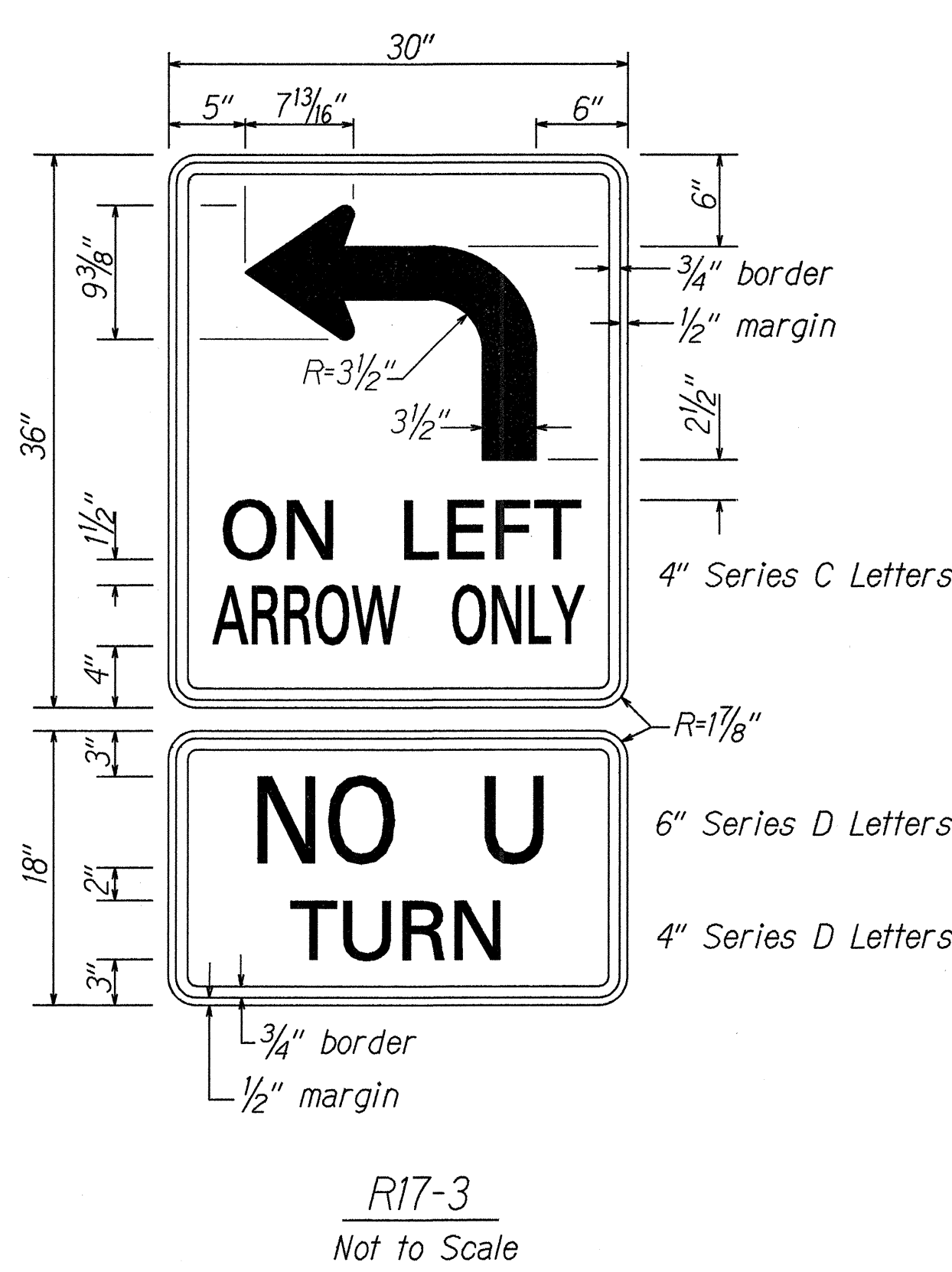
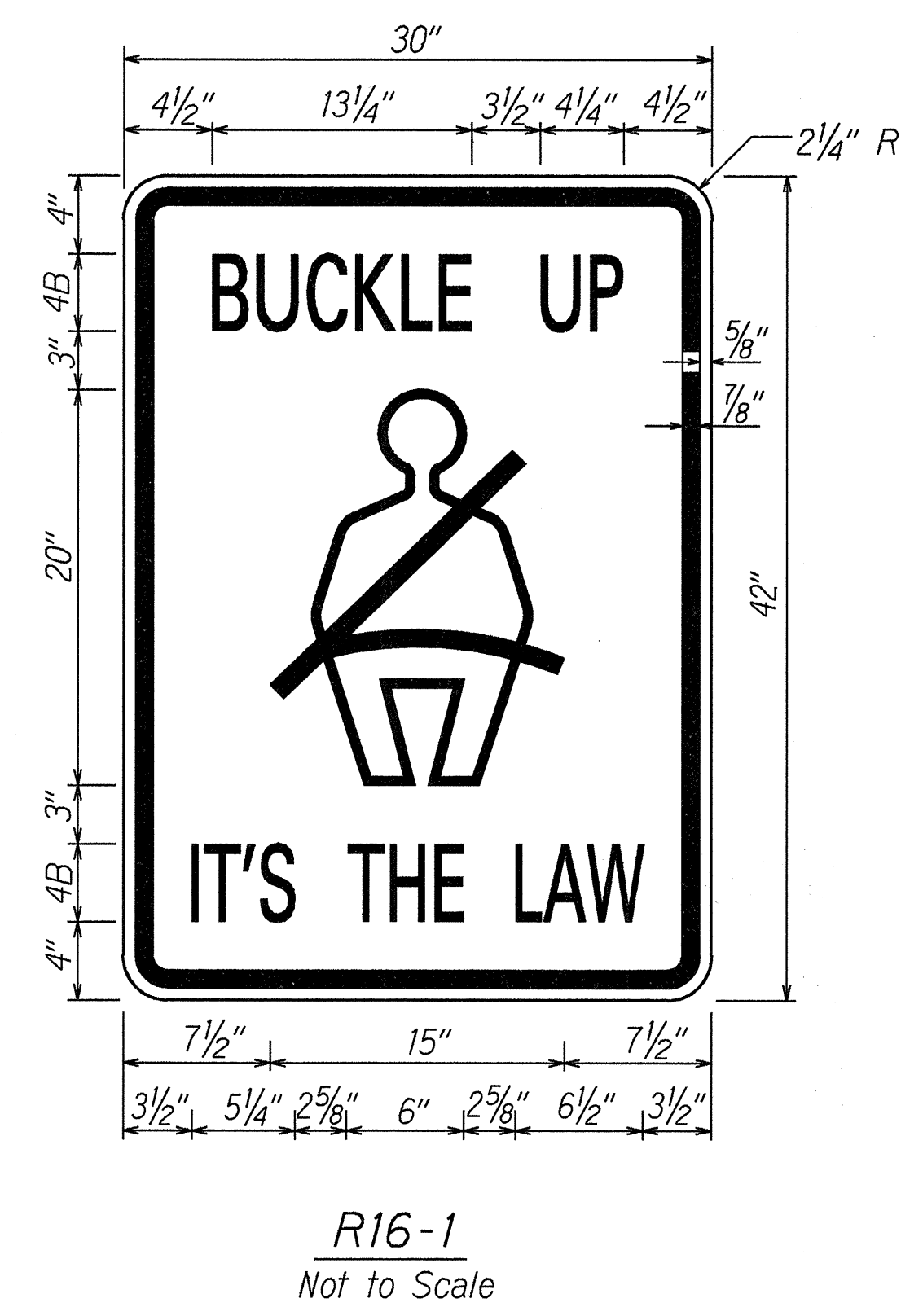

|                   |             |               |
|-------------------|-------------|---------------|
| ORIGINAL PLAN     | DATE        | 5/22/95       |
| SURVEY PLATTED BY | DESIGNED BY | TRACED BY     |
| NOTE BOOK         | DESIGNED BY | QUANTITIES BY |
| IN                | IN          | IN            |

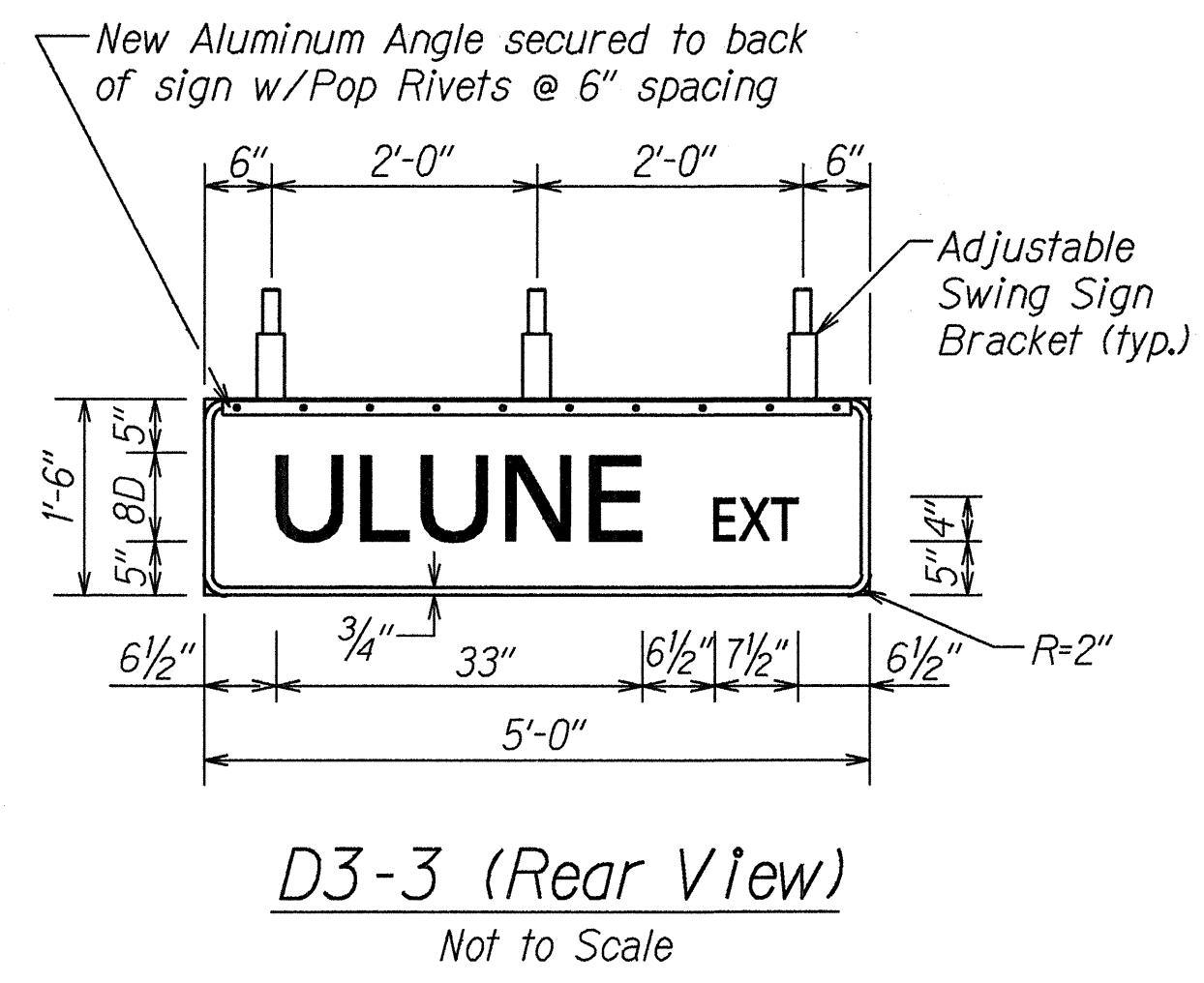
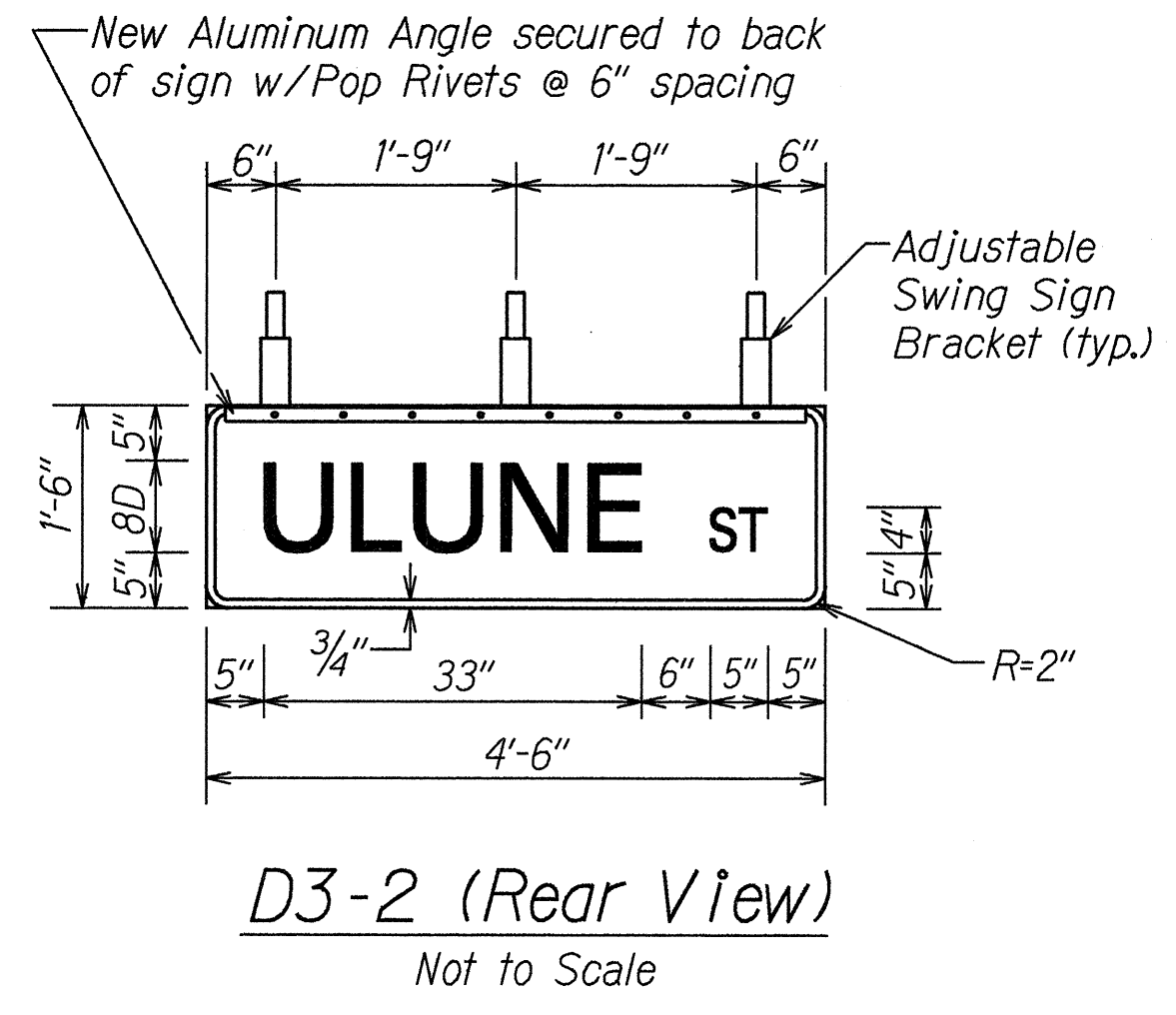
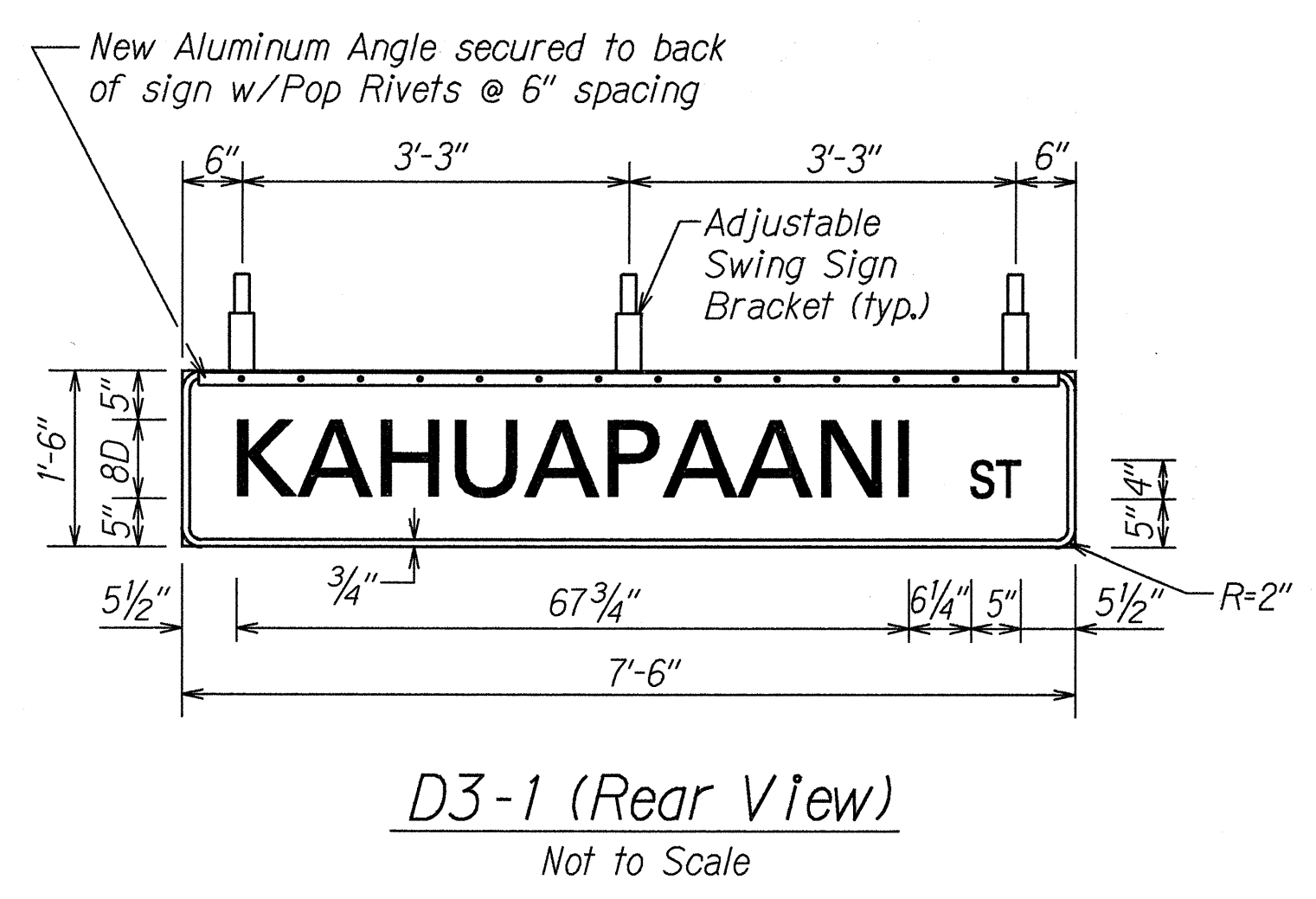

| LEGEND FOR AS-BUILT POSTINGS |                                     |
|------------------------------|-------------------------------------|
|                              | Squiggly line for as-built deletion |
|                              | Double line for as-built deletion   |
| Roadway                      | Text for as-built posting           |

STATE OF HAWAII  
DEPARTMENT OF TRANSPORTATION  
HIGHWAYS DIVISION

**SIGN DETAILS**

**KAHUAPAANI ST. RESURFACING**  
**Ulune St. to Salt Lake Blvd.**  
**Fed. Aid Project No. STP-724(1)**  
Scale: As noted Date: June, 1995

SHEET No. 111 OF 16 SHEETS



| FED. ROAD DIST. NO. | STATE | FED. AID PROJ. NO. | FISCAL YEAR | SHEET NO.   | TOTAL SHEETS |
|---------------------|-------|--------------------|-------------|-------------|--------------|
| HAWAII              | HAW.  | STP-724(1)         | 1995        | ADD. 37 S-1 | 42           |

EXPRESSWAY (E) AND DESTINATION (D) SIGN NOTES

- The Contractor shall verify the locations and dimensions of existing Sign Panels and supports.
- New sign panels shall be laminated aluminum or extruded aluminum.
- Letter Size:
  - When letters are all uppercase, use series "E"
  - When initial uppercase letter is used in conjunction with lowercase letters, use series "E"(M) for uppercase
- Contractor shall submit all sign splicing details to the Engineer for approval. All backing for signs 4 feet by 6 feet or less shall be of one sheet.
- Destination and Expressway Sign Posts shall be as noted on the plans.
- Removal and disposal of existing sign panels, posts with foundation, luminaires and supports will not be paid for separately, but shall be considered incidental to the various signing items.
- Install New Overlay with messages over existing sign panel. Remove and dispose existing sign luminaires and install New 175-Watt Metal Halide Sign Luminaires as shown on plans. Connect Luminaires to existing transformer and ballast housing. The cost for installing the new sign overlay shall be paid for under Item Nos. 621.0211 - Overlay Panel for Expressway Sign and 621.0212 - Overlay Panel for Destination Sign. The Expressway Sign Luminaires shall be paid for under Item No. 622.2300 - Replacement of Existing Luminaires with 175-Watt Metal Halide Luminaires for Expressway Sign Lighting.
- The amount and center-to-center spacing of Expressway Sign Luminaires shall be in accordance with the luminaires manufacturer's instructions. Maximum center-to-center spacing of luminaires shall be 10-feet.
- All existing expressway sign luminaires that are not operational and to remain shall be made operational. All additional materials and labor which are necessary to complete this work, shall be considered incidental to replacement of existing luminaires with 175-Watt metal halide, and no additional compensation will be allowed therefor.
- Existing damaged steel framing luminaire supports and/or ballast housing box shall be replaced prior to installing the new sign luminaires. This work shall be considered incidental to Item No. 622.2300 - Replacement of Existing Luminaires with 175-Watt Metal Halide Luminaires for Expressway Sign Lighting.
- Incidental parts and services, including sign lighting system, not shown on the plans or specified but deemed necessary for the sign installation, shall be furnished and installed by the Contractor as part of the work contracted.
- Connections of new sign luminaires to existing transformer and ballast housing and all incidental parts and service necessary will not be paid for separately but shall be considered as incidental to replacement of existing luminaires with 175-Watt metal halide.
- Installing additional steel framing luminaire supports will not be paid for separately, but shall be considered incidental to Item No. 622.2300 - Replacement of Existing Luminaires with 175-Watt Metal Halide Luminaires for Expressway Sign Lighting.

LEGEND

- △ Replace Existing Expressway Sign Luminaires w/New 175-Watt Metal Halide Expressway Sign Luminaires. (2 each per sign)



|               |                   |         |
|---------------|-------------------|---------|
| ORIGINAL PLAN | SURVEY PLANNED BY | DATE    |
| NOTED BY      | DRAWN BY          | 6/16/95 |
| DESIGNED BY   | C. Abe            |         |
| CHECKED BY    | N. Ikehara        |         |

|         |  |
|---------|--|
| 6/16/95 | Sheet added to Contract Plan Set per Addendum No. 1. |
|---------|--|

| DATE | REVISION |
|------|----------|
|------|----------|

|   |
|---|
| STATE OF HAWAII<br>DEPARTMENT OF TRANSPORTATION<br>HIGHWAYS DIVISION                          |
| <b>SIGN NOTES AND DETAIL</b>  |
| KAHUAPAANI ST. RESURFACING<br>Ulune St. to Salt Lake Blvd.<br>Fed. Aid Project No. STP-724(1) |
| Scale: As Noted Date: June, 1995  |
| SHEET No. OF SHEETS   |

ADD. 37 S-1

| FED. ROAD DIST. NO. | STATE | FED. AID PROJ. NO. | FISCAL YEAR | SHEET NO.  | TOTAL SHEETS |
|---------------------|-------|--------------------|-------------|------------|--------------|
| HAWAII              | HAW.  | STP-724(I)         | 1995        | ADD. 37-S2 | 42           |

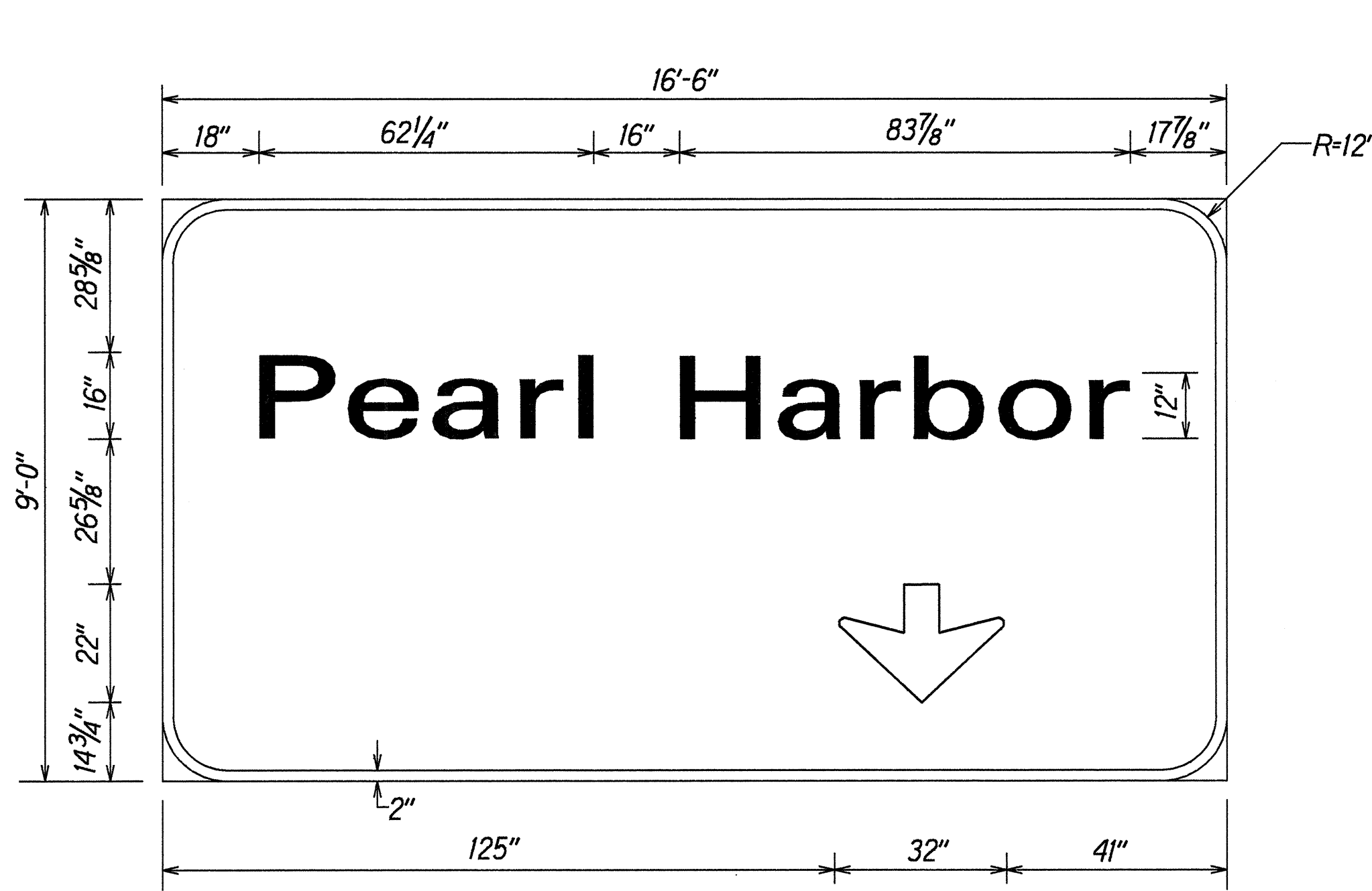

E-1(L)  
Scale: 1/2"=1'-0"

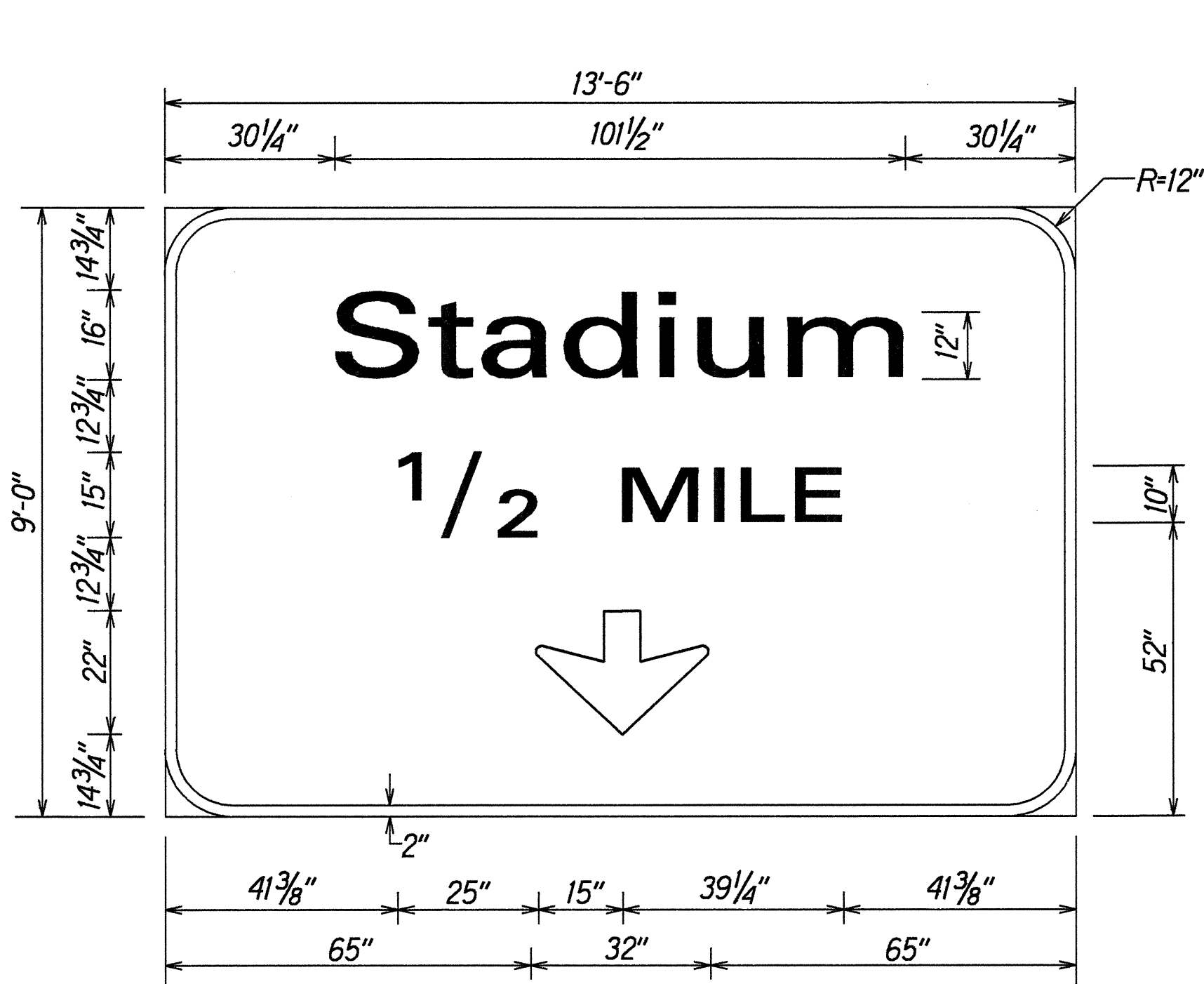

E-1(C)  
Scale: 1/2"=1'-0"

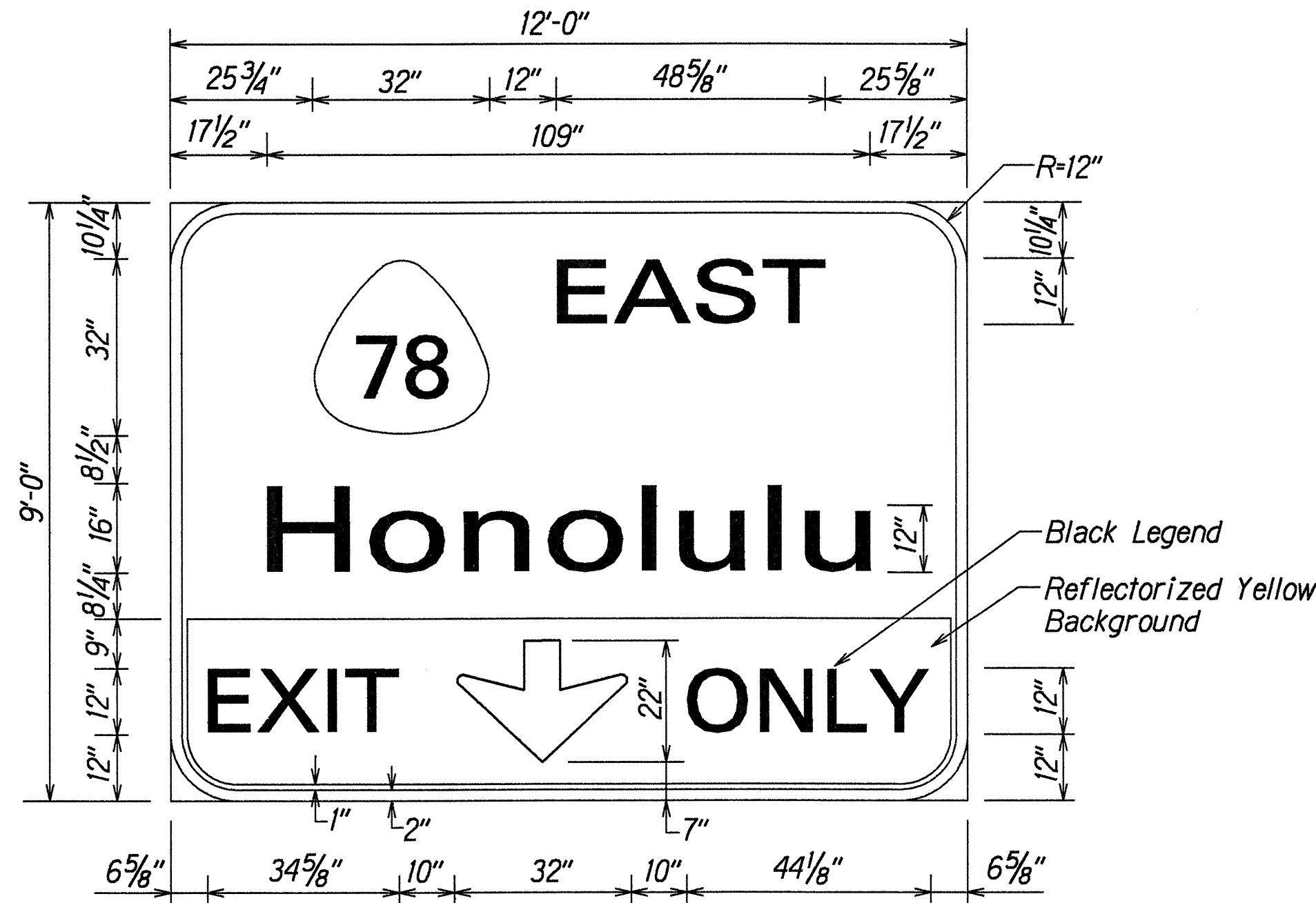

E-1(R)  
Scale: 1/2"=1'-0"

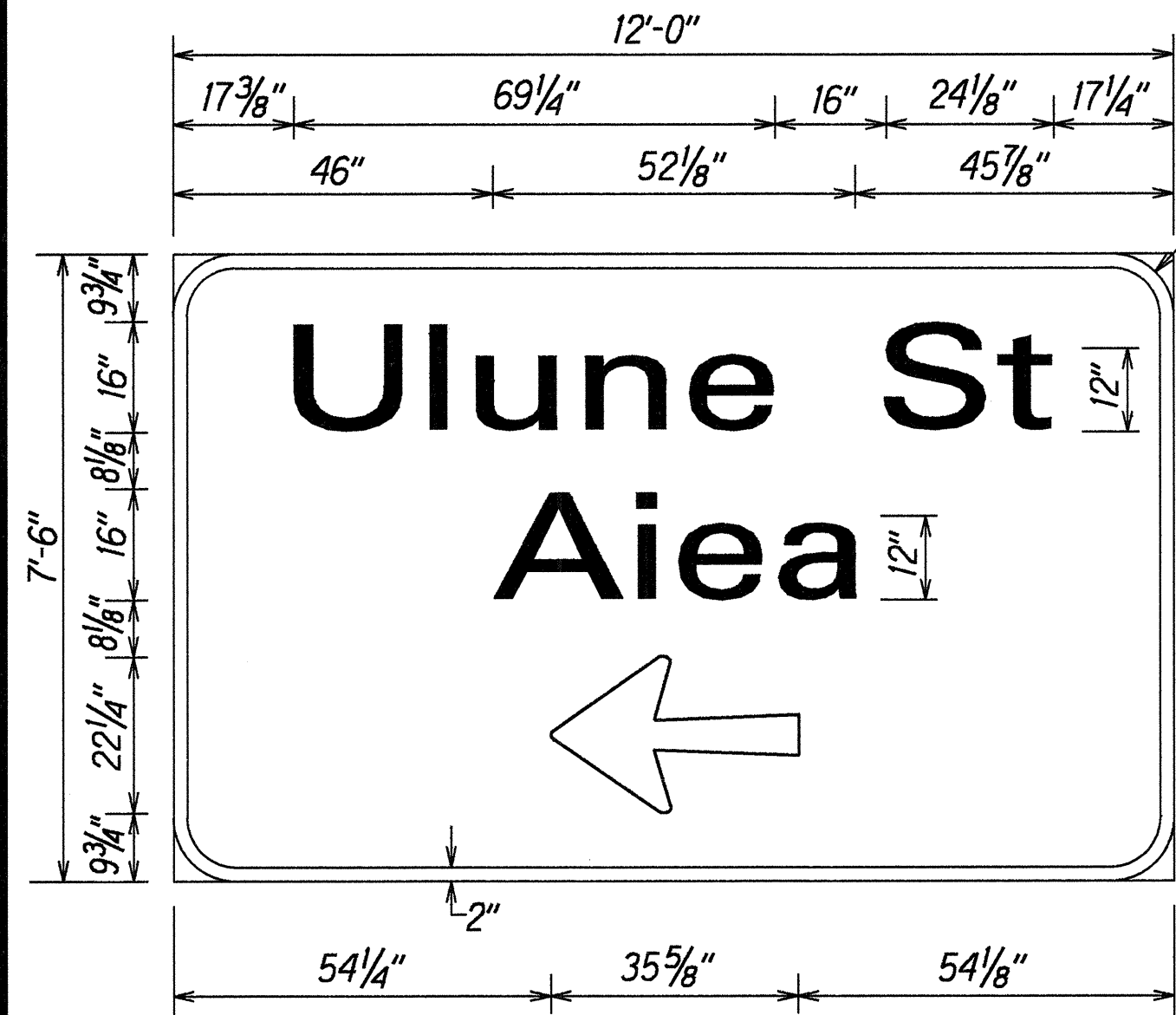

E-2(L)  
Scale: 1/2"=1'-0"

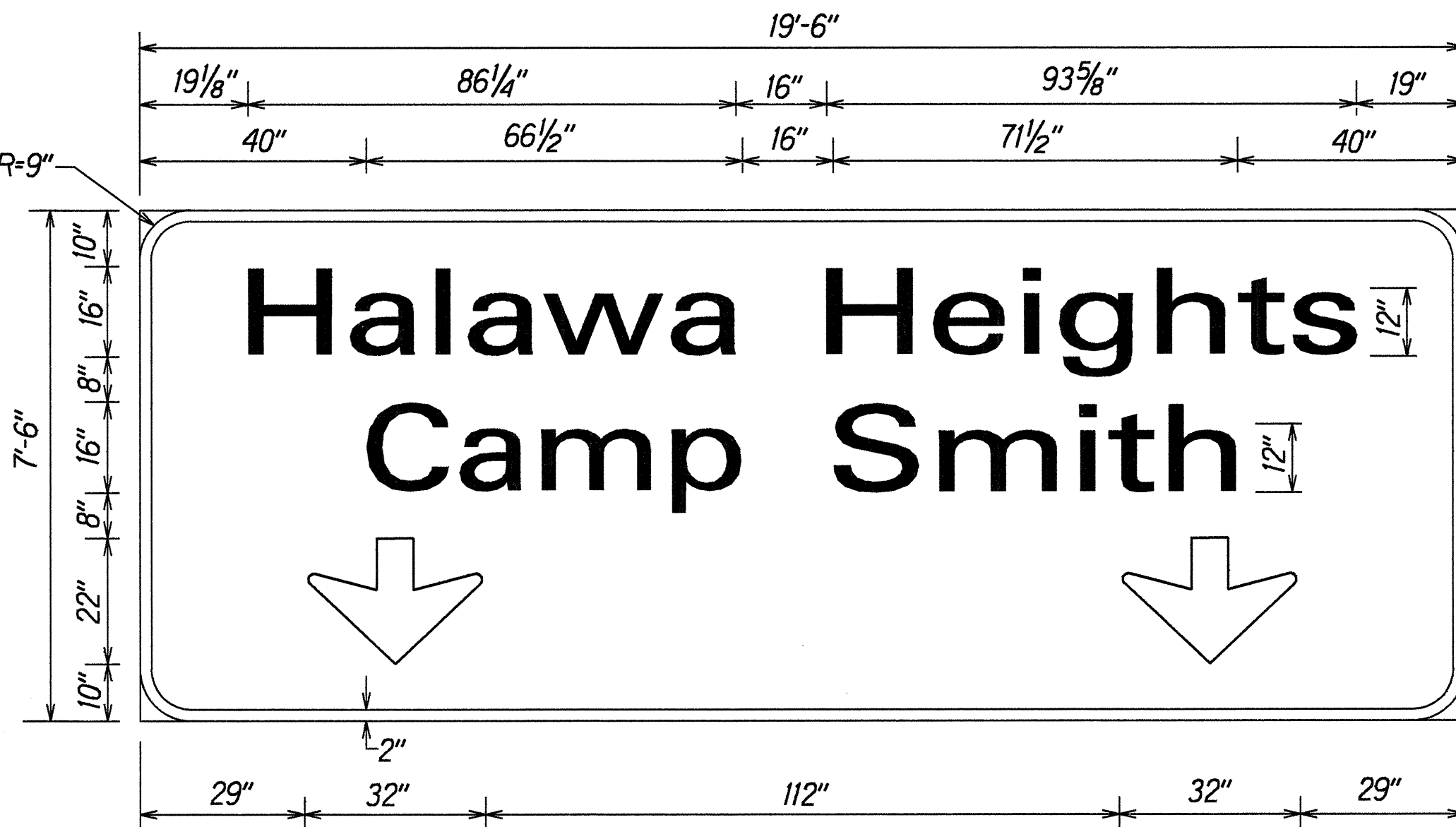

E-2(C)  
Scale: 1/2"=1'-0"

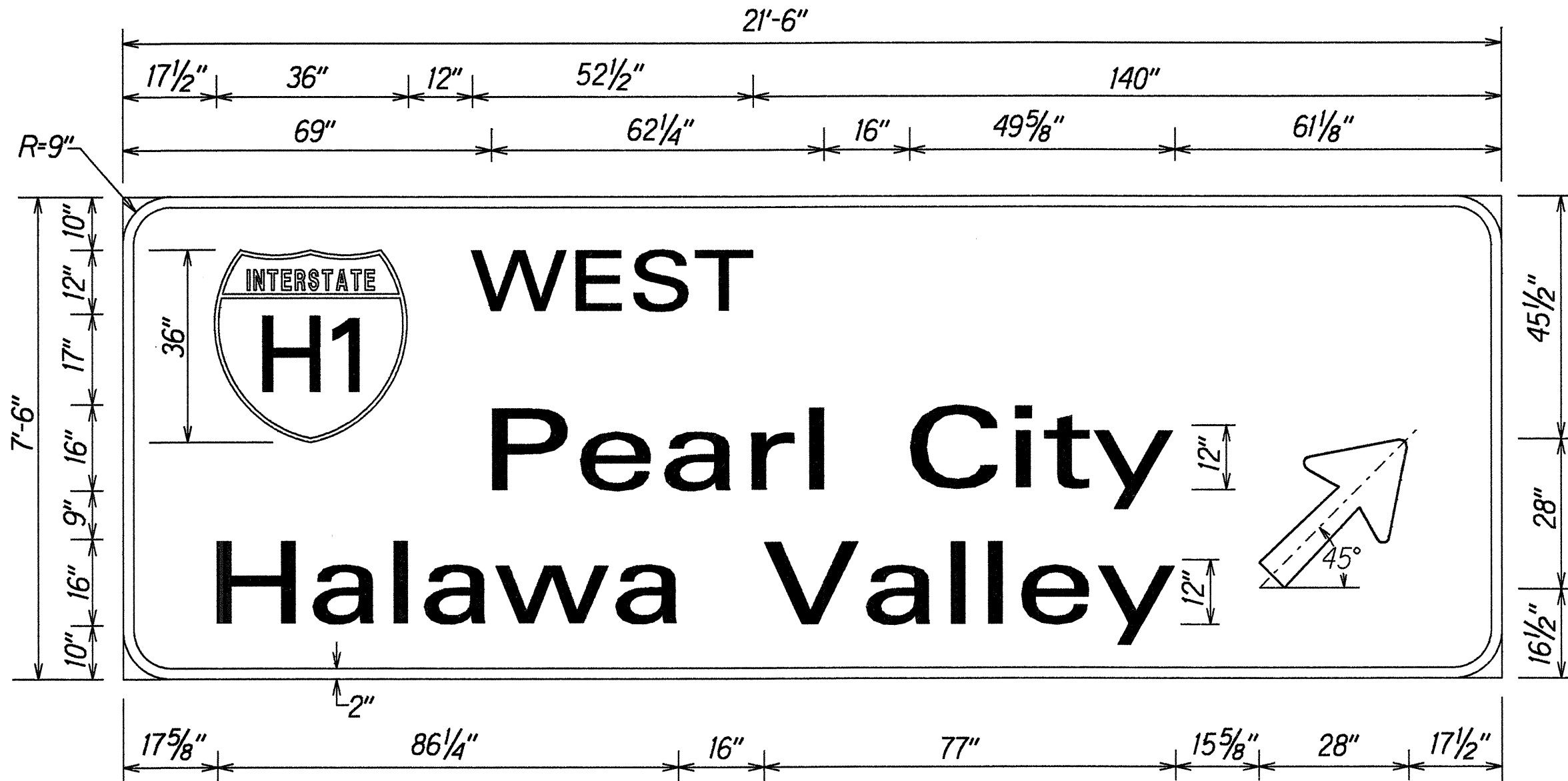

E-2(R)  
Scale: 1/2"=1'-0"

|               |         |
|---------------|---------|
| DESIGNED BY   | DATE    |
| DRAWN BY      | 6/16/95 |
| CHECKED BY    |         |
| NOTED BY      |         |
| QUANTITIES BY |         |
| REVISIONS     |         |

|         |  |
|---------|--|
| 6/16/95 | Sheet added to Contract Plan Set per Addendum No. 1. |
| DATE    | REVISION   |

|  |
|--|
| STATE OF HAWAII<br>DEPARTMENT OF TRANSPORTATION<br>HIGHWAYS DIVISION<br><b>EXPRESSWAY SIGN<br/>DETAILS</b><br>KAHUAPAANI ST. RESURFACING<br>Ulune St. to Salt Lake Blvd.<br>Fed. Aid Project No. STP-724(I)<br>Scale: As Noted Date: June, 1995<br>SHEET No. OF SHEETS |
|--|