

PLOTTING
COLORS PEN
1 R
2 B
3 G
4 Y
5 M
6 C
7 K
8 W
9 L
10 D
11 S
12 L
13 B
14 G
15 Y
SCALE: 1"=100'

CONSTRUCTION DETOUR LEGEND

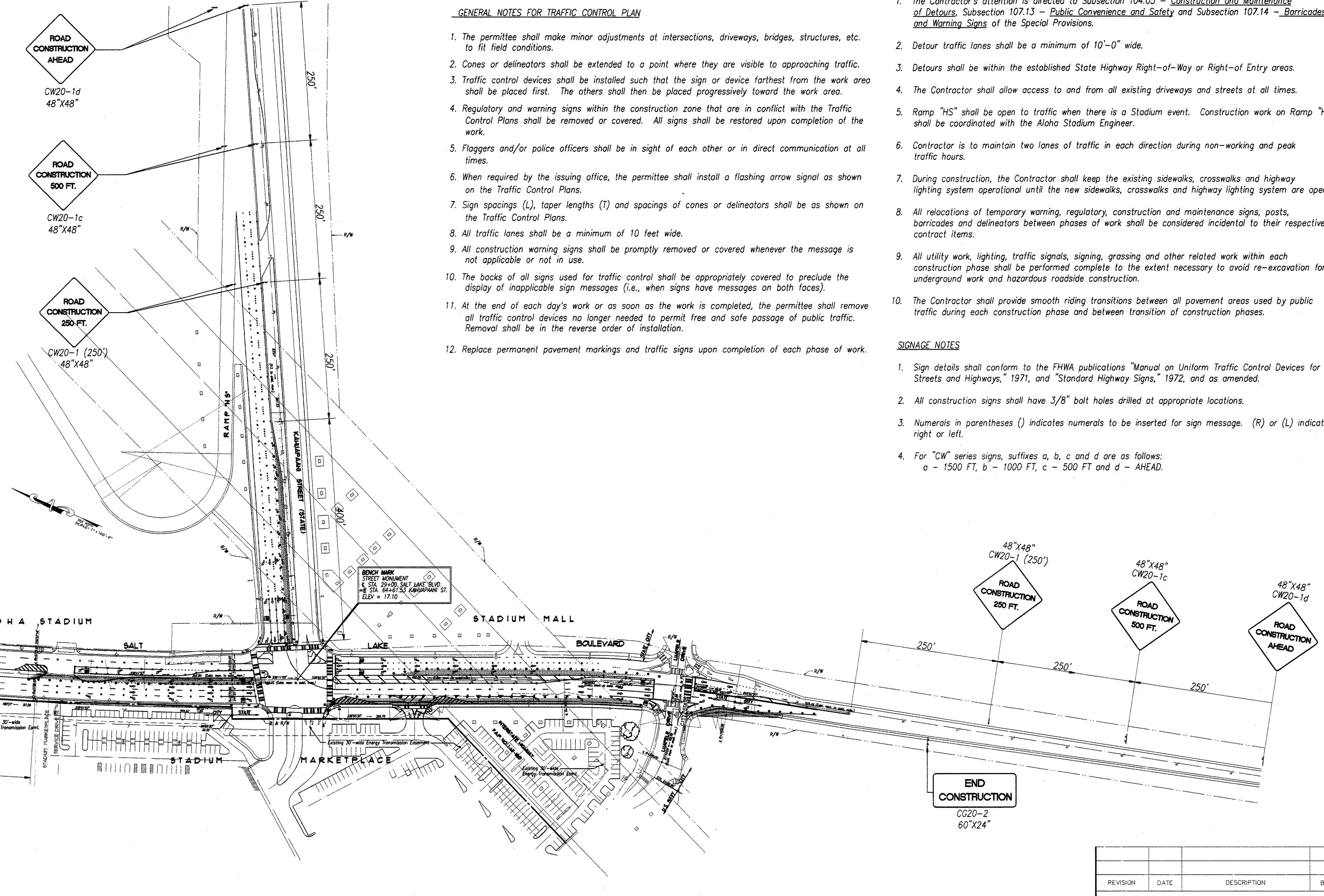
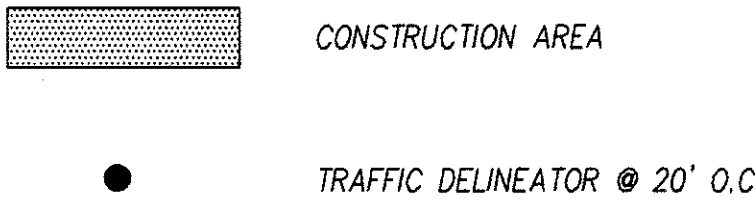

GENERAL NOTES FOR TRAFFIC CONTROL PLAN

1. The permittee shall make minor adjustments at intersections, driveways, bridges, structures, etc. to fit field conditions.
2. Cones or delineators shall be extended to a point where they are visible to approaching traffic.
3. Traffic control devices shall be installed such that the sign or device farthest from the work area shall be placed first. The others shall then be placed progressively toward the work area.
4. Regulatory and warning signs within the construction zone that are in conflict with the Traffic Control Plans shall be removed or covered. All signs shall be restored upon completion of the work.
5. Flaggers and/or police officers shall be in sight of each other or in direct communication at all times.
6. When required by the issuing office, the permittee shall install a flashing arrow signal as shown on the Traffic Control Plans.
7. Sign spacings (L), taper lengths (T) and spacings of cones or delineators shall be as shown on the Traffic Control Plans.
8. All traffic lanes shall be a minimum of 10 feet wide.
9. All construction warning signs shall be promptly removed or covered whenever the message is not applicable or not in use.
10. The backs of all signs used for traffic control shall be appropriately covered to preclude the display of inapplicable sign messages (i.e., when signs have messages on both faces).
11. At the end of each day's work or as soon as the work is completed, the permittee shall remove all traffic control devices no longer needed to permit free and safe passage of public traffic. Removal shall be in the reverse order of installation.
12. Replace permanent pavement markings and traffic signs upon completion of each phase of work.

GENERAL NOTES DURING CONSTRUCTION

1. The Contractor's attention is directed to Subsection 104.05 - Construction and Maintenance of Detours, Subsection 107.13 - Public Convenience and Safety and Subsection 107.14 - Barricades and Warning Signs of the Special Provisions.
2. Detour traffic lanes shall be a minimum of 10'-0" wide.
3. Detours shall be within the established State Highway Right-of-Way or Right-of Entry areas.
4. The Contractor shall allow access to and from all existing driveways and streets at all times.
5. Ramp "HS" shall be open to traffic when there is a Stadium event. Construction work on Ramp "HS" shall be coordinated with the Aloha Stadium Engineer.
6. Contractor is to maintain two lanes of traffic in each direction during non-working and peak traffic hours.
7. During construction, the Contractor shall keep the existing sidewalks, crosswalks and highway lighting system operational until the new sidewalks, crosswalks and highway lighting system are operational.
8. All relocations of temporary warning, regulatory, construction and maintenance signs, posts, barricades and delineators between phases of work shall be considered incidental to their respective contract items.
9. All utility work, lighting, traffic signals, signing, grading and other related work within each construction phase shall be performed complete to the extent necessary to avoid re-excavation for underground work and hazardous roadside construction.
10. The Contractor shall provide smooth riding transitions between all pavement areas used by public traffic during each construction phase and between transition of construction phases.

SIGNAGE NOTES

1. Sign details shall conform to the FHWA publications "Manual on Uniform Traffic Control Devices for Streets and Highways," 1971, and "Standard Highway Signs," 1972, and as amended.
2. All construction signs shall have 3/8" bolt holes drilled at appropriate locations.
3. Numerals in parentheses () indicates numerals to be inserted for sign message. (R) or (L) indicates right or left.
4. For "CW" series signs, suffixes a, b, c and d are as follows:
a - 1500 FT, b - 1000 FT, c - 500 FT and d - AHEAD.

TRAFFIC CONTROL PLAN

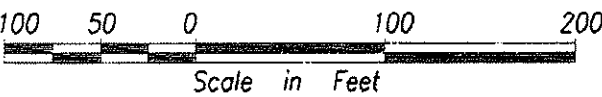

PROJECT TITLE: KWAH
CAD. DWG. NO.: 232841CP
DATE: OCTOBER 18, 1993