

CONSTRUCTION PHASING NOTES

FED. ROAD DIST. NO.	STATE	FED. AID PROJ. NO.	FISCAL YEAR	SHEET NO.	TOTAL SHEETS
HAWAII	HAW.	STP-0300(39)	1996	15	70

1. The Contractor shall follow the consecutive order of Construction Phasing as follows:
- Phase I - Outbound Widening & Improvements
Excavating; Grading; Drainage, traffic signals, and guardrail improvements; and Constructing new retaining walls, highway lighting, concrete sidewalks, wheelchair ramps, curb & gutter and a.c. pavement - Ulune Street & Sta. 38+61± to & Sta. 43+95± and Halawa Valley Road & Sta. 15+00± to & Sta. 25+17±.
- Phase II - Inbound Widening & Improvements
Grading; Widening or reconstructing existing sidewalks; Drainage improvements; Recon-structing median & traffic island; and Constructing new concrete sidewalks, curb (& gutter) and a.c. pavement - Halawa Valley Road & Sta. 15+07± to & Sta. 24+82± and Ulune Extension & Sta 35+51± to & Sta. 37+52±.
2. Any requests for adjustments in sequence of Construction Phasing must be submitted in writing and approved by the Engineer. The Contractor's attention is directed to Sub-section 108.08 - Failure to Complete on Time and Liquidated Damages of the Special Provisions.
3. Type I Barricades with steady burn amber lamp used during Construction Phasing shall be considered incidental to the various contract items.
4. Relocation and/or removal of temporary signs, posts and portable concrete guardrails used for Construction Phasing shall be considered incidental to their respective contract items.
5. All temporary signs and barricades for the purposes of Construction Phasing shall become the property of the Contractor at the completion of the project.
6. The Contractor shall delete the use of the ground anchorage steel pin for State Furnished Portable Concrete Guardrail.
7. Portable concrete guardrail panels not in use during construction work shall not be stockpiled or otherwise stored within the highway rights-of-way except at locations approved by the Engineer.
8. The Contractor shall be periodically wash down signs, delineators and portable concrete guardrails called for in the Construction Phasing Plans as deemed necessary by the Engineer. This work shall be considered incidental to the various contract items and no payment will be made therefore.
9. The locations of pavement markings and signs, delineators and portable concrete guardrail panels used in the Construction Phasing shall be as shown on the plans and/or as determined in the field by the Engineer.
10. Damage to signs, temporary pavement markers, delineators and portable concrete guardrails caused by the public shall be repaired or replaced by the Contractor as directed by the Engineer. This work shall be paid for under Item No. 645.2000, Police Officers and/or Additional Traffic Control Devices. Damage caused by the Contractor's negligence shall be repaired or replaced at the Contractor's expense.

11. Work required in the State's Construction Phase Plans will be paid under applicable contract items or as otherwise specified herein. All other traffic control work shall be in accordance with Section 645 - Traffic Control. Work required for lane closures during the working day will not be paid for but shall be considered incidental to various contract items. Advance Construction Warning Signs as required under Section 645 of the Special Provisions shall be installed on all approaches to construction areas. This work shall be considered incidental to the various contract items.
12. For notification of Oahu Transit Services, Inc., see General Note No. 6 on Plan Sheet No. 3 .

ORIGINAL PLAN	SURVEY PLOTTED BY	DATE
PLAN	DRAWN BY	4/12/96
NOTE BOOK	TRACED BY	
ddlynn	BY	
theraphan	QUANTITIES BY	
	CHECKED BY	

STATE OF HAWAII
DEPARTMENT OF TRANSPORTATION
HIGHWAYS DIVISION

CONSTRUCTION PHASING NOTES

ULUNE STREET IMPROVEMENTS
Halawa Hts. Rd. to Halawa Valley Rd.
And
HALAWA VALLEY RD. IMPROVEMENTS
Ulune Ext. to Iwaiwa St.
Fed. Aid Project No. STP-0300(39)

Date: May, 1996

SHEET No. 1 OF 1 SHEETS

FED. ROAD DIST. NO.	STATE	FED. AID PROJ. NO.	FISCAL YEAR	SHEET NO.	TOTAL SHEETS
HAWAII	HAW.	STP-0300(39)	1996	16	70

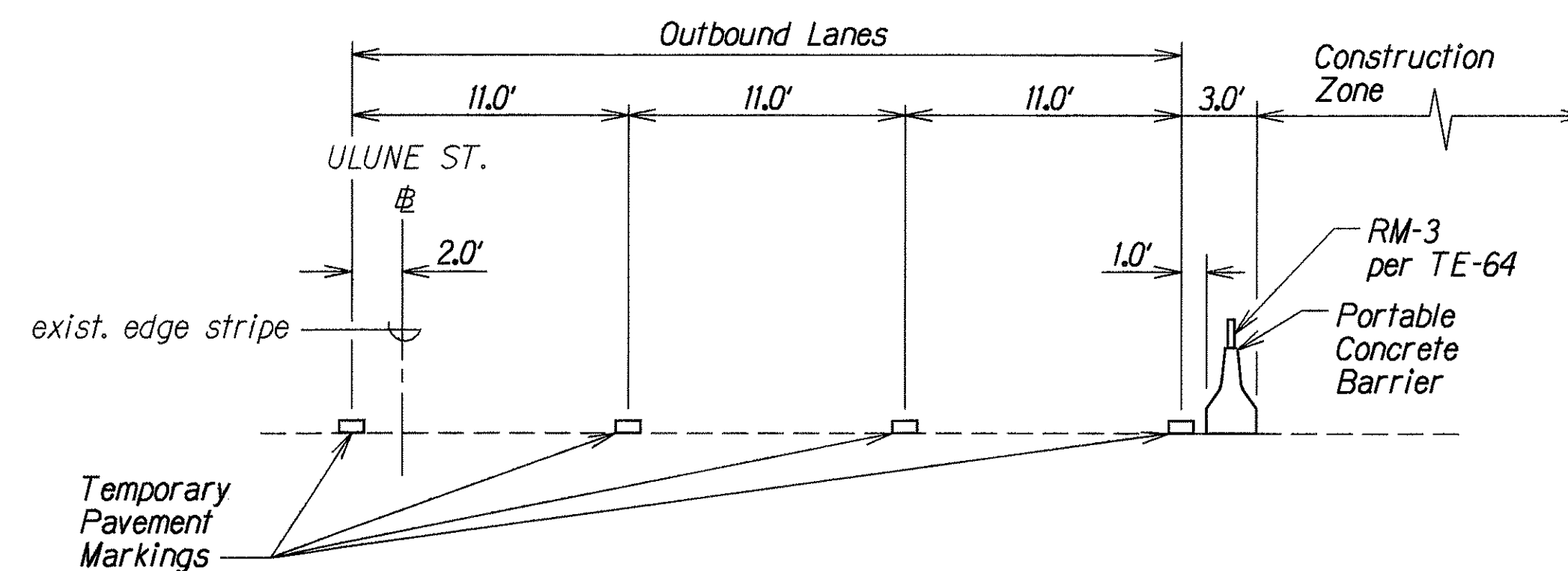
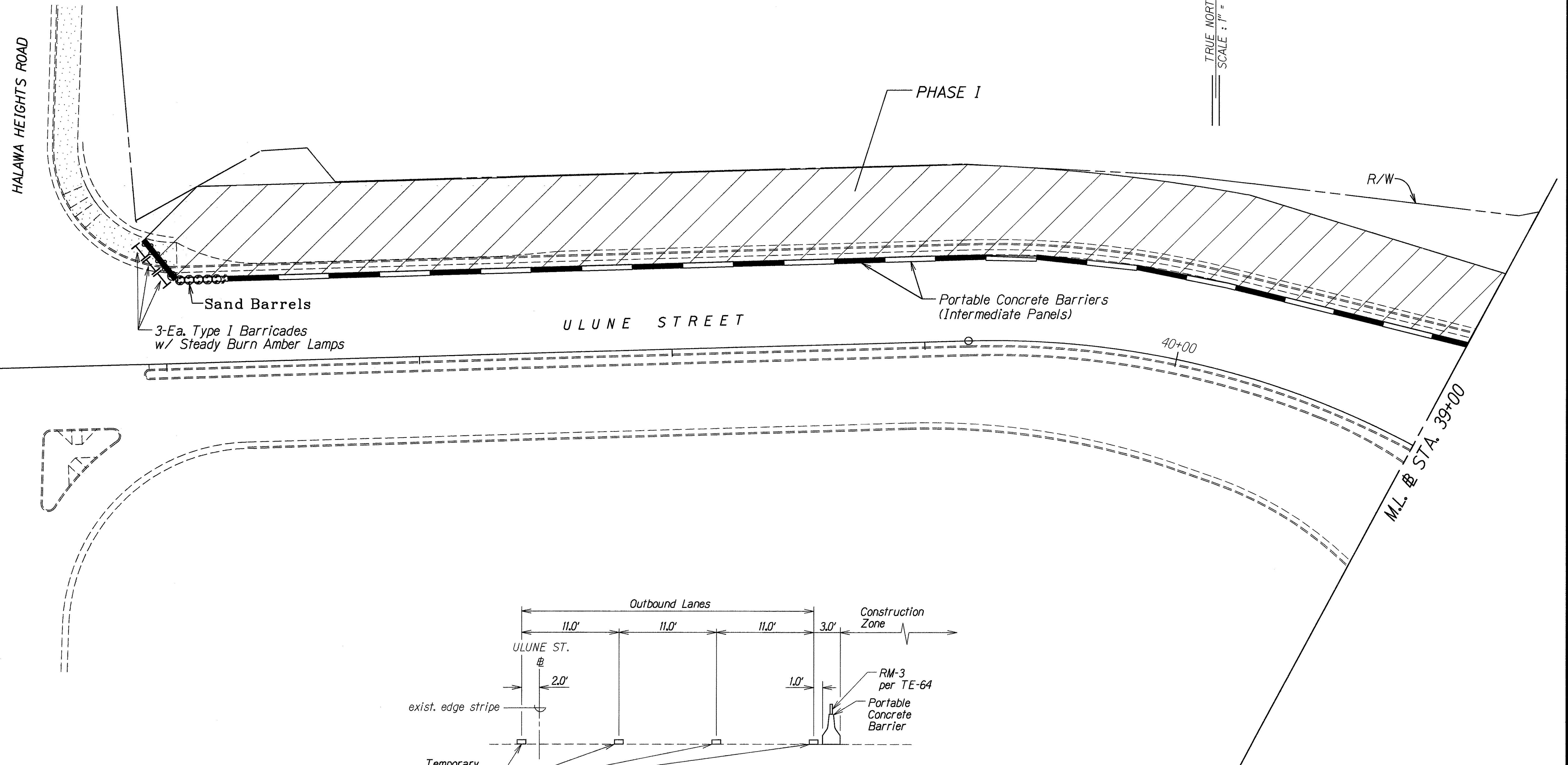

TYPICAL SECTION - ULUNE STREET
PHASE I
 Not to Scale

LEGEND FOR AS-BUILT POSTINGS	
	Squiggly line for as-built deletion
	Double line for as-built deletion
Roadway	Text for as-built posting

STATE OF HAWAII
 DEPARTMENT OF TRANSPORTATION
 HIGHWAYS DIVISION

CONSTRUCTION PHASING

ULUNE STREET IMPROVEMENTS
 Halawa Hts. Rd. to Halawa Valley Rd.
 And
HALAWA VALLEY RD. IMPROVEMENTS
 Ulune St. to Iwaiwa St.
 Fed. Aid Project No. STP-0300(39)

Scale: As Shown Date: May, 1996

SHEET No. 1 OF 3 SHEETS

"AS-BUILT"

ORIGINAL PLAN	DATE
DESIGNED BY	3/12/96
NOTED BY	
QUANTITIES BY	
CHECKED BY	

FED. ROAD DIST. NO.	STATE	FED. AID PROJ. NO.	FISCAL YEAR	SHEET NO.	TOTAL SHEETS
HAWAII	HAW.	STP-0300(39)	1996	17	70

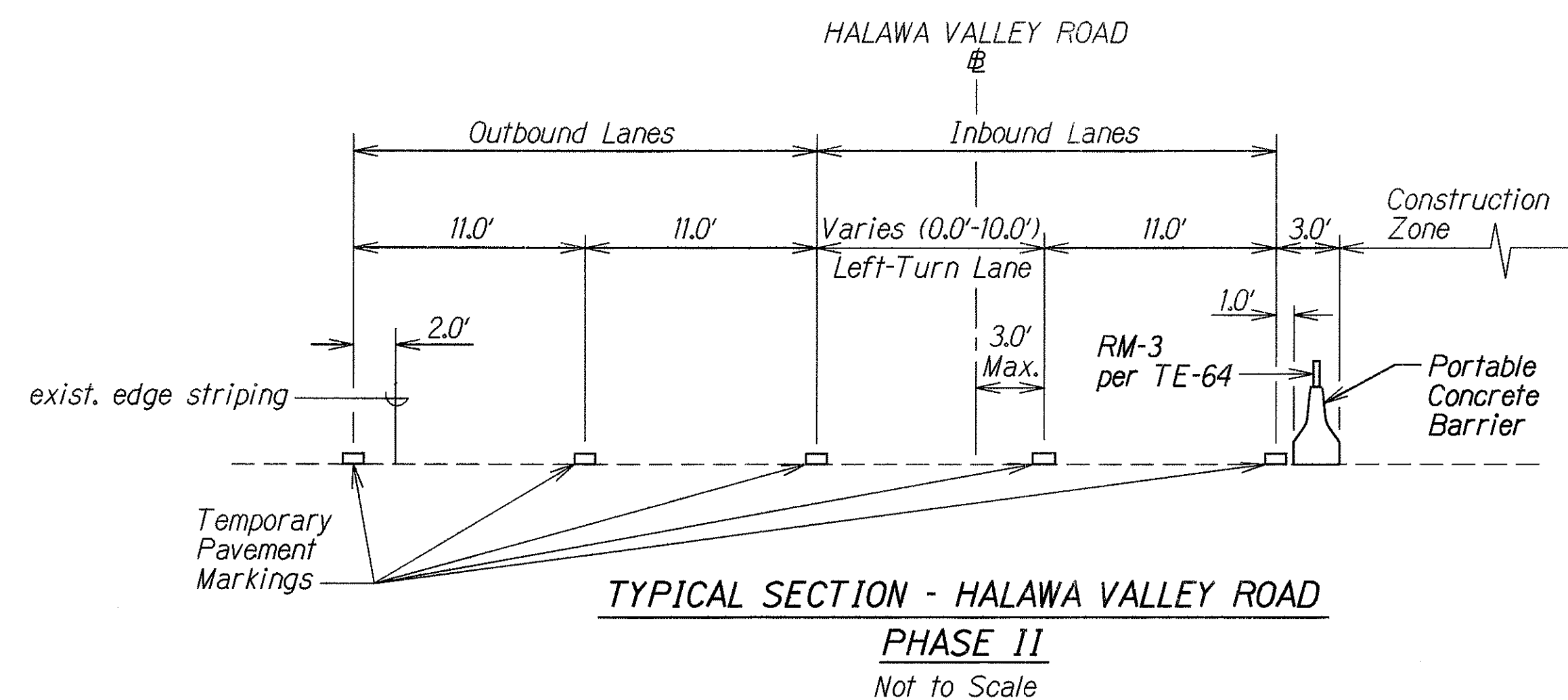
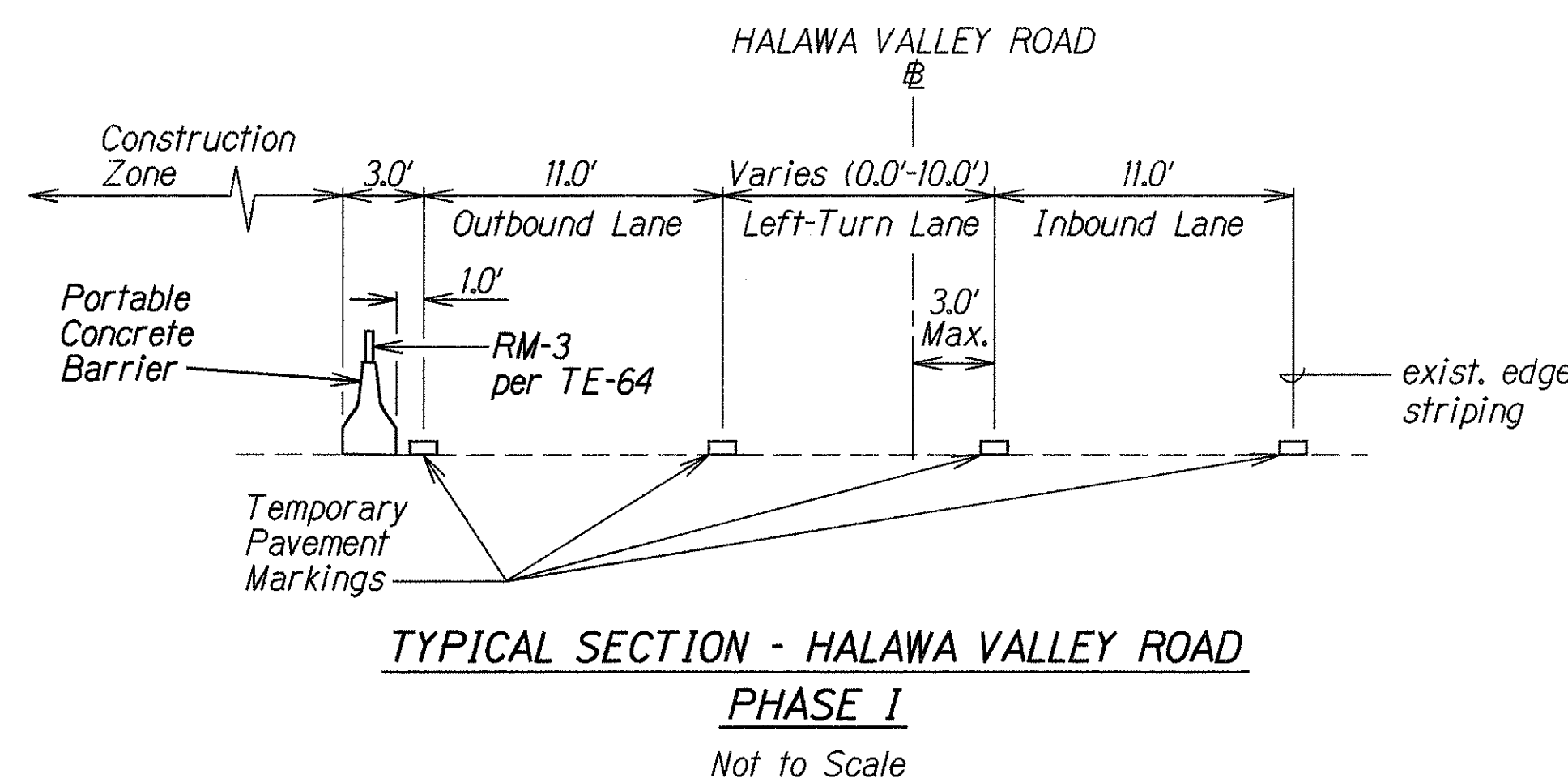
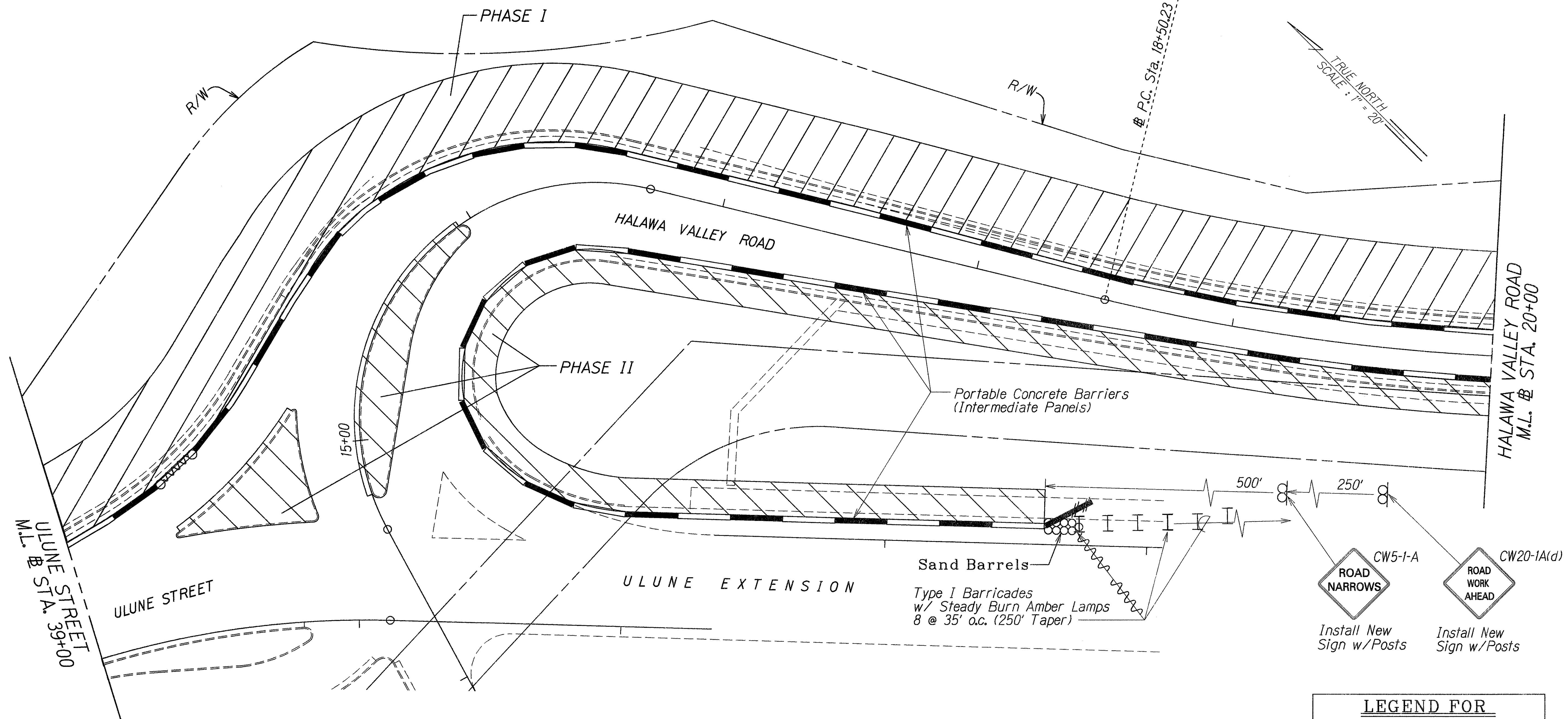

LEGEND FOR AS-BUILT POSTINGS	
	Squiggly line for as-built deletion
	Double line for as-built deletion
	Text for as-built posting

STATE OF HAWAII
DEPARTMENT OF TRANSPORTATION
HIGHWAYS DIVISION
CONSTRUCTION PHASING
ULUNE STREET IMPROVEMENTS
Halawa Hts. Rd. to Halawa Valley Rd.
And
HALAWA VALLEY RD. IMPROVEMENTS
Ulune St. to Iwaiwa St.
Fed. Aid Project No. STP-0300(39)
Scale: As Shown Date: May, 1996
SHEET No. 2 OF 3 SHEETS

"AS-BUILT"

FED. ROAD DIST. NO.	STATE	FED. AID PROJ. NO.	FISCAL YEAR	SHEET NO.	TOTAL SHEETS
HAWAII	HAW.	STP-0300(39)	1996	18	70

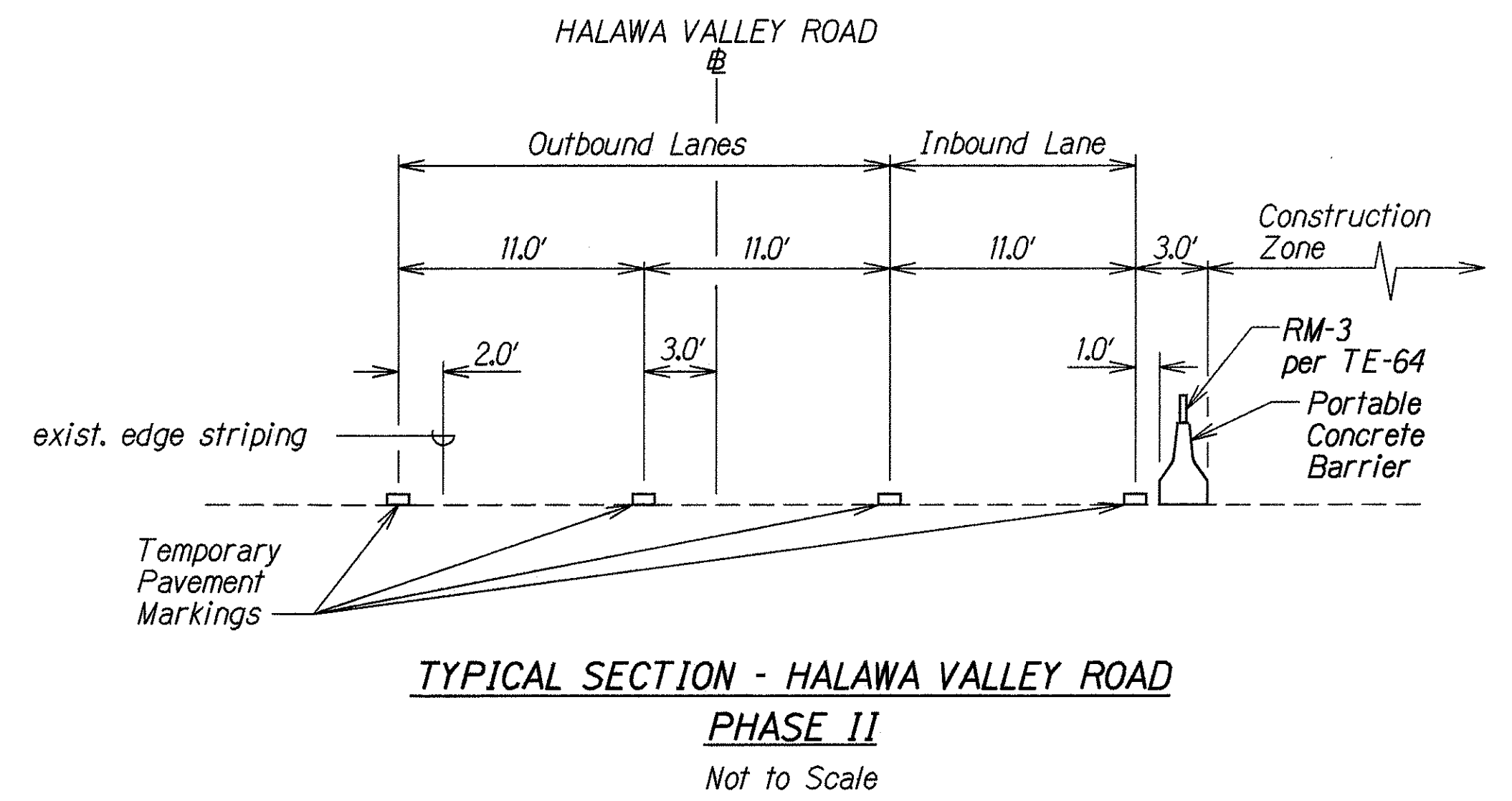
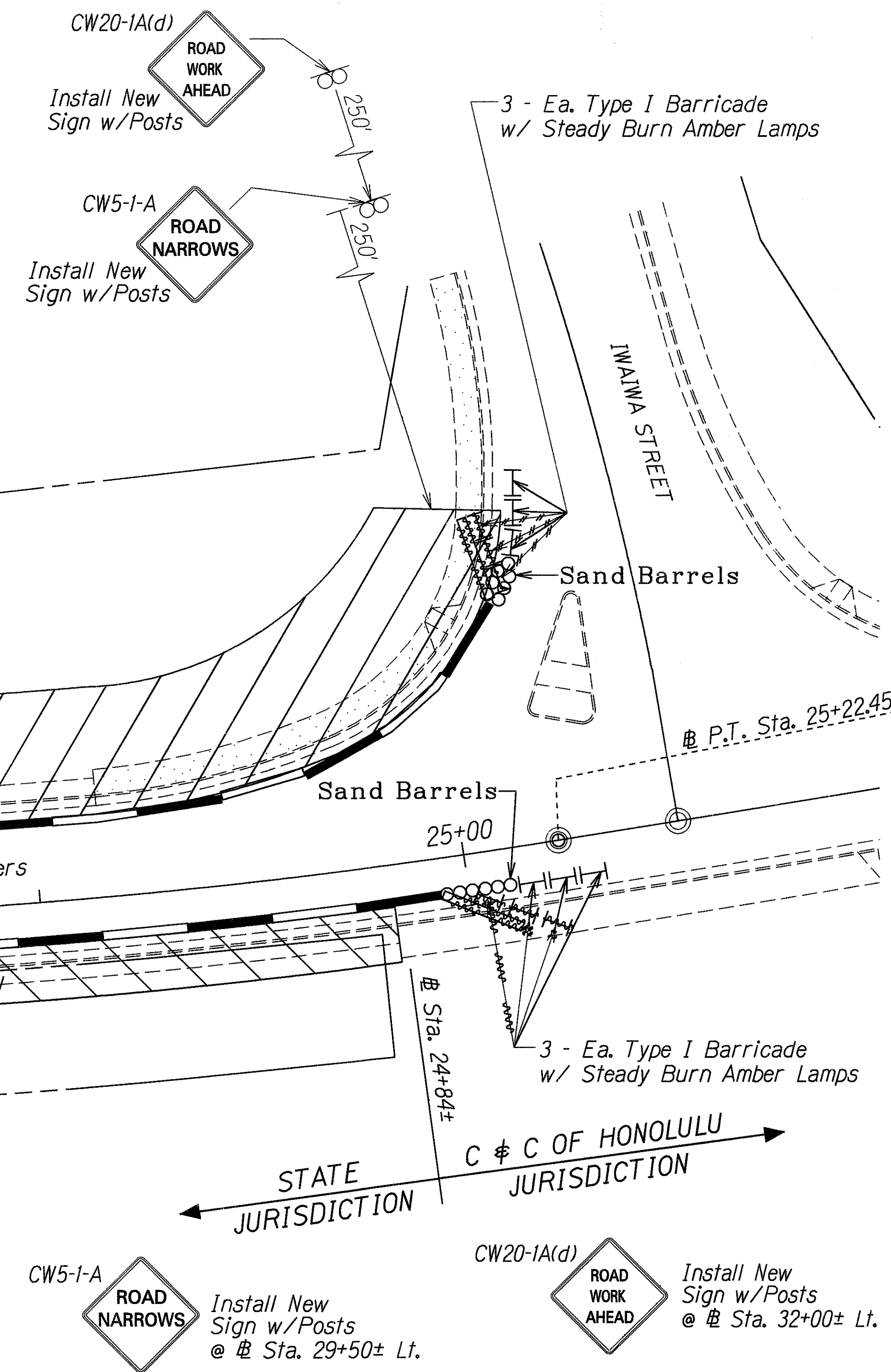
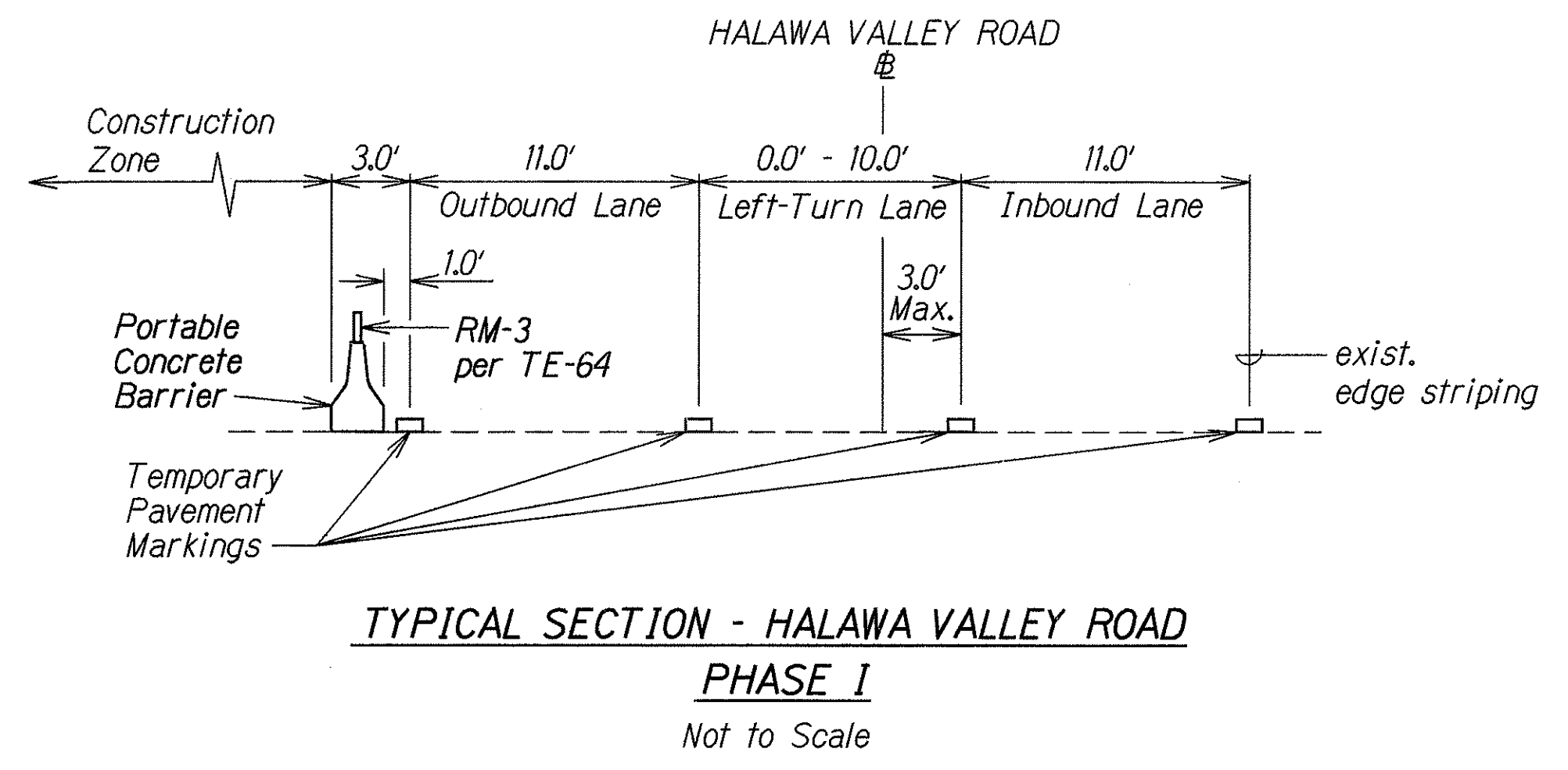
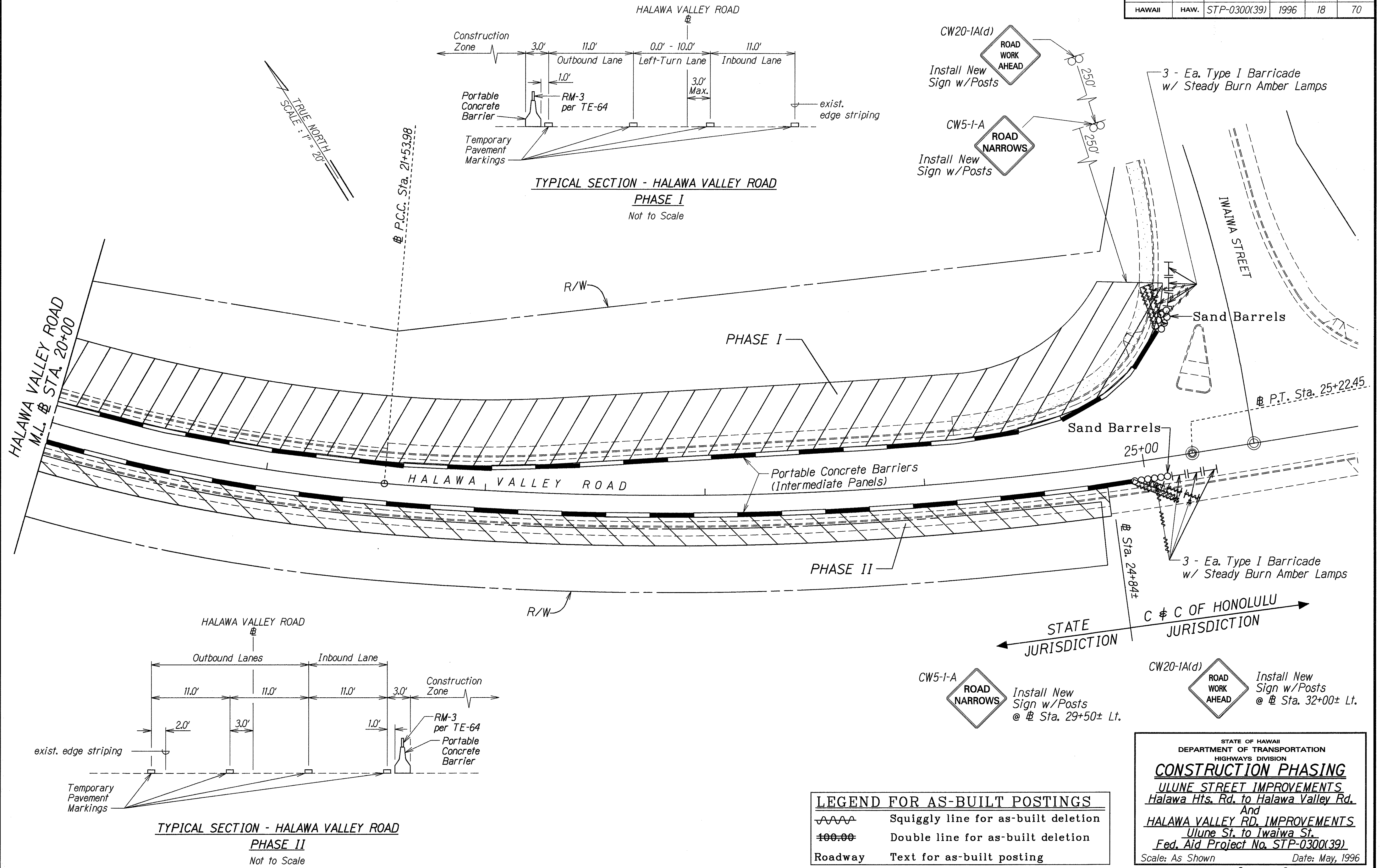

LEGEND FOR AS-BUILT POSTINGS	
	Squiggly line for as-built deletion
	Double line for as-built deletion
Roadway	Text for as-built posting

STATE OF HAWAII
DEPARTMENT OF TRANSPORTATION
HIGHWAYS DIVISION

CONSTRUCTION PHASING
ULUNE STREET IMPROVEMENTS
Halawa Hts. Rd. to Halawa Valley Rd.
And
HALAWA VALLEY RD. IMPROVEMENTS
Ulune St. to Iwaiwa St.
Fed. Aid Project No. STP-0300(39)
Scale: As Shown Date: May, 1996

SHEET No. 3 OF 3 SHEETS

ORIGINAL PLAN	DATE	5/13/96
DESIGNED BY	TRACED BY	
NOTED BY	DESIGNED BY	
CHECKED BY	QUANTITIES BY	