

INDEX TO DRAWINGS	
SHEET NO.	DESCRIPTIONS
1	Title Sheet
2	Typical Sections
3-6	Plan and Profile
7&8	Standard Details
9	Flat Slab Syphon
10	Indust. R.R. & Tractor Crossing and Syphon Details
11	Cross Sections

TERRITORY OF HAWAII  
TERRITORIAL HIGHWAY DEPARTMENT  
HONOLULU T.H.

## PLANS OF EWA-WEST LOCH ACCESS ROAD

HAWAII PROJECT NO. DA-NR-3 (1)  
EWA DISTRICT  
ISLAND OF OAHU

FED. ROAD DIST. NO.	STATE	FED. AID PROJ. NO.	FISCAL YEAR	SHEET NO.	TOTAL SHEETS
HAWAII	HAW.	DA-NR-3	1942	1	11

CONVENTIONAL	SIGNS
Existing Road	-----
Existing Fence	-x-x-
Boundary Line	-----
Center Line	-----
Paved Approaches etc.	-----
Culverts	-----
Railroad	-----

**SCALE**

PLAN	HOR. 1 INCH = 100 FT.
PROFILE	VER. 1 INCH = 100 "
CROSS SECT.	HOR. 1 INCH = 10 "
	VER. 1 INCH = 10 "

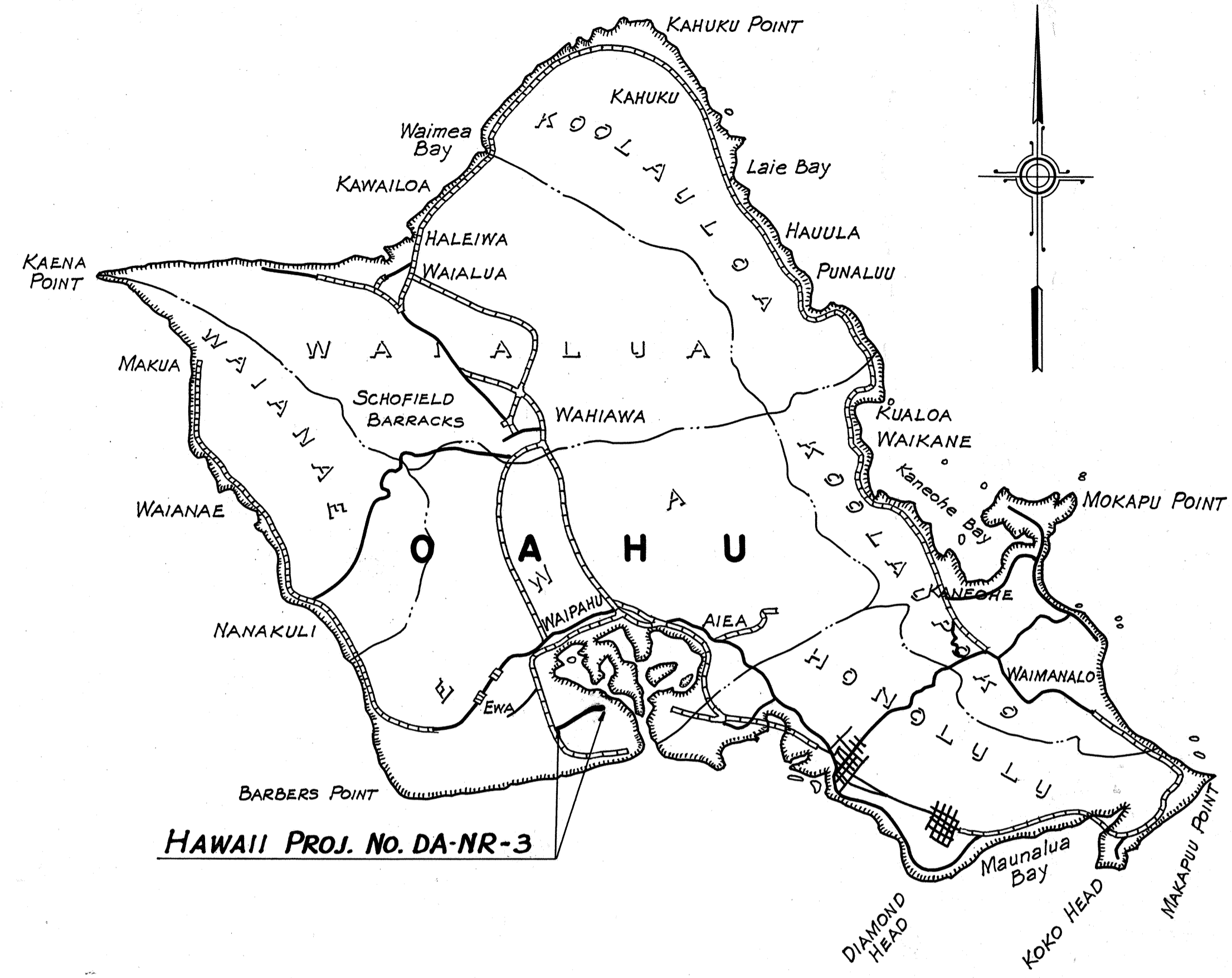

HAWAII PROJ. No. DA-NR-3

Federal Aid Projects previously constructed or under construction.

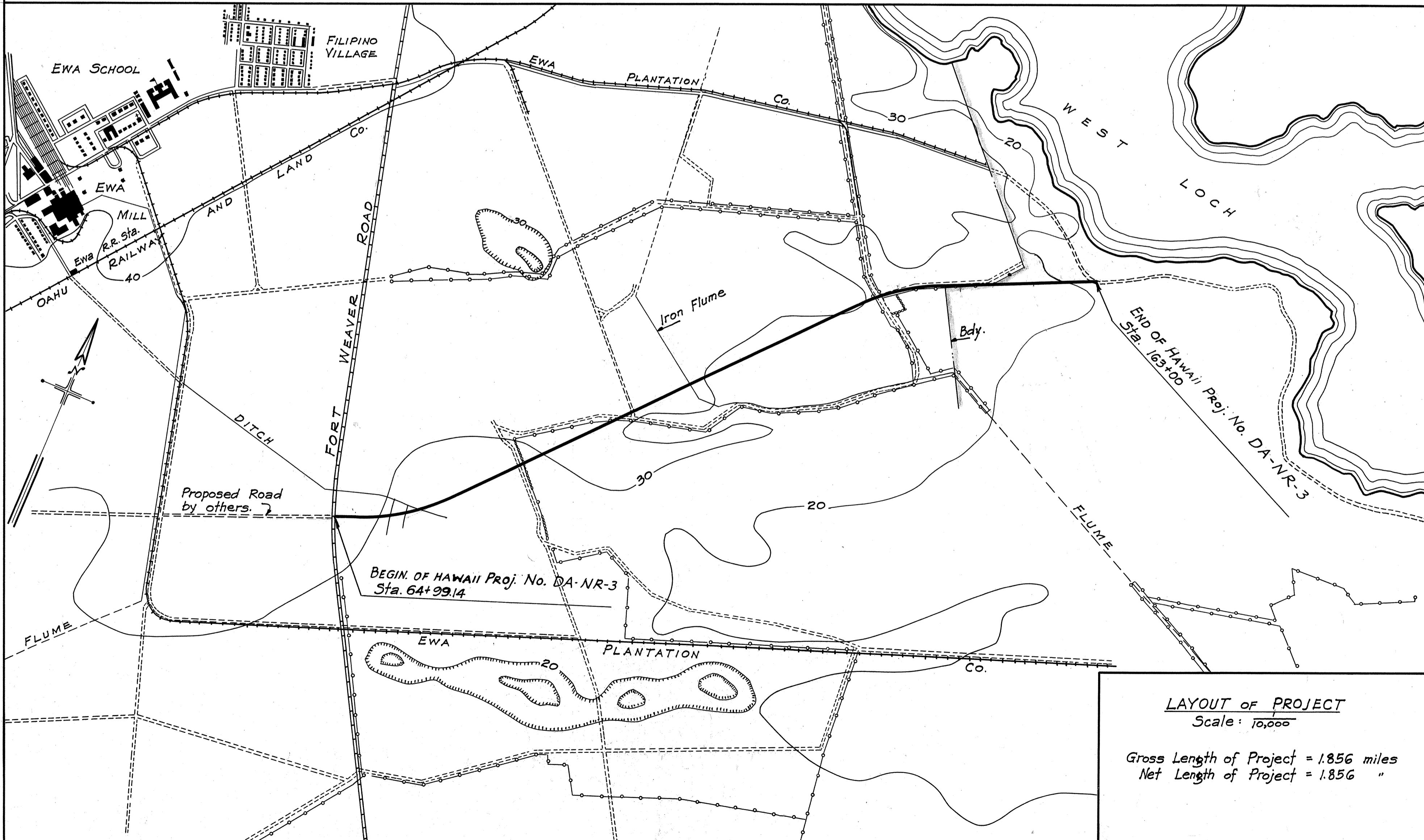

**LAYOUT of PROJECT**  
Scale: 10,000

Gross Length of Project = 1.856 miles  
Net Length of Project = 1.856 "

SURVEY PLOTTED BY	J.L.P.	DATE	May, 1942
ORIGINAL PLAN	BY		
TRACED BY	S.H. & T.H.		
NOTE BOOK	BY		
QUANTITIES CHECKED BY	J.L.P.		
CHECKED BY			

APPROVED

TERRITORIAL HIGHWAY ENGINEER

RECOMMENDED FOR APPROVAL

DISTRICT ENGINEER  
PUBLIC ROADS ADMINISTRATION  
FEDERAL WORKS AGENCY

RECOMMENDED FOR APPROVAL

CHIEF WESTERN REGION  
PUBLIC ROADS ADMINISTRATION  
FEDERAL WORKS AGENCY

APPROVED

COMMISSIONER  
PUBLIC ROADS ADMINISTRATION  
FEDERAL WORKS AGENCY