

FED. ROAD DIST. NO.	STATE	PROJ. NO.	FISCAL YEAR	SHEET NO.	TOTAL SHEETS
HAWAII	HAW.	7101A-01-04M	2006	51	74

**LEGEND**

- 4 each Type A Raised Pavement Markers  
Type C Raised Pavement Markers @ 40'-0" o.c.
- 4 each Type J Raised Pavement Markers  
Type D Raised Pavement Markers @ 40'-0" o.c.
- 8" White Stripe with Type C Raised Pavement Markers @ 20'-0" o.c. (Tape, Type I or Thermoplastic Extrusion)
- 4" Double Solid Yellow with Type D Raised Pavement Markers @ 20'-0" o.c. (Tape, Type I or Thermoplastic Extrusion)
- 4" Double Solid Yellow Stripes with Type H Raised Pavement Markers @ 20'-0" o.c. (Tape, Type II or Thermoplastic Extrusion)
- 4" Yellow Edge Stripe with Type H Raised Pavement Markers @ 40'-0" o.c. (Tape, Type II or Thermoplastic Extrusion)
- 4" Double Solid White Stripes with Type C Raised Pavement Markers @ 20'-0" o.c. (Tape, Type I or Thermoplastic Extrusion)
- Lane Change Restriction Marking  
4 each Type A Raised Pavement Markers  
Type C Raised Pavement Markers @ 20'-0" o.c.  
4" White Stripe (Tape, Type I or Thermoplastic Extrusion)
- 4" or 8" White Edge Stripe with Type C Raised Pavement Markers @ 40'-0" o.c. (Tape, Type II or Thermoplastic Extrusion)
- 4" White Guide Lines (Tape, Type III or Thermoplastic Extrusion except for bus bays)
- Transverse Median Marking (Tape, Type II or Thermoplastic Extrusion)
- Transverse Shoulder Marking (Tape, Type II or Thermoplastic Extrusion)
- Channelizing Island or Deceleration Lane Gore (Tape, Type II or Thermoplastic Extrusion)
- Crosswalk and Stop Line. All Stop Lines shall be 10'-0" from Crosswalk unless otherwise noted. The circled number indicates the number of lanes for payment (Tape, Type III or Thermoplastic Extrusion)
- Pavement Arrow (Tape, Type III or Thermoplastic Extrusion)
- Pavement Word (Tape, Type III or Thermoplastic Extrusion)
- 4 Each Type J Raised Pavement Markers  
Type D Raised Pavement Markers @ 40'-0" o.c.  
Type H Raised Pavement Markers (Reflective Surface facing no-passing direction)  
4" Single Solid Yellow Stripe (Tape, Type I or Thermoplastic Extrusion)
- Extension of Edge Line, 4" Wide x 2'-0" Long White Stripe @ 10'-0" o.c. w/Type C Markers @ 40'-0" o.c. (Tape, Type III or Thermoplastic Extrusion)

**NOTES**

1. Layout of pavement markings and striping shall be done by the Contractor and approved by the Engineer prior to any installation work.
2. Existing pavement markings not incorporated in the final traffic pattern shall be removed as directed by the Engineer. Costs shall be incidental to the various pavement marking items.
3. Raised pavement markers shall not be installed within crosswalks.
4. Final locations of all signs shall be approved by the Engineer prior to any installation work.
5. Existing signs not shown on these plans shall remain as posted unless otherwise directed by the Engineer. Removal and disposal of existing signs and/or posts as designated on these plans shall be incidental to the various signing items.
6. Final locations of all Stop Lines shall be approved by the Engineer prior to installation.
7. All pavement striping shall be as noted on the legend or plans.
8. All preformed pavement marking tapes over existing pavement shall be applied with an approved primer as recommended by the tape manufacturer and as approved by the Engineer. The primer shall be allowed to dry to the tacky stage prior to tape application.
9. Backing for all new signs shall not be spliced.
10. Final location of all sign posts installed within the sidewalk areas shall maintain a minimum clearance width of 36 inches from sidewalk edge to provide for wheelchair accessibility.
11. Removal of existing signs and posts shall not be paid for separately, but shall be considered incidental to various signing items.

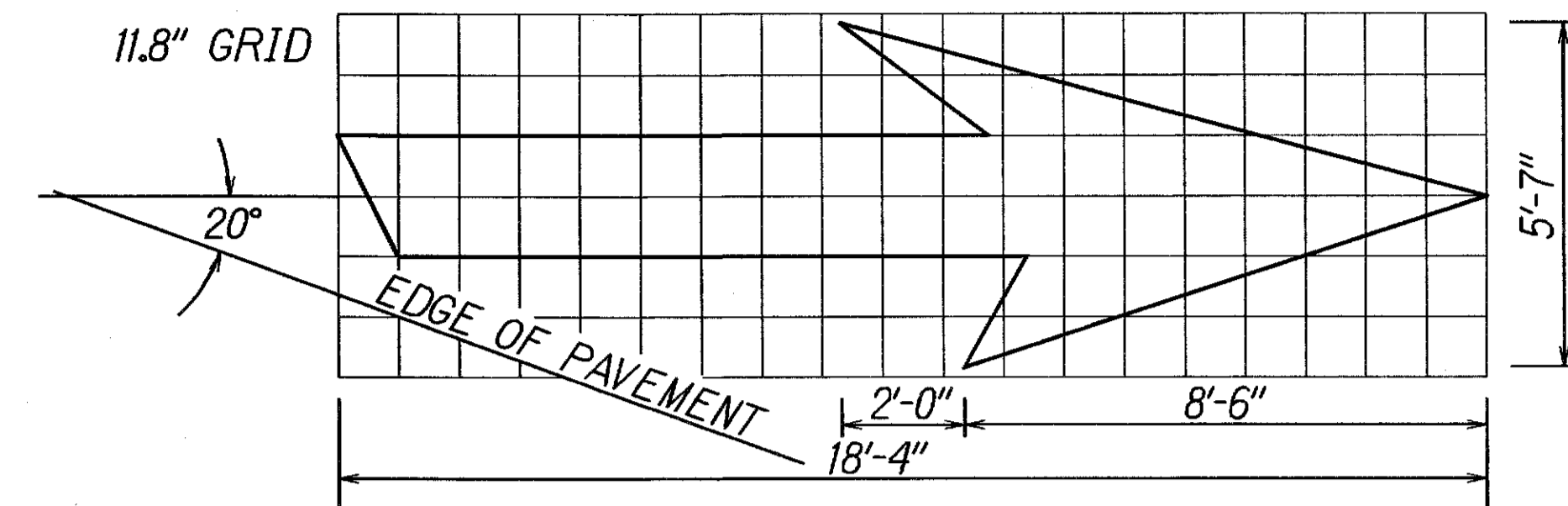

**TYPE VI ARROW**  
RIGHT LANE DROP ARROW  
(FOR LEFT LANE, USE MIRROR IMAGE)

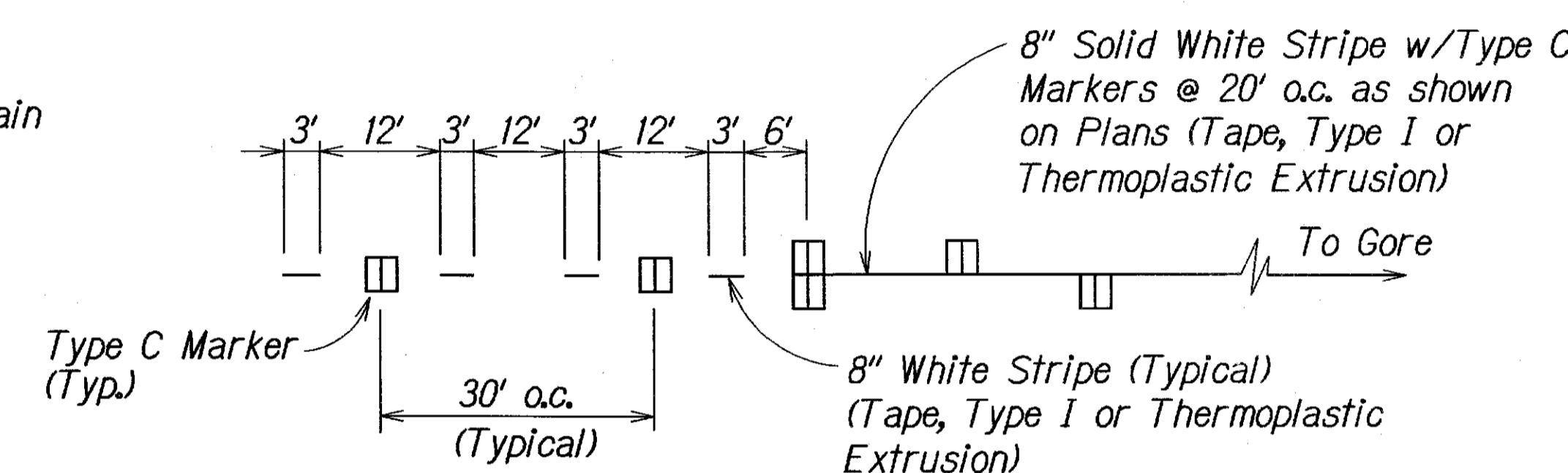

**LANE DROP MARKING**  
Not to Scale

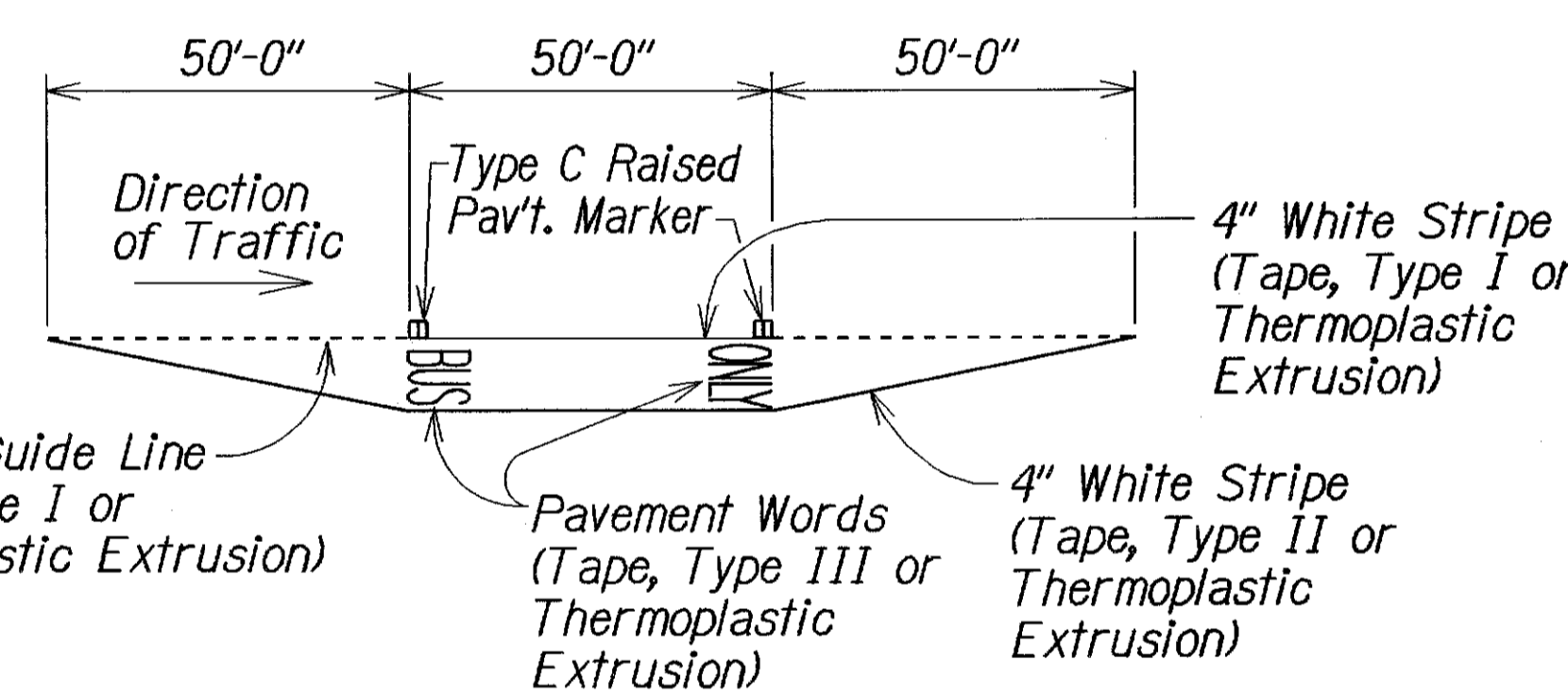

**TYPICAL BUS BAY STRIPING**  
Not to Scale

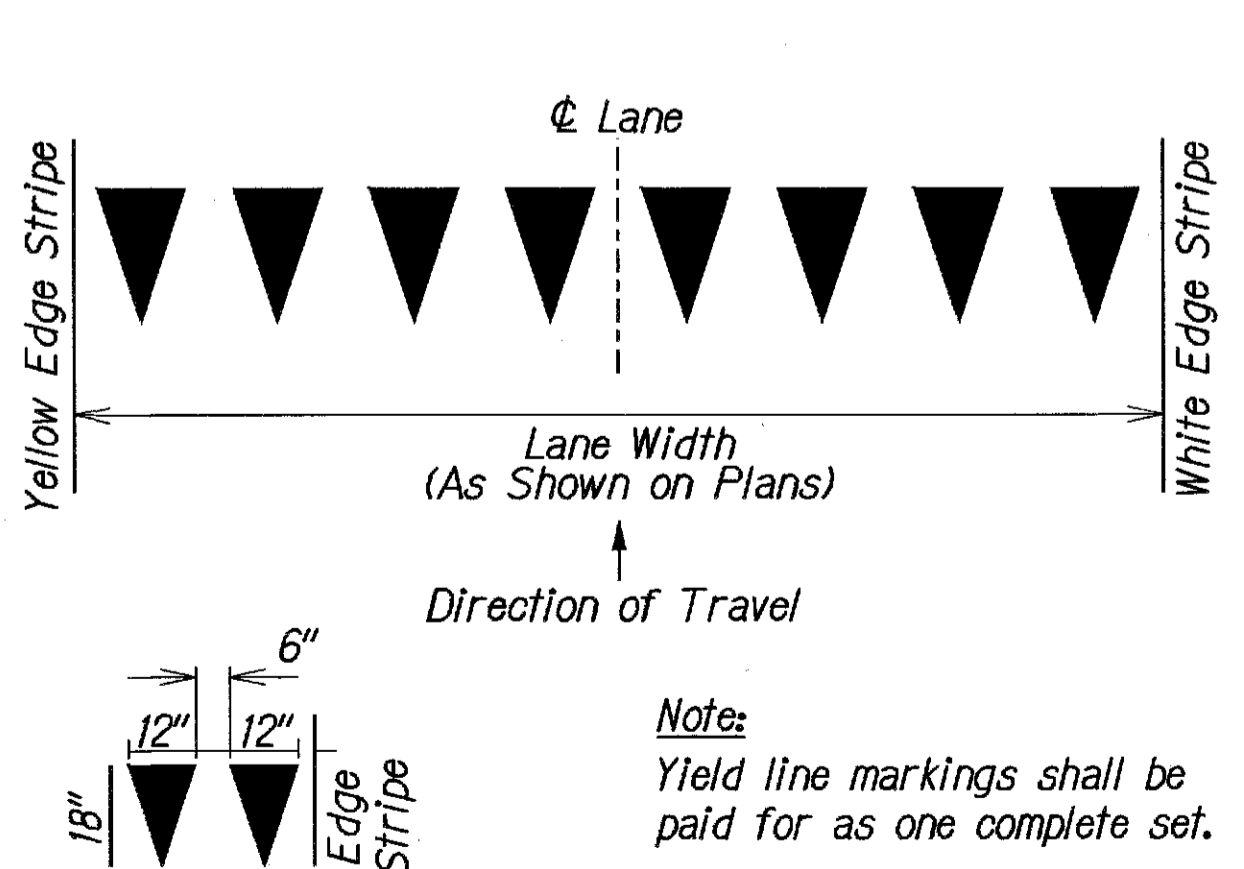

**YIELD LINE DETAIL**  
Not to Scale

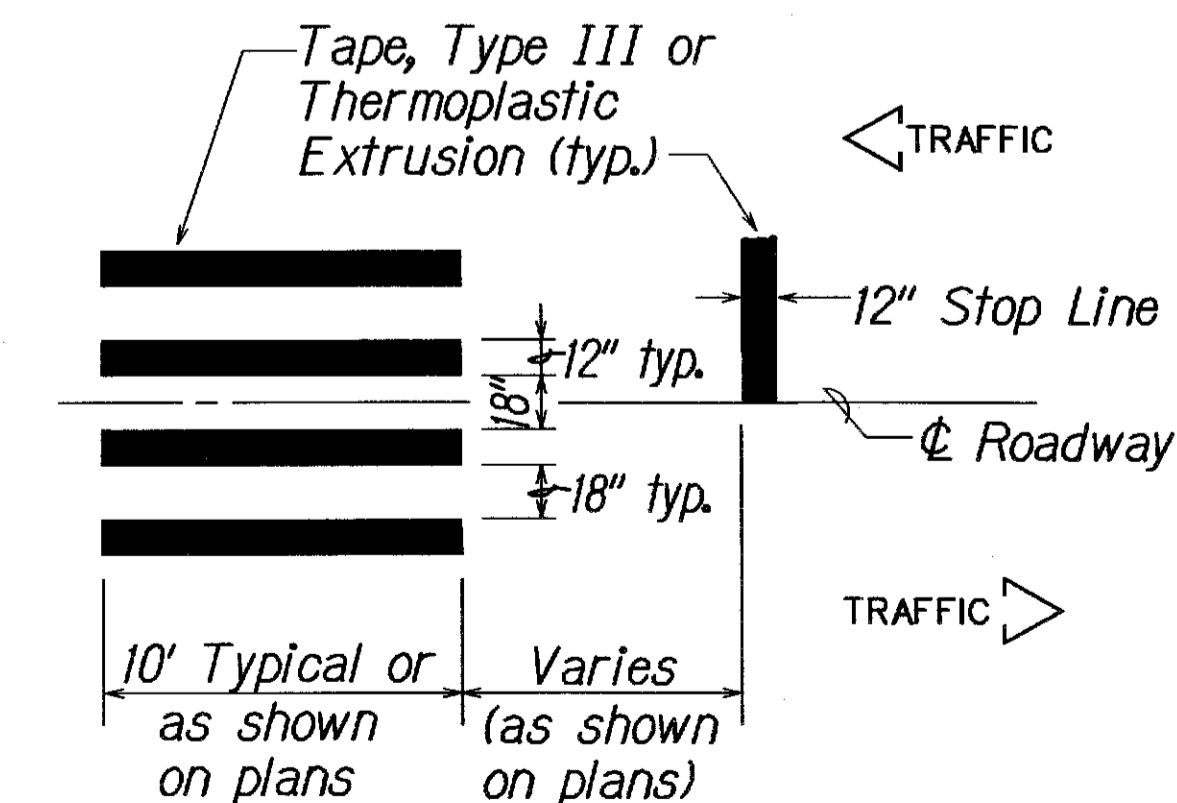

**DETAIL "A"**  
**CROSSWALK STRIPING DETAIL**  
Not to Scale

**SIGN LEGEND:**

- New Sign w/ New Post
- New Sign w/ Two New Posts
- Relocate Exist. Sign w/ Post
- Exist. Signs to Remain

SURVEY PLOTTED BY	DATE
DRAWN BY	
DESIGNED BY	
QUANTITIES BY	
CHECKED BY	
ORIGINAL PLAN	
NOTE BOOK	
DATE	

9/12/05	Revised Notes 9 - 11 and added pavement marking details.
DATE	REVISION
STATE OF HAWAII DEPARTMENT OF TRANSPORTATION HIGHWAYS DIVISION	
<b>PAVEMENT MARKING LEGEND</b> <b>DETAILS AND NOTES</b>	
FARRINGTON HIGHWAY REHABILITATION, VICINITY OF OLD FORT WEAVER ROAD TO KAMEHAMEHA HIGHWAY Project No. 7101A-01-04M	
Scale: As Shown	Date: Sept. 2005
SHEET No. 1 OF 10 SHEETS	

FED. ROAD DIST. NO.	STATE	PROJ. NO.	FISCAL YEAR	SHEET NO.	TOTAL SHEETS
HAWAII	HAW.	7101A-01-04M	2006	ADD. 51S-1	74

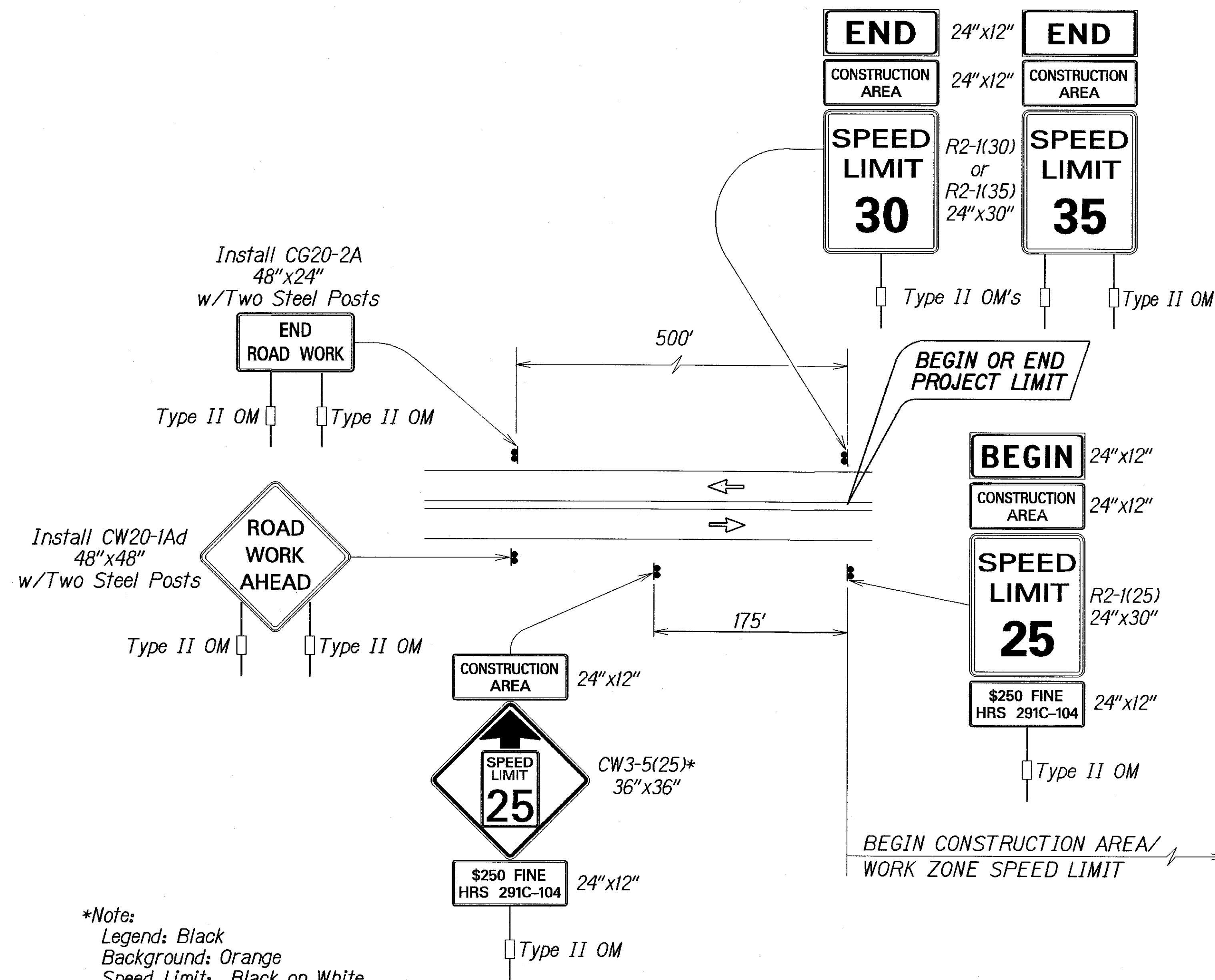

**Work Zone Notes:**

1. This Work Zone Sign Plan is intended for use on long-term stationary work zones/construction phases (3 days or more). All work zones or construction phases less than 3 days duration will use Traffic Control Plans shown in Section 645 of the Special Provisions.
2. All existing regulatory speed limit signs with posts within the work zone/project limits shall be removed and replaced with work zone speed limit sign assemblies (R2-1(35) and CW3-5(25) with "CONSTRUCTION AREA" and "\$250 FINE HRS 291C-104" Supplemental Signs).
3. Construction sign assemblies shall be installed on both the approaching and trailing ends of each work zone as shown on this plan.
4. Each construction warning sign shall have a minimum of two (2) Type II OM. Each work zone speed limit assembly shall have a minimum of one (1) Type II OM. Installation of each Type II OM shall be considered incidental to Item No. 645.0100, Traffic Control.
5. Upon the completion of all physical work or as directed by the Engineer, all construction signs and work zone speed limit assemblies shall be removed. All speed limit signs and posts that were existing at the start of the project within the work zone/project limits shall be restored back to their original locations and configurations.
6. Placement of construction signs shall not obstruct the path of pedestrians and bicyclists.
7. Furnishing of work zone speed limit assemblies shall be paid for under Item No. 645.0100, Traffic Control.
8. The removal and restoration of existing regulatory speed limit signs with new posts along with the installation, maintenance and removal of work zone speed limit sign assemblies shall be considered incidental to Item No. 645.0100, Traffic Control.

\*Note:  
Legend: Black  
Background: Orange  
Speed Limit: Black on White

**TYPICAL DETAIL FOR CONSTRUCTION SIGNS  
ON TWO LANE OR MULTILANE UNDIVIDED LOW SPEED HIGHWAY**

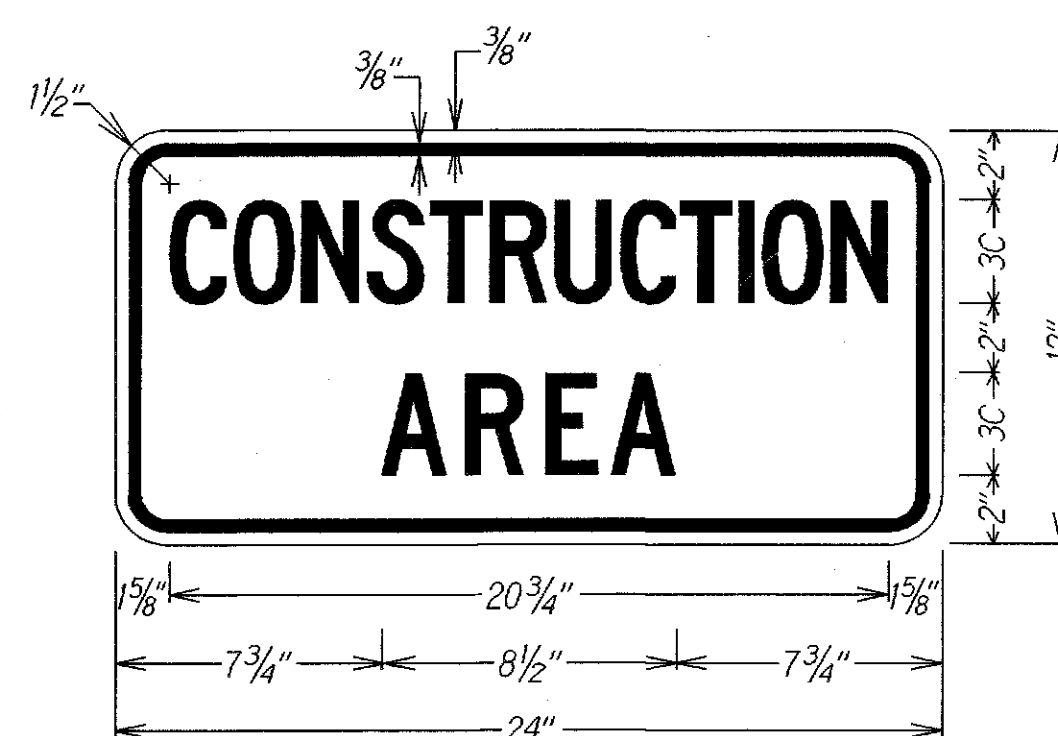

LEGEND: BLACK  
BACKGROUND: ORANGE

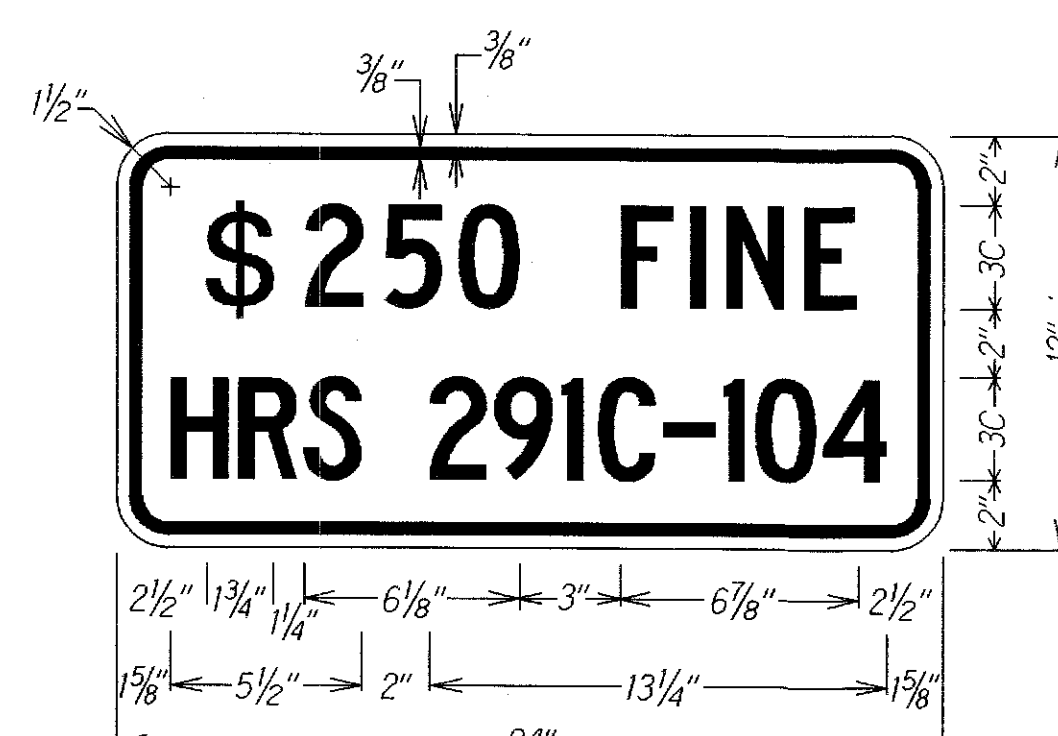

LEGEND: BLACK  
BACKGROUND: WHITE

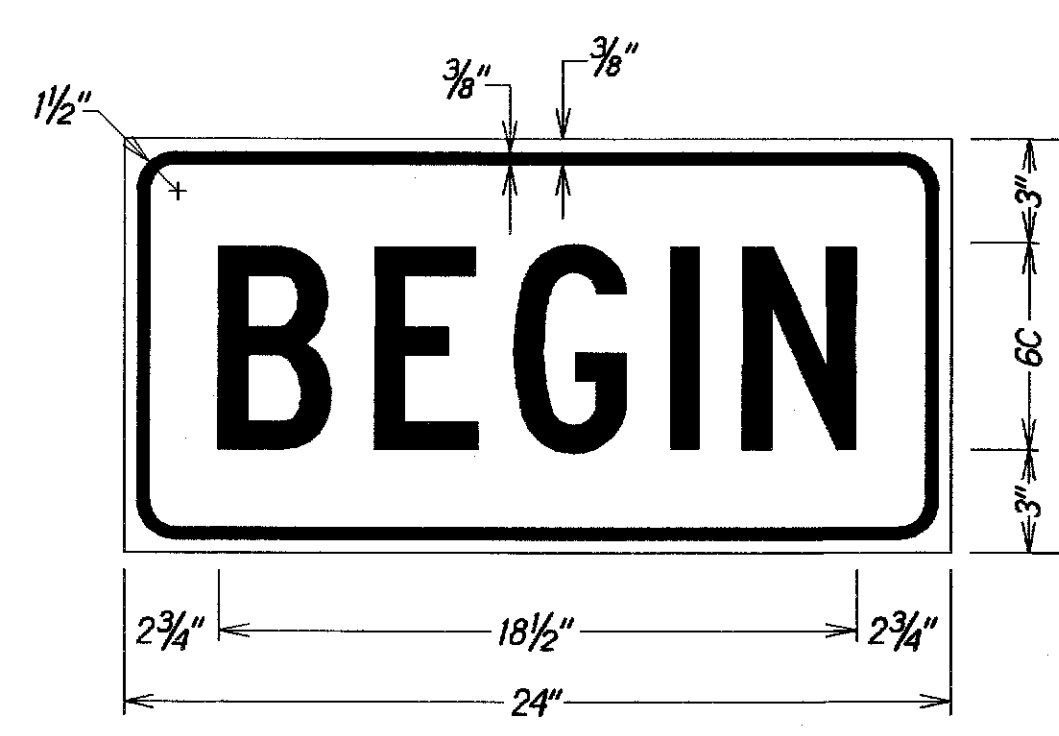

LEGEND: BLACK  
BACKGROUND: ORANGE

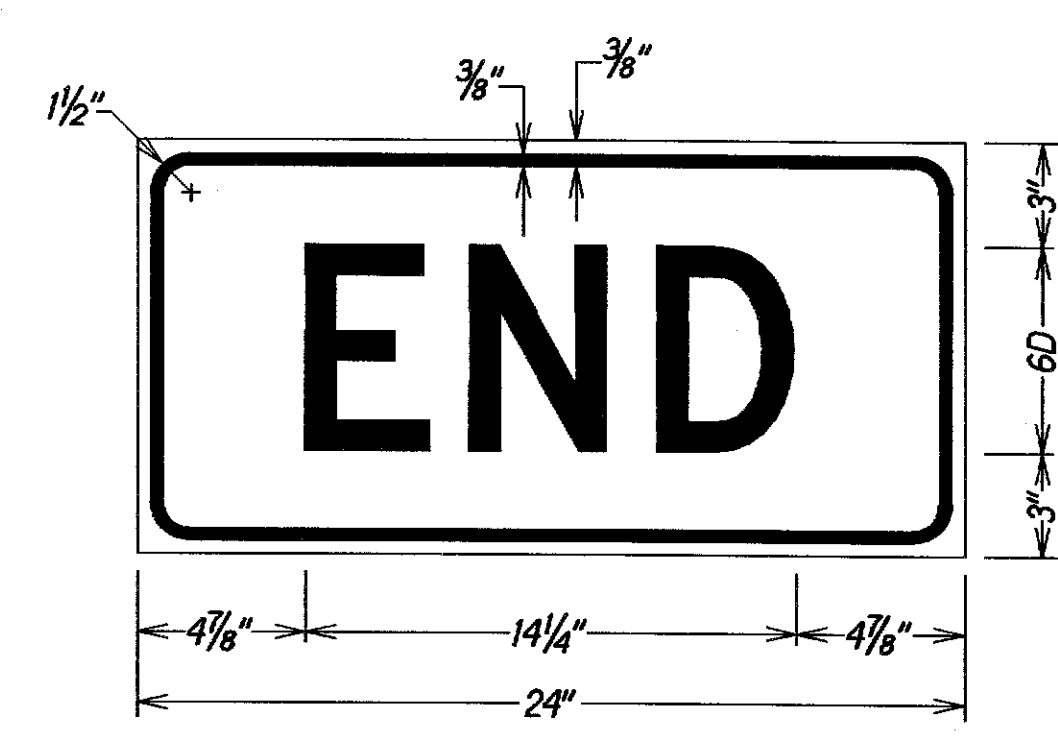

LEGEND: BLACK  
BACKGROUND: ORANGE

SURVEY PLOTTED BY	DATE
DRAWN BY	
DESIGNED BY	
QUANTITIES BY	
CHECKED BY	
ORIGINAL PLAN	
NOTE BOOK	
No. 12229	
STARTED	

9/12/05	Added this sheet to original contract plans.
DATE	REVISION
STATE OF HAWAII DEPARTMENT OF TRANSPORTATION HIGHWAYS DIVISION	
<b>LOW SPEED UNDIVIDED HIGHWAY WORK ZONE SIGNING PLAN, NOTES&amp;DETAILS</b>	
FARRINGTON HIGHWAY REHABILITATION, VICINITY OF OLD FORT WEAVER ROAD PROJECT NO. 7101A-01-04M	
Not To Scale	Date: Sept. 2005
SHEET No. 1 OF 10 SHEETS	

FED. ROAD DIST. NO.	STATE	PROJ. NO.	FISCAL YEAR	SHEET NO.	TOTAL SHEETS
HAWAII	HAW.	7101A-01-04M	2006	52	74

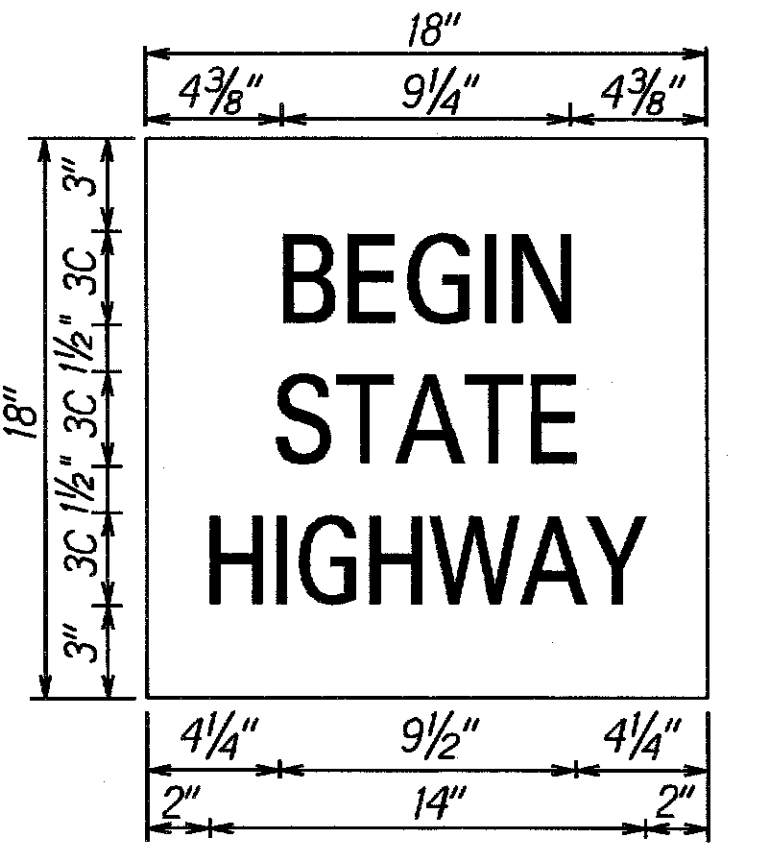
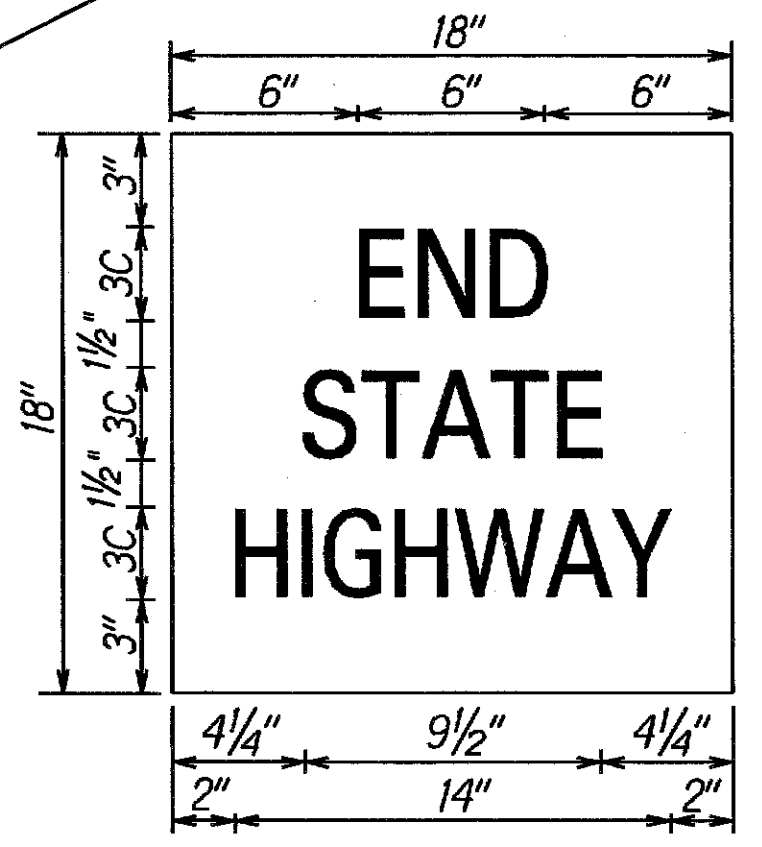
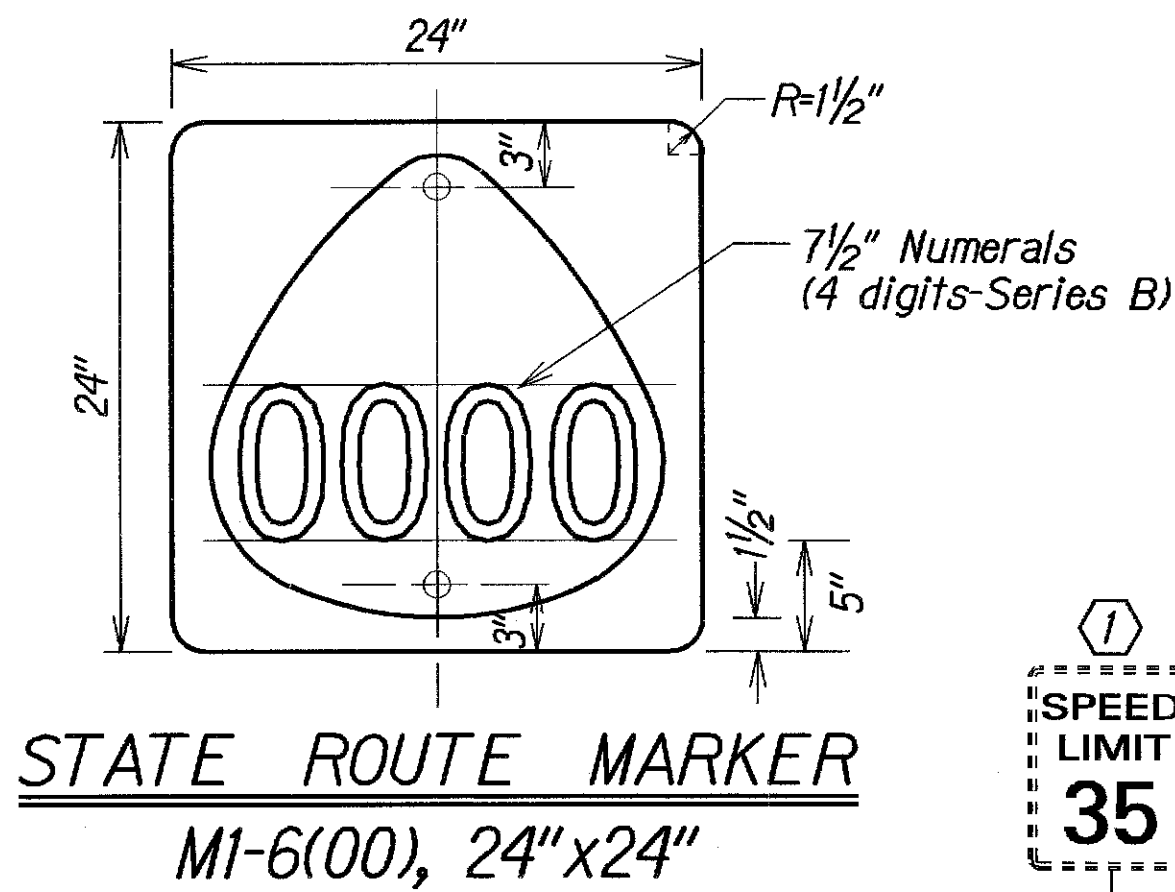
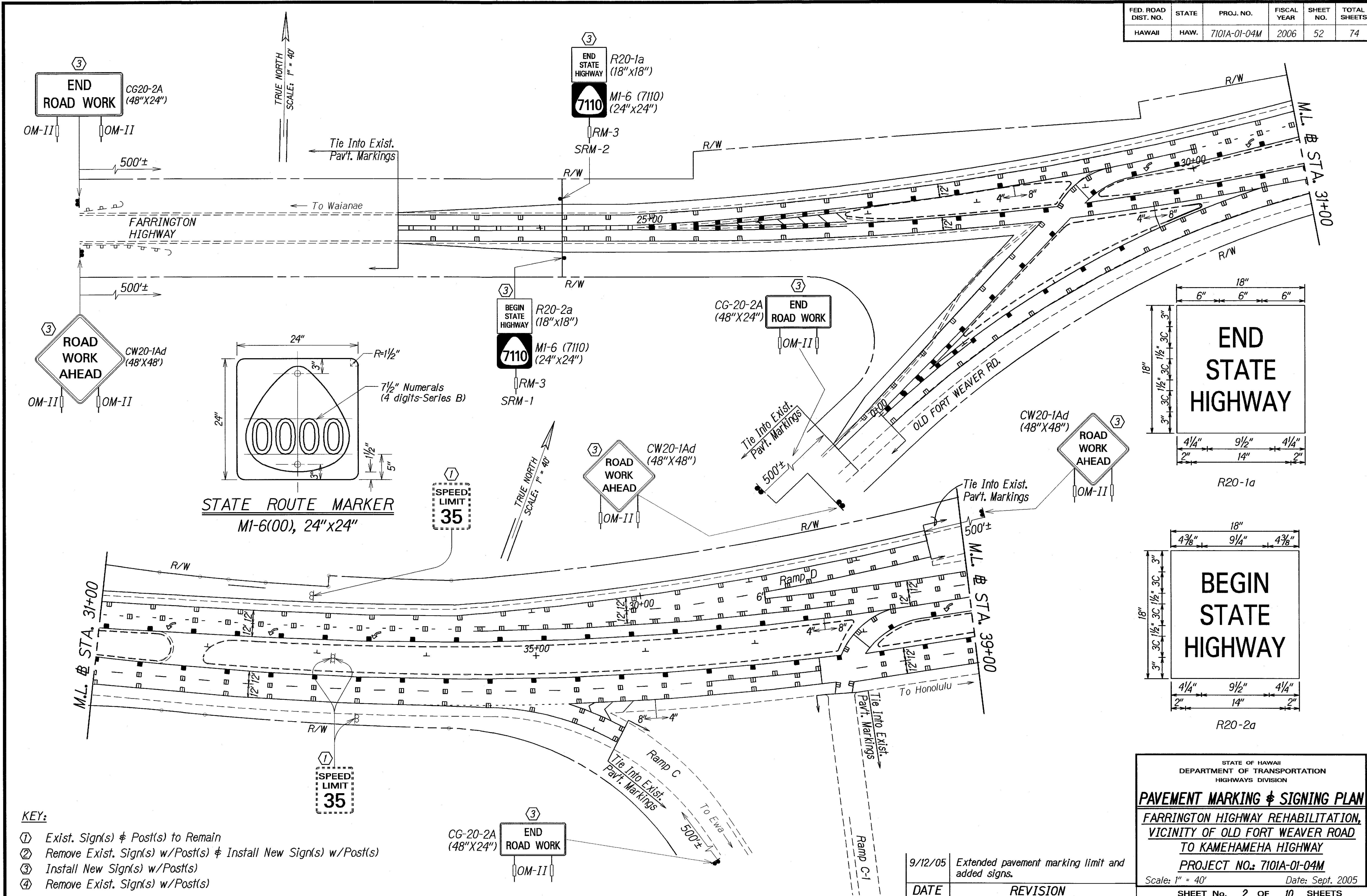

DATE	9/20/05
SURVEY PLOTTED BY	M. T. S. (C)
DRAWN BY	ERIK CHAN
NOTED BY	ERIK CHAN
QUANTITIES BY	ERIK CHAN
CHECKED BY	ERIK CHAN

- KEY:**
- ① Exist. Sign(s) & Post(s) to Remain
  - ② Remove Exist. Sign(s) w/Post(s) & Install New Sign(s) w/Post(s)
  - ③ Install New Sign(s) w/Post(s)
  - ④ Remove Exist. Sign(s) w/Post(s)

DATE	REVISION
9/12/05	Extended pavement marking limit and added signs.

STATE OF HAWAII  
DEPARTMENT OF TRANSPORTATION  
HIGHWAYS DIVISION

**PAVEMENT MARKING & SIGNING PLAN**

FARRINGTON HIGHWAY REHABILITATION,  
VICINITY OF OLD FORT WEAVER ROAD  
TO KAMEHAMEHA HIGHWAY

PROJECT NO.: 7101A-01-04M

Scale: 1" = 40' Date: Sept. 2005

SHEET No. 2 OF 10 SHEETS

FED. ROAD DIST. NO.	STATE	PROJ. NO.	FISCAL YEAR	SHEET NO.	TOTAL SHEETS
HAWAII	HAW.	7101A-01-04M	2006	53	74

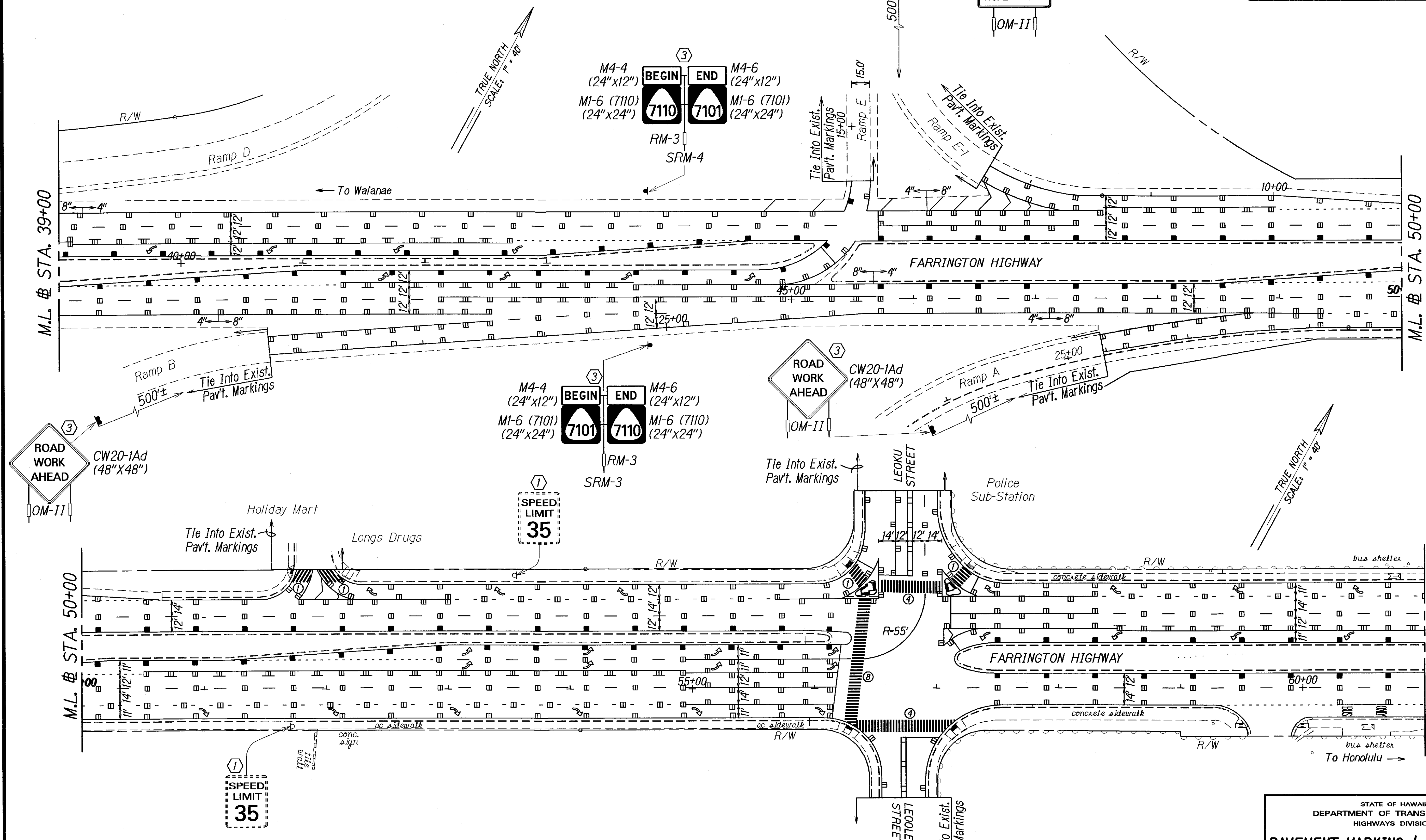

DATE	9/20/02
SURVEY PLOTTED BY	LEG/LL
DRAWN BY	M. T. B. CHAN
DESIGNED BY	FRANK CHAN
QUANTITIES BY	FRANK CHAN
CHECKED BY	FRANK CHAN

- KEY:**
- ① Exist. Sign(s) & Post(s) to Remain
  - ② Remove Exist. Sign(s) w/Post(s) & Install New Sign(s) w/Post(s)
  - ③ Install New Sign(s) w/Post(s)
  - ④ Remove Exist. Sign(s) w/Post(s)

DATE	REVISION
9/12/05	Added signs

STATE OF HAWAII  
DEPARTMENT OF TRANSPORTATION  
HIGHWAYS DIVISION

**PAVEMENT MARKING & SIGNING PLAN**  
FARRINGTON HIGHWAY REHABILITATION,  
VICINITY OF OLD FORT WEAVER ROAD  
TO KAMEHAMEHA HIGHWAY  
PROJECT NO.: 7101A-01-04M  
Scale: 1" = 40' Date: Sept. 2005  
SHEET No. 3 OF 10 SHEETS

FED. ROAD DIST. NO.	STATE	PROJ. NO.	FISCAL YEAR	SHEET NO.	TOTAL SHEETS
HAWAII	HAW.	7101A-01-04M	2006	C.O.ADD. 53S-1	74

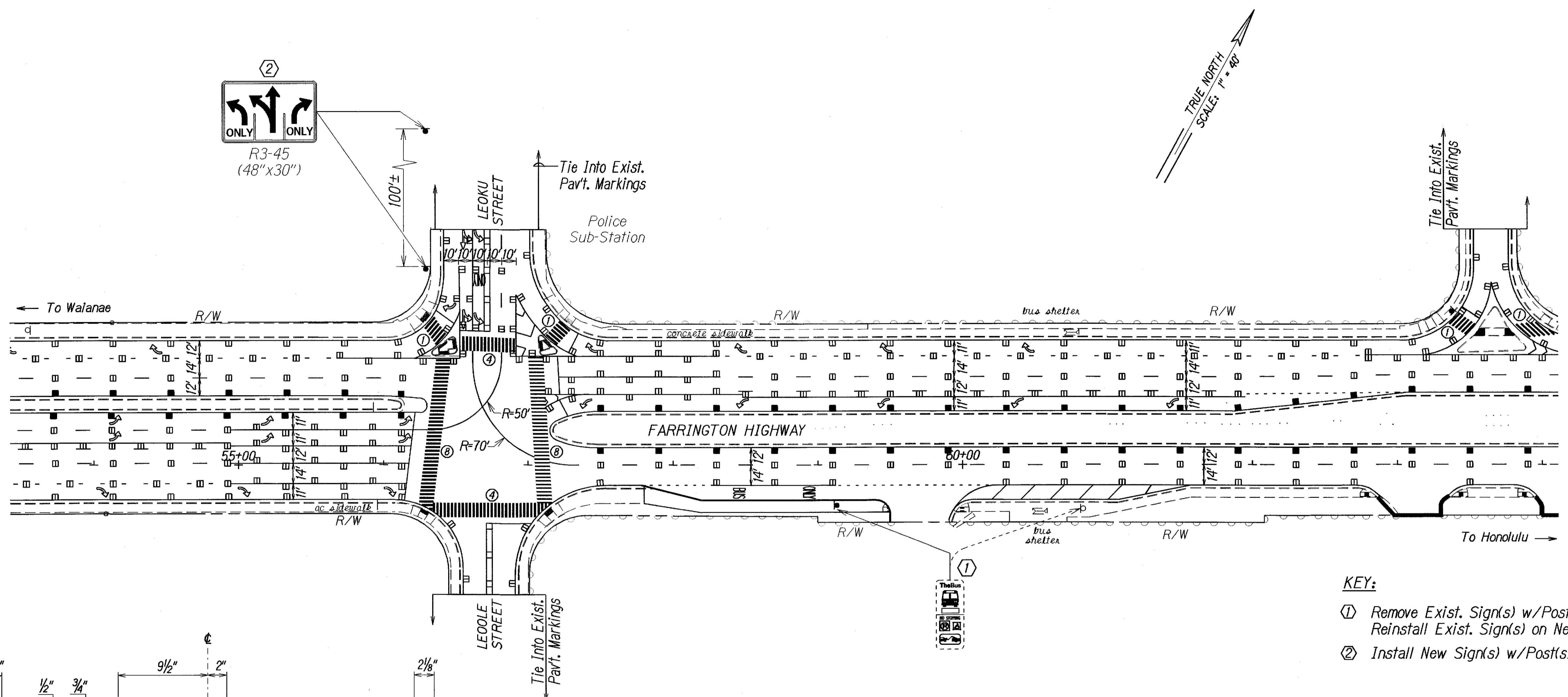

- KEY:**
- ① Remove Exist. Sign(s) w/Post(s) & Reinstall Exist. Sign(s) on New Post(s).
  - ② Install New Sign(s) w/Post(s)

- NOTES:**
1. Demolition and/or Relocation of existing bus shelter shall be done by others.
  2. The Contractor shall coordinate with Public Transit Div. DTS, City & County of Honolulu (phone no. 523-4582) regarding bus shelter relocation work.
  3. The Contractor shall notify the Oahu Transit Services (phone no. 848-4571 or 848-4578) two weeks prior to relocation of bus stop sign(s).

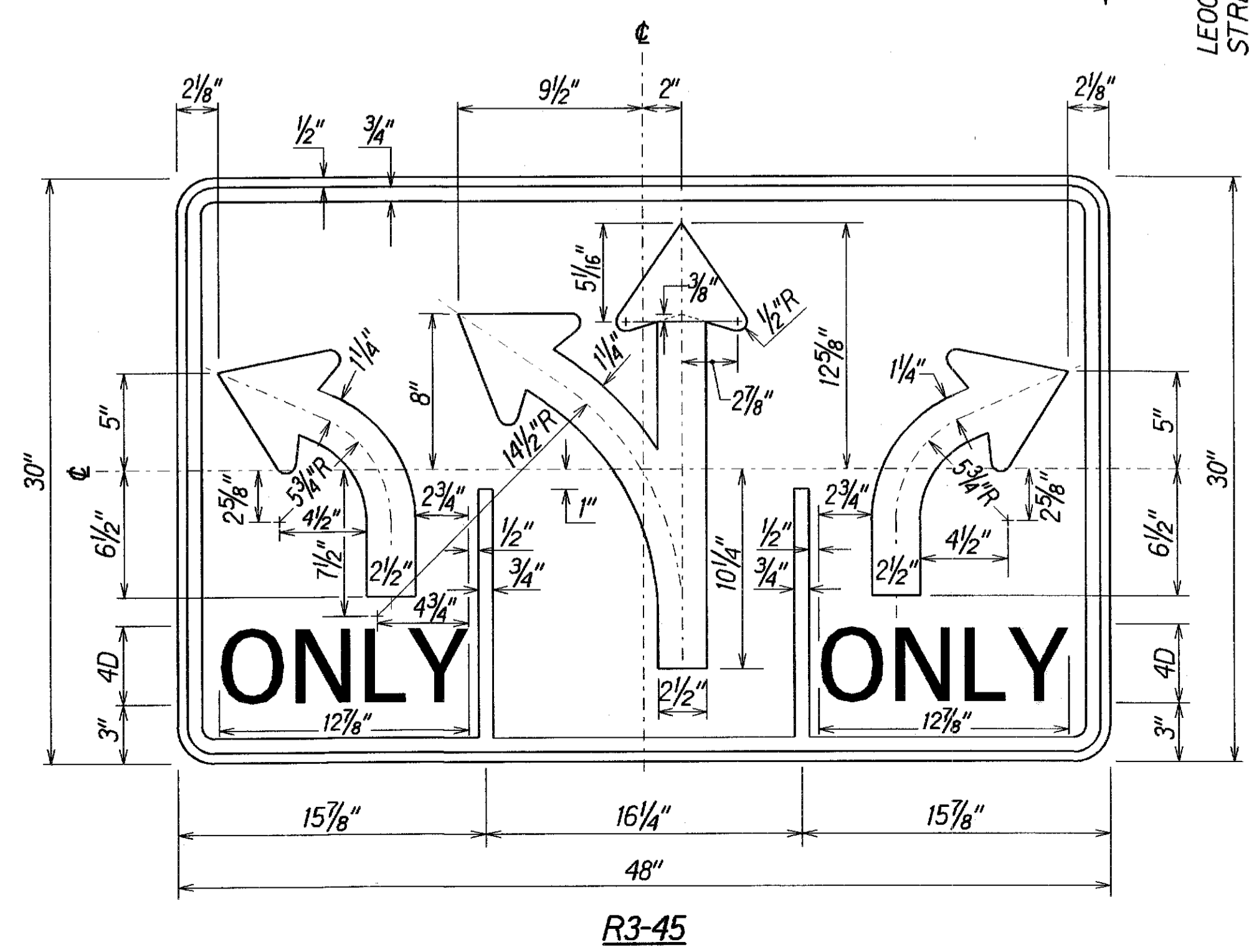

ORIGINAL PLAN	SURVEY PLOTTED BY	DATE
NOTE BOOK	DESIGNED BY	9/26/06
NO. 102-009	QUANTITIES BY	9/20/06
8/19/02.C0001.S	CHECKED BY	

9/27/06	This sheet added to contract plans. Revised intersection & bus pullout striping.
DATE	REVISION

STATE OF HAWAII  
DEPARTMENT OF TRANSPORTATION  
HIGHWAYS DIVISION

**PAVEMENT MARKING & SIGNING PLAN**

**FARRINGTON HIGHWAY REHABILITATION,  
VICINITY OF OLD FORT WEAVER ROAD  
TO KAMEHAMEHA HIGHWAY**

**PROJECT NO.: 7101A-01-04M**

Scale: 1" = 40'      Date: Sept. 2006

SHEET No. 3A OF 10 SHEETS

FED. ROAD DIST. NO.	STATE	PROJ. NO.	FISCAL YEAR	SHEET NO.	TOTAL SHEETS
HAWAII	HAW.	7101A-01-04M	2006	54	74

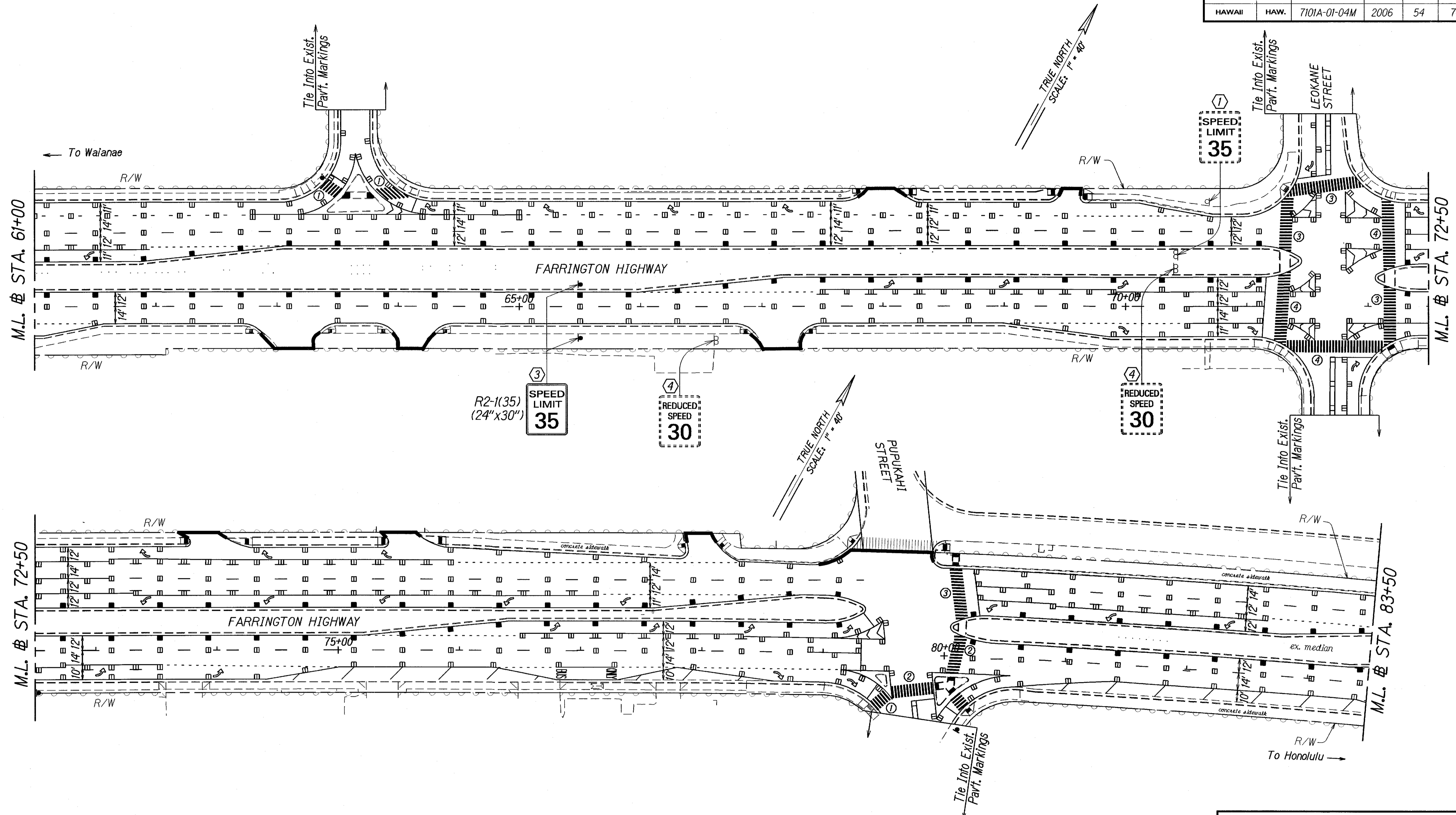

ORIGINAL PLAN	DATE
SURVEY PLOTTED BY	9/20/05
DRAWN BY	M. T. BERG
NOTE BOOK	9/20/05
DESIGNED BY	FRANK CHAN
QUANTITIES BY	
CHECKED BY	

**KEY:**

- ① Exist. Sign(s) & Post(s) to Remain
- ② Remove Exist. Sign(s) w/Post(s) & Install New Sign(s) w/Post(s)
- ③ Install New Sign(s) w/Post(s)
- ④ Remove Exist. Sign(s) w/Post(s)

DATE	REVISION
9/12/05	Added signs.

STATE OF HAWAII  
DEPARTMENT OF TRANSPORTATION  
HIGHWAYS DIVISION

**PAVEMENT MARKING & SIGNING PLAN**  
**FARRINGTON HIGHWAY REHABILITATION,**  
**VICINITY OF OLD FORT WEAVER ROAD**  
**TO KAMEHAMEHA HIGHWAY**  
**PROJECT NO.: 7101A-01-04M**  
Scale: 1" = 40' Date: Sept. 2005  
SHEET No. 4 OF 10 SHEETS

FED. ROAD DIST. NO.	STATE	PROJ. NO.	FISCAL YEAR	SHEET NO.	TOTAL SHEETS
HAWAII	HAW.	7101A-01-04M	2006	55	74

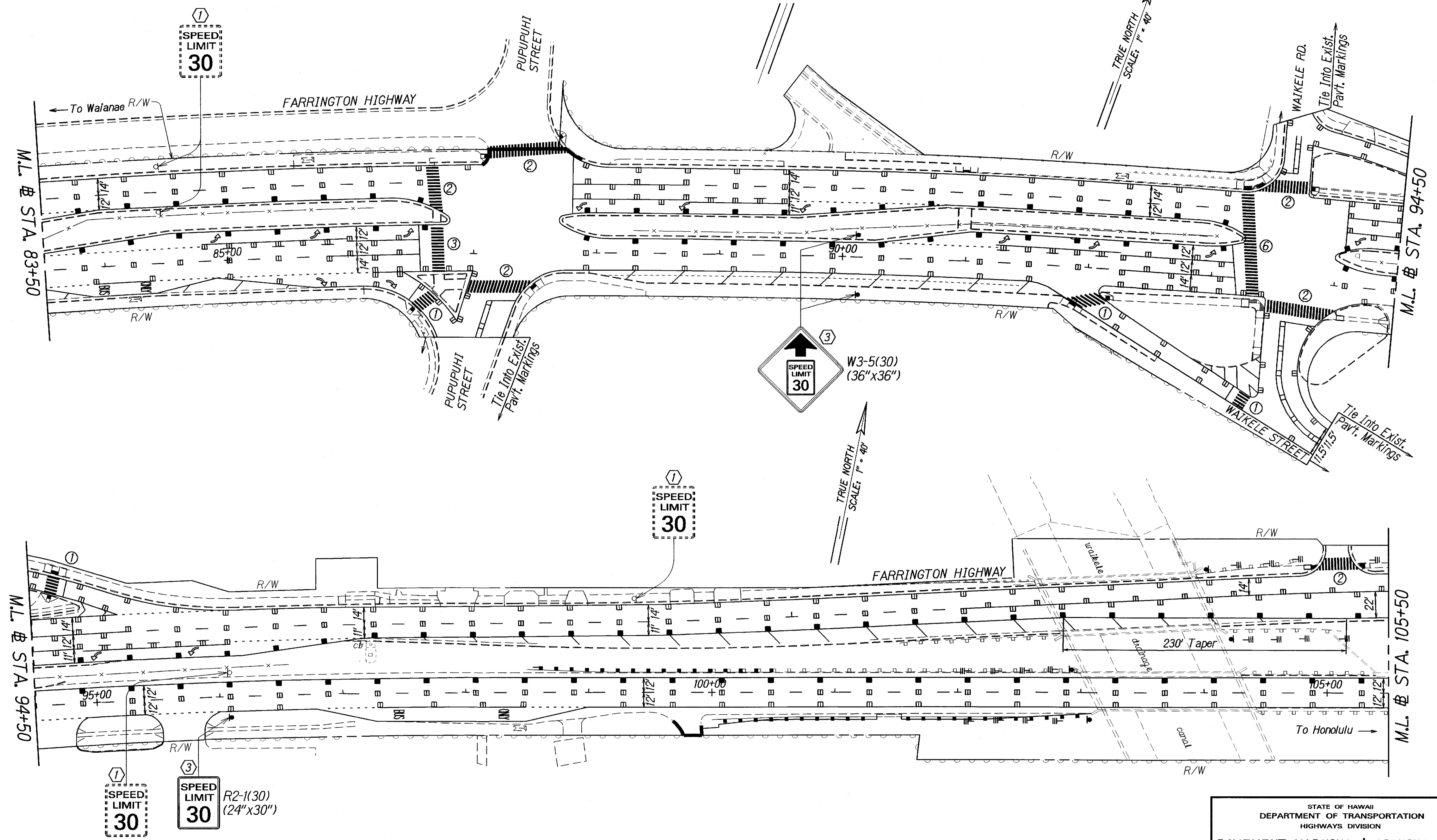

DATE	9/20/02
DESIGNED BY	ENG. CHAN
QUANTITIES BY	SAITOH/001
CHECKED BY	
ORIGINAL PLAN	
NOTE BOOK	

- KEY:**
- ① Exist. Sign(s) & Post(s) to Remain
  - ② Remove Exist. Sign(s) w/Post(s) & Install New Sign(s) w/Post(s)
  - ③ Install New Sign(s) w/Post(s)
  - ④ Remove Exist. Sign(s) w/Post(s)

DATE	REVISION
9/12/05	Revised pavement marking and added signs.

STATE OF HAWAII  
DEPARTMENT OF TRANSPORTATION  
HIGHWAYS DIVISION

**PAVEMENT MARKING & SIGNING PLAN**  
**FARRINGTON HIGHWAY REHABILITATION,**  
**VICINITY OF OLD FORT WEAVER ROAD**  
**TO KAMEHAMEHA HIGHWAY**  
**PROJECT NO.: 7101A-01-04M**  
Scale: 1" = 40' Date: Sept. 2005  
SHEET No. 5 OF 10 SHEETS

FED. ROAD DIST. NO.	STATE	PROJ. NO.	FISCAL YEAR	SHEET NO.	TOTAL SHEETS
HAWAII	HAW.	7101A-01-04M	2006	56	74

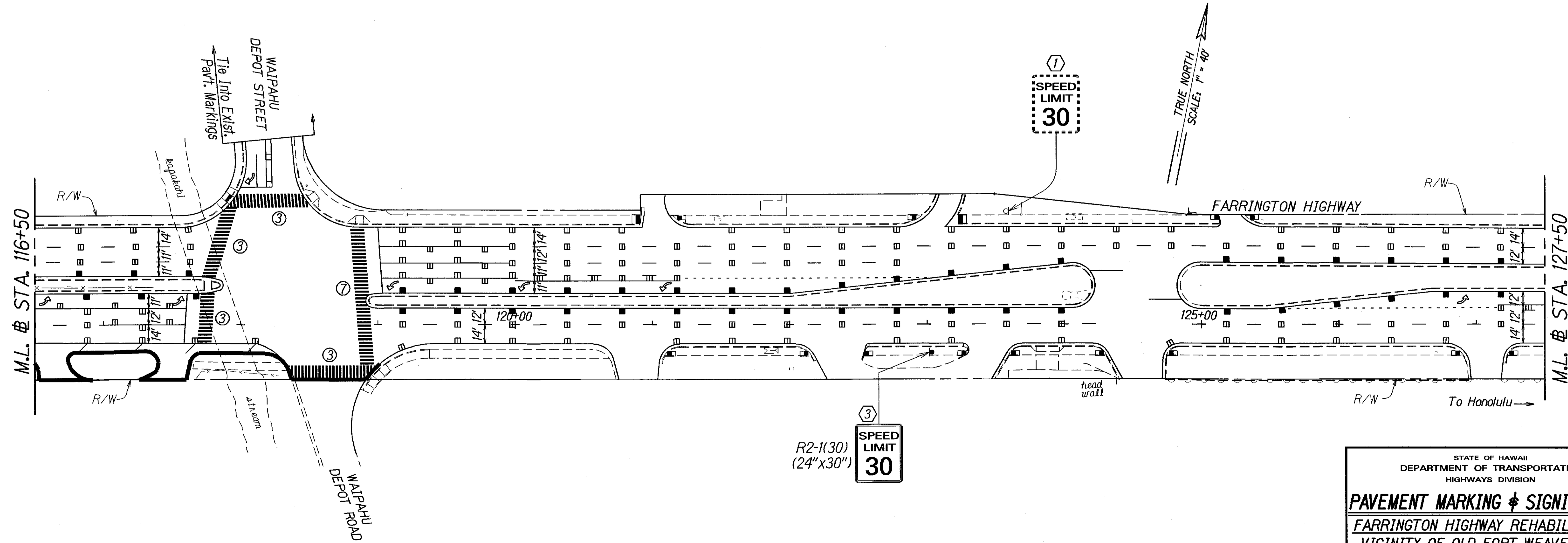
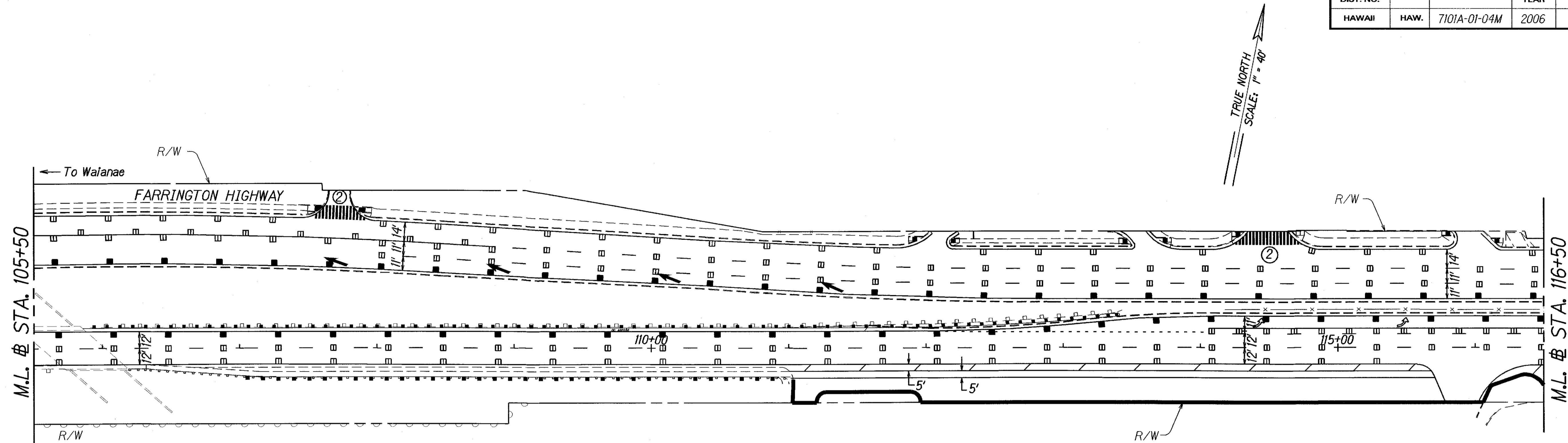

DATE	9/20/05
DESIGNED BY	ERIK CHOI
CHECKED BY	SEAN O'NEILL
DATE	9/20/05
DESIGNED BY	ERIK CHOI
CHECKED BY	SEAN O'NEILL

- KEY:**
- ① Exist. Sign(s) & Post(s) to Remain
  - ② Remove Exist. Sign(s) w/Post(s) & Install New Sign(s) w/Post(s)
  - ③ Install New Sign(s) w/Post(s)
  - ④ Remove Exist. Sign(s) w/Post(s)

R2-1(30)  
(24" x 30")  
**SPEED LIMIT 30**

①  
**SPEED LIMIT 30**

9/12/05 Added signs.

DATE REVISION

STATE OF HAWAII  
DEPARTMENT OF TRANSPORTATION  
HIGHWAYS DIVISION

**PAVEMENT MARKING & SIGNING PLAN**  
FARRINGTON HIGHWAY REHABILITATION,  
VICINITY OF OLD FORT WEAVER ROAD  
TO KAMEHAMEHA HIGHWAY  
PROJECT NO.: 7101A-01-04M  
Scale: 1" = 40' Date: Sept. 2005  
SHEET No. 6 OF 10 SHEETS

**ADD. 56**

FED. ROAD DIST. NO.	STATE	PROJ. NO.	FISCAL YEAR	SHEET NO.	TOTAL SHEETS
HAWAII	HAW.	7101A-01-04M	2006	57	74

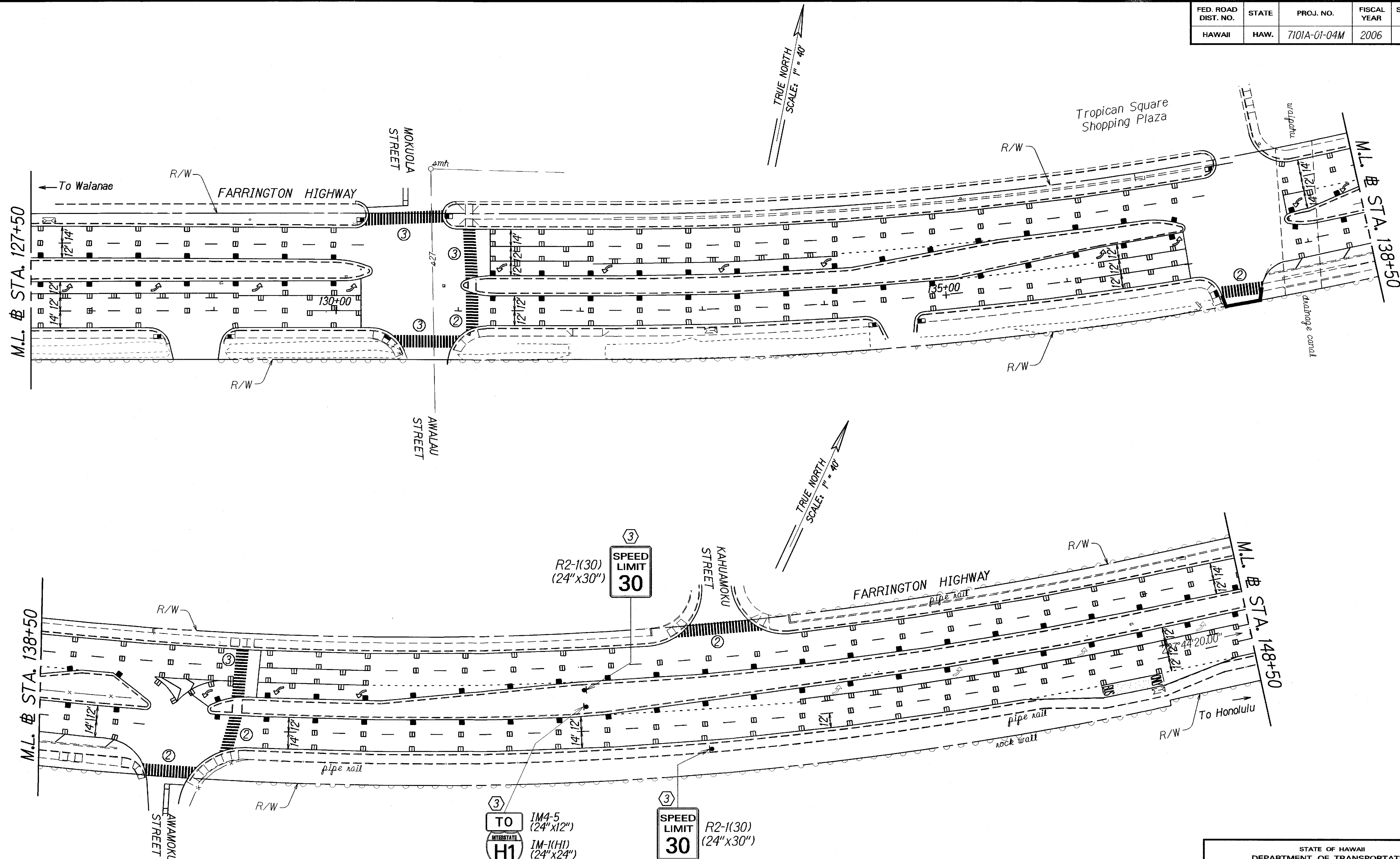

DATE	9/20/02
SURVEY PROVIDED BY	M. LEBEAU
DRAWN BY	F. CHAN
DESIGNED BY	F. CHAN
CHECKED BY	F. CHAN
ORIGINAL PLAN	
NOTE BOOK	
QUANTITIES BY	
CHECKED BY	

- KEY:**
- ① Exist. Sign(s) & Post(s) to Remain
  - ② Remove Exist. Sign(s) w/Post(s) & Install New Sign(s) w/Post(s)
  - ③ Install New Sign(s) w/Post(s)
  - ④ Remove Exist. Sign(s) w/Post(s)

- ③ TO INTERSTATE H1 ← IM4-5 (24"x12")
- IM-1(H) (24"x24")
- IM6-1(L) (21"x15")
- IRM-3
- IRM-1
- ③ SPEED LIMIT 30 R2-1(30) (24"x30")

DATE	REVISION
9/12/05	Added signs.

STATE OF HAWAII  
DEPARTMENT OF TRANSPORTATION  
HIGHWAYS DIVISION

**PAVEMENT MARKING & SIGNING PLAN**  
**FARRINGTON HIGHWAY REHABILITATION,**  
**VICINITY OF OLD FORT WEAVER ROAD**  
**TO KAMEHAMEHA HIGHWAY**  
**PROJECT NO.: 7101A-01-04M**  
Scale: 1" = 40' Date: Sept. 2005  
SHEET No. 7 OF 10 SHEETS

FED. ROAD DIST. NO.	STATE	PROJ. NO.	FISCAL YEAR	SHEET NO.	TOTAL SHEETS
HAWAII	HAW.	7101A-01-04M	2006	58	74

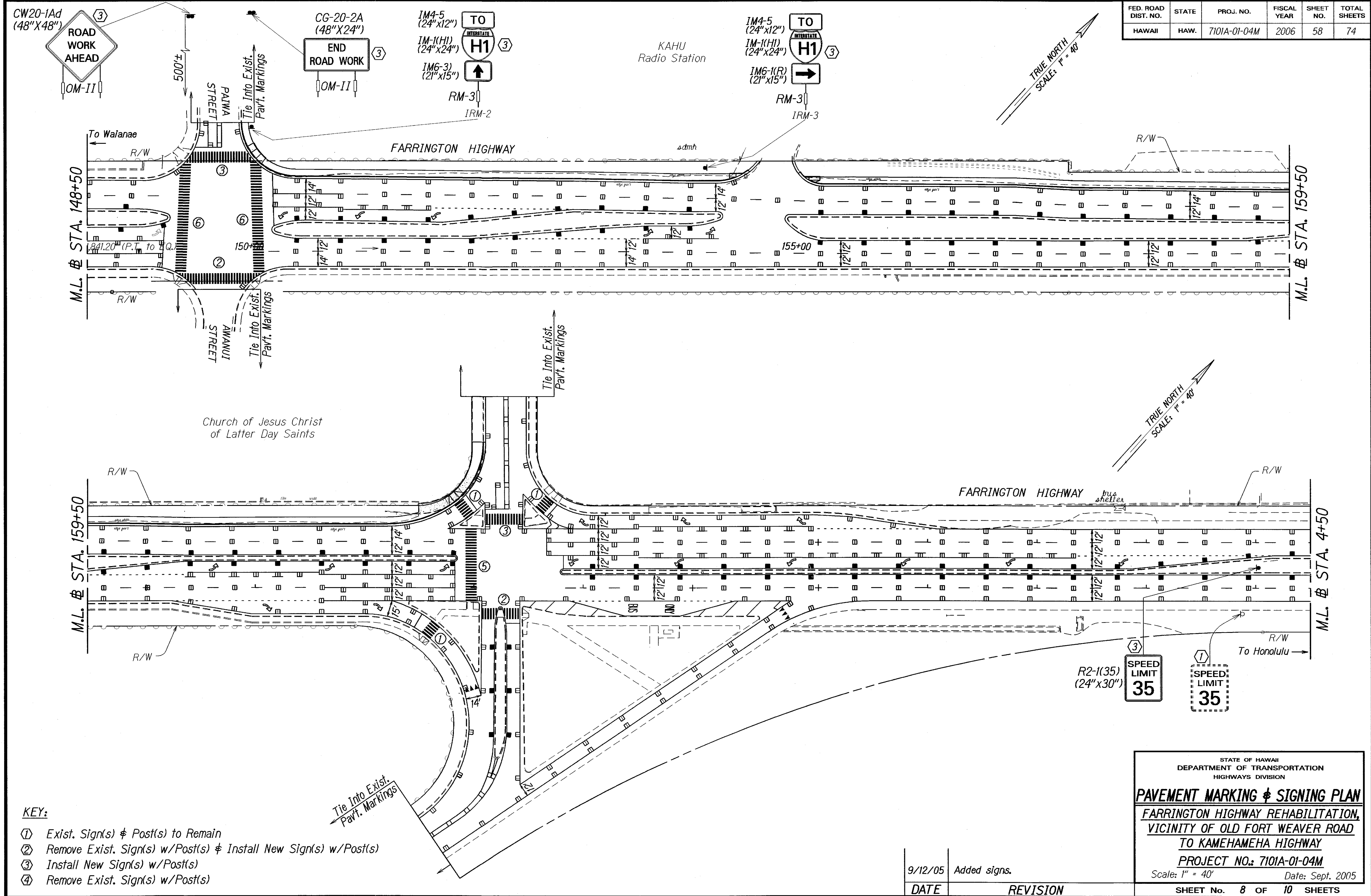

ORIGINAL PLAN	DATE
NOTED BY	9/20/05
DESIGNED BY	9/20/05
QUANTITIES BY	
CHECKED BY	

- KEY:**
- ① Exist. Sign(s) & Post(s) to Remain
  - ② Remove Exist. Sign(s) w/Post(s) & Install New Sign(s) w/Post(s)
  - ③ Install New Sign(s) w/Post(s)
  - ④ Remove Exist. Sign(s) w/Post(s)

DATE	REVISION
9/12/05	Added signs.

STATE OF HAWAII  
DEPARTMENT OF TRANSPORTATION  
HIGHWAYS DIVISION

**PAVEMENT MARKING & SIGNING PLAN**  
**FARRINGTON HIGHWAY REHABILITATION,**  
**VICINITY OF OLD FORT WEAVER ROAD**  
**TO KAMEHAMEHA HIGHWAY**  
**PROJECT NO.: 7101A-01-04M**  
Scale: 1" = 40' Date: Sept. 2005  
SHEET No. 8 OF 10 SHEETS

FED. ROAD DIST. NO.	STATE	PROJ. NO.	FISCAL YEAR	SHEET NO.	TOTAL SHEETS
HAWAII	HAW.	7101A-01-04M	2006	59	74

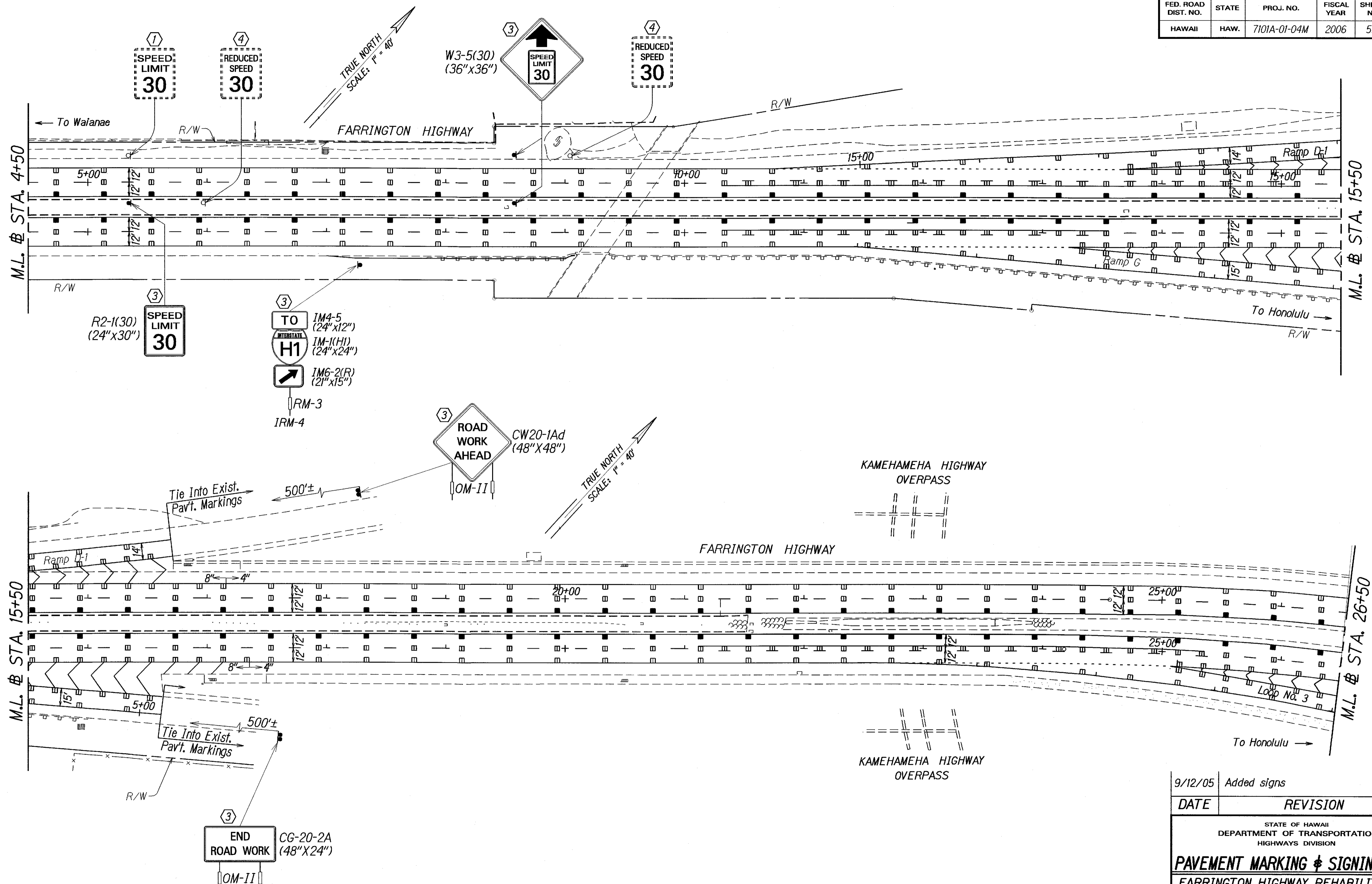

DATE	9/20/05
DESIGNED BY	PAUL CHAN
CHECKED BY	...
...	...

- KEY:**
- ① Exist. Sign(s) & Post(s) to Remain
  - ② Remove Exist. Sign(s) w/Post(s) & Install New Sign(s) w/Post(s)
  - ③ Install New Sign(s) w/Post(s)
  - ④ Remove Exist. Sign(s) w/Post(s)

9/12/05	Added signs
DATE	REVISION
STATE OF HAWAII DEPARTMENT OF TRANSPORTATION HIGHWAYS DIVISION	
<b>PAVEMENT MARKING &amp; SIGNING PLAN</b>	
FARRINGTON HIGHWAY REHABILITATION, VICINITY OF OLD FORT WEAVER ROAD TO KAMEHAMEHA HIGHWAY	
PROJECT NO.: 7101A-01-04M	
Scale: 1" = 40'	Date: Sept. 2005
SHEET No. 9 OF 10 SHEETS	

FED. ROAD DIST. NO.	STATE	PROJ. NO.	FISCAL YEAR	SHEET NO.	TOTAL SHEETS
HAWAII	HAW.	7101A-01-04M	2005	C.O.32	74

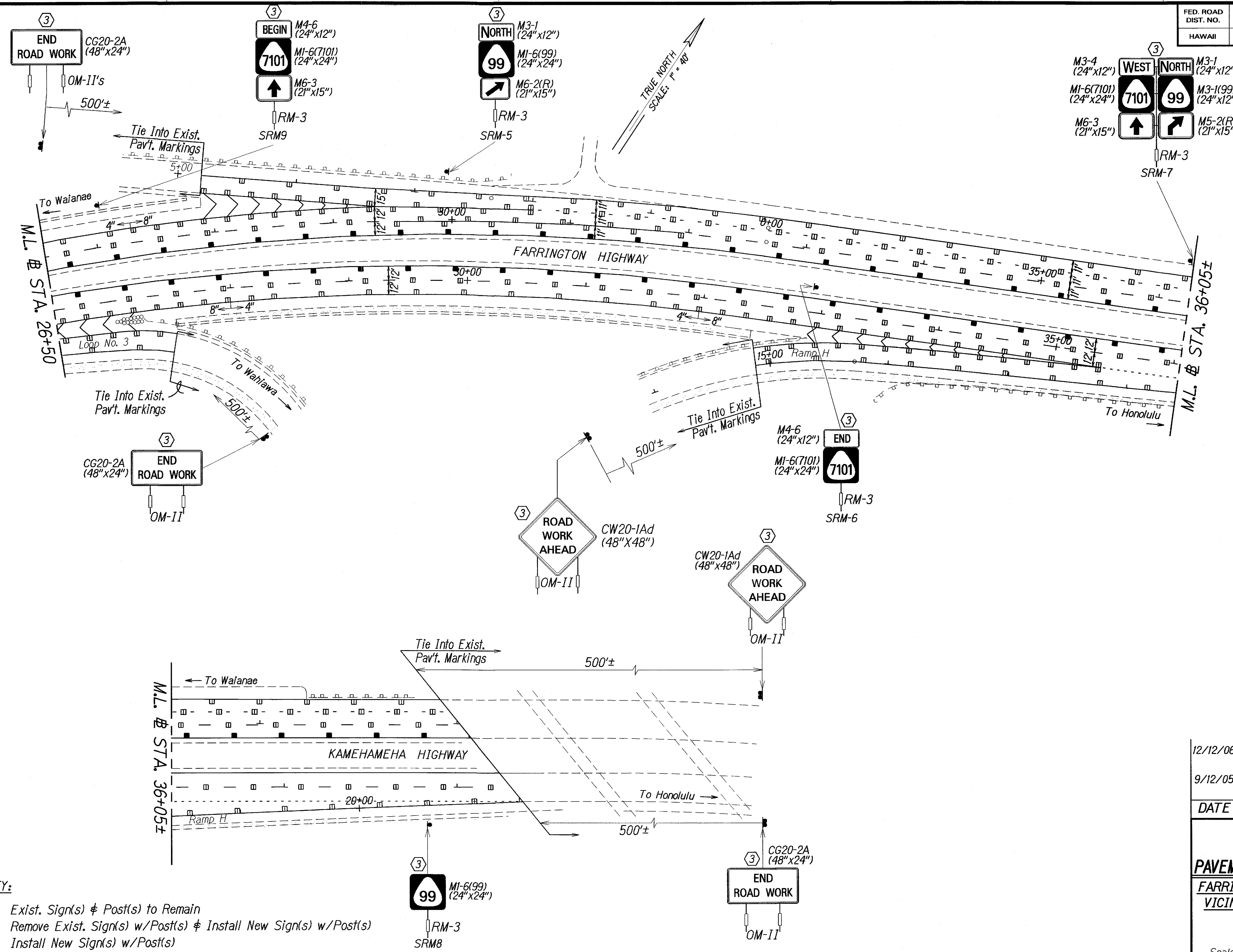

ORIGINAL	DATE
REVISED	12/12/06
DESIGNED BY	F. Chien
CHECKED BY	

- KEY:**
- ① Exist. Sign(s) & Post(s) to Remain
  - ② Remove Exist. Sign(s) w/Post(s) & Install New Sign(s) w/Post(s)
  - ③ Install New Sign(s) w/Post(s)
  - ④ Remove Exist. Sign(s) w/Post(s)

DATE	REVISION
12/12/06	Extend project limits, revised signs & location
9/12/05	Revised pavement markings and added signs

STATE OF HAWAII  
DEPARTMENT OF TRANSPORTATION  
HIGHWAYS DIVISION

**PAVEMENT MARKING & SIGNING PLAN**  
**FARRINGTON HIGHWAY REHABILITATION,**  
**VICINITY OF OLD FORT WEAVER ROAD**  
**TO KAMEHAMEHA HIGHWAY**  
**PROJECT NO.: 7101A-01-04M**  
Scale: 1" = 40' Date: October, 2004  
SHEET No. 10 OF 10 SHEETS