

FED. ROAD DIST. NO.	STATE	PROJ. NO.	FISCAL YEAR	SHEET NO.	TOTAL SHEETS
HAWAII	HAW.	7101A-01-98	2002	46	80

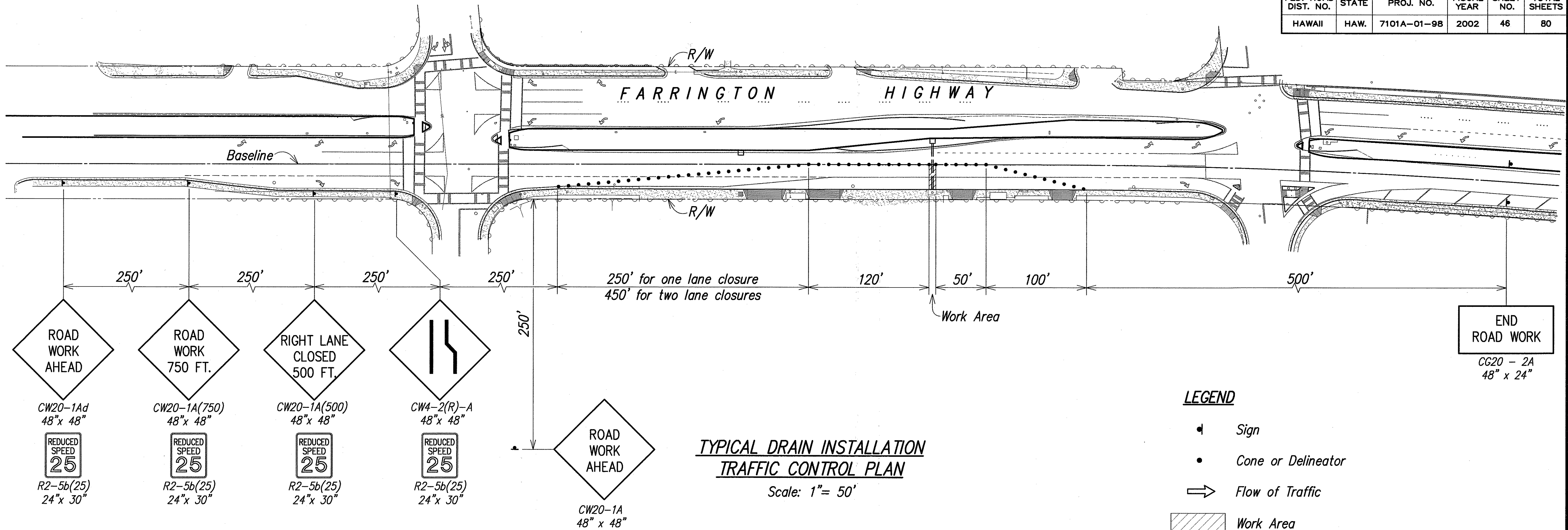

GENERAL NOTES FOR TRAFFIC CONTROL PLAN

1. THE CONTRACTOR SHALL MAKE MINOR ADJUSTMENTS WHICH ARE IN CONFORMANCE WITH THE MUTCD AT INTERSECTIONS, DRIVEWAYS, BRIDGES, STRUCTURES, ETC., TO FIT FIELD CONDITIONS.
2. CONES OR DELINEATORS SHALL BE EXTENDED TO A POINT WHERE THEY ARE VISIBLE TO APPROACHING TRAFFIC.
3. TRAFFIC CONTROL DEVICES SHALL BE INSTALLED SUCH THAT THE SIGN OR DEVICE FARTHEST FROM THE WORK AREA SHALL BE PLACED FIRST. THE OTHERS SHALL THEN BE PLACED PROGRESSIVELY TOWARD THE WORK AREA.
4. REGULATORY AND WARNING SIGNS WITHIN THE CONSTRUCTION ZONE THAT ARE IN CONFLICT WITH THE TRAFFIC CONTROL PLANS SHALL BE REMOVED OR COVERED. ALL SIGNS SHALL BE RESTORED UPON COMPLETION OF THE WORK.
5. FLAGGERS AND/OR POLICE OFFICERS SHALL BE IN SIGHT OF EACH OTHER OR IN DIRECT COMMUNICATION AT ALL TIMES.
6. WHEN REQUIRED BY THE ISSUING OFFICE, THE CONTRACTOR SHALL INSTALL A FLASHING ARROW SIGNAL AS SHOWN ON THE TRAFFIC CONTROL PLANS.
7. CONES OR DELINEATORS SHALL BE INSTALLED AT 10' o.c. MAX.
8. ALL TRAFFIC LANES SHALL BE A MINIMUM OF 10 FEET WIDE.
9. ALL CONSTRUCTION WARNING SIGNS SHALL BE PROMPTLY REMOVED OR COVERED WHENEVER THE MESSAGE IS NOT APPLICABLE OR NOT IN USE.
10. THE BACKS OF ALL SIGNS USED FOR TRAFFIC CONTROL SHALL BE APPROPRIATELY COVERED TO PRECLUDE THE DISPLAY OF INAPPLICABLE SIGN MESSAGES (I.E., WHEN SIGNS HAVE MESSAGES ON BOTH FACES).

11. AT THE END OF EACH DAY'S WORK OR AS SOON AS THE WORK IS COMPLETED, THE CONTRACTOR SHALL REMOVE ALL TRAFFIC CONTROL DEVICES NO LONGER NEEDED TO PERMIT FREE AND SAFE PASSAGE OF PUBLIC TRAFFIC. REMOVAL SHALL BE IN THE REVERSE ORDER OF INSTALLATION.
12. REPLACE PERMANENT PAVEMENT MARKINGS AND TRAFFIC SIGNS UPON COMPLETION OF EACH PHASE OF WORK.
13. ALL TRAFFIC CONTROL DEVICES INCLUDING CONES, BARRICADES, ETC., SHALL COMPLY WITH THE 2000 MANUAL ON UNIFORM TRAFFIC CONTROL DEVICES.
14. ALL EXISTING SPEED LIMIT SIGNS COVERED DURING THE LANE CLOSURE PERIOD SHALL BE UNCOVERED UPON THE REMOVAL OF THE LANE CLOSURE INCLUDING CONSTRUCTION WARNING/REGULATORY SIGNS.
15. ALL EXISTING SPEED LIMIT SIGNS WITH TRAFFIC CONTROL PLAN LIMITS SHALL BE COVERED TO PRECLUDE THEIR DISPLAY DURING IMPLEMENTATION OF TRAFFIC CONTROL PLAN. CONTRACTOR SHALL INSURE THE COVERED SIGNS ARE RESTORED UPON THE REMOVAL OF THE TRAFFIC CONTROL DEVICES. COVERING OF EXISTING SPEED LIMIT SIGNS SHALL BE CONSIDERED INCIDENTAL TO VARIOUS TRAFFIC CONTROL DEVICES.

SURVEY PLOTTED BY	DATE
DESIGNED BY	
TRACED BY	
NOTE BOOK	
QUANTITIES BY	
CHECKED BY	



THIS WORK WAS PREPARED BY
ME OR UNDER MY SUPERVISION
Cory O. Okuda
dba PARK ENGINEERING

STATE OF HAWAII
DEPARTMENT OF TRANSPORTATION
HIGHWAYS DIVISION
TRAFFIC CONTROL PLAN NOTES
TYPICAL DRAIN INSTALLATION
TRAFFIC CONTROL PLAN
FARRINGTON HIGHWAY LANDSCAPING
Kamehameha Highway to Fort Weaver Road
Project No. 7101A-01-98
Scale: As Noted Date: April 2002
SHEET No. TE1 OF 4 SHEETS

FED. ROAD DIST. NO.	STATE	PROJ. NO.	FISCAL YEAR	SHEET NO.	TOTAL SHEETS
HAWAII	HAW.	7101A-01-98	2002	47	80

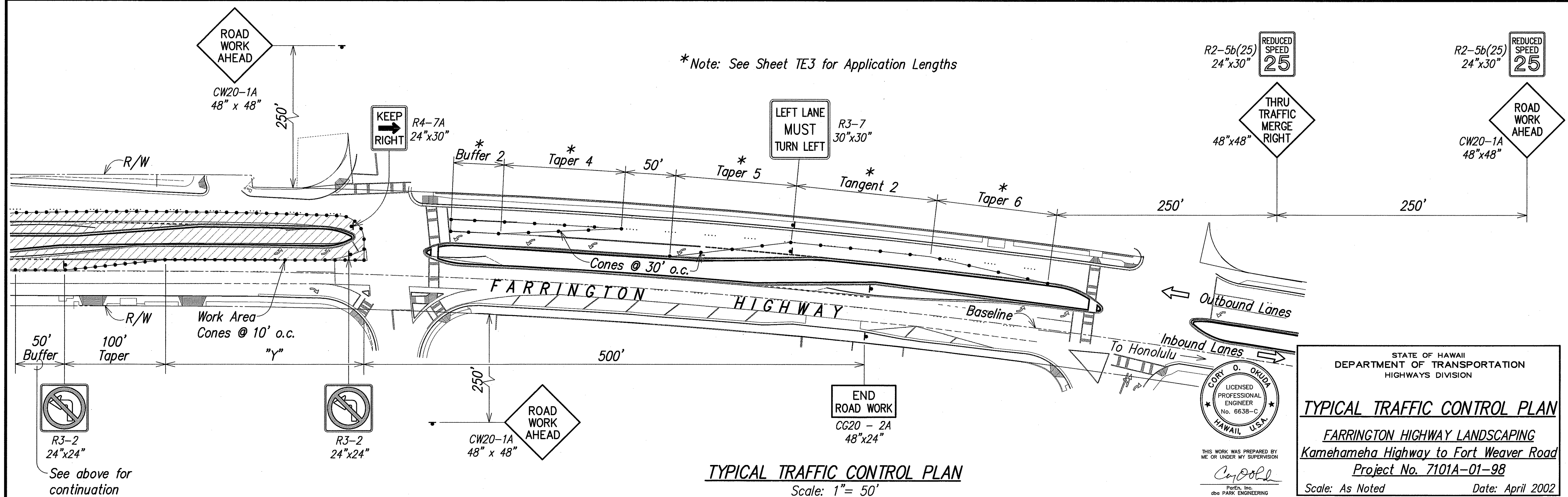
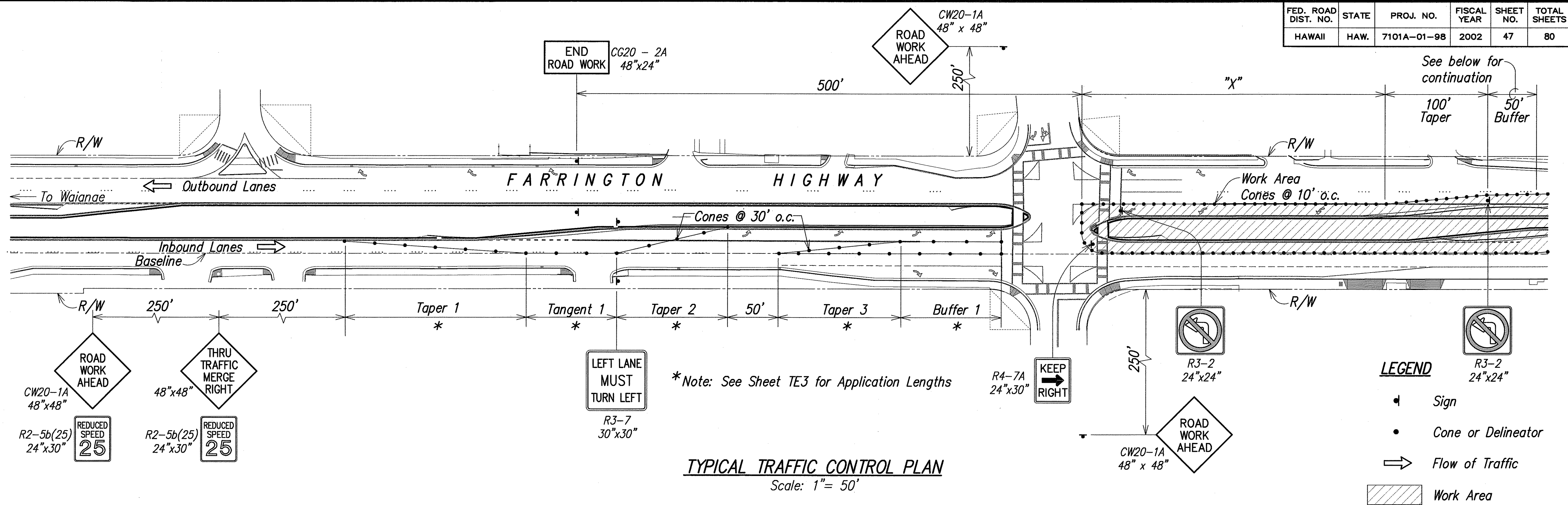

SURVEY PLOTTED BY	DATE
DRAWN BY	
TRACED BY	
CHECKED BY	
ORIGINAL PLAN	
NOTE BOOK	
No.	

FED. ROAD DIST. NO.	STATE	PROJ. NO.	FISCAL YEAR	SHEET NO.	TOTAL SHEETS
HAWAII	HAW.	7101A-01-98	2002	48	80

WORK AREA SCHEDULE

Block	Taper 1	Tan 1	Taper 2	Taper 3	Buffer 1	"X"	"Y"	Buffer 2	Taper 4	Taper 5	Tan 2	Taper 6
Leoku Street – Leokane Street	100'	100'	50'	100'	100'	300'	355'	100'	220'	50'	100'	250'
Leokane Street – Pupukahi Street	180'	100'	100'	120'	100'	300'	200'	100'	120'	120'	140'	120'
Pupukahi Street – Pupupuhi Street	180'	130'	120'	120'	100'	160'	90'	50'	120'	120'	80'	120'
Pupupuhi Street – Aniani Place	180'	100'	100'	120'	100'	N/A	N/A	90'	120'	250'	200'	250'
Waipuhu Depot Road – Awalau/Mokuola Street	250'	200'	250'	250'	120'	150'	85'	80'	100'	120'	100'	150'
Awalau/Mokuola St. – Cane Haul Road	250'	100'	250'	250'	100'	100'	100'	80'	120'	250'	150'	250'
Cane Haul Road – Awamoku Street	150'	100'	120'	100'	80'	N/A	N/A	80'	120'	250'	150'	250'
Awamoku Street – Paiwa/Awanui Street	150'	100'	120'	100'	80'	100'	235'	50'	80'	80'	50'	90'
Paiwa/Awanui Street – KDEO Radio	250'	150'	250'	120'	80'	N/A	N/A	100'	150'	150'	120'	180'
KDEO Radio – Kahualii/Waipio Access Rd	90'	50'	80'	80'	50'	N/A	200'	100'	250'	250'	200'	250'
Kahualii/Waipio Access Rd. – End Project	180'	120'	150'	150'	100'	300'	N/A	50'	80'	80'	50'	90'

ORIGINAL PLAN	SURVEY PLOTTED BY _____	DATE _____
NOTE BOOK No. _____	DRAWN BY _____	
	DESIGNED BY _____	
	QUANTITIES BY _____	
	CHECKED BY _____	



THIS WORK WAS PREPARED BY
ME OR UNDER MY SUPERVISION

Cory O. Okuda

dba PARK ENGINEERING

STATE OF HAWAII
DEPARTMENT OF TRANSPORTATION
HIGHWAYS DIVISION

TRAFFIC CONTROL SCHEDULES

FARRINGTON HIGHWAY LANDSCAPING
Kamehameha Highway to Fort Weaver Road
Project No. 7101A-01-98

Scale: As Noted Date: April 2002

SHEET No. 7E3 OF 4 SHEETS

FED. ROAD DIST. NO.	STATE	PROJ. NO.	FISCAL YEAR	SHEET NO.	TOTAL SHEETS
HAWAII	HAW.	7101A-01-98	2002	49	80

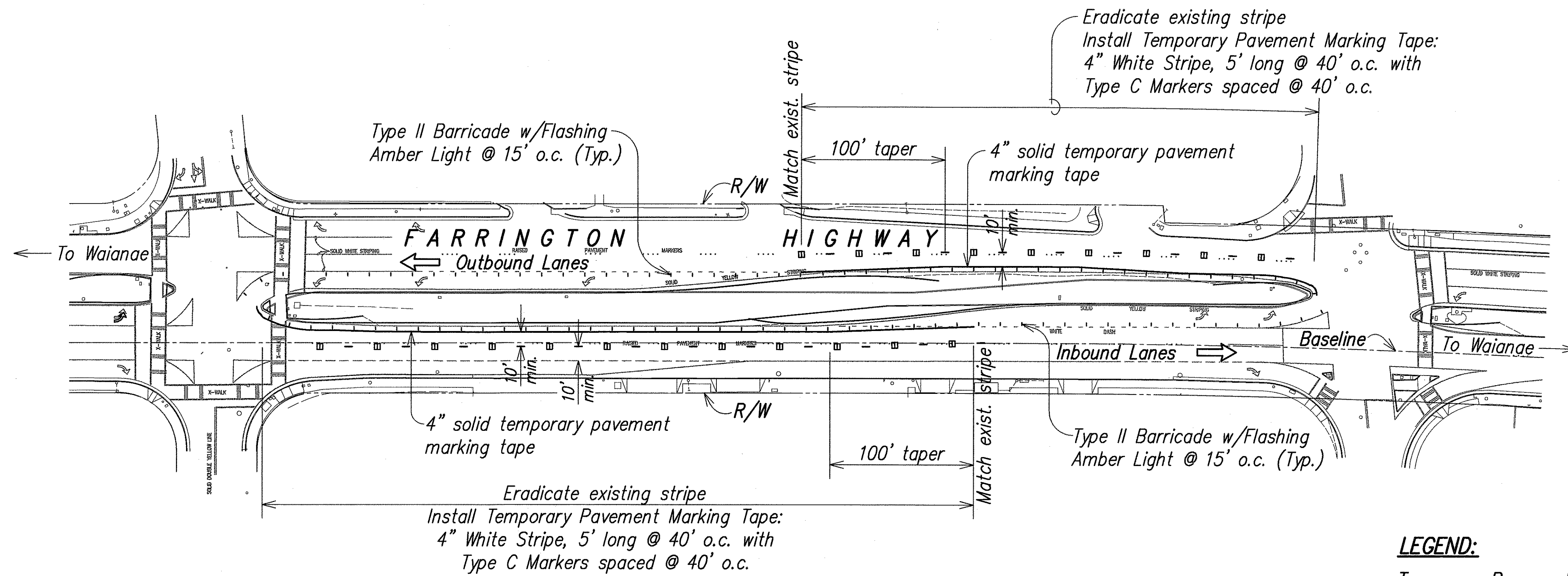

TYPICAL DIVERSION PLAN
Scale: 1" = 50'

LEGEND:

Temporary Pavement Marking:

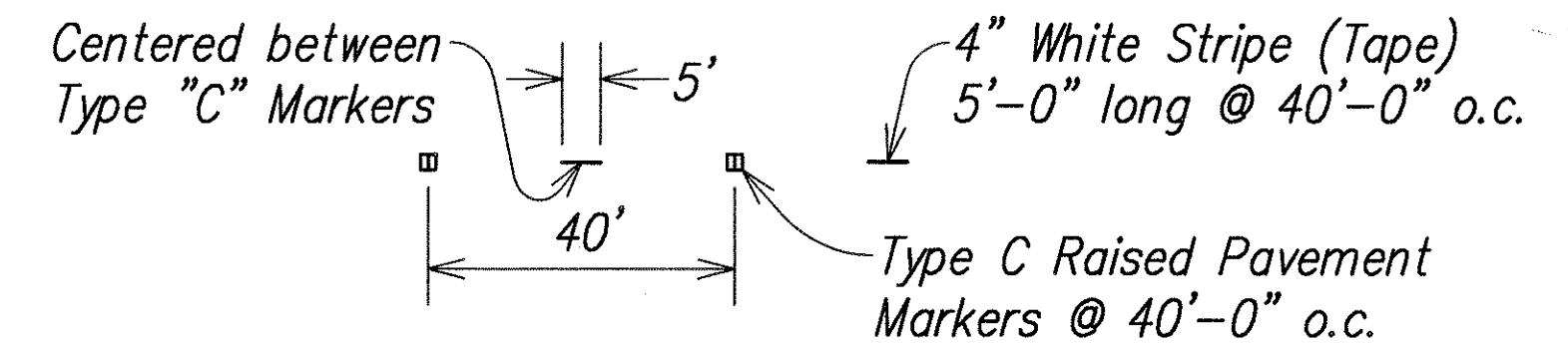

→ Flow of Traffic

**DIVERSION PLAN SUMMARY FOR
TEMPORARY RESTIPING**

Outbound	Inbound
61+85 To 71+45	57+10 To 66+10
76+80 To 79+35	72+05 To 76+00
82+60 To 86+85	80+00 To 85+00
123+00 To 130+30	87+70 To 90+85
135+25 To 137+05	118+90 To 128+55
137+80 To 139+40	131+00 To 135+15
141+75 To 149+25	137+80 To 139+40
151+75 To 154+30	139+90 To 143+30
154+90 To 162+85	150+15 To 152+30
169+00 To 11+00	154+90 To 159+30
	163+65 To 11+00

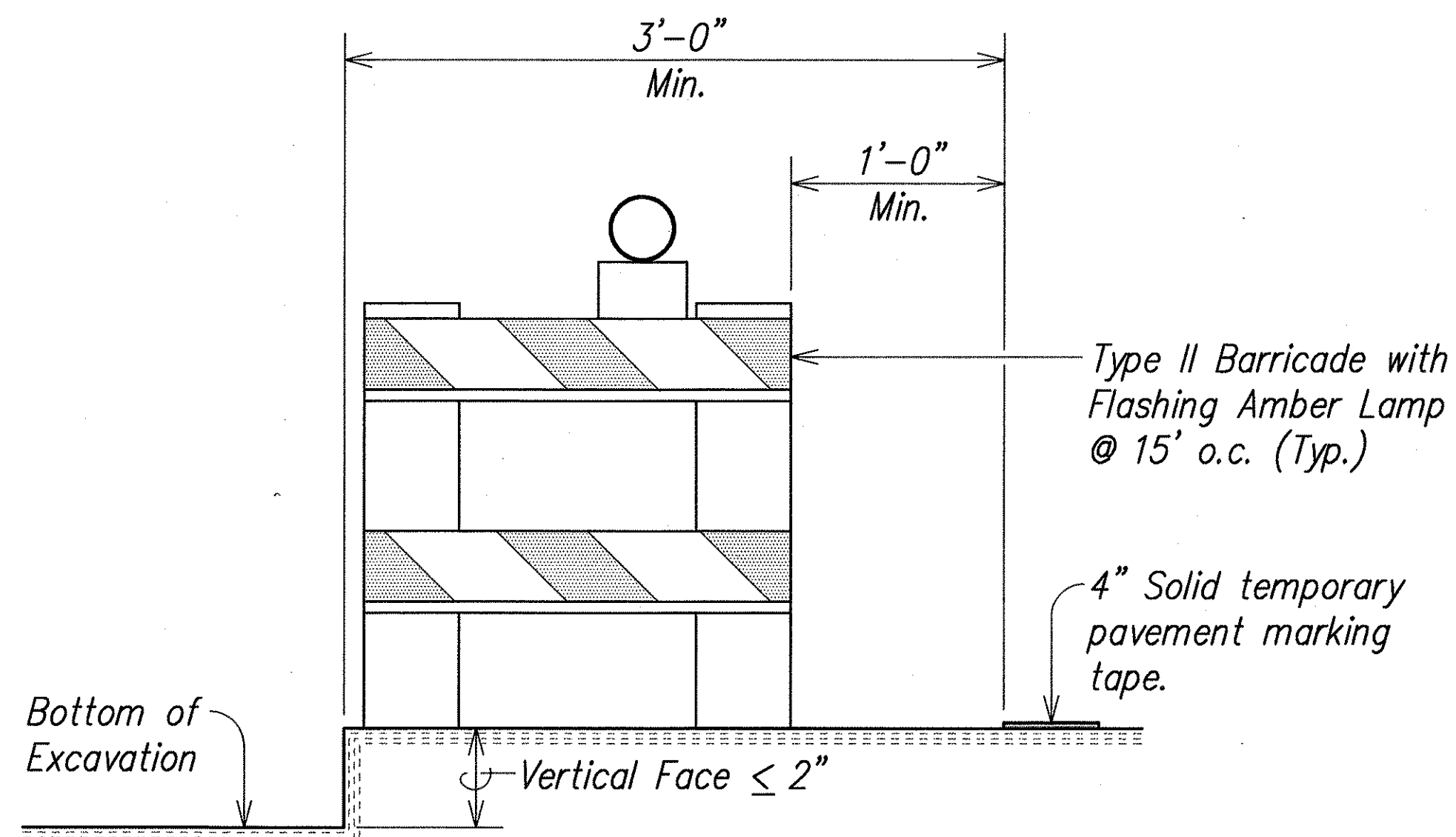

TYPICAL SECTION
TEMPORARY TRAFFIC CONTROL AT EXCAVATIONS
DURING NON-WORK HOURS
Not to Scale



THIS WORK WAS PREPARED BY
ME OR UNDER MY SUPERVISION

Cory O. Okuda
dba PARK ENGINEERING

STATE OF HAWAII
DEPARTMENT OF TRANSPORTATION
HIGHWAYS DIVISION

TYPICAL DIVERSION PLAN
FARRINGTON HIGHWAY LANDSCAPING
Kamehameha Highway to Fort Weaver Road
Project No. 7101A-01-98

Scale: As Noted Date: April 2002
SHEET No. TE4 OF 4 SHEETS