

TRAFFIC SIGNAL NOTES

- ALL TRAFFIC SIGNAL CONTROLLER EQUIPMENT SHALL BE COMPLETELY WIRED IN THE CABINET AND SHALL CONTROL THE TRAFFIC SIGNALS AS CALLED FOR IN THE PLAN.
- SIGNAL INDICATIONS DURING CLEARANCE INTERVAL:
 - IF A SIGNAL IS G OR ~~G~~ AND WILL REMAIN G OR ~~G~~ DURING THE NEXT PHASE, IT SHALL BE G OR ~~G~~ DURING THE CLEARANCE INTERVAL.
 - IF A SIGNAL IS G OR ~~G~~ AND WILL BECOME R OR EXTINGUISHED DURING THE NEXT PHASE, IT SHALL BE Y OR ~~Y~~ DURING THE CLEARANCE INTERVAL.
 - IF A SIGNAL IS R AND WILL REMAIN R OR BECOME G DURING THE NEXT PHASE, IT SHALL BE R DURING THE CLEARANCE INTERVAL.

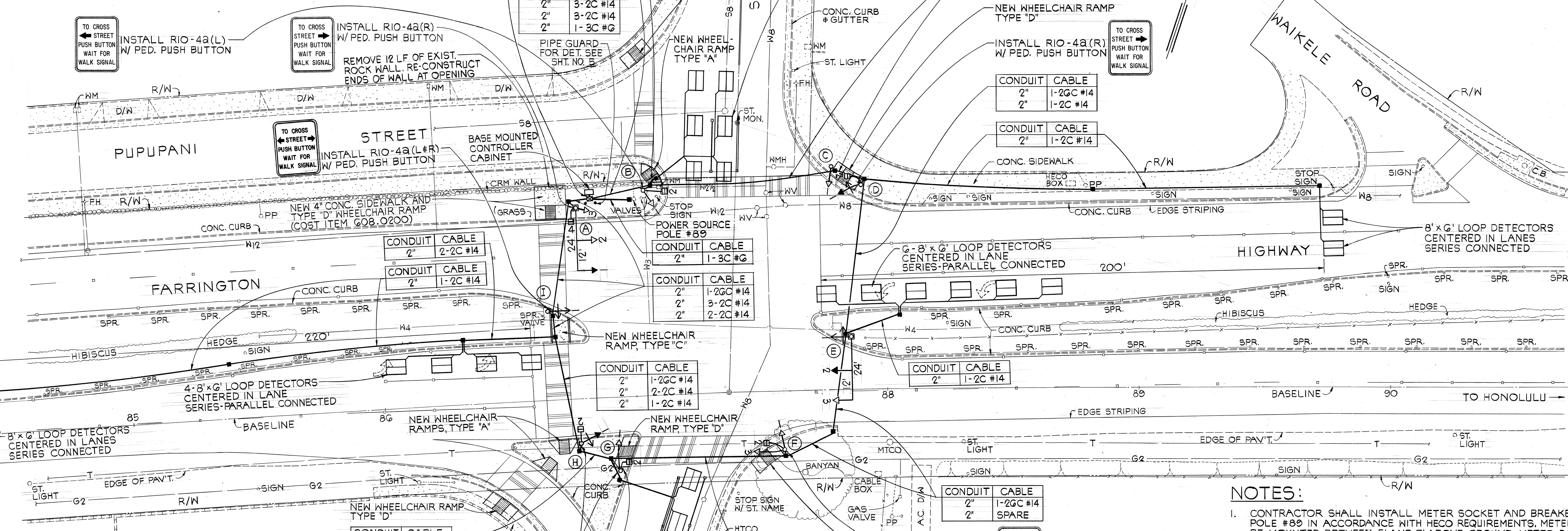

LEGEND

- STANDARD TRAFFIC AND PEDESTRIAN SIGNAL HEADS MOUNTED ON TYPE I SIGNAL STANDARD, HEIGHT 10'
- PROGRAMMED VISIBILITY HEAD
- 12" RY↑ TRAFFIC SIGNAL HEAD
- 12" RY↓ STANDARD TRAFFIC SIGNAL HEAD
- TRAFFIC SIGNAL HEADS MOUNTED ON TYPE II SIGNAL STANDARD, ARM SPREAD SHOWN 24' AND DISTANCE BETWEEN SIGNAL HEADS SHOWN IS 12'
- 12" RY← TRAFFIC SIGNAL HEAD
- STANDARD TYPE "B" PULLBOX
- TYPE "D" PULLBOX
- LOOP DETECTOR, SERIES-PARALLEL CONNECTED
- LOOP DETECTOR, SERIES CONNECTED
- W12 EXISTING UTILITY LINES & SIZES AS INDICATED
W = WATER
S = SEWER
T = TELEPHONE
G = GAS

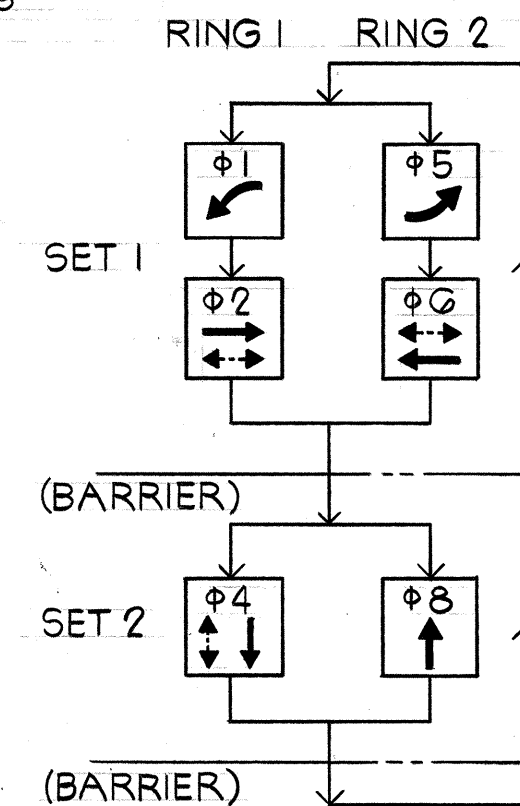

PHASE DIAGRAM

R	R	R	
Y	Y	Y	
G	↑	←	
A-2	A-1	D-1	A-4
A-3	E-2	*E-1	B-2
B-1		H-1	D-2
C-1		*I-1	F-2
E-3			G-2
F-1			H-2
F-3			
G-1			

* PROGRAMMED VISIBILITY HEAD

SIGNAL INDICATIONS

NOTES:

- CONTRACTOR SHALL INSTALL METER SOCKET AND BREAKER ON POLE #80 IN ACCORDANCE WITH HECO REQUIREMENTS. METER SHALL BE MOUNTED BETWEEN 5' AND 7' ABOVE GROUND. METER SOCKET SHALL BE 4-PRONG COMPLETE WITH A MANUAL CIRCUIT CLOSING DEVICE. A 50-AMP. CIRCUIT BREAKER IN WEATHERPROOF BOX SHALL BE PROVIDED.
- THE CONTROLLER FURNISHED SHALL BE A 2-8 PHASE CONTROLLER. A COORDINATION UNIT IS NOT REQUIRED ON THIS PROJECT. HOWEVER, CABINET SHALL BE WIRED TO ACCEPT A FUTURE COORDINATION UNIT.
- MINIMUM CONTROLLER CABINET SIZE SHALL BE 40" HIGH, 24" WIDE AND 14" DEEP.
- COST OF REMOVAL OF EXISTING ROCK WALL FOR SIDEWALK CONSTRUCTION AND FINISHING ENDS OF THE WALL AT THE NEW OPENING SHALL BE CONSIDERED INCIDENTAL TO THE COST OF THE SIDEWALK (ITEM G08.0200).

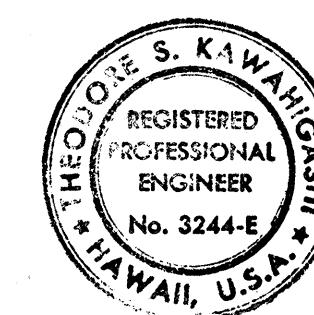

THIS WORK WAS PREPARED BY ME OR UNDER MY SUPERVISION
Theodore S. Kawahara
 Signature

STATE OF HAWAII
 DEPARTMENT OF TRANSPORTATION
 HIGHWAYS DIVISION
 FARRINGTON HIGHWAY
 TRAFFIC SIGNALS AT
 PUPUPUHI STREET
 PROJECT NO. 9000A-01-81

TRAFFIC SIGNAL PLAN
 SCALE: AS SHOWN DATE: 12-24-80
 SHEET NO. 1 OF 1 SHEETS